

USE & CARE MANUAL



utility

Electrical Service:

A 110V, 60 Hz, 15 Amp GFCI protected grounded circuit must be used to supply power to the pedicure spa.

Water Supply:

· Observe and follow all local codes in regards to plumbing connections.

· 30 to 80 PSI water pressure is needed to correctly fill the basin a correct level.

· The hot water supply temperature must not exceed 150° F (65° C); exceeding this temperature may cause damage to your unit and injury. If the temperature is higher than this, then please lower your water heater to the correct and acceptable temperature.

· Carefully connect the incoming water supply lines to the appropriate fittings located on the back of the pedicure spa.

For hot and cold water supply fittings (see figure 2) below.

· Shut-off valves are recommended.

· To prevent the water supply contamination, our shower head includes a back flow preventer. (see figure 1)

We also highly recommend you to install a Reduced Pressure Back Flow for each hot & cold water supply line.

Please check with your local plumbing code requirements.

You are responsible for your valves, connections, and compliance to local codes.

figure 1

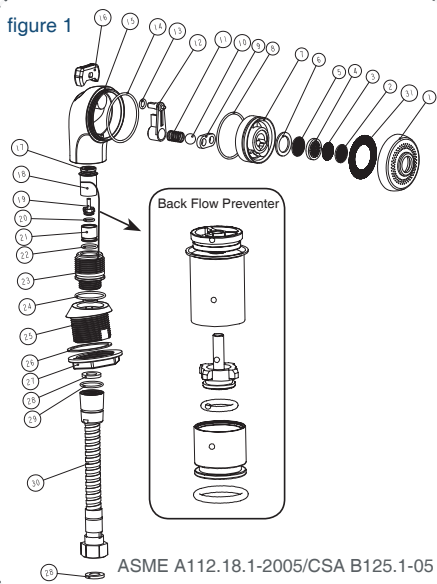

figure 2

Attach hose with red markings to hot water line.

Our Hot & Cold 8' Stainless Steel Hoses are UPC Approved

installation

Location and Support

The pedicure spa must be on a level location. The floor structure of that location must be capable of supporting both the pedicure spa and its occupant at the same time.

To fully recline the pedicure chair, the base of the unit must be positioned to a minimum of 25" from the wall.

Minimum installation dimensions:....W 30" x L 69"

Licensed Installation Required

Please check your local plumbing and electrical codes. Installation of this pedicure spa must comply with both. You must hire a licensed plumber and a licensed electrician to complete the applicable connections to your pedicure spa.

NOTE: Failure to comply with federal, state, or local codes will result in the warranty being null and void.

Parts Included:
5 bolts, 1 Allen Wrench

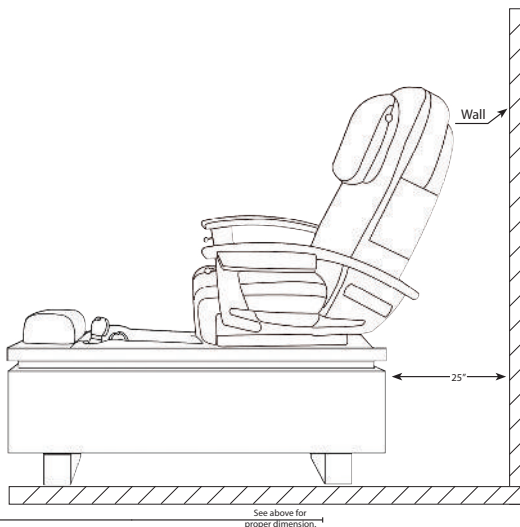

drain installation

Wall Drain Installation

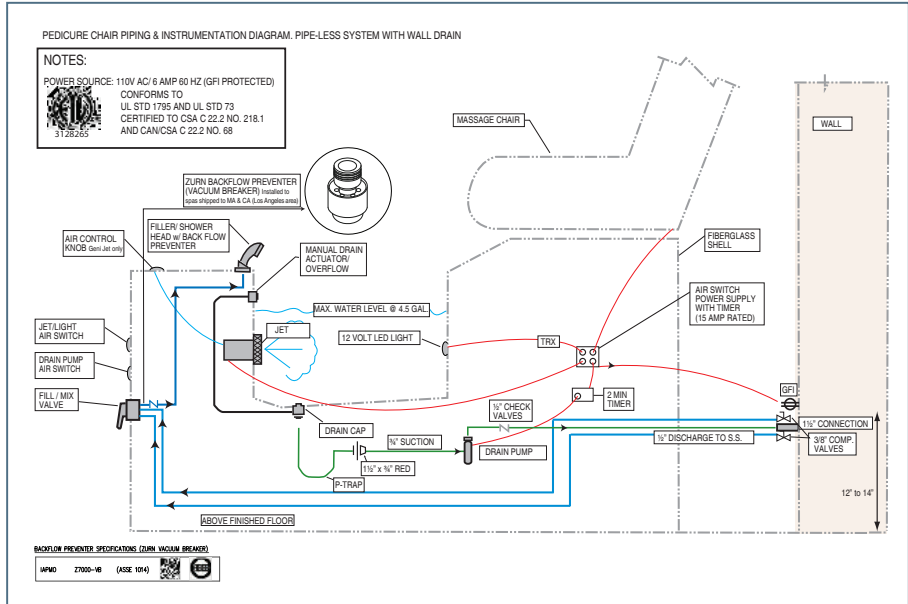

Floor Drain Installation

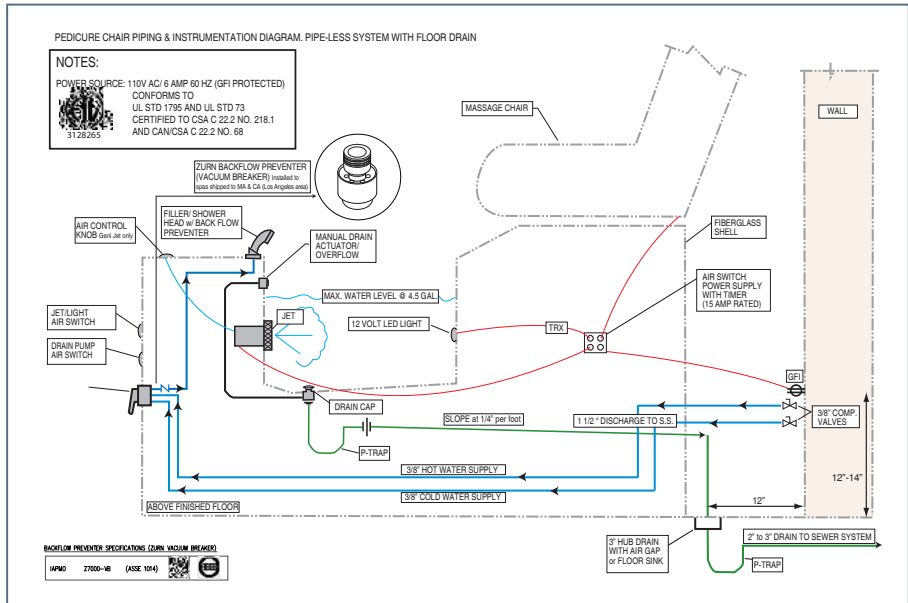

spa basin operation

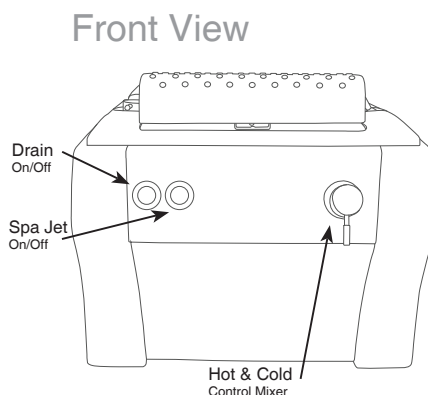
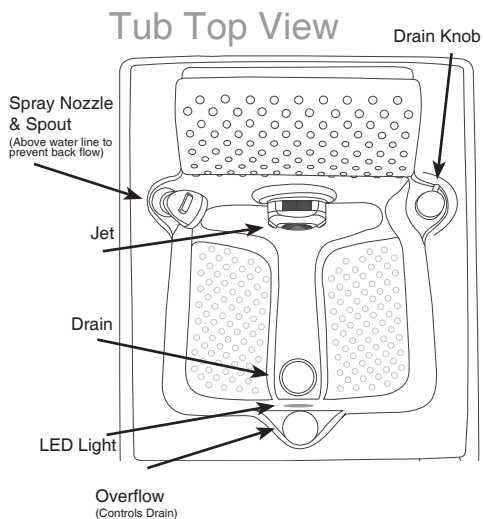

Preparing the Pedicure Spa for Operation:

Clean and disinfect the basin following the instructions on page 17 before initial use.

Operating the Pedicure Spa:

Add Water to the Pedicure Spa Basin:

1. Turn the overflow knob counter-clockwise until it stops to close drain.
2. Lift upward on the hot & cold control mixer to add water to the basin. Turn the handle in a counter-clockwise direction for cold water or clockwise for warm water as indicated by the red (hot) and blue (cold) markings under the handle. Continue to add water until the fill line is reached. The fill line is indicated by the wavy (~~~~) line in the basin.
3. Turn the off water by pushing the handle downward. Start or stop the whirlpool by pressing the jet button.

CAUTION: Always check water temperature before use; hot water can burn skin and can cause serious injuries. Water temperature should not exceed 105° F (41° C).

Remove water from the Pedicure Spa Basin: Make certain the whirlpool jets are turned off by pressing the jet button.

For use with a floor drain, simply open the drain by turning the drain knob in a clockwise direction until it stops. You should see the water level lowering as water exits the basin.

For use with the optional drain pump feature, open the drain by turning the drain knob in a clockwise direction until it stops. Press the silver button marked "Drain" on the front panel. The water level will lower as water is pumped out of the basin. Turn the pump off by pressing the "Drain" button on the front panel once the basin is fully drained (NOTE: the drain pump will automatically shut off after 2 minutes.) We recommend turning off the pump manually if all water has drained before automatic shut-off. Drain pump may overheat if operated more than 10 minutes.

NOTE: If you are using a wall drain, it is very important that you close the drain cap for each use. Failure to do so will result in contamination of the system.

HT-245-PS installation



CAUTION: Massage chair is heavy. To install chair to basin two people are required. Risking and attempting to install by yourself could result in serious injuries or damage to the products.

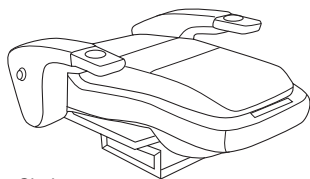

Chair

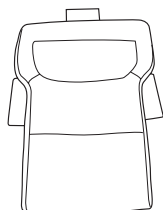

Backrest Pad

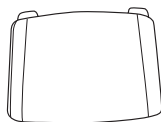

Seat Pad

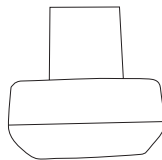

Head Pillow

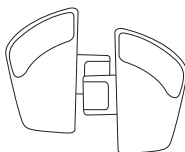

Manicure Trays



Control Dock

box contents

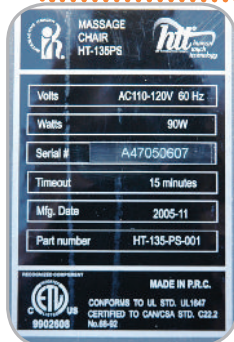

1. Please write down all of your serial #s and important information on page 3 in this manual. Register your spa and HT massage chair by filling out and return warranty registration form or fill out form on buynailsdirect.com

2. Remove chair out of the box carefully, make sure that you do not grab the armrest. Lifting the chair incorrectly may cause damage to the chair. Place chair on the tub.

3. While one person holds the chair in place, the second person flips up the bottom cover.

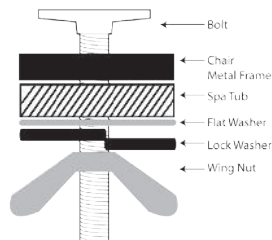
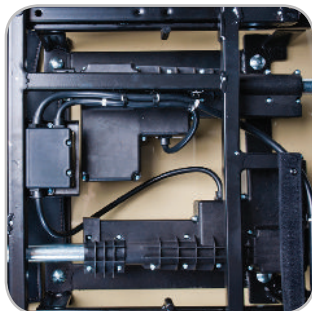

4. Lift the bottom cover. Plug chair in. Move chair forward / backward with remote control to clear the holes. Align bolt holes in chair with holes in spa.

5. Place bolts into holes. Add the washers according to the following drawing. (figure 6)

6. Install bolt and washers in order shown here. Tighten bolts by reaching underneath the chair. Bolt is not tight until lock washer is fully flat. This will prevent the chair's vibration from unscrewing the bolt.



1. Unfold the chair

Remove all packaging materials from the chair. Pull gently up on the backrest to unfold the chair to an upright position. The backrest locks into place automatically.

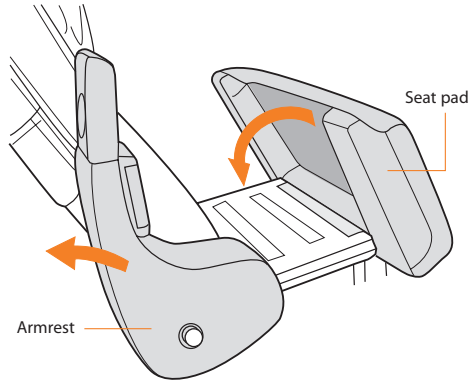

2. Attach the seat pad

Raise both armrests. Place the seat pad into position, with the front edge placed firmly against the front of the seat frame. While holding the front of the seat pad to ensure that it remains flush with seat frame, press down firmly on the seat pad to secure it to the seat canvas support.

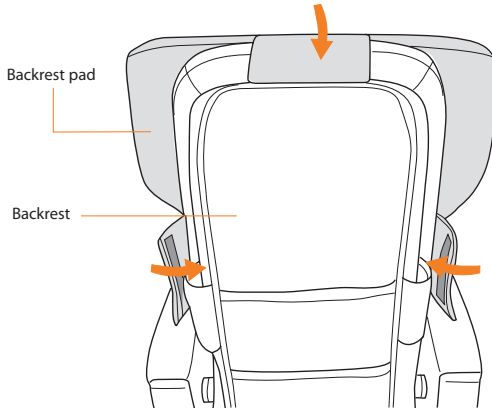

3. Attach the backrest pad

Attach the two side flaps to the backrest using the hook-and-loop fasteners.

From the front of the chair, grasp the bottom backrest pad flap and pull downward to detach the hook and loop fasteners from the back of the backrest pad. Pulling firmly down on the backrest pad, attach the bottom flap to the bottom of the backrest using the hook and loop fasteners.

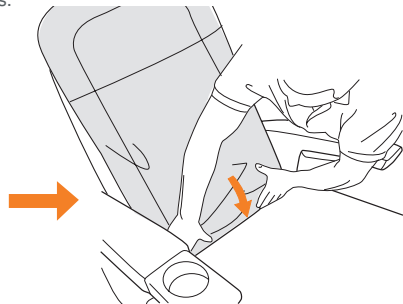
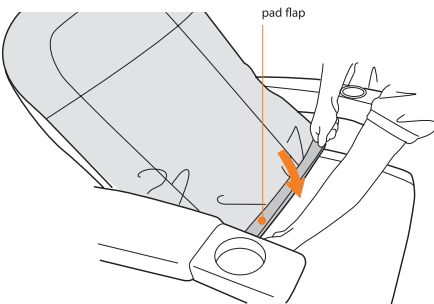



4. Attach the head pillow

Attach the head pillow flap to the backrest at the desired height using the hook-and-loop fasteners

Head pillow flap

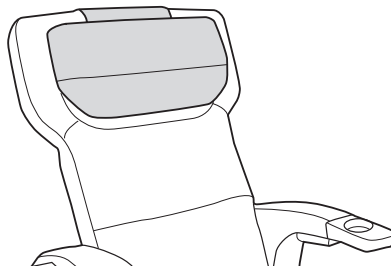
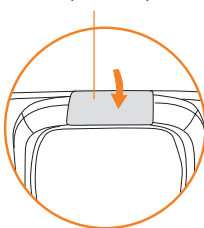

5. Attach the manicure trays

Holding the tray with two hands, align the locking tongue with the mounting dock and insert the tongue straight into the dock. Use the palm of your hand to tap the tongue into the dock until the tray edge is flush with the armrest. To remove the tray, use your fingers to press and hold the release button on the bottom of the tray while pulling outward on the tray with your other hand to release the locking tongue from the dock. Once the tongue is unlocked, use both hands to pull the tray straight out from the dock. When not in use, store the trays in the convenient storage pocket in the back of the back rest.

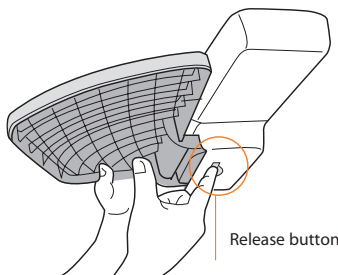
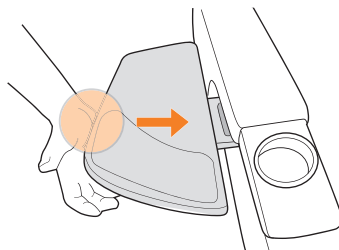
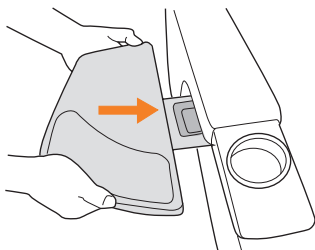

Release button

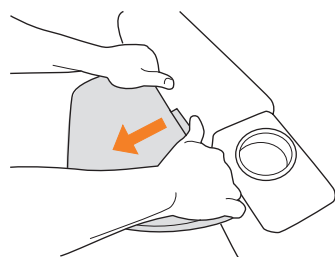

6. Install the controller dock

Remove the cup holder from the armrest in which you want to install the controller dock, then place the controller dock into the armrest receptacle. The controller slides easily into the dock, which rotates 360 degrees for your convenience. Secure the controller dock by installing the screw knob beneath the armrest. Tighten the knob to lock the controller dock into position or leave it loose to allow 360-degree rotation.

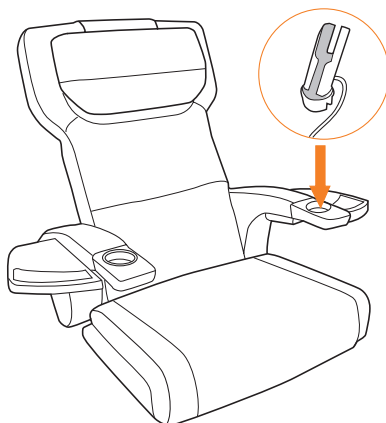



HT-245-PS features

PURSE HANGER

Pull gently outward on the purser hanger for a convenient place to store purses.

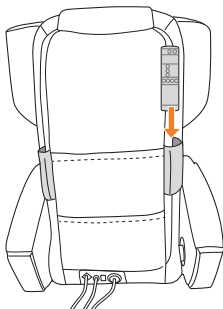
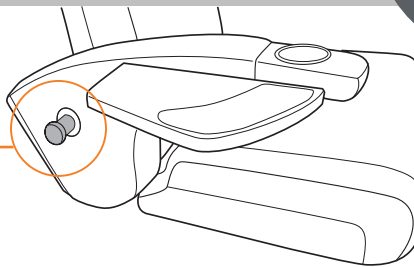

CONTROLLER POCKETS

If your controller holder is not installed in one of the armrests, you can still store the controller conveniently out of the way using one of the controller pockets, located on the each side of the backrest.

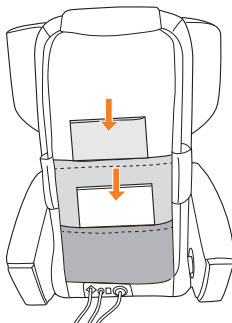

TWO STORAGE POCKETS



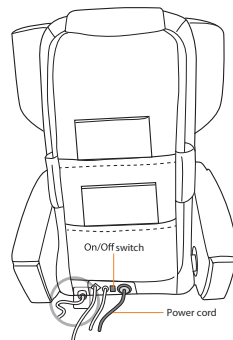

Two convenient pockets located on the backrest provide handy storage for clip boards and manicure tables.



POWER ON

Plug the power cord into a ground power source, then turn the on/off switch on the back of the backrest to ON. Press the red button on the GFI breaker at the end of the power cord to activate power to the chair.

MASSAGE TECHNIQUES

Massage Techniques	What it Does	Benefits
KNEADING 	Kneads your back in a small circular motion on both sides of your spine simultaneously	Relieves tension and soreness by lifting and stretching muscles. Improves circulation and helps bring vital nutrients to the spinal area.
KNEADING + PERCUSSION 	Combines circular kneading motion with rapid-tapping percussion strokes.	Relieves muscle tension and spinal pressure, improves circulation and invigorates the back all at once.
PERCUSSION 	Alternates rapid-tapping strokes along the spine to stimulate both spinal muscle and spinal joint areas, emulating the percussive massage technique used in sports medicine for deep muscle therapy	Flexes spinal joints and relieves pressure on the spinal column, invigorates the entire back area.
ROLLING 	Rolls gently up and down your back near your spine.	Warms and loosens your muscles, preparing your back for deeper massage. Relieve muscle tension, improves circulation and relaxes the back.

HT-045-PS installation



CAUTION: Massage chair is heavy. To install chair to basin two people are required. Risking and attempting to install by yourself could result in serious injuries or damage to the products.

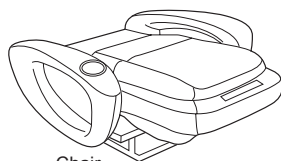

Chair

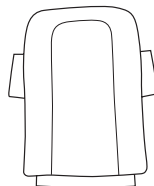

Backrest Pad

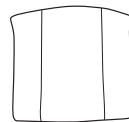

Seat Pad



Head Pillow



Manicure Trays

box contents



1. Please write down all of your serial #s and important information on page 3 in this manual. Register your spa and HT massage chair by filling out and return warranty registration form or fill out form on buynailsdirect.com

2. Remove chair out of the box carefully, make sure that you do not grab the armrest. Lifting the chair incorrectly may cause damage to the chair. Place chair on the tub.

3. While one person holds the chair in place, the second person flips up the bottom cover.

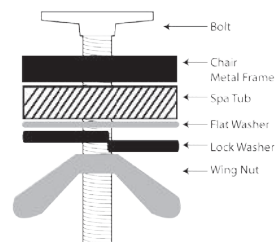
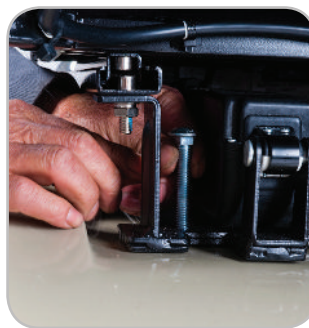
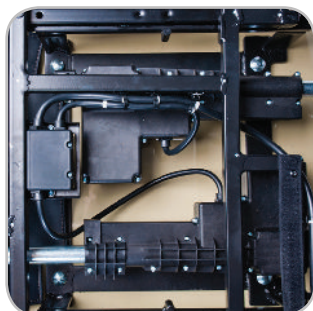

4. Lift the bottom cover. Plug chair in. Move chair forward / backward with remote control to clear the holes. Align bolt holes in chair with holes in spa.

5. Place bolts into holes. Add the washers according to the following drawing. (figure 6)

6. Install bolt and washers in order shown here. Tighten bolts by reaching underneath the chair. Bolt is not tight until lock washer is fully flat. This will prevent the chair's vibration from unscrewing the bolt.

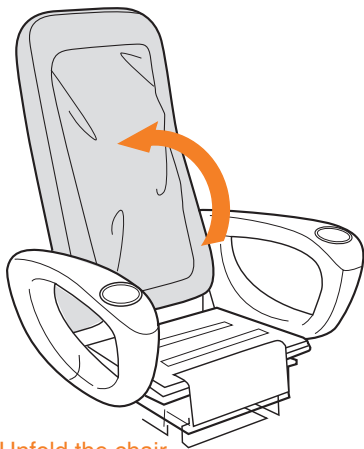

1. Unfold the chair

Remove all packaging material from the chair. Pull gently up on the backrest to unfold the chair to an upright position. The backrest locks into place automatically.

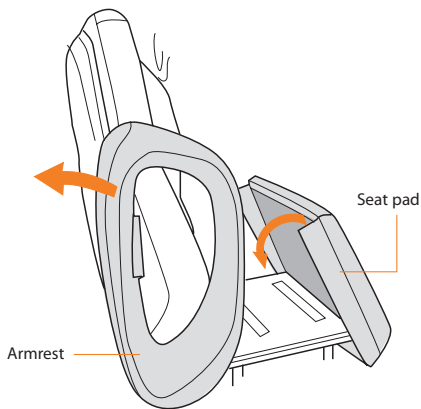

2. Attach the seat pad

Raise both armrest. Place the seat pad into position, with the front edge placed firmly against the front of the seat frame. While holding the front of the seat pad to ensure that it remains flush with the seat frame, press down firmly on the seat pad to secure it to the seat canvas support.

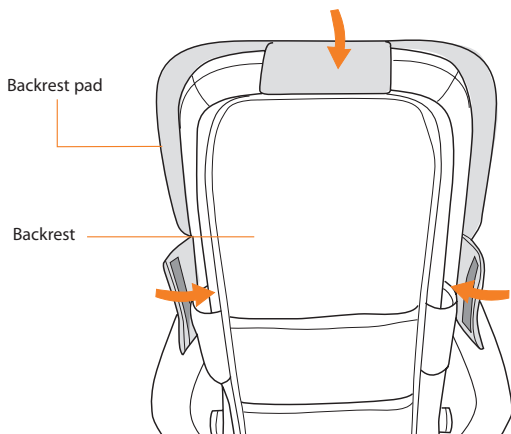

3. Attach the backrest pad

Place the backrest pad into position, then attach the top flap to backrest using the hook-and-loop fasteners. Attach the two side flaps to the backrest using the hook-and-loop fasteners.

From the front of the chair, grasp the bottom pad flap and pull downward to detach the hook and loop fasteners from the back of the backrest pad. Pulling firmly down on the backrest pad, attach the bottom flap to the bottom of the backrest using the hook and loop fasteners.

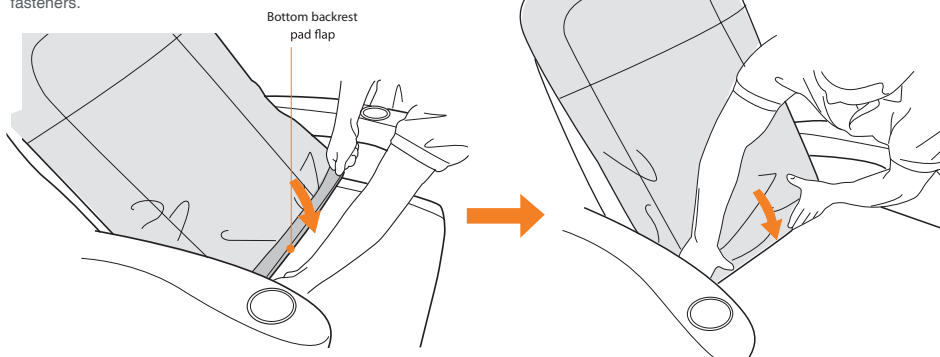



Head pillow flap

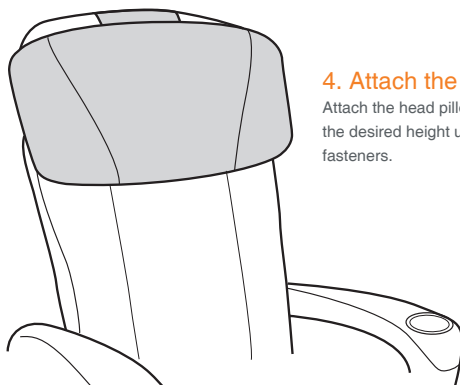
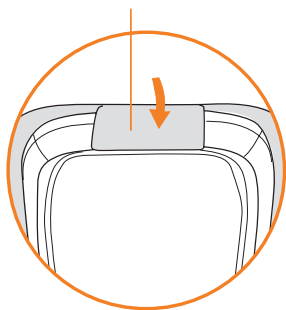

4. Attach the head pillow

Attach the head pillow flap to the backrest at the desired height using the hook-and-loop fasteners.

5. Attach the manicure trays

Holding the tray with two hands, align the locking tongue with the mounting dock and insert the tongue straight into the dock. Use the palm of your hand to tap the tongue into the dock until the tray edge is flush with the armrest.

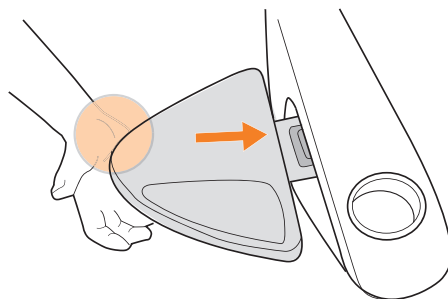
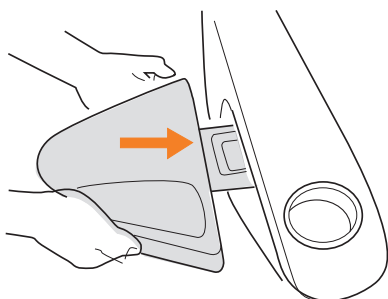

To remove the tray, use your fingers to press and hold the release button on the bottom of the tray while pulling outward on the tray with your other hand to release the locking tongue from the dock. Once the tongue is unlocked, use both hands to pull the tray straight out from the dock. Store the tables in the convenient table storage pocket on the back of the chair.

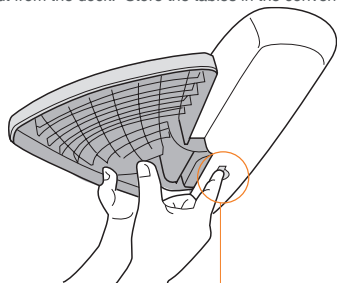

Release button

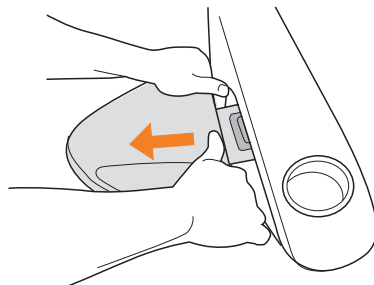

HT-045-PS features

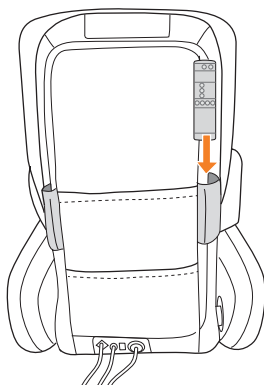

CONTROLLER POCKETS

If your controller holder is not installed in one of the armrests, you can still store the controller conveniently out of the way using one of the controller pockets, located on the each side of the backrest.

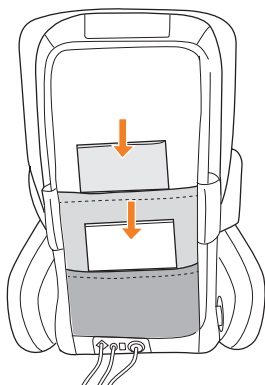

TWO STORAGE POCKETS



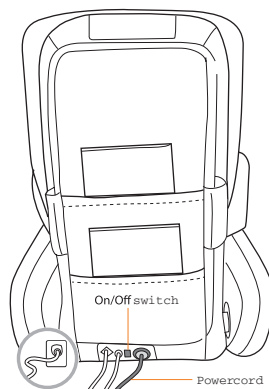

Two convenient pockets located on the backrest provide handy storage for clip boards and manicure tables.



POWER ON

Plug the power cord into a ground power source, then turn the on/off switch on the back of the backrest to ON. Press the red button on the GFI breaker at the end of the power cord to activate power to the chair.

MASSAGE TECHNIQUES

Massage Techniques	What it Does	Benefits
KNEADING 	Kneads your back in a small circular motion on both sides of your spine simultaneously	Relieves tension and soreness by lifting and stretching muscles. Improves circulation and helps bring vital nutrients to the spinal area.
KNEADING + PERCUSSION 	Combines circular kneading motion with rapid-tapping percussive strokes.	Relieves muscle tension and spinal pressure, improves circulation and invigorates the back all at once.
PERCUSSION 	Alternates rapid-tapping strokes along the spine to stimulate both spinal muscle and spinal joint areas, emulating the percussive massage technique used in sports medicine for deep muscle therapy	Flexes spinal joints and relieves pressure on the spinal column, invigorates the entire back area.
ROLLING 	Rolls gently up and down your back near your spine.	Warms and loosens your muscles, preparing your back for deeper massage. Relieve muscle tension, improves circulation and relaxes the back.

HT-044-PS installation



CAUTION: Massage chair is heavy. To install chair to basin two people are required. Risking and attempting to install by yourself could result in serious injuries or damage to the products.

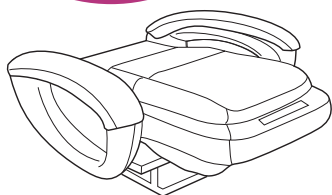

Chair
box contents

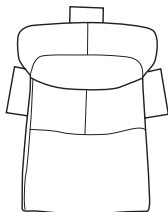

Backrest Pad

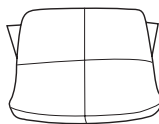

Seat Pad

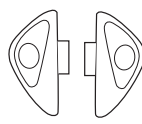

Manicure Trays



1. Please write down all of your serial #s and important information on page 3 in this manual. Register your spa and HT massage chair by filling out and return warranty registration form or fill out form on buynailsdirect.com



2. Remove chair out of the box carefully, make sure that you do not grab the armrest. Lifting the chair incorrectly may cause damage to the chair. Place chair on the tub.



3. While one person holds the chair in place, the second person flips up the bottom cover.

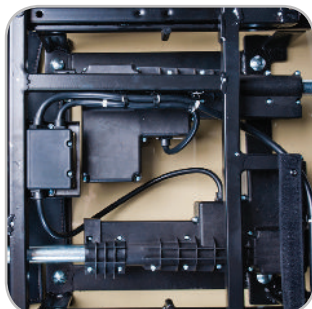

4. Lift the bottom cover. Plug chair in. Move chair forward / backward with remote control to clear the holes. Align bolt holes in chair with holes in spa.



5. Place bolts into holes. Add the washers according to the following drawing. (figure 6)

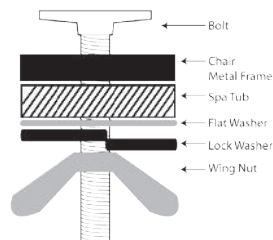

6. Install bolt and washers in order shown here. Tighten bolts by reaching underneath the chair. Bolt is not tight until lock washer is fully flat. This will prevent the chair's vibration from unscrewing the bolt.

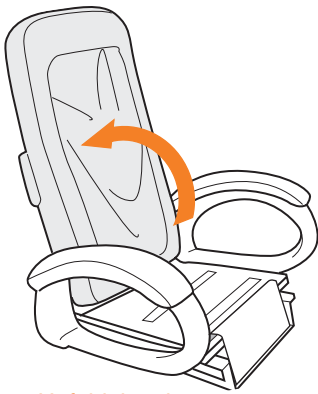

1. Unfold the chair

Remove all packaging material from the chair. Pull gently up on the backrest to unfold the chair to an upright position. The backrest locks into place automatically.

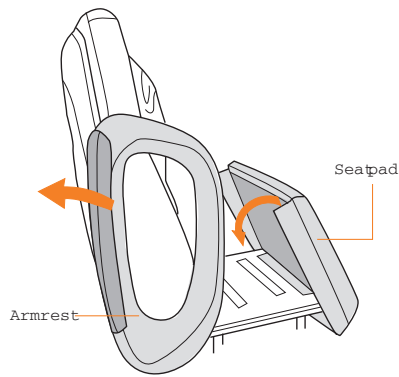

2. Attach the seat pad

Raise both armrest. Place the seat pad into position, with the front edge placed firmly against the front of the seat frame. While holding the front of the seat pad to ensure that it remains flush with the seat frame, press down firmly on the seat pad to secure it to the seat canvas support.

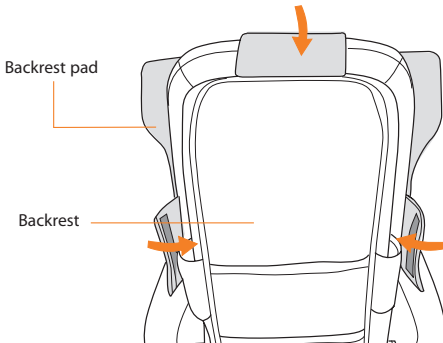

3. Attach the backrest pad

Place the backrest pad into position, then attach the top flap to backrest using the hook-and-loop fasteners. Attach the two side flaps to the backrest using the hook-and-loop fasteners.

From the front of the chair, grasp the bottom pad flap and pull downward to detach the hook and loop fasteners from the back of the backrest pad. Pulling firmly down on the backrest pad, attach the bottom flap to the bottom of the backrest using the hook and loop fasteners.

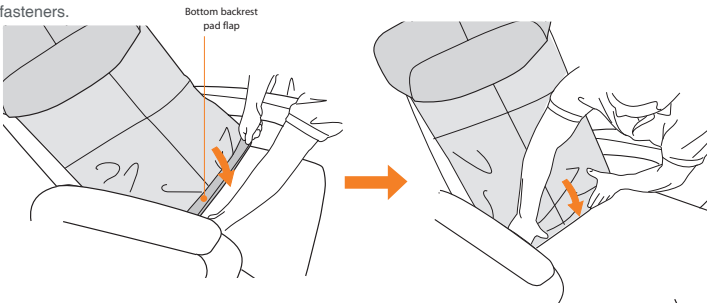

4. Attach the manicure trays

- Use a Phillips-head screwdriver, remove the two screws that secure the spacer on the underside of the armrest.
- Place the manicure tray into position, aligning the screw holes with the holes in the armrest.
- Replace the two screws to secure the manicure tray to the chair.

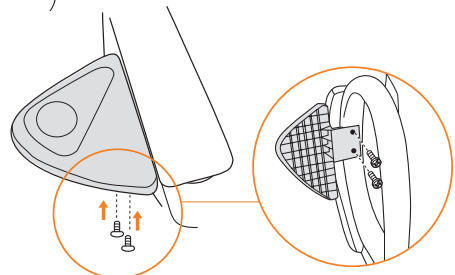

HT-044-PS features

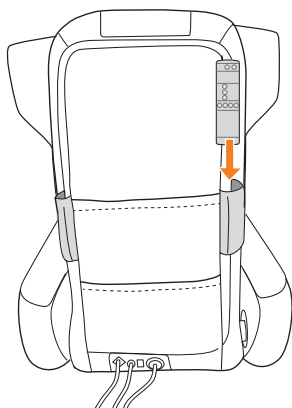

CONTROLLER POCKETS

If your controller holder is not installed in one of the armrests, you can still store the controller conveniently out of the way using one of the controller pockets, located on the each side of the backrest.

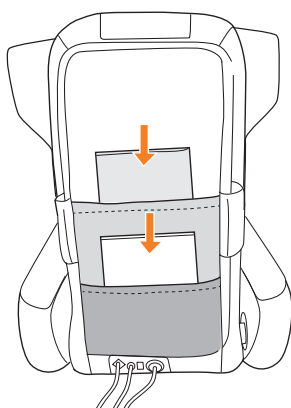

TWO STORAGE POCKETS



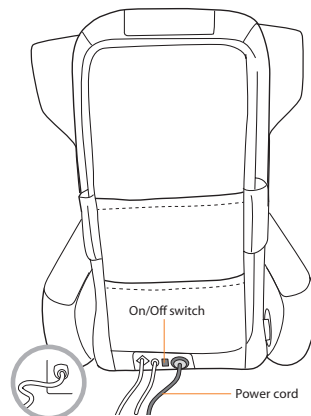

Two convenient pockets located on the backrest provide handy storage for clip boards and manicure tables.



POWER ON

Plug the power cord into a ground power source, then turn the on/off switch on the back of the backrest to ON. Press the red button on the GFI breaker at the end of the power cord to activate power to the chair.

MASSAGE TECHNIQUES

Massage Techniques	What it Does	Benefits
KNEADING 	Kneads your back in a small circular motion on both sides of your spine simultaneously	Relieves tension and soreness by lifting and stretching muscles. Improves circulation and helps bring vital nutrients to the spinal area.
KNEADING + PERCUSSION 	Combines circular kneading motion with rapid-tapping percussion strokes.	Relieves muscle tension and spinal pressure, improves circulation and invigorates the back all at once.
PERCUSSION 	Alternates rapid-tapping strokes along the spine to stimulate both spinal muscle and spinal joint areas, emulating the percussive massage technique used in sports medicine for deep muscle therapy	Flexes spinal joints and relieves pressure on the spinal column, invigorates the entire back area.
ROLLING 	Rolls gently up and down your back near your spine.	Warms and loosens your muscles, preparing your back for deeper massage. Relieve muscle tension, improves circulation and relaxes the back.



HT-245-PS

remote

– Stops the massage and parks the massage mechanism at the top of the backrest.

– Lights to indicate that the power switch is on.

– Slides the chair forward and backward for ideal pedicure position.

Auto Massage Experiences – Three unique auto massage experiences automatically massage your back for 15 minutes, using a variety of massage techniques. The LED lights to indicate which massage technique is currently in use.



Restore – Automatically restores the backrest to the full upright position.

Back – Effortlessly reclines and inclines the backrest to the desired position.

Range – Select from high, medium, or low vertical massage range settings, based on your height.

Width – Select from wide, medium, or narrow massage width settings, based on the width of your back.

Message techniques – Select from four massage techniques to customize your massage. Rolling can be combined with any of the other three techniques.

Where do you want to feel better?
– Simply press the number that corresponds with the area of your back you want to feel better, then sit back and let the chair do the rest!

remote

HT-045-PS & HT-044-PS

Power – Lights to indicate that the power switch is on.

Stop – Stops the massage immediately.

Auto Massage Experiences – Three unique auto massage experiences automatically massage your back for 15 minutes, using a variety of massage techniques. The corresponding LED lights on the remote to indicate which massage technique is currently in use.

Position (up/down arrows)– Use these buttons along with any massage technique, to target the massage to the desired area of your back. You can press this button before or after selecting the massage technique.

Back – Effortlessly reclines and inclines the backrest to the desired position.

Seat – Slides the chair forward and backward for ideal pedicure position.

Stop/Park – Stops the massage and parks the massage mechanism at the top of the backrest.

Manual / Rolling – Select from three manual massage techniques and a full rolling massage, or combine them. Select Zone to focus the massage on a six-inch zone.

Width – Select from wide, medium, or narrow message width settings, based on the width of your back.

Height – Select from high, medium, or low vertical massage range settings, based on your height.



HT-135-PS remote



Master Power Switch

Before starting, please read all Safety Warnings and Cautions at the beginning of this manual. Plug the massage chair into a grounded 110 VAC power source and turn on the master power switch located on the back side of the backrest, next to the power panel.



Stop Button

Use Stop/Park to cancel all massage sessions and park rollers at the top of the back rest.



Restore Button

Auto Restore functions the same as Stop/Park plus resets backrest to normal upright position.



Seat Power Recline Buttons

Use the "back" buttons to recline seat. Use the "seat" buttons to move seat forwards and backwards.



Auto Massage Programs

Choose from 3 different fully automatic massage programs, which concentrate on certain areas of the back. Programs run for 15 minutes each. (See next page for details.)



Range

Adjusts chair to proper shoulder height.



Width

Focus or diffuse massage pressure by adjusting the width of the precision massage rollers. Select narrow, standard, or wide roller setting while in Percussion, Roll Full Back and Roll Partial Back massage modes.



Position: Use with manual massage buttons.

Allows you to customize the massage for your individual needs. Fine tune the position and focus of your massage with finger tip control. Select custom massage functions, and pinpoint the massage anywhere on your back.



Zone

Concentrates massage in a 5" spot wherever you hit this button.



Roll

Use with manual massage modes. Press roll for full back massage.

HT-135-PS1 installation

CAUTION: Massage chair is heavy. To install chair to basin two people are required. Risking and attempting to install by yourself could result in serious injuries or damage to the products.

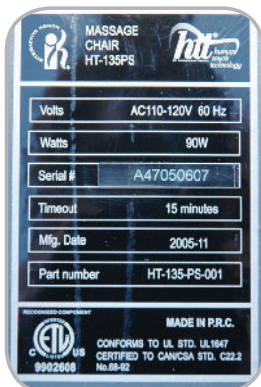

1. Please write down all of your serial #s and important information on page 3 in this manual. Register your spa and HT massage chair by filling out and return warranty registration form or fill out form on buynailsdirect.com

2. Remove chair out of the box carefully, make sure that you do not grab the armrest. Lifting the chair incorrectly may cause damage to the chair.

3. Place chair on the tub.



4. While one person holds the chair in place, the second person flips up the bottom cover.

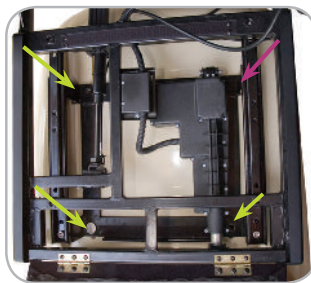

5. Lift the bottom cover. Plug chair in. Move chair forward / backward with remote control to clear the holes. Align bolt holes in chair with holes in spa.

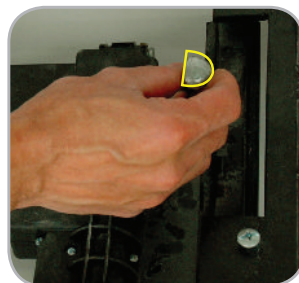

6. Place the 3 regular bolts into holes. Place 1 moon shaped bolt in back right corner. (see figure 5) Add the washers according to the following drawing (figure 7)

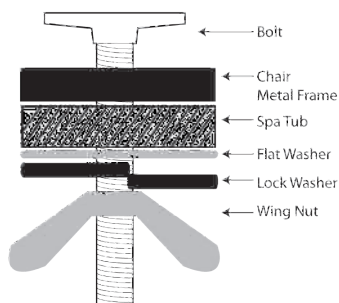

7. Install bolt and washers in order shown here. Tighten bolts by reaching underneath the chair. Bolt is not tight until lock washer is fully flat. This will prevent the chair's vibration from unscrewing the bolt.



8. After placing the screws, lock the backrest of chair by pushing the back until it locks. To unlock the chair, pull down lever.

Cushion Installation- HT-135-PS1



1. After attaching the chair to the pedicure tub, simply flip back the bottom cover to install the seat covers.



2. Place the back cushion first.



3. Attach all the velcro areas in the correct location.



4. Your chair should resemble image number 4.



5. Place the bottom cushion next.



6. Your chair should resemble image 6.



7. Attach the two straps of headrest pillow



8. OPTIONAL: Install the provided back softening pad for a softer massage. Unzip very top zipper and insert pad.

Side Tray Installation - HT-135-PS1



1. Remove trays from protective packaging.



2. Lift the chair arm to begin installation of the side tray.



3. Unscrew the bolts under armrest with the Allen Wrench tool that is included with chair.



4. Align holes on tray with holes on armrest.



5. Replace bolts and hand tighten.



6. Secure the bolts tightly with the Allen Wrench tool that is included with chair.



7. To lock trays, simply lift the side tray up.



8. Pull the lever underneath the tray down to unlock.

Please note: Side trays are not for support when entering or leaving chair. Manicure trays are NOT under warranty.

greasing drive shaft

Greasing the drive shaft every 6 months - more if in dusty conditions is recommended. Failure to follow this procedure will void warranty.



HT-135-PS Greasing Drive Shaft



1. First, remove chair cushions.



2. Locate zipper pull on bottom of chair. Carefully cut off plastic zip tie blocking zipper.



3. Unzip cover to expose roller mechanism

suggested item:



4. Use white or yellow colored grease. **DO NOT** use black. Grease can be bought at any hardware or auto parts store.



5. Apply grease along coiled pole and at the very bottom of pole. Use remote to move mechanism down, and grease top of pole.



6. Also apply grease at the joints of robotic arms.



7. Replace mechanism cover and cushions.

HT-115-PS Greasing Drive Shaft



1. First, remove chair cushions.



2. Locate zipper pull on bottom of chair.



3. Unzip cover to expose roller mechanism

suggested item:



4. Use white or yellow colored grease. **DO NOT** use black. Grease can be bought at any hardware or auto parts store.

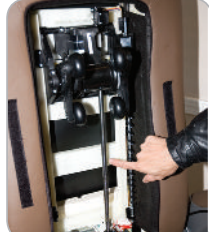

5. Apply grease along coiled pole and at the very bottom of pole. Use remote to move mechanism down, and grease top of pole.



6. Also apply grease at the joints of robotic arms.



7. Replace mechanism cover and cushions.



CAUTION: Massage chair is heavy. To install chair to basin two people are required. Risking and attempting to install by yourself could result in serious injuries or damage to the products.

HT-115-PS1 installation



1. Carefully remove chair from packaging. Place chair on top of spa. While one person holds the chair in place, flip up the bottom cover.

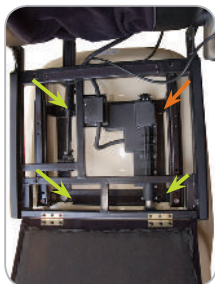

2. Plug chair in. Move chair forward/backward with remote control to clear the holes. Align bolt holes in chair with holes in spa



3. Place the 3 regular bolts into holes. Place 1 moon shaped bolt in back right corner. (see figure 2) Add the washers according to the following drawing.

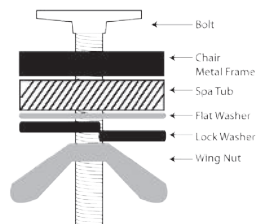

4. Install bolt and washers in order shown here. Tighten bolts by reaching underneath the chair. Bolt is not tight until lock washer is fully flat. This will prevent the chair's vibration from unscrewing the bolt.



5. Place back cushion first.



6. Place flap on seat bottom, then place bottom cushion.



7. Attach head rest cushion



8. To recline chair, pull lever on left side and pull top of chair down.

HT-115-PS1 remote features



Master Power Switch

Before starting, please read all Safety Warnings and Cautions at the beginning of this manual. Plug the massage chair into a grounded 110 VAC power source and turn on the master power switch located on the back side of the backrest, next to the power panel.



Stop Button

Use Stop to cancel all massage sessions and park rollers at the top of the back rest.



Manual Massage Programs

Choose from kneading or compression massage, press one of these then use rolling to move mechanism up or down, and press rolling again to stop.



Auto

Fully automatic massage program.



Seat Forward/Backward Buttons

Use the "forward" button to move seat forward.
Use the "backward" button to move seat backwards.



Our spas feature Liner™ Jet Technology with the innovative SaniSmart® Jet. Paired with disposable liners, buffers, files, and pedicure sponges, our pedispas make it easy to keep your customers safe, and your salon clean and sanitary.

SaniSmart®

Vệ sinh an toàn số một™ • Every visit a clean visit™

ATTENTION!



- Do not run SaniSmart® jet without water. This will void your warranty
- Do not place two wet ends into same bowl when cleaning. The jet's strong magnets could cause injury.
- Do not attach two wet ends to each other. Doing so will cause breakage to wet ends and will void the warranty.

Troubleshooting:

Why is SaniSmart® Jet not on?

1. Make sure water is above the wet end.
2. Turn off for 3 seconds to reset the SS jet, then turn on again.
3. Make sure the magnetic disk is freely rotating.
4. Make sure all power connections are connected properly.
5. Make sure you have 110V-120V power from your wall outlet.
6. Make sure clear air tube from push button labeled Jet is connected to the power supply (black box)
7. Wet-end must be in place. SaniSmart® dry-end (motor) will automatically turn off if wet end is not detected.

Turn off for 3 seconds to reset the SaniSmart® jet, then turn on again.

Why is SaniSmart® Jet making noise or vibrating?

The alignment is not correct.
Remove SaniSmart® wet-end and reattach.
Adjust to align accordingly.



1. Insert disposable liner



2. Cradle SaniSmart® wet-end in your palm. Do not hold with your thumb. Jet will attach itself to dry-end. Adjust to align accordingly.

3. Fill water to 2 inches above SaniSmart® wet-end

4. Press jet button. Light and SaniSmart® jet will turn on.



5. After completing pedicure, drop wet end into concentrated disinfectant solution.

6. Each day, clean impeller with a soft brush.



SANISMAART and logo are trademarks of Quy T Ton. Used with permission. All rights reserved.

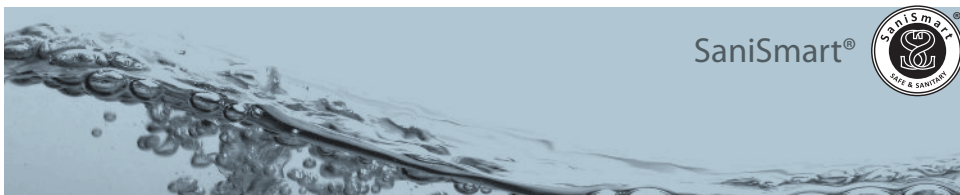

INSERT

Insert SaniSmart® Liner



PLACE

Place Jet and fill water



SERVICE

Service your customers with SaniSmart® disposable files and buffers



SANITIZE

Simply remove the wet end of the jet, disassemble, and immerse into concentrated Pediclear disinfectant solution.



DISCARD

Pull long tab, drain water then wipe entire basin with disinfectant wipes. Go green and recycle the liner

1 - INSERT Liner

A fast and sanitary solution!

Liners are inexpensive, disposable and easy to use.



SaniSmart® Liners
Use with round glass bowl

\$1 ea

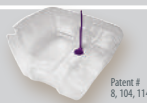

SaniSmart® Liners
Use with square fiberglass sink

\$1 ea



Econo™ Liners

50¢ ea

Fits most bowls. Simply slip on the liner onto the basin and footrest, then place the SaniSmart® Jet. Square basin requires the assist of two 3M hooks.



Econo™ Liners covers basin and footrest.

2 - PLACE Jets



Patent Pending

SaniSmart® Jet

Place the jet in the designated area. The jet's mechanism operates by a magnetic disk in an encased propeller that produces a powerful current.

3 - SERVICE SaniSmart® Disposables

Use once, then throw away or give to your customer.



Disposable Buffer
Grit: 100/120
dimensions:
L 2 5/8" x W 1 1/4"
x 1/2" thick

\$120 case/1000ct



Disposable Acrylic /
Manicure File
Grit: 80/120
dimensions:
L 4 1/4" x W 5/8"
x 1/2" thick

\$100 case/1000ct



Pedicure Sponge
Coarse
dimensions:
L 3 1/8" x W 1 5/16"
x 1/2" thick

\$85 case/500ct

SaniSmart® SS2Jet Retrofit Kit Installation Instructions



Easily update any pedicure spa by replacing your old jet with the innovative SaniSmart® Retrofit Jet.



Insert rubber gasket, smooth side facing plate.



Insert motor through 3.5 inch hole from inside of sink

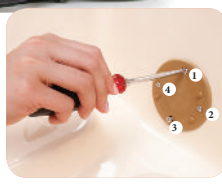

Make sure four dimples on the plate will make two lines parallel to the ground before tighten the screws. Tighten screws position #1 then #3, and #2 then #4.



Please SaniSmart Wet End and installation is complete.

Do not use drill gun. Please hand tighten.



Parts Identification

Floor Drain

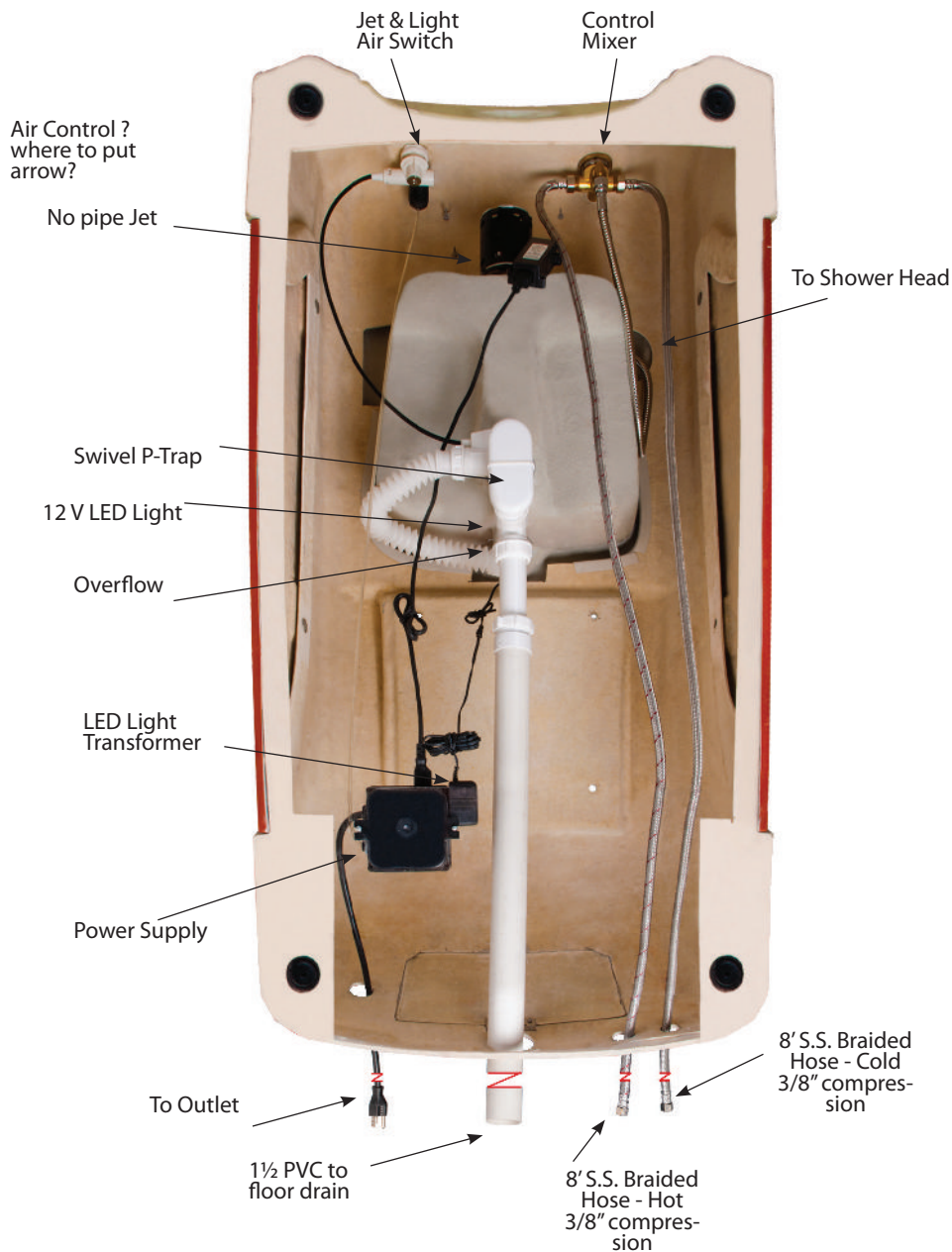



Parts Identification

Wall Drain

