

Important Considerations

Electrical Service

A 110V, 60 Hz, 15 Amp GFCI protected grounded circuit must be used to supply power to each individual pedicure spa. And the main circuit breaker MUST be at 25 Amp. for maximum of two unit.

Water Supply

All plumbing connections must conform to local codes.

Water supply to the spa should be provided with adequate water pressure and water temperature.

Water pressure

To fill the basin correctly up to level, Normal water pressure of 30 to 80 P.S.I is required.

Water temperature

The hot water supply temperature must not exceed 140°. Adjust your hot water accordingly. For hot and cold water supply fittings and drain fittings location, see below diagram .Carefully connect the water supply line to the appropriate fittings located on the rear of the pedicure spa.

Backflow Preventive Device

All pedicure spas are pre-installed with Dual Back flow Preventive Device for the following state; CA, AZ, NV, OR, WA, and NE. This Device is optional, therefore you need to order separately. Salontech does not guarantee the quality of this Device.

Specification

Backflow preventive device for faucet: Vacuum Breaker comply with ANSI/NSF - 61-2000, ASMB A112.18.1-2000, ASSE 1014 and CSA standard - B125.98.

ANSI/ASME A112.18.3M (performance requirements for back flow preventive device and systems in plumbing fixture fittings) is applicable to plumbing fixture fittings with outlets not protected by an air gap. Included in the possible range of applications are fittings with hose connected outlets, fitting with pull out spout, hand held showers, shampoo fittings and deck mounted fittings. ASME A112.18.3M is now referenced in ASME A112.18.1M (plumbing fixture fittings) and CSA B125. Backflow preventive devices are listed to both standards with the Canadian standard association, IAPMO and UL.

ANSI - American National Institute, ASME - American Society of Mechanical Engineers, CSA - Canadian Standard Association IAPMO - International Association of Plumbing and Mechanical Officials, UL - Underwriters Laboratory

Drain Facilities

The pedicure spa Drain must meet local plumbing codes. **Check valve for Drain (not Provided) Must be installed by a licensed plumber.**

PLUMBING CONNECTIONS

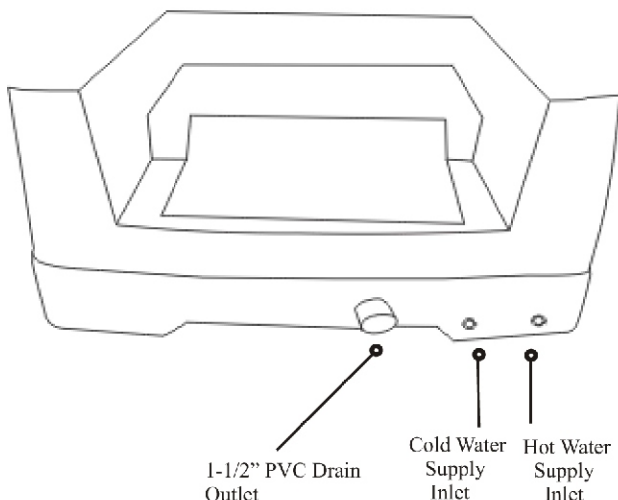

ALL Fittings are 1/2"NPS (Male)

Back of the pedicure spa

First Class

Identifying Components

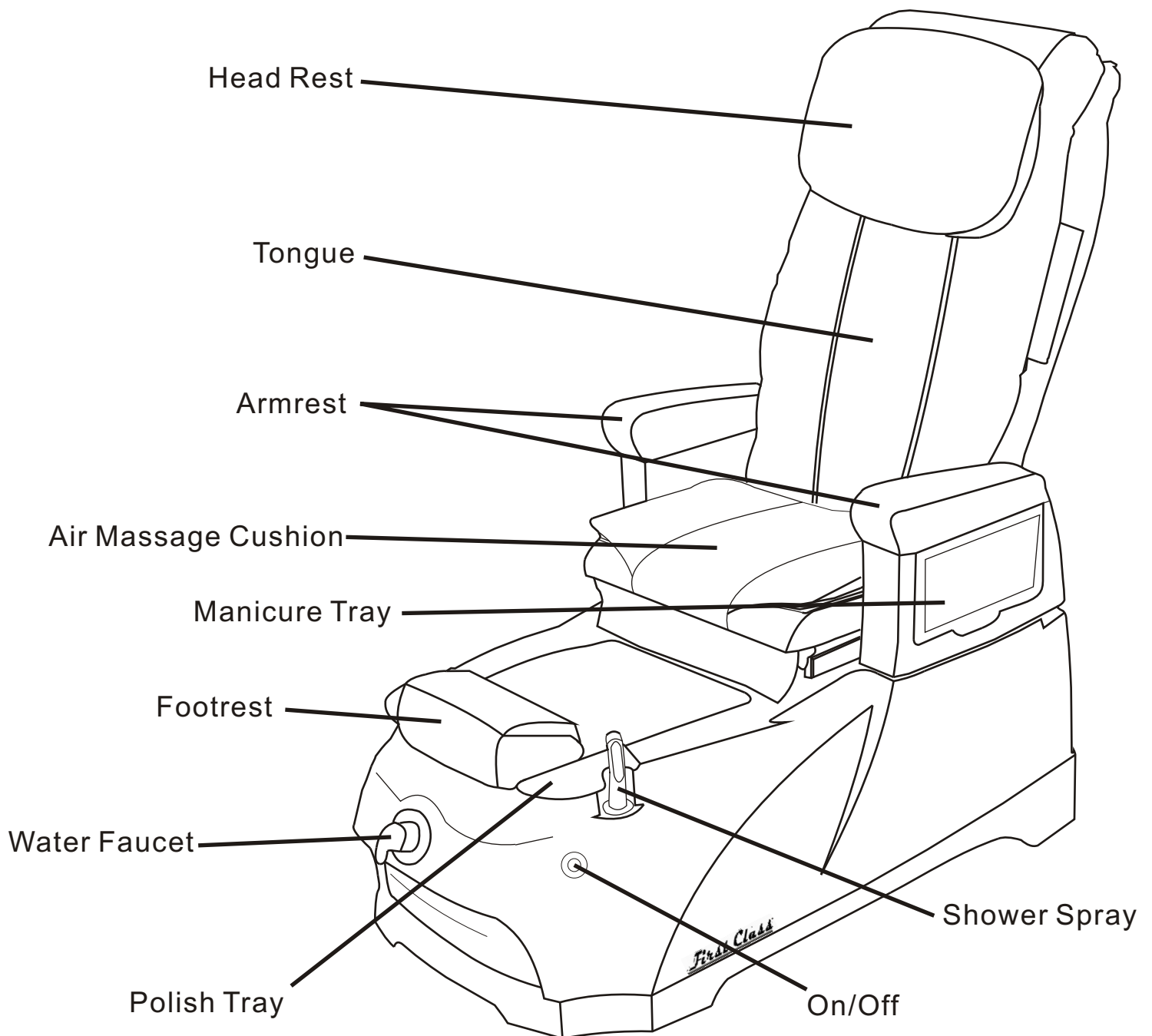

First Class

Specifications

Hydro Therapeutic JJT Motor Jets
with Dual Impeller System

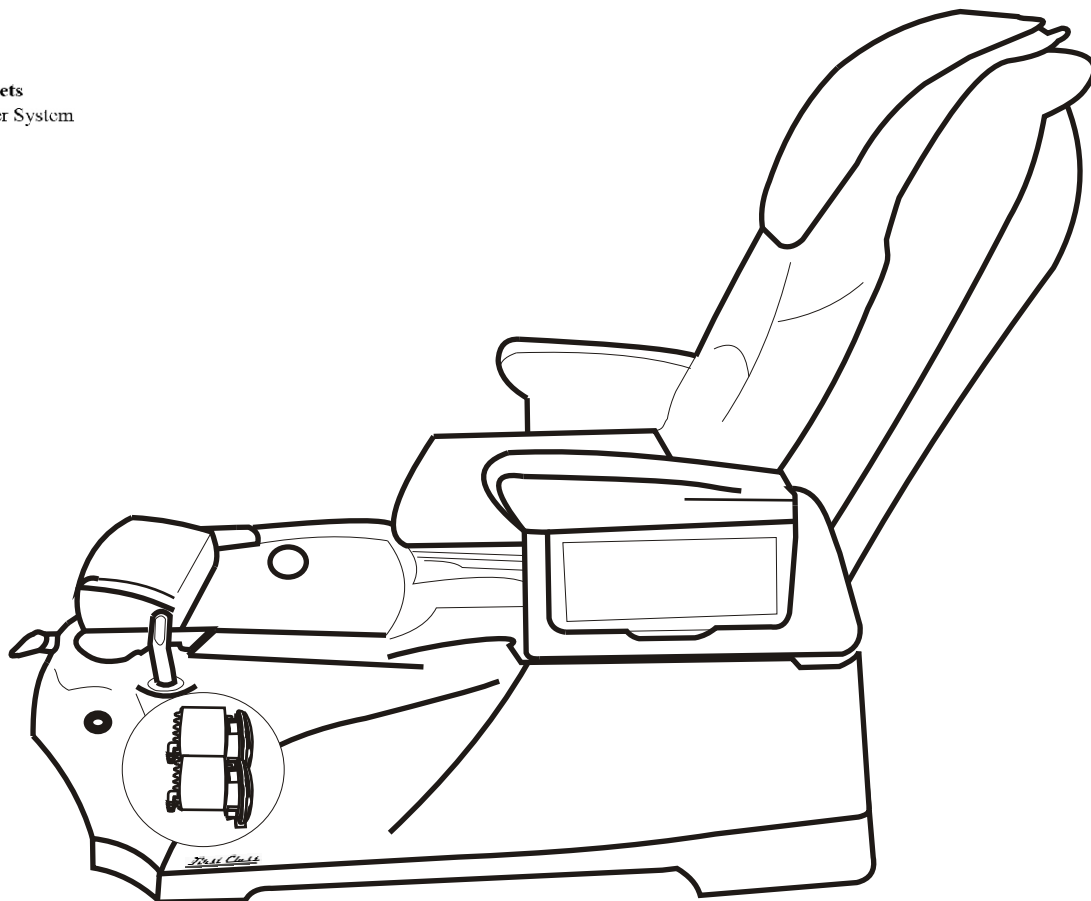

Specification

Dimension & Weight	First Class (Base unit)	30"W x 51"L x 32" H Wt. 165 Lbs.
	First Class (Chair)	21"W x 34 1/2"H (Incline), 50"H (Recline) x 44"H (Incline), 34"H (Recline) Wt. 125 Lbs
	Stool	19"W x 19"L x 22"H Wt. 13 Lbs
Capacity of Tub		4.25 US Gallon
Switch		On / Off Air Activated Switch
Whirlpool	JJT Dual Impeller Motor Jets	Hydro Therapeutic Motor Jet with Dual Impeller System
	Air Control	Air Induction System
Power Source	Motor	115V 1.2 Amp 60Hz 55W / Each Motor
	Discharge Pump (optional)	115V 3.2 Amp 60Hz
	Massage System	110V - 120V 60Hz 90W 5 Amp
Plumbing Source	Hot Water	1/2 inch (fitting pre-installed)
	Cold Water	1/2 inch (fitting pre-installed)
	Drain	1-1/2 inch (see Plumbing instruction)
Warranty	Unit	One Year (see Warranty)
	Optional Item	180 Days

Due to continuous improvements on all our products, specification, characteristics, packing, color and designs are subject to change without notice.

First Class

FRONT VIEW

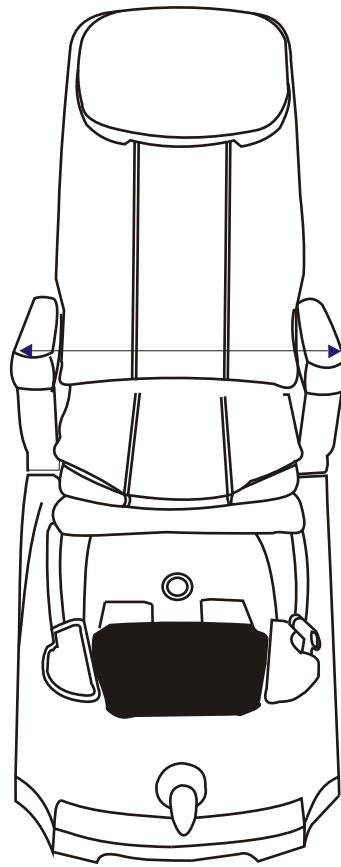

29" arm to arm

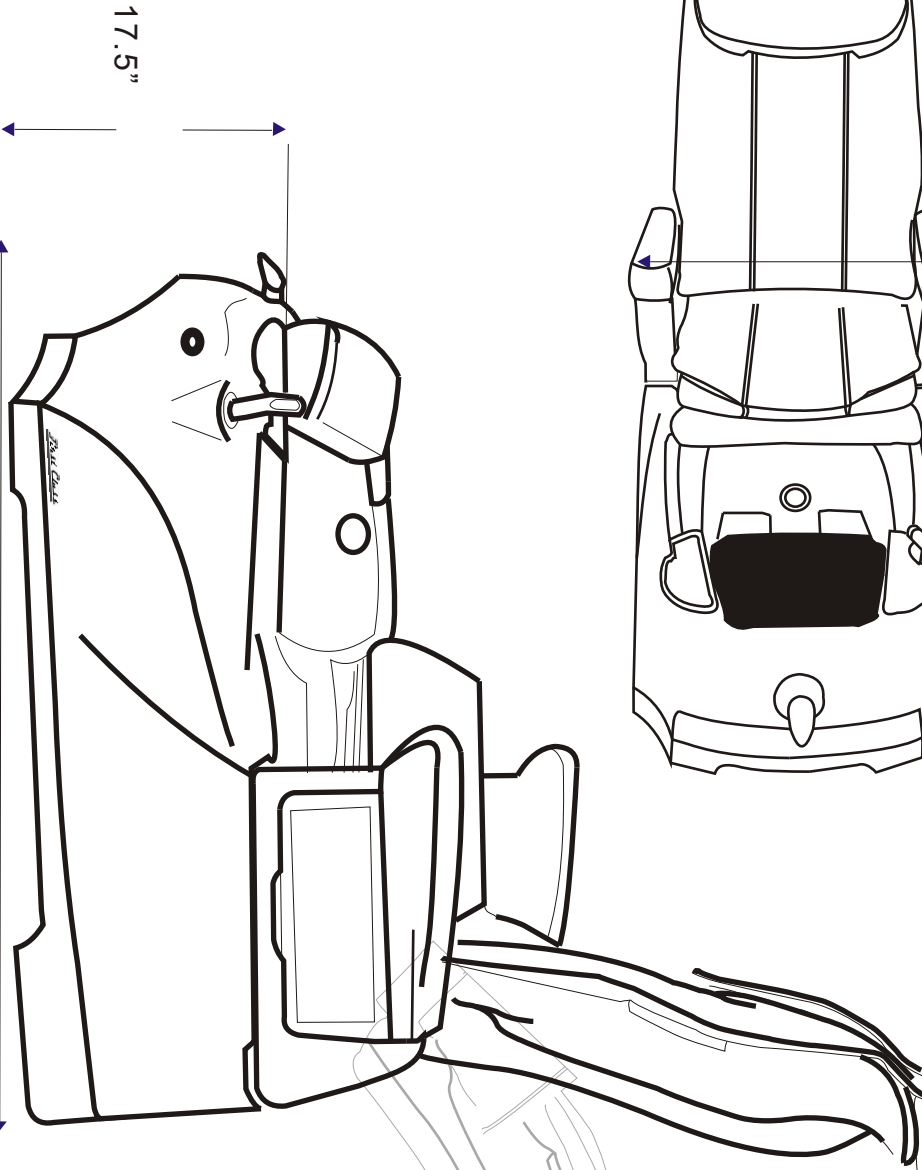

SIDE VIEW

Minimum space from the wall

22"

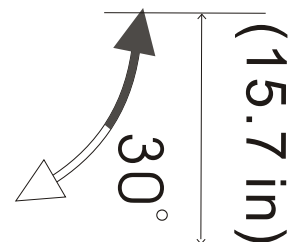

Wall

First Class

Side and Front

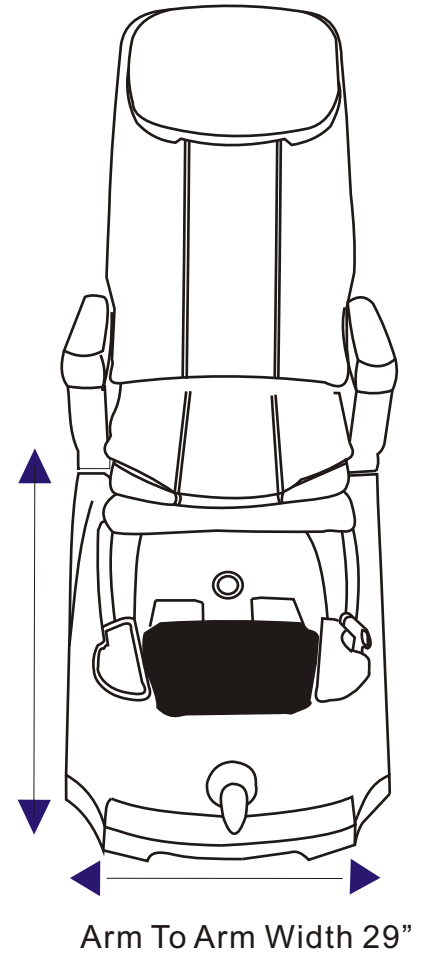

Plumbing area right rear view

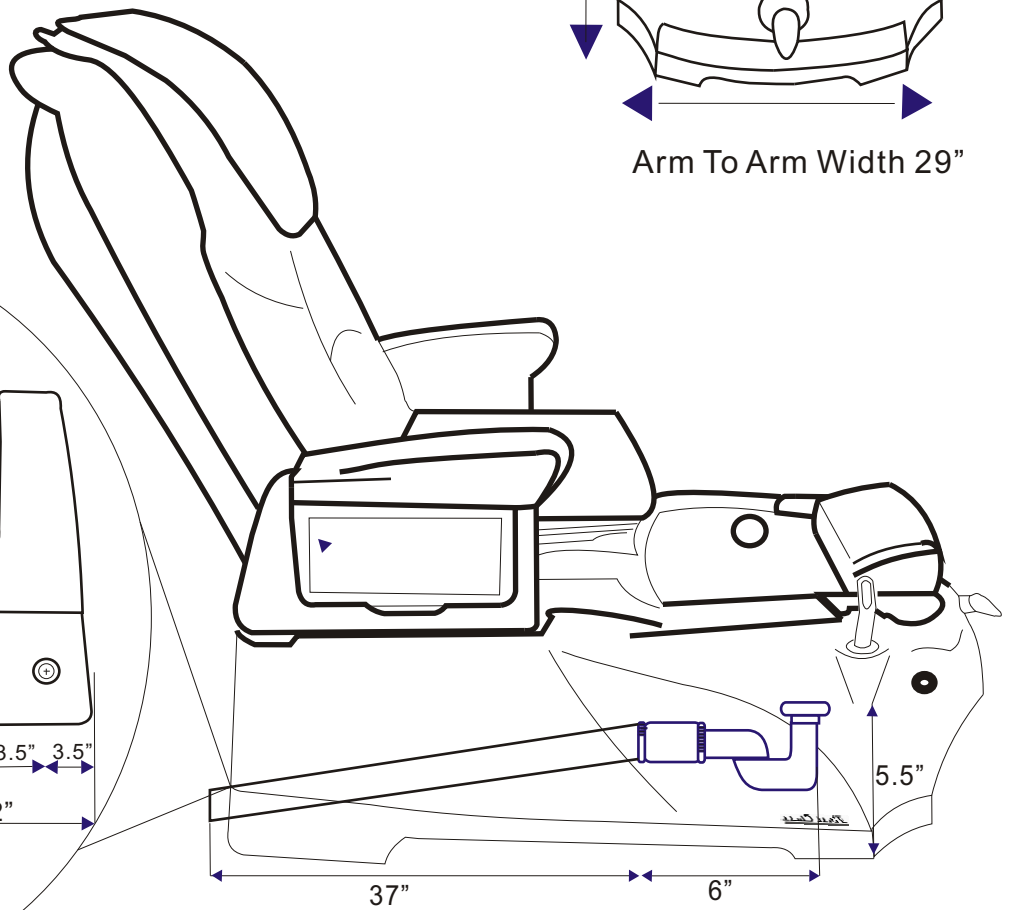
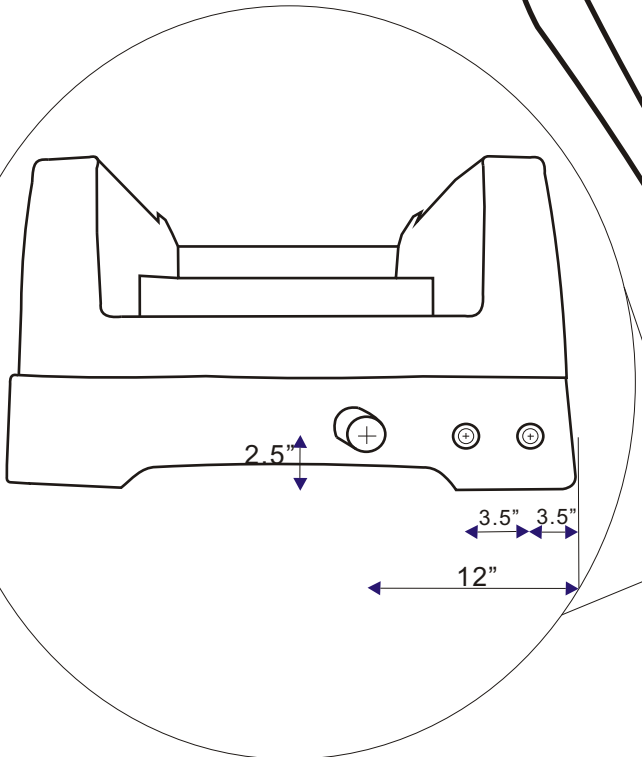

Installation Specifications Summary

WARNING: Failure to comply with federal, state or local codes and ordinances will result in warranty being null and void.

As stated, the pedicure spa installation must comply with all plumbing and electrical codes. A licensed plumber and licensed electrician must complete the applicable connections of the pedicure spa.

Location and Support

Select a level location. The floor structure beneath the pedicure spa must be capable of supporting the occupied pedicure spa. For the seat back to fully recline, the pedicure spa base must be mounted 22 inches from the wall as shown below:

How to use adjustable footrest

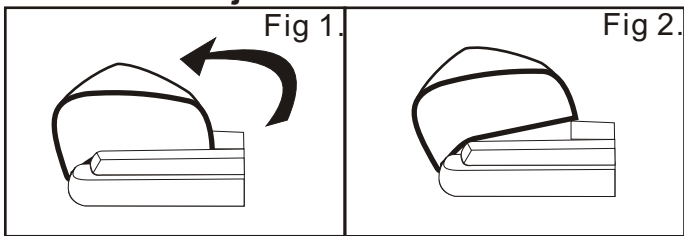

Place left hand on the back of the footrest and gently pull up toward to front as shown fig.2.

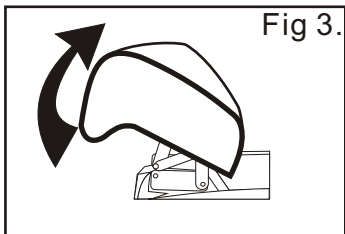

Place right hand on the front of the footrest, gently pull up for desired height and use locking lever to secure the footrest.

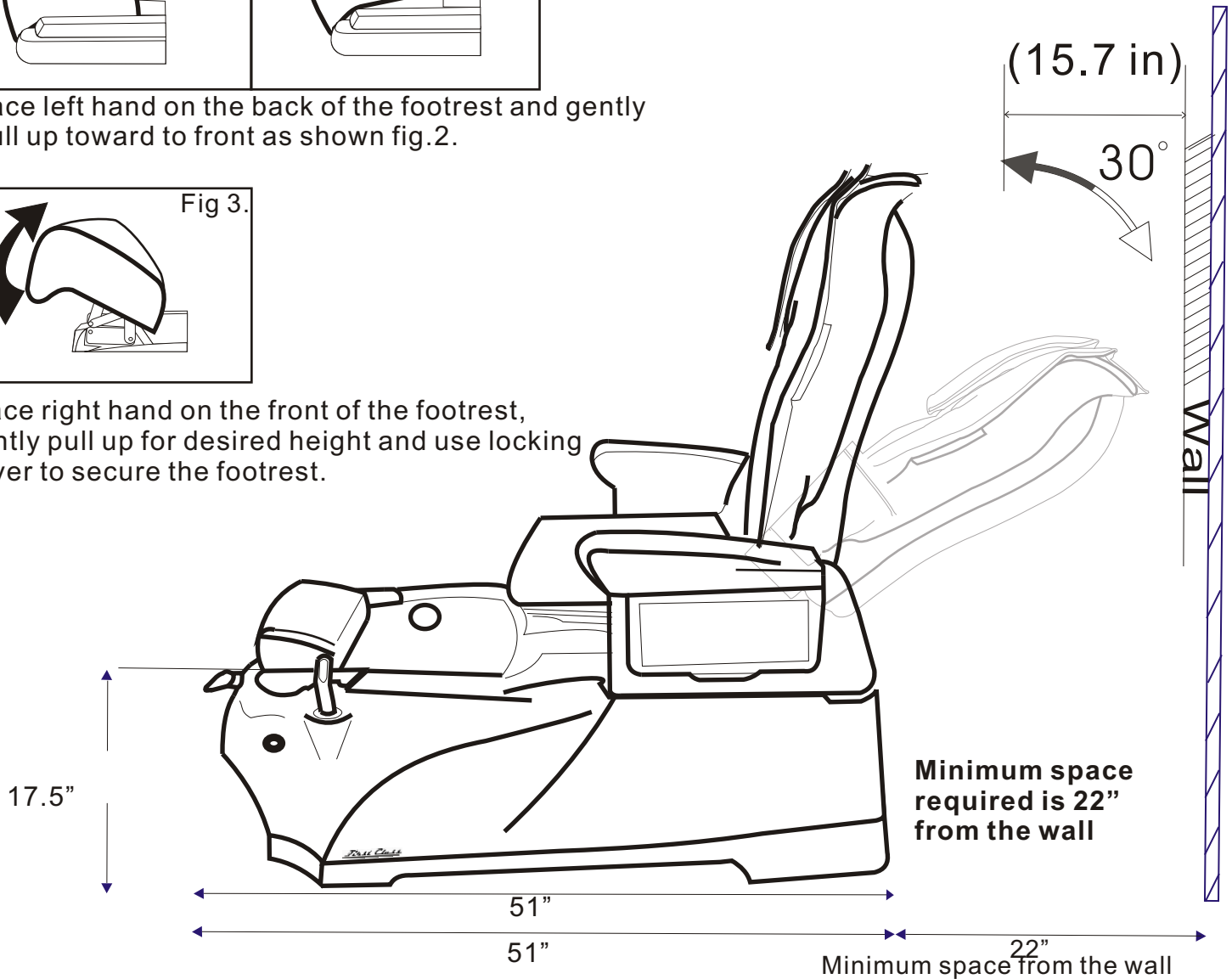

Due to continuous improvements on all our products, specification, characteristics, packing, color, designs are subject to change without notice.



Massage System

Important Safety Instructions

WARNING: To reduce risk of burns, fire, electric shock or injury:

READ ALL INSTRUCTIONS BEFORE USE; *burns will result from improper use; please be careful handling this product.*

Close supervision is necessary when unit is used by, on, or near children, and the disabled. Use this unit only for its intended use as described in this manual. Do not use any attachment/s not recommended by MFG.

- Keep the cord away from heated and wet surfaces.
- Do not use outdoors.
- Do not operate where aerosol products are being used or where oxygen is being administered.
- Never operate this unit if it has a damaged cord or plug, if it is not working properly, if it has been dropped or damaged, or dropped into water. To disconnect, press power button to turn off, then remove plug from the outlet.
- Allow 30 minutes break in between operations.
- Do not place any heavy object on the chair and do not let children play with it.
- The maximum weight capacity for the massage chair is 250 lbs.

Your massage chair is simple to operate using the handheld controller included with your chair. Before you use your chair, we recommend that you familiarize yourself with the remote control and the basic massage functions.

Due to continuous improvements on all our products, specification, characteristics, packing, color, designs are subject to change without notice.

First Class

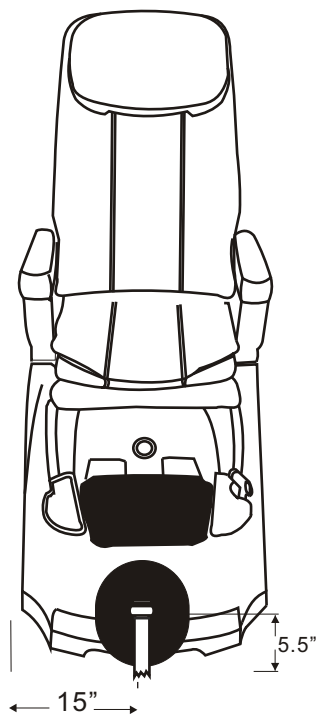

Floor

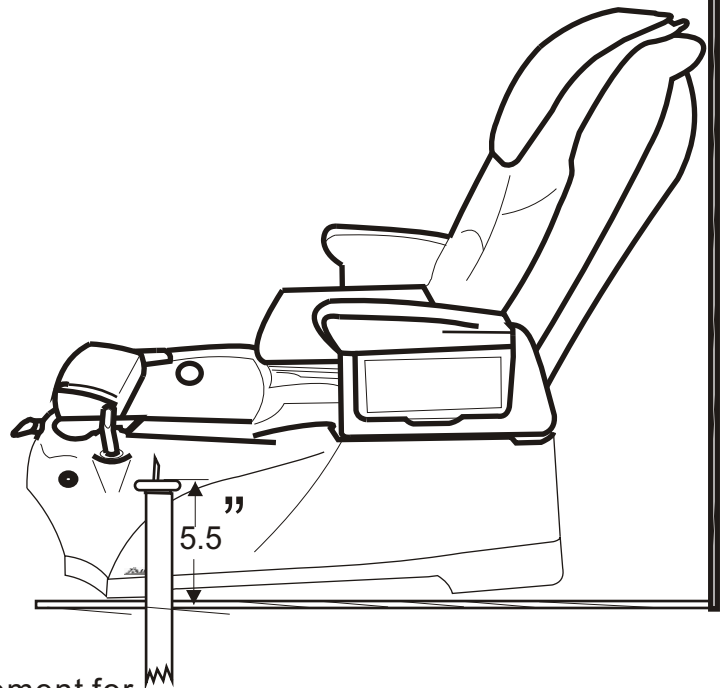

NOTE: the requirement for vacuum breaker varies from state to state and province to province. Please consult with the licensed plumber.

Wall

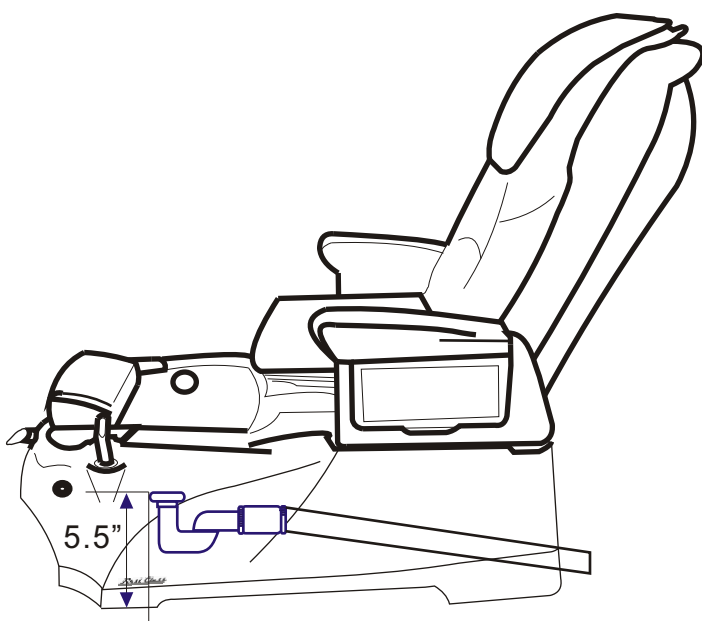

Power Drain

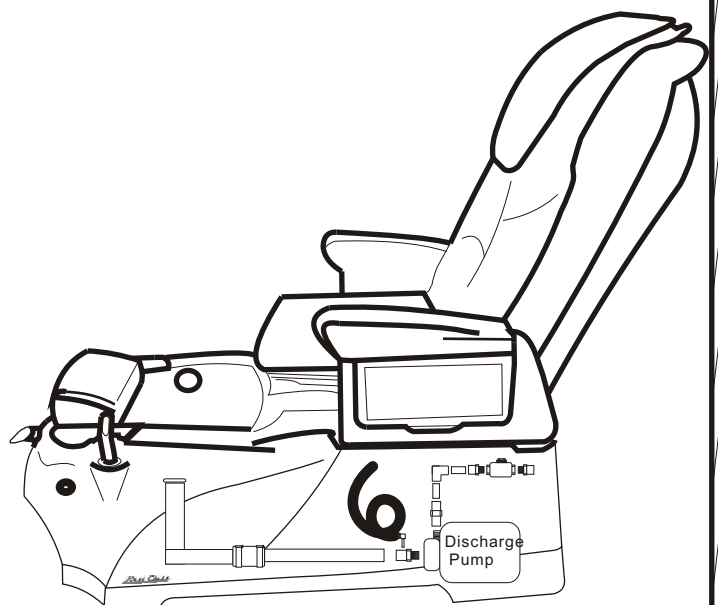

6" Adjustable P-Trap and connector

37" (1.5" PVC drain pipe)

See Detailed installation page

Massage chair remote control instruction

Method of usage

1. Controller operate

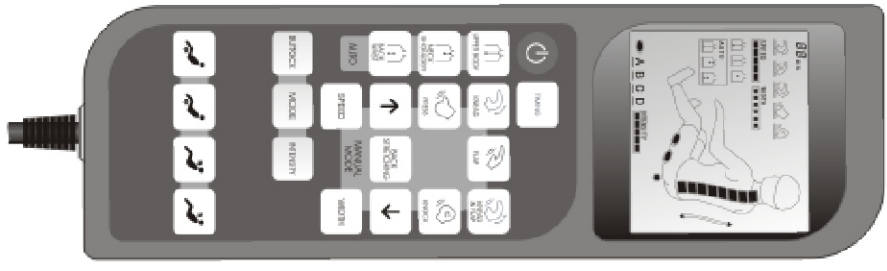

Button	Adjust massage tools
	To start or stop massage of the upper body, the button does not work when the massage system is at its position of recovery.
TIMING	Three modes of timing: 10 mins, 20 mins and 30 mins.
UPPER BODY	Adopt the various facilities to carry on automatic massage to different position of the upper part of the body, the massage position covers the whole upper part of the body,
NECK SHOULDER	To carrying on automatic massage around the neck shoulder mainly
BACK WAIST	Carry on automatic massage around in carrying the waist mainly

06

Method of usage

(1) Upper body manual massage, lower body massage upper body manual massage:

Function	Button	Display status	Adjust massage tools
Method	press		Speed, Width, Strength
	Kneading		Speed, Strength
	Flapping		Speed, Width, Strength
	Kneading & Flapping		Speed, Strength
	Knocking		Speed, Width, Strength
Backrest stretch		Upper body(overall) trip massage	
		Small area(partial) trip massage	
		Fixed position (fixed) massage	
Speed	SPEED	Speed	5 speed options available
Width	WIDTH	Width	3 width options available

(2) Lower body air pressure manual massage:

BUTTOCK		ON/OFF button of buttock airbag massage
Mode	MODE	4 options of buttock airbag modes A, B, C, D
Strength		Adjusting the intensity of airbags, two levels for your choice

07

Maintenance

Daily (No pipe JJT motor users)

Manufacturer requires that the pedicure spa be thoroughly cleaned at the end of the day in following manner.

1. Remove the jet cover (fig.1). All debris trapped on or behind the cover must be removed. The jet cover must be free of debris.
2. Before placing the jet cover, the cover must be immersed with EPA-Registered disinfectant.
3. Flush out the whirlpool with low foaming detergent and warm water for 10 minutes.
4. With fresh water, EPA-registered cleanser for run the no pipe motor for 5 minutes.
5. Rinse with fresh water.

Weekly (No pipe JJT motor users)

1. Fill the basin with hot water up to its level.
2. Add 3 to 4 table spoons of a low foaming agent.
3. Run whirlpool for 5 minutes.
4. Stop whirlpool and sit for 5 to 7 minutes.
5. Open air control and whirlpool for 5 minutes.
6. Drain completely.
7. Fill the basin with warm water up to its level.
8. Apply EPA-registered disinfectant according to its direction.
9. Run whirlpool for 5 minutes.
10. Drain completely.
11. Wipe out excessive water with soft cloth.
12. Repeat step 7 to 10, if necessary.

JJT double locking covers cleaning instruction (suggested by manufacturer)

1. Gently turn the cover counter clock-wise to remove. (Shown fig.1)---this will expose the entire water chamber.
2. Use antibacterial soap or a solution of 3% hydrogen peroxide to wipe the inner chamber.

DO NOT use chlorine or chlorinated products (such as diluted bleach) as this will damage the plastic, chrome cover and VOID your warranty.

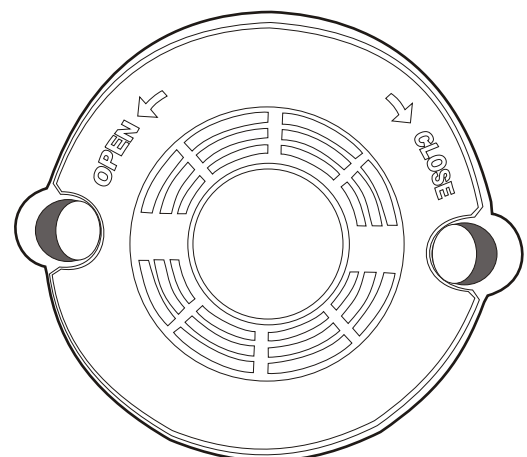
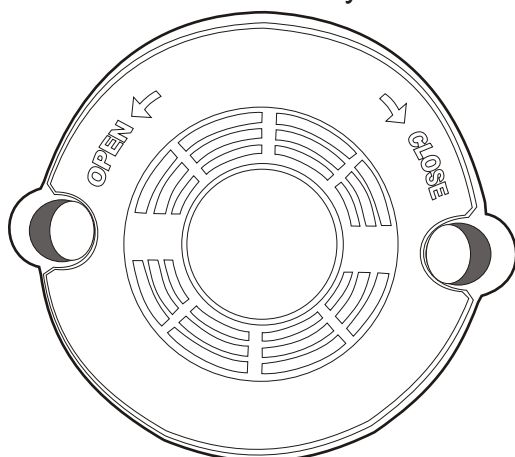

First Class

Discharge Pump

On/Off Push Button
Fig. 1

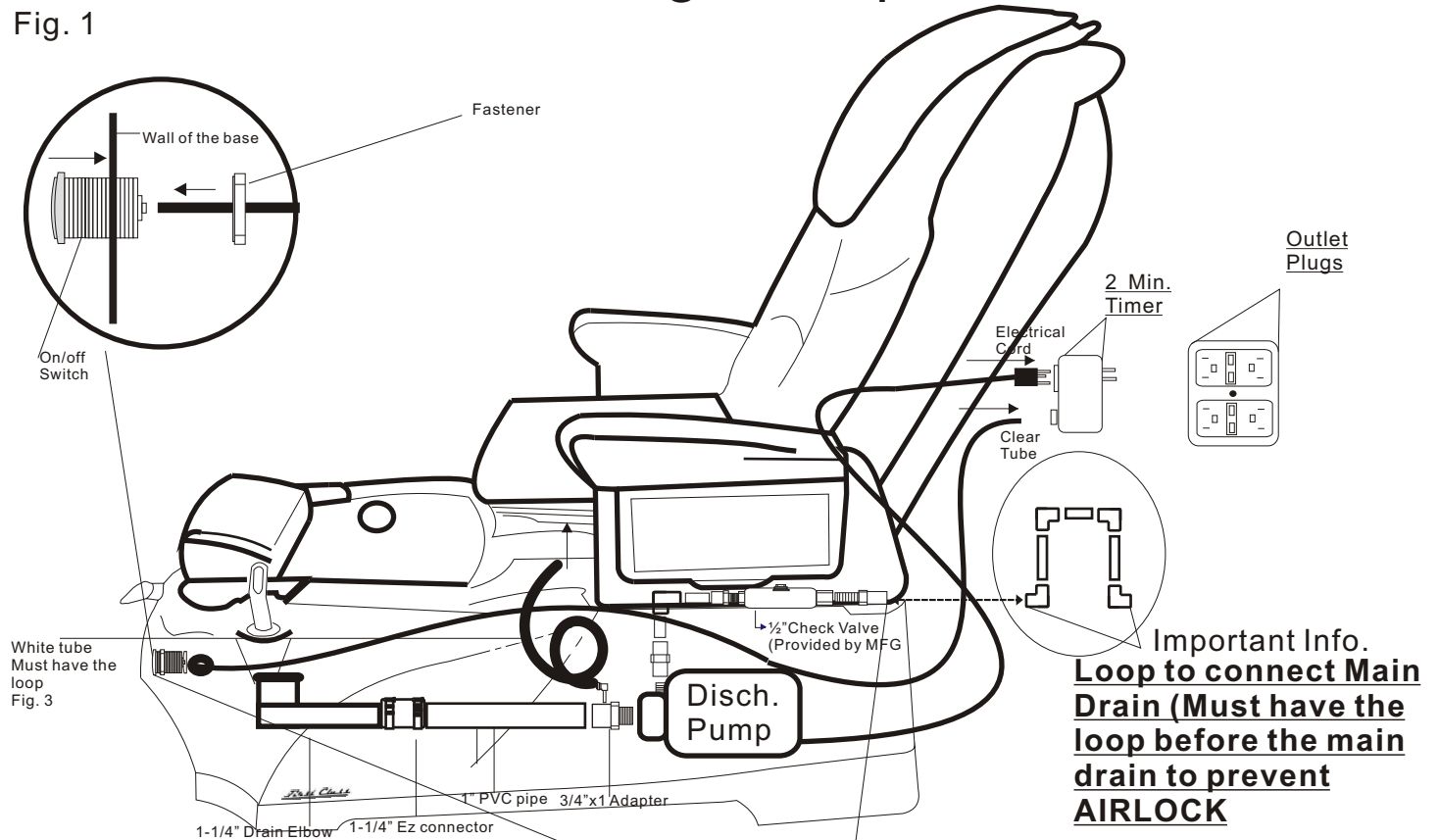

Discharge Pump Installation Instruction

1. Make a hole (size 1-3/8") for the On/Off switch as shown fig. 1. Pre drill required.
2. Place 1/8" clear hose into the rear of the switch and On/Off switch into the hole.
3. The discharge pump kit is made to fit into the pedicure unit as shown is fig 2.
4. Connect Ez connector to the drain Elbow.
5. Plug discharge pump outlet into blue 2 minute timer.
6. Plug blue 2 minute timer into the wall outlet.
7. It is very important that tip of white tube remain above the water level with one big loop as shown in fig. 3

Pre Assembled
Disc. Pump
Fig.2



Disch. Pump Kit

Operation Instruction

Please DO NOT run dry

1. Turn to open the drain plug--wait 2 seconds
2. Press On/Off switch to activate the timer.
3. After all the water has drained out from the basin. Press the On/Off switch again to stop.

SALONTECHSPA LIMITED WARRANTY

salontechspa manufactures the First Class, Whirlpool Pedicure Spa with the highest standards for quality materials, with UL listed components and highest workmanship for duration of the warranty period, which duration begins on the date of purchase by the customer (end-user). Each customer is responsible for maintaining the proof of purchase (invoice) to initiate the warranty. The customer **MUST** send in warranty card in the manual booklet. Read and fill out (warranty form) carefully and return to **salontechspa** within 15 days from purchase.

Warranty Period

- ◆ All components: One (1) year from date of shipment.
- ◆ All optional items: 180 days from date of shipment.

If **salontechspa** receives defective product notice during the applicable warranty period, **salontechspa** shall either repair or replace the defective parts at Salontechspa's option. Replacement product (part) may be either new or equivalent in performance. **NO CONSEQUENTIAL, INCIDENTAL, OR CONTINGENT DAMAGE WILL BE ALLOWED WHATSOEVER.** This warranty is null and void if the spa is removed from its place of initial installation, or is not in accordance with federal, state or local codes and ordinances. Furthermore, this warranty does not apply if the spa has been subject to misapplication, improper installation or maintenance, negligence, improper cleaning, refurbished or tampered with in any way or other circumstances beyond Salontechspa's control.

salontechspa's warranty is valid in only within the continental 48 U.S. The warranty may be available from any authorized Salontechspa service facility where the product is distributed by Salontechspa or by an authorized distributor.

Not Covered

1. Damage to pump parts and/or motor parts due to obstruction in plumbing, etc.
2. Staining, fading or discoloration of surface due to exposure and/or the use of harmful cleaning Agents or chemical.
3. Staining, fading or discoloration caused by improper or poor water additives not related to maintenance of proper water.
4. Malfunctions or damage caused by improper installation; including NOT meeting local and state plumbing, electrical, and building codes.
5. Staining, fading or discoloration of the leather chair and urethane footrest.
6. Damage resulting from standing in basin.
7. Freight damage, misuse, neglect, accident, natural disaster, and abuse.
8. Unauthorized repairs.

Should service be required for any reason or any question on our product/s, please contact

salontechspa

Technical Support

79-F Express Street

Plainview, NY 11803

T: 516-433-0900 F: 516-433-0977

E-mail: info@salontechspa.com / www.salontechspa.com

No distributor or other person has any authority to bind **salontechspa** to change or add this warranty or its products. **salontechspa** is not responsible for such warranties or representations.

Due to continuous improvements on all our products, specifications, characteristics, packing, color, designs are subject to change without notice.