



SHAMPOO BOWLS
12 SQUARE FIBERGLASS
22 ROUND FIBERGLASS
32 SQUARE PLASTIC

Before installing and using this unit, please carefully read all instructions. Be sure to keep instructions available for later reference.

LITERATURE DIMENSIONS ARE FOR GENERAL REFERENCE USE ONLY. INSTALLATION DIMENSIONS SHOULD BE TAKEN DIRECTLY FROM THE SINK. GARFIELD RECOMMENDS THAT A LICENSED PLUMBER PLAN & PERFORM INSTALLATION

BEFORE YOU BEGIN

- ☐ Shut off the hot and cold water supplies.
- ☐ Unpack the new sink and inspect for damage. Return the sink to the carton before installation.
- ☐ Remove rings, wristwatches and other items that may accidentally scratch or damage the fiberglass surface during installation.
- ☐ Observe local plumbing codes*

*GARFIELD RECOMMENDS THAT A LICENSED PLUMBER PLAN & PERFORM INSTALLATION. ALL WORK MUST MEET LOCAL PLUMBING STANDARDS. CHECK WITH YOUR LOCAL PLUMBING INSPECTOR PRIOR TO STARTING ANY PLUMBING WORK. GARFIELD IS NOT RESPONSIBLE FOR INCLUDING LOCAL PLUMBING CODES WITHIN THIS GUIDE. IT IS THE RESPONSIBILITY OF THE PURCHASER AND/ OR THE INSTALLER TO ENSURE THAT THE BOWLS AND ITS' INSTALLATION CONFORMS TO ALL LOCAL PLUMBING CODES.

WARRANTY

Any alterations, addition, or deletion made to the sink will void the warranty.

CARE & CLEANING

Keep your product looking new by rinsing it thoroughly after each use.

Because of the detrimental effects that mineral deposits, soap scum, and hard water stains have on finished surfaces, it is important to keep your sink and the fixtures clean on a regular basis.

Use the recommended information described in this section. Use of other cleaning materials and/or methods may harm your sink and will void the warranty. Failure to perform periodic maintenance on your sink may cause health and/or safety problems, also possibly harming the bathtub, pump, or piping, voiding all warranties.

Do not use wire brushes, metal sponges, knives, steel wool, or scouring pads on any part of the sink.

Do not use abrasive cleaners or solvents including but not limited to petroleum based solvents such as paint thinner, acetone or abrasive cleanser on any part of the sink.

We recommend that, once a week, wash all exposed surfaces of the sink with a mild solution of vinegar and water. Check for stubborn spots. Oily or greasy spots can be lifted with denatured alcohol. Wipe off with clean warm water until dry.

ROUGHING-IN

**DO NOT USE ANY PORTION OF THE PLUMBING FOR LIFTING OR POSITIONING THE SINK.
DO NOT SUPPORT THE WEIGHT OF THE SINK BY THE RIM.**

**LITERATURE DIMENSIONS ARE FOR GENERAL REFERENCE USE ONLY. INSTALLATION
DIMENSIONS SHOULD BE TAKEN DIRECTLY FROM THE SINK. GARFIELD RECOMMENDS THAT
A LICENSED PLUMBER PLAN & PERFORM INSTALLATION**

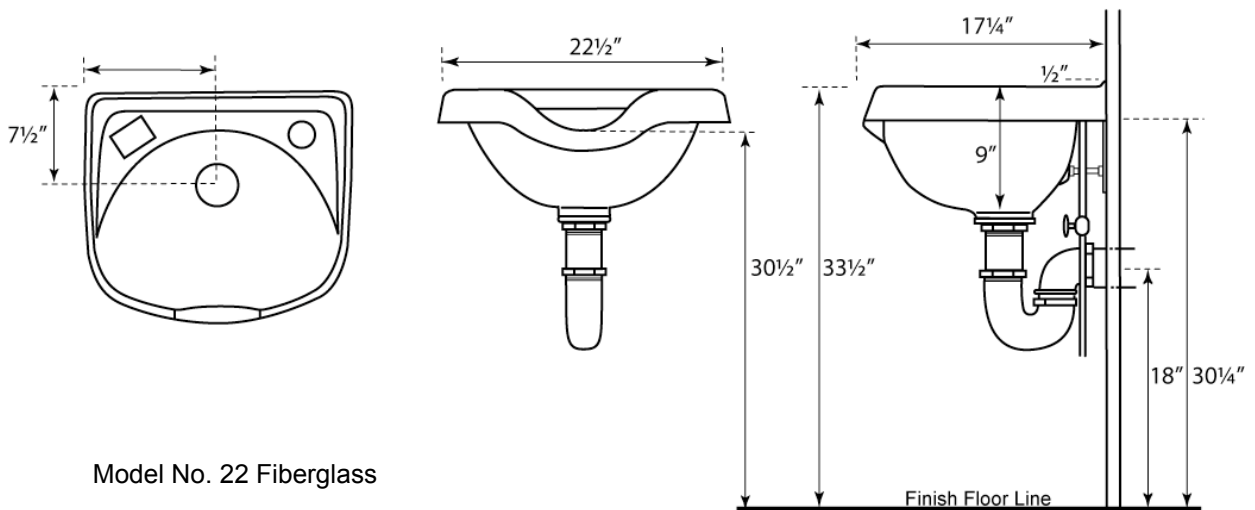
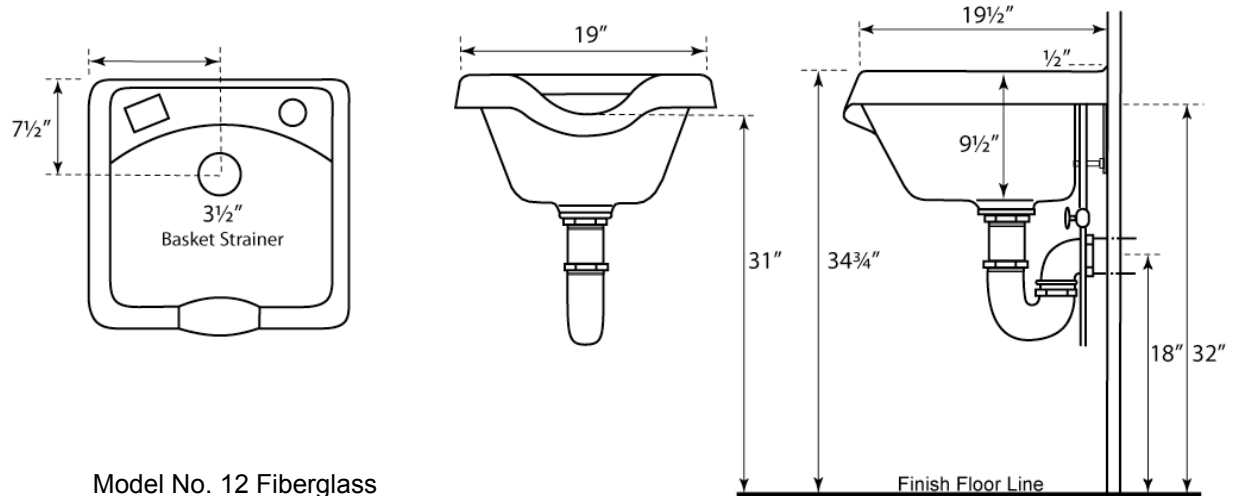

POSITION THE SINK

- Recline your shampoo chair to the optimal position.
- Check your shampoo chair measurements before completing installation.
- Recommended neck height for barber/ salon bowls is 31\"-35\".
Actual height will vary depending on installation type.

BASIC INSTALLATION GUIDE

LITERATURE DIMENSIONS ARE FOR GENERAL REFERENCE USE ONLY. INSTALLATION DIMENSIONS SHOULD BE TAKEN DIRECTLY FROM THE SINK. GARFIELD RECOMMENDS THAT A LICENSED PLUMBER PLAN & PERFORM INSTALLATION

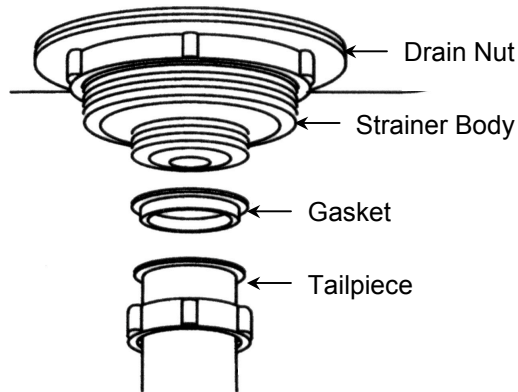

2 ASSEMBLING THE DRAIN

- Apply plumber's putty along the rim of drain opening
- Firmly place the strainer body in the drain opening
- Secure the strainer body with the drain nut
- Attach the gasket and tailpiece

**DO NOT USE EXCESSIVE FORCE TO TIGHTEN
YOU MAY CRACK THE DRAIN ASSEMBLY**

Diagram displays underside of the bowl

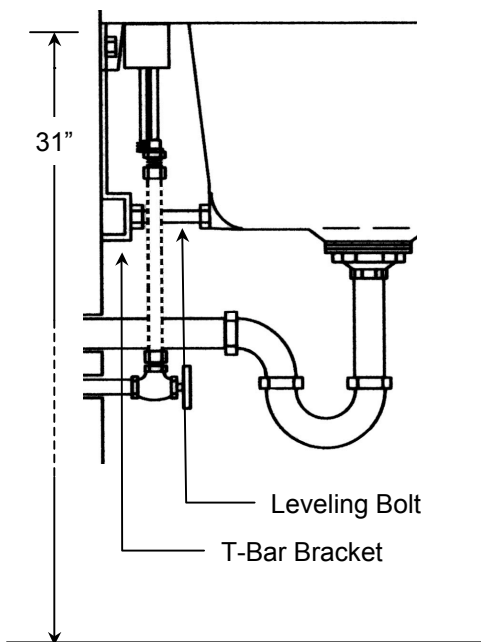
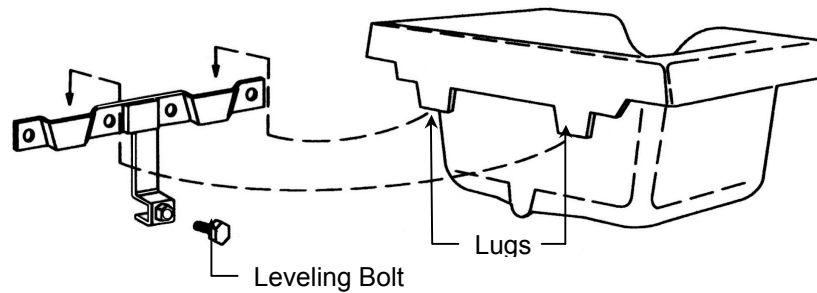

MOUNTING THE BOWL

- Fasten the T-Bar to the wall, making sure it is level and securely fastened to sound structural material
- Place lugs into allotted slots on bracket
- Push down until the bowl rests firmly on the bracket
- Tighten all bolt/ screws
- Adjust the leveling bolt to secure the bowl in place

FAUCET FIXTURE

LITERATURE DIMENSIONS ARE FOR GENERAL REFERENCE USE ONLY. INSTALLATION DIMENSIONS SHOULD BE TAKEN DIRECTLY FROM THE SINK.

