

# PEDICURE SPA USER MANUAL

LIBERTE<sup>®</sup>

Before Operating the unit, please read this manual thoroughly and retain it for future reference.

## RECEIVING AND INSPECTION:

PLEASE TAKE NOTE! Thoroughly inspect each shipment immediately upon arrival. It is important that you notify the driver and insist on a notation of the damage. Make this notation directly on the freight company's waybill or bill of lading. Failure to note damage on the waybill or bill of lading may impede and/or prevent any claims that you may have against the freight carrier.

If missing parts or damage is found. Please notify the carrier at once and request an inspection. DO NOT DISCARD THE SHIPPING BOX. If you give the carrier a clear receipt for goods that have been damaged in transit, you do so at your own risk and expense.

# CERTIFICATE OF COMPLIANCE

**Certificate Number** 20140424-E319402  
**Report Reference** E319402-20130425  
**Issue Date** 2014-April-24

**This is to certify that  
representative samples of**

**COMPONENT - PLUMBING ACCESSORIES**  
Pedicure Spa Pump / Jet Assembly, Model Pureflo 7 and  
EcoJet-MD

Have been investigated by UL in accordance with the  
Standard(s) indicated on this Certificate.

**Standard(s) for Safety:** ANSI/UL 1951- Electric Plumbing Accessories  
**Additional Information:** See the UL Online Certifications Directory at  
[www.ul.com/database](http://www.ul.com/database) for additional information

Only those products bearing the UL Recognized Component Mark should be considered as being covered by UL's Recognition and Follow-Up Service.

The UL Recognized Component Mark generally consists of the manufacturer's identification and catalog number, model number or other product designation as specified under "Marking" for the particular Recognition as published in the appropriate UL Directory. As a supplementary means of identifying products that have been produced under UL's Component Recognition Program, UL's Recognized Component Mark: , may be used in conjunction with the required Recognized Marks. The Recognized Component Mark is required when specified in the UL Directory preceding the recognitions or under "Markings" for the individual recognitions.

Recognized components are incomplete in certain constructional features or restricted in performance capabilities and are intended for use as components of complete equipment submitted for investigation rather than for direct separate installation in the field. The final acceptance of the component is dependent upon its installation and use in complete equipment submitted to UL LLC.

Look for the UL Recognized Component Mark on the product.

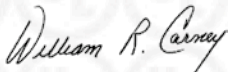

William R. Carney, Director, North American Certification Programs

UL LLC

Any information and documentation involving UL Mark services are provided on behalf of UL LLC (UL) or any authorized licensee of UL. For questions, please contact a local UL Customer Service Representative at [www.ul.com/contactus](http://www.ul.com/contactus)



# Table of Contents

RECEIVE AND INSPECTION .....	1
UL CERTIFICATION .....	2
TABLE OF CONTENT .....	3
SAFETY PRECAUTION .....	4

## PARTS

Identifying Parts for Liberte® Model .....	5
--	---

## INSTALLATION

Spa to Spa Recommended Clearance / Top Chair Manual Lock- Revision 1 .....	6
Top Chair - Auto Lock -Revision 2 .....	7
Plumbing Connection / Flow Pattern for Gravity Drain:.....	8
Plumbing Flow Pattern for Power Drain .....	9
Hot and Cold Water Supply Lines .....	10

## SPA SPECIFICATION

Electrical and Pedicure Spa Component Specifications.....	11
---	----

## OPERATION AND CARE

Manual Operation .....	12
Auto-Fill™ Models Operation and Care.....	13
Magnetic Whirlpool Jet & Auto Fill Liner & Foot-rest Calf Support .....	14
Conventional Whirlpool Jet & Massage Remote Control.....	15
Cleaning Suggestion for Pedicure Spas .....	16

### **READ AND FOLLOW INSTRUCTIONS CAREFULLY**

#### **SAFETY PRECAUTIONS:**



**Warning** THIS PRODUCT IS FOR INDOOR USE ONLY & IS NOT RECOMMENDED FOR USE ON CARPET OR WOOD FLOORS  
DISCONNECT POWER SUPPLY CORD BEFORE SERVICING

This product is to be connected to a branch circuit outlet protected by a Class A GROUND FAULT CIRCUIT INTERRUPTER (GFCI), and the GFCI shall be tested regularly for continued protection and correct operation. If a Class A GFCI protected outlet is not available, DO NOT USE THIS PRODUCT! Please contact a licensed electrician for installation of a Class A GFCI according to local electric codes, or equivalent.



**Warning** DO NOT USE if you are diabetic, have poor circulation, or if any area of your feet or legs is inflamed or has an open sore. Consult your physician before using if you have any kind of fungal infection, swelling, fracture or persistent pain.



**Warning** TO REDUCE RISK OF INJURY, DO NOT PERMIT CHILDREN TO USE THIS UNIT UNLESS THEY ARE CLOSELY SUPPervised AT ALL TIME

- LIRE LES INSTRUCTION DU FABRICANT AVANT DE METTRE EN MARCHÉ
- UTILISER SEULEMENT A L'INTERIEUR
- COUPER LE COURANT AVANT DE PROCEDRE AU DEPANNAGE, AU NETTOYAGE



- Warning**
1. Excessive water temperature is dangerous and should be checked BEFORE use.
  2. Maximum temperature of the water should never exceed 100 degrees F.
  3. DO NOT STEP/ STAND IN FOOT BASIN.
  4. Always enter and exit the Pedicure Spa slowly and carefully.
  5. NEVER bring and / or operate any electrical devices into or near the Pedicure Spa.
  6. Maximum load in spa chair is 250lbs (114kg).
  7. Pedicure Spa Chairs are not recommended for use on carpet or wood floors.



**Warning**

PROPER INSTALLATION ACCORDING TO THIS MANUAL IS REQUIRED. FAILURE TO DO SO MAY RESULT IN SERIOUS INJURY AND/OR WARRANTY WILL BE NULL. YOU MUST HAVE A QUALIFIED LICENSED PLUMBER TO CONNECT THE SPA IN PLACE SAFELY.

#### **STATES' NOTICE**

*In the commonwealth of most of the States, all pedicure spas shall be installed for Commercial usage in the states, are required to have backflow preventer. This equipment shall be installed between the water inlets and the spa at Salon's cost.*

**PLEASE SAVE THESE INSTRUCTIONS FOR FUTURE REFERENCE**

## Identifying Parts for Liberte® Model

### Pedicure Whirlpool with Massage System

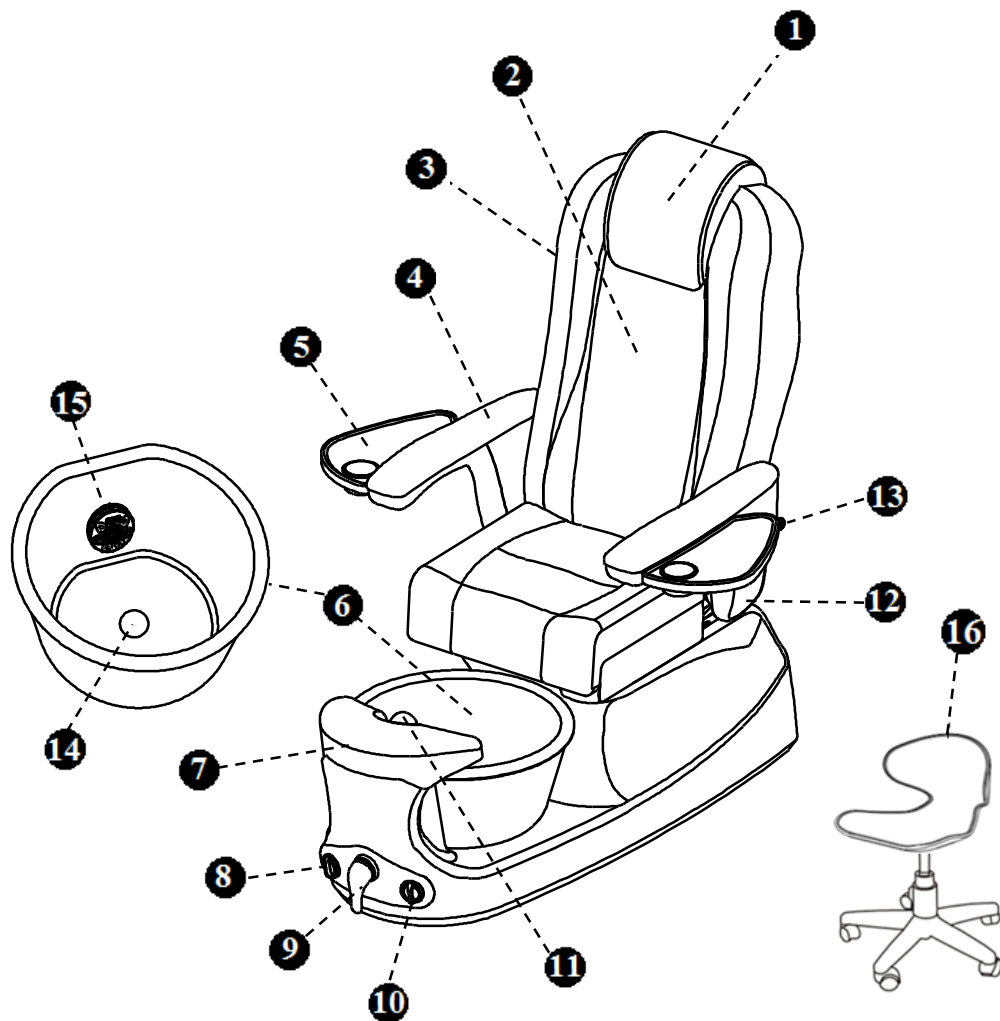

1. Head Rest
2. Chair Cushion with Massage
3. Massage Remote Control
4. Armrest Cushion
5. Manicure-Tray (Optional)
6. Glass Bowl
7. Footrest
8. Sani-Drain™ System with Discharge On/Off Knob

9. Hot/Cold Water Mixer Valve
10. Jet On/Off Knob
11. Flex Water Filler/Spray Spout
12. Up/Down Armrest

13. Handbag (Purse) Hook (Upgrade Option Only)
14. Drain Stopper
15. Ecojet™ Jet
16. Low Profile Stool for Pedicure

## WALL TO WALL & SPA to SPA RECOMMENDED CLEARANCE:

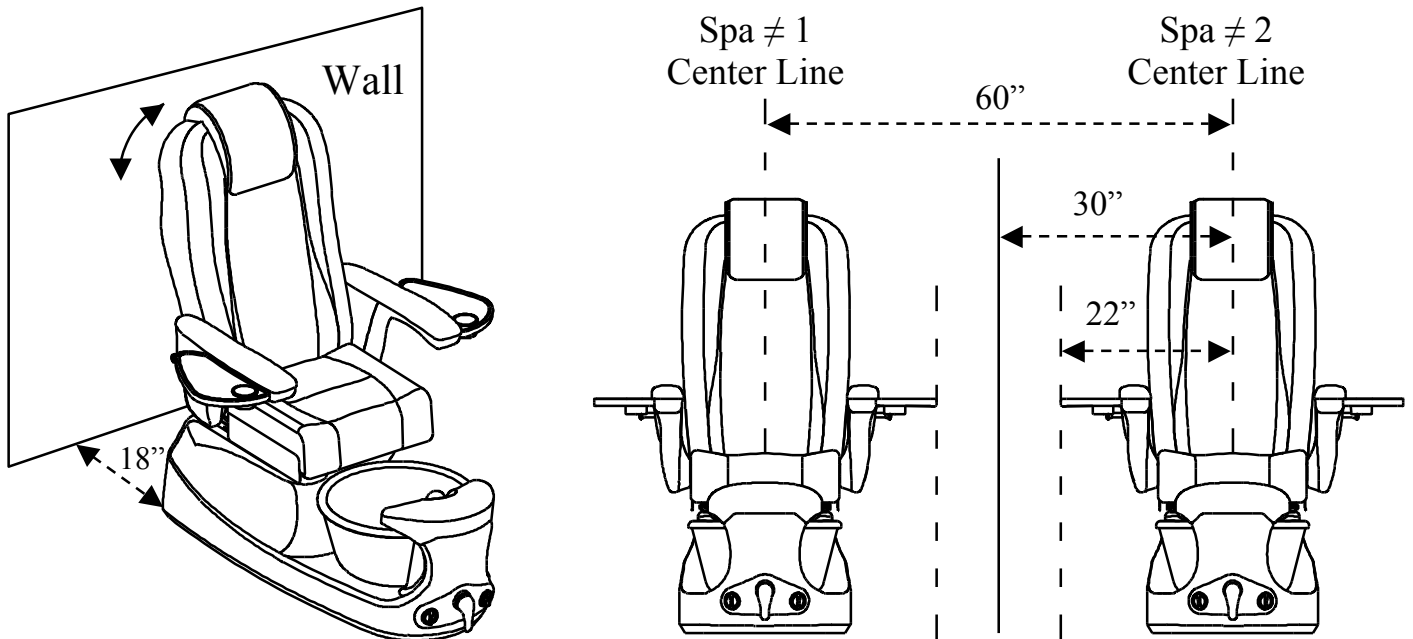

## TOP CHAIR REVISION 1 : FOLD AND UNFOLD BACK-REST MASSAGE

(Completed unit Packed in a single Box)

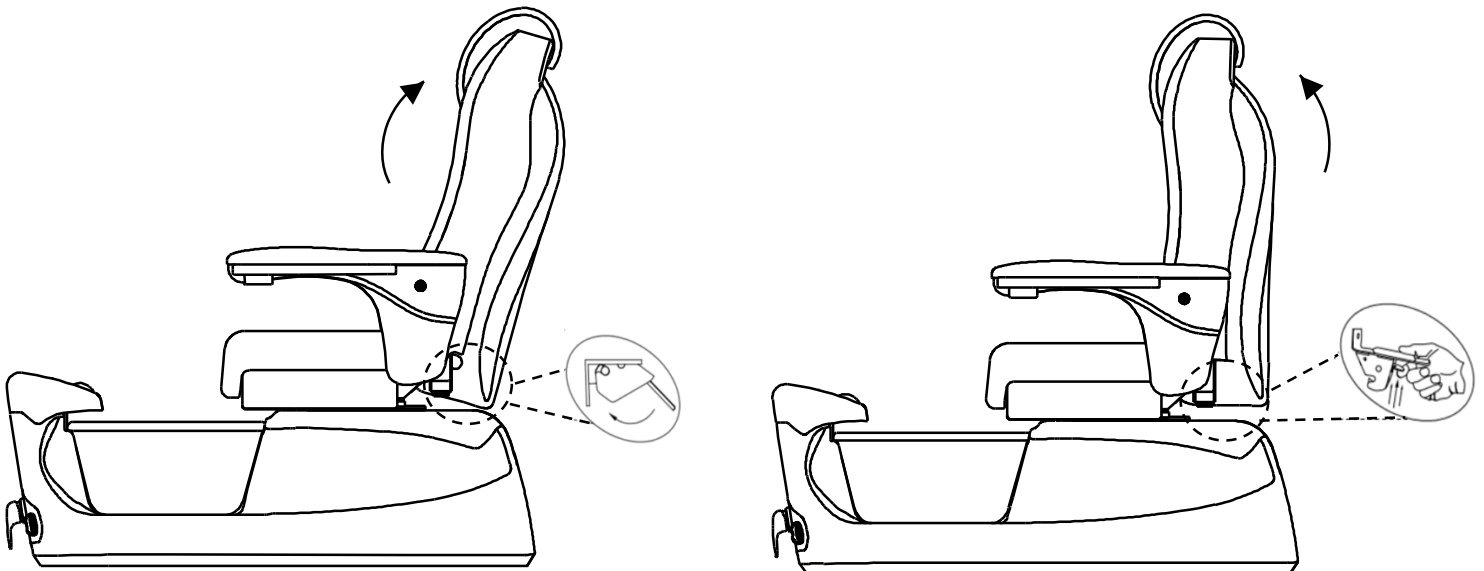

1. To set backrest up: Lift up the backrest until a "Click" is heard. Make sure the lever is locked before operating.
2. To fold down backrest: Lift up lever handle located on the left side / bottom of Chair.

## TOP CHAIR REVISION 2: (2 Units installation. Packed in Separated Boxes)

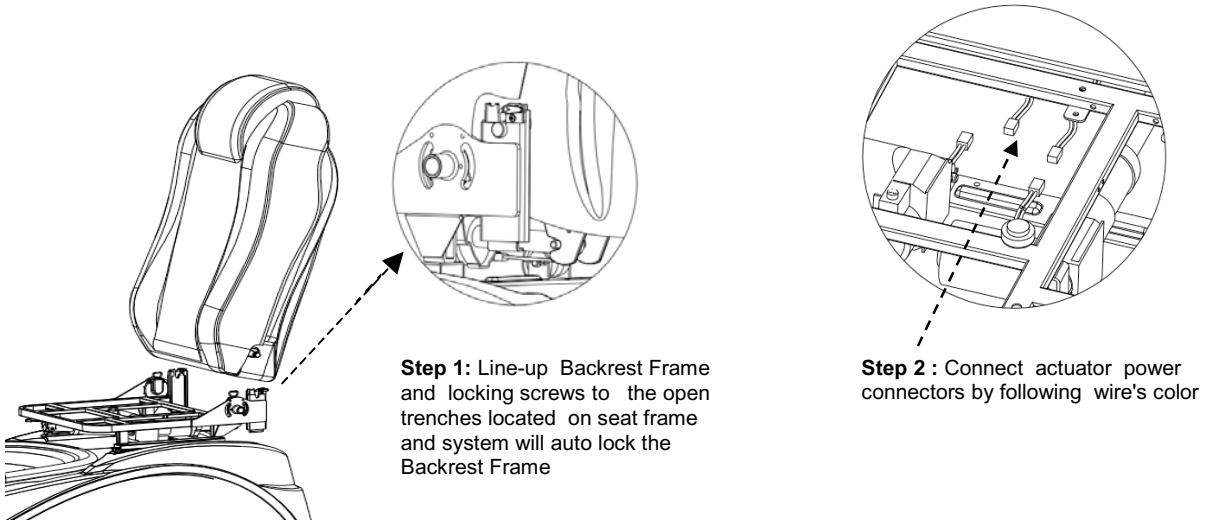

**Step 3:** Line-up & install 2 screws beneath the seat cushion onto seat frame

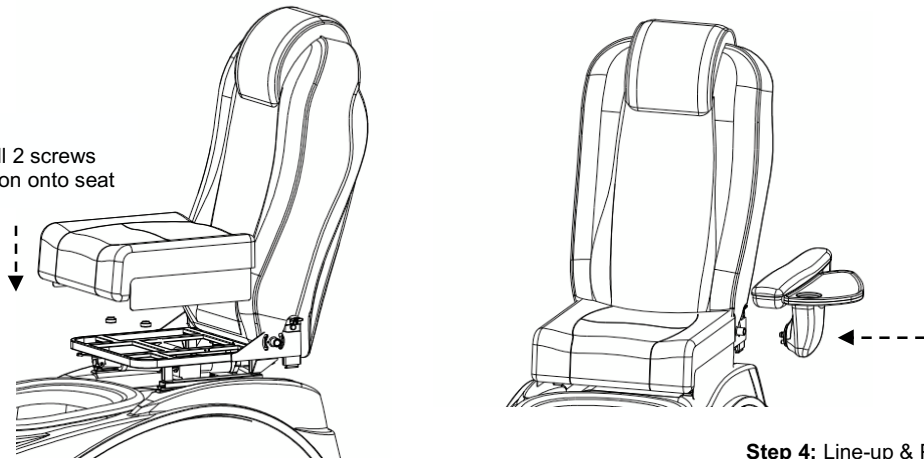

## TOP CHAIR REVISION 2 : REMOVAL

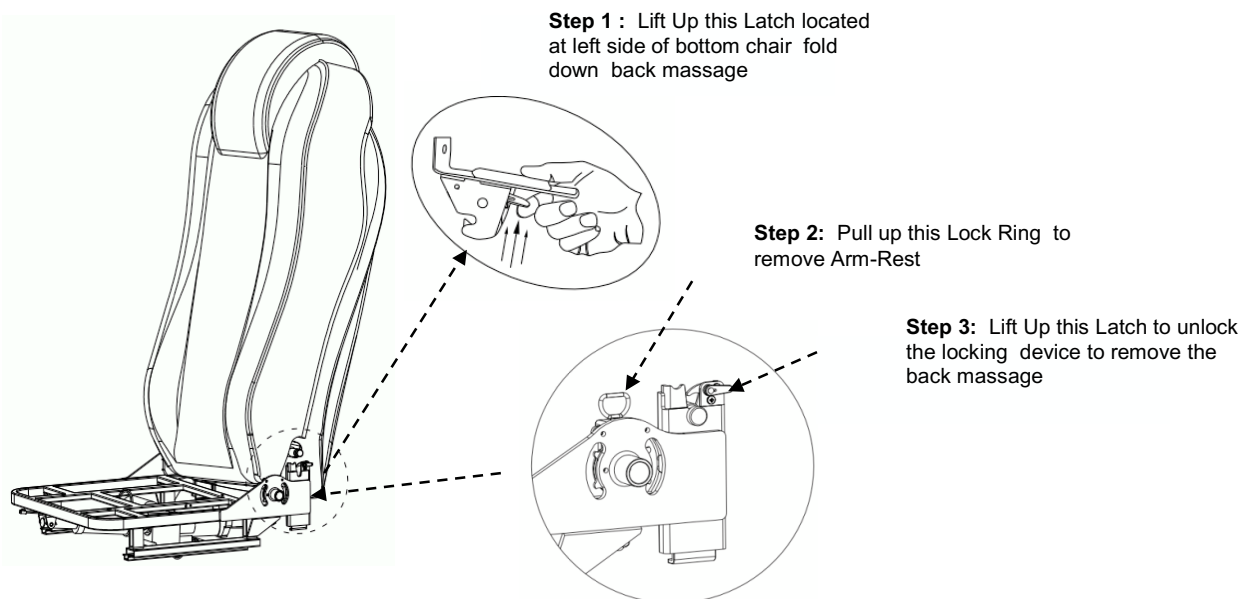

## Plumbing Connections:

**Warning** Before any connection, pay attention to these subjects:

1. Debris or residue may become lodged into the Hot and Cold hoses during construction, which may clog the Hot and Cold Mixer. To clean, drain a good amount of water from water hoses to bucket before connecting them to the pedicure spa. Failure to do so may void your Warranty.
2. Hooking up a used Hot/Cold flex hose is not recommended since debris from broken rubber seal might clog water mixer. Failure to do so may void your Warranty.
3. Backflow preventer: Due to differences in construction lay-out of your Salon and City's plumbing code, please contact your local Plumber to fulfill your needs as required. Backflow Preventers are not supplied by the pedicure spa manufacturer.
4. Check valve is an optional part and supplied free of charge for your convenience. Factory is not liable for this Check valve.
5. Maximum Inlet water pressure must be under 75 PSI.

## GRAVITY DRAIN (Under Ground):

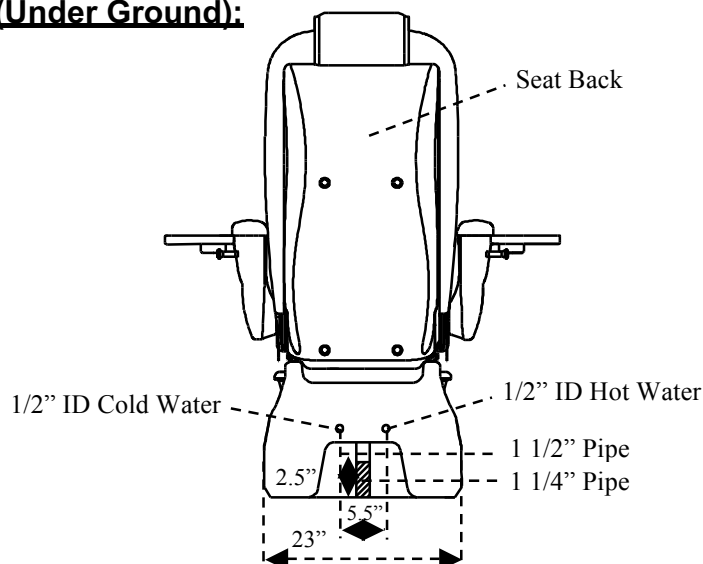

## Plumbing Flow Pattern for Gravity Drain:

\*\*\* Extra 1 1/4" Flex-hose is supplied for fast connecting to underground 1 1/2" connector

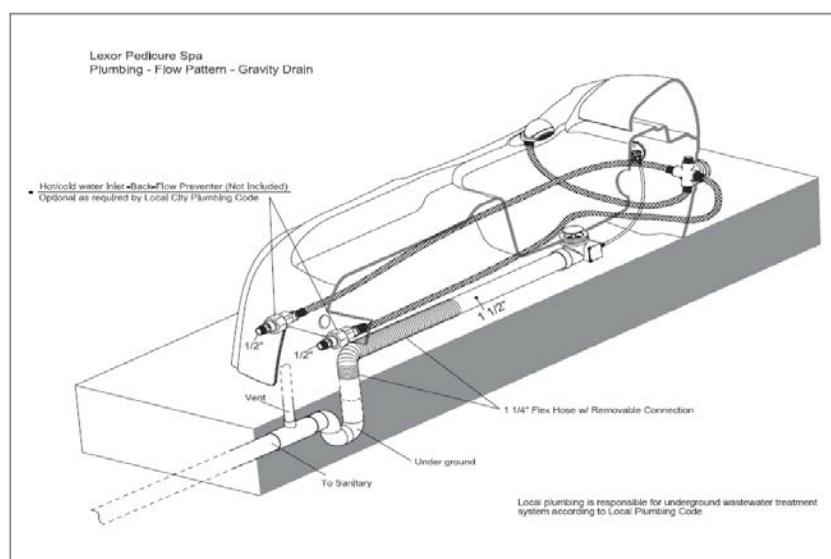

## POWER DRAIN : Connect Drain System with Drain Pump

- Using  $\frac{3}{4}$ " schedule 40 PVC (Power Drain). Connect drain to meet local plumbing codes.
- Flexible connection to the drain should be removable for easy service and should not be permanent to prevent damages.

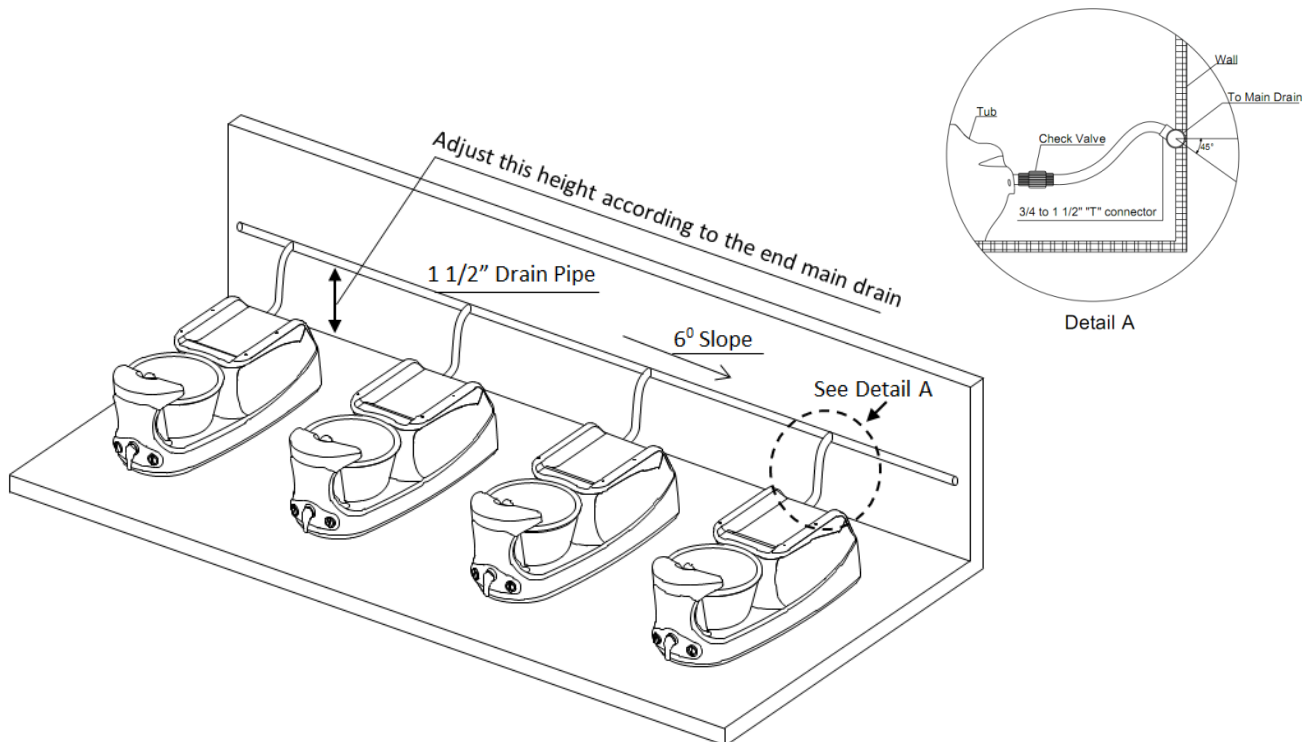
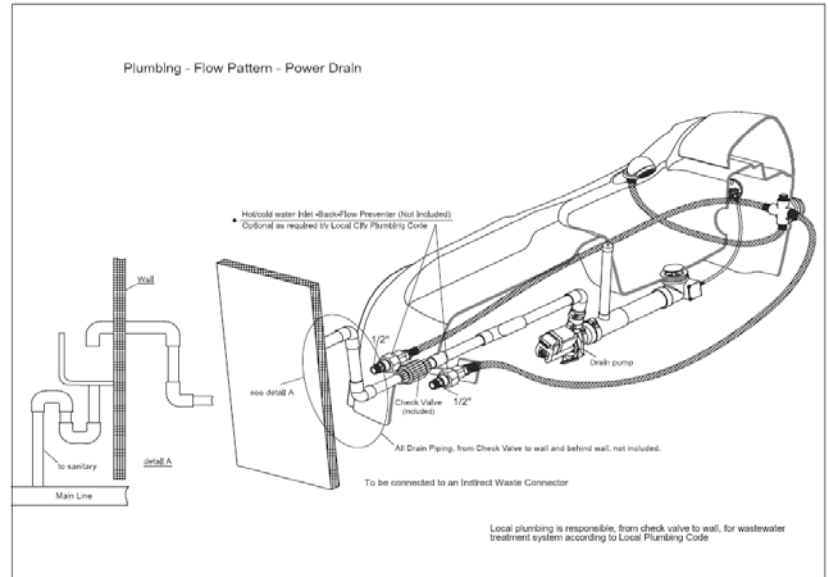
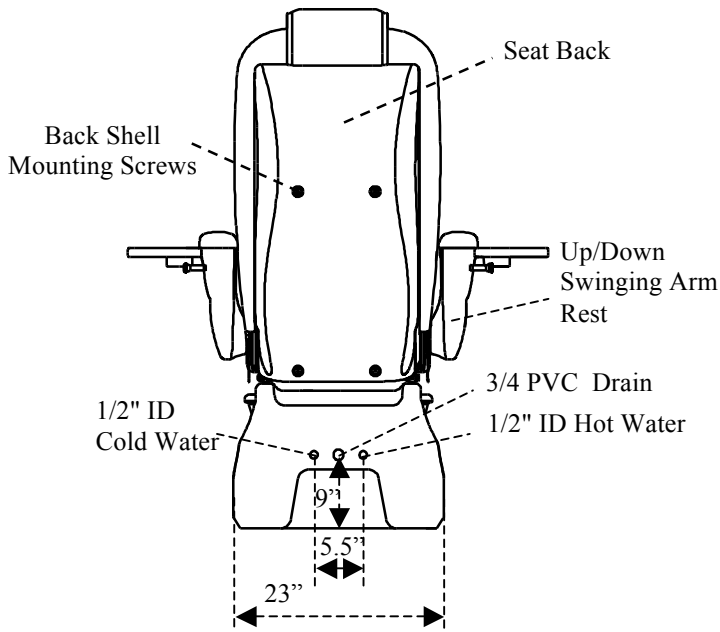

## HOT AND COLD WATER SUPPLY LINES

Carefully connect ½" ID supply hoses (not provided) to fresh water sources. Shut-off valves (not provided) should be utilized. Valves should be placed outside the tub for easy access.

Before water line connections, please follow below:

Determine if your spa chair is used for a new construction of a salon or a replacement spa chair.

1. **New construction:** Make sure to remove any and all debris and/or dust from current hot cold water pipes before hooking up to spa. Suggested direction to remove debris: turn on water and drain into a bucket or container. See illustration below:

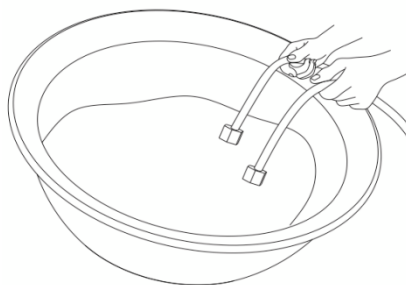

2. **Replacement Spa:** Always use new hot/cold water hoses when connecting a new spa chair to prevent debris, such as old rubber particles, from clogging drain.

## ELECTRICAL AND PEDICURE SPA COMPONENT SPECIFICATIONS

All electrical connections **MUST** be made by a qualified, licensed electrician in accordance with Local & National Electrical and Building Codes. A 110V-50/60 Hz, 15 Amp, GFCI protected grounded circuit **MUST** be used to supply power to the Pedicure Spa. A dedicated circuit must be used with a GFCI. All wiring must conform to National & Local Electrical Codes.



**WARNING: IT IS EXTREMELY IMPORTANT THAT THE FOOT SPA OPERATES WITH GFCI PROTECTION**

**VERY IMPORTANT** Both back of chair and seat are adjustable. When both are at maximum positions one must allow 18"(44cm) from back wall to foot spa. This minimum distance assures unobstructed recline. Failure to follow this required dimension might damage your spa components and plumbing connections, which will void your warranty.

### PEDICURE SPA SPECIFICATIONS:

- Construction: Marble composite, high gloss, acetone-proof gel coat.
- Two (2) electro-mechanical knobs control the drain and whirlpool.
- Electro-mechanically operated reclining, massaging, and sliding seat with hand held control.
- One (1) pipe-less whirlpool jet. (Pipe-free technology)
- Power drain or Gravity drain
- Extendable water spray positioned well above water line, air gap is accommodated with back-flow prevention required by plumbing code
- Depending on pedicure spa model, arms may swing open, swing up / down or slide forward / backward.

SPECIFICATIONS	
Spa Dimensions & Weights	L⊕ 52"(132cm), W=31"(79cm) w/ Tray 47" (120cm) H=56"(142cm) *Spa Fully Recline: 68" (172cm) Empty Weight: ~ 200 lbs. Shipping Weight: ~ 260 lbs. Max. Handling Weight ~ 250lbs Pedicure Stool: 12" – 13". Manicure Stool: 16.25" – 20"
Adjustable Stool	
Spa Water Capacity	~ 4.5 US Gallon
Jet Motor	120 VAC. at 85W 60Hz
Massage Motors, Seat Sliding & Reclining	24VDC, 2.5A x 5
Discharge Pump	Motor – 120V at 85W 60 Hz Maximum vertical lift: 3ft . Flow rate 500 GPH @ floor level
Power source	115 VAC, 60HZ, Power needed per spa chair = 6 Amp
Electrical Switches	One (1) electro-mechanical knob for the Whirlpool. Rated at 5A contact. One (1) electro-mechanical knob for the Drain. Rated at 5A contact.
Plug & Play Installation	Installation should be made with connection at the external interface parts. Please consult with your local plumber.
Safety	Liberte® Pedicure Spa is UL listed.

## OPERATION AND CARE INSTRUCTIONS

### Manual Operation (For Non Auto-Fill™/Drain Models):

#### Filling

Close the Drain Stopper by turning the Drain Knob counterclockwise. Utilizing the single lever hot/cold mixer faucet located on the front of the Pedicure Spa, fill the tub to the water level above the whirlpool jet at least 1 inch. You must completely submerge the jet. If during the operation of the whirlpool, the water level decreases, simply add more water.

#### Whirlpool Starting

Turn the Jet Knob located on the right side of the front panel to clockwise to turn on. Turn counterclockwise to shut off.



**Warning** Do NOT turn “ON” the WHIRLPOOL JET unless adequate water is in the tub.

#### Draining

Turn the Drain Knob clockwise to open the Drain Stopper. Power Drain will turn on automatically if drain pump exist.



**Warning** Do NOT turn “ON” the DRAIN PUMP unless adequate water is in the tub.  
THE WARRANTY IS VOID IF THE PUMP HAS BEEN RUNNING DRY

NOTE: Whirlpool action can cause even small amounts of soap or body oil to foam excessively. For this reason, refrain from using these products during the whirlpool cycle.

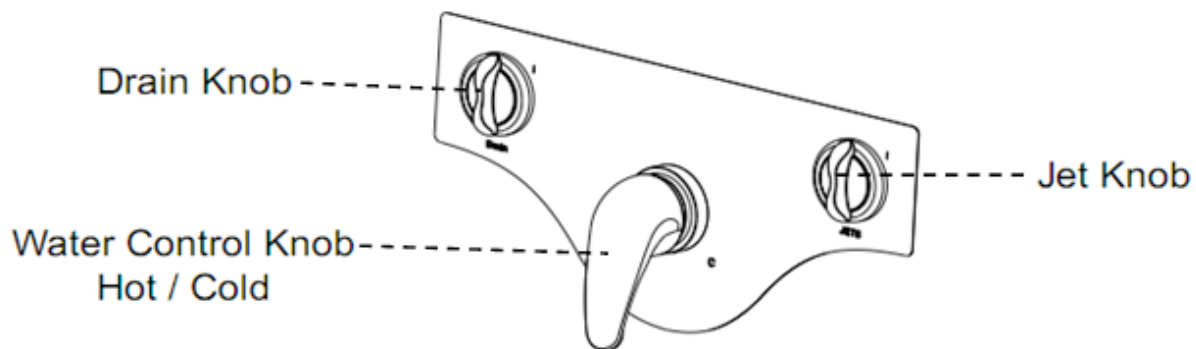

### **AUTO OPERATION (Auto-Fill™ Models Optional on QSpa):**

- 1.1 Use faucet knob to adjust optimal water temperature at "H" (Left) or "C" (Right) directory.
- 1.2 Pull out and tilt down faucet knob to shut off water any time during the automatic or manual operational cycle.

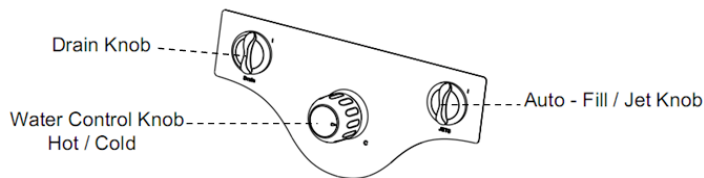

**Warning** Water control knob must be used to shut off water supply to basin when spa chair is left unattended and overnight

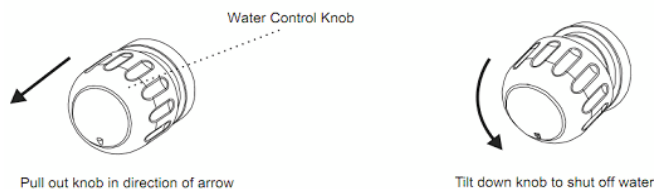

Water will automatically turn-off when optimal water level is detected by 2 sensors.

- ❖ Auto-Fill™ option can be simply reset to normal manual mode as a contingent system when automatic operation becomes unavailable. Please call our Customer care for instructions.
- ❖ If you notice the water stops before reaching water sensors. This might cause by the power unstable at that moment. To continue filling, turn the Auto-Fill knob clockwise again.



**Important!** Must scrub and clean water sensors frequently to ensure that water stops right at sensor level. If necessary, clean using sponge buffer.

### **Auto-Fill™ / Jet Switch:** (Dual-functional momentary switch located on the right side of the front panel)

1. **To turn water on:** Turn knob clockwise and release. Water will fill up to reach the sensor level and activate the whirlpool jets
2. **To turn water off:** Turn knob clockwise and release to turn off water. The switch can be activated to turn on or turn off water any time during the Auto-Fill™ cycle,

**NOTE:** Activate this Auto-Fill/Jet Knob:

1. When water is running, system will resume with turn off water.
2. When Whirlpool Jet is running, system will resume with turn off Jet
3. When water is full and Jet is off, system will resume with fill up water for 3sec and Jet turns on.
4. When water level is low, system will resume with fill up water prior activating whirlpool jet

### **Drain Switch:**

(Dual Action Electro-mechanical Switch located on the left side of the front panel)

When activating the switch, it will raise the drain-stopper and power up the drain pump (if exist) at the same time.

1. **To drain water:** Turn the drain knob clockwise. Drain pump is activated.
2. **To turn off the drain pump:** Turn the drain knob counterclockwise.

**CAUTION:** Reset the Drain knob to vertical position to close the drain stopper prior fill up water

**MAGNETIC WHIRLPOOL JET VERSION:**

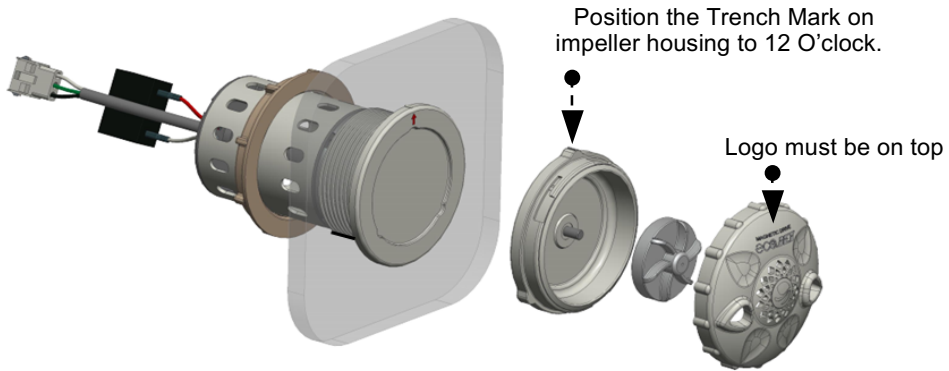

Turn Counterclockwise to remove Cap Cover



Turn Clockwise to Close Cap Cover

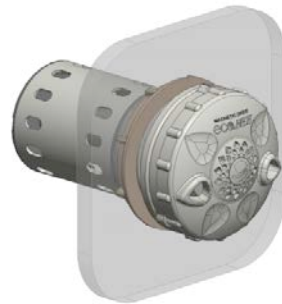

## CONVENTIONAL WHIRLPOOL JET VERSION

### JET COVER REMOVAL & INSTALLATION:

1. Turn Counterclockwise to remove. Turn Clockwise to install.

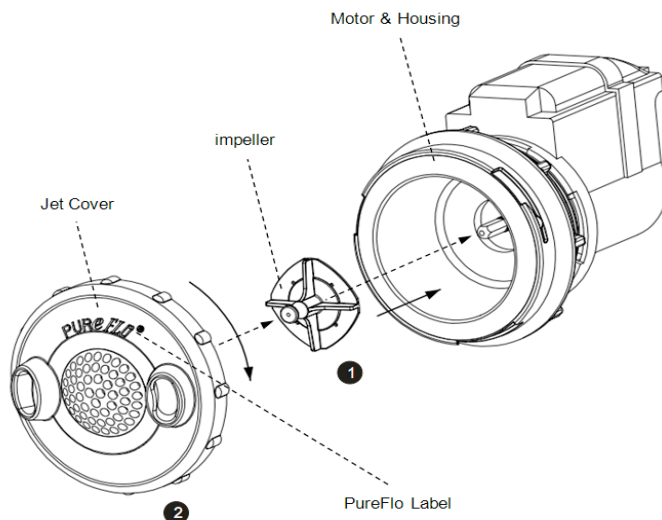

### MASSAGE SYSTEM & REMOTE CONTROLLER:

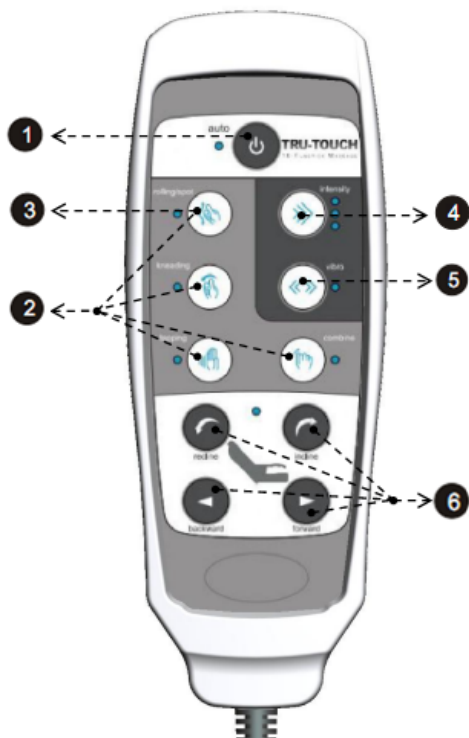

1. Press Auto Button to start Auto mode. Press again to turn off massage. Auto and Manual mode will run for duration of 20min.
2. Press any button (Rolling/Spot, Kneading, Tapping, and Combine) to enter Manual mode
3. Press Rolling/Spot to stop rolling up/down and stop at desired spot.
4. Press Intensity button to select tapping intens
5. Vibro Button is an option. Pressing this button will resume with Tapping action.
6. Press any chair button (Recline, Incline, Backward, Forward) to move the chair to desired positions

**WARNING**

You must always refer to your state or local guidelines for cleaning requirements. Overnight soaking with overdosed Chlorine may damage rubber part in basin

## **CLEANING PROCEDURE IS REQUIRED BY STATE BOARDS**

*Note: \*\*\* A cleaning log should be kept with each pedicure spa \*\*\**

Each State will have slight differences in cleaning policies, please check with your state's Bureau of Barbering and Cosmetology or Regulatory Authority for specific details.

### **Safety Requirements for Pedicure Spas**

*The Bureau of Barbering and Cosmetology requires that salons using whirlpool pedicure foot spas must follow these disinfecting procedures to ensure proper cleaning and maintenance of the equipment and to prevent the spread of bacterial or parasitic disease.*

*Violation of this section may result on an administrative fine and/or disciplinary action. Each foot spa that is not in compliance with this section may result in a separate violation.*

*NOTE: Authority cited: Section 7312, Business and Profession Code. Reference: Section 7312 (e), Business and Profession Code.*

Below is a suggestion for your pedicure spa chair's cleaning procedure:

#### ***After Each Customer***

1. All water shall be drained and all debris shall be removed from the spa basin.
2. The spa basin must be cleaned with soap or detergent and water
3. The spa basin must be disinfected with an EPA-registered disinfectant with demonstrated bactericidal, fungicidal, and virucidal activity, which must be used according to manufacturer's instructions.
4. The spa basin must be wiped dry with a clean towel.

#### ***At the End of Each Day***

1. The screen shall be removed, all debris trapped behind the screen shall be removed, and the screen and the inlet shall be washed with soap or detergent and water.
2. Before replacing the screen, the screen shall be totally immersed in an EPA-registered disinfectant with demonstrated bactericidal, fungicidal and virucidal activity, which must be used according to the manufacturer's instructions.
3. The spa system shall be flushed with low sudsing soap and warm for at least 10 minutes, after which the spa shall be rinsed and drained.

#### ***At Least Once A Week***

1. The spa basin shall be filled completely with warm water and 1 teaspoon of 5.25% bleach for each gallon of water, or a solution of Sodium Hypochlorite of approximately 50ppm used according to manufacturer's instructions.
2. The spa system shall be flushed with the bleach and water solution, or Sodium Hypochlorite solution, for 5-10 minutes and allowed to sit for 6-10 hours.
3. The spa system shall be drained and flushed with water before use upon a patron.

To validate the Limited Warranty, The Registration Form on the back MUST be filled out, signed to confirm to your knowledge this warranty terms and conditions. within 15 days from received date.

**2-Year Parts Exchange Limited Warranty:**

All parts for pedi-spa model: Envision, Elite, Mystique, Luminous, and Infinity

**1-Year Parts Exchange Limited Warranty:**

All parts for pedi-spa model: Liberte, Versas, Q-Spa, Mani/Pedi Stools, and Customer Chairs.

**Part Shipping Fee:**

Shipping cost for replacement part is covered under warranty. To continue warranty, Salon owners have 15 days to return the defective parts at the Salon owner's expense prior to the next service.

**Limited Warranty Terms and Conditions:**

Wear and tear, physical damage, abuse, misuse, accidental events, freight damages, and Terra Bella Furniture lines are excluded.

Replacement parts are supplied with instructions and specially designed for simple installation, therefore do not require a technician onsite.

Phone support on Thanksgiving, Christmas, New Years, Chinese New Year's, and Independence Day are not available.

**Shipping Damages:**

Shipping damages must be claimed within 48 hrs after receiving the products. An investigation by the carrier can take up to 4-6 weeks to resolve.

**Individual Parts Sold Warranty:**

All parts purchase will be covered for 90-Days limited warranty.

Complete Top Chair w/ Massage will be covered for 6-Months limited warranty.

Complete Spa Base with Plumbing installed will be covered for 6-Months limited warranty.

**Warranty Disclaimer:**

Shall have no obligation to repair, replace, or refund until the verification process is completed. Limited warranty applies only to Pedicure Spas utilized in the United States. This limited warranty is not transferrable. Furthermore, this limited warranty is void if removed from its place of initial shipment.

\*Continuing a policy of constant research and development to improve the quality of our products. reserves the right to change pricing, parts, design and specifications without prior notice or obligation.

Your Initials:

\_\_\_\_\_

2016 All Rights reserved. Design and Specifications are subject to change without notice