



PEDICURE SPA USER MANUAL

ENVISIONTM SPA 2.17

Before Operating the unit, please read this manual thoroughly and retain it for future reference.

RECEIVING AND INSPECTION:

PLEASE TAKE NOTE! Thoroughly inspect each shipment immediately upon arrival. It is important that you notify the driver and insist on a notation of the damage. Make this notation directly on the freight company's waybill or bill of lading. Failure to note damage on the waybill or bill of lading may impede and/or prevent any claims that you may have against the freight carrier.

If missing parts or damage is found. Please notify the carrier at once and request an inspection. DO NOT DISCARD THE SHIPPING BOX. If you give the carrier a clear receipt for goods that have been damaged in transit, you do so at your own risk and expense.

TRADEMARK DISCLAIMER

Envision, Sani-Drain, PureFlo, Pioneering "SMART" Pedi-Spa, Auto-Fill, AutoClean, and Tru-Touch are the registered trademarks of Lexor, Inc. Reproduction or reuse of part or all of trademarks are expressly prohibited without written permission from Lexor, Inc. Due to limitation of the printing process, product colors shown might look different from actual colors. Lexor will not be responsible for any misprint of this advertisement. Lexor's footspa specification and prices may change without prior notice. Pedicure Spas are intended for professional used only, always follow your State Board's sanitation and disinfectant guideline.

Design and Specifications are subject to change without notice

CERTIFICATE OF COMPLIANCE

Certificate Number 20140424-E319402
Report Reference E319402-20130425
Issue Date 2014-April-24

Issued to: LEXOR INC
14800 GOLDENWEST ST WESTMINSTER CA 92683

**This is to certify that
representative samples of** COMPONENT - PLUMBING ACCESSORIES
Pedicure Spa Pump / Jet Assembly, Model Pureflo 7 and
EcoJet-MD

Have been investigated by UL in accordance with the
Standard(s) indicated on this Certificate.

Standard(s) for Safety: ANSI/UL 1951- Electric Plumbing Accessories

Additional Information: See the UL Online Certifications Directory at
www.ul.com/database for additional information

Only those products bearing the UL Recognized Component Mark should be considered as
being covered by UL's Recognition and Follow-Up Service.

The UL Recognized Component Mark generally consists of the manufacturer's identification and
catalog number, model number or other product designation as specified under "Marking" for the
particular Recognition as published in the appropriate UL Directory. As a supplementary means of
identifying products that have been produced under UL's Component Recognition Program, UL's
Recognized Component Mark: , may be used in conjunction with the required Recognized Marks.
The Recognized Component Mark is required when specified in the UL Directory preceding the
recognitions or under "Markings" for the individual recognitions.

Recognized components are incomplete in certain constructional features or restricted in
performance capabilities and are intended for use as components of complete equipment
submitted for investigation rather than for direct separate installation in the field. The final
acceptance of the component is dependent upon its installation and use in complete
equipment submitted to UL LLC.

Look for the UL Recognized Component Mark on the product.



William R. Carney, Director, North American Certification Programs

UL LLC

Any information and documentation involving UL Mark services are provided on behalf of UL LLC (UL) or any authorized licensee of UL. For questions, please
contact a local UL Customer Service Representative at www.ul.com/contactus



Table of Contents

RECEIVING AND INSPECTION:	1
UL CERTIFICATION	2
TABLE OF CONTENTS	3
SAFETY PRECAUTIONS:.....	4

PARTS

Identifying Parts for ENVISION™ SPA 2.17 Model	5
--	---

INSTALLATION

Spa to Spa Recommended Clearance/Top Chair Manual Lock Revision :.....	6
Top Chair - Auto Lock - Revision 2 :.....	7
Plumbing Connection Warning / Flow Pattern for Gravity Drain	8
Plumbing Flow Pattern For Power Drain	9
Hot & Cold Water Supply Lines	10

SPA SPECIFICATION

Electrical and Pedicure Spa Component Specification.....	11
--	----

OPERATION AND CARE

Auto-Fill™ Models Operation and Care	12
Auto-Fill™ Digital Control System (optional).....	13
Magnetic Whirlpool Jet - AutoFill Liner & Footrest Calf Support.....	14
Conventional Whirlpool Jet - Massage Remote.....	15
Cleaning Suggestion for Pedicure Spa	16

WARRANTY

LEXOR LIMITED FACTORY WARRANTY.....	17
-------------------------------------	----

READ AND FOLLOW INSTRUCTIONS CAREFULLY

SAFETY PRECAUTIONS:



Warning

**THIS PRODUCT IS FOR INDOOR USE ONLY & IS NOT RECOMMENDED FOR USE ON CARPET OR WOOD FLOORS
DISCONNECT POWER SUPPLY CORD BEFORE SERVICING**

This product is to be connected to a branch circuit outlet protected by a Class A GROUND FAULT CIRCUIT INTERRUPTER (GFCI), and the GFCI shall be tested regularly for continued protection and correct operation. If a Class A GFCI protected outlet is not available, **DO NOT USE THIS PRODUCT!** Please contact a licensed electrician for installation of a Class A GFCI according to local electric codes, or equivalent.



Warning

DO NOT USE if you are diabetic, have poor circulation, or if any area of your feet or legs is inflamed or has an open sore. Consult your physician before using if you have any kind of fungal infection, swelling, fracture or persistent pain.



Warning

TO REDUCE RISK OF INJURY, DO NOT PERMIT CHILDREN TO USE THIS UNIT UNLESS THEY ARE CLOSELY SUPERVISED AT ALL TIME

- LIRE LES INSTRUCTION DU FABRICANT AVANT DE METTRE EN MARCHÉ
- UTILISER SEULEMENT A L'INTERIEUR
- COUPER LE COURANT AVANT DE PROCEDRE AU DEPANNAGE, AU NETTOYAGE



Warning

1. Excessive water temperature is dangerous and should be checked **BEFORE** use.
2. Maximum temperature of the water should never exceed 100 degrees F.
3. **DO NOT STEP/ STAND IN FOOT BASIN.**
4. Always enter and exit the Pedicure Spa slowly and carefully.
5. **NEVER** bring and / or operate any electrical devices into or near the Pedicure Spa.
6. Maximum load in spa chair is 250lbs (114kg).
7. Pedicure Spa Chairs are not recommended for use on carpet or wood floors.



Warning

PROPER INSTALLATION ACCORDING TO THIS MANUAL IS REQUIRED. FAILURE TO DO SO MAY RESULT IN SERIOUS INJURY AND/OR WARRANTY WILL BE NULL. YOU MUST HAVE A QUALIFIED LICENSED PLUMBER TO CONNECT THE SPA IN PLACE SAFELY.

STATES' NOTICE

In the commonwealth of most of the States, all pedicure spas shall be installed for Commercial usage in the states, are required to have backflow preventer. This equipment shall be installed between the water inlets and the spa at Salon's cost.

PLEASE SAVE THESE INSTRUCTIONS FOR FUTURE REFERENCE

Identifying Parts for ENVISION™ SPA 2.17 Model

Pedicure Whirlpool with Massage System

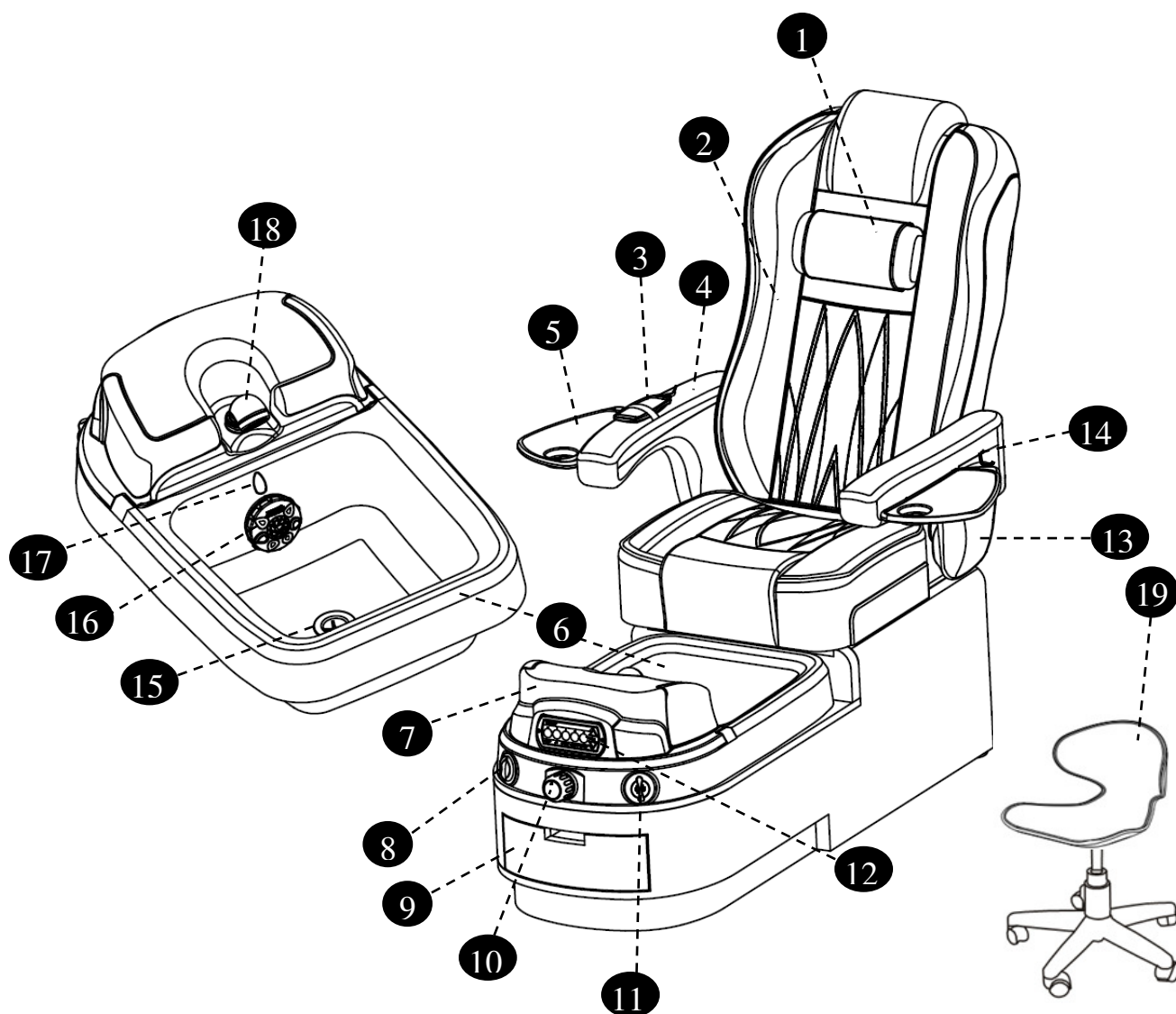
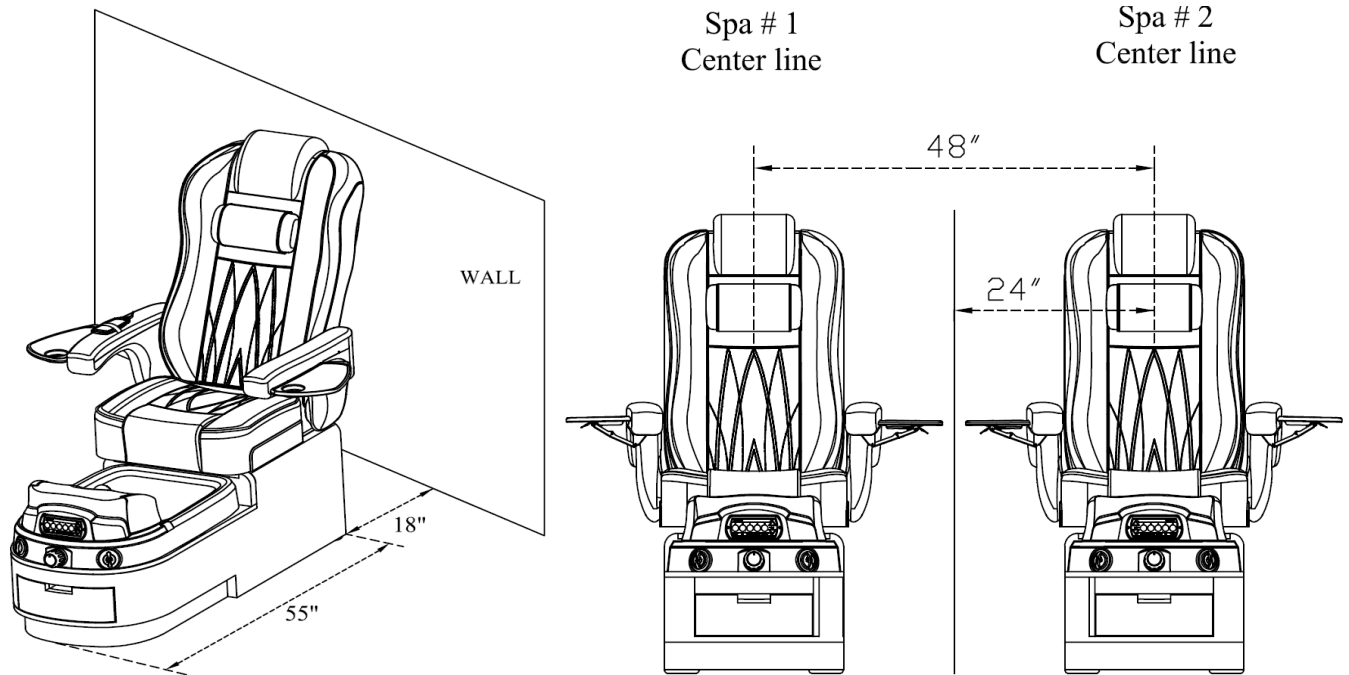
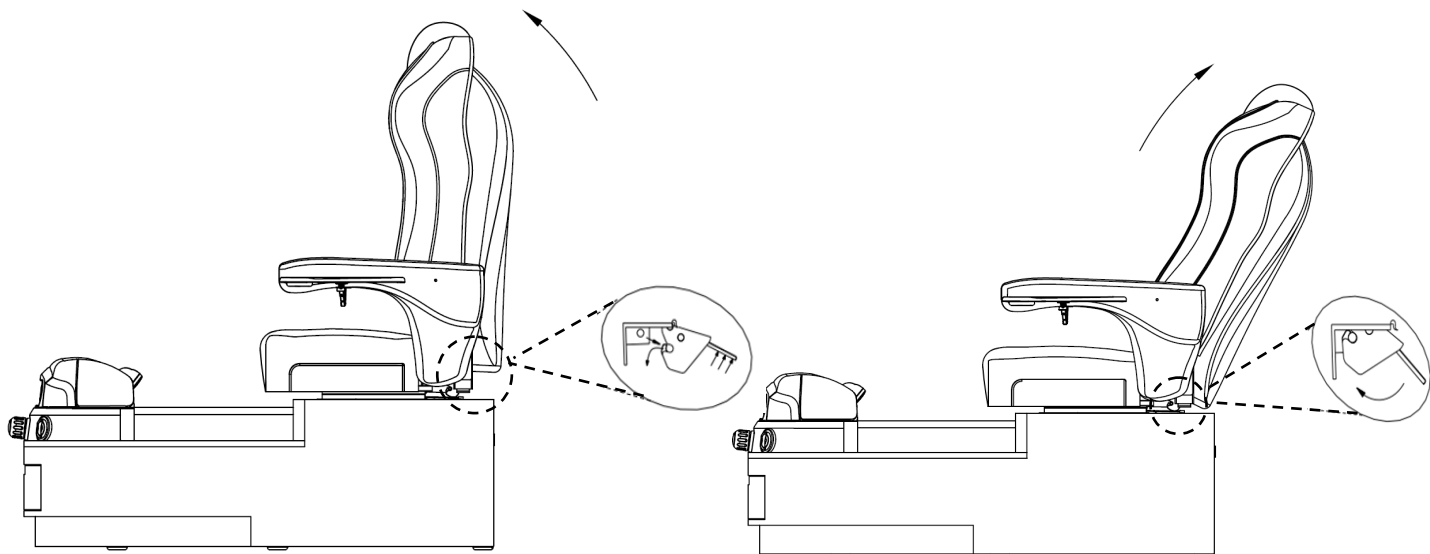

Figure 1 Identifying Parts for Envision™ Spa 2.17

- | | | |
|---|---|------------------------------------|
| 1. Head Rest | 9. Drawer. | 13. Up/Down Armrest |
| 2. Chair Cushion with Massage | 10. Hot/Cold Water Mixer Valve | 14. Handbag (Purse) Hook |
| 3. Massage Remote Control | 11. Dual Function Auto-Fill™ & Jet On/Off Knob* | 15. Drain Stopper |
| 4. Armrest Cushion | 12. Digital Automated System (DAS) control panel (Optional)** | 16. Ecojet™ Jet |
| 5. Manicure-Tray | | 17. Water Level Sensors |
| 6. Angelic Bowl | | 18. Flex Water Filler/Spray Spout |
| 7. Footrest | | 19. Low Profile Stool for Pedicure |
| 8. Sani-Drain™ System with discharge On/Off Knob* | | |

**found on AutoClean models

WALL CLEARANCE- SPA to SPA RECOMMENDED CLEARANCE:**TOP CHAIR VERSION 1 : FOLD & UNFOLD BACK REST MASSAGE
(1 Unit Packed in a Single Box)**

1. **To set backrest up:** Lift up the backrest until a "Click" is heard. Make sure the lever is locked before operating
2. **To fold down backrest:** Lift up latch handle located on the left side / bottom of Chair

TOP CHAIR REVISION 2: (2 Units installation. Packed in Separated Boxes)

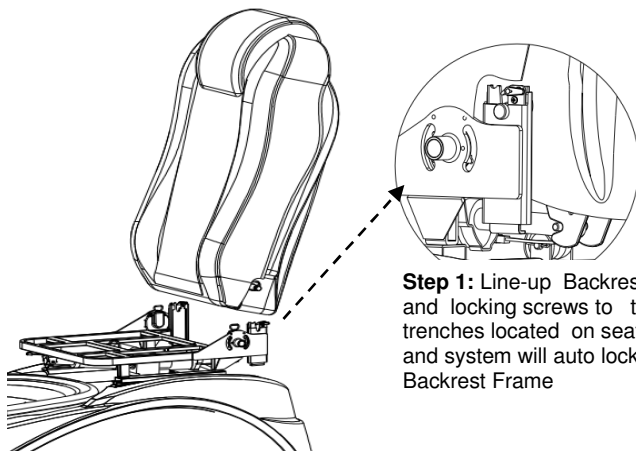

Step 1: Line-up Backrest Frame and locking screws to the open trenches located on seat frame and system will auto lock the Backrest Frame

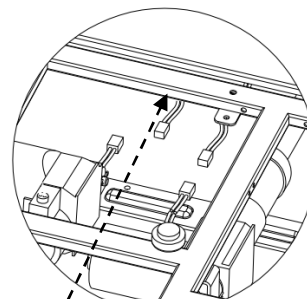

Step 2 : Connect actuator power connectors by following wire's color

Step 3: Line-up & install 2 screws beneath the seat cushion onto seat frame

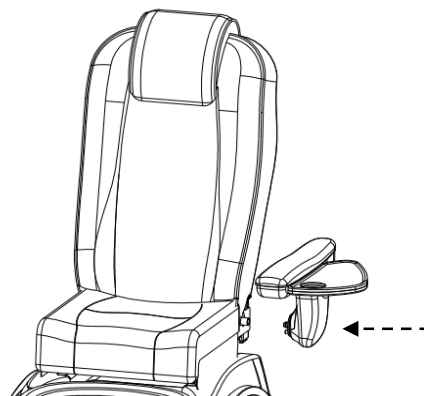
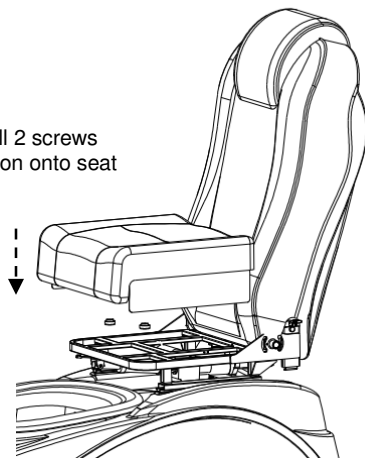

Step 3: Line-up & Plug arm-rest into seat frame until "Click" is heard. Raise Tray to horizontal level and push in.

TOP CHAIR REVISION 2 : REMOVAL

Step 1 : Lift Up this Latch located at left side of bottom chair fold down back massage

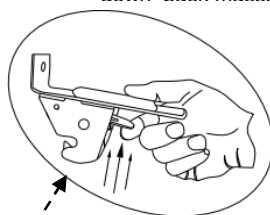
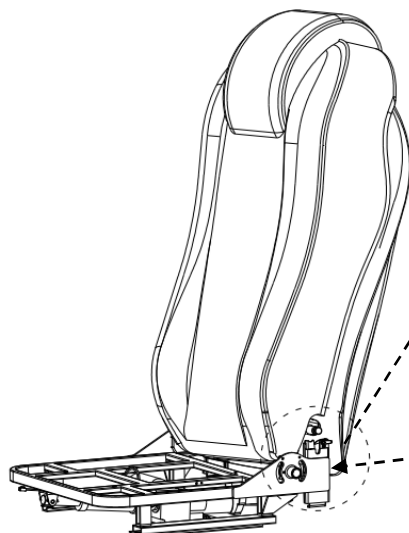

Step 2: Pull up this Lock Ring to remove Arm-Rest

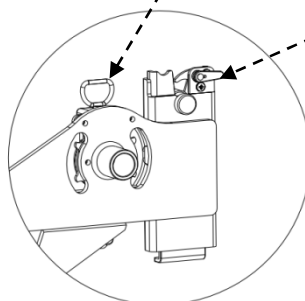

Step 3: Lift Up this Latch to unlock the locking device to remove the back massage

Plumbing Connections:

Warning Before any connection, pay attention to these subjects:

1. Debris or residue may become lodged into the Hot and Cold hoses during construction, which may clog the Hot and Cold Mixer. To clean, drain a good amount of water from water hoses to bucket before connecting them to the pedicure spa. Failure to do so may void your Warranty.
2. Hooking up a used Hot/Cold flex hose is not recommended since debris from broken rubber seal might clog water mixer. Failure to do so may void your Warranty.
3. Backflow preventer: Due to differences in construction lay-out of your Salon and City's plumbing code, please contact your local Plumber to fulfill your needs as required. Backflow Preventers are not supplied by the pedicure spa manufacturer.
4. Check valve is an optional part and supplied free of charge for your convenience. Factory is not liable for this Check valve.
5. Maximum Inlet water pressure must be under 75 PSI.

GRAVITY DRAIN (Under Ground):

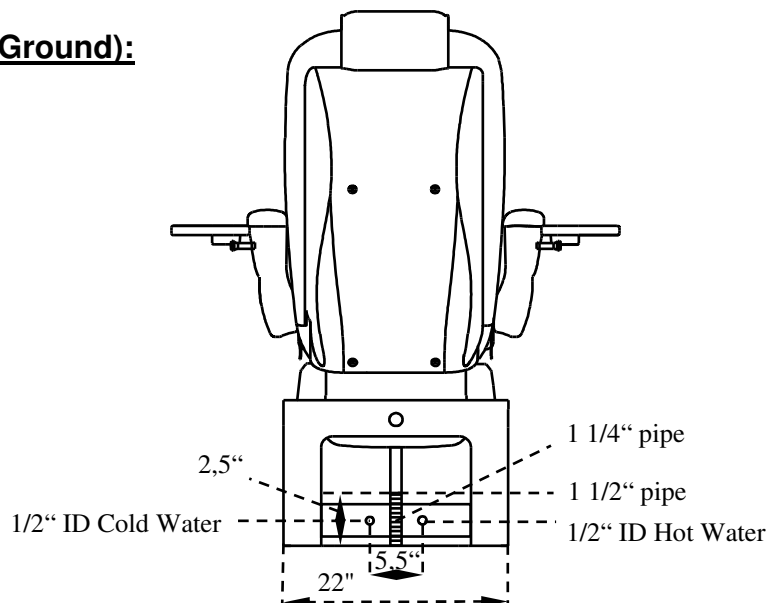

Plumbing Flow Pattern for Gravity Drain:

*** Extra 1 1/4" Flex-hose is supplied for fast connecting to underground 1 1/2" connector
 Lexor Pedicure Spa
 Plumbing –Flow Pattern- Gravity Drain

Hot/Cold water Inlet-Back-Flow Preventer (Not Included)
 Optional as required by Local City Plumbing

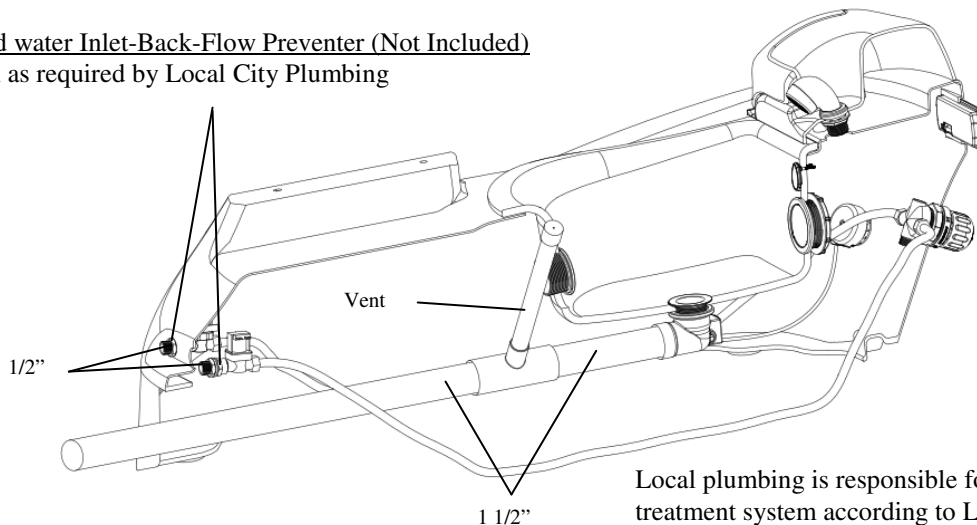

Local plumbing is responsible for underground wastewater treatment system according to Local Plumbing Code

POWER DRAIN : Connect Drain System with Drain Pump

- Using $\frac{3}{4}$ " schedule 40 PVC (Power Drain). Connect drain to meet local plumbing codes.
- Flexible connection to the drain should be removable for easy service and should not be permanent to prevent damages.

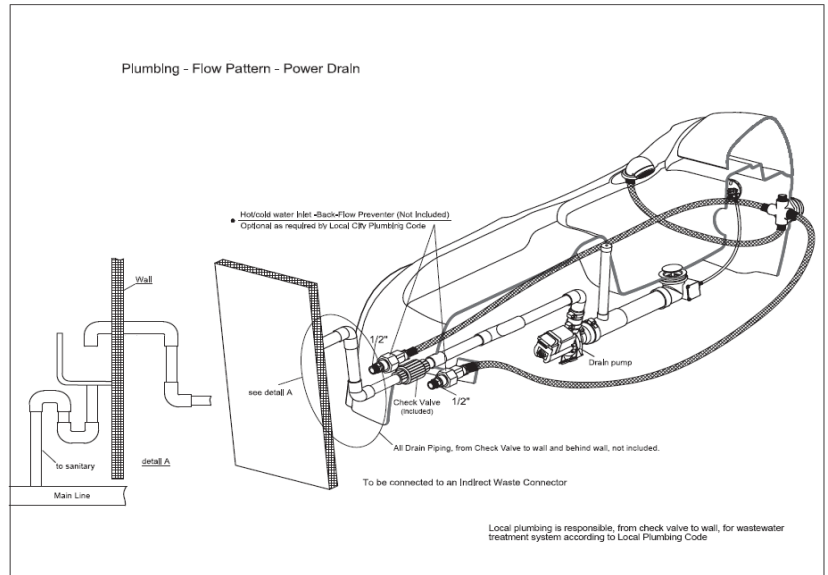
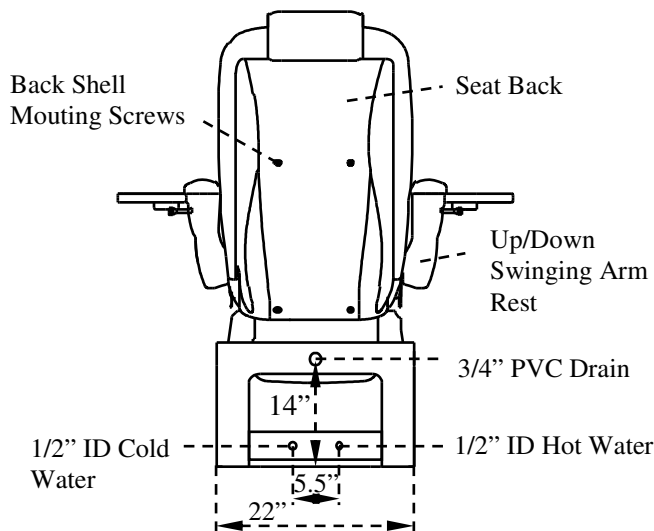

Drain System Recommendation

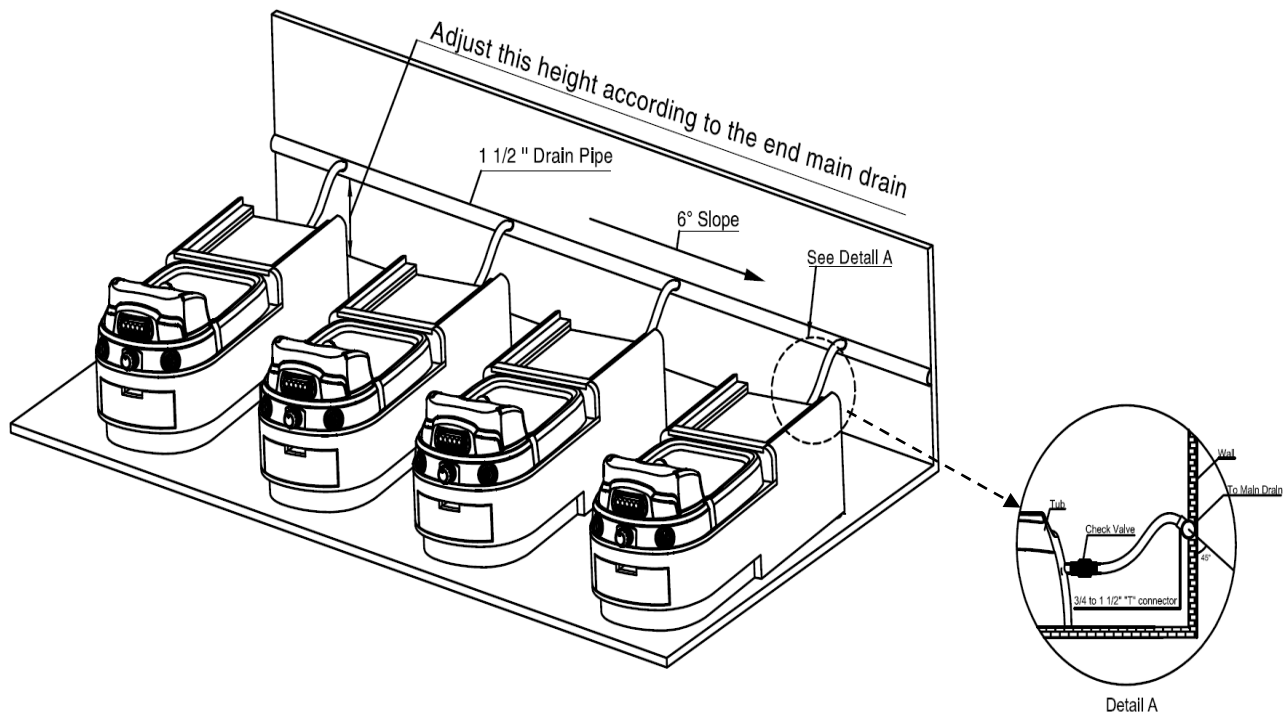

HOT AND COLD WATER SUPPLY LINES

Carefully connect ½" ID supply hoses (not provided) to fresh water sources. Shut-off valves (not provided) should be utilized. Valves should be placed outside the tub for easy access.

Before water line connections, please follow below:

Determine if your spa chair is used for a new construction of a salon or a replacement spa chair.

1. **New construction:** Make sure to remove any and all debris and/or dust from current hot cold water pipes before hooking up to spa. Suggested direction to remove debris: turn on water and drain into a bucket or container. See illustration below:

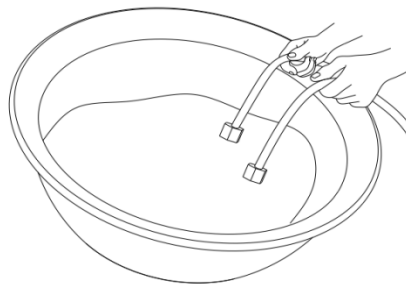

2. **Replacement Spa:** Always use new hot/cold water hoses when connecting a new spa chair to prevent debris, such as old rubber particles, from clogging drain.

ELECTRICAL AND PEDICURE SPA COMPONENT SPECIFICATIONS

All electrical connections MUST be made by a qualified, licensed electrician in accordance with Local & National Electrical and Building Codes. A 110V-50/60 Hz, 15 Amp, GFCI protected grounded circuit MUST be used to supply power to the Pedicure Spa. A dedicated circuit must be used with a GFCI. All wiring must conform to National & Local Electrical Codes.



WARNING: IT IS EXTREMELY IMPORTANT THAT THE FOOT SPA OPERATES WITH GFCI PROTECTION

VERY IMPORTANT Both back of chair and seat are adjustable. When both are at maximum positions one must allow 18"(44cm) from back wall to foot spa. This minimum distance assures unobstructed recline. Failure to follow this required dimension might damage your spa components and plumbing connections, which will void your warranty.

PEDICURE SPA SPECIFICATIONS:

- Construction: Marble composite, high gloss, acetone-proof gel coat.
- Two (2) electro-mechanical knobs control the drain and whirlpool. (*found on Auto-Fill™ only models)
- One (1) Digital Control System Panel
- Electro-mechanically operated reclining, massaging, and sliding seat with hand held control.
- One (1) magnetic pipe-less whirlpool jet. (Pipe-free technology)
- Power drain or Gravity drain
- Extendable water spray positioned well above water line, air gap is accommodated with back-flow prevention required by plumbing code
- Depending on pedicure spa model, Top Chair may be pre-installed or separated in box which require installation

SPECIFICATIONS	
Spa Dimensions & Weights	Envision™ Spa 2.17(seat up-right): L=55"(140cm), W=31"(79cm) w/ Tray =47"(120cm) H=60"(153cm) Empty Weight: ~ 200 lbs. Shipping Weight: ~ 260 lbs.
Adjustable Stool	Pedicure Stool: 12" – 13". Manicure Stool: 16.25" – 20"
Spa Water Capacity	~ 4.4 US Gallon
Jet Motor	120 VAC. at 85W 60Hz
Massage Motors, Seat Sliding & Reclining	24VDC, 75W
Led light	24VDC 45W
Discharge Pump	Motor – 120V at 85W 60 Hz Maximum vertical lift: 3ft . Flow rate 500 GPH @ floor level
Power source	115 VAC, 60HZ, Power needed per spa chair = 6 Amp
Electrical Switches	AutoFill™ Model : One (1) electro-mechanical knob for the Whirlpool. Rated at 5A contact. One (1) electro-mechanical knob for the Drain. Rated at 5A contact.
Plug & Play Installation	Installation should be made with connection at the external interface parts. Please consult with your local plumber.
Safety	Envision™ Spa 2.17 Pedicure Spa is UL listed.

AUTO OPERATION (Auto-Fill™ Models):

- 1.1 Use faucet knob to adjust optimal water temperature at "H" (Left) or "C" (Right) directory.
- 1.2 Pull out and tilt down faucet knob to shut off water any time during the automatic or manual operational cycle.

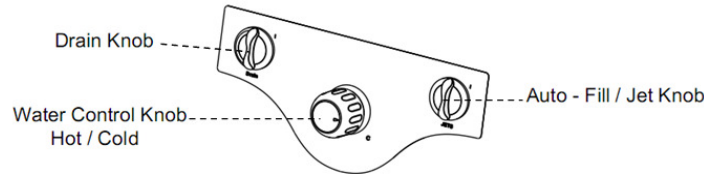

Warning Water control knob must be used to shut off water supply to basin when spa chair is left unattended and overnight

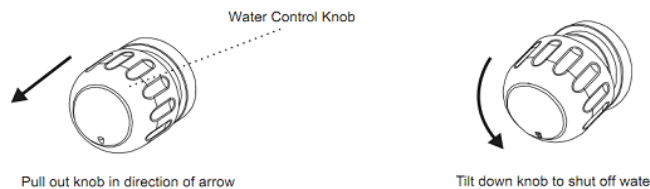

Water will automatically turn-off when optimal water level is detected by 2 sensors.

- ❖ Auto-Fill™ option can be simply reset to normal manual mode as a contingent system when automatic operation becomes unavailable. Please call our Customer care for instructions.



Important! Must scrub and clean water sensors frequently to ensure that water stops right at sensor level. If necessary, clean using sponge buffer.

Auto-Fill™ / Jet Switch: (Dual-functional momentary switch located on the right side of the front panel)

1. **To turn water on:** Turn knob clockwise and release. Water will fill up to reach the sensor level and activate the whirlpool jets
2. **To turn water off:** Turn knob clockwise and release to turn off water. The switch can be activated to turn on or turn off water any time during the Auto-Fill™ cycle,

NOTE: Activate this Auto-Fill/Jet Knob:

1. When water is running, system will resume with turn off water.
2. When Whirlpool Jet is running, system will resume with turn off Jet
3. When water is full and Jet is off, system will resume with fill up water for 3sec and Jet turns on.
4. When water level is low, system will resume with fill up water prior activating whirlpool jet

Drain Switch:

(Dual Action Electro-mechanical Switch located on the left side of the front panel)

When activating the switch, it will raise the drain-stopper and power up the drain pump (if exist) at the same time.

1. **To drain water:** Turn the drain knob clockwise. Drain pump is activated.
2. **To turn off the drain pump:** Turn the drain knob counterclockwise.

CAUTION: Reset the Drain knob to vertical position to close the drain stopper prior fill up water

Optional on Envision Model

- 1.1 Use faucet knob to adjust optimal water temperature at "H" (Left) or "C" (Right) directory.
- 1.2 Pull out and tilt down faucet knob to shut off water any time during the automatic or manual operational cycle.

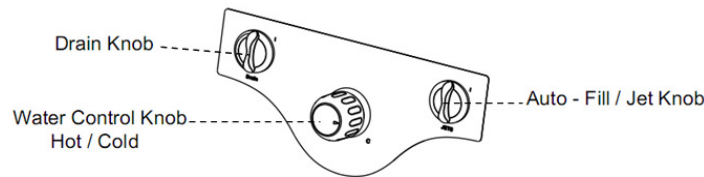

NOTE : Autofill Jet Knob & Drain Knob functionalities are same as Auto Operation (Auto-Fill Model) in previous section

DCS Front Panel Functional & Operating Instructions:

DIGITAL CONTROL SYSTEM

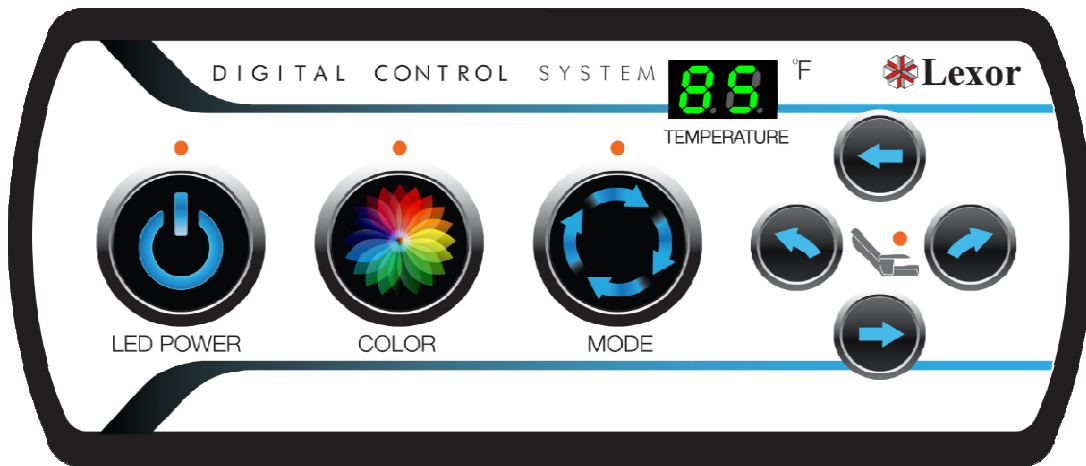

1. **LED POWER BUTTON:** Press to turn The RGB Led on or off. The Led color selected from previous spa service session will be turned on.
2. **COLOR BUTTON:** Press and Release Color button to select desired color. There are 7 colors. The selected color will be set to turn on for the next session.
3. **MODE BUTTON:** LED color lights will rotate automatically.
4. **Seat Adjustment Backward:** Press and hold the Top Button until desired backward length of the customer chair position is achieved.
5. **Seat Adjustment Forward:** Press and hold the Bottom Button until desired forward length of the customer chair position is achieved.
6. **Back Recline:** Press and hold the Left Button until the desired recline position of the customer chair is achieved.
7. **Back Incline:** Press and hold the Right Button until the desired incline position of the customer chair is achieved.
8. **Temperature Gauge:** Monitor the temperature of the water inside the bowl.

MAGNETIC WHIRLPOOL JET VERSION:

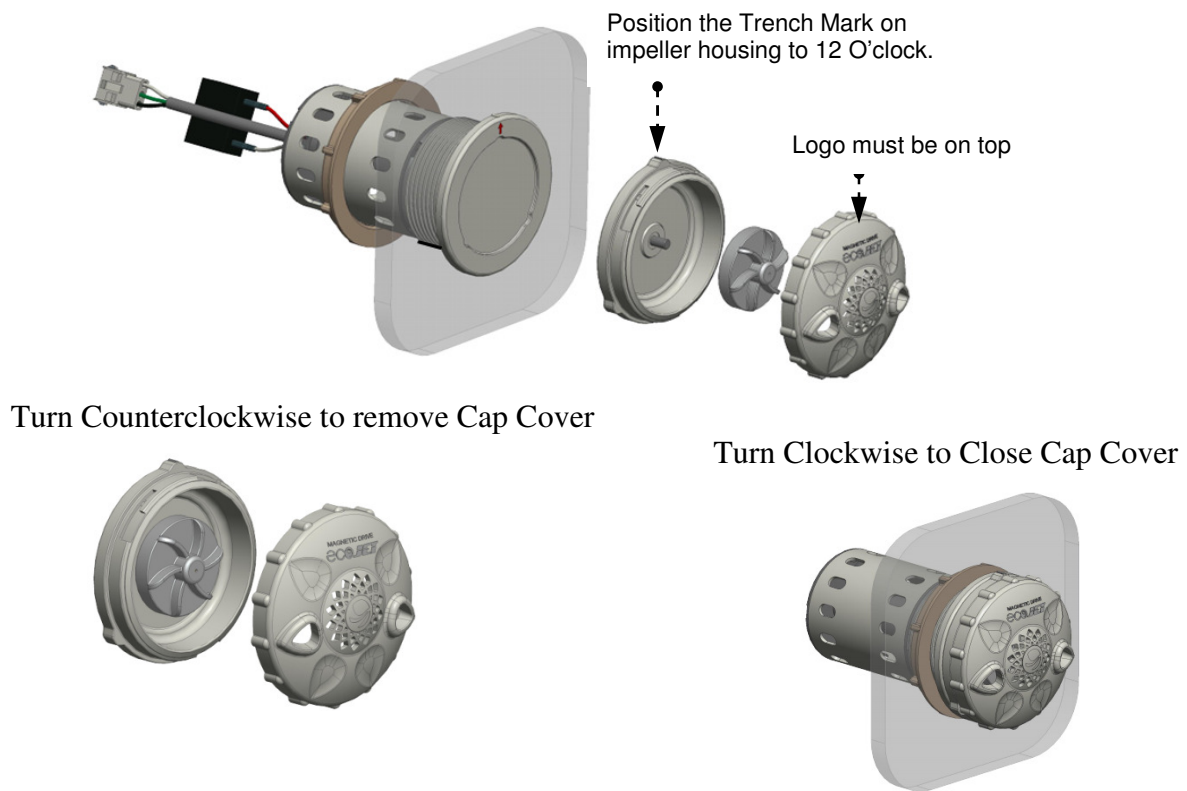

AUTOFILL SYSTEM USING PLASTIC LINER

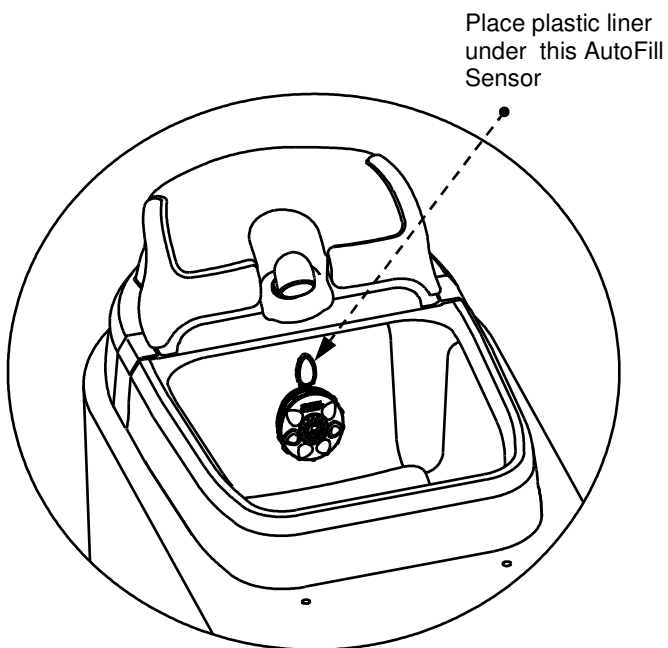

FOOT-REST CALF SUPPORT



CONVENTIONAL WHIRLPOOL JET VERSION

MASSAGE SYSTEM & REMOTE CONTROLLER:

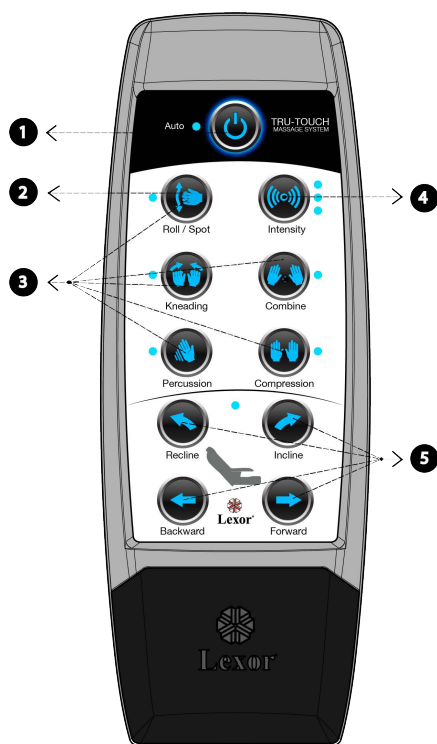

1. Press Auto Button to start Auto mode. Press again to turn off massage. Auto and Manual mode will run for duration of 20min.
2. Press Rolling/Spot to stop rolling up/down and stop at desired spot.
3. Press any button (Rolling/Spot, Kneading, Percussion, Compression, Combine) to enter Manual mode
4. Press Intensity button to select tapping intensity
5. Press any chair button (Recline, Incline, Backward, Forward) to move the chair to desired positions

Suggestion of Cleaning Requirements for Pedicure Spas



WARNING

You must always refer to your state or local guidelines for cleaning requirements. Overnight soaking with overdosed Chlorine may damage rubber part in basin

CLEANING PROCEDURE IS REQUIRED BY STATE BOARDS

*Note: *** A cleaning log should be kept with each pedicure spa ****

Each State will have slight differences in cleaning policies, please check with your state's Bureau of Barbering and Cosmetology or Regulatory Authority for specific details.

Safety Requirements for Pedicure Spas

The Bureau of Barbering and Cosmetology requires that salons using whirlpool pedicure foot spas must follow these disinfecting procedures to ensure proper cleaning and maintenance of the equipment and to prevent the spread of bacterial or parasitic disease.

Violation of this section may result on an administrative fine and/or disciplinary action. Each foot spa that is not in compliance with this section may result in a separate violation.

NOTE: Authority cited: Section 7312, Business and Profession Code. Reference: Section 7312 (e), Business and Profession Code.

Below is a suggestion for your pedicure spa chair's cleaning procedure:

After Each Customer

1. All water shall be drained and all debris shall be removed from the spa basin.
2. The spa basin must be cleaned with soap or detergent and water
3. The spa basin must be disinfected with an EPA-registered disinfectant with demonstrated bactericidal, fungicidal, and virucidal activity, which must be used according to manufacturer's instructions.
4. The spa basin must be wiped dry with a clean towel.

At the End of Each Day

1. The screen shall be removed, all debris trapped behind the screen shall be removed, and the screen and the inlet shall be washed with soap or detergent and water.
2. Before replacing the screen, the screen shall be totally immersed in an EPA-registered disinfectant with demonstrated bactericidal, fungicidal and virucidal activity, which must be used according to the manufacturer's instructions.
3. The spa system shall be flushed with low sudsing soap and warm for at least 10 minutes, after which the spa shall be rinsed and drained.

At Least Once A Week

1. The spa basin shall be filled completely with warm water and 1 teaspoon of 5.25% bleach for each gallon of water, or a solution of Sodium Hypochlorite of approximately 50ppm used according to manufacturer's instructions.
2. The spa system shall be flushed with the bleach and water solution, or Sodium Hypochlorite solution, for 5-10 minutes and allowed to sit for 6-10 hours.
3. The spa system shall be drained and flushed with water before use upon a patron.



Warranty Terms

To validate the Limited Warranty, The Registration Form on the back MUST be filled out, signed to confirm to your knowledge this warranty terms and conditions and return to Lexor Inc. within 15 days from received date.

2-Year Parts Exchange Limited Warranty:

All parts for pedi-spa model: Envision, Elite, Mystique, Luminous, Infinity, and Liberte.

1-Year Parts Exchange Limited Warranty:

All parts for pedi-spa model: Versas, Q-Spa, Mani/Pedi Stools, and Customer Chairs.

Part Shipping Fee:

Shipping cost for replacement part is covered under warranty. To continue warranty, Salon owners have 15 days to return the defective parts to Lexor at the Salon owner's expense prior to the next service.

Limited Warranty Terms and Conditions:

Wear and tear, physical damage, abuse, misuse, accidental events, freight damages, and Terra Bella Furniture lines are excluded.

Replacement parts are supplied with instructions and specially designed for simple installation, therefore do not require a technician onsite.

Phone support on Thanksgiving, Christmas, New Years, Chinese New Year's, and Independence Day are not available.

Shipping Damages:

Shipping damages must be claimed within 48 hrs after receiving the products. An investigation by the carrier can take up to 4-6 weeks to resolve.

Individual Parts Sold Warranty:

All parts purchase will be covered for 90-Days limited warranty.

Complete Top Chair w/ Massage will be covered for 6-Months limited warranty.

Complete Spa Base with Plumbing installed will be covered for 6-Months limited warranty.

Warranty Disclaimer:

Lexor shall have no obligation to repair, replace, or refund until the verification process by Lexor is completed. Lexor's limited warranty applies only to Lexor Pedicure Spas utilized in the United States. This limited warranty is not transferrable. Furthermore, this limited warranty is void if removed from its place of initial shipment.

*Continuing a policy of constant research and development to improve the quality of our products, Lexor, Inc. reserves the right to change pricing, parts, design and specifications without prior notice or obligation.

Your Initials:
