

PEDICURE SPA USER MANUAL

BRISA[®]

Before Operating the unit, please read this manual thoroughly and retain it for future reference.

PLEASE TAKE NOTE! Thoroughly inspect each shipment immediately upon arrival. It is important that you notify the driver and insist on a notation of the damage. Make this notation directly on the freight company's waybill or bill of lading. Failure to note damage on the waybill or bill of lading may impede and/or prevent any claims that you may have against the freight carrier.

If missing parts or damage is found. Please notify the carrier at once and request an inspection. DO NOT DISCARD THE SHIPPING BOX. If you give the carrier a clear receipt for goods that have been damaged in transit, you do so at your own risk and expense.

TRADEMARK DISCLAIMER

BRISA is the registered trademarks of ProSpaDepot. Reproduction or reuse of part or all of trademarks are expressly prohibited without written permission from ProSpaDepot. Due to limitation of the printing process, product colors shown might look different from actual colors. ProSpaDepot will not be responsible for any misprint of this advertisement. ProSpaDepot's footspa specification and prices may change without prior notice. Pedicure Spas are intended for professional use only, always follow your State Board's sanitation and disinfectant guideline.

Table of Contents

SAFETY PRECAUTIONS:	3
Parts	
Identifying Parts for BRISA® Model	4
SPA to SPA RECOMMENDED CLEARANCE:	5
Wall Clearance:	5
MANICURE TRAY/ ARMREST / BACK REST INSTALLATION	6
Up/Down Swinging Armrest	6
Plumbing Connections	7
Power Drain (optional)	7
Gravity Drain (No Drain Pump)	8
Plumbing Flow Pattern for Power Drain	8
Plumbing Flow Pattern for Gravity Drain	9
HOT AND COLD WATER SUPPLY LINES	9
ELECTRICAL AND PEDICURE SPA COMPONENT SPECIFICATIONS.....	11
OPERATION AND CARE INSTRUCTIONS.....	12
MAGNETIC JET COVER REMOVAL & INSTALLATION	13
JET HOUSING REMOVAL & INSTALLATION	14
MASSAGE SYSTEM & REMOTE CONTROLLER.....	15
MASSAGE TOP CHAIR INSTALLATION	16
CLEANING REQUIREMENT FOR PEDICURE SPAS	17

READ AND FOLLOW INSTRUCTIONS CAREFULLY



Warning

SAFETY PRECAUTIONS:

**THIS PRODUCT IS FOR INDOOR USE ONLY
DISCONNECT POWER SUPPLY CORD BEFORE SERVICING**



This product is to be connected to a branch circuit outlet protected by a Class A GROUND FAULT CIRCUIT INTERRUPTER (GFCI), and the GFCI shall be tested regularly for continued protection and correct operation. If a Class A GFCI protected outlet is not available, **DO NOT USE THIS PRODUCT!** Please contact a licensed electrician for installation of a Class A GFCI according to local electric codes, or equivalent.



Warning

DO NOT USE if you are diabetic, have poor circulation, or if any area of your feet or legs is inflamed or has an open sore. Consult your physician before using if you have any kind of fungal infection, swelling, fracture or persistent pain.

Warning

**TO REDUCE RISK OF INJURY, DO NOT PERMIT CHILDREN TO USE
THIS UNIT UNLESS THEY ARE CLOSELY SUPERVISED AT ALL TIME**



Warning

- LIRE LES INSTRUCTION DU FABRICANT AVANT DE METTRE EN MARCHÉ
- UTILISER SEULEMENT A L'INTERIEUR
- COUPER LE COURANT AVANT DE PROCEDRE AU DEPANNAGE, AU NETTOYAGE



1. Excessive water temperature is dangerous and should be checked BEFORE use.
2. Maximum temperature of the water should never exceed 100 degrees F.
3. DO NOT STEP/ STAND IN FOOT BASIN.
4. Always enter and exit the Pedicure Spa slowly and carefully.
5. NEVER bring and / or operate any electrical devices into or near the Pedicure Spa.
6. Maximum load in spa chair is 250lbs (114kg).
7. Do not over use of bleach or it will damage the spa , 1 teaspoon of 5.25% bleach for each gallon of water is recommended.

STATES' NOTICE

In the common wealth of most of the States, all pedicure spas shall be installed for Commercial usage in the states, are required to have backflow preventer. This equipment shall be installed between the water inlets and the spa at Salon's cost.

PLEASE SAVE THESE INSTRUCTIONS FOR FUTURE REFERENCE

Identifying Parts for BRISA® Model
(Pedicure Whirlpool with Massage System)

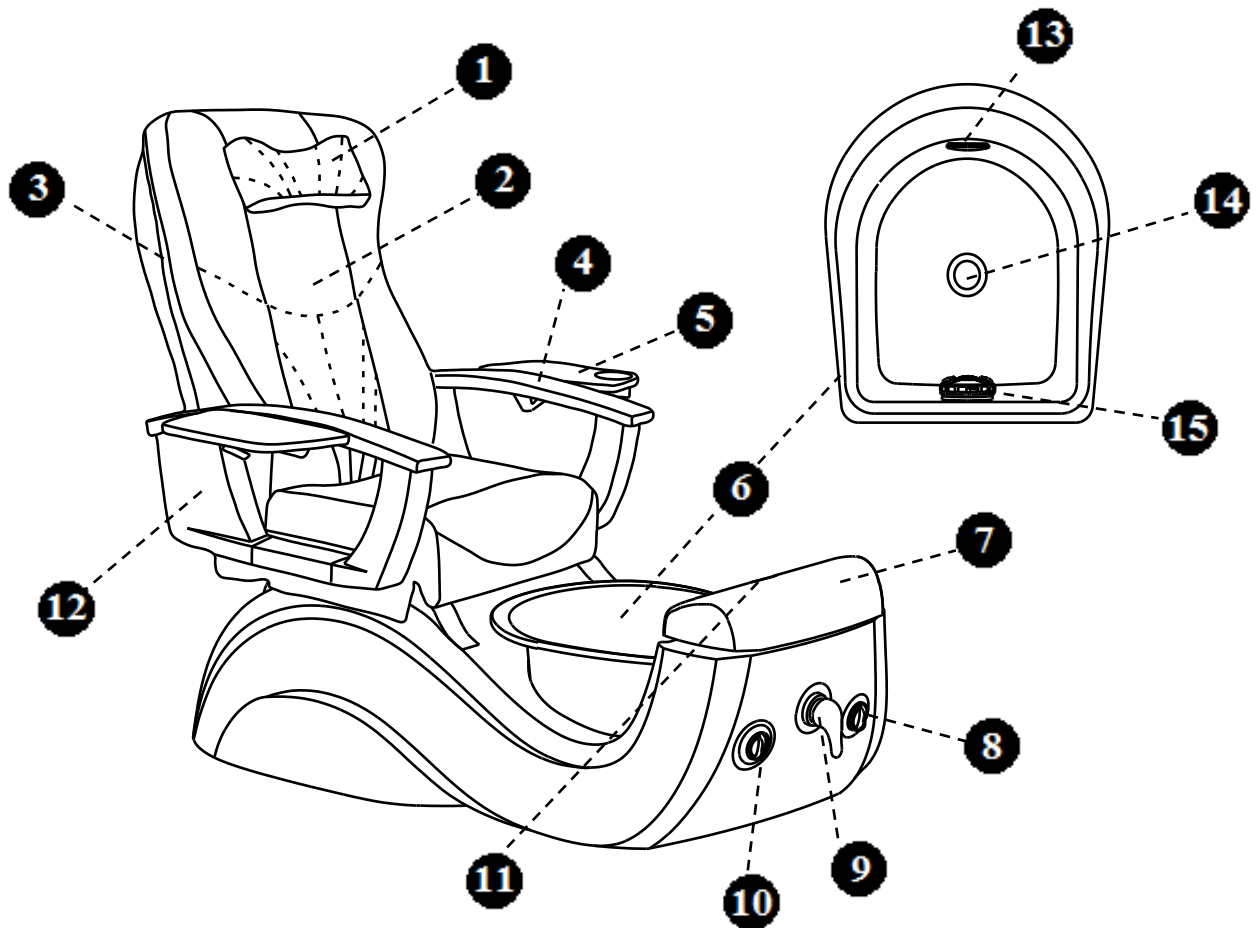

- 1. Head Rest
- 2. Chair Cushion with Massage
- 3. Massage Remote Control
- 4. Armrest Wood
- 5. Manicure-Tray (Optional)

- 6. Angelic Bowl
- 7. Footrest
- 8. Jet On/Off Knob
- 9. Hot/Cold Water Mixer Valve.
- 10. Sani-Drain™ System with Discharge On/Off Knob

- 11. Flex Water Filler/Spray Spout
- 12. Up/Down Armrest
- 13. Tub Light
- 14. Drain Stopper
- 15. Ecojet™ Jet

SPA to SPA RECOMMENDED CLEARANCE:

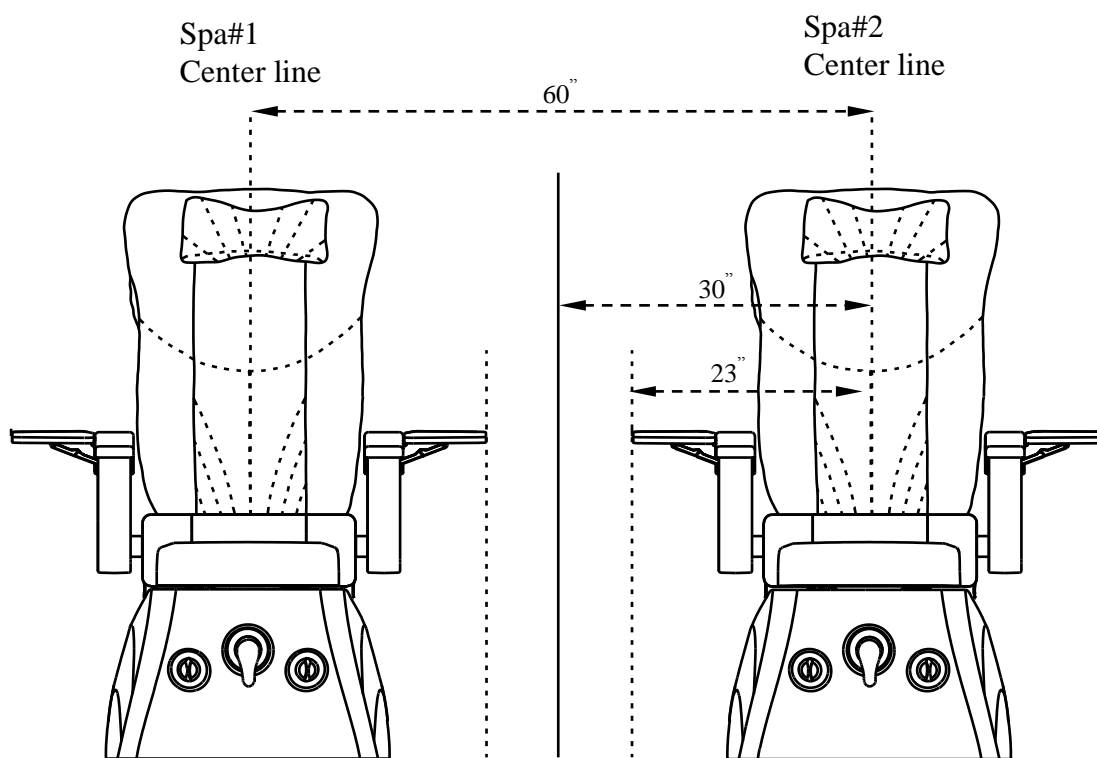

Wall Clearance:

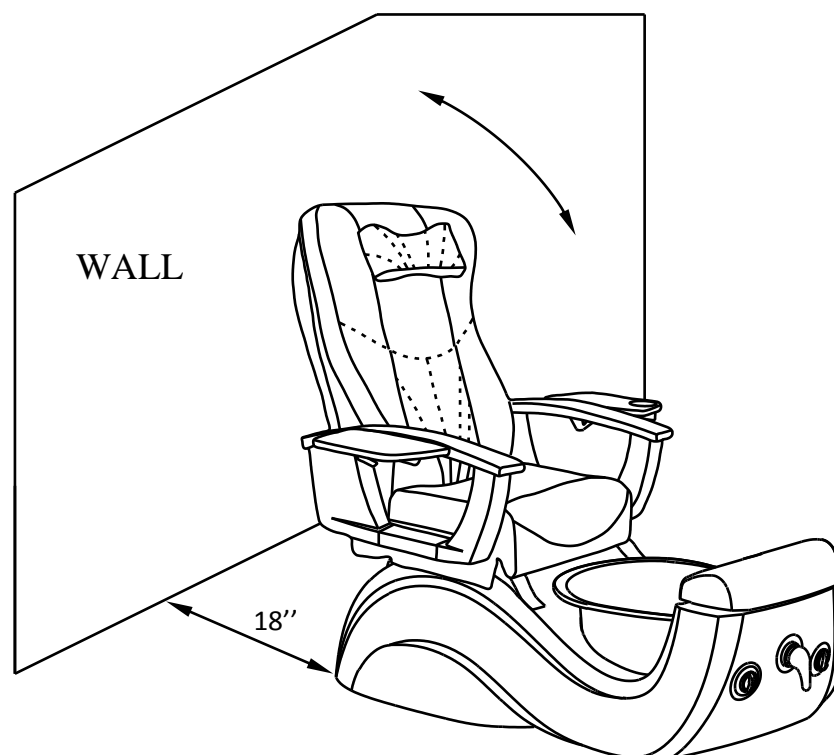

MANICURE TRAY/ ARMREST / BACK REST INSTALLATION

Up/Down Swinging Armrest, Manicure tray up and down

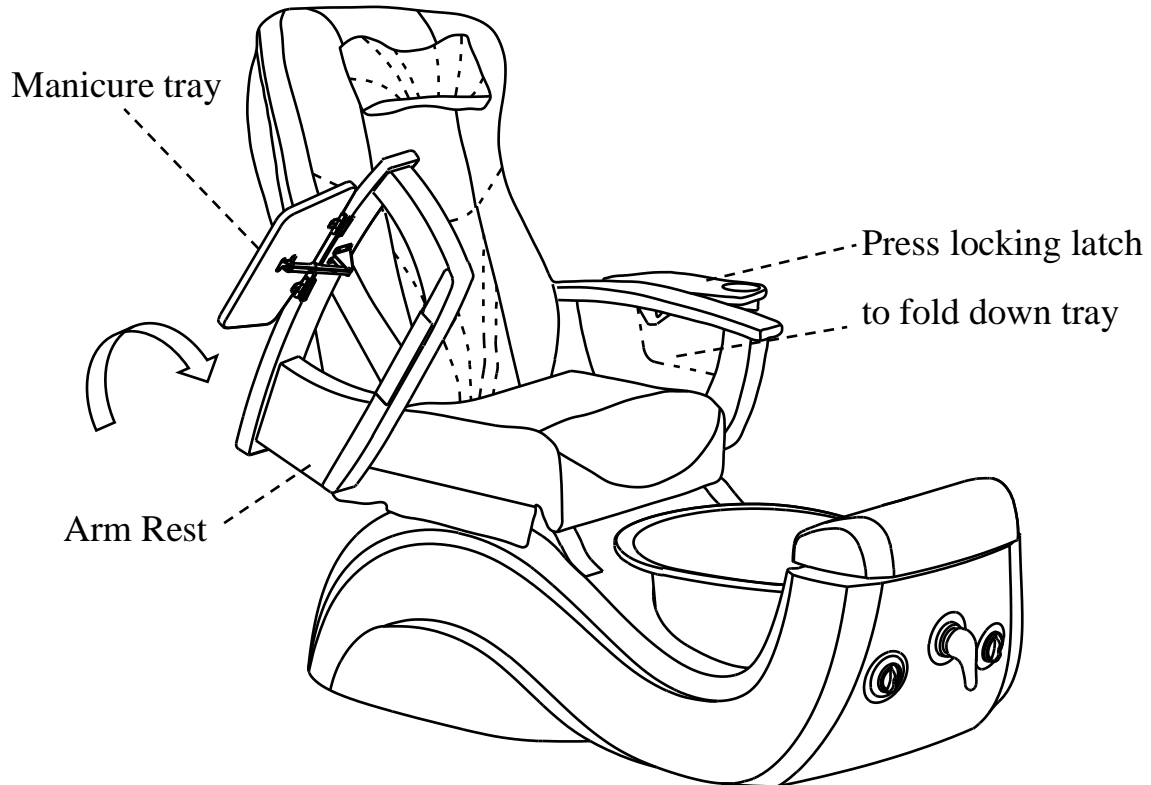

Back Rest:

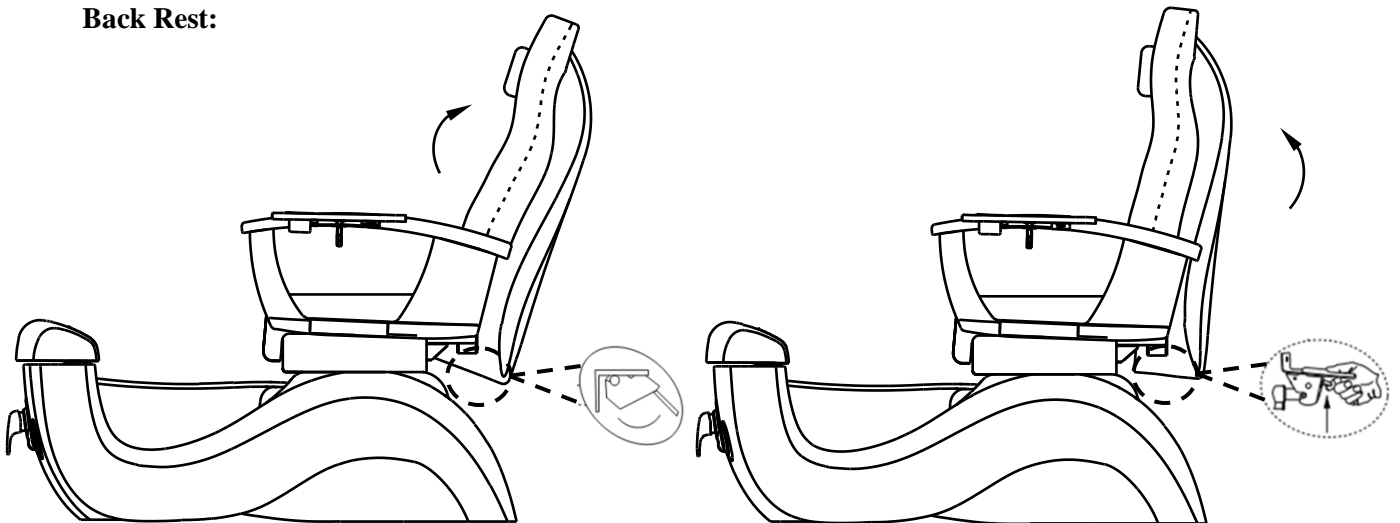

1. To set backrest up: Lift up the backrest until a "Click" is heard. Make sure the lever is locked before operating.
2. To fold down backrest: Lift up lever handle located on the left side / bottom of Chair.

Plumbing Connections:

Warning Before any connection, pay attention to these subjects:

1. Debris or residue may become lodged into the Hot and Cold hoses during construction, which may clog the Hot and Cold Mixer. To clean, drain a good amount of water from water hoses to bucket before connecting them to the pedicure spa. Failure to do so may void your Warranty.
2. Hooking up a used Hot/Cold flex hose is not recommended since debris from broken rubber seal might clog water mixer. Failure to do so may void your Warranty.
3. Backflow preventer: Due to differences in construction lay-out of your Salon and City's plumbing code, please contact your local Plumber to fulfill your needs as required. Backflow Preventers are not supplied by the pedicure spa manufacturer.
4. Check valve is an optional part and supplied free of charge for your convenience. Factory is not liable for this Check valve.
5. Maximum Inlet water pressure must be under 75 PSI.

Power Drain (optional):

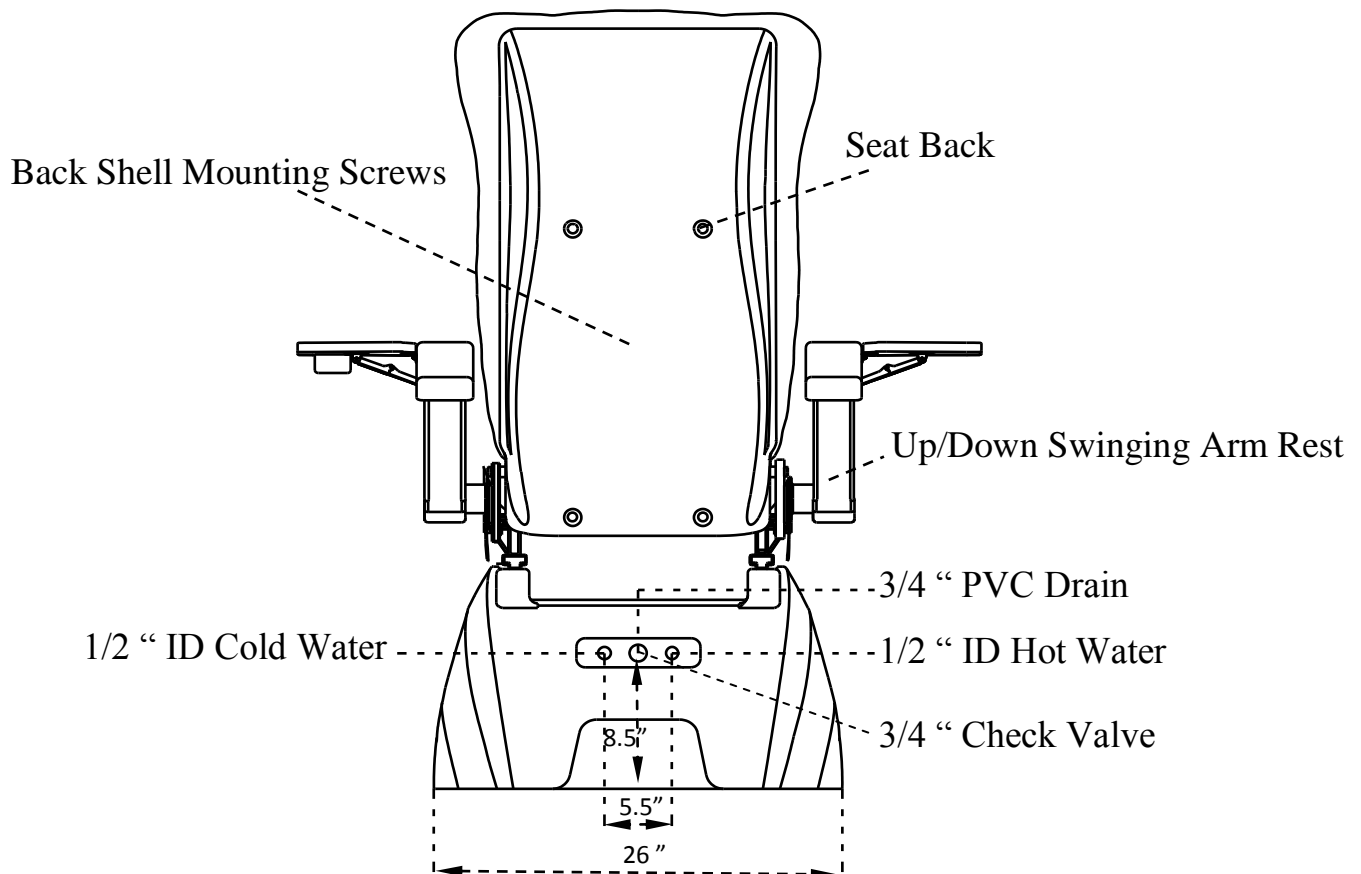

Gravity Drain (No Drain Pump):

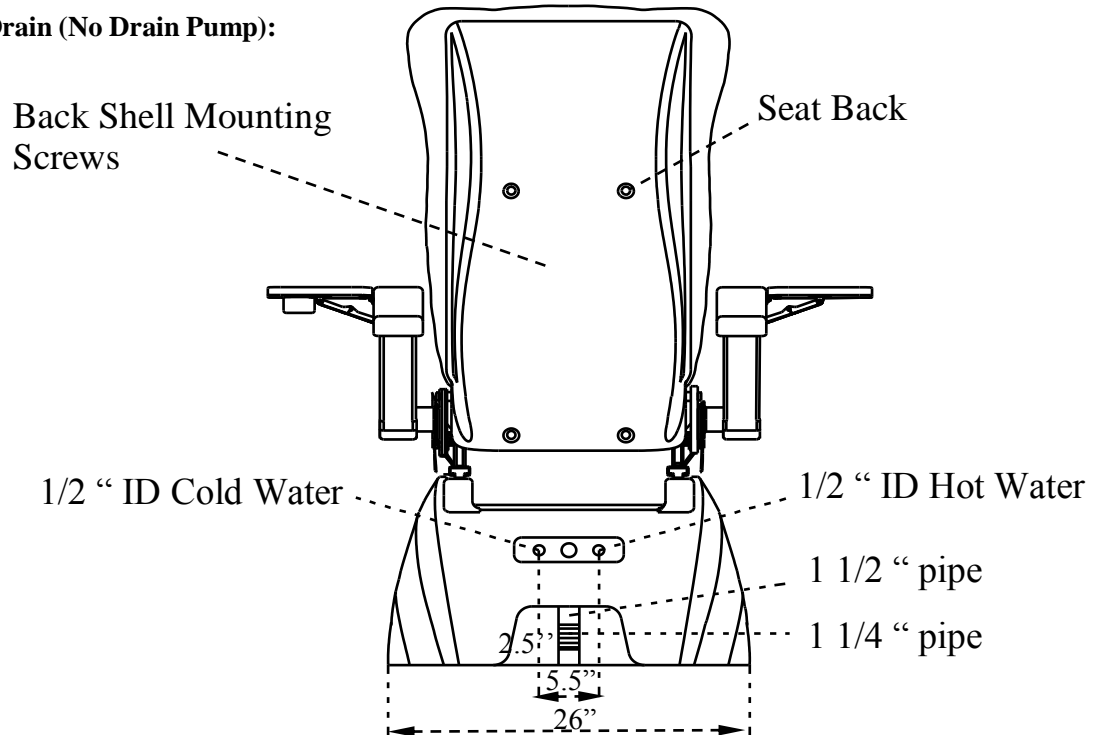

Plumbing – Flow Pattern – Power Drain

Hot/Cold water Inlet & Back-Flow Preventer (Not Included)
Optional as required by Local city Plumbing Code

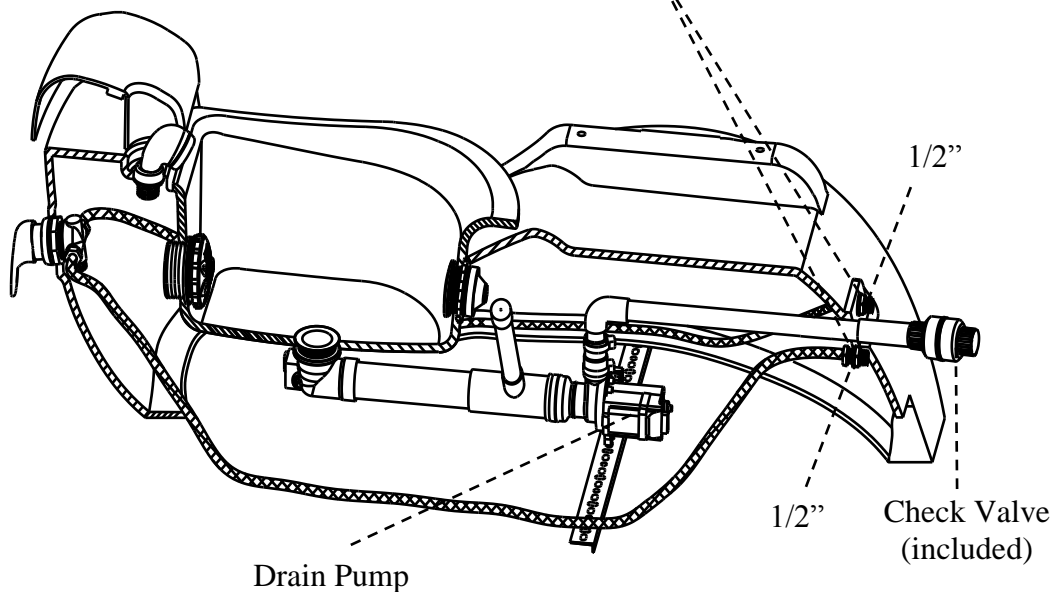

Plumbing – Flow Pattern – Gravity

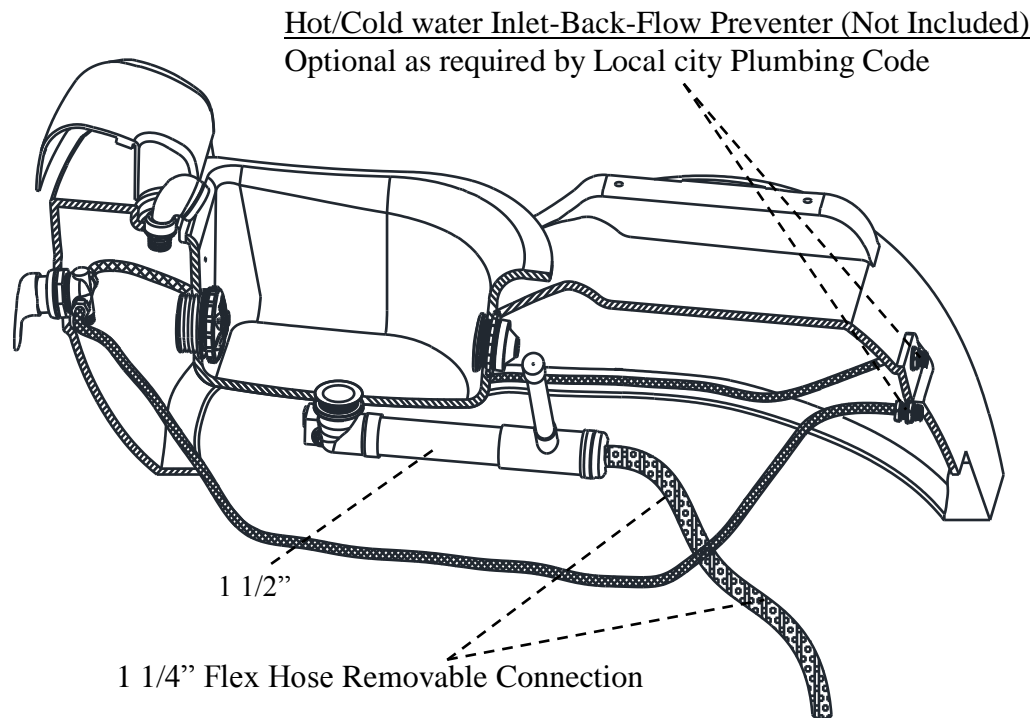

HOT AND COLD WATER SUPPLY LINES

Carefully connect $\frac{1}{2}$ " ID supply hoses (not provided) to fresh water sources. Shut-off valves (not provided) should be utilized. Valves should be placed outside the tub for easy access.

Before water line connections, please follow below:

Determine if your spa chair is used for a new construction of a salon or a replacement spa chair.

1. New construction: Make sure to remove any and all debris and/or dust from current hot cold water pipes before hooking up to spa. Suggested direction to remove debris: turn on water and drain into a bucket or container. See illustration below:

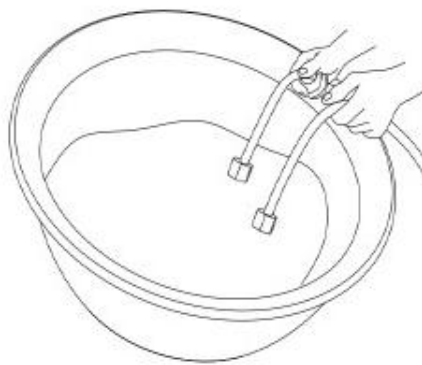

2. Replacement Spa: Always use new hot/cold water hoses when connecting a new spa chair to prevent debris, such as old rubber particles from clogging the system

CONNECT DRAIN WITH POWER DRAIN (PUMP) OR GRAVITY DRAIN (NO PUMP)

Using $\frac{3}{4}$ " schedule 40 PVC (Power Drain) or $1\frac{1}{4}$ " flex tube (Gravity Drain) and appropriate traps.
 Connect drain to meet local plumbing codes.
 Rubber connection to the drain should be removable for easy service and should not be permanent to prevent damages.

Drain System Recommendation

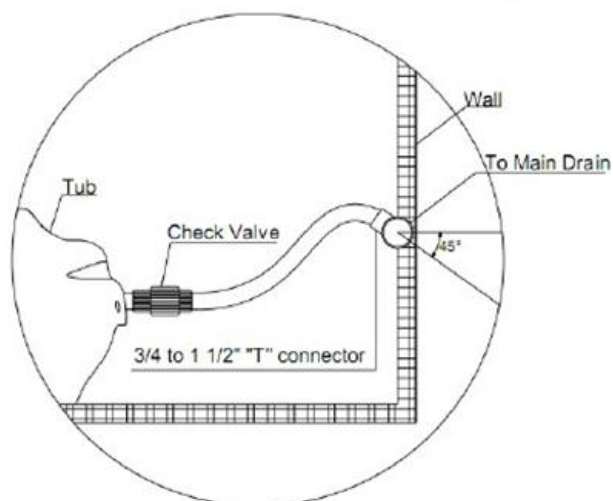
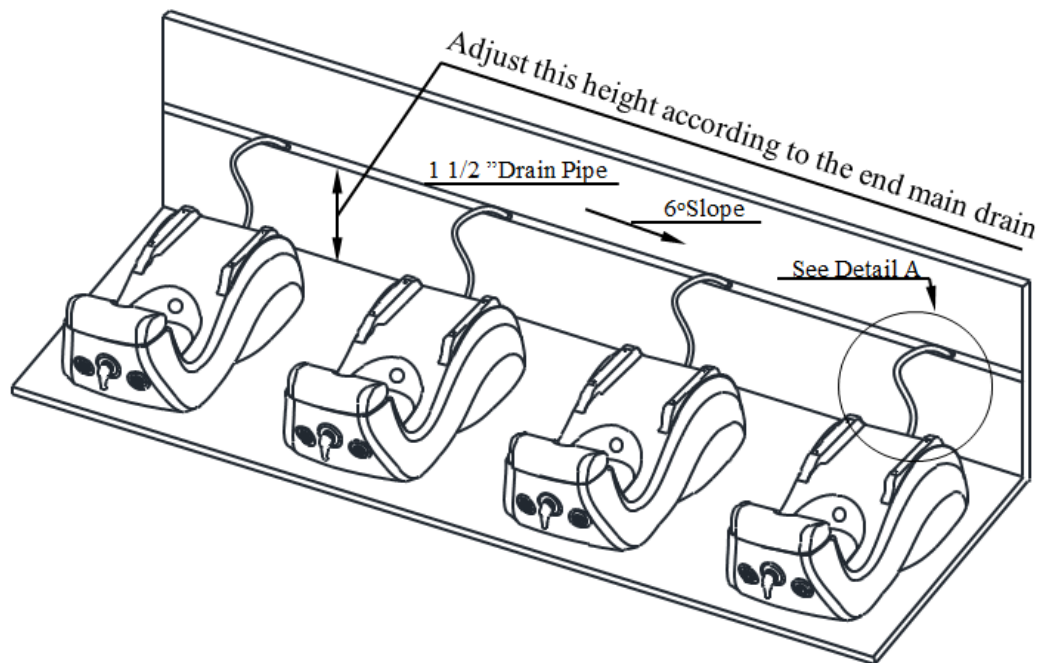

Detail A

ELECTRICAL AND PEDICURE SPA COMPONENT SPECIFICATIONS

All electrical connections **MUST** be made by a qualified, licensed electrician in accordance with Local & National Electrical and Building Codes. A 110V-50/60 Hz, 15 Amp, GFCI protected grounded circuit **MUST** be used to supply power to the Pedicure Spa. A dedicated circuit must be used with a GFCI. All wiring must conform to National & Local Electrical Codes.

WARNING: IT IS EXTREMELY IMPORTANT THAT THE FOOT SPA OPERATES WITH GFCI PROTECTION

VERY IMPORTANT Both back of chair and seat are adjustable. When both are at maximum positions one must allow 18"(44cm) from back wall to foot spa. This minimum distance assures unobstructed recline. Failure to follow this required dimension might damage your spa components and plumbing connections, which will void your warranty.

PEDICURE SPA SPECIFICATIONS:

Construction: Marble composite, high gloss, acetone-proof gel coat.
 Two (2) electro-mechanical knobs control the drain and whirlpool.
 Electro-mechanically operated reclining, massaging, and sliding seat with hand held control.
 One (1) pipe-less whirlpool jet. (Pipe-free technology)
 Power drain (optional) or Gravity drain (no drain pump)
 Extendable water spray positioned well above water line, air gap is accommodated with back-flow prevention required by plumbing code
 Armrest swing up / down.

SPECIFICATIONS

Spa Dimensions & Weights	BRISA = 30" (W) x 55" (L) All Models fully reclined: 74" (L). With Manicure Tray Installed: 46" (W) Empty Weight: ~ 200 lbs. Shipping Weight: ~ 260 lbs.
Adjustable Stool Height	Pedicure Stool: 12" – 13".
Spa Water Capacity	~ 4-5 US Gallon
Jet Motor	120 VAC. at 85W 60Hz
Massage Motors, Seat Sliding & Reclining	24VDC, 2.5A x 5
Discharge Pump	Motor – 120V at 85W 60 Hz Maximum vertical lift: 3ft . Flow rate 500 GPH @ floor level
Power source	115 VAC, 60HZ. Power needed per spa chair = 6 Amp
Electrical Switches	One (1) electro-mechanical knob for the Whirlpool. Rated at 5A contact. One (1) electro-mechanical knob for the Drain. Rated at 5A contact.
Plug & Play Installation	Installation should be made with connection at the external interface parts. Please consult with your local plumber.
Safety	BRISA® Pedicure Spa is UL listed.

OPERATION AND CARE INSTRUCTIONS

Filling Water Close the Drain Stopper by turning the Drain Knob counterclockwise. Utilizing the single lever hot/cold mixer faucet located on the front of the Pedicure Spa, fill the tub to the water level above the whirlpool jet at least 1 inch. You must completely submerge the jet. If during the operation of the whirlpool, the water level decreases, simply add more water.

Whirlpool Starting

Turn the Jet Knob located on the right side of the front panel to clockwise to turn on.
Turn counterclockwise to shut off.

Warning : Do NOT turn "ON" the JET PUMP KNOB unless adequate water is in the tub.
THE WARRANTY IS VOID IF THE PUMP HAS BEEN RUNNING DRY

Draining Turn the Drain Knob clockwise to open the Drain Stopper. Power Drain will turn on automatically if drain pump exist.
a Dual Action Electro-mechanical Switch located on the left side of the front panel) When activating the switch, it will raise the drain-stopper and power up the drain pump (if exist) at the same time.

Warning Do NOT turn "ON" the DRAIN PUMP KNOB unless adequate water is in the tub.
THE WARRANTY IS VOID IF THE PUMP HAS BEEN RUNNING DRY

NOTE: Whirlpool action can cause even small amounts of soap or body oil to foam excessively. For this reason, refrain from using these products during the whirlpool cycle.

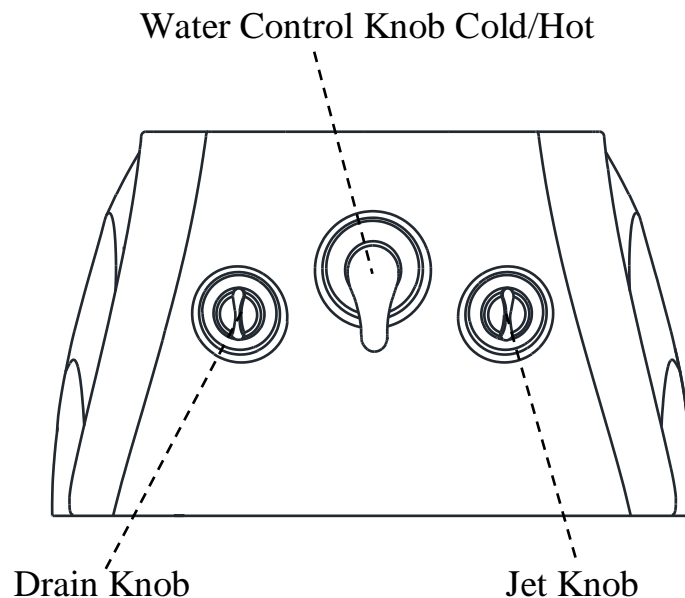

MAGNETIC JET COVER REMOVAL & INSTALLATION:

1. Turn Counterclockwise to remove. Turn Clockwise to install.

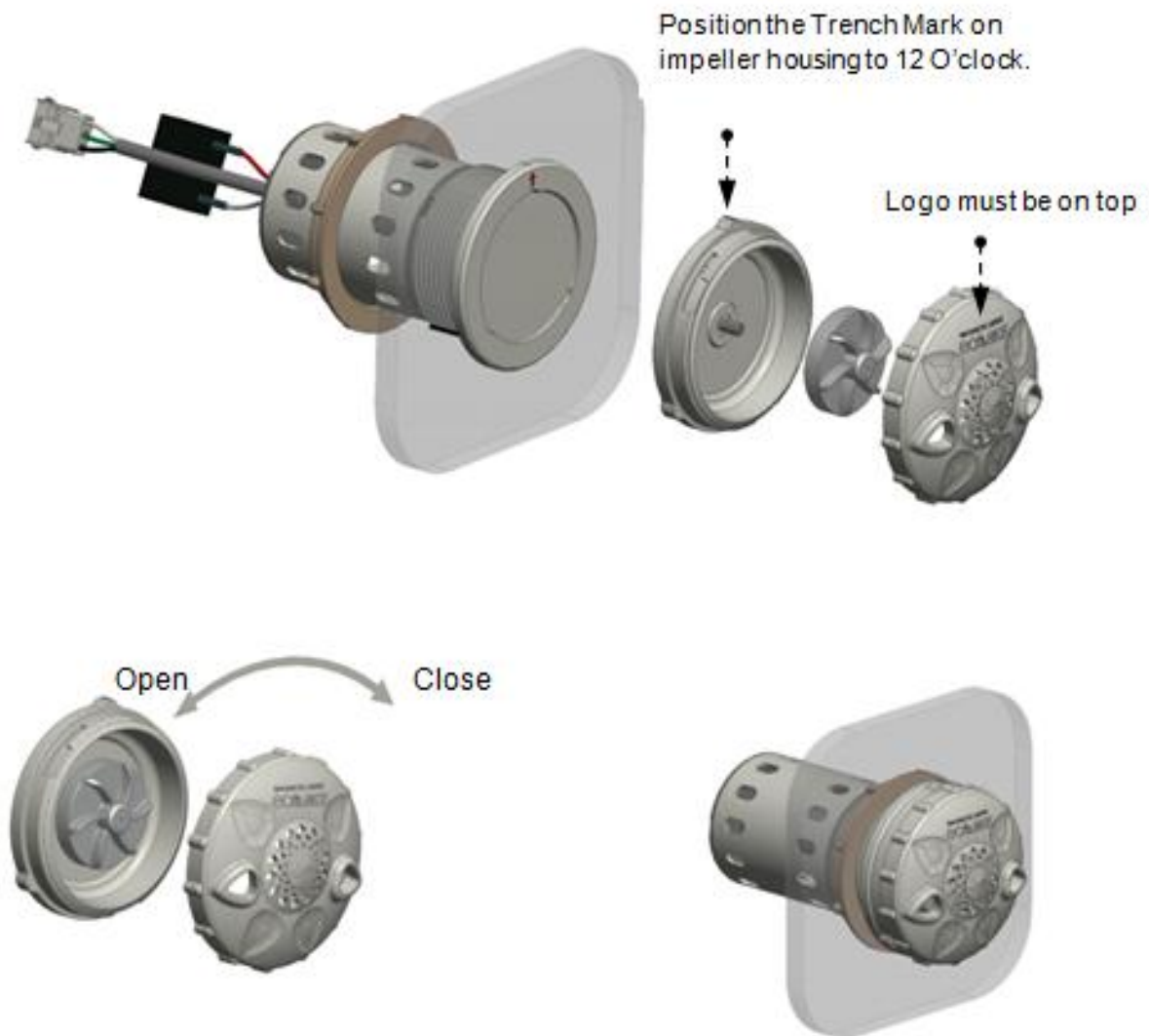

JET HOUSING REMOVAL & INSTALLATION

1. Turn clockwise to remove motor. Turn counterclockwise to install motor.

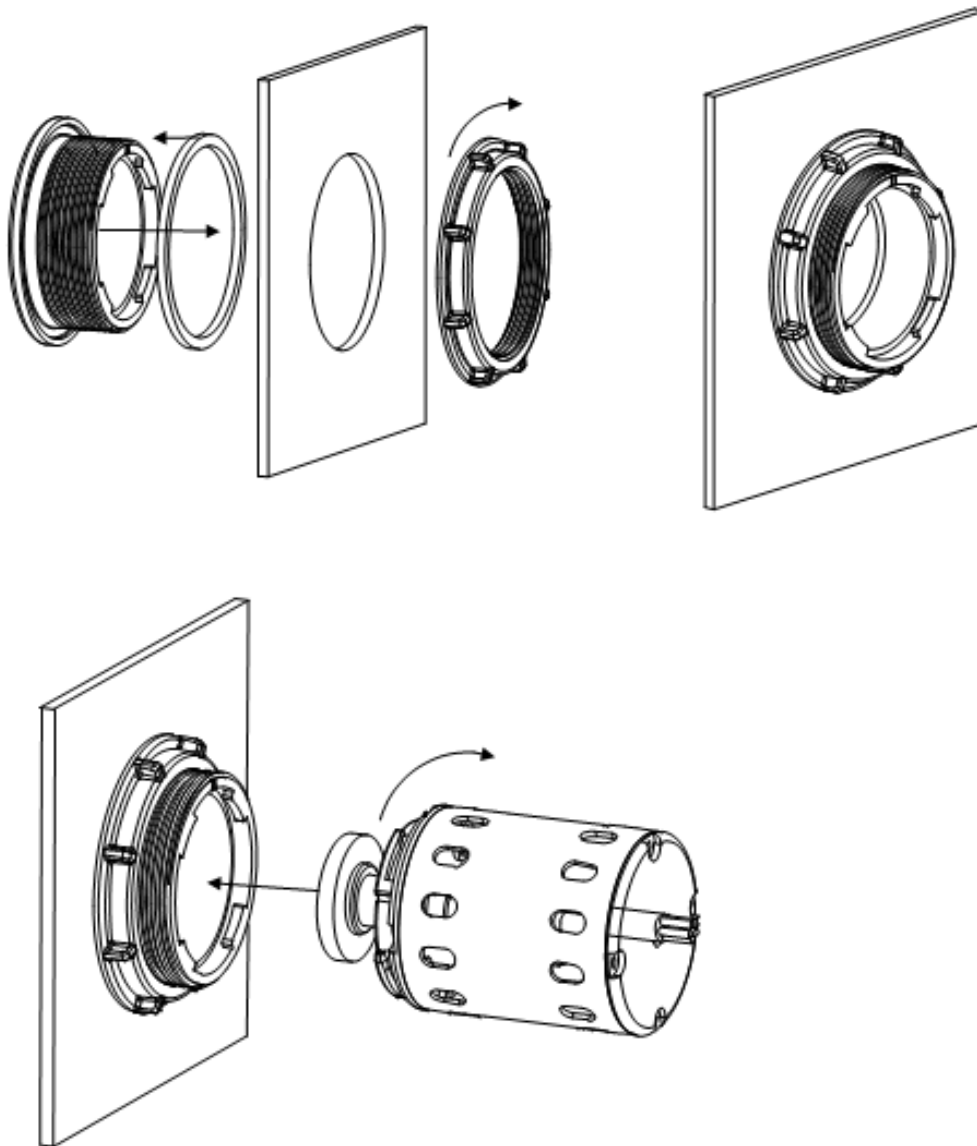

MESSAGE SYSTEM & REMOTE CONTROLLER:

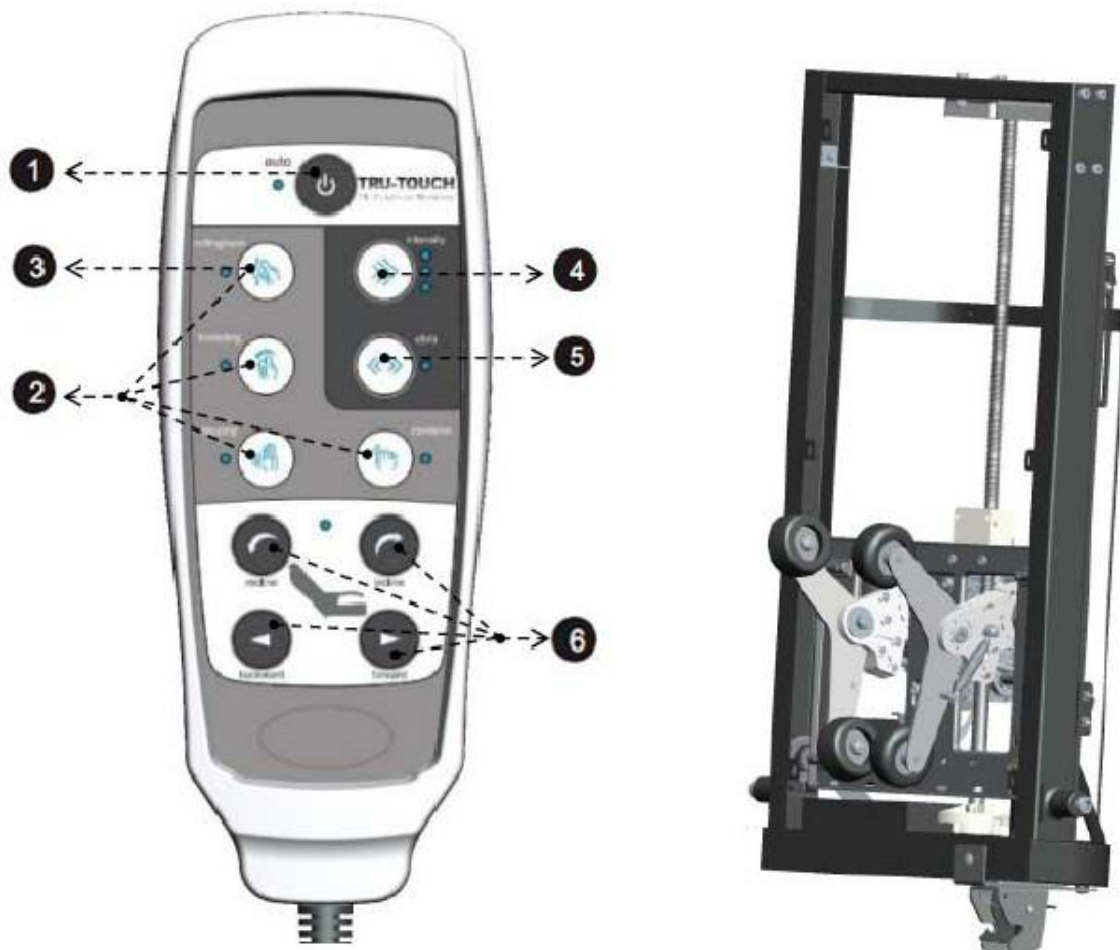

1. Press Auto Button to start Auto mode. Press again to turn off massage.
Auto and Manual mode will run for duration of 15min.
2. Press any button (Rolling/Spot, Kneading, Tapping, Combine) to enter Manual mode.
3. Press Rolling/Spot to stop rolling up/down and stop at desired spot.
4. Press Intensity button to select tapping intensity.
5. Vibro Button/LED is an option. Pressing this button will resume with Tapping action.
6. Press any chair button (Recline, Incline, Backward, Forward) to move the chair to desired positions.

NOTE : If the Massage Chair is not provided, then the end-user will need to install a UL listed and cUL/CSA certified massage chair with a suitable Class 2 Power Supply.

TOP MESSAGE CHAIR BASIC INSTALLATION INSTRUCTIONS:

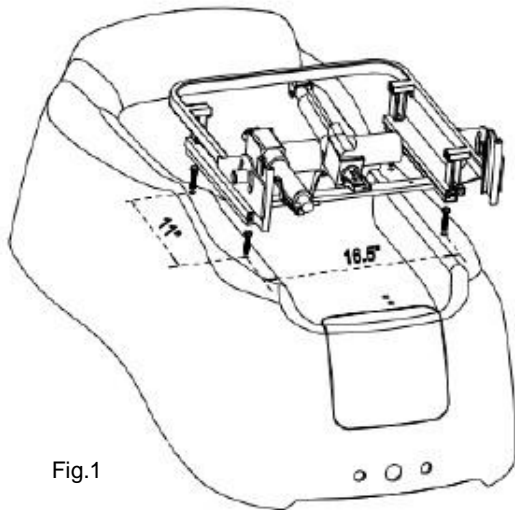

Fig.1

Drill 4 mounting holes $\frac{1}{2}$ " Width=16.5"
Length=11". Install seat frame and secure 4
screws from bottom base. Using the provided
stand-off blocks to adjust the height of seat frame as
needed to allow seat frame to travel freely.

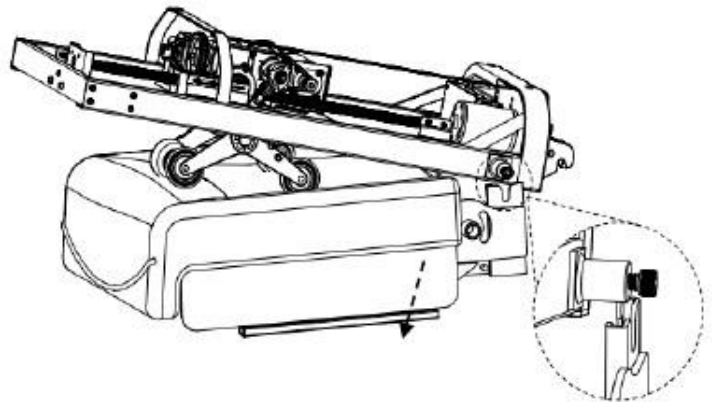

Fig.2

Install seat cushion with 2 screw-Knobs
Lever the back massage and secure 2 hinge
screws onto the metal brackets.(Do not turn
the screws all the way in)
Leave $\frac{1}{4}$ " thread screw head for sliding
Install back shell with 4 screws as Fig.3

Lift up back massage to engage
locking device. (Manually adjust
actuator rod to lock as needed)
Install back cushions.
Plug AC cord to power strip
Located inside of the tub base.

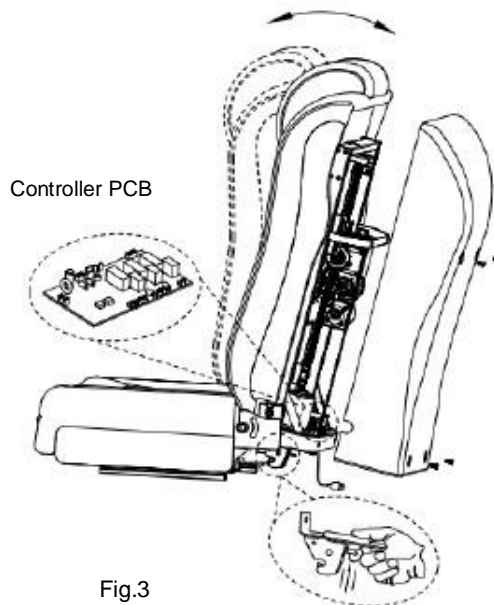

Fig.3

**WARNING**

You must always refer to your state or local guidelines for cleaning requirements. Overnight soaking with overdosed Chlorine may damage rubber part in basin

CLEANING PROCEDURE IS REQUIRED BY STATE BOARDS

Note: *** A cleaning log should be kept with each pedicure spa ***

Each State will have slight differences in cleaning policies, please check with your state's Bureau of Barbering and Cosmetology or Regulatory Authority for specific details.

Safety Requirements for Pedicure Spas

The Bureau of Barbering and Cosmetology requires that salons using whirlpool pedicure foot spas must follow these disinfecting procedures to ensure proper cleaning and maintenance of the equipment and to prevent the spread of bacterial or parasitic disease.

Violation of this section may result on an administrative fine and/or disciplinary action. Each foot spa that is not in compliance with this section may result in a separate violation.

NOTE: Authority cited: Section 7312, Business and Profession Code. Reference: Section 7312 (e), Business and Profession Code.

Below is a suggestion for your pedicure spa chair's cleaning procedure:

After Each Customer

1. All water shall be drained and all debris shall be removed from the spa basin.
2. The spa basin must be cleaned with soap or detergent and water
3. The spa basin must be disinfected with an EPA-registered disinfectant with demonstrated bactericidal, fungicidal, and virucidal activity, which must be used according to manufacturer's instructions.
4. The spa basin must be wiped dry with a clean towel.

At the End of Each Day

1. The screen shall be removed, all debris trapped behind the screen shall be removed, and the screen and the inlet shall be washed with soap or detergent and water.
2. Before replacing the screen, the screen shall be totally immersed in an EPA-registered disinfectant with demonstrated bactericidal, fungicidal and virucidal activity, which must be used according to the manufacturer's instructions.
3. The spa system shall be flushed with low sudsing soap and warm for at least 10 minutes, after which the spa shall be rinsed and drained.

At Least Once A Week

1. The spa basin shall be filled completely with warm water and 1 teaspoon of 5.25% bleach for each gallon of water, or a solution of Sodium Hypochlorite of approximately 50ppm used according to manufacturer's instructions.
2. The spa system shall be flushed with the bleach and water solution, or Sodium Hypochlorite solution, for 5-10 minutes and allowed to sit for 6-10 hours.
3. The spa system shall be drained and flushed with water before use upon a patron.