

PEDICURE SPA USERMANUAL

Before Operating the unit, please read this manual thoroughly and retain it for future reference

RECEIVING AND INSPECTION:

PLEASE TAKE NOTE! Thoroughly inspect each shipment immediately upon arrival. It is important that you notify the driver and insist on a notation of the damage. Make this notation directly on the freight company's waybill or bill of lading. Failure to note damage on the waybill or bill of lading may impede and/or prevent any claims that you may have against the freight carrier.

If missing parts or damage is found. Please notify the carrier at once and request an inspection. **DO NOT DISCARD THE SHIPPING BOX.** If you give the carrier a clear receipt for goods that have been damaged in transit, you do so at your own risk and expense.

TRADEMARK DISCLAIMER

LUXE is the registered trademarks of Spatech, Inc. Reproduction or reuse of part or all of trademarks are expressly prohibited without written permission from Spatech, Inc. Due to limitation of the printing process, product colors shown might look different from actual colors. Spatech will not be responsible for any misprint of this advertisement. Spatech's footspa specification and prices may change without prior notice. Pedicure Spas are intended for professional used only, always follow your State Board's sanitation and disinfectant guideline.

RECEIVING AND INSPECTION:	1
SAFETY PRECAUTIONS:	3

PARTS

Identifying Parts for LUXE Model	4
----------------------------------------	---

INSTALLATION

Spa to Spa Recommended Clearance:	5
Wall Clearance:	6
Manicure Tray/ Armrest / Back Rest Installation	8
Up/Down Swinging Armrest:	9
Back Rest:	9
Plumbing Connections:	10
Power Drain:	10
Gravity Drain (Under Ground):	12
Plumbing Flow Pattern for Power Drain:	12
Plumbing Flow Pattern for Gravity Drain:	12
Hot and Cold Water Supply Lines	12

SPA SPECIFICATION

Electrical and Pedicure Spa Component Specifications	12
------------------------------------------------------------	----

OPERATION AND CARE

Manual Operation	13
Filling	13
Whirlpool Starting	13
Draining	19
Auto Operation: (Upgraded Option)	20
Auto-Fill Models:	21
Jet Cover Removal & Installation:	22
Jet Housing Removal & Installation	23
Massage System & Remote Controller:	24
Safety Requirements for Pedicure Spas	24

WARRANTY

SPA TECH LIMITED FACTORY WARRANTY	24
-----------------------------------------	----

SAFETY PRECAUTIONS:



Warning

THIS PRODUCT IS FOR INDOOR USE ONLY
DISCONNECT POWER SUPPLY CORD BEFORE SERVICING

This product is to be connected to a branch circuit outlet protected by a Class A GROUND FAULT CIRCUIT INTERRUPTER (GFCI), and the GFCI shall be tested regularly for continued protection and correct operation. If a Class A GFCI protected outlet is not available, DO NOT USE THIS PRODUCT! Please contact a licensed electrician for installation of a Class A GFCI according to local electric codes, or equivalent.



Warning

DO NOT USE if you are diabetic, have poor circulation, or if any area of your feet or legs is inflamed or has an open sore. Consult your physician before using if you have any kind of fungal infection, swelling, fracture or persistent pain.



Warning

TO REDUCE RISK OF INJURY, DO NOT PERMIT CHILDREN TO USE THIS UNIT UNLESS THEY ARE CLOSELY SUPERVISED AT ALL TIME

- LIRE LES INSTRUCTION DU FABRICANT AVANT DE METTRE EN MARCHÉ
- UTILISER SEULEMENT À L'INTERIEUR
- COUPER LE COURANT AVANT DE PROCÉDER AU DÉPANNAGE, AU NETTOYAGE



Warning

1. Excessive water temperature is dangerous and should be checked BEFORE use.
2. Maximum temperature of the water should never exceed 100 degrees F.
3. DO NOT STEP/ STAND IN FOOT BASIN.
4. Always enter and exit the Pedicure Spa slowly and carefully.
5. NEVER bring and / or operate any electrical devices into or near the Pedicure Spa.
6. Maximum load in spa chair is 250lbs (114kg).



Warning

If a crack in the GLASS BOWL occurs, DO NOT handle unless the proper attire and equipment is used. Discontinue use of the bowl until proper equipment is replaced. You may be held accountable for any injury that may occur. Spatech, Inc. is not liable for any injury that may occur.

STATES' NOTICE

In the common wealth of most of the States, all pedicure spas shall be installed for Commercial usage in the states, are required to have backflow preventer. This equipment shall be installed between the water inlets and the spa at Salon's cost.

PLEASE SAVE THESE INSTRUCTIONS FOR FUTURE REFERENCE

Connect drain with power drain (pump)

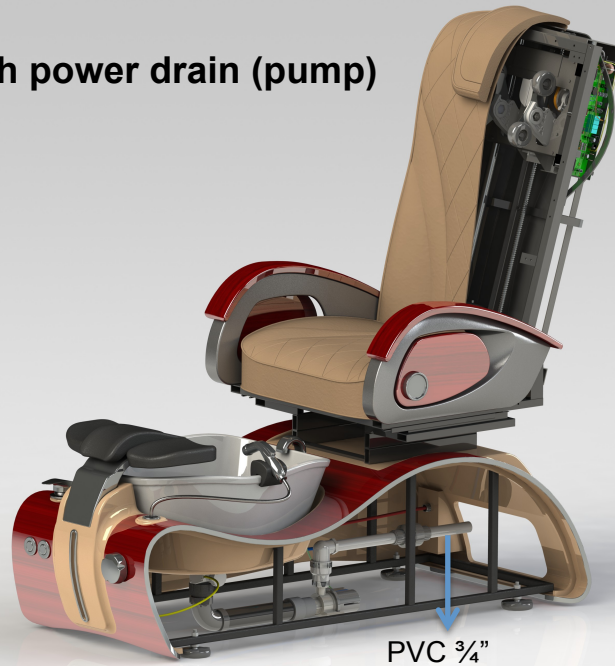

Gravity Drain (no pump)

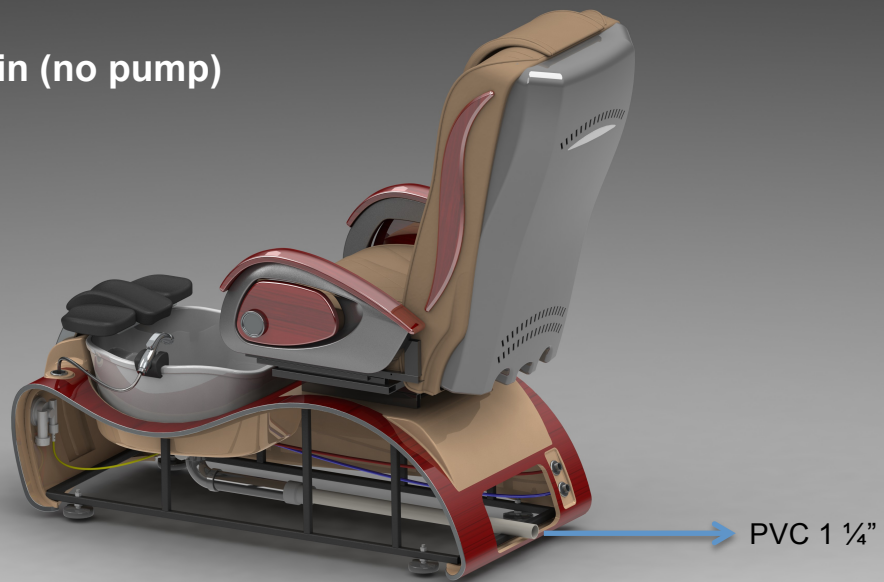

Connect drain with power drain (pump) or gravity drain (no pump)

Using $\frac{3}{4}$ " schedule 40 PVC (Power Drain) or 1 $\frac{1}{4}$ " flex tube (Gravity Drain) and appropriate P-Traps connect drain to meet local plumbing codes.

Rubber connection to the drain should be removable for easy service and should not be permanent to prevent damages.

Plumbing Flow Pattern for Gravity Drain:

*** Extra 1 1/4" Flex-hose is supplied for fast connecting to underground 1 1/2" connector

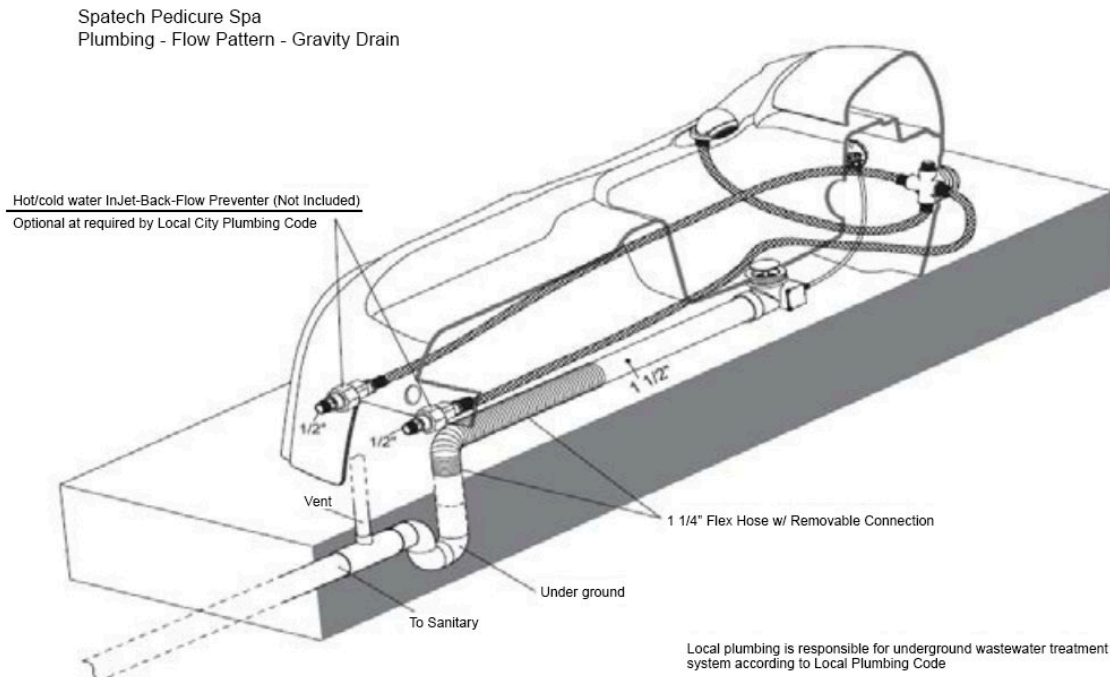

Hot and cold water supply lines

Before water line connections, please follow below:

Determine if your spa chair is used for a new construction of a salon or a replacement spa chair.

1. New construction: Make sure to remove any and all debris and/or dust from current hot cold water pipes before hooking up to spa. Suggested direction to remove debris: turn on water and drain into a bucket or container.
2. Replacement Spa: Always use new hot/cold water hoses when connecting a new spa chair to prevent debris, such as old rubber particles, from clogging drain.

*** Vaccum Breaker

Due to Town and/or State requirement/s are varies in building code, if the Town and /or State requires Vaccum Breaker, As the Plumber MUST provide Vaccum Breaker according to building code requirement.

Connect drain with power drain (pump) or gravity drain (no pump)

Using $\frac{3}{4}$ " schedule 40 PVC (Power Drain) or 1 $\frac{1}{4}$ " flex tube (Gravity Drain) and appropriate P-Traps connect drain to meet local plumbing codes.

Rubber connection to the drain should be removable for easy service and should not be permanent to prevent damages.

WALL CLEARANCE & SPA to SPA RECOMMENDED CLEARANCE SPA DIMENSION.

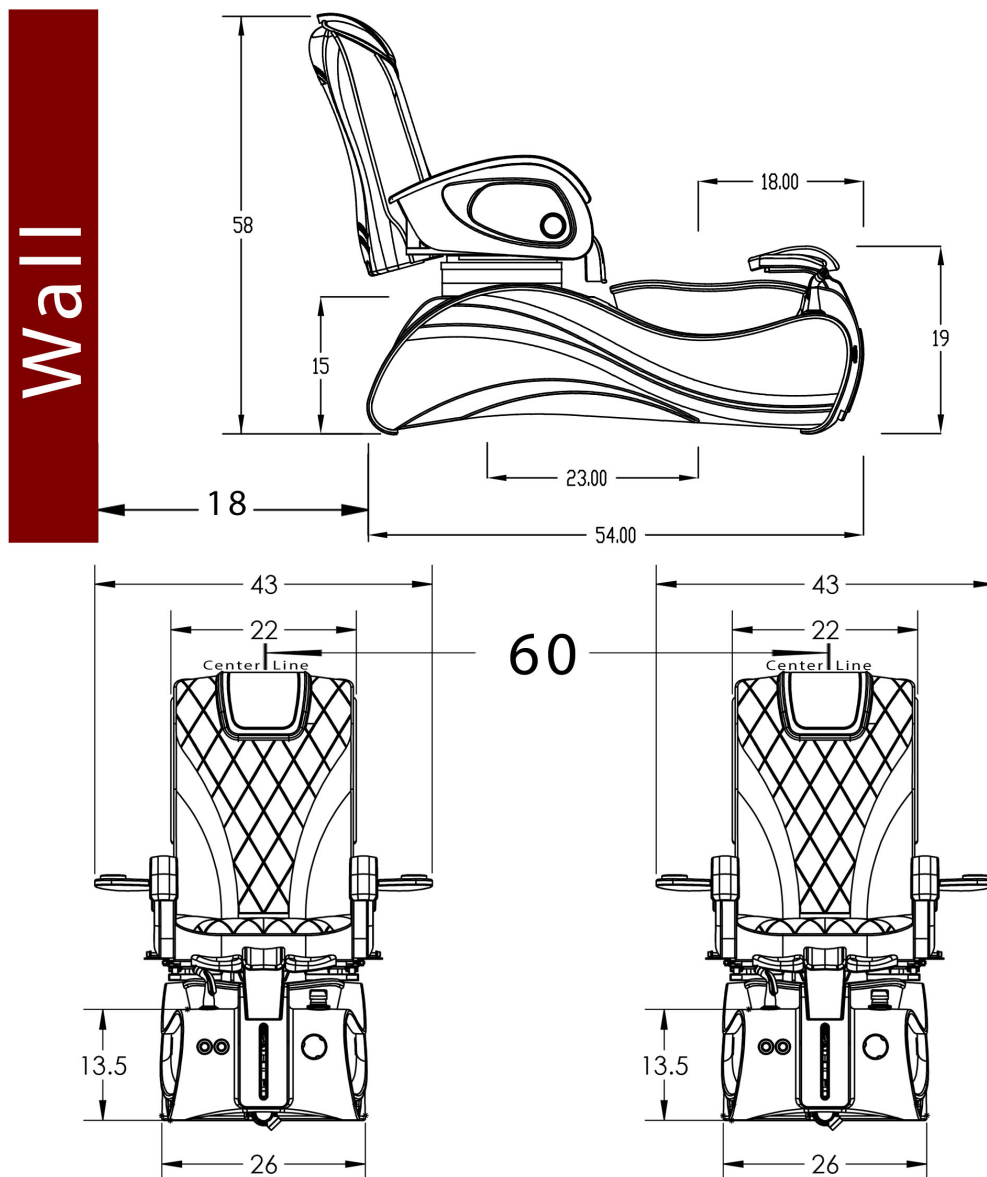

ELECTRICAL AND PEDICURE SPA COMPONENT SPECIFICATIONS

All electrical connections MUST be made by a qualified, licensed electrician, in accordance with Local & National Electrical and Building Codes. A 110V-50/60 Hz, 15 Amp, GFCI protected grounded circuit MUST be used to supply power to the Pedicure Spa. A dedicated circuit must be used with a GFCI. All wiring must conform to National & Local Electrical Codes.



Warning It is extremely important that the foot spa operates with GFCI protection

VERY IMPORTANT Both back of chair and seat are adjustable. When both are at maximum positions one must allow 18"(44cm) from back wall to foot spa. This minimum distance assures unobstructed recline. Failure to follow this required dimension might damage your spa components and plumbing connections, which will void your warranty

PEDICURE SPA SPECIFICATIONS:

- Construction: Marble composite, high gloss, acetone-resistant gel coat.
- Two (2) electro-mechanical knobs control the drain and whirlpool.
- Electro-mechanically operated reclining, massaging, and sliding seat with hand held control.
- One (1) pipe-less whirlpool jet. (Pipe-free technology)
- Power drain or Gravity drain
- Extendable water spray positioned well above water line, air gap is accommodated with back-flow prevention required by plumbing code
- Depending on pedicure spa model, arms may swing open, swing up / down or slide forward / backward.

SPECIFICATIONS	
Spa Dimensions & Weights Adjustable Stool	All Spa (seat up-right): L≈51"-52"(129-132cm), LUXE model Length = 52" (127cm) W=22"(56cm) w/ Tray ≈45"-46"(114-116cm) H=58"(147cm) *Clearance of 18" (20.32cm) needed for recline Empty Weight: ~ 220 lbs. Shipping Weight: ~ 250 lbs. Pedicure Stool: 12" – 13". Manicure Stool: 16.25" – 20"
Spa Water Capacity	~ 4.5 US Gallon
Jet Motor	120 VAC. at 85W 60Hz
Massage Motors, Seat Sliding & Reclining	24VDC, 5 Amp
Discharge Pump	Motor – 120V at 85W 60 Hz Maximum vertical lift: 3ft. Flow rate 500 GPH @ floor level
Power source	115 VAC, 60HZ, Power needed per spa chair = 6 Amp
2 Air Switches	For control, turn Whirlpool Jet and Drain
Plug & Play Installation	Installation should be made with connection at the external interface parts. Please consult with your local plumber.
Safety	SpaTech® Pedicure Spa is UL listed.

OPERATION AND CARE INSTRUCTIONS

Manual Operation (For Non Auto-Fill / Drain Models):

Filling

Close the Drain Stopper by turning the Drain Knob counterclockwise. Utilizing the single lever hot/cold mixer faucet located on the front of the Pedicure Spa, fill the tub to the water level above the whirlpool jet at least 1 inch. You must completely submerge the jet. If during the operation of the whirlpool, the water level decreases, simply add more water.

Whirlpool Starting

Turn the Jet Knob located on the right side of the front panel to clockwise to turn on. Turn counterclockwise to shut off.



Warning Do NOT turn “ON” the WHIRLPOOL JET unless adequate water is in the tub.

Draining

Turn the Drain Knob clockwise to open the Drain Stopper. Power Drain will turn on automatically if drain pump exist.



Warning Do NOT turn “ON” the DRAIN PUMP unless adequate water is in the tub. THE WARRANTY IS VOID IF THE PUMP HAS BEEN RUNNING DRY

NOTE: Whirlpool action can cause even small amounts of soap or body oil to foam excessively. For this reason, refrain from using these products during the whirlpool cycle.

WHIRPOOL JET INSTALLATION

PURE JET INSTALLATION

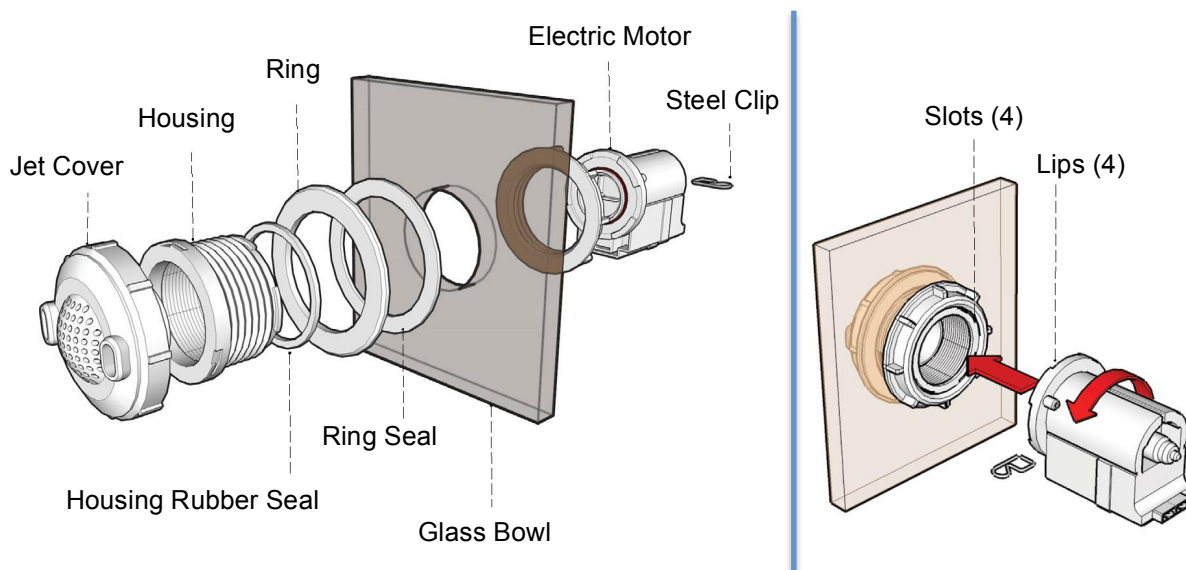

NOTE: 1. To avoid water leakage, it is essential to align lips from electric motor perfectly with slots on housing.
2. When installing motor, first apply moderate pressure to motor to engage motor lips (4) with housing slots (4), then twist motor counterclockwise until secured.

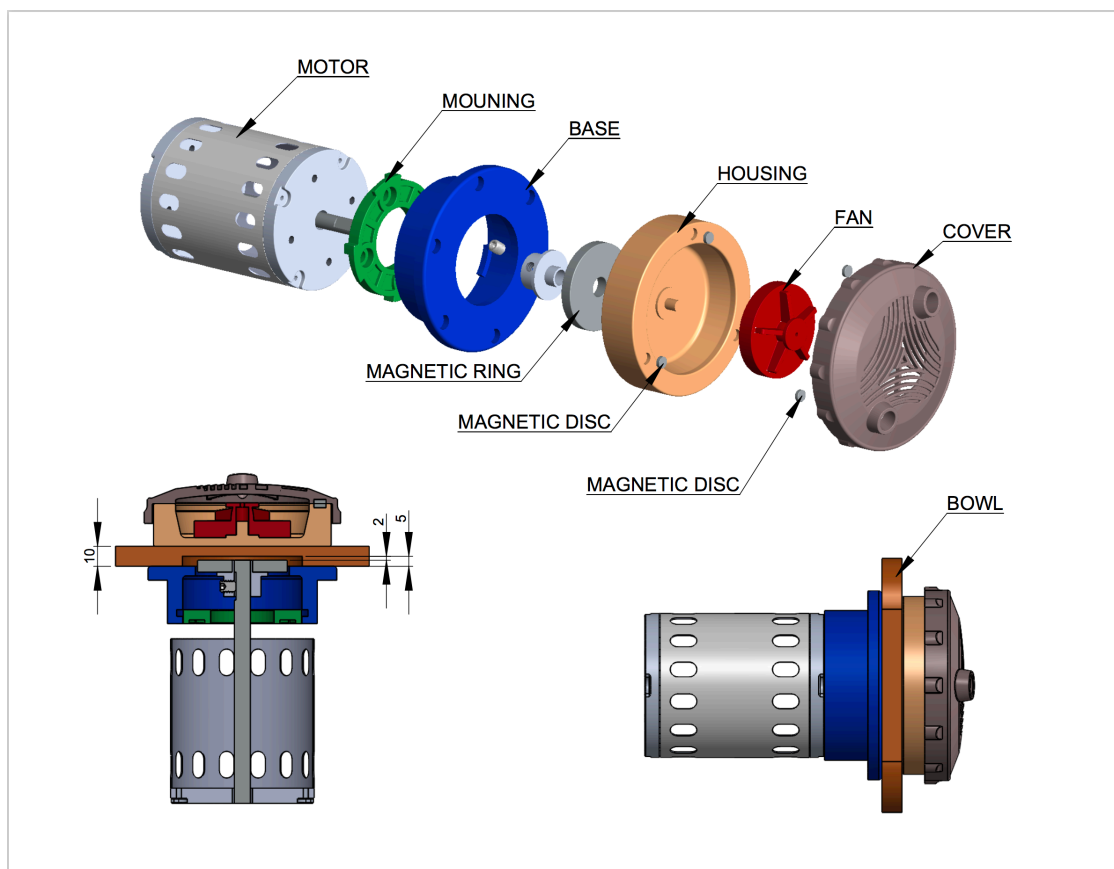

MASSAGE SYSTEM & REMOTE CONTROLLER:

1. Press Auto Button to start Auto mode. Press again to turn off massage. Auto and Manual mode will run for duration of 20min.
2. Press any button (Rolling/Spot, Kneading, Tapping, Combine) to enter Manual mode.
3. Press Rolling/Spot to stop rolling up/down and stop at desired spot.
4. Press Intensity button to select tapping intensity.
5. Button/LED is an option. Pressing this button will resume with Tapping action.
6. Press any chair button (Recline, Incline, Backward, Forward) to move the chair to desired positions.

POWER

ON/OFF

AUTO MESSAGE

Automatic program selection buttons: UPPER BODY, NECK & SHOULDER, and BACK & WAIST. Each AUTO MODE is designed for regular purpose of massage about timing, strength, and type of massage.

MANUAL MESSAGE

Manual massage selection buttons: KNEAD, FLAP, KNEAD&FLAP, PRESS, KNOCK, and BACK STRETCHING. Each MANUAL MODE can adjust SPEED and WIDTH.

SEAT ADJUSTMENTS

Chair can adjust

- Up and Down with RECLINER
- Backward and forward with SLIDER



TIMING

Manual time setting for
10 / 20 / 30 minutes

BACK STRETCHING

It has Weak / Medium / Strong
to choose.

SPEED

It has Slow / Fast / Fastest

WIDTH

It has 3 different types:
Out / Regular / In

You must always refer to your state or local guidelines for cleaning requirements.
Overnight soaking with overdosed Chlorine may damage rubber part in basin

CLEANING PROCEDURE IS REQUIRED BY STATE BOARDS

Note: * A cleaning log should be kept with each pedicure spa *****

Each State will have slight differences in cleaning policies, please check with your state's Bureau of Barbering and Cosmetology or Regulatory Authority for specific details.

Safety Requirements for Pedicure Spas

The Bureau of Barbering and Cosmetology requires that salons using whirlpool pedicure foot spas must follow these disinfecting procedures to ensure proper cleaning and maintenance of the equipment and to prevent the spread of bacterial or parasitic disease.

Violation of this section may result on an administrative fine and/or disciplinary action. Each foot spa that is not in compliance with this section may result in a separate violation.

NOTE: Authority cited: Section 7312, Business and Profession Code. Reference: Section 7312 (e), Business and Professions Code.

Below is a suggestion for your pedicure spa chair's cleaning procedure:

After Each Customer

1. All water shall be drained and all debris shall be removed from the spa basin.
2. The spa basin must be cleaned with soap or detergent and water
3. The spa basin must be disinfected with an EPA-registered disinfectant with demonstrated bactericidal, fungicidal, and virucidal activity, which must be used according to manufacturer's instructions.
4. The spa basin must be wiped dry with a clean towel.

At the End of Each Day

1. The screen shall be removed, all debris trapped behind the screen shall be removed, and the screen and the inlet shall be washed with soap or detergent and water.
2. Before replacing the screen, the screen shall be totally immersed in an EPA-registered disinfectant with demonstrated bactericidal, fungicidal and virucidal activity, which must be used according to the manufacturer's instructions.
3. The spa system shall be flushed with low sudsing soap and warm for at least 10 minutes, after which the spa shall be rinsed and drained.

At Least Once A Week

1. The spa basin shall be filled completely with warm water and 1 teaspoon of 5.25% bleach for each gallon of water, or a solution of Sodium Hypochlorite of approximately 50ppm used according to manufacturer's instructions.
2. The spa system shall be flushed with the bleach and water solution, or Sodium Hypochlorite solution, for 5-10 minutes and allowed to sit for 6-10 hours.
3. The spa system shall be drained and flushed with water before use upon a patron.

SPATECH LLC WARRANTY

LIMITED COVERAGE:

All parts are solely repaired or replaced, at Spatech's option, any evaluated defects in workmanship, except the strictly excluded conditions below. Labor, shipping and return shipping are not included. Spatech reserves the rights to send out new or equivalent to new as replacements.

Spatech shall have no obligation to repair, replace, or refund until the verification process by Spatech is completed.

Spatech's limited warranty applies only to Spatech Pedicure Spas utilized in the United States.

This limited warranty is not transferrable. Furthermore, this limited warranty is void if removed from its place of initial shipment.

**Spa Tub: Shipping or return shipping cost of spa tub is not included in the limited warranty.*

**Pedicure Stool, Manicure Stool and Customer Chair: 1-Yr warranty on adjustable hydraulic and wheels from the date of shipment. No warranty on Upholstery and any other parts not listed.*

WARRANTY:

Claims of damages or any missing parts must be made within 48 hrs (business day) after receiving the furniture by calling our Customer Care and opening a case. Image(s) of the damage(s) and a signed Bill of Lading must be submitted. Spatech will not cover any missing part or damage claims after 48 hrs.

WHAT IS NOT COVERED:

Mishandling, damages from shipping, expenses from returning eligible defectives to factory, improper installation, abuse, misuse, neglect, accidental events, freight damages, damage resulting from a person standing in the Pedicure Spa's basin or other similar stress to that basin, normal wear and tear on upholstery, or natural disaster.

REQUEST FOR SERVICE:

Prior to calling, please have your Salon or company name, address, telephone number, contact name, model name, and serial number, and a brief description of the problem. Contact Spatech's Customer Care Department to report defects or if you have questions on warranty prior to the expiration date of warranty at:

Spatech LLC - Customer Care Department
11801 Westminster Ave. Garden Grove, CA 92843
Tel: 800.866.6377 | Fax: 714.554.1506
Email: info@spatechcorp.com | www.spatechcorp.com

LENGTH OF WARRANTY:

*Twelve (12) months starting from the date of shipment. Purchase invoice, bill of sale, date of purchase, or delivery receipt are required by Spatech to qualify for your warranty coverage.

UNAUTHORIZED REPAIR:

Any performed or attempted repair or modification on the spa without explicit authorization in writing from Spatech will void this limited warranty.

DISTRIBUTOR WARRANTIES:

There is no distributor, dealer, general contractor, or other party has any legal rights to apprentice Spatech to any obligations or charges to this warranty in any extent.

LIMITED DAMAGES:

Allowed by law, Spatech will fully extend its options to disclaim and refuse any liability for substantial damages including, but not limited to, loss of business reputation, decrease in profits, or any fastidious damages other than these limited damages. In some states, the mentioned damages are not allowed to lawfully sustain; therefore, they may not apply to you.

***Extended 1-Yr Warranty: (optional as an upgrade – to be purchased prior to the shipment date of the original order)**

*Warranty - Parts Sale:

All parts purchased from Spatech Customer Care will have a 90-Day warranty from shipped date, except Complete Chair Top with Massage System and Complete Spa Base with Plumbing. Spatech reserves the rights to send out new or equivalent to new as replacements. All part sales are final and no refunds will be accepted.

*Complete Chair Top with Massage System will have a 6-Month Limited Warranty from the date of shipment.

*Complete Spa Base with Plumbing Installed will have a 6-Month Limited Warranty from the date of shipment.



Warning

PROPER INSTALLATION ACCORDING TO THIS MANUAL IS REQUIRED. FAILURE TO DO SO MAY RESULT IN SERIOUS INJURY AND/OR WARRANTY WILL BE NULL. YOU MUST HAVE A QUALIFIED LICENSED PLUMBER TO CONNECT THE SPA IN PLACE SAFELY. UL SAFETY RECOGNIZED FOR UNITED STATES AND CANADA.