

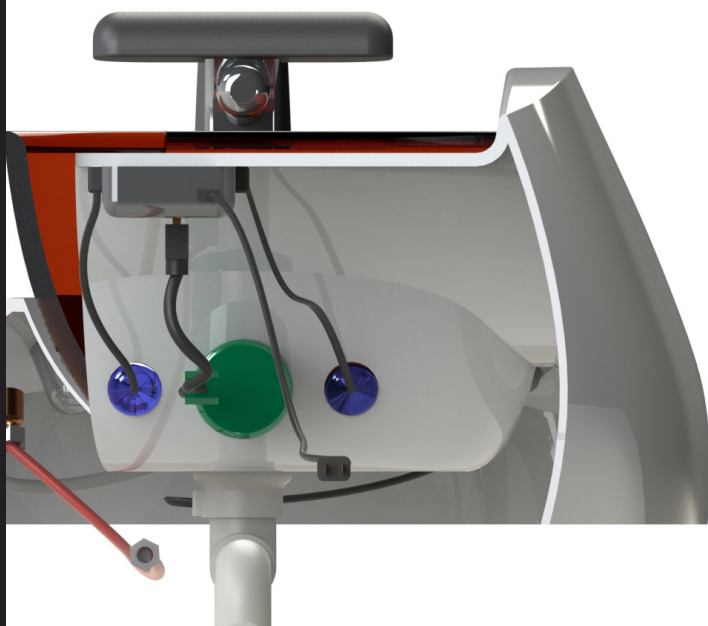

Pedicure Spa Use & Care Manual

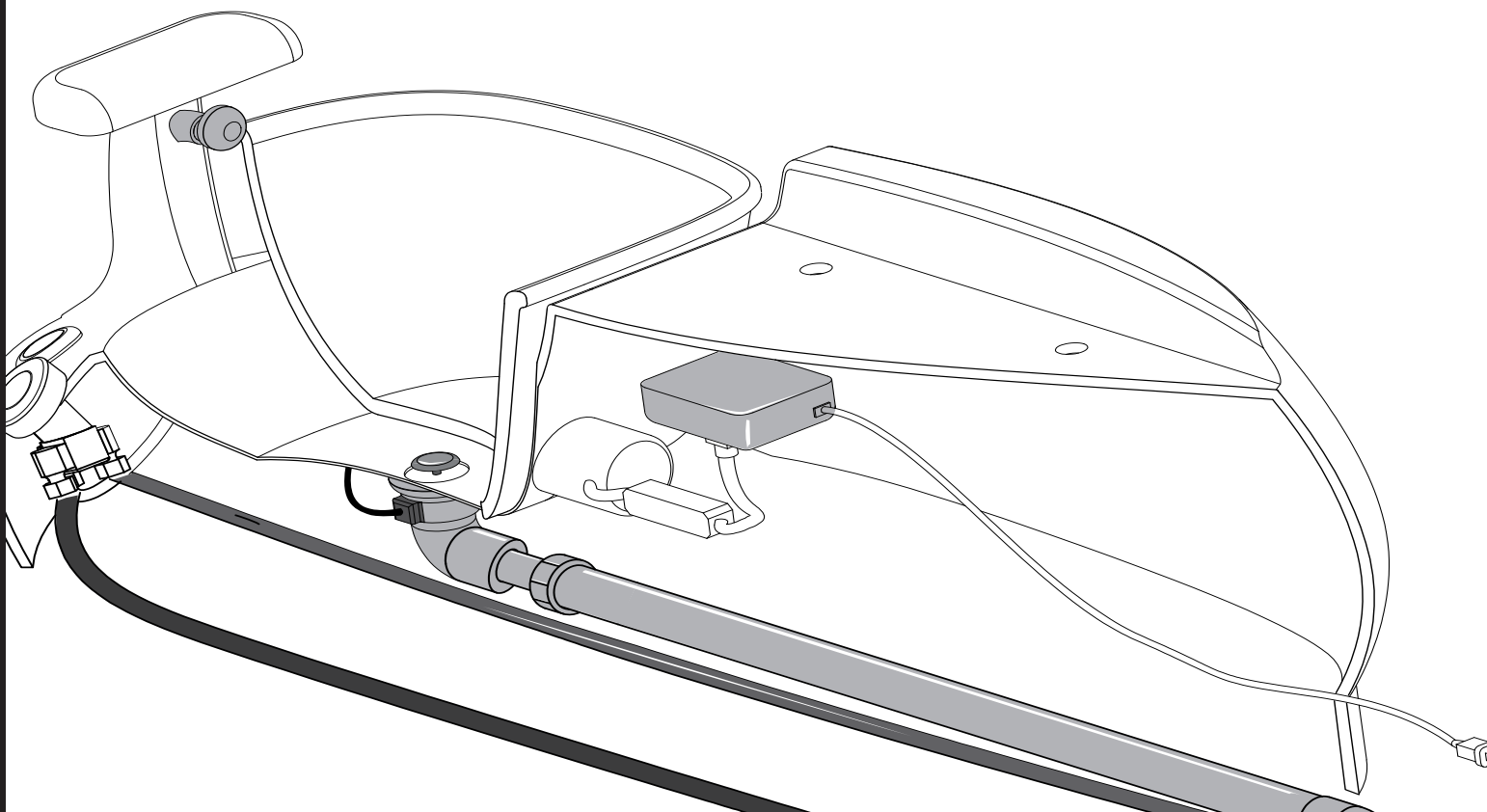

RECEIVING AND INSPECTION:

PLEASE TAKE NOTE! Each shipment received should be carefully inspected, making sure items reflect your bill of lading.

If you notice ANY DAMAGES please notify and document the damages to the driver immediately, PLEASE DO NOT SIGN for the items. Once signed, all claims are waived.

Parts Identification

Bottom View

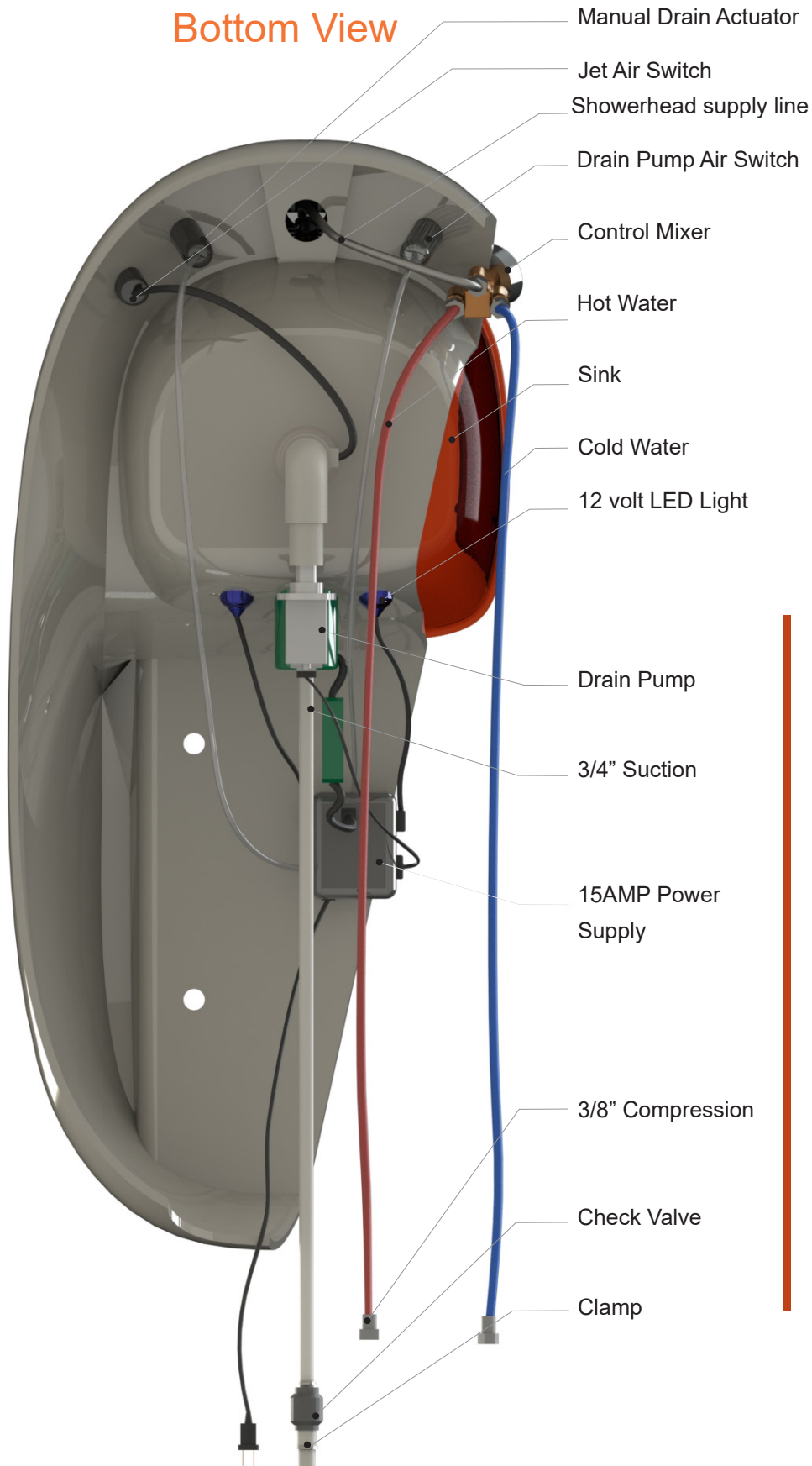

Top View

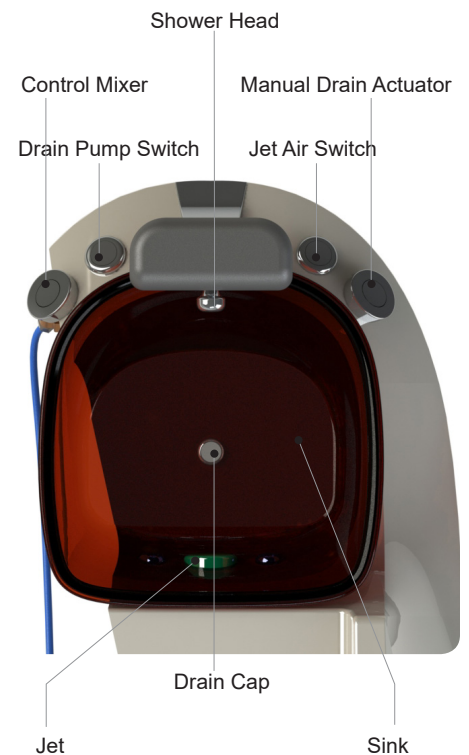

Ready for Installation

Licensed Installation Required

Please check your local plumbing and electrical codes. Installation of this pedicure spa must comply with both. You must hire a licensed plumber and a licensed electrician to complete the applicable connections to your pedicure spa.

NOTE: Failure to comply with federal, state, or local codes will result in the warranty being null and void.

Location and Support

- The pedicure spa must be on a level location.
- The floor structure of that location must be capable of supporting both the pedicure spa and its occupant at the same time.
- To fully recline the pedicure chair, the base of the unit must be positioned to a minimum of 24" from the wall.

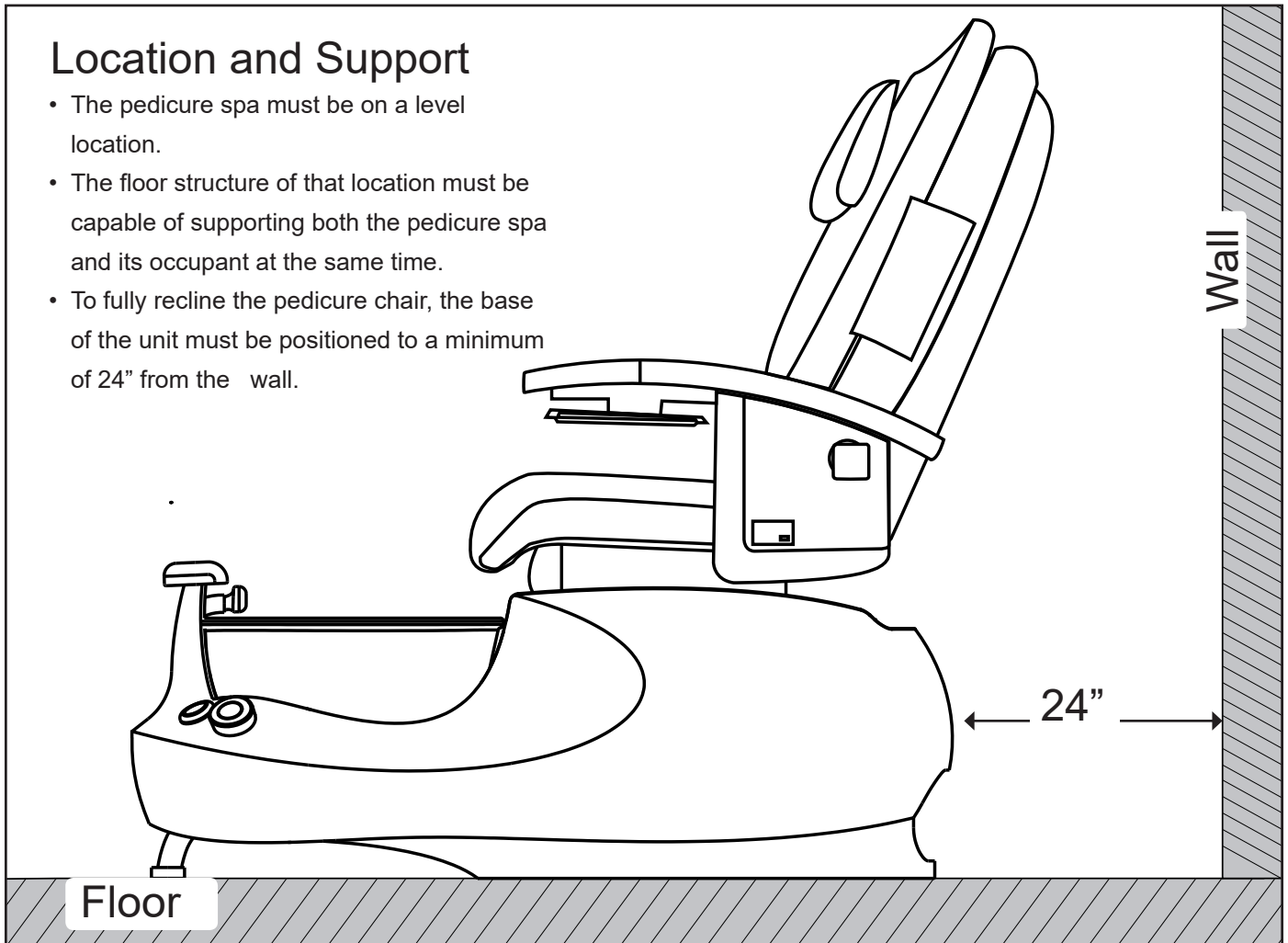

Parts Included

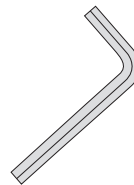
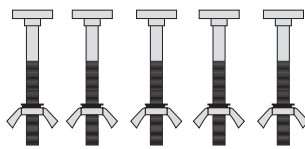

Pedicure Installation

Underground connection

- Please check the local plumbing codes before installation.
- Please ensure the pedicure system is installed by a licensed plumber.

**If using
P-Trap please
check Fig.1**

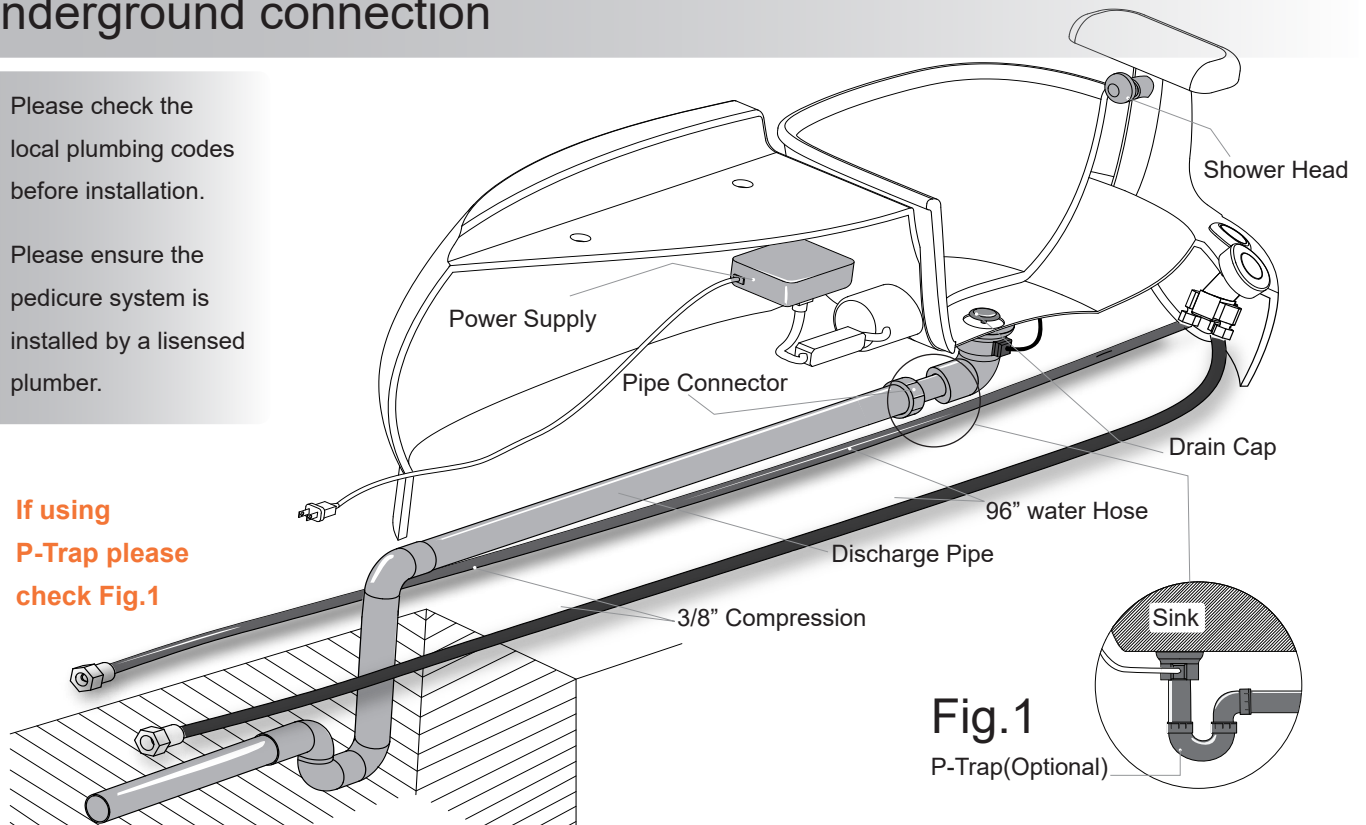

Wall Drain Connection

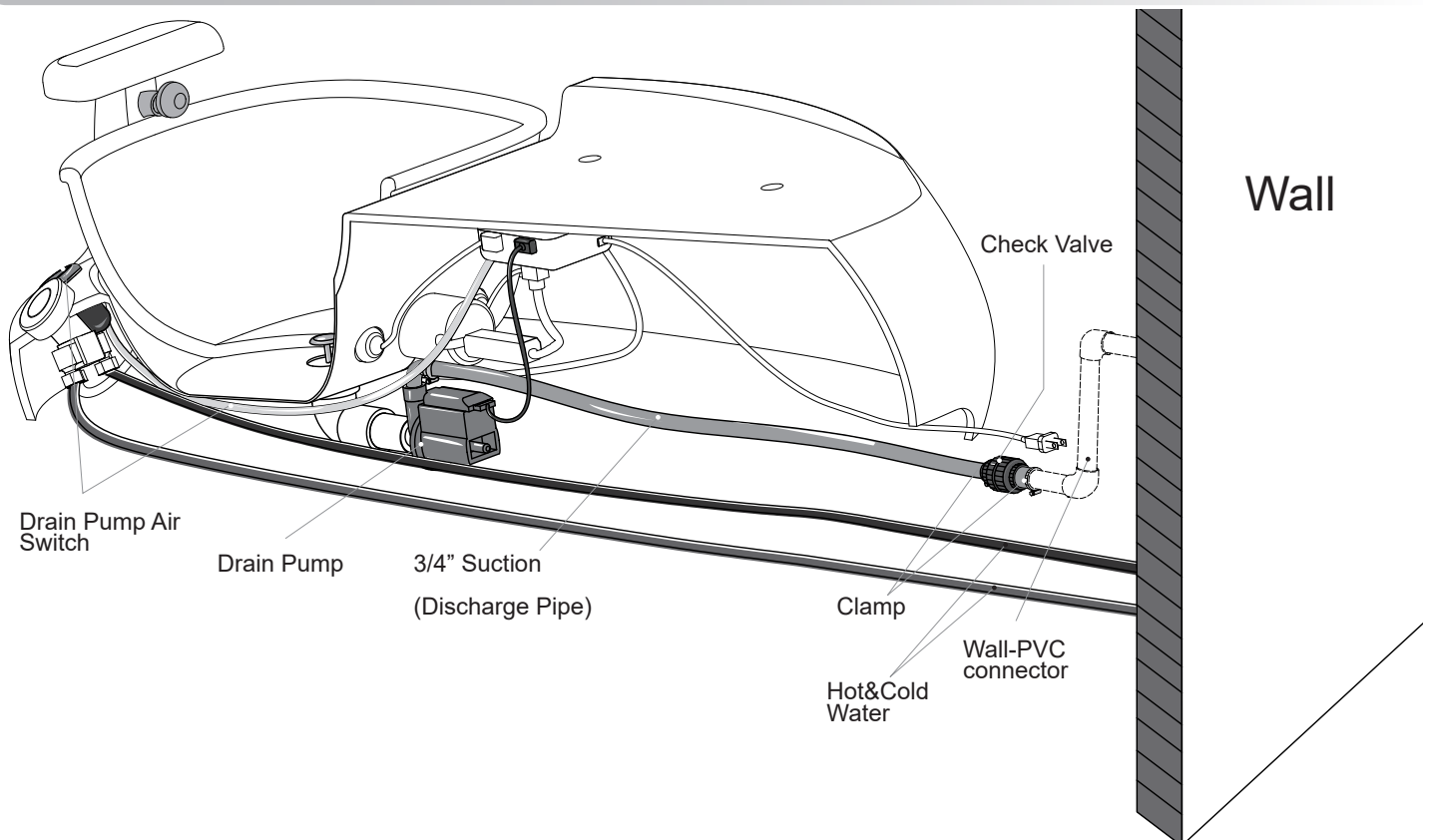

Pedicure Installation

WALL DRAIN Technical Drawing

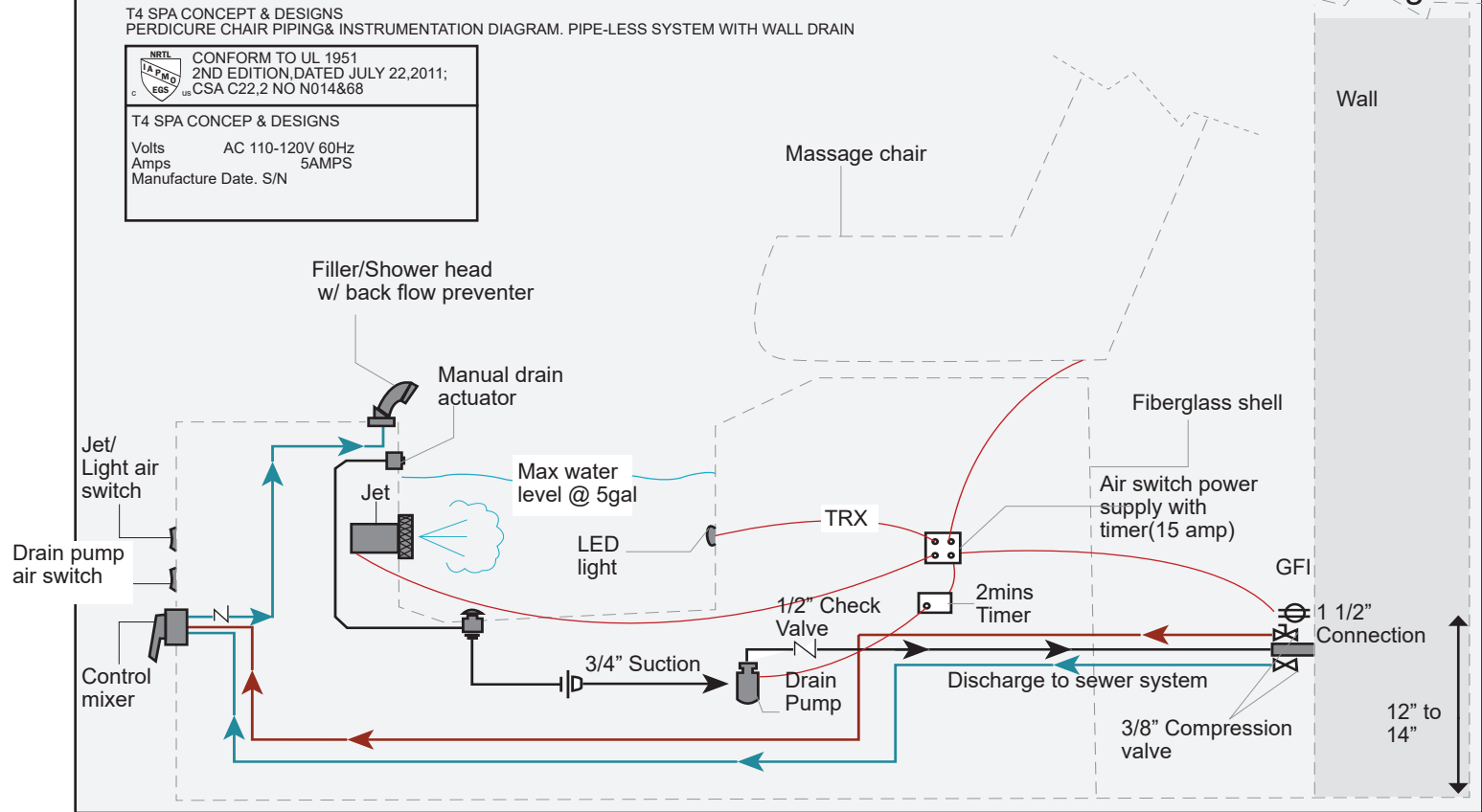

FLOOR DRAIN Technical Drawing

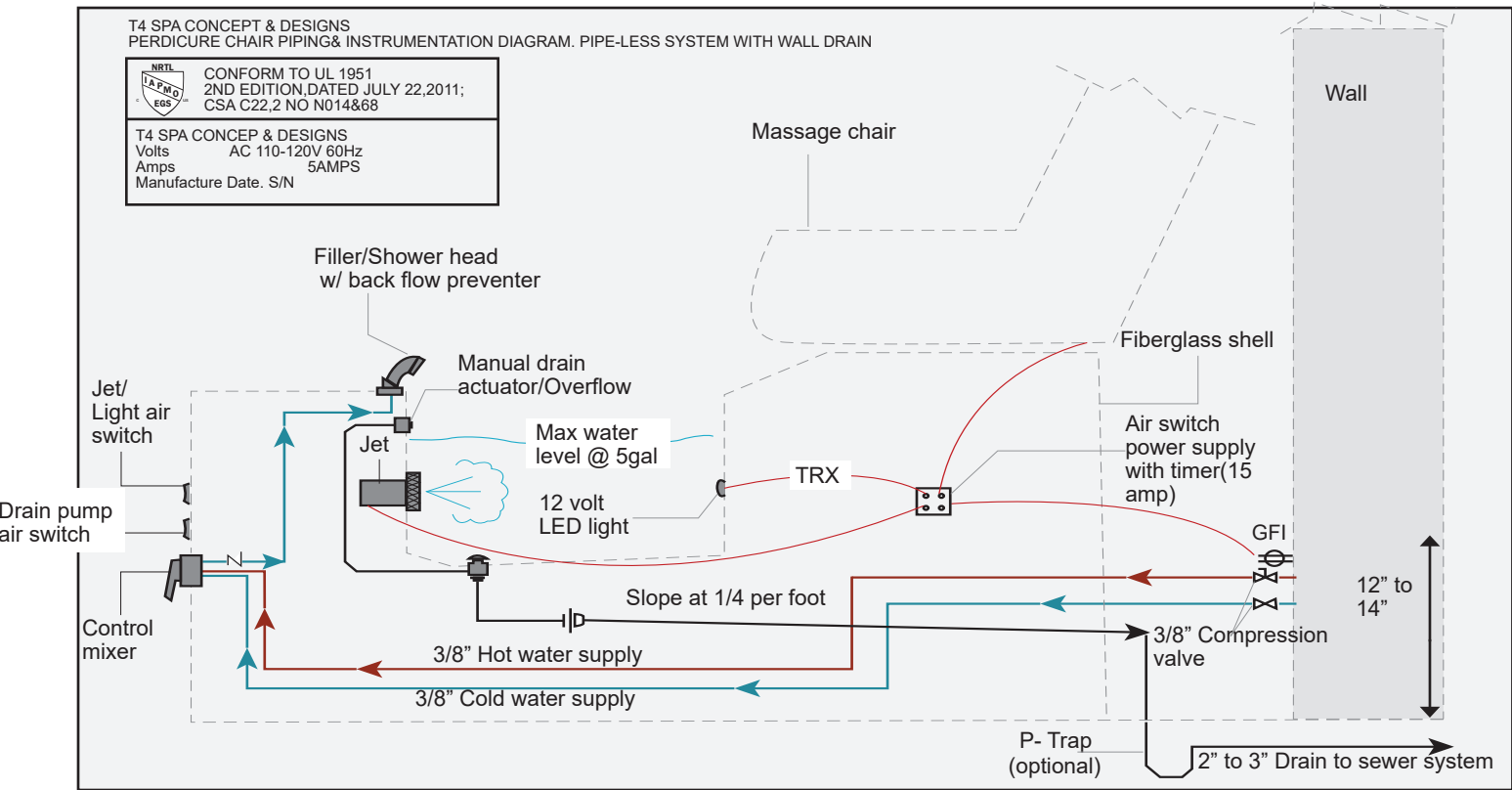

Pedicure Installation

Licensed Installation Required

Please check your local plumbing and electrical codes. Installation of this pedicure spa must comply with both. You must hire a licensed plumber and a licensed electrician to complete the applicable connections to your pedicure spa.

NOTE: Failure to comply with federal, state, or local codes will result in the warranty being null and void.

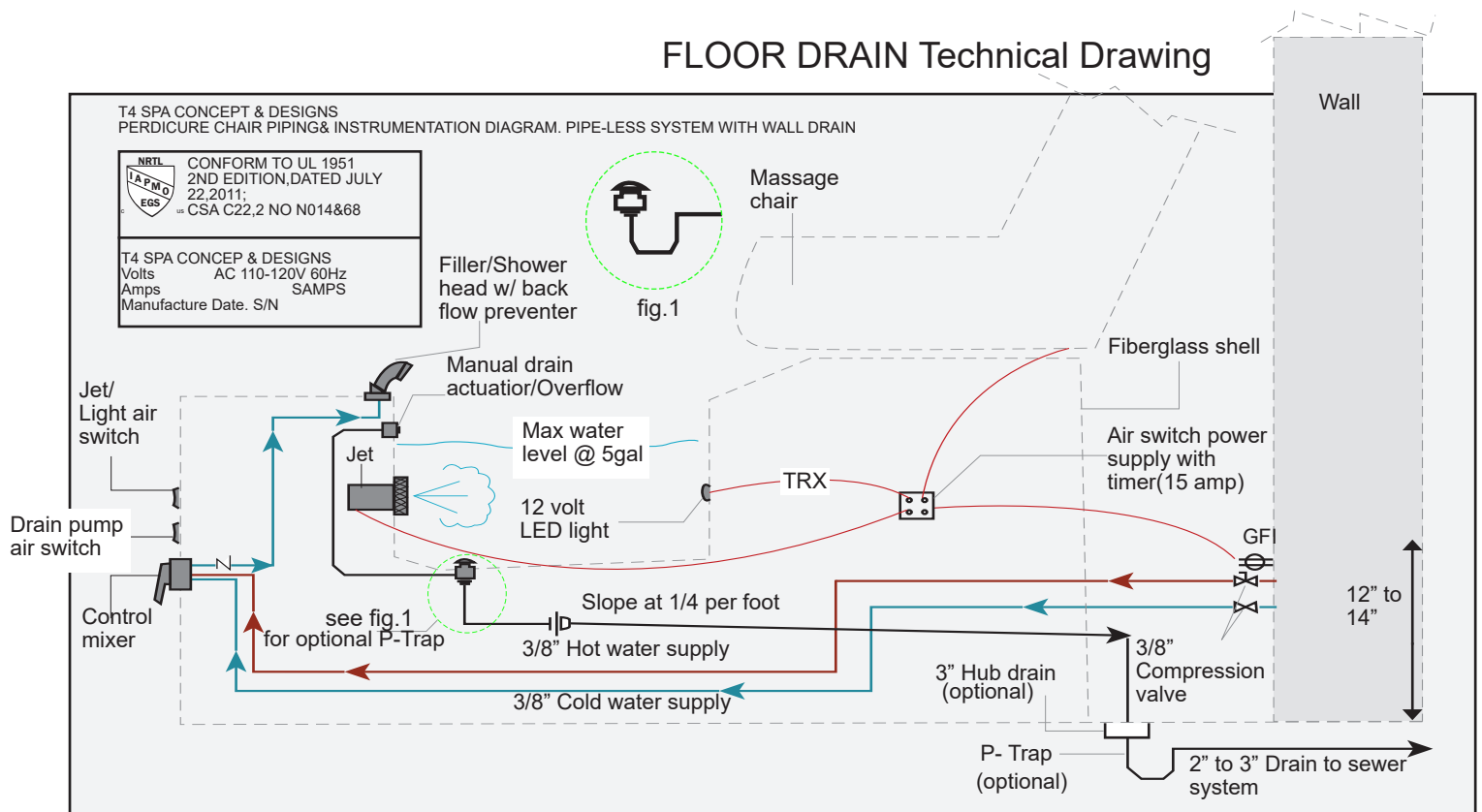

Spa Basin Specifications

- To keep your product working properly and effectively, please carefully follow these Instruction guidelines.

Please do not allow customer step or stand directly on the sink. It might break and injure the customer.

Note: All dimensions and weights are approximate

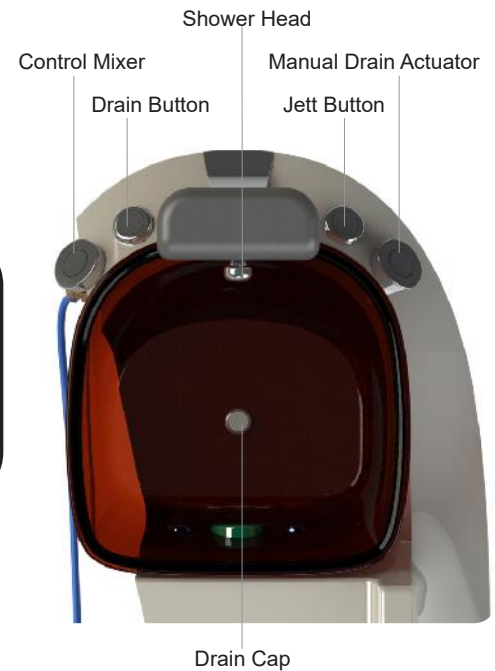

Basin Specifications

- Hot and cold water supply lines required (hot and cold shut offs may be installed under or behind pedicure spa basin) see page 11
- Drain installation: Reference note on page 8; can be installed with optional drain pump for wall drain or a gravity drain.
- Capacity of basin: 4.5 U.S. Gallons (17.03L) = Traditional Whirlpool (with Jets)* Power source: 110V AC | 15 Amp, 60 Hz (GFCI Protected)
- Caution: Pedicure spa must be installed by a licensed electrician and a licensed plumber, conforming to all local and national electrical codes.
- Jet System: Pipe free whirlpool pedicure spas: 1 jet, LED lights, optional drain pump. Jets: (may contain either)
- Luraco Jet Motors: 120V AC, 60Hz, 1A 0-29 Jet: 120V, 85W, 60Hz, 1A
- LED Lights: (may contain either)
- T4-L 18: input: 120V AC, 60Hz, 28VA Output: 12V, 60 Hz, 1.67A
- T4-L 18C: input: 120V AC, 60Hz, 28 VA, Output: 12V Ac 1.67A, 20VA, Class 2
- Electrical switches: On/Off air switch for Luraco Jet & Led Light. On/Off air switch for drain pump.
- Limited warranty: One (1) year from date of purchase.
- Due to our policy of continuous improvements, all specifications are subject to change without notice.

shipping Weights: (Total)

Arion - 325 lbs
Buffalo - 315 lbs
EOS - 315 lbs
Gspa F - 335 lbs
Gspa W - 345 lbs
Jaguar - 315 lbs
Katai - 335 lbs
Katai Glass - 365 lbs
Katai SE - 345 lbs
Onska - 315 lbs
Panther - 315 lbs
Stellar - 305 lbs
Triton - 315 lbs

Chair Parts & Dimensions

HTxT4s

Specifications*

Operating Voltage: AC110-120V 60 Hz
Power Consumption: 65 Watts
Chair Size (upright): 32" L x 32" W x 43" H
Chair Size (reclined): 49" L x 32" W x 36" H
Product Weight: 93 Lbs.
Maximum Load Weight: 285 Lbs.

*Specifications are subject to change without prior notice.

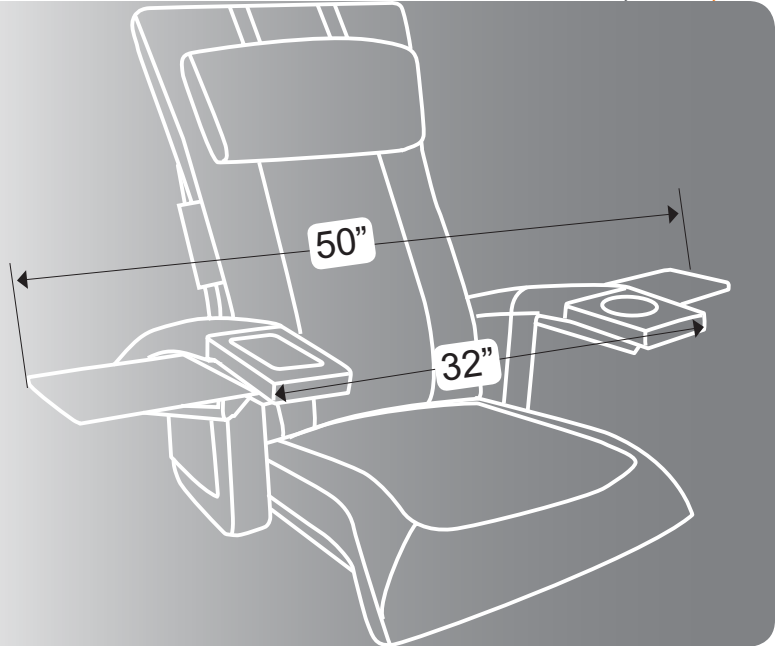

INSIDE THE BOX

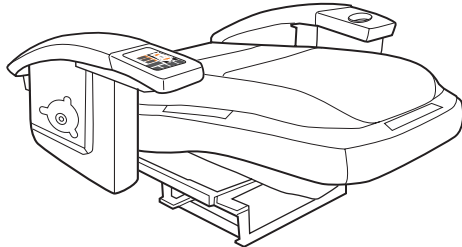

Chair

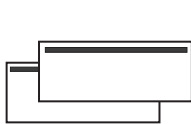

Splash Guard

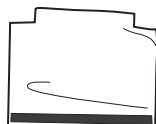

Side Flaps

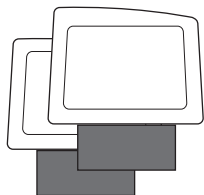

Manicure Trays

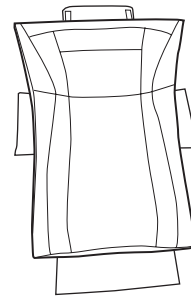

Backrest Pad

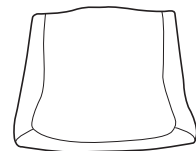

Seat Pad

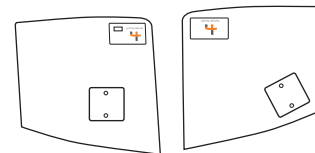

Side Panels

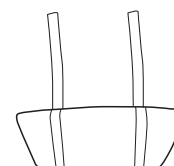

Head Pillow

Please Save the Instruction Manual

Do not attempt to repair this product yourself.

Grounding Instructions:

This product must be grounded. If it should malfunction or breakdown, grounding provides a path of least resistance for electrical current to reduce the risk of electric shock. This product is equipped with a cord having an equipment-grounding conductor and a grounding plug. The plug must be plugged into an appropriate outlet that is properly installed and grounded in accordance with all local codes and ordinances.

⚠ DANGER: Improper connection of the equipment-grounding conductor can result in a risk of electric shock. Check with a qualified electrician or serviceman if you are in doubt as to whether this product is properly grounded. Do not modify the plug provided with the product – if it will not fit the outlet, have a proper outlet installed by a qualified electrician.

This product is for use on a normal 110-volt circuit and has a grounding plug that looks like the plug illustrated in sketch (A). A temporary adapter that looks like the adapter used in sketches (B) and (C) may be used to connect this plug to a 2-pole receptacle as shown in sketch (B), if a properly grounded plug is not available. The temporary adapter should be used only until a properly grounded outlet (sketch A) can be installed by a qualified electrician. The green colored, rigid ear tab or the like extending from the adapter must be connected to a permanent ground such as a properly grounded outlet box cover. Whenever the adapter is used, it must be held in place by a metal screw.

For all grounded cord-connected products:

⚠ WARNING: This product is equipped with a thermal resetting protection device. This is an added safety feature to protect you and this product from overheating. If the product should suddenly stop and will not start, turn off the main power switch, located on the back of the product, to off and do not operate the product for at least 30 minutes. Failure to turn the product off may result in the product starting unexpectedly when the product cools.

Grounding methods:

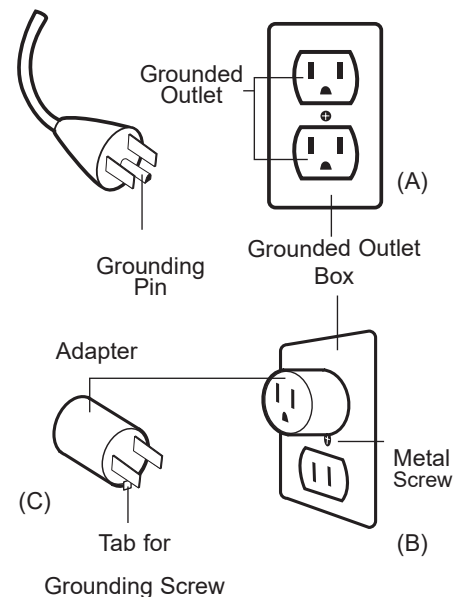

The use of a temporary adaptor is not permitted in Canada.

Chair Installation

HTxT4s

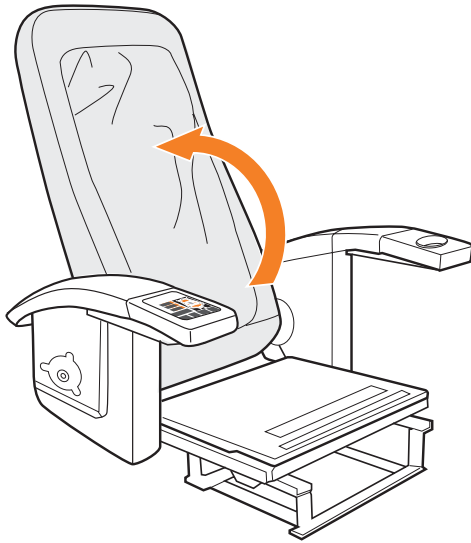

1. Unfold the chair.

Remove all packaging materials from the chair. Pull gently up on the backrest to unfold the chair to an upright position. The backrest locks into place automatically.

2. Attach the seat pad.

Place the seat pad into position, with the front edge placed firmly against the front of the seat frame. While holding the front of the seat pad to ensure that it remains flush with the seat frame, press down firmly on the seat pad to secure it to the seat canvas support.



3. Attach the splash guard and side flaps.

Attach the top edge of the splash guard to the hook-and-loop fasteners located just beneath the front edge of the seat. Attach the lower edge of the splash guard to the chair frame using the hook-and-loop fasteners.

Attach the side flaps to the chair using the hook-and-loop fasteners.

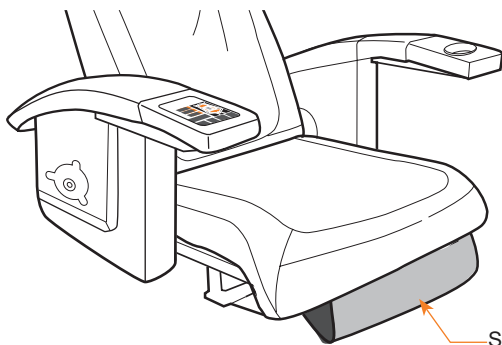

Splash guard

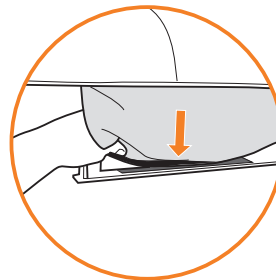
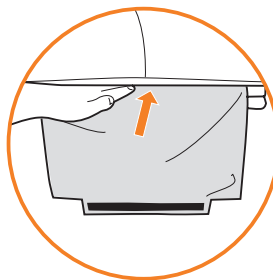

4. Attach the backrest pad.

Place the backrest pad into position, then attach the top flap to backrest using the hook-and-loop fasteners (A). Attach the two side flaps to the backrest using the hook-and-loop fasteners (B). From the front of the chair, tuck the bottom of the backrest pad behind the seat (C). From behind the chair, press the backrest release lever to release the backrest from the base, tip the backrest forward, then secure the bottom backrest flap to the underside of the chair using the hook-and-loop fasteners (D).

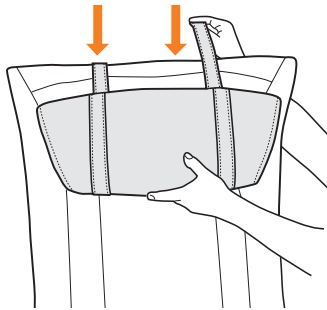
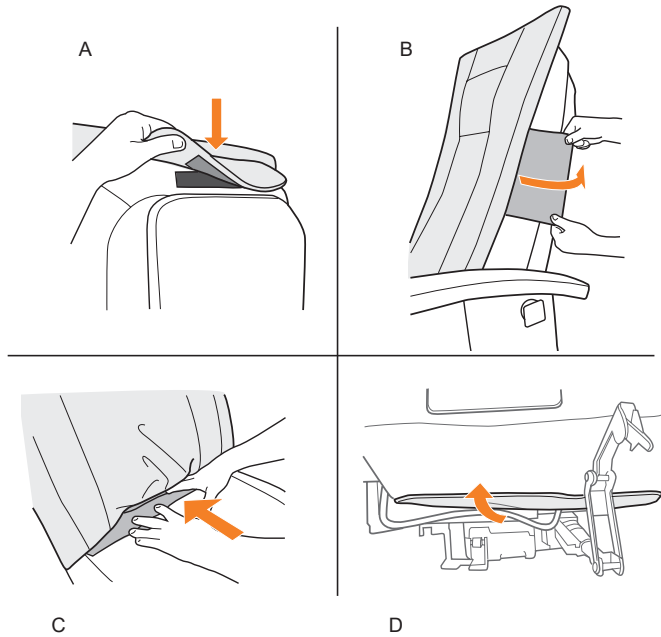

5. Attach the head pillow.

Align the head pillow with the upholstery window on the front of the backrest pad, then attach the head pillow straps to the backrest pad using the hook-and-loop fasteners.

6. Install the side panels

1. Pull the purse hook outward.
2. Align the side panel mounting posts with the corresponding holes on the chair.
3. Press the side panel to snap it into position.
4. Push the purse hook inward.
5. Repeat steps 1 – 4 to install the second side panel.

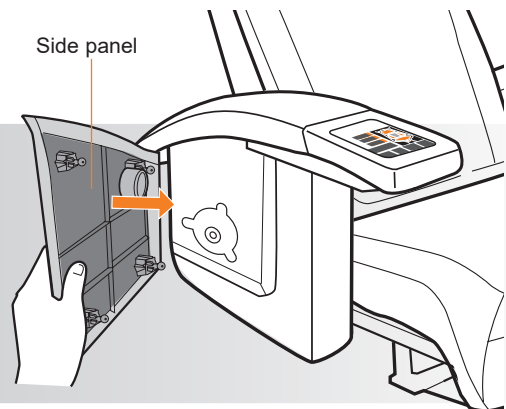

7. Attach the manicure tray.

1. Locate the left-hand manicure tray (wide end of the tray toward the back of the chair).
2. Place the mounting bracket into position underneath the armrest, aligning the holes, then secure the mounting bracket to the armrest using the three screws (provided).
3. Repeat step 2 to install the right-hand manicure tray.

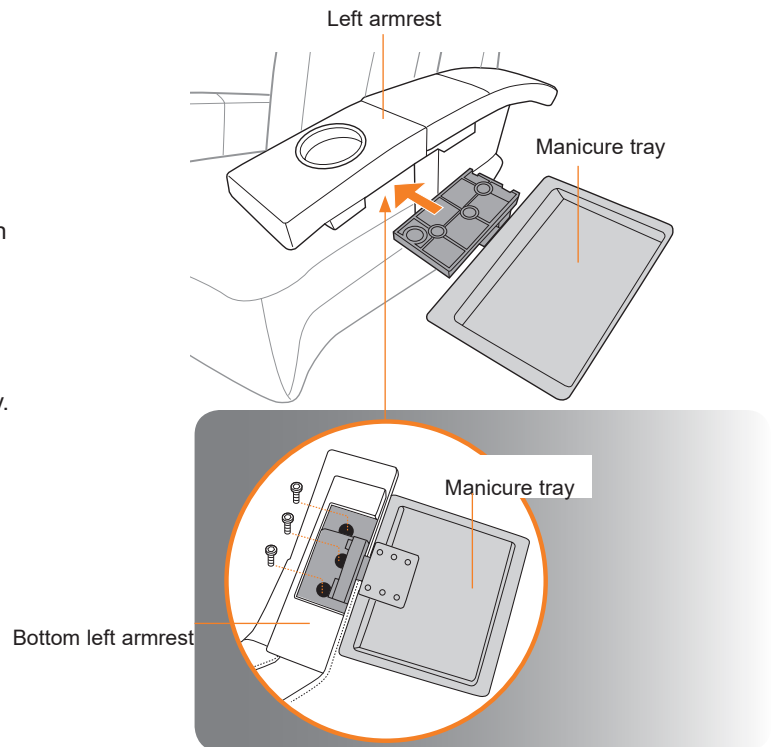

8. Raise the manicure trays.

To lower the tray, push/pull the tray backward toward the backrest to disengage the hinge, then lower it (A). To raise the tray, pull upward until the tray locks into place (B).

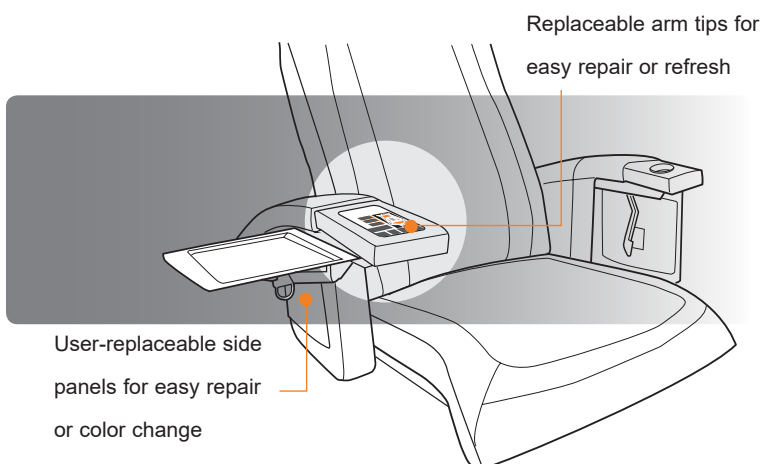
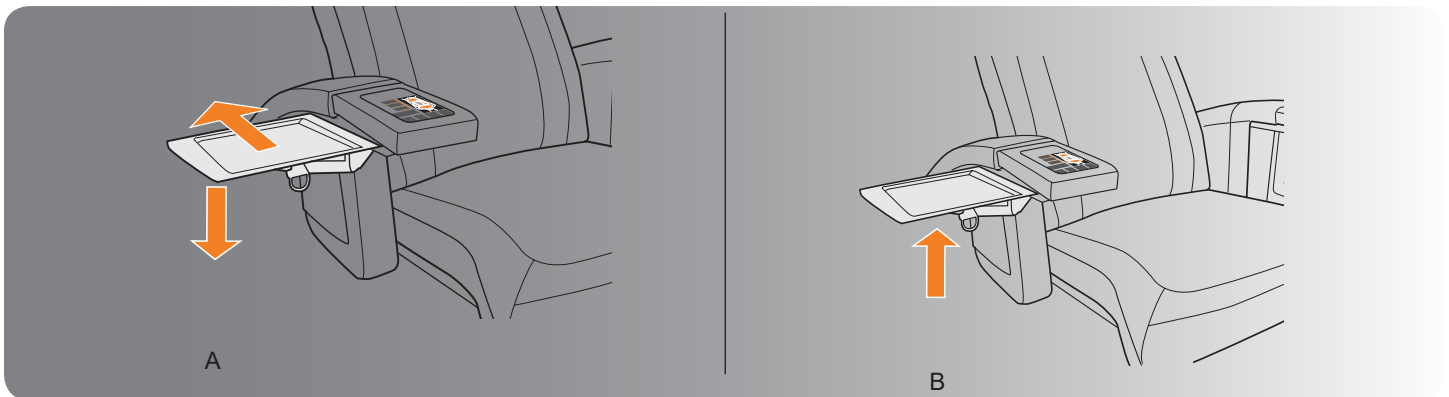

LOCATE THE CONTROL PANEL

Your massage chair has a built-in control panel, so it is always handy.

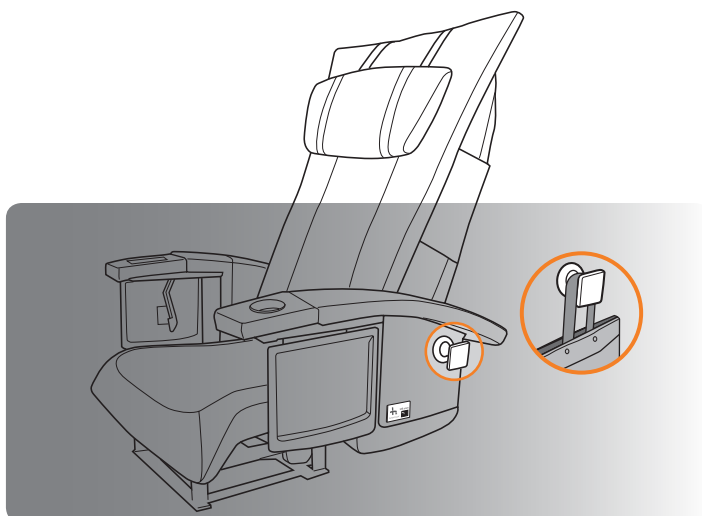

LOCATE THE TWO STORAGE POCKETS

Two convenient pockets located on the backrest provide handy storage for clip boards and magazines.

HANG IT UP

Your massage chair has a convenient purse holder on each side. Simply pull outward on the purse holder to use it.

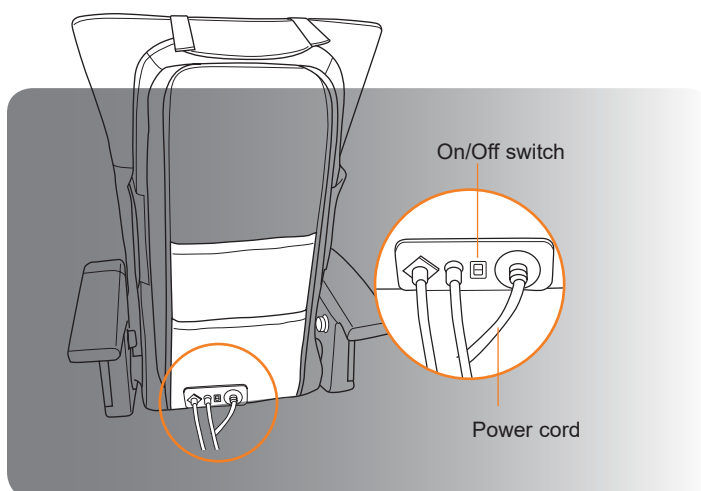
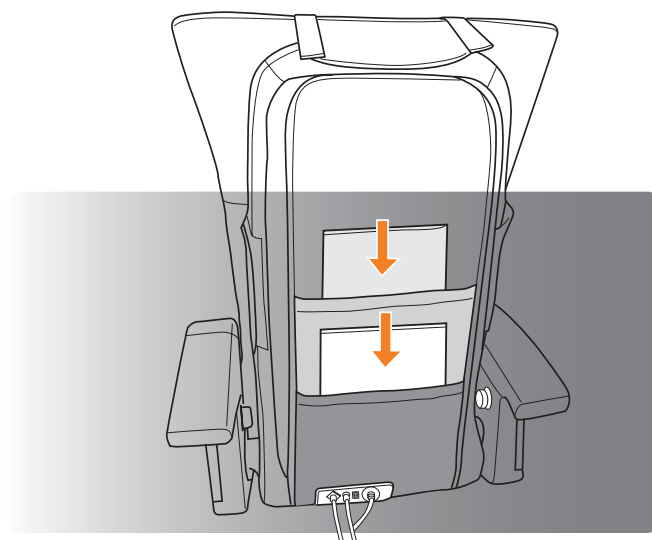

POWER ON

Plug the power cord into a grounded power source, then turn the On/Off switch on the back of the backrest to On. Press the red button on the GFI breaker at the end of the power cord to activate power to the chair.

Control Operations

Back – Effortlessly reclines and inclines the backrest to the desired position.

Seat – Slides the chair forward and backward for ideal pedicure position.

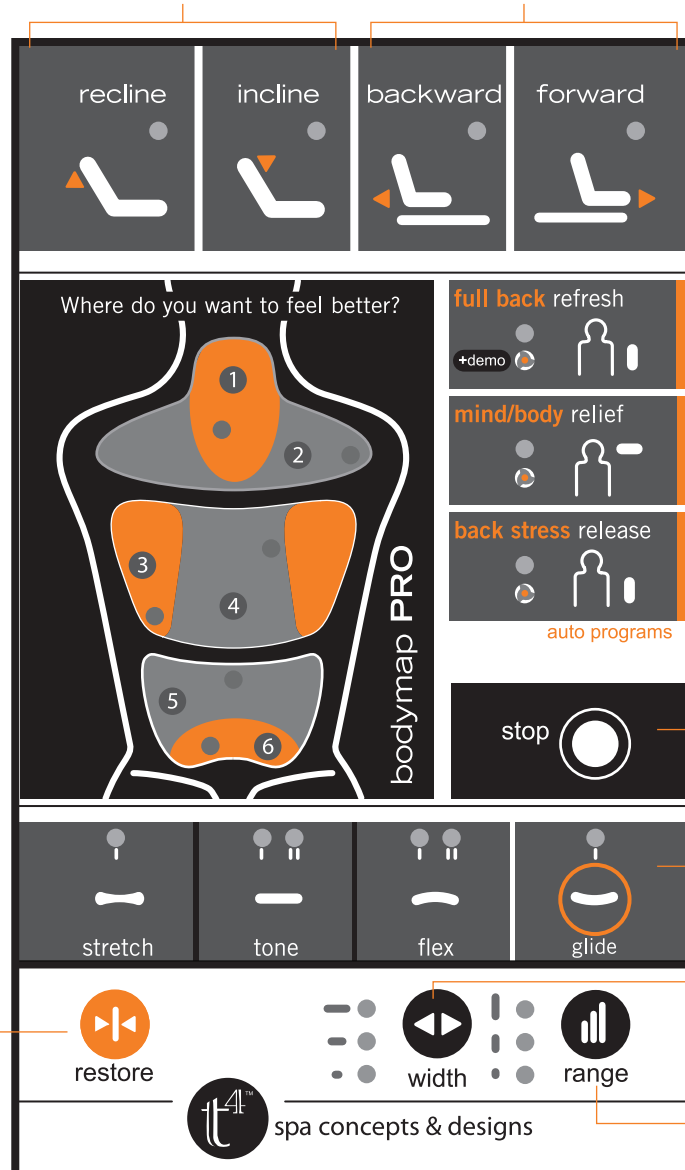

bodymap PRO

Where do you want to feel better? – Simply press where you want to feel better, then sit back and let the chair do the rest!

Restore — Press and hold to stop the massage, return the massage mechanism to the top of the backrest, raise the backrest to the upright position, and return the chair to the rear position on the tub.

Auto Massage Experiences – Three unique auto massage experiences automatically massage your back for 15 minutes, using a variety of massage techniques. The corresponding LED lights to indicate which massage technique is currently in use.

Stop – Stops the massage immediately.

Massage techniques – Select from four massage techniques to customize your massage. Rolling can be combined with any of the other three techniques.





Width – Select from wide, medium, or narrow massage width settings, based on the width of your back.

Range – Select from high, medium, or low vertical massage range settings, based on your height.



spa concepts & designs

MASSAGE TECHNIQUES

Massage Modes	What It Does	Benefits
 Stretch	Kneads your back in a small, circular motion on both sides of your spine simultaneously.	Relieves tension and soreness by lifting and stretching muscles. Improves circulation and helps bring vital nutrients to the spinal area.
 Tone	Combines circular kneading motion with rapid-tapping percussion strokes.	Relieves muscle tension and spinal pressure, improves circulation and invigorates the back, all at once.
 Flex	Alternates rapid-tapping strokes along the spine to stimulate both spinal muscles and spinal joint areas, emulating the percussive massage technique used in sports medicine for deep muscle therapy.	Flexes spinal joints and relieves pressure on the spinal column, invigorating the entire back area.
 Glide	Glides gently up and down your back near your spine.	Warms and loosens your muscles, preparing your back for deeper massage. Relieves muscle tension, improves circulation and relaxes the back.

Where do you want to feel better?

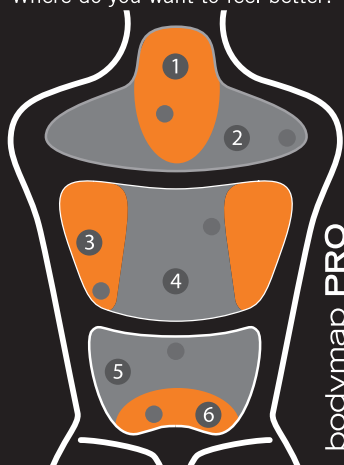

bodymap PRO

Experience the innovation and simplicity of bodymap PRO

When you're experiencing muscle and joint discomfort, you want relief – now. Human Touch BodyMap PRO delivers. Simply press where you want to feel better and immediately receive an effective, therapeutic massage experience. The Human Touch FlexGlide massage engine is automatically tuned to just the right intensity to relieve your toughest aches and pains. Each zone runs an individual seven-minute session.

- ① Relieve those tight stresses at your neck (remove head pillow).
- ② Been sitting at your desk all day? Spread stress relief between your shoulders.
- ③ Auto focus on those knots below your shoulder blades.
- ④ Get generous relief for the muscles in the middle of your back.
- ⑤ Been standing all day? Get big relief in your lower back all the way out to your sides.
- ⑥ Focus-in, close to the spine, on those aches and pains in your lower back.

Control Panel Replacement

HTxT4s

SERVICE LEVEL: 1

It is imperative that Human Touch® products are repaired in a manner that ensures product safety and regulatory compliance and that is fully consistent with the practices used during the manufacturing process. Therefore, Human Touch requires that all product repairs are performed using only factory-new parts and in accordance with these repair instructions. Failure to adhere to these instructions voids the product warranty and releases Human Touch from all liability for injury or product damage resulting from the repair.

Tools Required: Razor blade, Phillips-head screwdriver

Save all removed parts for used during reassembly

1. Power off the chair, then unplug it.
2. Using a razor blade, remove the control panel label (Fig.1).
3. Using a Phillips-head screwdriver, remove the four screws that secure the switch cluster frame to the armrest (Fig.2).
4. Using a razor blade, pry the switch cluster frame out of the armrest (Fig.3).
5. If you are replacing the control panel for cosmetic reasons only (no problem with control panel function), go to Installing the new Control Panel.
6. Using a razor blade, pry the control panel PCB out of the armrest (Fig.4).
7. Disconnect the PCB connector, then remove the PCB from the chair (Fig.5).



(Fig.1)



(Fig.2)



(Fig.3)

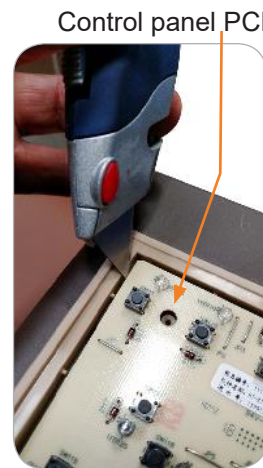

(Fig.4)

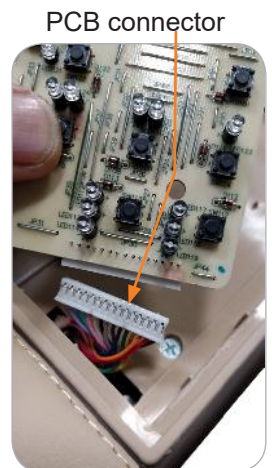

(Fig.5)

INSTALLING THE NEW CONTROL PANEL

1. If you replaced the control panel PCB, connect the new PCB connector to the corresponding connector in the armrest, then place the new PCB into position in the armrest.
2. Place the new switch cluster frame into position in the armrest, then replace the four screws to secure it.
3. Apply the new control panel label to the switch cluster frame.
4. Plug in the chair, power it on, then verify that the control panel is working properly.

Armrest Replacement

HTxT4s

SERVICE LEVEL: 3

It is imperative that Human Touch® products are repaired in a manner that ensures product safety and regulatory compliance and that is fully consistent with the practices used during the manufacturing process. Therefore, Human Touch requires that all product repairs are performed using only factory-new parts and in accordance with these repair instructions. Failure to adhere to these instructions voids the product warranty and releases Human Touch from all liability for injury or product damage resulting from the repair.

Tools Required: 3/16" Allen Wrench, Phillips-head screwdriver, M14 socket with handle extension; M6 Allen wrench, wire cutter, flat-head screwdriver, pliers, new zip ties.

Save all removed parts for used during reassembly

Removing the Armrest

1. Power off the chair, then unplug it.
2. Raise the armrest, then use a 3/16" Allen wrench to remove the three screws that secure the manicure tray to the armrest
3. Remove the manicure tray.

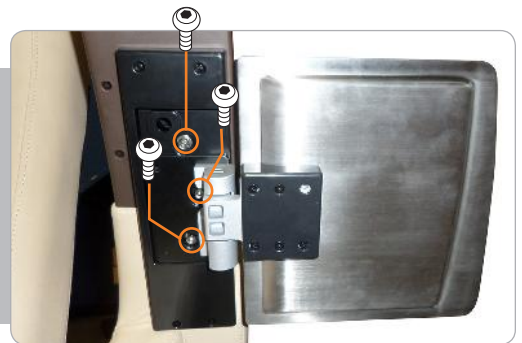

Removing the Side Panel

Use your fingers to pop the side panel off of the armrest you are replacing



If you are removing the right-hand Armrest

Using a wire cutter, cut the lower zip tie that secures the control panel connectors to the armrest, then disconnect the connectors



If you are removing the right-hand Armrest

1. Using a wire cutter, cut the zip ties that secure the cable to the armrest.
2. Using a Phillips-head screwdriver, remove the three screws that secure the USB PCB cover

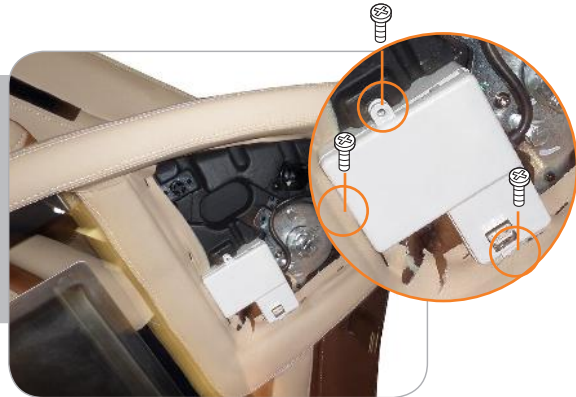

3. Remove the cover, then disconnect the PCB connector



4. Using a Phillips-head screwdriver, remove the screw that secures the green ground wire to the armrest

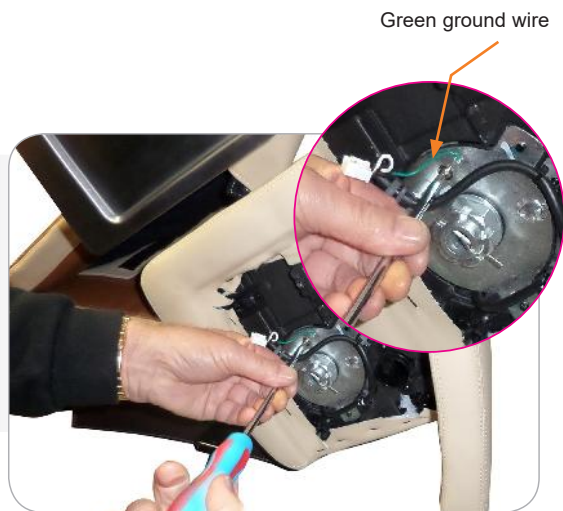

REMOVE THE ARMREST

1. Locate the nut and screw that secure the armrest to the chair (Fig.8).
2. Using an M14 socket with handle extension, loosen the nut located behind the armrest screw (Fig.9).
3. While holding the armrest in place, use an M6 Allen wrench to remove the armrest screw (Fig.10).

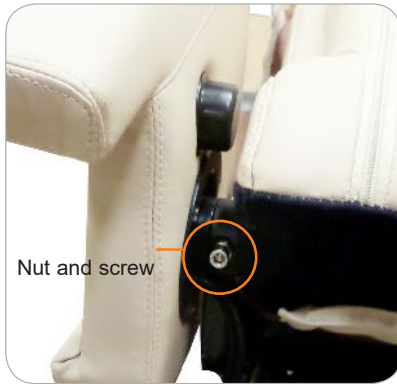

(Fig.8)



(Fig.9)



(Fig.10)

4. Using both hands, pull the armrest off the chair base. **IMPORTANT:** Make sure the two black washers stay in position on the armrest shaft.



5. Separate the black collar from the armrest, then feed the cable carefully through the armrest. **IMPORTANT:** Note the location at which the cable feeds through the armrest, as you will need to feed it through the same location when installing the new armrest.



INSTALLING THE NEW ARMREST

Install The New Armrest Onto The Chair

1. Confirm that the two black washers are in position on the armrest shaft.
2. Feed the cable through the black collar and the armrest in the same location as it was previously located.
3. Install the new armrest mounting point into the armrest shaft (Fig.13).
4. Push the black plastic collar onto the armrest shaft as far as it will go, to ensure that it does not interfere with the following step (Fig.14).
5. From the back of the chair, ensure that the hole in the armrest mounting point is aligned with the hole in the armrest shaft. If the two holes are not lined up, you will be unable to insert the screw far enough to secure the armrest to the chair. If the holes are not aligned, move the armrest slightly up and down as necessary to align them.
6. Using an M6 Allen wrench, replace the armrest screw to secure the armrest to the chair.
7. Using an M14 socket with handle extension, tighten the nut behind the armrest screw.
8. Raise and lower the armrest to verify that the armrest screw is properly installed. If the armrest falls below a horizontal position, the armrest screw was not installed all the way through the armrest mounting point into the armrest shaft. Repeat steps 4 – 7 until the armrest will not fall below a horizontal position.



(Fig.13)



(Fig.14)

If you are replacing the left-hand armrest

1. Place the green USB PCB ground wire into position, then replace the screw to secure it (Fig.15).
2. Connect the new armrest cable connector to the PCB connector.
3. Place the PCB into the white box base, aligning the cables with the cable guides (Fig.15).
4. Place the PCB box cover into position, then replace the three screws to secure it.
5. Align the three screws with the corresponding screw holes on the armrest, then tighten the three screws to secure the PCB box to the chair. (Fig.16).
6. Install new zip ties in the locates as they were previously, to hold the cable in position.

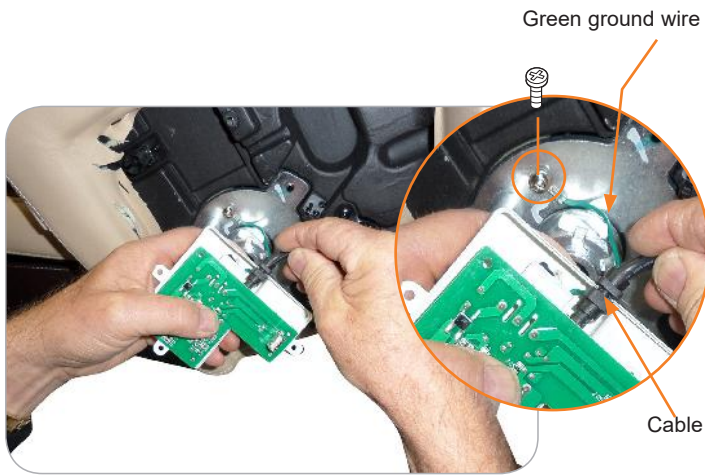

(Fig.15)

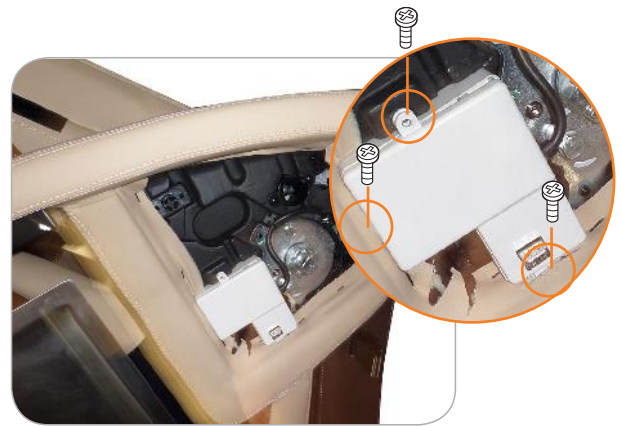

(Fig.16)

If you are replacing the right-hand armrest

1. Connect the control panel connector to the corresponding connector on the armrest.
2. Position the connectors inside the connector cavity, then install a new zip tie to secure it.

Install the side panel

Align the plugs on the inside of the side panel with the corresponding sockets on the side of the chair, then snap the power panel into place to secure it.

Install the manicure tray

Place the manicure tray into position then replace the three Allen screws to secure it.

REPLACING THE MASSAGE MECHANISM

HT-Bliss / HT-XT4 / HTxT4s/ Rapture

SERVICE LEVEL: 3

It is imperative that Human Touch® products are repaired in a manner that ensures product safety and regulatory compliance and that is fully consistent with the practices used during the manufacturing process. Therefore, Human Touch requires that all product repairs are performed using only factory-new parts and in accordance with these repair instructions. Failure to adhere to these instructions voids the product warranty and releases Human Touch from all liability for injury or product damage resulting from the repair.

Tools Required: Phillips-head screwdriver, wire cutters or any instrument suitable for cutting zip ties, new zip ties.

NOTE: Save all screws for use during reassembly.

REMOVING THE MASSAGE MECHANISM

1. Power off the chair, then unplug it.
2. Pull up on the backrest release lever to release the backrest from the seat, then fold the backrest forward onto the seat (Fig.1).
3. Using a wire cutter, cut the zip tie that secures the backrest zippers together (Fig.1).

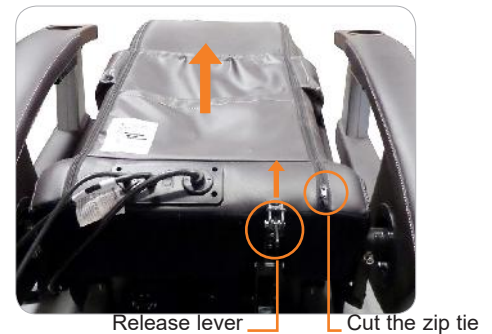

(Fig.1)

4. Open the backrest zippers to expose the massage mechanism (Fig.2).
5. Using a Phillips-head screwdriver, remove the seven screws that secure the massage mechanism side panel, then remove the panel from the chair (Fig.3).
6. Using a Phillips-head screwdriver, remove the eight screws that secure the massage mechanism to the chair (Fig.4).



(Fig.2)

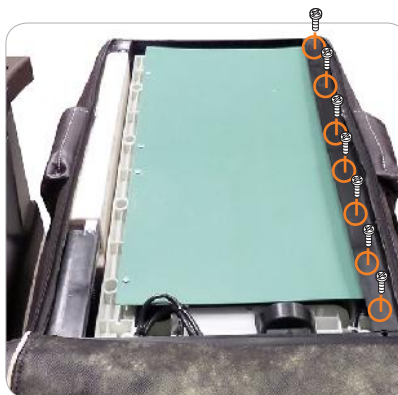

(Fig.3)

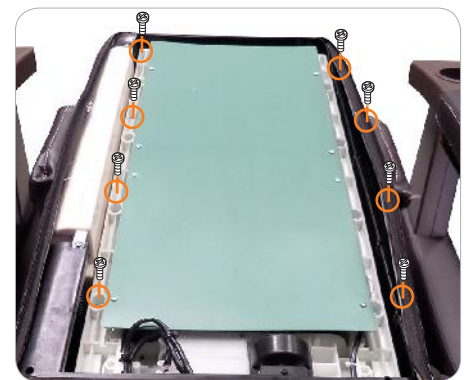

(Fig.4)

7. Lift the massage mechanism and set it on the backrest frame (Fig.5).
8. Using the wire cutter, cut the zip tie that secures the massage mechanism harness to the chair frame. Note the location of the zip tie as you will need to install a new zip tie in the same location when installing the new mechanism.
9. Disconnect the four connectors that connect the mechanism cables to the main PCB (Fig.6).
10. Remove the mechanism from the chair (Fig.7).

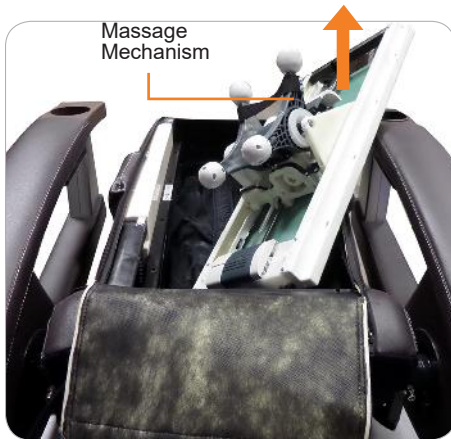

(Fig.5)



(Fig.6)

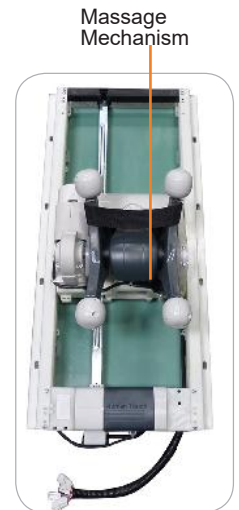

(Fig.7)

REPLACING THE MASSAGE MECHANISM

1. Place the new massage mechanism onto the backrest frame, then connect the four main harness connectors to the corresponding main PCB connectors.
2. Secure the cable harnesses where they were secured previously, using a new zip tie.
3. Place the massage mechanism into the backrest frame, then replace the eight screws/washers to secure it.
4. Place the massage mechanism side panel into position, then replace the seven screws to secure it.
5. Close the backrest zippers, then secure them using a new zip tie.
6. Pull gently upward on the backrest to return it to an upright position.
7. Plug in the chair, power it on, then verify that the massage mechanism is working properly.

Troubleshooting HTxT4s/Ht-Bliss/Rapture

This Troubleshooting Guide walks you step-by-step through the diagnosis of HTxT4s customer problems. It is important to follow these steps carefully, to ensure that the problem is diagnosed correctly, and therefore the appropriate repair action is taken.

Getting Started

Turn the power switch on the lower rear of the chair to Off, wait approximately five seconds, then turn it back On.

Check whether any controller LEDs light.

Choose from the following:

To Troubleshoot This Issue	Do the following:
My control panel is not working	Power to control panel has already been verified therefore: If a control panel LED does not light when you press it, but the function it controls works, replace the control panel. This requires three parts: controller PCB, switch cluster frame, and controller label. If a control panel LED lights when you press it, but the function it controls does not work, replace the massage mechanism.
My chair is not massaging properly	If the Stretch, Tone, Flex, or Glide massage is not working, or is making a loud noise, replace the massage mechanism.
My chair will not recline or incline	Replace the backrest actuator.
My chair will not slide forward or backward.	Replace the slide actuator.

Power

Step 1: Check the power and remote control cables

Verify that the power cord connections to the power panel are secure, and that the cord is not damaged. If any of the power panel components is damaged, replace the power panel.

Step 2: Check the wall outlet

Plug a different device into the AC outlet into which the chair is plugged. If the device does not work (is not receiving power), the AC outlet is most likely not working. Plug the chair into a different AC outlet to verify that it receives power.

Step 3: If the chair is still not receiving power, replace the main PCB box

Use & Care

Failure to follow these necessary maintenance instructions will void warranty.

Chair Maintenance

Lubrication is required on the drive shaft every 6 months. Yellow or white grease sold at auto part stores can be used. "Greasing Drive Shaft" for further instructions.

Remove dust on the backrest or armrest with a vacuum.

Do not use benzene, thinner or any other solvents on your massage chair.

If the backrest or armrests become soiled, wipe with a damp cloth, then a dry cloth (common vinyl cleaners may be used for tough stains.)

Use a dry cloth only to clean the controller and around the power switch.

Foreign objects should not be inserted between the massage nodes or the unit housing. Cover the chair when not in use for a long period of time.

If chair will be out of use for a long period of time, unplug and coil the power cord and cover the chair or place in an environment free for dust and moisture.

Prolonged exposure to direct sunlight can cause color fading and/or damage to the massage chair.

Pedicure Product Guidelines

Please follow these guidelines when choosing products to use in your pedicure spa.

Always use pedicure products and cleaning solutions in accordance with each manufacturer's directions.

Understand and follow your state regulations regarding proper product use and disinfecting requirements. This is solely your responsibility.

- Avoid products that contain a foaming agent; this will cause excessive foam.
- Products containing non-dissolving abrasives (such as sand and sea salts) will not harm the internal component structure of your pedicure spa as long as the spa cleaning requirements are followed after each use and each night. Refer to page 23 and 33.
- Oil based products may be used in your pedicure spa as long as the cleaning requirements are followed after each use and each night. Refer to page 23 and 33.

If you follow the operating, cleaning, and maintenance procedures, this pedicure spa can give you many years of service.