

Installation Guide

PRODUCT #: CNMST	ITEM: Maestro from Continuum Footspas		
		BRAND:	
		Continuum Footspas	
		SOURCE FOR PURCHASE:	
		SpaSalon.us 950 Herrington Rd. Ste C#237 Lawrenceville GA 30044 706-534-2349 www.SPASALON.US	
FEATURES: The Maestro footspa promises an enlightening experience guaranteed to satisfy the most discriminating clientele. The Maestro is as strong and beautiful as the arch itself. Sleek lines and distinctive looks highlight a footspa that is both inviting and functional. Featuring a cherry wood base, this pipe-less Solojet steady stream water system provides a pulsating massage. The basin is handcrafted, stain resistant and durable made from solid surface material similar to Corian. The dual and independent leg supports pivot upward to support the entire leg, not just the foot. Feet are perfectly positioned for massage and pedicure treatments. SO Sound Acoustic technology relaxes clients by resonating Sound Hearts™ embedded into a comfortable upholstered seat cushion made of Boltafex, an ultra soft, durable leather-like material available in black, burgundy, bone, white, or gray. Most operational functions are controlled by the touch of a button, electronically controlled seat slides and tilts smoothly and quietly. Seat swivels to assist clients in and out of the chair. Adjustable, color-coordinated neck/head rest, convenient cup holder/tray and drain pump are standard. Designed and manufactured in USA.			
SPECIFICATIONS: Dimensions: 70.4" L (179 cm) x 36.2" W (92 cm) x 55" H (140 cm) Electrical: 120V AC, 20 Amp, 60 Hz Separate and Dedicated 20 amp GFCI protected outlet must be used. Suggested Outlet: See Detailed Specifications Plumbing: Hot/Cold supply lines 1/2" ID Notes: Connections located on back of spa Warranty: 5 year warranty on basin, 1 year all other parts and accessories Certifications: ETL/CETL Certified Country of Origin: United States Installed By: Client's Contractor			

CAUTION - EXTREMELY IMPORTANT

THIS DRAWING IS NOT COMPLETE UNLESS
ACCOMPANIED BY AN ADDENDUM
ENTITLED:
"INSTALLATION AND ROUGH-IN INFORMATION".
PLEASE REVIEW IT CAREFULLY.

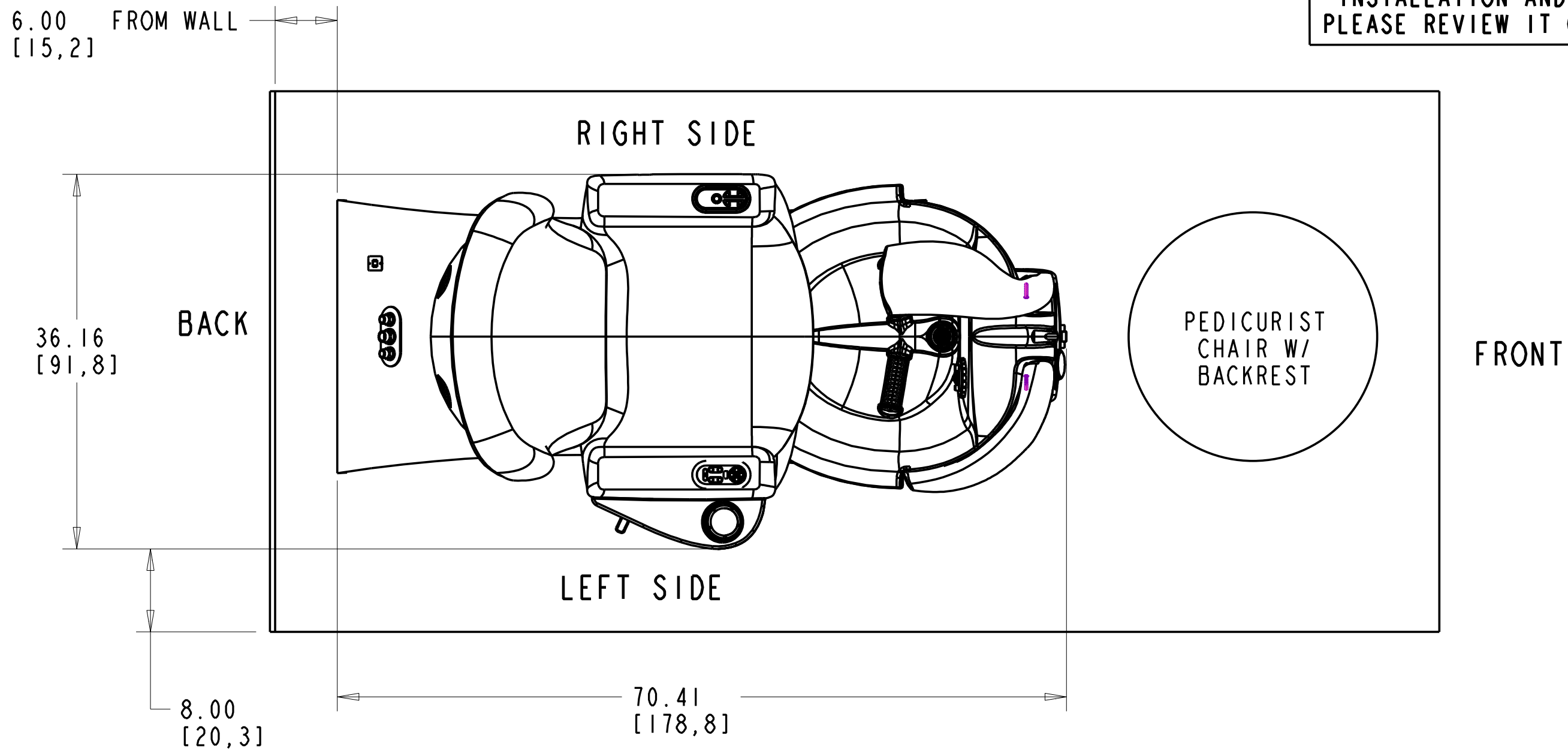

LEGEND:
UPPER DIMENSIONS ARE IN INCHES
LOWER DIMENSIONS [] ARE IN CENTIMETERS

SINGLE INSTALLATION - DRAWING #1

(DECEMBER, 2008)

CONTINUUM FOOTSPAS
MODEL: THE MAESTRO™
PH - 877-255-3030
WWW.CONTINUUMFOOTSPAS.COM

CAUTION - EXTREMELY IMPORTANT

THIS DRAWING IS NOT COMPLETE UNLESS
ACCOMPANIED BY AN ADDENDUM
ENTITLED:
"INSTALLATION AND ROUGH-IN INFORMATION".
PLEASE REVIEW IT CAREFULLY.

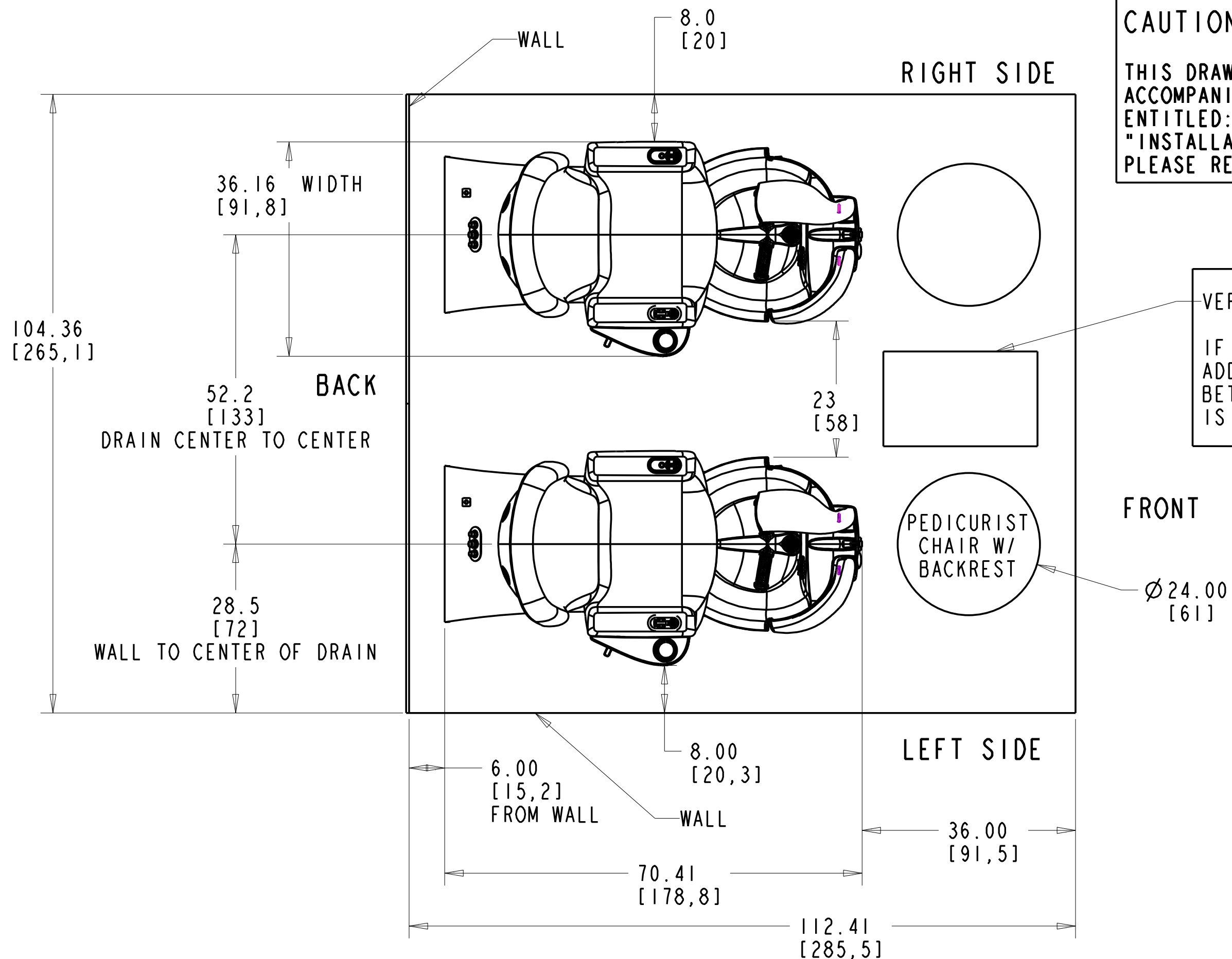
**VERY IMPORTANT:**

IF UTILIZING A CART, AN
ADDITIONAL 10" (25.4 CM)
BETWEEN EACH FOOT SPA
IS RECOMMENDED

(DECEMBER, 2008)

LEGEND:
UPPER DIMENSIONS ARE IN INCHES
LOWER DIMENSIONS [] ARE IN CENTIMETERS

MULTIPLE SIDE X SIDE INSTALLATION - DRAWING #2

CONTINUUM FOOTSPAS
MODEL: THE MAESTRO™
PH - 877-255-3030
WWW.CONTINUUMFOOTSPAS.COM

CAUTION - EXTREMELY IMPORTANT

THIS DRAWING IS NOT COMPLETE UNLESS
ACCOMPANIED BY AN ADDENDUM ENTITLED:
"INSTALLATION AND ROUGH-IN INFORMATION".

PLEASE REVIEW IT CAREFULLY.

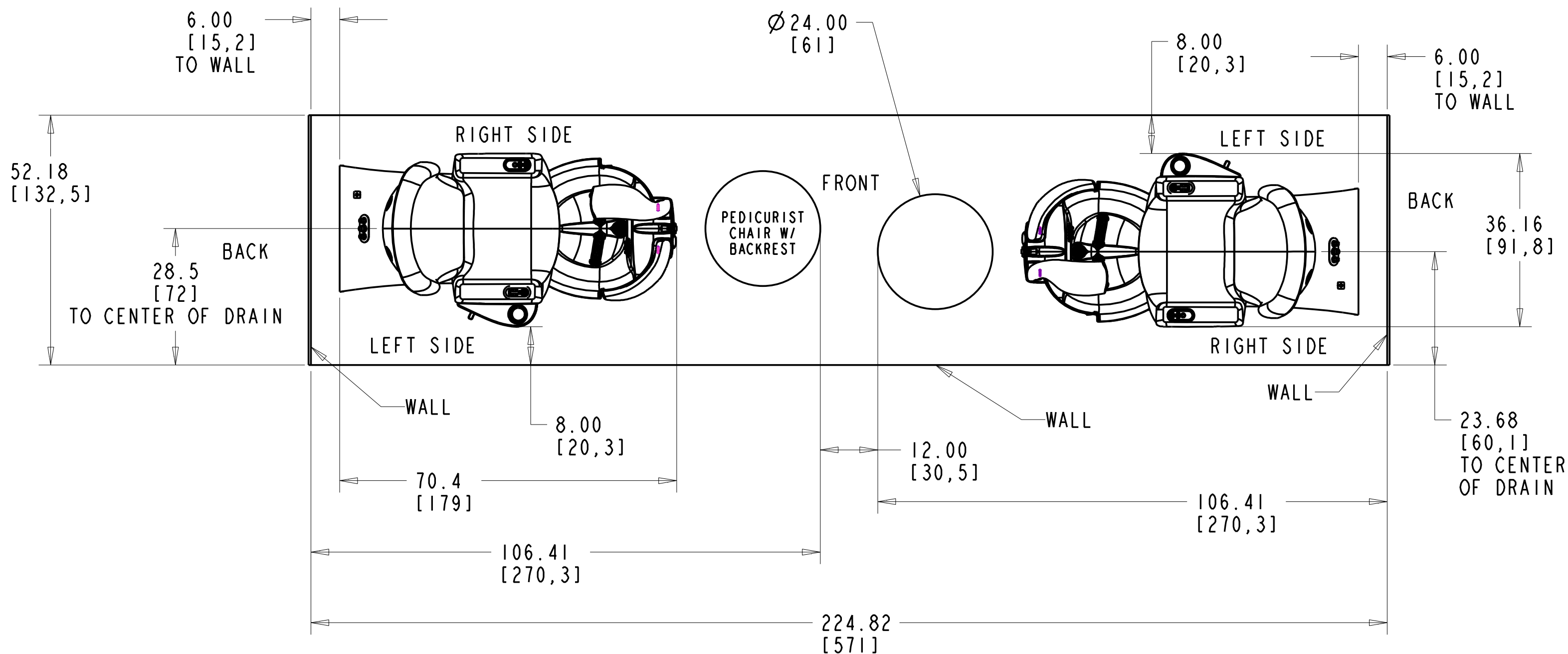

(DECEMBER, 2008)

ACROSS INSTALLATION - DRAWING #3

LEGEND:
UPPER DIMENSIONS ARE IN INCHES
LOWER DIMENSIONS [] ARE IN CENTIMETERS

CONTINUUM FOOTSPAS
MODEL: THE MAESTRO™
PH - 877-255-3030
WWW.CONTINUUMFOOTSPAS.COM

CAUTION - EXTREMELY IMPORTANT

THIS DRAWING IS NOT COMPLETE UNLESS
ACCOMPANIED BY AN ADDENDUM
ENTITLED:
"INSTALLATION AND ROUGH-IN INFORMATION".
PLEASE REVIEW IT CAREFULLY.

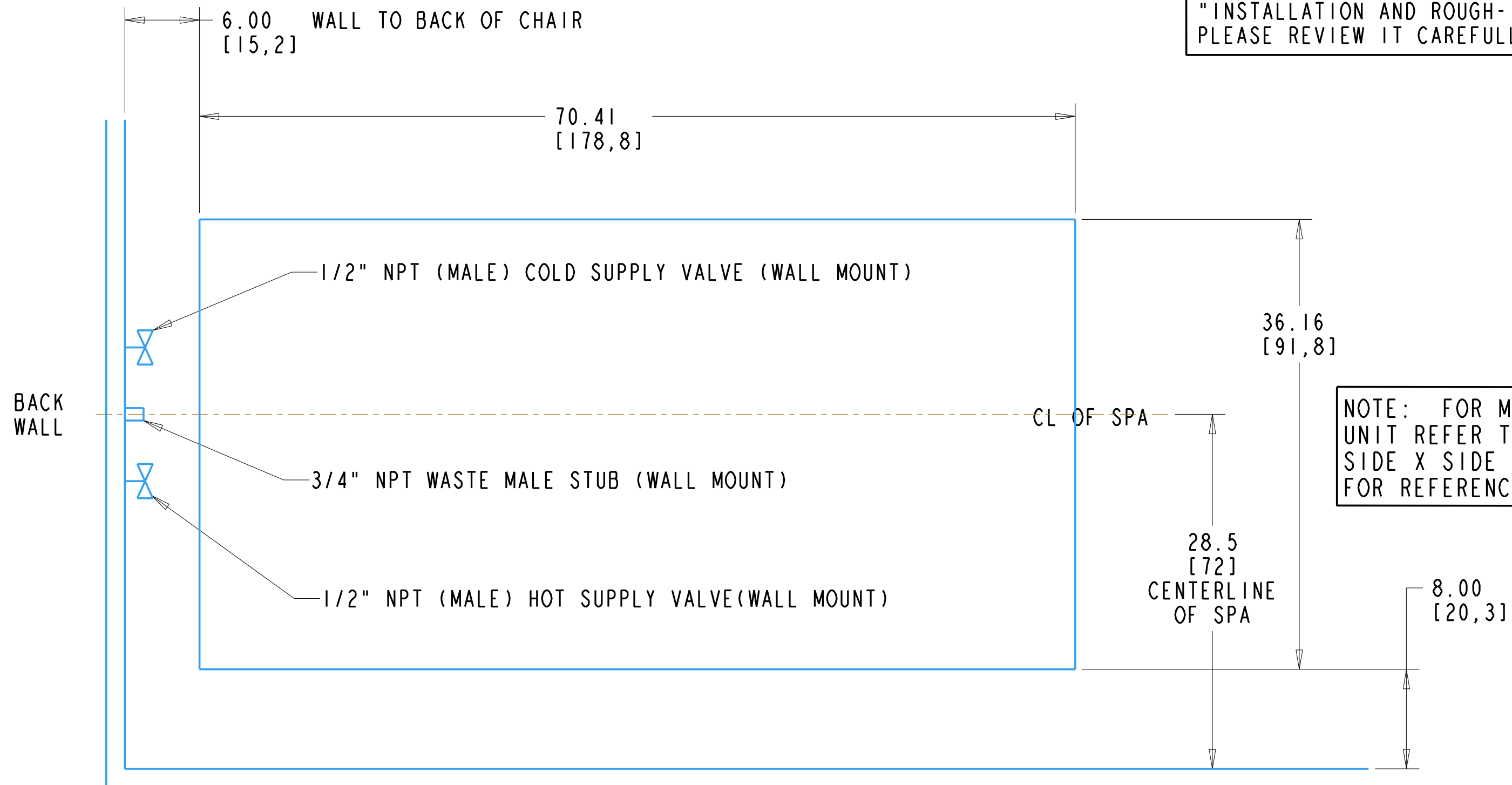

NOTE: FOR MORE THAN ONE
UNIT REFER TO THE MULTIPLE
SIDE X SIDE DRAWING #2
FOR REFERENCE DIMENSIONS

PLUMBING ROUGH-IN - STANDARD BACK WALL INSTALLATION - DRAWING #5

(DECEMBER, 2008)

LEGEND:
UPPER DIMENSIONS ARE IN INCHES
LOWER DIMENSIONS [] ARE IN CENTIMETERS

CONTINUUM FOOTSPAS
MODEL: THE MAESTRO™
PH - 877-255-3030
WWW.CONTINUUMFOOTSPAS.COM

INDIRECT WASTE RECEPTOR INSTALLATION - DRAWING #6

(IF AIR GAP IS REQUIRED BY LOCAL CODE)

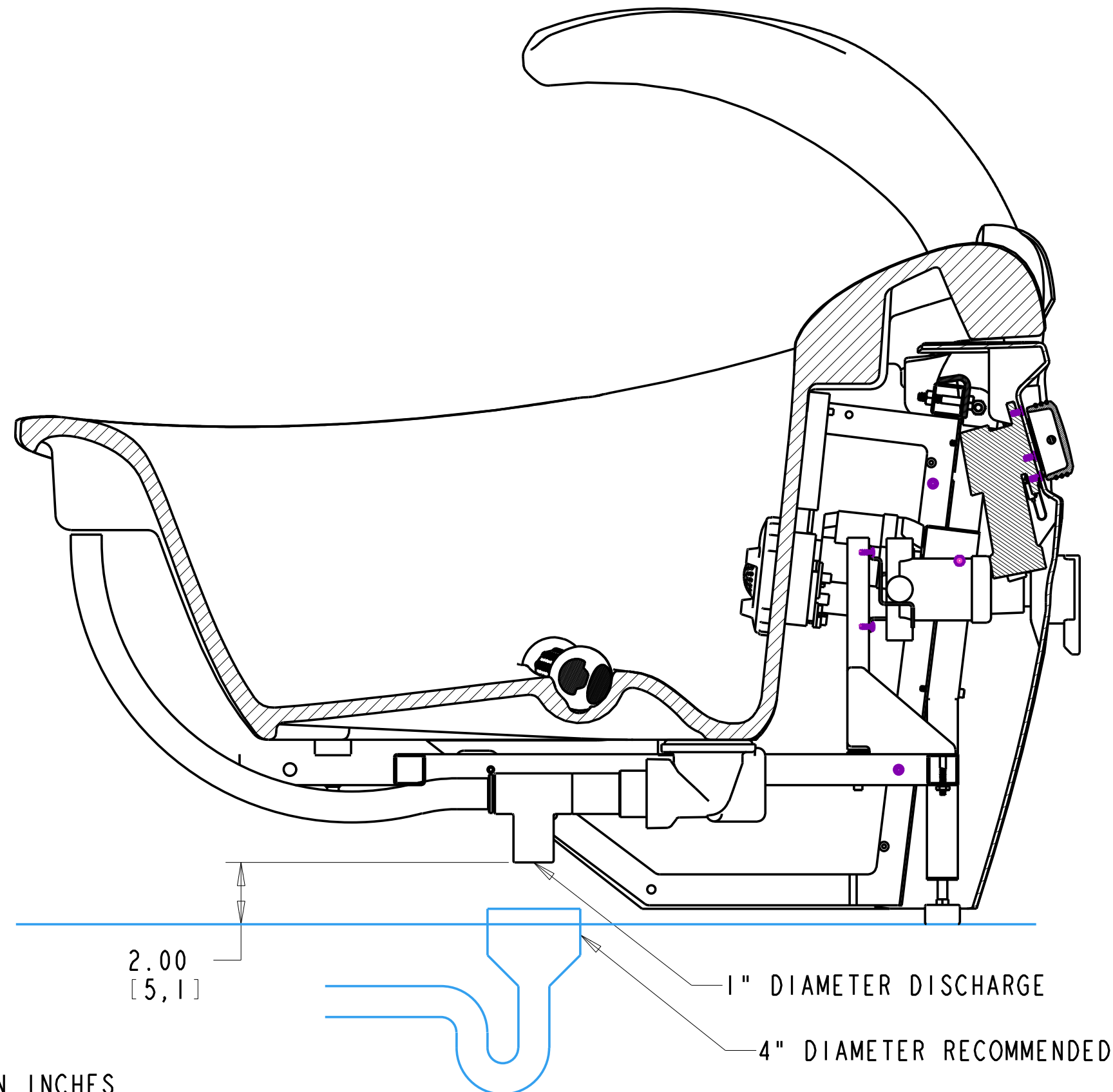

LEGEND:
UPPER DIMENSIONS ARE IN INCHES
LOWER DIMENSIONS [] ARE IN CENTIMETERS

(DECEMBER 2008)

CONTINUUM FOOTSPAS
MODEL: THE MAESTRO
PH - 877-255-3030
WWW.CONTINUUMFOOTSPAS.COM

Installation and Rough-In Information Addendum

- Upper dimensions are in inches, lower dimensions [] are in centimeters.
- The centerline dimension reflects the center of the basin. This does not reflect the center of the stated width as that particular dimension includes the cup holder shelf.
- For two or more units, refer to “Multiple Side X Side – Drawing #2 for reference dimensions.
- If utilizing accessory cart(s), an additional ten (10) inches (25.4 cm) between each unit is recommended. (Carts may be shared to save space)
- Electrical Requirements: One (1) dedicated 20 amp, GFCI protected wall outlet/circuit per unit located within two (2) feet of the rear of the unit. (Actual draw is 5 amps) Each unit will be supplied with a standard three (3) foot grounded power cord.
- Water Supply: One (1) each ½” hot and cold water supply. Preferred location through the wall behind the unit (suggested range 4” to 12” apart on center, 4” to 8” above the finish floor) or may be roughed up from the floor where shown. Provide ½” shut off valves and ½” male NPT connections.
- Water Discharge: Drain pump factory installed (unless otherwise specified). Wall drain required, ¾” ID NPT (male).

Special Information regarding gravity drain installations

- Always check with local plumbing inspectors for possible special requirements pertaining to pedicure units.
- Gravity drain is always preferred. If drain pump is NOT required, unit should be ordered WITHOUT drain pump.
- For gravity drain installations, refer to Plumbing Rough-In Drawing #4 and/or #5. If an air gap is required, also refer to Drawing #6.
- Gravity drain: One (1) 1-1/2” trapped waste is required. Outlet is 1-1/2” female PVC, 3” above the finish floor. A sleeve around the waste line may be necessary to allow for connection to the unit drain connection. Installation is similar to that of a bathtub.

MODEL: THE MAESTRO™

PH- 706-534-2349

WWW.SPASALON.US

MAESTRO® PEDICURE SPA

Specifications

Dimensions: 70.4" L (179 cm) x 36.2" W (92 cm) x 55" H (140 cm)

Shipping Dimensions (Carton Size): 84" L (214 cm) x 40" W (102 cm) x 61" H (155 cm) The Maestro ships fully assembled.

Net Weight: 310 lbs (141 kg)

Shipping Weight without accessories: 408 lbs (185 kg)

Shipping Weight with accessories: 463 lbs (210 kg)

Client Weight Capacity: 300 lbs (136 kg)

Basin Capacity: 6.8 US Gallons (25.7 liters)

Power Requirements: 120V AC, 20 Amp, 60HZ. A **separate and dedicated** 20 Amp GFC protected circuit MUST be used for each foot spa.

Construction: Welded steel frame with cherry veneered wood panels. ABS cover panels.

Basin: Solid surface, pre-plumbed.

Jet System: Two (2) self contained NoPipe™ Jets; removable screens, no recirculating pipes.

IMPORTANT: The Maestro Pedicure Spa MUST be installed by a licensed electrician and a licensed plumber in accordance with all national, state and local codes/regulations.

Plumbing:

Incoming: Hot/Cold supply lines required (1/2" ID), solenoid controlled, built-in fill sensor. Connections located on back of spa.

Discharge: Gravity drain or optional factory installed drain pump.

NOTE: If through floor installation is desired, refer to Plumbing Rough-in drawing (available at ContinuumFootspas.com). See Owners Manual for complete installation instructions.

Massage: Exclusive Acoustic Therapy relaxation system.

Built-in MP3 player, Headphones included.

Controls: Technician's keypad: Fill, Jets, Sprayer, Clean and Drain. Also, Seat Forward/Backward and Tilt.

Armchair: Left Side: Seat Forward/Backward, Tilt and Exit.

Right Side: Acoustic Therapy relaxation system.

All Controls are low voltage.

Certification: ETL Certified



Limited Warranty*: Basin- Sixty (60) months from date of shipment from Continuum Footspas facility.

All other parts and accessories - Twelve (12) months from date of shipment from Continuum Footspas facility.

Labor: Twelve (12) months labor may be covered under this Limited Warranty. Refer to Owner's Manual for complete details.

***See Limited Warranty for complete details**

ACCESSORIES:

Technician's chair: Base: 24" diameter (61 cm) Height range: 15.5" to 20" (39 cm to 51 cm) Net weight: 15 lbs (6.80 kg)

Shipping Dimensions: 25" W (64 cm) x 24" L (61 cm) x 12" H (31 cm) Shipping Weight: 19 lbs (8.6 kg)

Accessory Cart: 25" L (64 cm) x 18" W (46 cm) x 23" H (58 cm) Net Weight: 33 lbs (14.9 kg)

Shipping Dimensions: 24" W (61 cm) x 28" L (71 cm) x 11" H (28 cm) Shipping Weight: 35 lbs (16 kg)

Note: Due to continuous improvements, all specifications are subject to change without notice. All dimensions and weights are approximate.

UNPACKING INSTRUCTIONS

CAUTION!

EXTREMELY IMPORTANT

READ CAREFULLY

ANY QUESTIONS? CALL SPASALON.US

TOLL FREE AT 1.888.400.2648

- **This Pedicure Chair is very heavy. It weighs approximately 310 pounds. Three (3) to four (4) able-bodied men are required to move your pedicure spas into your facility. Please make certain these arrangements are made prior to delivery.**
- **Chair ships fully assembled.**
- **DO NOT remove chair from base.**
- **Lifting ropes have been provided.**
- **DO NOT LIFT BY WOOD BASE.**
- **Lift front of pedicure chair by left and right side of basin.**
- **DO NOT LIFT BY LEG SUPPORTS.**
- **A 1/2" open-end wrench is required to remove the four (4) shipping brackets. (Included)**
- **Do not discard the four (4) shipping brackets. They may be used to secure pedicure chair in location.**