



LX

**SpaSalon.us**  
*wholesale*

## OWNER'S MANUAL

Please read user's Manual thoroughly  
before using pedicure spa

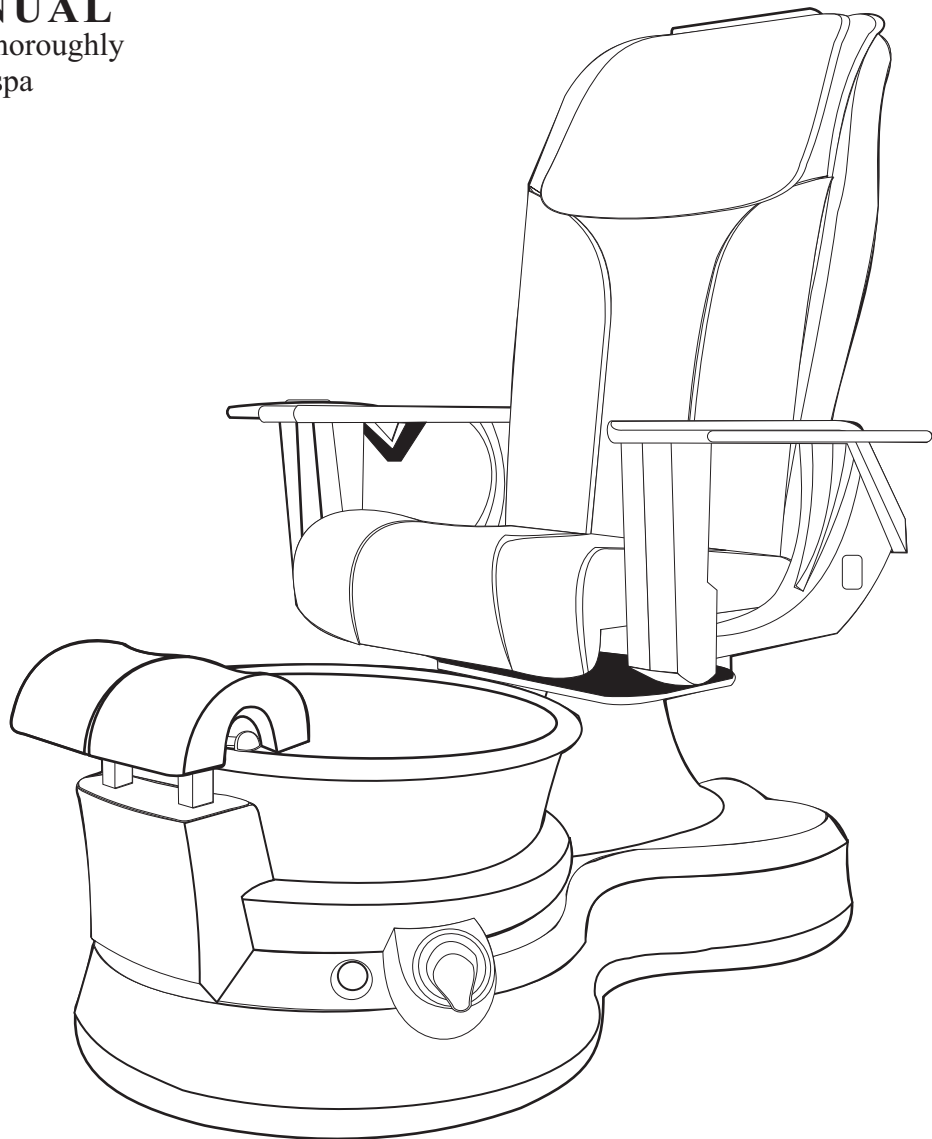

## **Table of Contents**

Table of contents	2
Warranty form	3
Service inquiry form	4
Introduction & Safety	5
Important Consideration	6
Identify parts & Description	7
Specification	8
Dimension	9
Drain Connection	10
Rough end (Plumbing)	11--15
Magna-Jet Pipeless System	16
Power Discharge Pump	17
Maintenance (Massage Mechanism)	18
Assembly Instruction (Chair)	19
Disinfecting Pedicure Spa	20
Trouble Shooting	21
User's Recommendation	22
UL Certification	23
Back Flow Prevention Device Dual Check Valve Information	24
JSG Oceana Implied Warranty	25
Warranty	26



# Important Considerations

## Electrical Service

110V, 60Hz, 15Amp GFCI protected grounded circuit **MUST** be used to supply power each individual pedicure spa. And the main circuit breaker **MUST** be at 25Amp. For maximum of two units per each electrical outlet.

## Water Supply

All plumbing connections must conform to local codes.

Water supply to the spa should be provided with adequate water pressure and water temperature.

## Water pressure

To fill the basin correctly up to level, Normal water pressure of 30 to 80 P.S.I is required.

## Water temperature

The hot water supply temperature must not exceed 140°. Adjust your hot water accordingly. For hot and cold water supply fittings and drain fittings location, see below diagram .Carefully connect the water supply line to the appropriate fittings located on the rear of the pedicure spa.

## Pressure / Temperature

Maximum Pressure: 150 psi (10 bars)

Minimum Pressure: 10 psi (69kPa)

Working Temperature: 33F to 140F constant; intermittent to 180f  
(0.6C to 60C sustained; intermittent to 82.2C)

Maximum Recommended Flow: 1.5gpm

## UL LISTED / CE CERTIFIED

Compliance with following Code (s): Uniform Plumbing Code, National Plumbing Code of Canada and international Plumbing Code. Also, Compliance with following Standard (s): ASME A112.18.3M / A112.18.1M, CSA B125, NSF / ANSI 61

ANSI - American National Institute, ASME - American Society of Mechanical Engineers, CSA - Canadian Standard Association IAPMO - International Association of Plumbing and Mechanical Officials, UL - Underwriters Laboratory

All J&A USA products has been compliance with requirements for Whirlpool bath appliances contained in ASME / ANSI A122.19.7M-1995, CSA C22.2 No. 68-69

## **\*\* Vaccum Breaker**

Due to Town and / or State requirement/s are varies in building code, if the Town and / or State requires Vaccum Breaker, As the Plumber **MUST** provide Vaccum Breaker according to building code requirement.

## Drain Facilities

The pedicure spa Drain must meet local plumbing codes. **Check valve for Drain (not Provided) Must be installed by a licensed plumber.** Also Pedicure spa must be securely fasten to the floor.

## Installation Summary

The installation must comply with local, state, and federal building, plumbing and electrical codes, where applicable. A licensed plumber should complete the plumbing of the pedicure spa.

Note: Failure to comply with federal, state, or local codes and ordinances will result in warranty being nullified and void.

## IDENTIFICATION

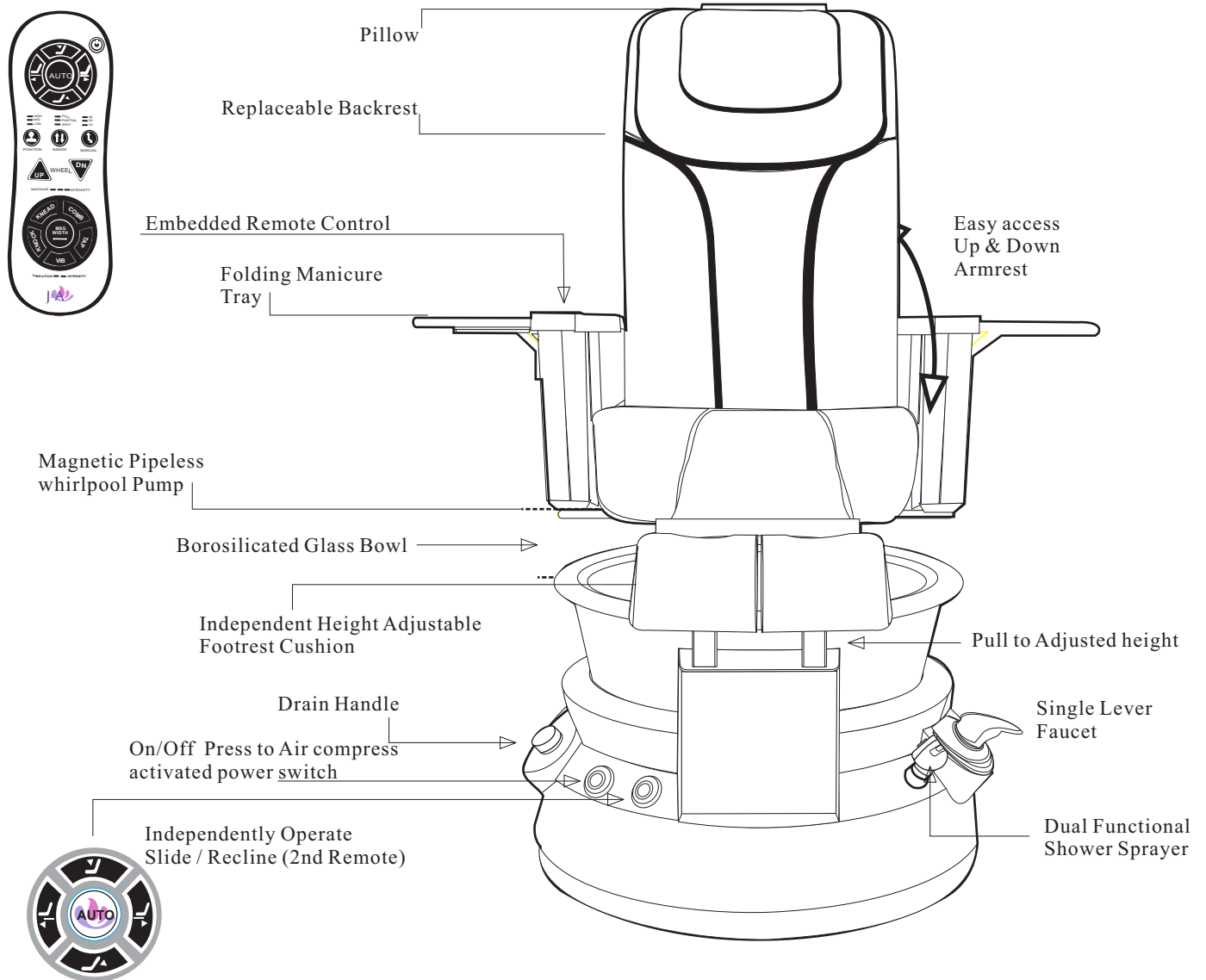

## BASIN

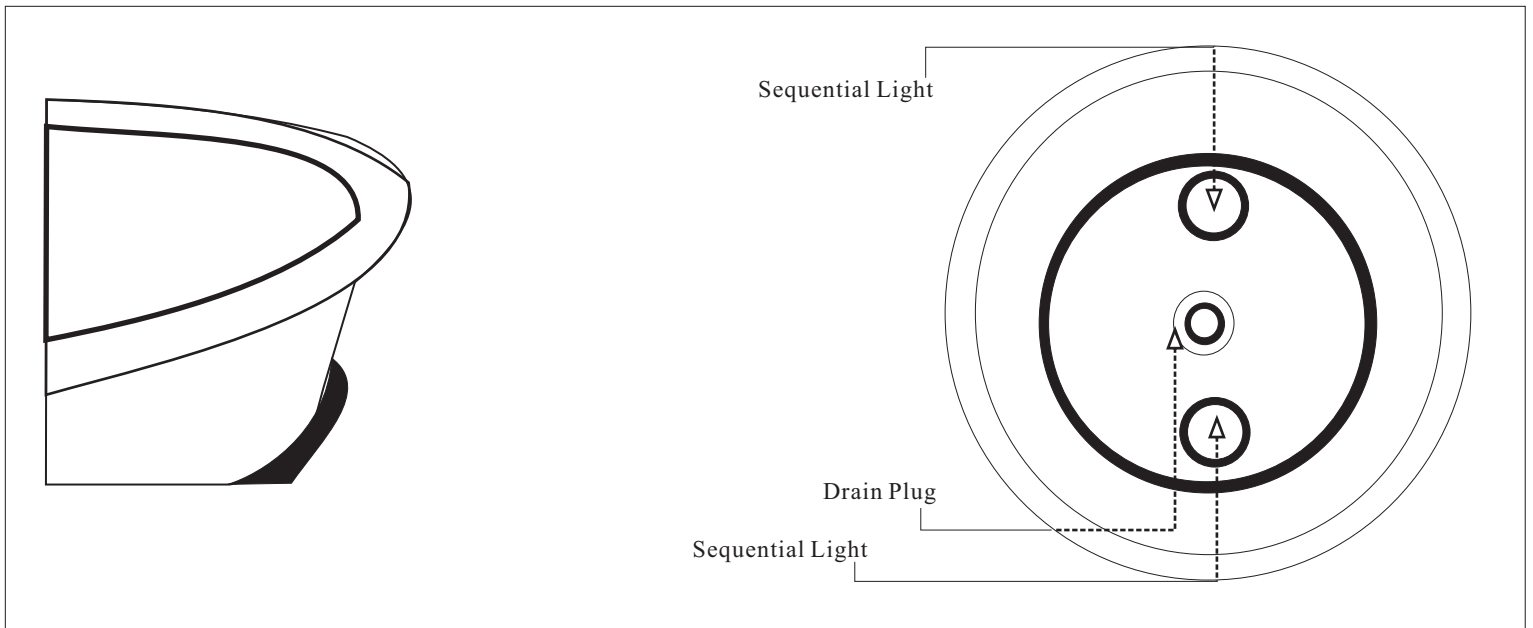

Specification



**CAUTION: Pedicure spa must be installed by a licensed electrician and a licensed plumber, conforming to all local and national electrical codes.**

Dimension & Weight (Shipping)	Lenox Pedicure Spa Stool	67L x 37W x 40H 20.25L x 27.25W x 17H	285lbs 20lbs
Capacity of Tub Switch	Lenox LX	5 GAL. On/Off Air Activated Switch	
Power Source	Dedicated 15 Amp. GFCI protected Ground outlet Magna-Jet Pipelss Massage System	115 Vac. 60Hz. 3.2 Amp. 120 Vac. 60Hz. 3.12Amp. 75W	
Plumbing	Hot Water Cold Water Drain	0.5 inches (Fitting Provided) 0.5 inches (Fitting Provided) 1.5 inches (See detailed instruction)	
Warranty	Epi - Lenox Pedicure Spa	One year Parts and labor	

All J&A products are equipped with Back Flow Prevention Device Dual Check Valve :  
TESTED AND CERTIFIED TO MEET NSF61 / 372 Complies with ANSI/ASME A112.18.3M, A112.18.1M AND CSA B125

Due to continuous improvement on all our products, followings are subject to change without notice: specification, characteristics, packing, information, color and design

Dimension

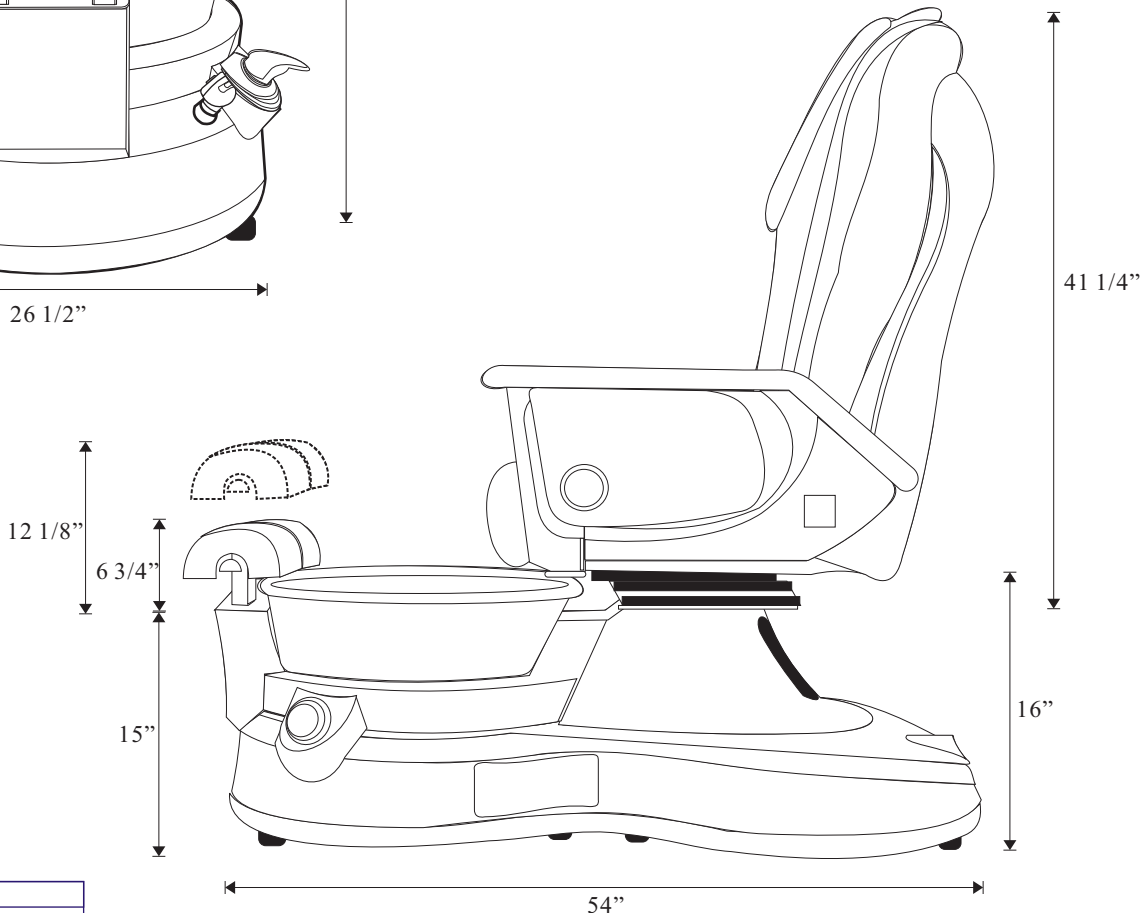
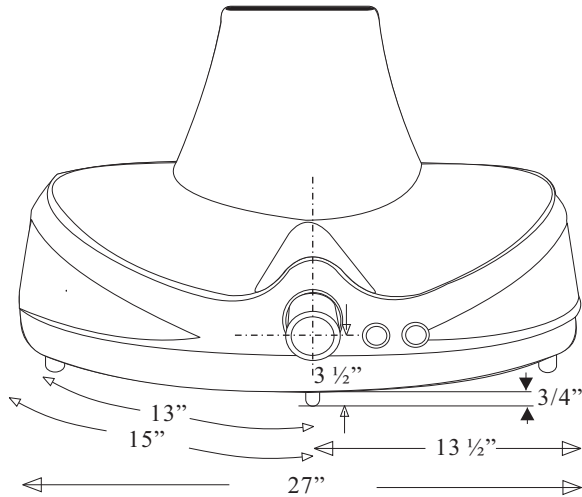
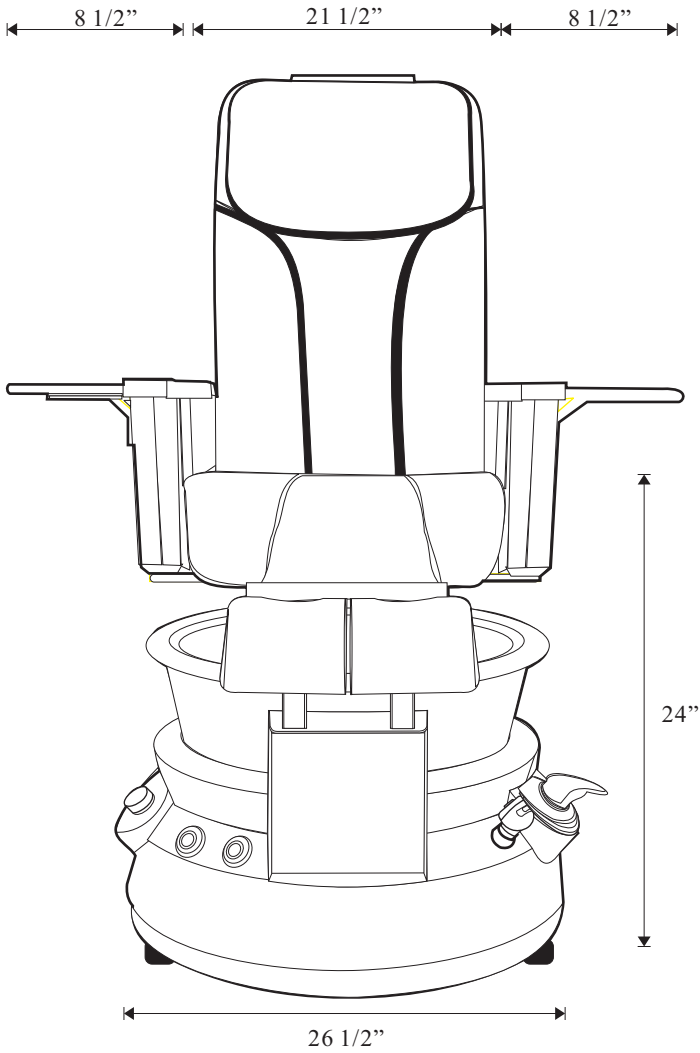

	Model :
USA Inc.,	Lenox LX
	Prepared by :
/Side	J&A USA Inc.

**Drain Connection**

Wall Drain

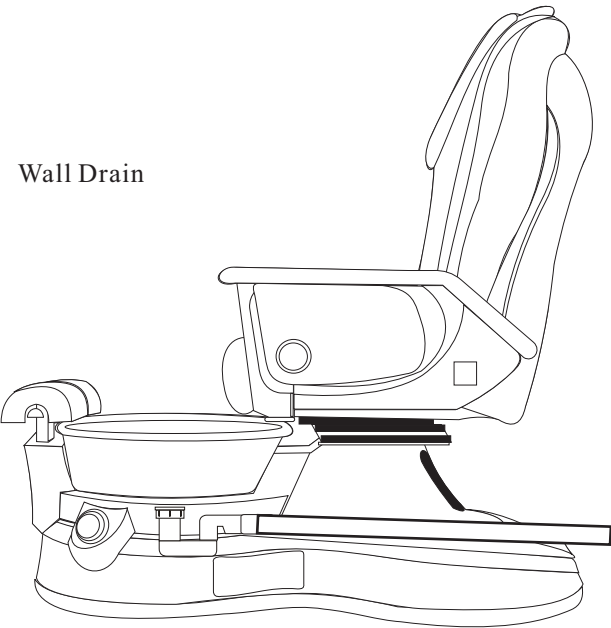

Basement Drain Connection  
(Not Recommended as Floor Drain)

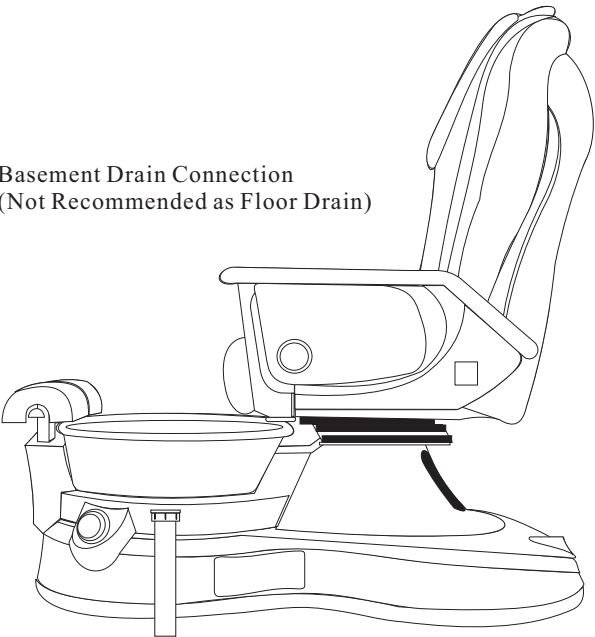

Rear View  
Drain / Hot Cold Water

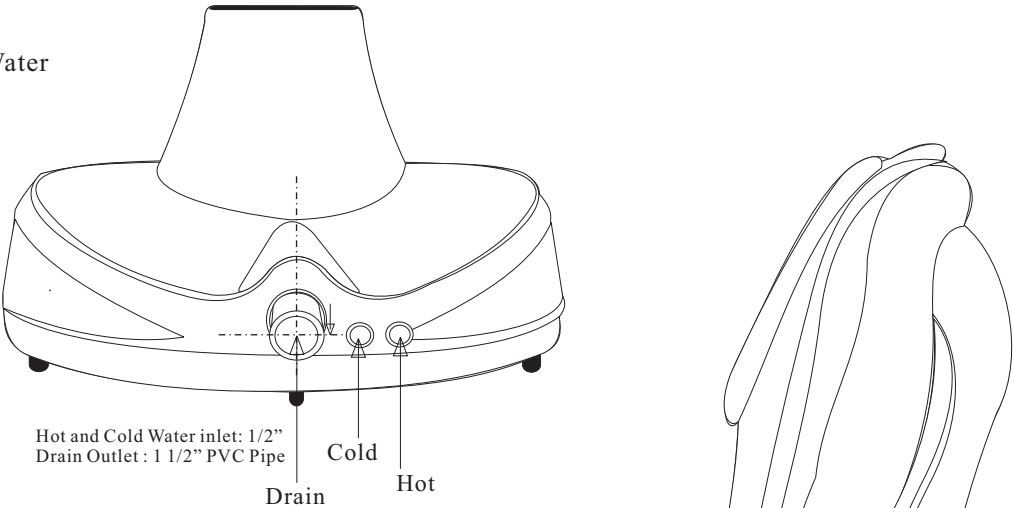

Discharge Pump- Optional  
(See Detailed)

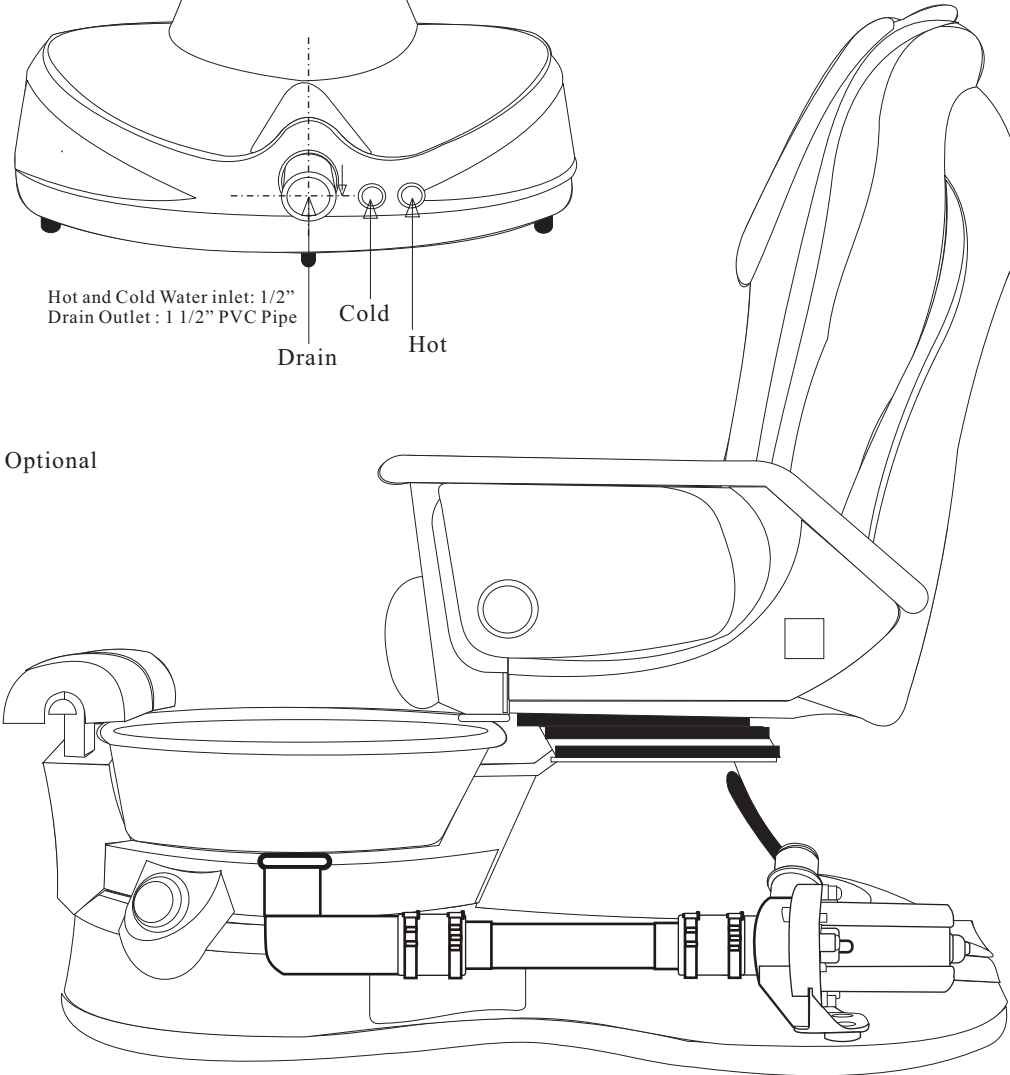

## Installation Specifications Summary

**Warning:** Failure to comply with federal, state or local codes and ordinances will result in warranty being null and void.

As stated, the pedicure spa installation must comply with all plumbing and electrical codes. A licensed plumber and licensed electrician must complete the applicable connections of the pedicure spa.

### Location and support

Select a level location. The floor structure beneath the pedicure spa must be capable of supporting the occupied pedicure spa.

For the seat back to fully recline, the pedicure spa base must be mounted as follow from the wall as shown below:

\*\*\* When chair slide all the way back – would require 14 inches from the wall\*\*\*



Due to continuous improvements on all our products, specification, characteristics, packing, color, designs are subject to change without notice.



## **MAGNA-JET (OPTIONAL)**

### **Safety Instructions**

**When using electrical equipment, Basic safety precautions must be followed to reduce the risk of fire, electrical shock, and injury to Persons.**

1. Read and follow all instructions before using the equipment.
2. Keep electrical cord out of heavy traffic area. To avoid fire hazard NEVER place electrical cord under the rug, near heat Generating devices.
3. Always turn power off the equipment before service.
4. Do not drop or insert any object into any openings.
5. Do not operate any equipment with damaged parts.
6. Any other use not recommended by the manufacturer may cause electrical shock or cause injury to person/s.
7. Never use it outdoors
8. Do not attempt to repair or adjust any electrical or mechanical.

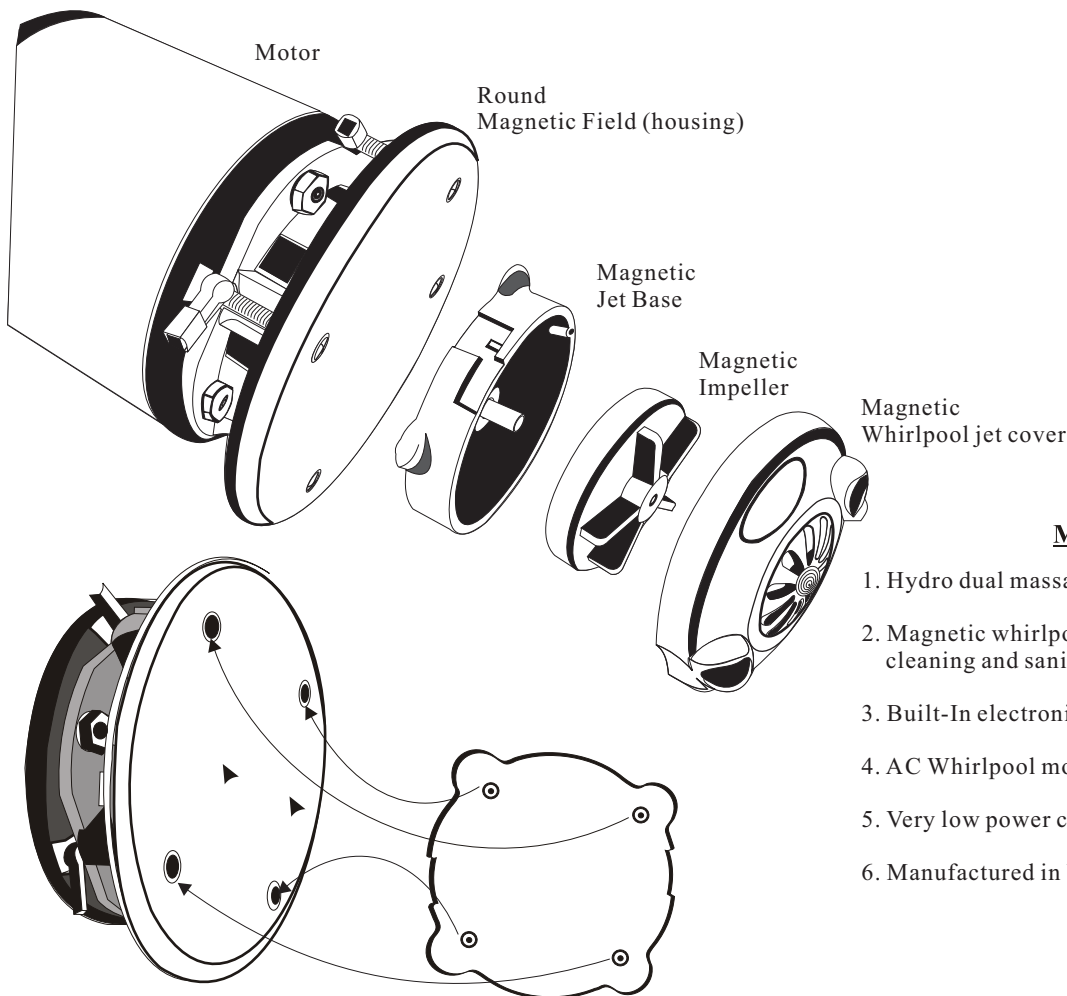

### **MAGNA-JET Features**

1. Hydro dual massage jet stream
2. Magnetic whirlpool jet cover can be remove for quick cleaning and sanitizing.
3. Built-In electronic sensor for pump control.
4. AC Whirlpool motor (long life)
5. Very low power consumption (27W)
6. Manufactured in USA.

### **Cleaning Instruction**

1. Turn off the unit and wait until the motor is fully stops.
2. Hold Hydro whirlpool jet cover firmly and pull to separate from the round magnetic field.
3. Turn hydro whirlpool jet cover to left to open and pull out impeller.
4. Use Anti - Bacterial solution (EPA Registered) to clean all parts.
5. After sanitize all parts, place impeller and close hydro whirlpool jet cover to turn right to lock
6. Hold firmly the whirlpool cover jet and gently place it onto the round magnetic field. Do not release the hydro whirlpool jet cover until Jet cover is on the round magnetic housing.

### **MAGNA-JET Specifications**

Model: MAGNA-JET - 120VAC, 60Hz, 1.0Amp,

Pump: Hydro-Massage Dual jet Flow

Mounting: Single 3.5" hole Diameter  
Auto tighten Mounting screws(4)

## How to USE Magnetic jet !

**WARNING:** DO NOT RUN DRY, BASIN MUST FILLED WITH WATER TO LEVEL INDICATOR.

**CAUTION: MAGNETIC JET COVER ASSEMBLY MUST ALIGN WITH DISCHARGE PORT POSITIONED AT 3/9 O'CLOCK.**

WHEN READY TO USE, **MAKE** SURE JET COVER IS POSITIONED AT **3/9 OCLOCK** FOR PROPER WHIRLPOOL ACTION IN THE BASIN. IF JET COVER IS **NOT** ALIGN AT 3/9 O'CLOCK, WATER WILL SPLASH OUTSIDE OF THE BASIN.



### **PROPER WAY TO USE MAGNETIC JET SYSTEM**

1- FILL THE WATER TO WATER LEVEL INDICATOR.

2- HOLD MAGNETIC JET FIRMLY TO BRING CLOSER TO THE ROUND MAGNETIC FIELD AND DO NOT RELEASE

THE MAGNETIC JET PREMATURELY OR THIS WILL CAUSE IMPACTS ON THE JET COVER AND THE ROUND

MAGNETIC FIELD(HOUSING) SHORTENING THE LIFE EXPECTANCY OF THE JET COVER. WHEN THE JET COVER NEARS THE ROUND MAGNETIC FIELD, PLACE JET COVER ONTO THE FOUR DIMPLE AREA (SEE

DIAGRAM). THE JET COVER MUST ALIGN WITH DISCHARGE PORTS POSITIONED AT 3/9 O'CLOCK.

3- WHEN FINISHED WITH CLIENT, DO NOT REMOVE MAGNETIC JET UNTIL MOTOR IS FULLY STOPPED.

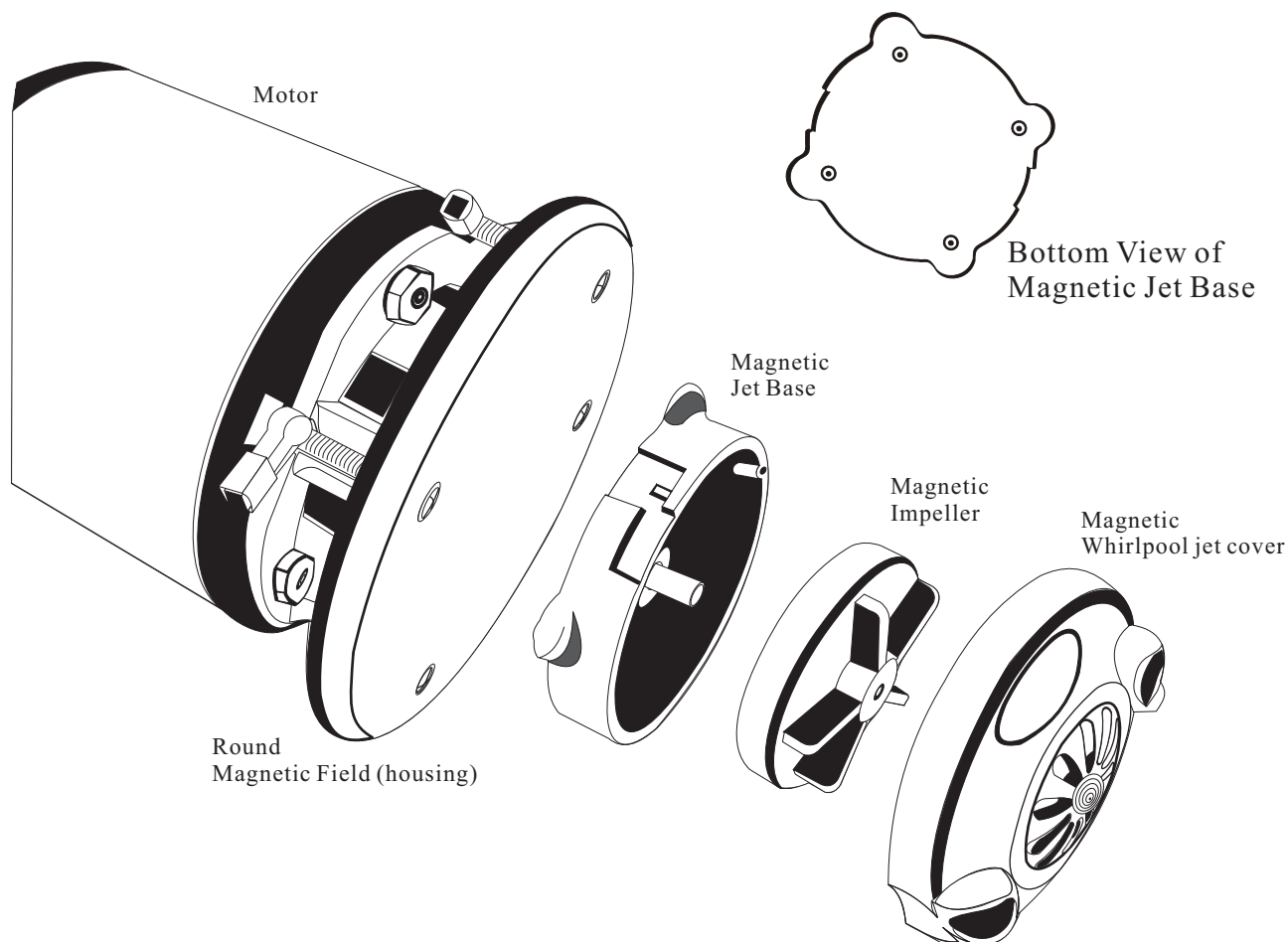

# Ultra jet Whirlpool Motor

## Safety Instructions

**When using electrical equipment, basic safety precautions should always be followed to reduce the risk of fire, electrical shock, and injury to persons, including the following:**

1. Read and follow all instructions before using the equipment.
2. Keep the cord out of heavy traffic area. To avoid fire hazard NEVER put the cord under the rugs, near heat generating devices.
3. Always turn off the equipment before servicing.
4. Do not drop or insert any object into any openings.
5. Do not operate any equipment with a damaged parts.
6. Any other use not recommended by the manufacturer may electrical shock or injury to persons.
7. Never use outdoors
8. Do not attempt to repair or adjust any electrical or mechanical functions on the unit.

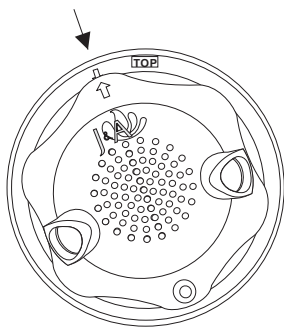

Close Jet Cover

1. Align an arrow line
2. Turn to right (Top indicated)

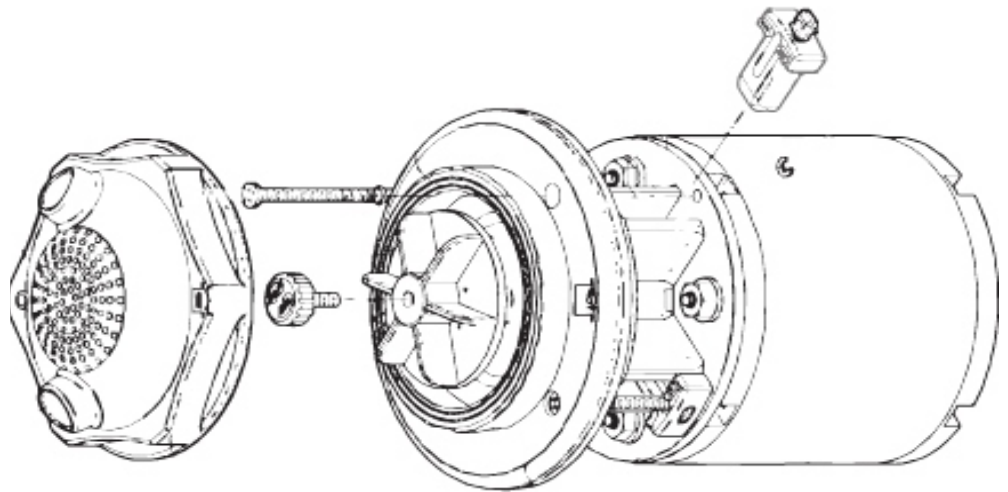
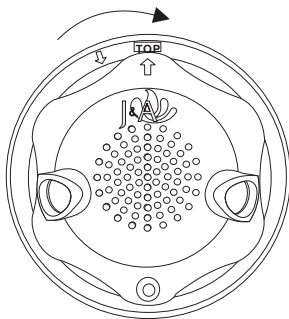

### Ultra Pipeless Jet whirlpool motor

1. Dual powerful massage jet-streams
2. Jet assembly can be attached from the pump for quick cleaning and sanitizing.
3. Thermally Protected
4. AC motor (long life)
5. Extremely low power consumption .

## Cleaning Instruction

1. Turn the unit off and wait until the motor is fully stops.
2. Remove the front jet cover and notice the locking screw in the center
3. Remove the locking center screw (Indicated an Arrow) and pull out impeller from housing.
4. Use Anti-Bacterial solution (EPA Registered) to clean all part/s.
5. After sanitization, place impeller onto the motor shaft and fasten with center locking screw ( Opposite arrow)

## Ultra Pipeless jet Whirlpool Motor Specifications

Model: CS-0216A-MT

Rating: 120VAC / 60Hz, 0.4A - thermally Protected

Pump: Dual whirlpool Jet Flow

Mounting: Single 3.5" hole Diameter  
Auto tighten Mounting screws(4)



## Discharge Pump ( Optional):

Up to 4ft @ +/- 39 sec. with 1/2" Connection to main drain

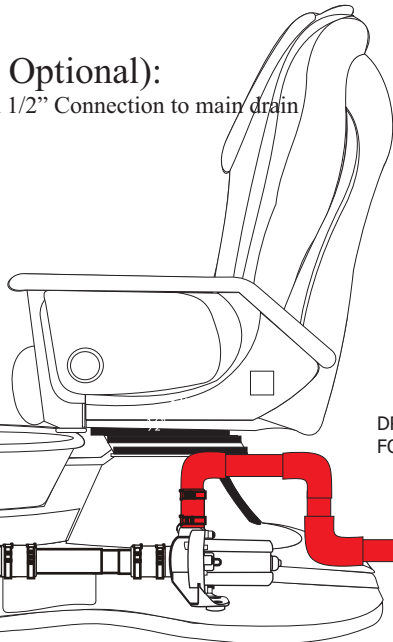
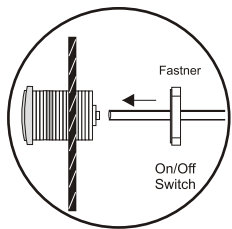

DRAIN OUTLET MUST BE 1/2" FOR EFFICIENT DRAINAGE.

1/2" Brass Check Valve  
PLUMBER MUST BE UTILIZED TO INSTALL CHECK VALVE

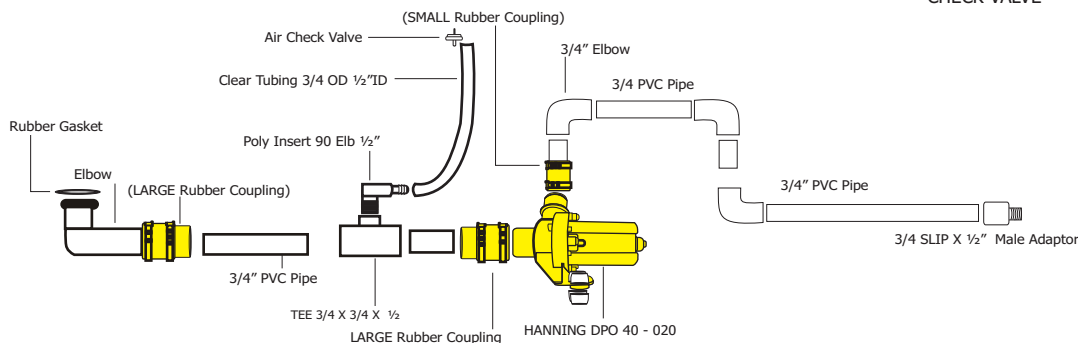

Electrical Control Box  
(Located left bottom inside of base)

3/8" clear Tube from On/Off Switch for Part time control box

## Installation Instruction

1. Make a hole ( size 1-3/8") for the On/Off switch as shown (see fig 1). Pre-drill required.
2. Placed a 1/8" clear hose into the rear of the switch and on/off switch into the hole.
3. The discharge pump kit is made to fit onto the pedicure unit. (see fig 2)
4. Connect E-Z connector onto the drain elbow.
5. Plug discharge pump outlet into the two minute timer outlet
6. Plug two minute timer into the wall outlet.
7. It is very important that tip of the clear tub remain above the water Level with one loop as shown.

**\*\* Please cut to fit 1" Flex hose to your size\*\***

## Operation Instruction

**Please! DO NOT run dry**

1. Turn to open drain plug.
2. Press On/Off switch to activate timer.
3. At any time, water drain completely from the basin. Press On/Off switch to stop or built in two minute timer

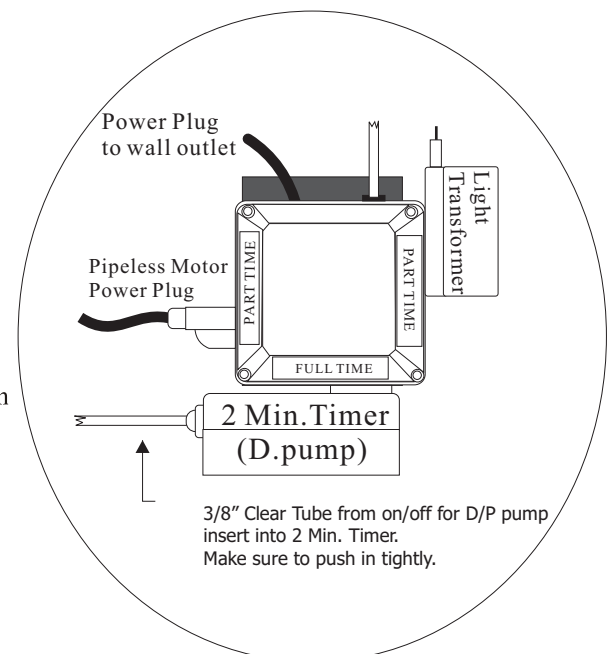

3/8" Clear Tube from on/off for D/P pump insert into 2 Min. Timer.  
Make sure to push in tightly.



## Remote Controller Functions

**INCLINE**  
Press down to move chair  
To desirable angle.

**FORWARD**  
Press to hold to move  
chair to desirable position

**AUTO**  
Pre-Programmed Automatic  
Massage with 2 Selection

**POSITION**  
User's Height  
(HIGH / MID / LOW)

**WHEEL**  
Adjust Massage Wheels  
Up and Down to desirable  
position.

**KNEADING**  
3 Selections of Kneading Intensity

**KNOCKING**  
Impulse Tapping Massage.  
2 Selections of Knocking Intensity

**VIB**  
2 Selections of Intensity for Seat  
vibration Massage.



**POWER**  
On / Off

**BACKWARD**  
Press to hold to move  
chair to desirable position

**RECLINE**  
Press down to move chair  
To desirable angle.

**MANUAL**  
Press for Manual MODE with  
Time Selection of 10~30 Mins.

**RANGE**  
FULL / PARTIAL / SPOT  
3 Selections

**MSG**  
Keep Pressing to Massage Wheel  
to the intended Massage Width.

**COMB**  
Kneading / Tapping / Knocking  
Combinations

**TAP**  
3 Selections of Tapping intensity

**SHIATSU**  
1. Press Manual / Timer to choose  
Shiatsu Massage Time Selection

2. Press Massage Range to Select  
FULL or PARTIAL Travel  
Position.

3. Press Tapping Width to fine  
tune comfort.



## 2nd Remote Control Connection to Main PCB

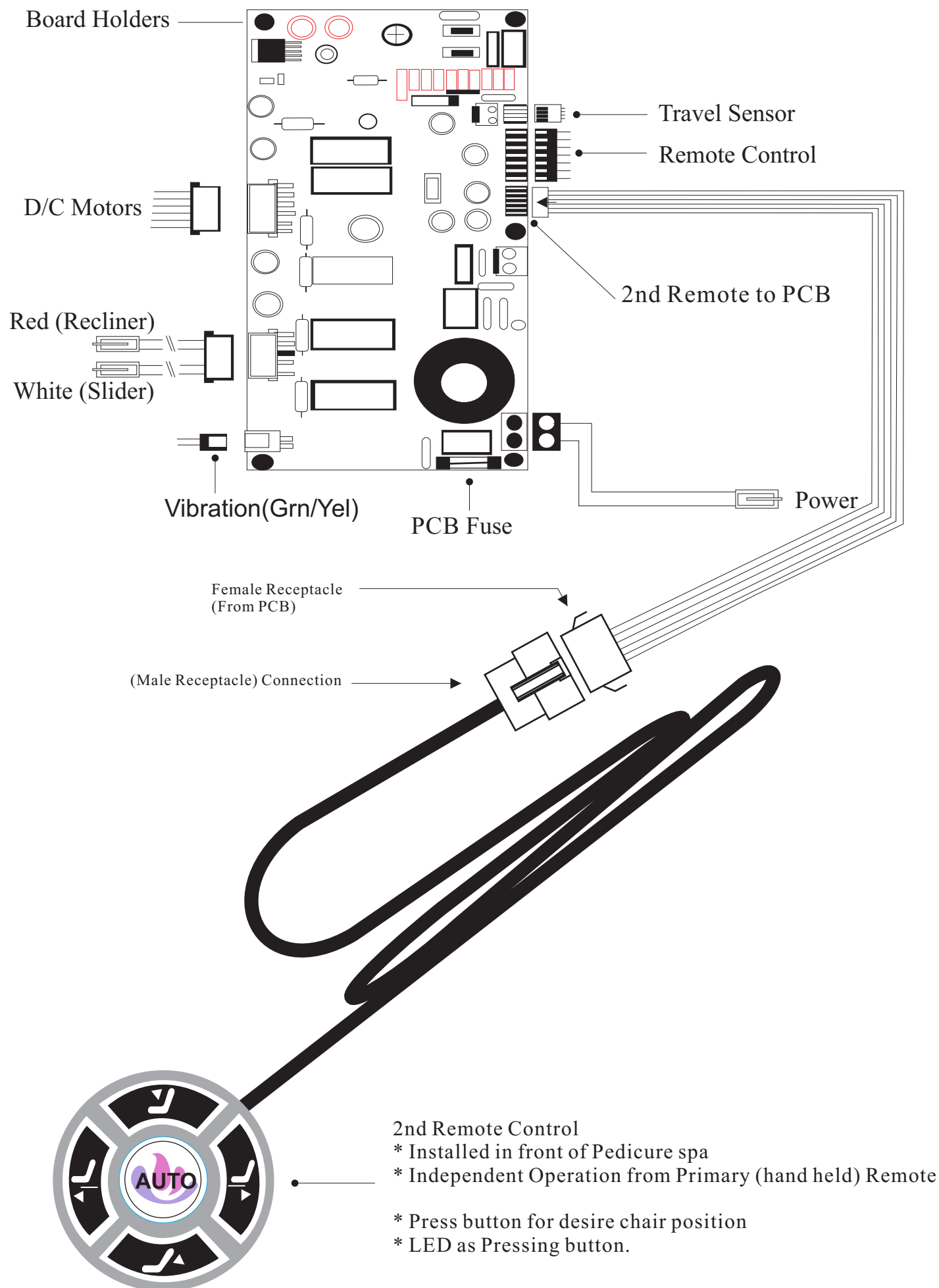

Massage Mechanism (Lenox LX)  
Massage Mechanism Exposed View

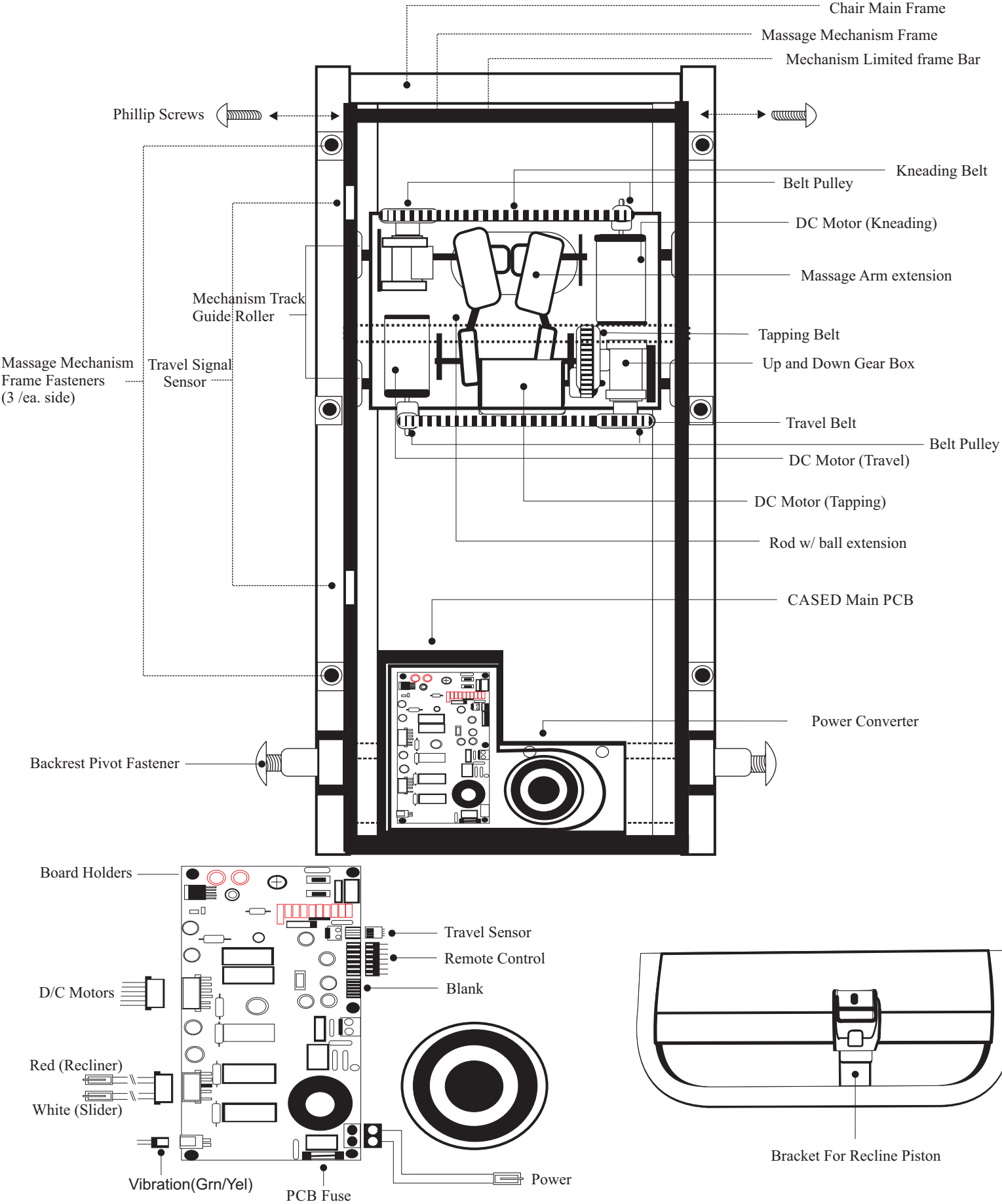



## Placing Backrest in Correct position

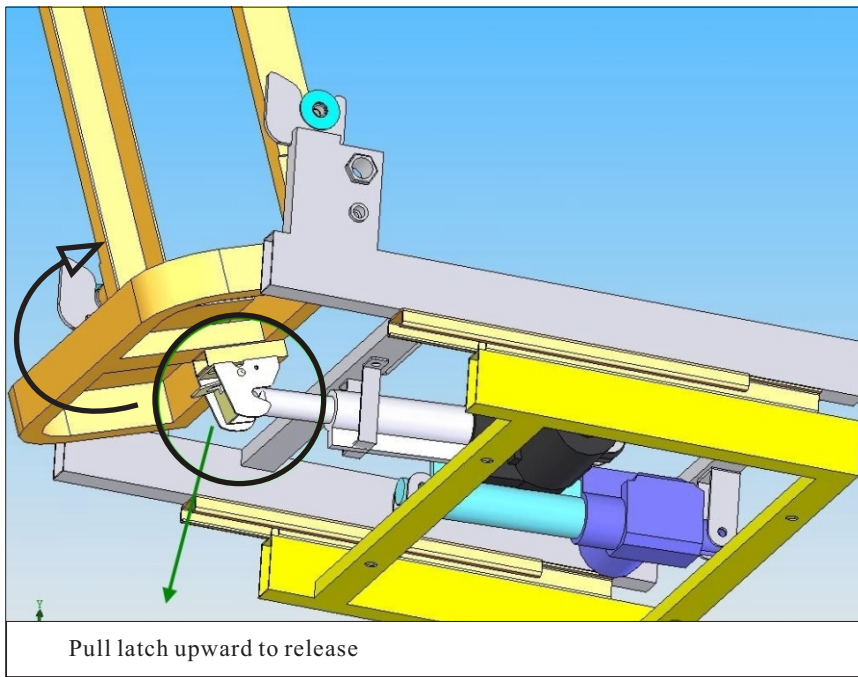

### Detachment of Backrest

- \* Pull latch lever upward to release from recliner piston.
- \* As Arrow indicates, bring backrest to fold onto the seat.
- \* Disconnect all cables ( recliner, slider)

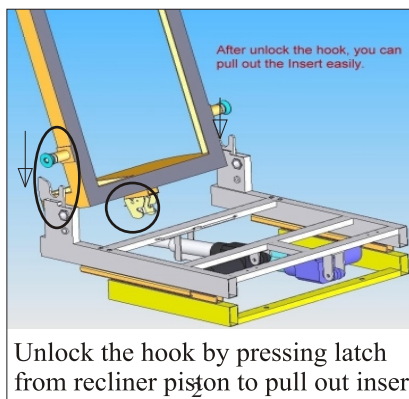

Fig.1

### Attachment of Backrest

- \* On the lower portion of both side of the backrest, there are pivots (Fig.1)
- \* Align both pivots correctly so they rest perfectly onto the “U”pivot frame (Fig.2)
- \* Once both pivots sit snugly on the “U” pivot frame, align the release latch with the Recliner piston and snap close.

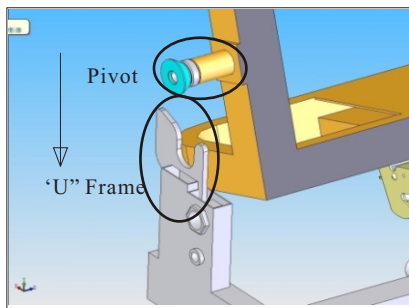

Fig.2

### **Before operating the chair upon attachment, check following items to ensure proper operation**

- \* Figure 1: shows Pivot and “U”pivot frame at correct alignment / be sure to clear wire
- \* Figure 2: Close-up view of pivot and “U” pivot frame.
- \* Figure 3: shows correct pivot alignment.

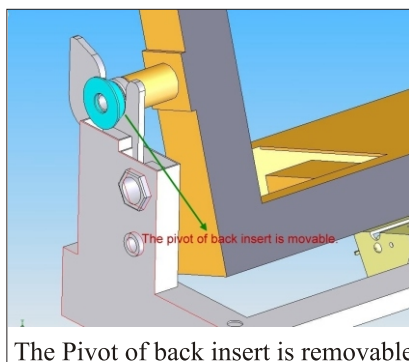

Fig.3

The Pivot of back insert is removable



## Troubleshooting Guide

If there is still a problem after trying the solutions given in the troubleshooting guide, stop using the product immediately so as to prevent accident or injury and unplug the product from the wall outlet. For technical service, please contact J&A technical support at 631-243-5300 with any issue that cannot be resolved using troubleshooting guide.

No water movement  On/Off button - No click sound On/Off button - Click sound	1-Verify unit is plugged in to live wall outlet. 2- Press reset button on the wall outlet. 3- Verify air activated tube is plugged in to black control box. 4- Ensure that the magnetic jet assembly is properly and securely attached to the basin.
Water not Draining  Not Draining properly  Not Draining properly with PDP (Power Discharge Pump)	1- Be sure Drain plug is set high enough to allow water to pass through (Gravity Drain) 2- Check for plugged drain and clear if clog is found. 3- If pump is heard, Check for plugged drain and clear if clog is found. 4- If pump is heard , Check for air lock ( see PDP in manual) follow instruction. 5- If pump is not heard, verify discharge pump is properly connected to two minute timer And to black control box. 6- If pump is not heard, verify two minute timer
Water Pressure is low and/ or not coming out.  The water sprayer is not working or very little water comes out of the sprayer.	1- Verify if water utility valve is on. 2- Check for loose water connections under the basin and at the rear of the basin 3- Check if sprayer screen is clear. 4- Verify if water supply breaded hoses are snug and not twisted on the faucet.
Losing water  The basin continually loses water either quickly or slowly	1- Check drain plug for tears in rubber gasket 2- Check drain plug height is correct and bolt below plug is tight. 3- Verify drain strainer is tight. 4- Verify if water level is correct.

## Massage Chair

Noise during operation  During tapping and kneading.  Sound of roller squeaky rubbing against cover.  Clatter during normal operation.  Vibrating mechanism noise.  Sound of recline or slide mechanism.	These noises are a normal part of the product's operation and do not effect its performance in any way.
Remote control do not work properly.  Remote control working with out power light.  Remote control with power light and not working properly	1- Verify connection if fully plugged in. 2- If chair is not return to normal, stop using the chair and unplug it from the wall outlet. Contact the vendor or J&A service for assistance.

## **DISINFECTING YOUR PEDICURE SPA**

**Note:** Please be advised that it is responsibility of purchaser/user to adhere strictly to the following procedure.  
Any non-compliance will be considered negligence of the purchaser/user.

The Bureau of barbering and cosmetology requires that salons using whirlpool pedicure spas use the following disinfecting Procedures to ensure proper cleaning and maintenance of the equipment, and to prevent bacterial infection.

### **After each customer:**

1. Drain all water and remove all debris from the pedicure spa.
2. Clean the surfaces and walls of the basin with soap or detergent and rinse with clean, clear water.
3. Disinfect with an EPA - registered disinfectant with bactericidal, fungicidal, and virucidal activity.
4. Wipe dry with clean towel.

### **At the end of the day:**

1. Remove the intake suction screen, All debris trapped behind the screen of each pedicure spa must be removed. And the screen and the inlet shall be washed with soap or detergent and water
2. Before replacing the screen, Totally immersed the screen into an EPA- registered disinfectant with bactericidal, Fungicidal, and virucidal activity.
3. Finally, flush the whirlpool system with low-sudsing detergent and warm OR an EPA - registered cleanser for 10 minutes. Rinse with clean flash water and drain.

### **Every other week**

1. After following the outlined required cleaning procedures for the end of each day, fill the basin with warm water And 1 teaspoon of 5.25% powdered bleach for each one gallon of water.
2. Circulate the solution through the whirlpool system for 5 to 10 minutes.
3. The solution rests for over night (at least 6-10 hours)
4. The following morning ( before the first customer) drain and flush the system with water.

<p>Massage stops in the middle of the program</p>	<p>Reset the main power switch located at the rear of the chair to OFF and back ON after about 5 second.</p> <p>1- if the chair return to normal, No further action is required.</p> <p>2- if the chair does not return to normal, stop using the chair and unplug it from the wall outlet. Contact the vendor or J&amp;A service for assistance.</p>
<p>The roller stop during the massage</p>	<p>Sometimes when the speed is slow than a normal and there is too much pressure to the rollers, it may stop moving temporarily.</p> <p>This is not breakage. Just release pressure by lift body weight.</p>
<p>The roller moved up or down and then stop.</p>	<p>Auto timer will cause the rollers to move up to the top of the chair and sometimes roller pass secondary stopper and causes mis-alignment of the roller.</p> <p>1- contact vendor or J&amp;A service for assistance.</p>
<p>The right and left rollers are out of alignment.</p>	<p>The rollers are designed to provide for alternating tapping function, So in the stopped position it seems they are out of sync. This is part of the design, and there is nothing wrong with product.</p>
<p>Reclining and sliding cannot be perform</p>	<p>Check to be sure there are no objects between the seat back, where moving mechanism .</p> <p>This unit has maxium weight capacity of 225 lbs.</p>

## USER RECOMMENDATION

PLEASE READ THE MANUAL THOROUGHLY BEFORE USE TO ENSURE CORRECT OPERATION.

THOSE UNDER A DOCTORS CARE OR WHO ARE EXPERIENCING ONE OR MORE OF THE FOLLOWING CONDITIONS SHOULD CONSULT THEIR DOCTOR BEFORE USE.

- You are receiving medical treatment or are feeling ill.
- Your body shows any cute symptoms.
- You have heart disease.
- You are pregnant or having a menstrual period.
- Your doctor has ordered you to rest.
- You have a back disorder resulting from an accident or disease.
- You have a high fever.
- You have sensory disorders.
- You have medical electrical device (e.g. pacemaker).
- You have service interruption in the circulation of the legs.
- You are diabetic.

FAILURE TO DO SO MAY RESULT IN ACCIDENTS AND HEALTH PROBLEMS.



## Glass bowl Care and Cleaning

### CARE AND CLEANING

Clean the surface of your ***JSG Oceana*** glass product with mild soap and warm water. Wipe the entire surface completely dry with a clean, soft cloth.

### MANUFACTURER'S RECOMMENDED DRAIN INSTALLATION

Drain installation requirements will vary by supplier basin and unit. Manufacturer's drain installation instructions suggest to apply plumber's putty under rim of drain and hand-tighten drain only. **DO NOT OVER - TIGHTEN.**

### EXCLUSIVE WRITTEN WARRANTY

#### LIMITED ONE - YEAR WARRANTY

***JSG Oceana*** Glass products are warranted free of manufacturing defects. ***JSG Oceana*** LLC will, at its election, repair, replace, or make appropriate adjustment where ***JSG Oceana*** LLC inspection discloses any such defects occurring in normal usage within one year after installation. ***JSG Oceana*** is not responsible for installation or removal costs. Proof of purchase requires the original sales receipt from the original consumer purchaser and must accompany all warranty claims.

**Implied warranties, including that of merchantability or fitness for a particular purpose, are expressly limited in duration to the duration of this warranty. *JSG Oceana* LLC disclaims any liability for special, incidental or consequential damages.**

Some States do not allow limitation on how long an implied warranty lasts or the exclusion or limitation of special, incidentals, or consequential damages, so these limitations and exclusions may not apply to you. This warranty gives you specific rights. You may also have other rights which vary state to state.

This limited warranty provides specific legal rights as they apply within U.S.A, and other rights may be available, but may vary from country to country.

**Crystalline material and air bubbles are a unique characteristic of art glass. They are an inherent part of the glass making process and are not detrimental to the mechanical strength or function of the glass basins. Each piece of *JSG Oceana* is individually inspected for durability and superior performance.**