

# LUMI

## Instruction Manual

Model No.YUME

---

**SpaSalon.us**  
*wholesale*

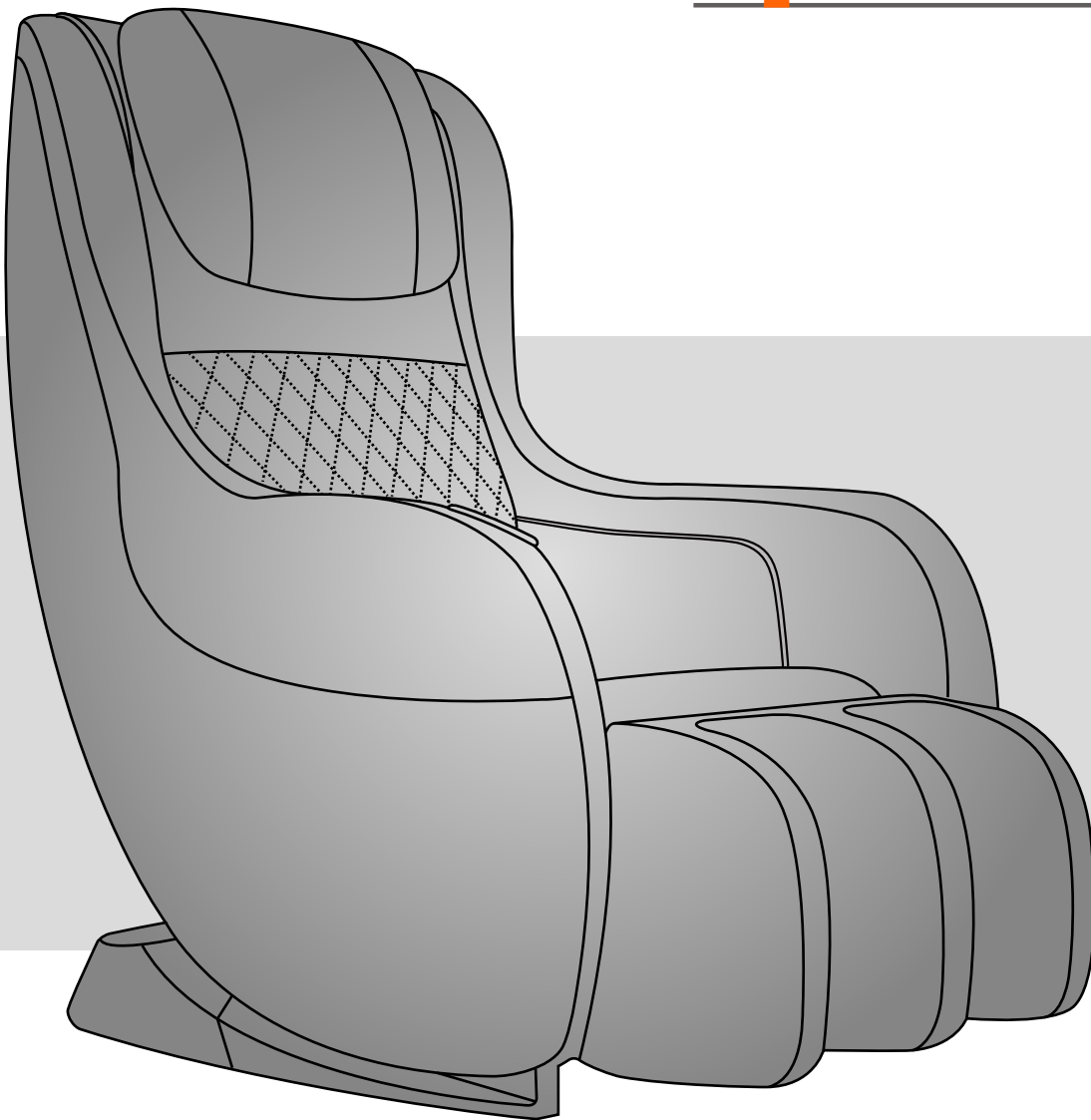

Before operating this unit, please read these instructions completely.

# Contents

---

## Before Use

---

Safety Precautions .....	1-3
• FCC Radiation Exposure Statement .....	3
Chair Components .....	4-5

## How to Use

---

Operation Instruction .....	6-7
After massage.....	8

## Q&A / Important

---

Grounding Instructions.....	9
Specifications.....	10

Thank you for purchasing this Massage Chair.  
Before using your massage chair, please read the contents of this  
instruction manual and refer to it when needed.

# Safety Precautions

When using the massage chair, basic precautions should always be followed to reduce the risk of electric shock, burns, fire or injury to persons. Please read the following precautions before using the massage chair.

- Make sure the power plug is securely inserted into a proper electrical outlet to reduce the risk of short-circuit and fire.
- It is highly recommended that a surge protector is used to prevent from damage.
- DO NOT use the massage chair in areas where the humidity is high such as a sauna steam room, Pools, bathrooms, AC or heating vents, etc.
- DO NOT use the massage chair outdoors and avoid areas with direct sunlight.
- If the chair is not being used, turn the power switch to the OFF position and unplug the massage chair from the electrical outlet to prevent any damages to the chair when there are power outages/surges that may cause serious damage.
- Never plug/unplug the power cord plug socket with wet hands.
- Close and continuous supervision is necessary when the massage chair is used by, on or near children or disabled persons.
- No more than one person should use the massage chair at the same time.
- The massage chair is intended for use as described in the Instruction Manual. Do not use any attachments other than those recommended by the manufacturer.
- DO NOT attempt to stand or sit on the backrest, armrest or footrest in order to prevent accident, injury or damage to the chair.
- Avoid falling asleep while using the massage chair.
- Always keep the massage chair clean, and never insert any objects into or around the gaps of the massage chair.
- DO NOT move the massage chair by pulling on the power supply cord.
- Make sure there are no children, pets or other obstacles behind or underneath the massage chair.
- If you find any rips or tears in the fabric of the massage chair contact the service department and stop using the chair immediately.
- This massage chair is designed for household use and should not be used in non-residential settings.

- Please consult your doctor if you are in doubt as to whether or not you should use this massage chair.
- Please consult a doctor before using the massage chair if you are pregnant, undergoing any medical treatment, using a medical electronic device such as a pacemaker, or are experiencing any of the following: Malignant tumor, heart disease, back pain, abnormal or curved back bone, osteoporosis or acute illness.
- If you experience pain while using the massage chair, stop using the chair immediately and consult your doctor.
- Never use a massage function on swollen or inflamed parts of the body.
- DO NOT use the massage chair for more than 30 minutes at a time.
- DO NOT use the massage chair where aerosol(spray) products are being used or where oxygen is being administered.
- This massage chair is a non-professional product designed to provide a comfortable massage and should not be substituted for appropriate medical treatment.
- Never operate the appliance with the air hoses that inflate while they are blocked. Keep the air openings free of lint, hair, and any other obstructions.
- Check the skin in contact with the heated area of the appliance frequently to reduce the risk of injury. If the heating pad malfunctions and extreme heat is produced it may cause serious burns.
- Burns may result from improper use. If this is the case immediately shut off the chair and unplug from the outlet.
- Remove all sharp objects from the body and pockets such as keys and Pens.
- Keep children away from extended foot support (or other similar parts.)
- DO NOT WET-DO NOT USE PINS.
- NEVER REMOVE COVER.

**Caution**

The user's weight is usually limited to 220 lbs.

For a user heavier than 220lbs, the product may have bigger noise and its fabric housing may be worn quicker.

# FCC Radiation Exposure Statement

## FCC Radiation Exposure Statement:

This equipment complies with FCC radiation exposure requirement.  
The device can be used in portable exposure condition without RF striction.

### FCC STATEMENT

1. This device complies with Part 15 of the FCC Rules. Operation is subject to the following two conditions:
  - (1) This device may not cause harmful interference, and
  - (2) This device must accept any interference received, including interference that may cause undesired operation.
2. Changes or modifications not expressly approved by the party responsible for compliance could void the user's authority to operate the equipment.

This equipment has been tested and found to comply with the limits for a Class B digital device, pursuant to part 15 of the FCC Rules. These limits are designed to provide reasonable protection against harmful interference in a residential installation. This equipment generates, uses and can radiate radio frequency energy and, if not installed and used in accordance with the instructions, may cause harmful interference to radio communications. However, there is no guarantee that interference will not occur in a particular installation. If this equipment does cause harmful interference to radio or television reception, which can be determined by turning the equipment off and on, the user is encouraged to try to correct the interference by one or more of the following measures:

- Reorient or relocate the receiving antenna.
- Increase the separation between the equipment and receiver.
- Connect the equipment into an outlet on a circuit different from that to which the receiver is connected.

# Chair Components

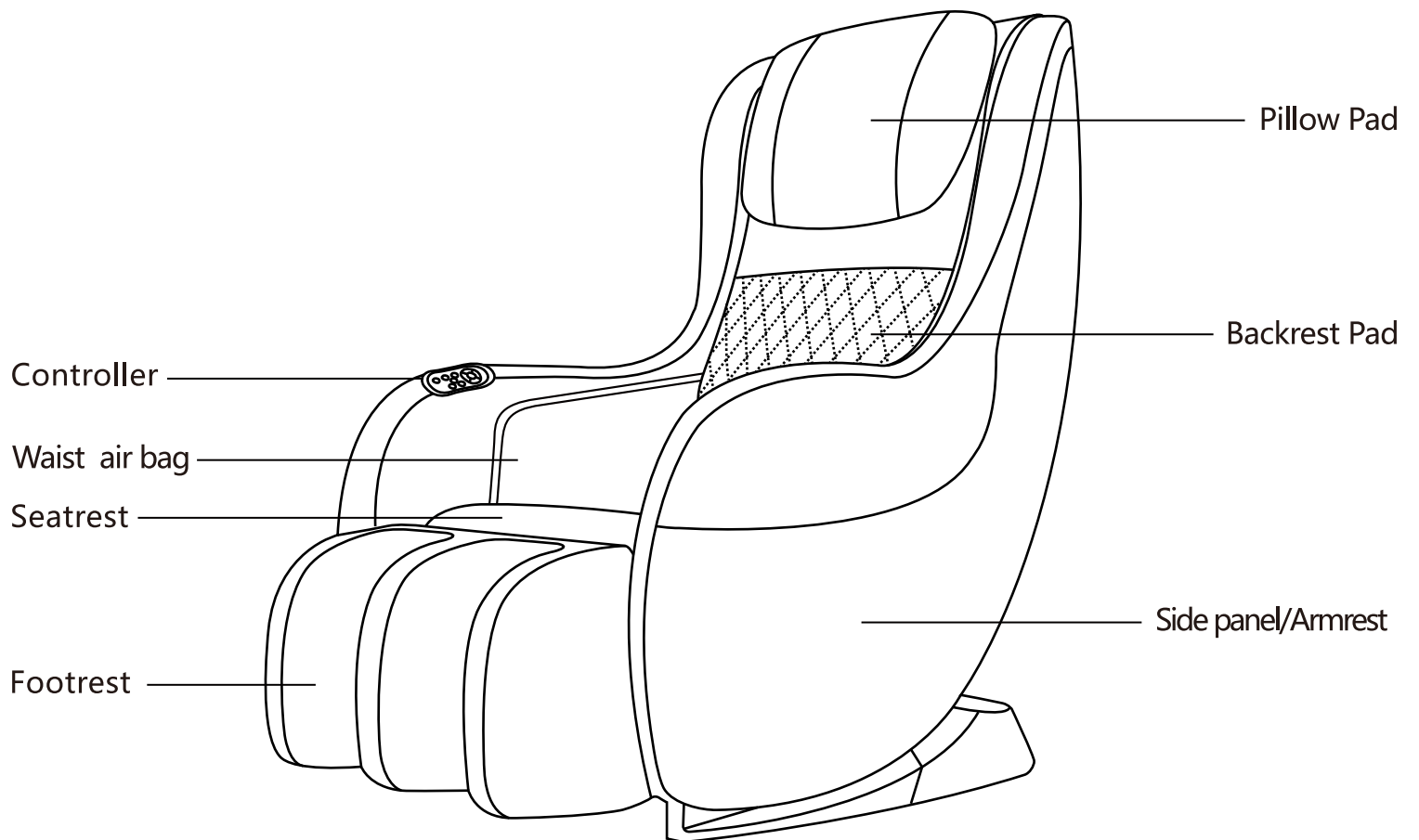

# Air Bags Massage Position

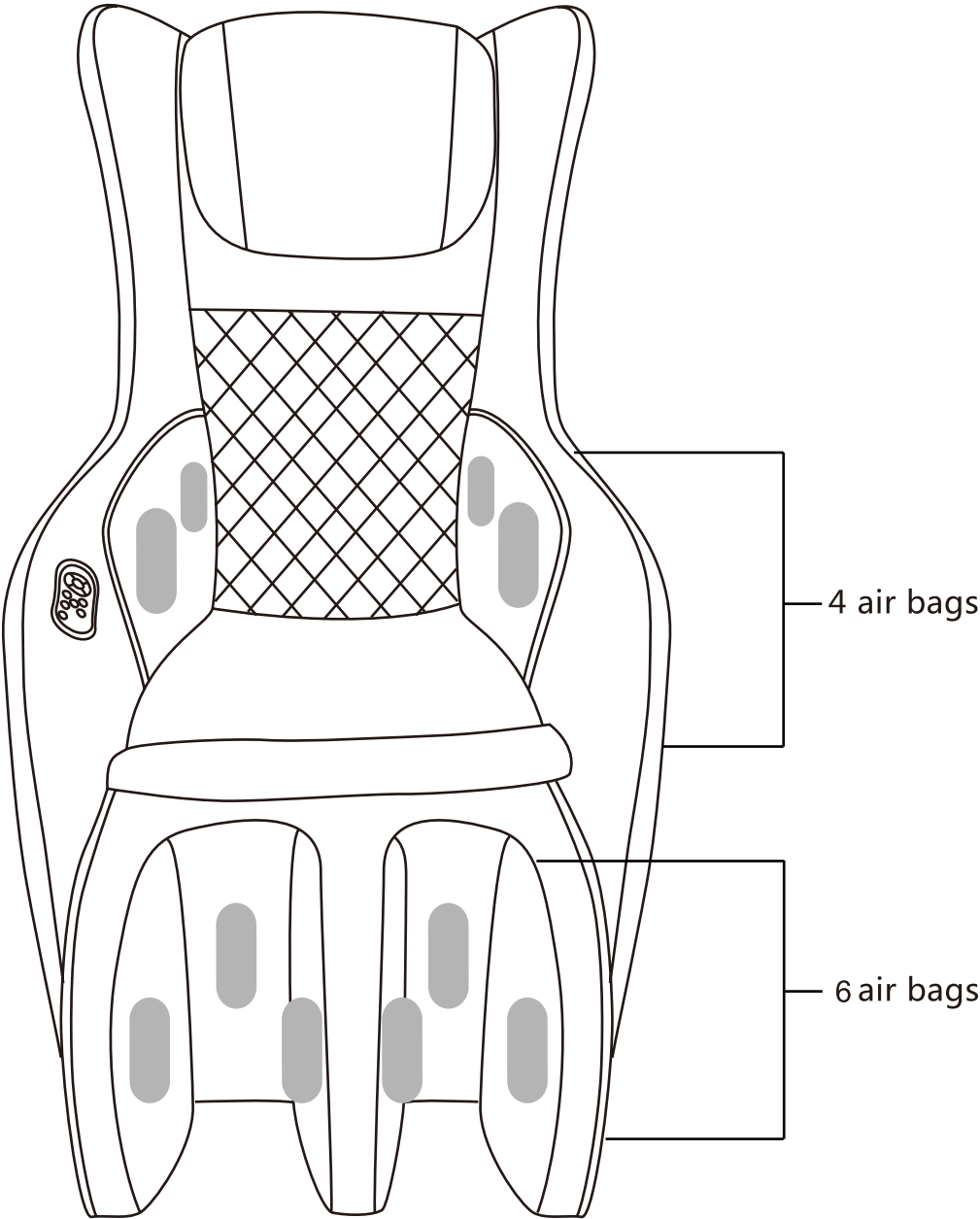

# Operation Instruction

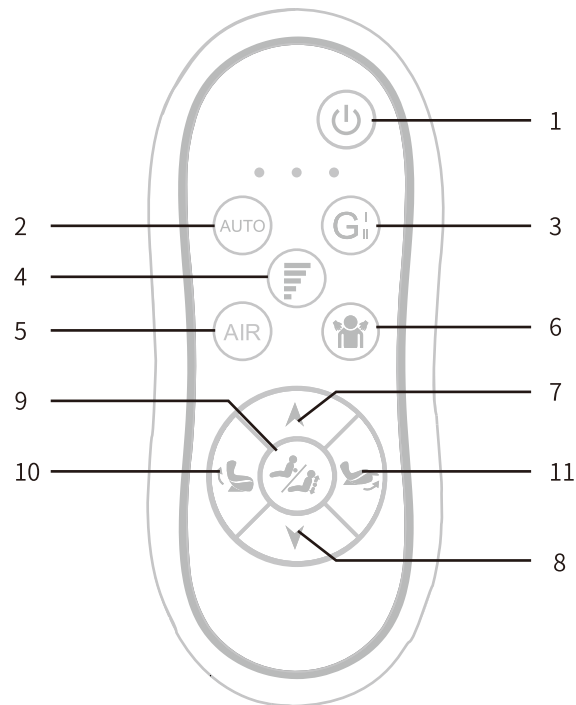

**Note:** The default time for all massage functions is minutes.  
The chair will be off after 15 min's use.

## 1 . ON / OFF

Turn on the power, and press the power switch on the bottom of the massage chair frame to "I" position, Massage chair in a reset state. At this point the massage chair into the standby mode. In Standby mode only backrest incline / recline and ON / OFF can be operate. Massage are not available. When the product is in ready mode, press any key to start massage function and activates the timer function.

## 2 . Auto Program

When the chair is operating, short press this button to start the Auto mode and the indicator will be lit. Every time this button is pressed, the auto program will change in sequence Full Body > Neck n' Shoulder > Shape n' Tone. After any auto program had been selected, the chair will first perform a shoulder height detection to provide a excellent massage journey. User can do their own tuning if needed.

1st LED turn ON = 1st Program; 2nd LED turn ON = 2nd program; 3rd LED turn ON = 3rd program.

## 3 . Zero Gravity & Cradle

When the chair is operating, press this button once to start Zero Gravity mode. The chair will recline into a Zero Gravity position. Press this button again to activate the Cradle function. The chair will swing like a cradle. Press the third time to turn off the functions.



## 4. Speed, Strength, Air Pressure Intensity ( \* Width )

When the chair is operating, short press this button to start increase the speed, strength and air pressure intensity. Every time this button is pressed, the level will change from LV1 > LV2 > LV3 in cycle

\* When the chair is operating in manual mode, long press 2 second to adjust the massage roller width. Every time long pressed this button the width level will change from narrow > medium > width in a cycle

## 5. Air Bag

When the chair is operating, short press this button to start air bag massage. Press again to shut off the function.

## 6. Manual massage

Kneading, Tapping, Swedish, Shiatsu, Clapping, Rolling.

When the chair is operating, short press this button to start kneading massage function for a full back. Every time this button is pressed, the manual massage function will change in sequence of kneading > tapping > swedish > shiatsu > clapping > rolling > stop in a cycle.

## 7/8. Upward / Downward

When the manual or automatic scan can not meet the personal requirements, press the up / down button, the massage wheel will be up or down according to your needs, release the key to the appropriate position, you can lock the upper limit of the massage trip to To achieve the purpose of fine-tuning.

Remark: During spot / partial, these two buttons can use to adjust the massage position

## 9 . Spot / Partial

Spot or localised back massage

This button allow user to select spot massage for any part on the back. Press this button once to activate spot massage. Press again to switch to partial function.

Partial Back Massage

This button allow user to select partial massage for any part on the back. Press this button once to activate partial massage. Partial massage will take the latest position as the centre to perform partial massage with distance of approximate 8 cm. Press again to switch to turn off the function.

## 10/11. Backrest Incline / Recline

When the chair is operating, press this button to adjust backrest angle. The footrest angle will be adjust in parallel during backrest incline / recline.

# After massage

## Power off the product.

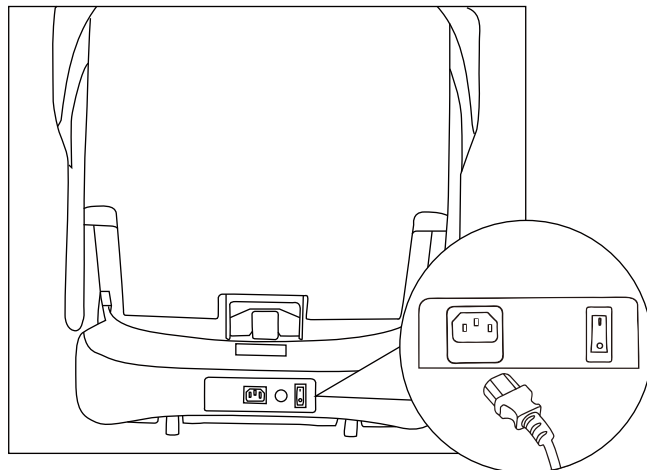

- ① Turn off the power switch.
- ② Pull out the power plug.

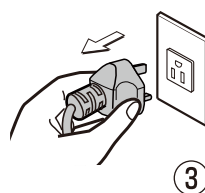

### **Warning**

- After use each time, pull the power switch to the **O** position and pull out the power plug; otherwise accidents and injuries by playing with them by children may happen.

# Grounding Instructions

This product must be grounded. If it should malfunction or break down, grounding provides a path of least resistance for the electric current to reduce the risk of electric shock. This product is equipped with a cord with an equipment-grounding conductor and a grounding plug. The plug must be plugged into an appropriate outlet that is properly installed and grounded in accordance with all local codes and ordinances.

Danger-Improper connection of the equipment-grounding conductor can result in a risk of electric shock. Check with a qualified electrician or service technician if the product will not fit the outlet, have a proper outlet installed by a qualified electrician. This product is for use on a nominal 120V circuit and has grounding plug that looks like that plug illustrated below. Make sure that the product is connected to an outlet having the same configuration as the plug. No adapter should be used with this product.

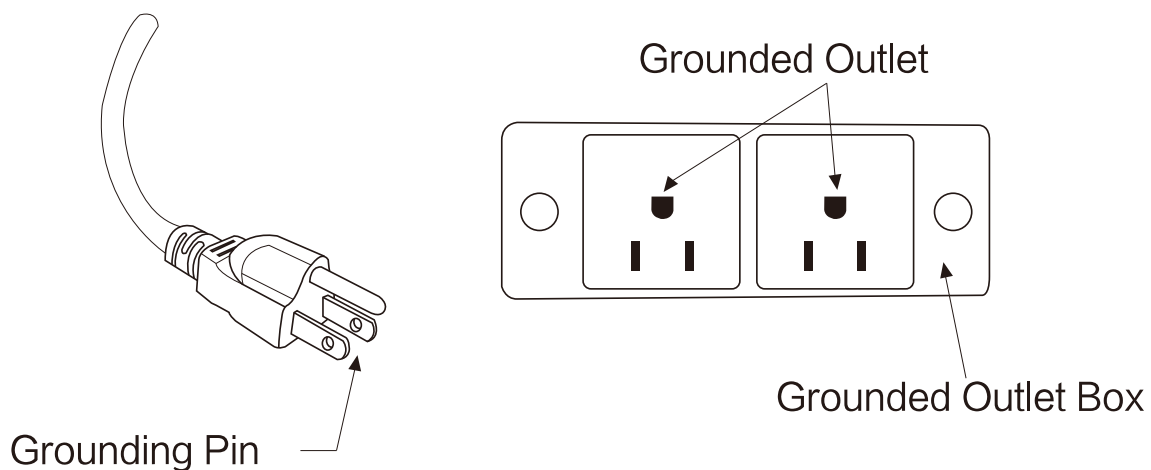

# Specifications

Description	Specifications
Power supply	110-120V ~ 60Hz
Power consumption	60W
Default timer	15min
Dimensions(L x W x H)	Upright: Approx. 45.67"x26.38"x39.37"
	Recline: Approx. 53.35"x26.38"x30.71"
Weight	Approx. 110lbs
Package dimensions(L x W x H)	Approx. 54.9"x27.7"x32.8"
Usage condition	Environment temperature: 32°F~95°F
	Contrasting humidity: 20-80RH
Storage condition	Storage temperature: 32°F~95°F
	Storage humidity: 20-80RH
Maximum body weight of user	220lbs