

PEDICURE USER MANUAL

(Pedicure Whirlpool with Massage System)

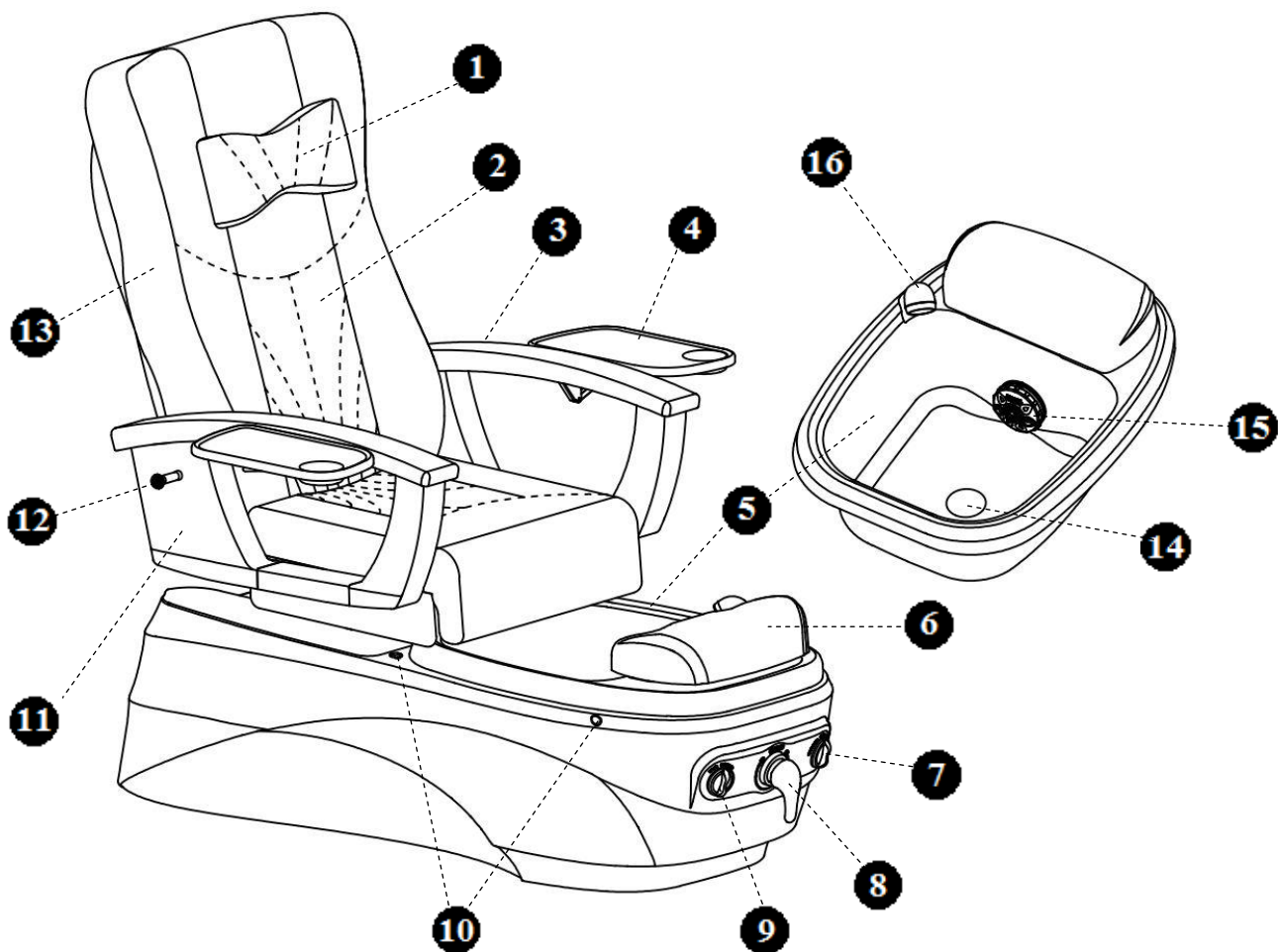

- 1. Head Rest
- 2. Chair Cushion with Massage
- 3. Armrest Wood
- 4. Manicure-Tray (Optional)

- 5. Angelic Bowl
- 6. Footrest
- 7. Jet On/Off Knob
- 8. Hot/Cold Water Mixer Valve
- 9. Sani-Drain™ System with Discharge On/Off Knob

- 10. Liner Hook
- 11. Up/Down Armrest
- 12. Handbag (Purse) Hook
- 13. Massage Remote Control
- 14. Drain Stopper
- 15. Ecojet™ Jet
- 16. Flex Water Filler/Spray spout

SPA to SPA RECOMMENDED CLEARANCE:

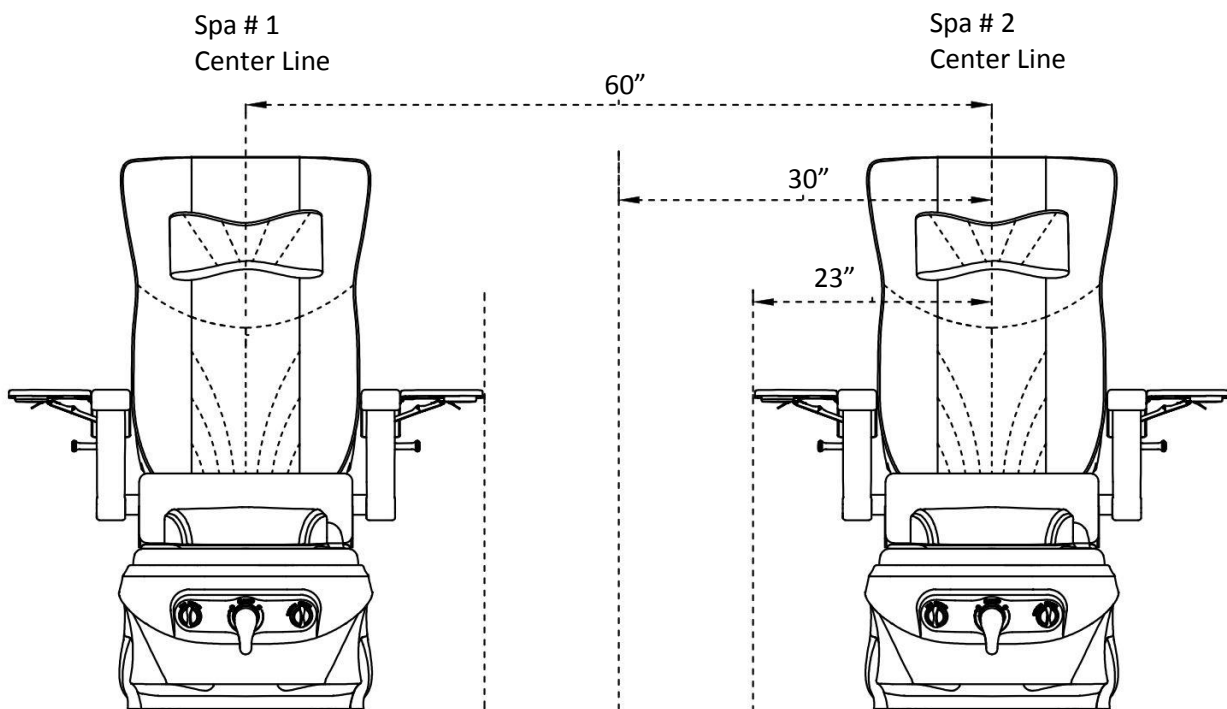

Wall Clearance:

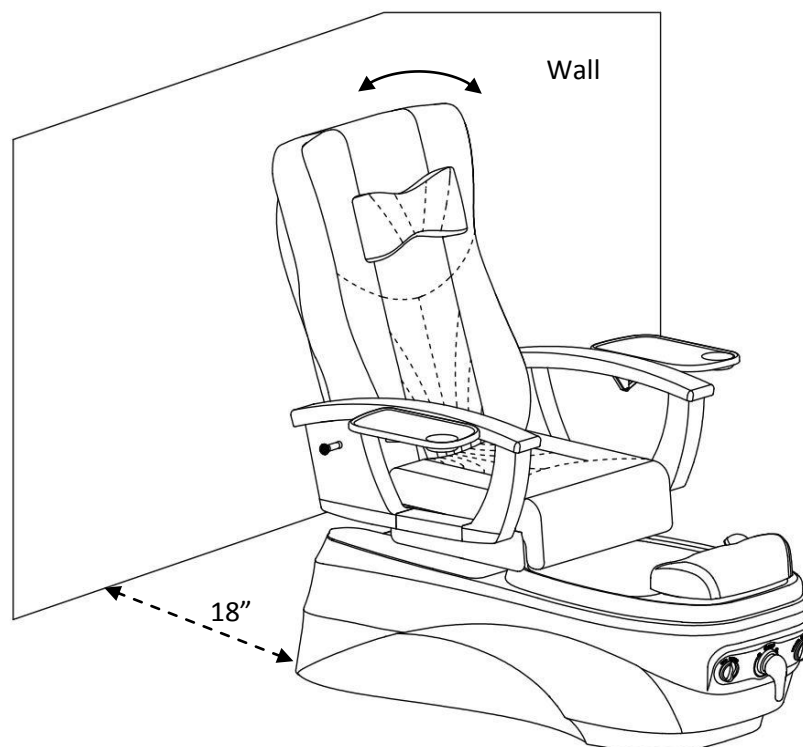

MANICURE TRAY/ ARMREST / BACK REST INSTALLATION

Up/Down Swinging Armrest, Manicure tray up and down

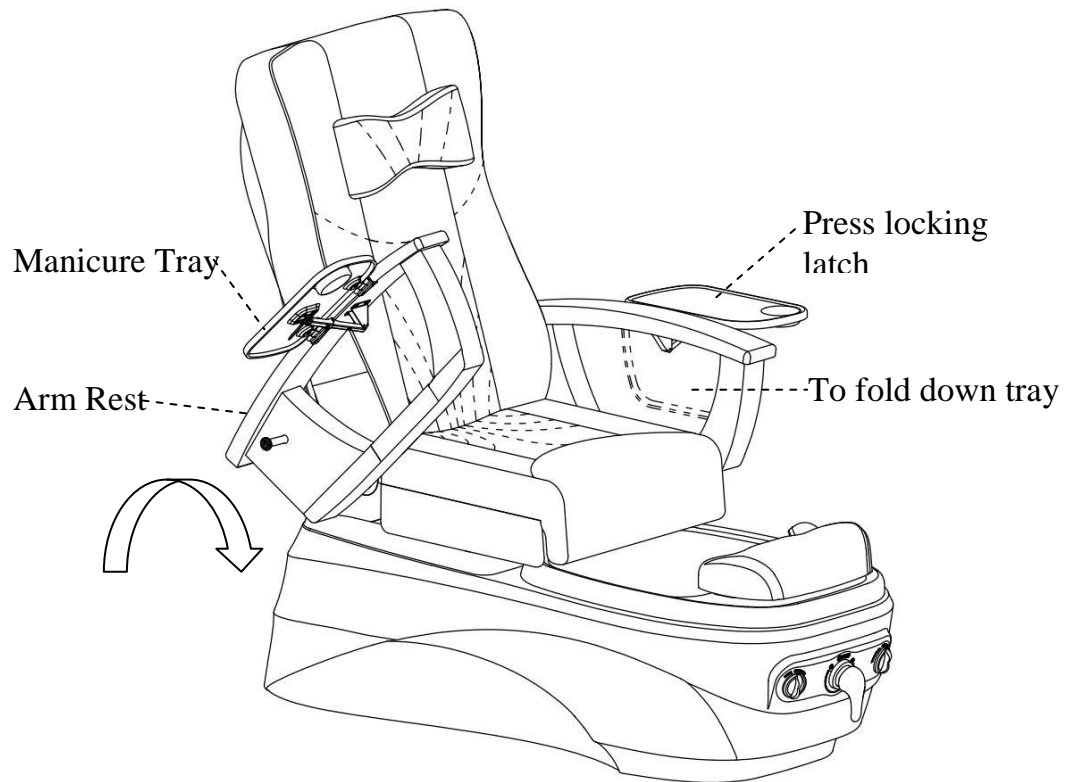

Back Rest:

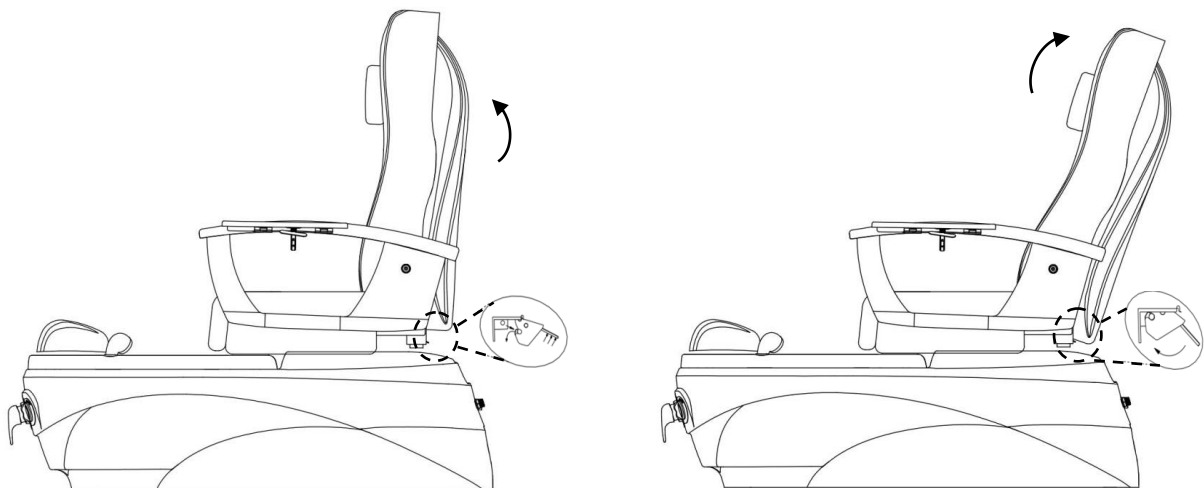

1. To set backrest up: Lift up the backrest until a "Click" is heard. Make sure the lever is locked before operating.
2. To fold down backrest: Lift up lever handle located on the left side / bottom of Chair.

Plumbing Connections:

Warning Before any connection, pay attention to these subjects:

1. Debris or residue may become lodged into the Hot and Cold hoses during construction, which may clog the Hot and Cold Mixer. To clean, drain a good amount of water from water hoses to bucket before connecting them to the pedicure spa. Failure to do so may void your Warranty.
2. Hooking up a used Hot/Cold flex hose is not recommended since debris from broken rubber seal might clog water mixer. Failure to do so may void your Warranty.
3. Backflow preventer: Due to differences in construction lay-out of your Salon and City's plumbing code, please contact your local Plumber to fulfill your needs as required. Backflow Preventers are not supplied by the pedicure spa manufacturer.
4. Check valve is an optional part and supplied free of charge for your convenience. Factory is not liable for this Check valve.
5. Maximum Inlet water pressure must be under 75 PSI.

Power Drain (optional):

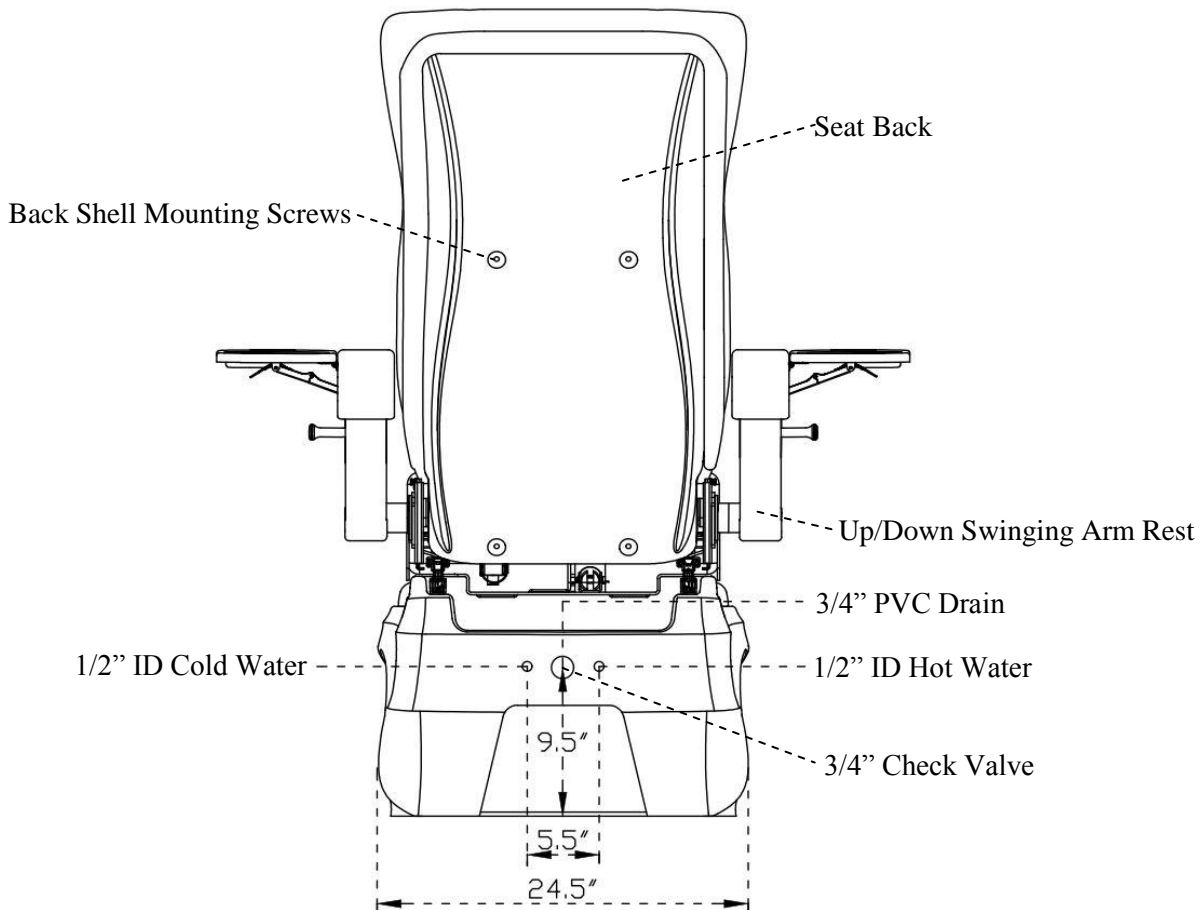

Gravity Drain (No Drain Pump):

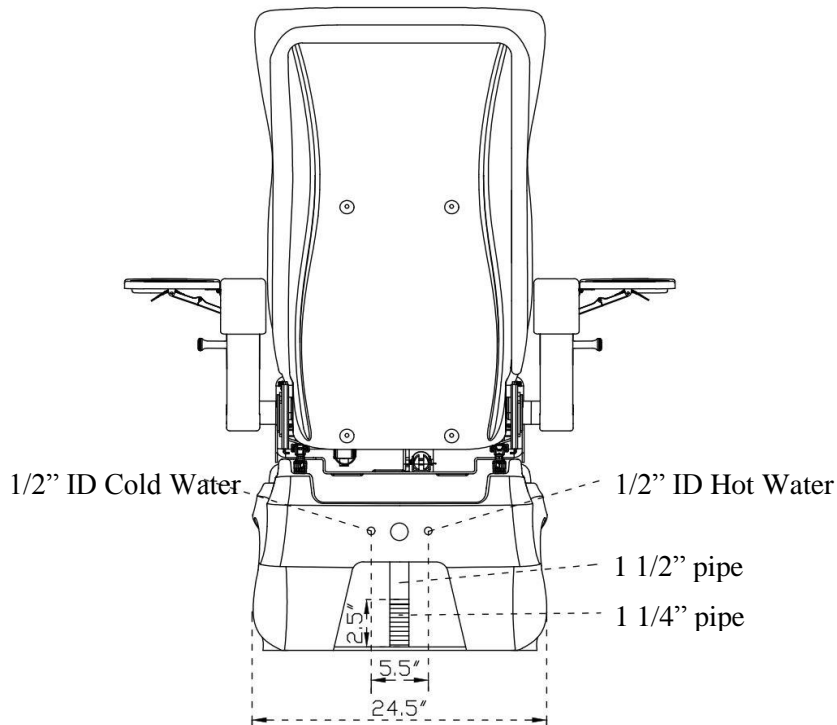

Plumbing – Flow Pattern – Power Drain

Hot/Cold water Inlet & Back-Flow Preventer (Not Included)
Optional as required by Local city Plumbing Code

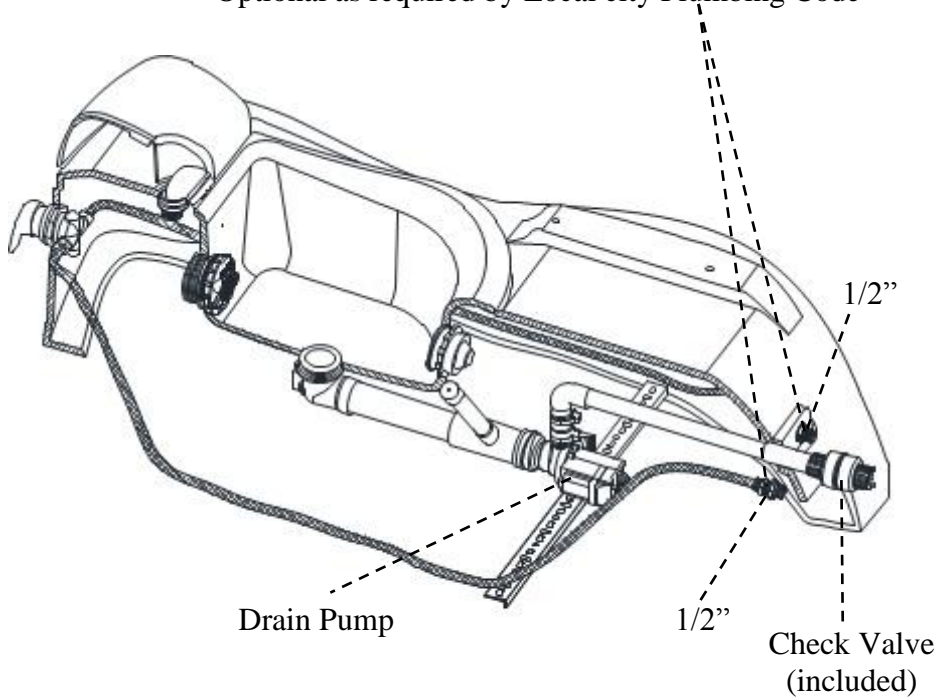

Plumbing Flow Pattern for Gravity Drain:

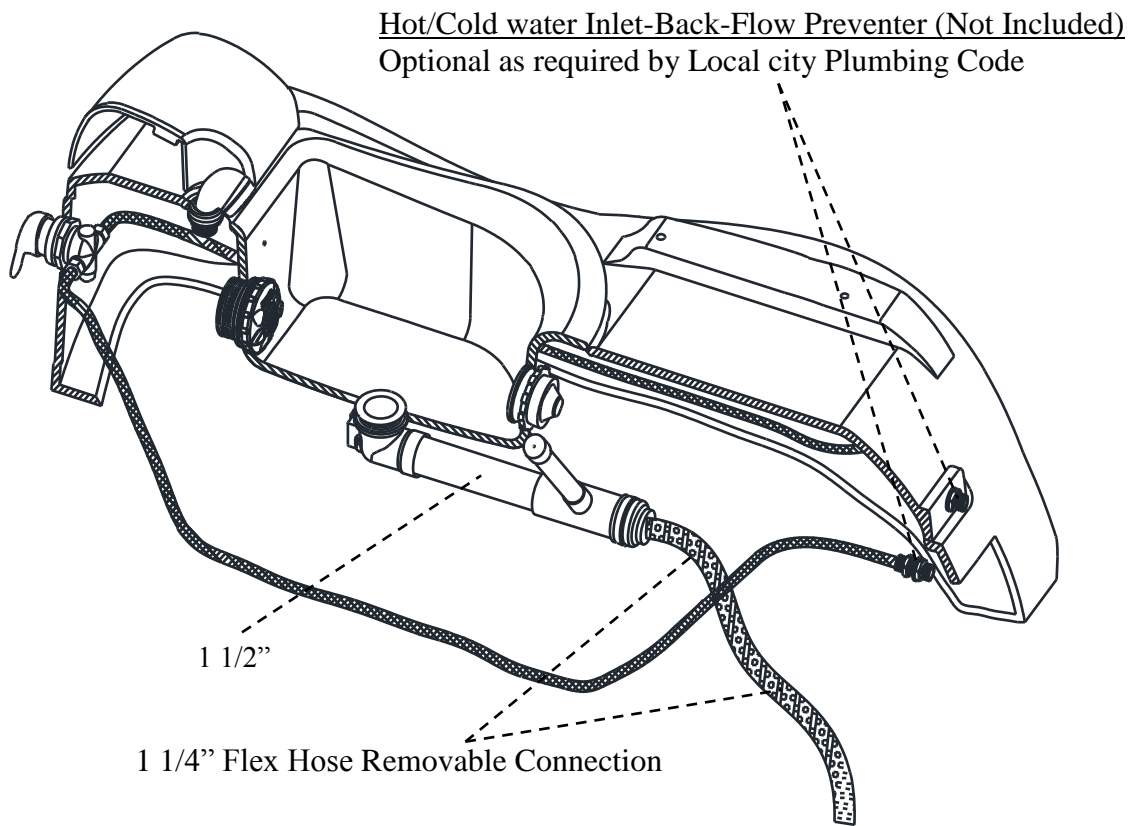

HOT AND COLD WATER SUPPLY LINES

Carefully connect 1/2" ID supply hoses (not provided) to fresh water sources. Shut-off valves (not provided) should be utilized. Valves should be placed outside the tub for easy access.

Before water line connections, please follow below:

Determine if your spa chair is used for a new construction of a salon or a replacement spa chair.

1. **New construction:** Make sure to remove any and all debris and/or dust from current hot cold water pipes before hooking up to spa. Suggested direction to remove debris: turn on water and drain into a bucket or container. See illustration below:

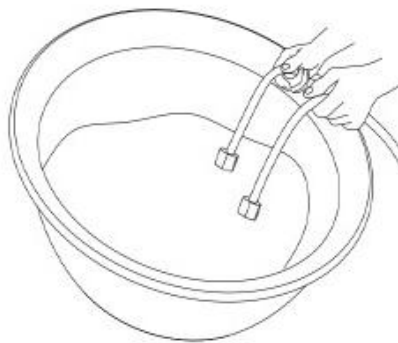

2. **Replacement Spa:** Always use new hot/cold water hoses when connecting a new spa chair to prevent debris, such as old rubber particles, from clogging the system

CONNECT DRAIN WITH POWER DRAIN (PUMP) OR GRAVITY DRAIN (NO PUMP)

Using $\frac{3}{4}$ " schedule 40 PVC (Power Drain) or $1\frac{1}{4}$ " flex tube (Gravity Drain) and appropriate traps.
Connect drain to meet local plumbing codes.
Rubber connection to the drain should be removable for easy service and should not be permanent to prevent damages.

Drain System Recommendation.

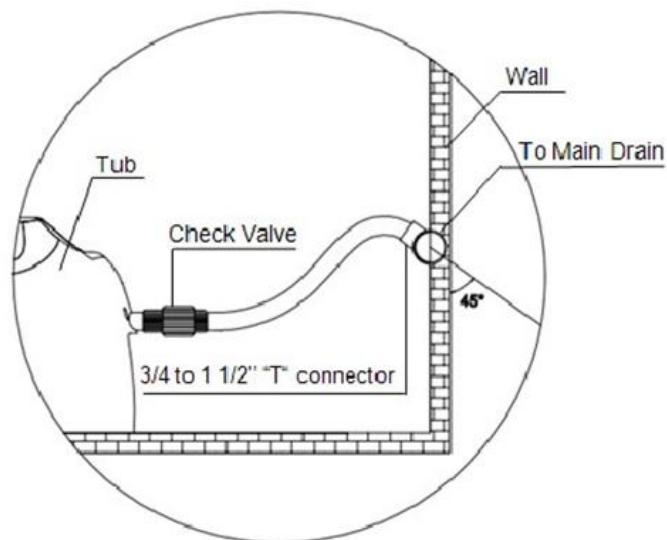
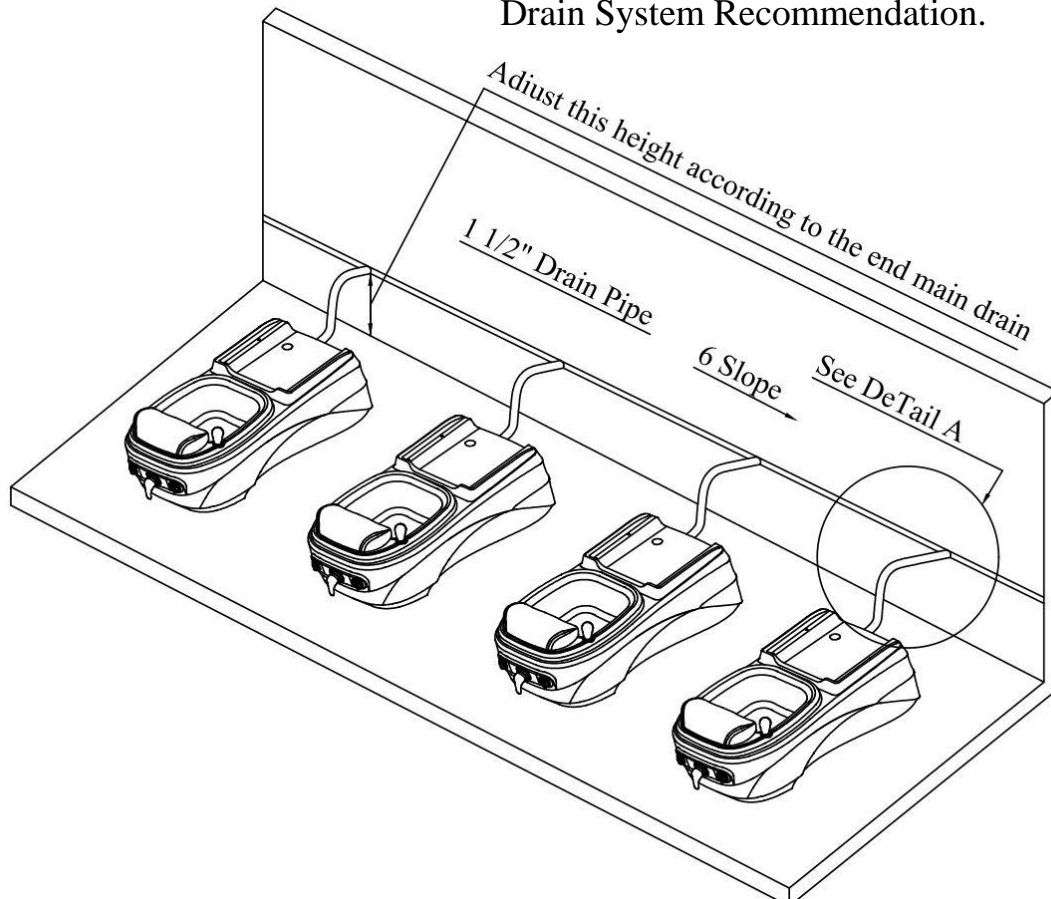

Detail A

ELECTRICAL AND PEDICURE SPA COMPONENT SPECIFICATIONS

All electrical connections **MUST** be made by a qualified, licensed electrician in accordance with Local & National Electrical and Building Codes. A 110V-50/60 Hz, 15 Amp, GFCI protected grounded circuit **MUST** be used to supply power to the Pedicure Spa. A dedicated circuit must be used with a GFCI. All wiring must conform to National & Local Electrical Codes.

WARNING: IT IS EXTREMELY IMPORTANT THAT THE FOOT SPA OPERATES WITH GFCI PROTECTION

VERY IMPORTANT Both back of chair and seat are adjustable. When both are at maximum positions one must allow 18"(44cm) from back wall to foot spa. This minimum distance assures unobstructed recline. Failure to follow this required dimension might damage your spa components and plumbing connections, which will void your warranty.

PEDICURE SPA SPECIFICATIONS:

Construction: Marble composite, high gloss, acetone-proof gel coat.
 Two (2) electro-mechanical knobs control the drain and whirlpool.
 Electro-mechanically operated reclining, massaging, and sliding seat with hand held control.
 One (1) pipe-less whirlpool jet. (Pipe-free technology)
 Power drain (optional) or Gravity drain (no drain pump)
 Extendable water spray positioned well above water line, air gap is accommodated with back-flow prevention required by plumbing code
 Armrest swing up / down.

SPECIFICATIONS

Spa Dimensions & Weights	PSD400 = 30" (W) x 55" (L) All Models fully reclined: 74" (L). With Manicure Tray Installed: 46" (W) Empty Weight: ~ 200 lbs. Shipping Weight: ~ 260 lbs.
Adjustable Stool Height	Pedicure Stool: 12" – 13".
Spa Water Capacity	~ 4-5 US Gallon
Jet Motor	120 VAC. at 85W 60Hz
Massage Motors, Seat Sliding & Reclining	24VDC, 2.5A x 5
Discharge Pump	Motor – 120V at 85W 60 Hz Maximum vertical lift: 3ft . Flow rate 500 GPH @ floor level
Power source	115 VAC, 60HZ. Power needed per spa chair = 6 Amp
Electrical Switches	One (1) electro-mechanical knob for the Whirlpool. Rated at 5A contact. One (1) electro-mechanical knob for the Drain. Rated at 5A contact.
Plug & Play Installation	Installation should be made with connection at the external interface parts. Please consult with your local plumber.
Safety	PSD400® Pedicure Spa is UL listed.

OPERATION AND CARE INSTRUCTIONS

Filling Water Close the Drain Stopper by turning the Drain Knob counterclockwise. Utilizing the single lever hot/cold mixer faucet located on the front of the Pedicure Spa, fill the tub to the water level above the whirlpool jet at least 1 inch. You must completely submerge the jet. If during the operation of the whirlpool, the water level decreases, simply add more water.

Whirlpool Starting

Turn the Jet Knob located on the right side of the front panel to clockwise to turn on.
Turn counterclockwise to shut off.

Warning : Do NOT turn "ON" the JET PUMP KNOB unless adequate water is in the tub.
THE WARRANTY IS VOID IF THE PUMP HAS BEEN RUNNING DRY

Draining

Turn the Drain Knob clockwise to open the Drain Stopper. Power Drain will turn on automatically if drain pump exist.
Dual Action Electro-mechanical Switch located on the left side of the front panel) When activating the switch, it will raise the drain-stopper and power up the drain pump (if exist) at the same time.

Warning Do NOT turn "ON" the DRAIN PUMP KNOB unless adequate water is in the tub.
THE WARRANTY IS VOID IF THE PUMP HAS BEEN RUNNING DRY

NOTE: Whirlpool action can cause even small amounts of soap or body oil to foam excessively. For this reason, refrain from using these products during the whirlpool cycle.

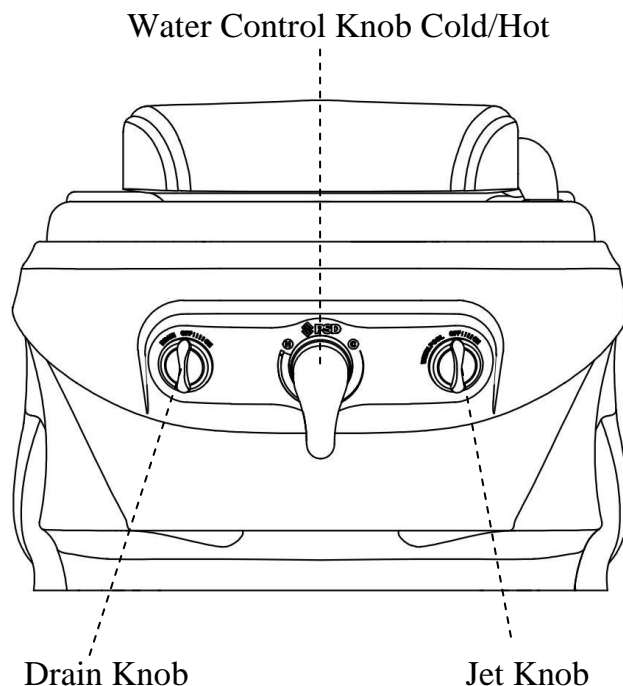

MAGNETIC JET COVER REMOVAL & INSTALLATION:

1. Turn Counterclockwise to remove. Turn Clockwise to install.

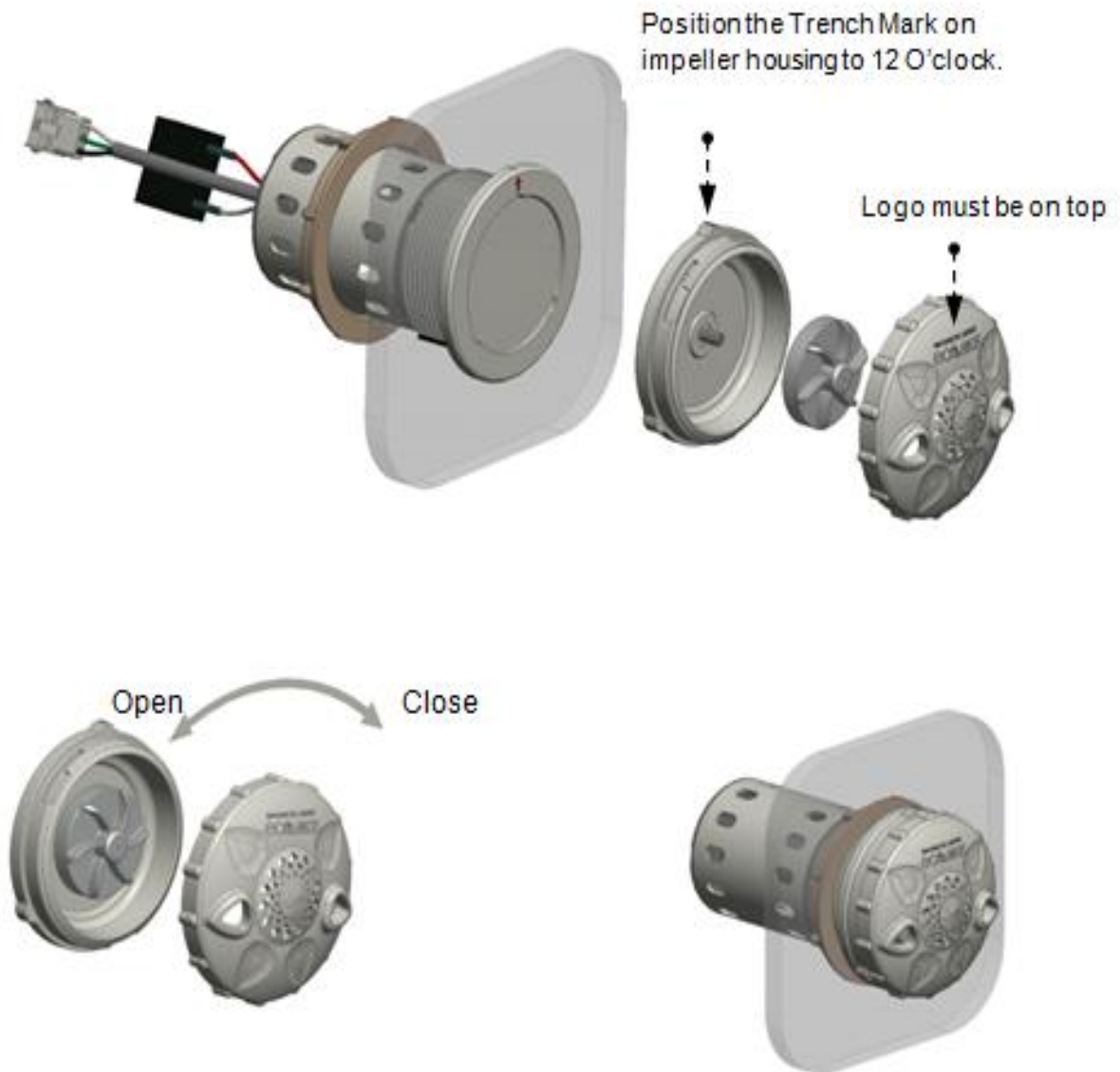

JET HOUSING REMOVAL & INSTALLATION

1. Turn clockwise to remove motor. Turn counterclockwise to install motor.

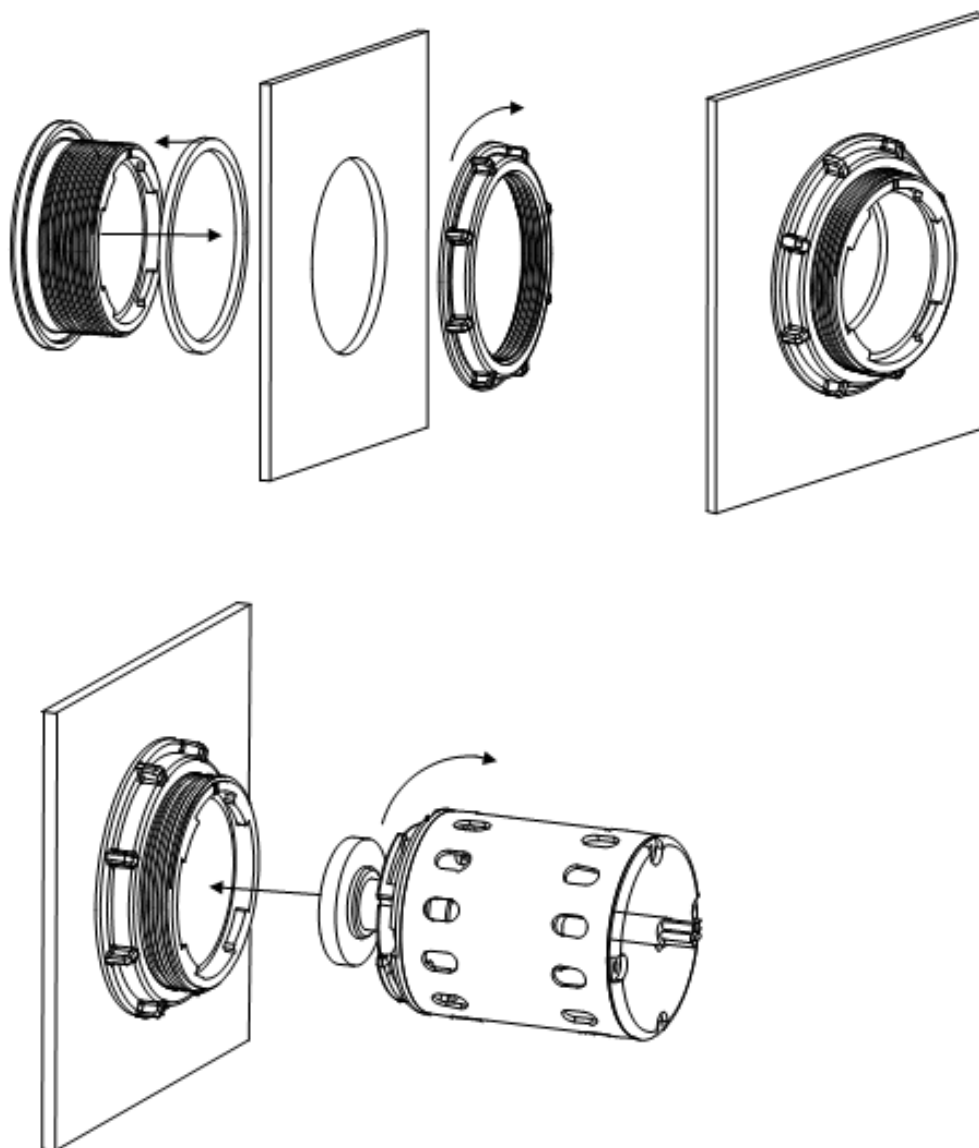

MESSAGE SYSTEM & REMOTE CONTROLLER:

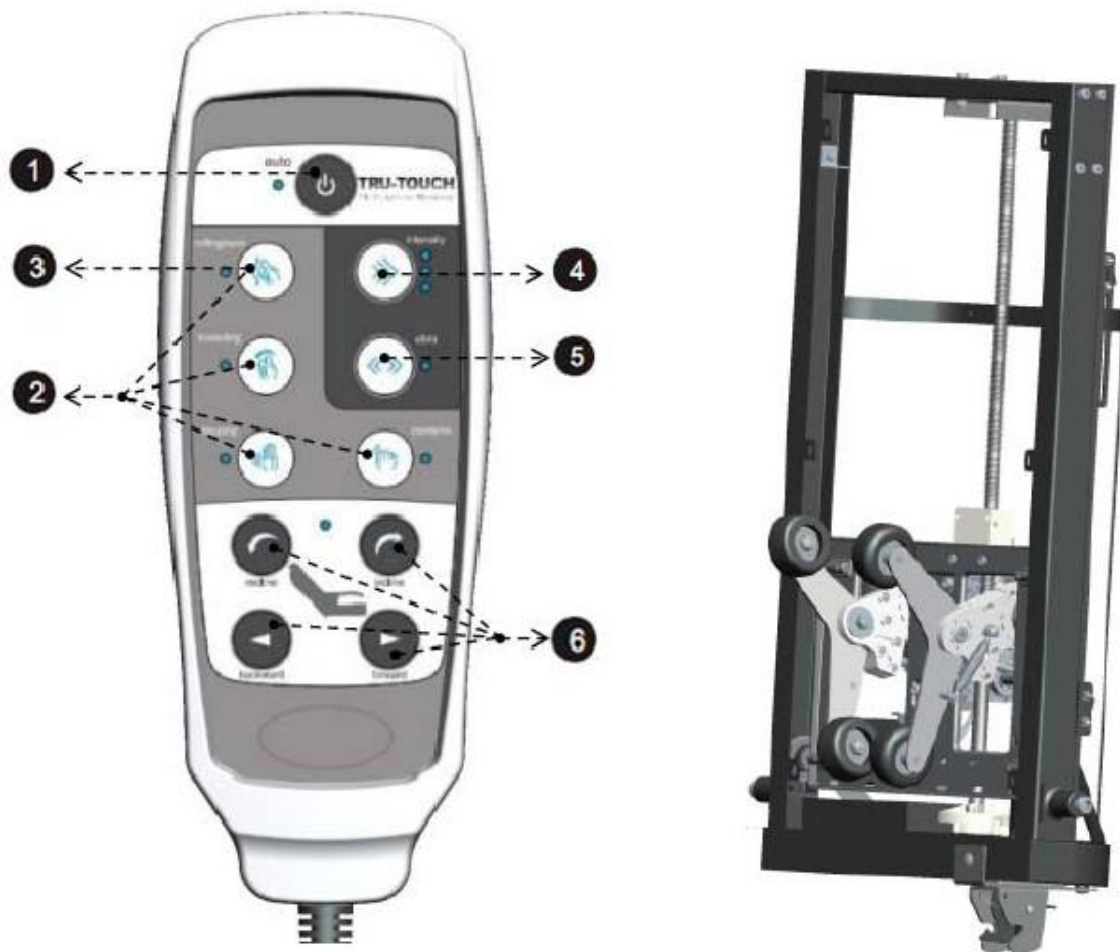

1. Press Auto Button to start Auto mode. Press again to turn off massage.
Auto and Manual mode will run for duration of 15min.
2. Press any button (Rolling/Spot, Kneading, Tapping, Combine) to enter Manual mode.
3. Press Rolling/Spot to stop rolling up/down and stop at desired spot.
4. Press Intensity button to select tapping intensity.
5. Vibro Button/LED is an option. Pressing this button will resume with Tapping action.
6. Press any chair button (Recline, Incline, Backward, Forward) to move the chair to desired positions.

NOTE : If the Massage Chair is not provided, then the end-user will need to install a UL listed and cUL/CSA certified massage chair with a suitable Class 2 Power Supply.

TOP MASSAGE CHAIR BASIC INSTALLATION INSTRUCTIONS:

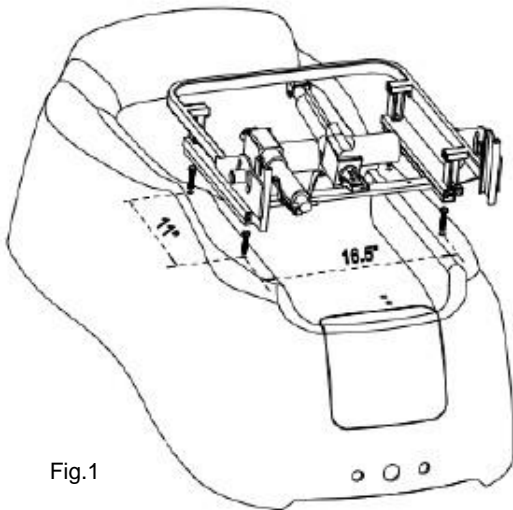

Fig.1

Drill 4 mounting holes $\frac{1}{2}$ " Width=16.5"
Length=11 .Install seat frame and secure 4
screws from bottom base. Using the provided
stand-off blocks to adjust the height of seat frame as
needed to allow seat frame to travel freely.

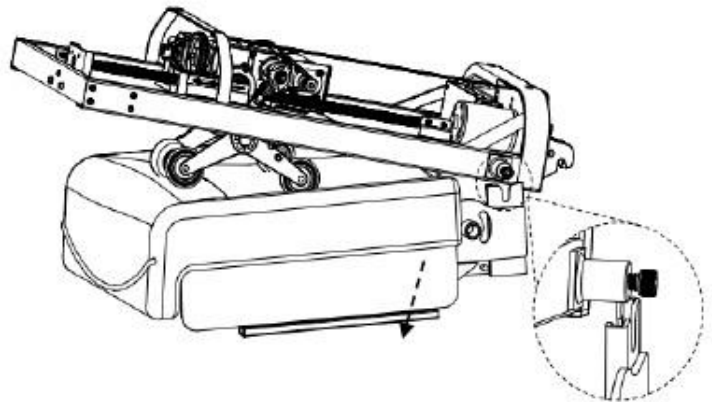

Fig.2

Install seat cushion with 2 screw-Knobs
Lever the back massage and secure 2 hinge
screws onto the metal brackets.(Do not turn
the screws all the way in)
Leave $\frac{1}{4}$ " thread screw head for sliding
Install back shell with 4 screws as Fig.3

Lift up back massage to engage
locking device. (Manually adjust
actuator rod to lock as needed)
Install back cushions.
Plug AC cord to power strip
Located inside of the tub base.

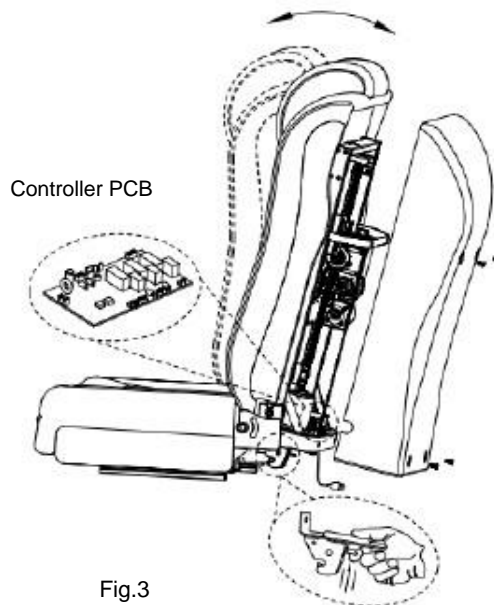

Fig.3