



SpaSalon.us
wholesale

USER MANUAL

PSD-100 | PSD-200 | PSD-300 | PSD-400

PEDICURE SPA USER MANUAL

Model: PSD 100, PSD200, PSD300, PSD400[®]

Before Operating the unit, please read this manual thoroughly and retain it for future reference.

PLEASE TAKE NOTE: Thoroughly inspect each shipment immediately upon arrival. It is important that you notify the driver and insist on a notation of the damage. Make this notation directly on the freight company's waybill or bill of lading. Failure to note damage on the waybill or bill of lading may impede and/or prevent any claims that you may have against the freight carrier.

If missing parts or damage is found , please notify the carrier at once and request an inspection.
DO NOT DISCARD THE SHIPPING BOX. If you give the carrier a clear receipt for goods that have been damaged in transit, you do so at your own risk and expense.

Table Of Contents

SAFETY & PRECAUTIONS	2
PARTS	
Identifying Parts for PSD100® Model	3
Identifying Parts for PSD200® Model	4
Identifying Parts for PSD300® Model	5
Identifying Parts for PSD400® Model	6
Spa - to - Spa Recommended Clearance.....	7
Manicure Tray/Armrest/Back Rest Installation	8
Plumbing Flow Pattern for Power Drain	9
Plumbing Flow Pattern for Gravity Drain	10
Hot And Cold Water Supply Lines	10
Electrical and Pedicure Spa Component Specifications	11
OPERATION AND CARE INSTRUCTIONS	12
MAGNETIC JET COVER REMOVAL & INSTALLATION	12
MASSAGE SYSTEM & REMOTE CONTROLLER	13
CLEANING REQUIREMENT FOR PEDICURE SPAS	14
UL Certification	16
CE Certification.....	17
ISO Certification	18

Identifying Parts for PSD 100® Model

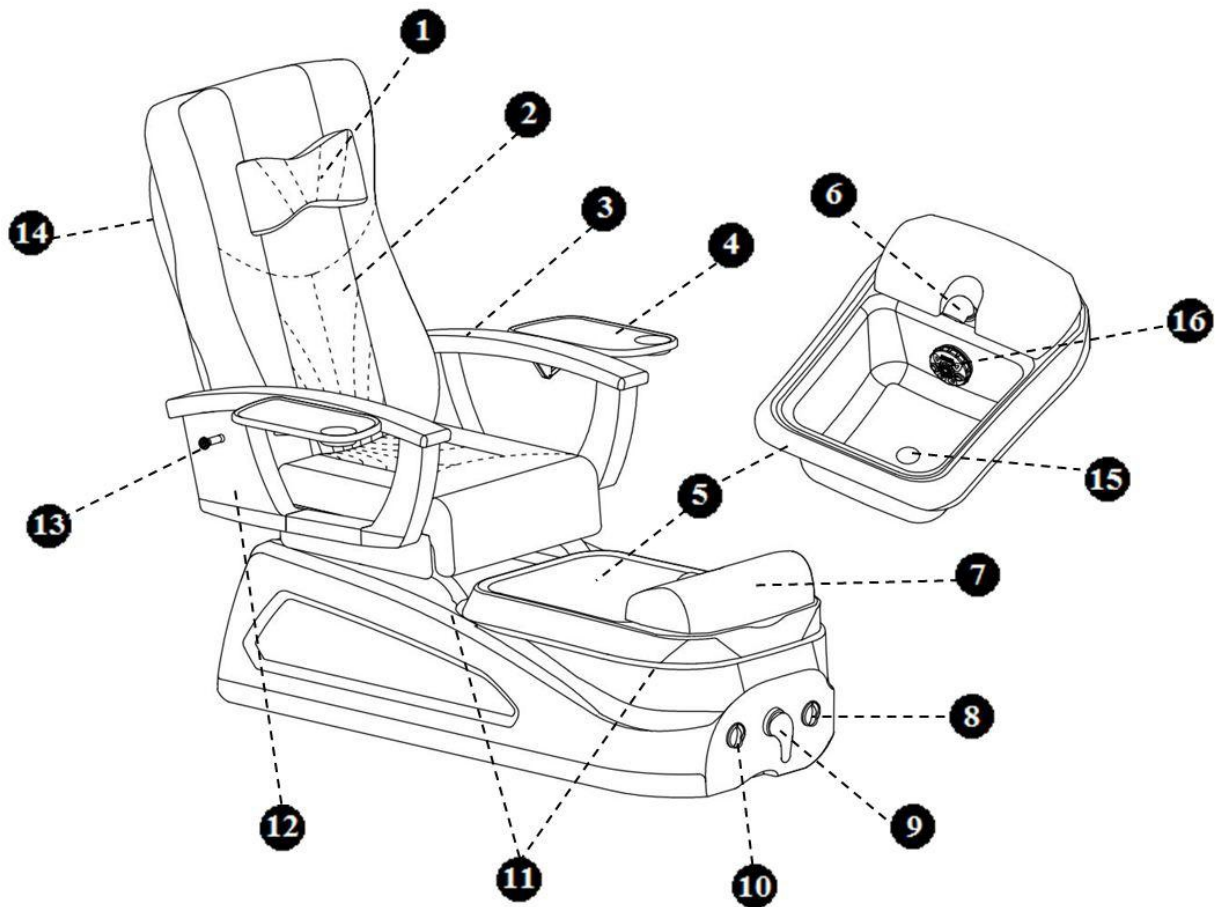

- | | |
|----------------------------------|---|
| 1. Headrest | 9. Hot/Cold Water Mixer Valve |
| 2. Chair Cushion with Massage | 10. Sani-Drain™ System with Discharge On/Off Knob |
| 3. Armrest | 11. Liner Hook |
| 4. Manicure-Tray (Optional) | 12. Up/Down Armrest |
| 5. LED Gel Bowl | 13. Handbag (Purse) Hook |
| 6. Flex Water Filler/Spray spout | 14. Massage Remote Control |
| 7. Footrest | 15. Drain Stopper |
| 8. Jet On/Off Knob | 16. Ecojet® Magnetic Drive |

Identifying Parts for PSD 200[®] Model

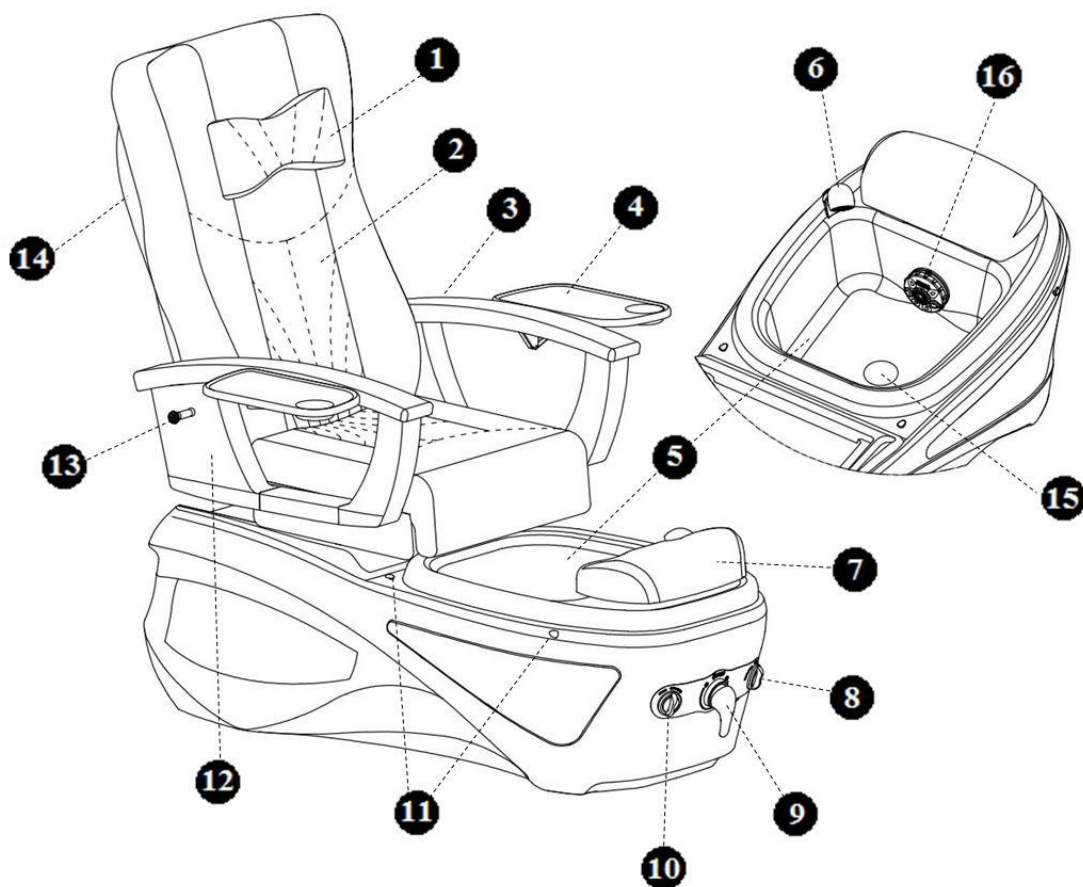

- | | |
|----------------------------------|---|
| 1. Headrest | 9. Hot/Cold Water Mixer Valve |
| 2. Chair Cushion with Massage | 10. Sani-Drain™ System with Discharge On/Off Knob |
| 3. Armrest | 11. Liner Hook |
| 4. Manicure-Tray (Optional) | 12. Up/Down Armrest |
| 5. LED Gel Bowl | 13. Handbag (Purse) Hook |
| 6. Flex Water Filler/Spray spout | 14. Massage Remote Control |
| 7. Footrest | 15. Drain Stopper |
| 8. Jet On/Off Knob | 16. Ecojet® Magnetic Drive |

Identifying Parts for PSD 300® Model

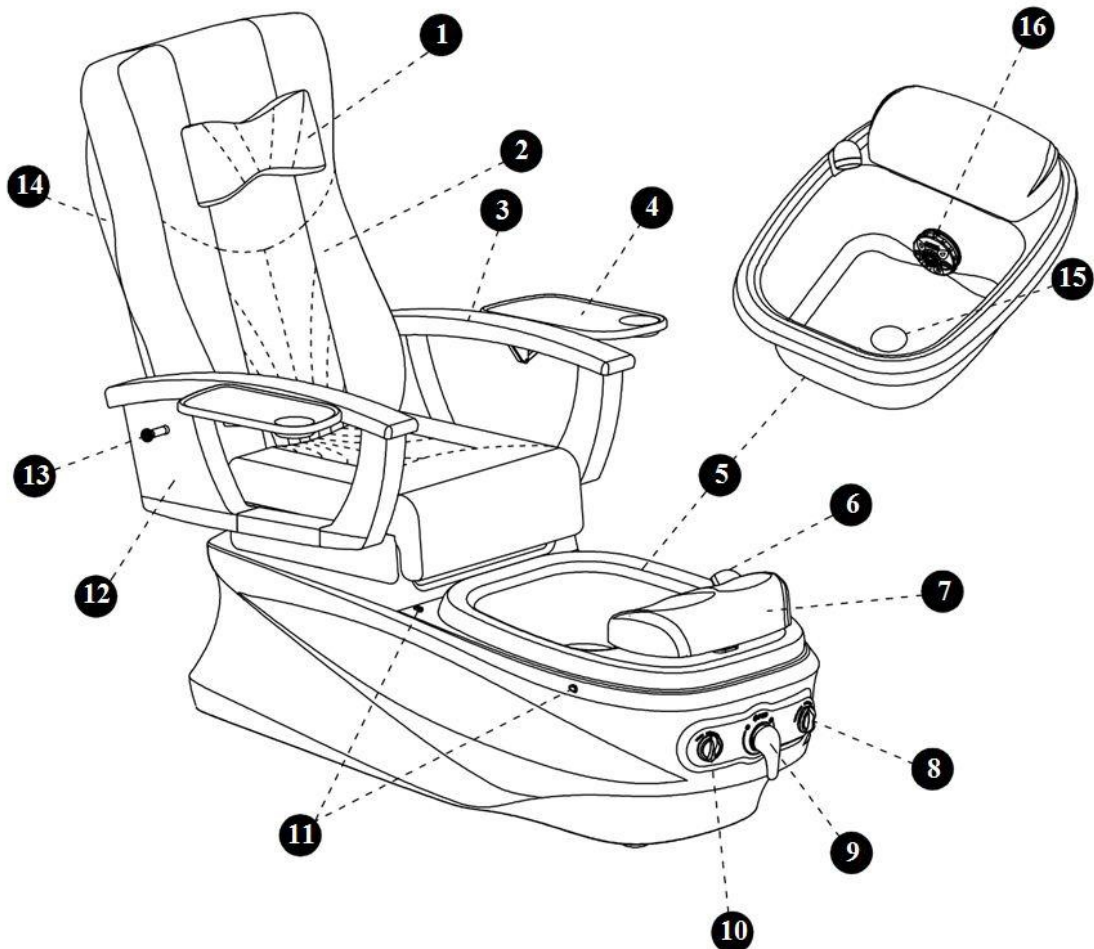

1. Headrest
2. Chair Cushion with Massage
3. Armrest
4. Manicure-Tray (Optional)
5. LED Gel Bowl
6. Flex Water Filler/Spray spout
7. Footrest
8. Jet On/Off Knob

9. Hot/Cold Water Mixer Valve
10. Sani-Drain™ System with Discharge On/Off Knob
11. Liner Hook
12. Up/Down Armrest
13. Handbag (Purse) Hook
14. Massage Remote Control
15. Drain Stopper
16. Ecojet® Magnetic Drive

Identifying Parts for PSD 400® Model

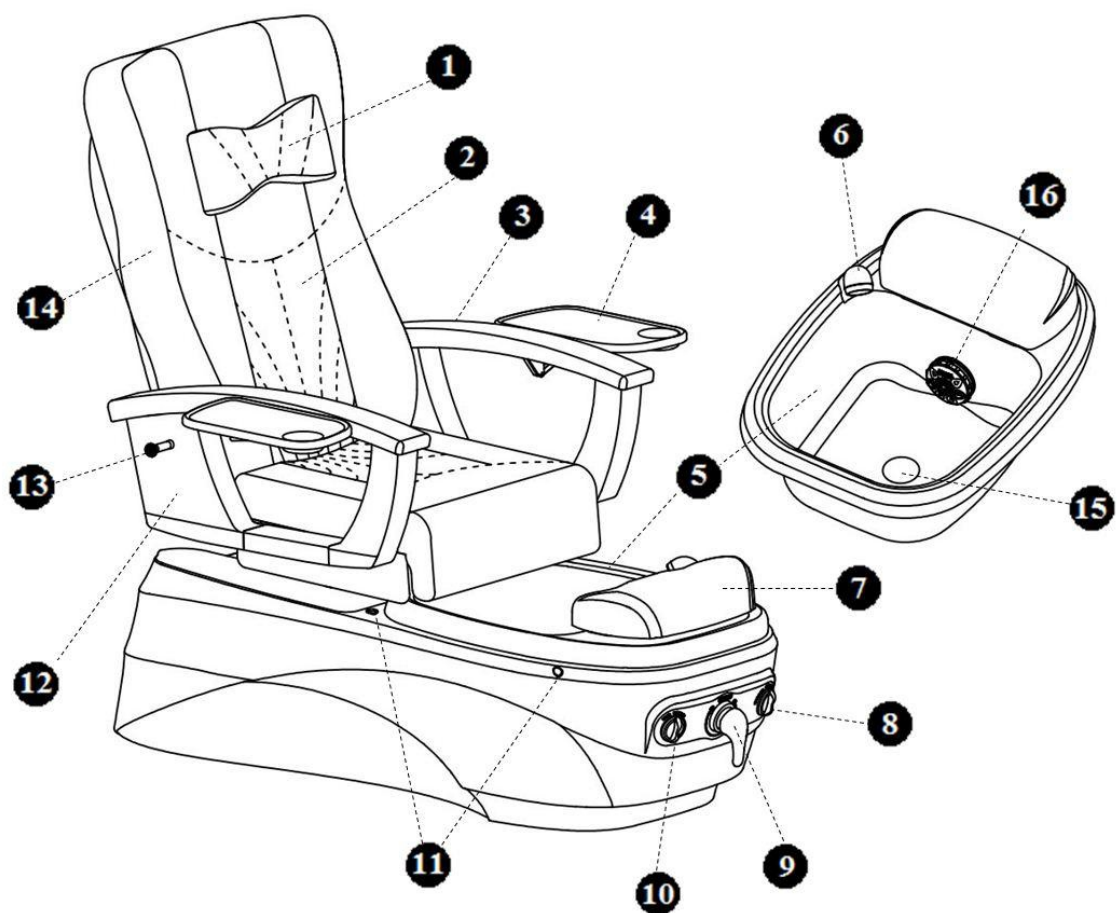

1. Headrest
2. Chair Cushion with Massage
3. Armrest
4. Manicure-Tray (Optional)
5. LED Gel Bowl
6. Flex Water Filler/Spray spout
7. Footrest
8. Jet On/Off Knob

9. Hot/Cold Water Mixer Valve
10. Sani-Drain™ System with Discharge On/Off Knob
11. Liner Hook
12. Up/Down Armrest
13. Handbag (Purse) Hook
14. Massage Remote Control
15. Drain Stopper
16. Ecojet® Magnetic Drive

SPA to SPA RECOMMENDED CLEARANCE:

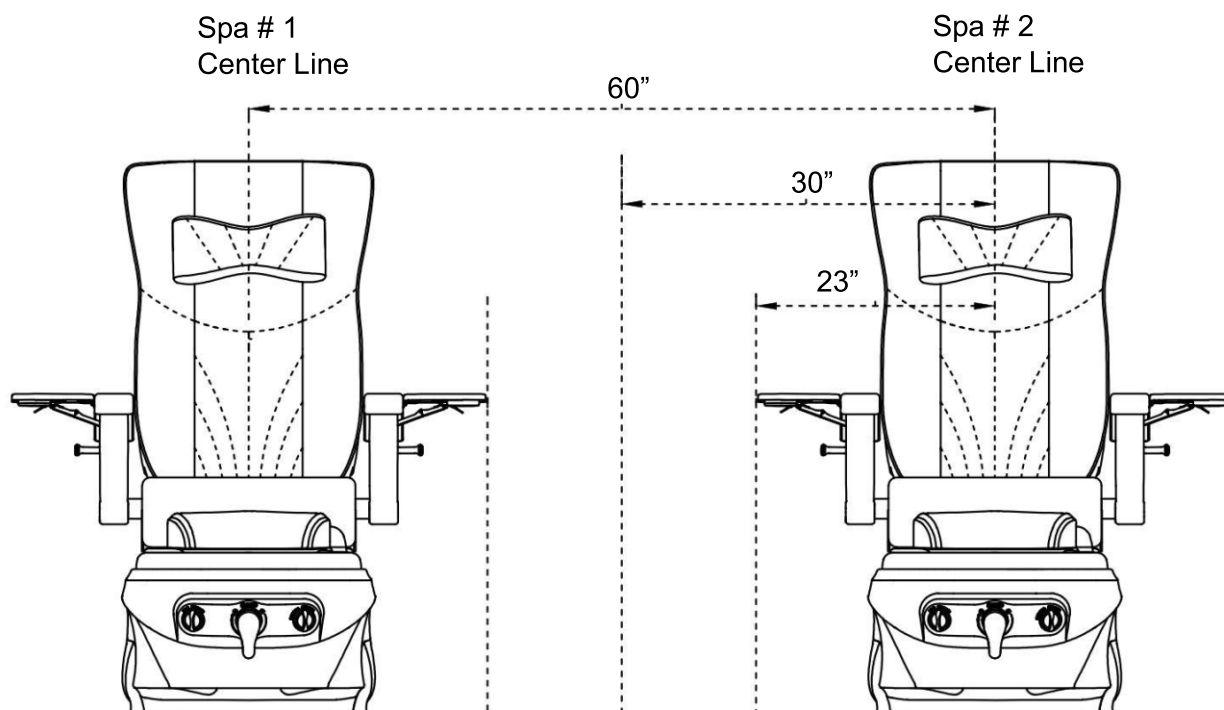

Wall Clearance:

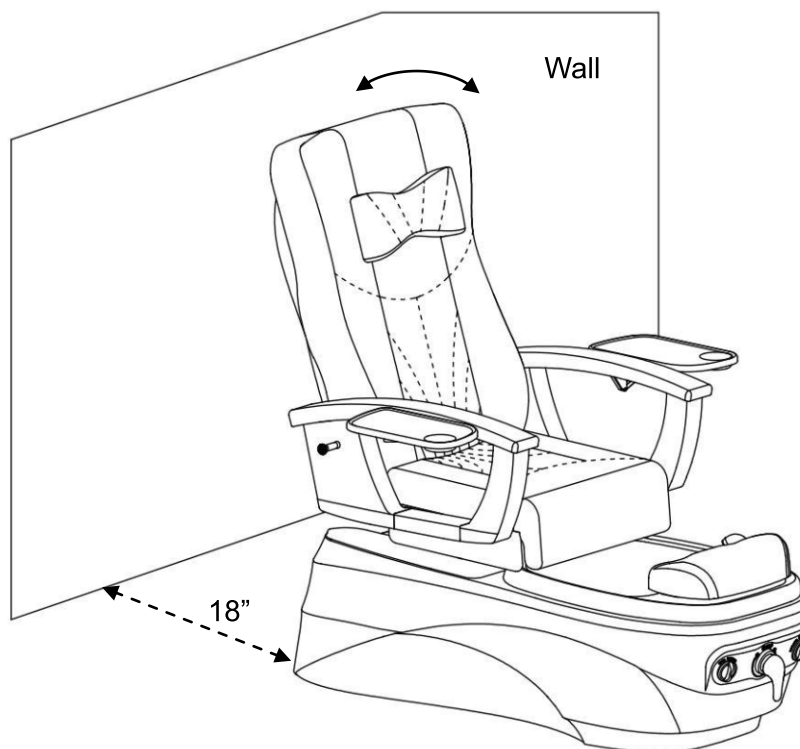

MANICURE TRAY/ ARMREST / BACK REST INSTALLATION

Up/Down Swinging Armrest, Manicure tray up and down

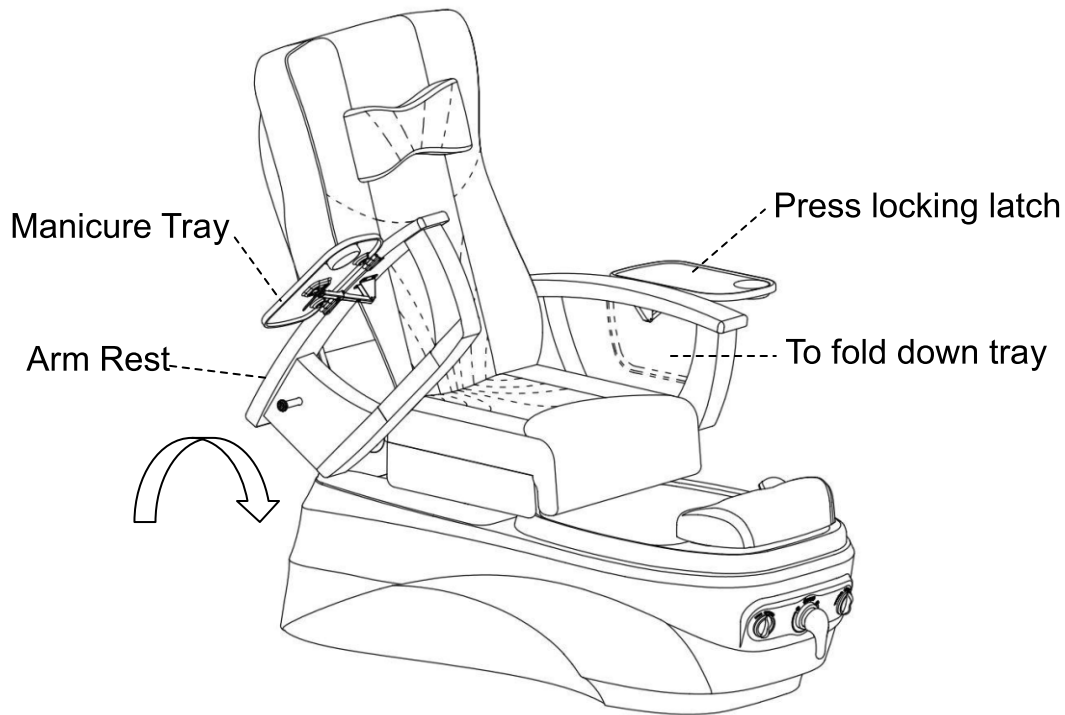

Back Rest:

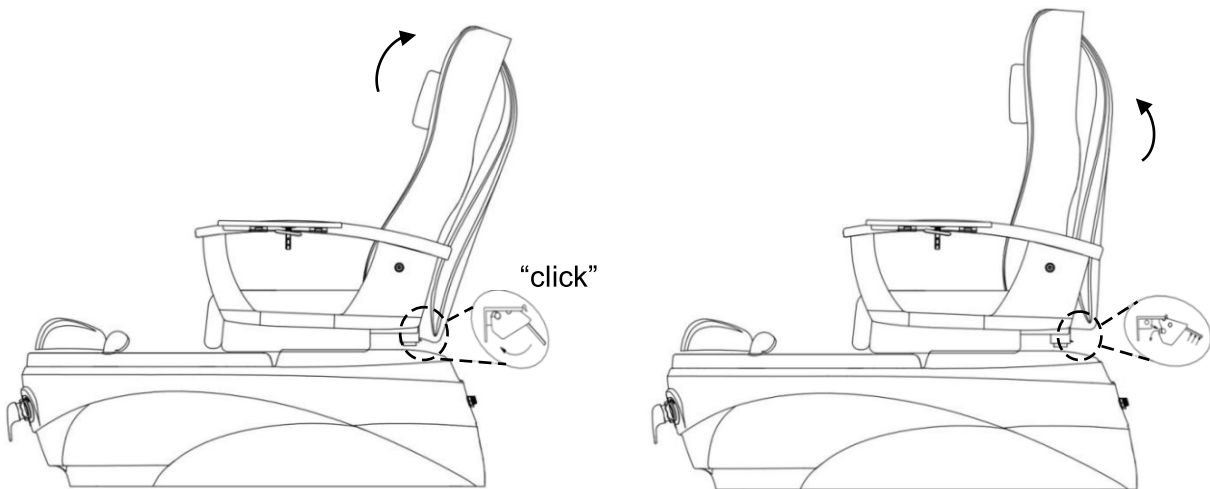

Raise the backrest until a "Click" is heard. Make sure the lever is locked before operating

To fold down backrest: Lift up lever handle.

Plumbing–Flow Pattern–Power Drain

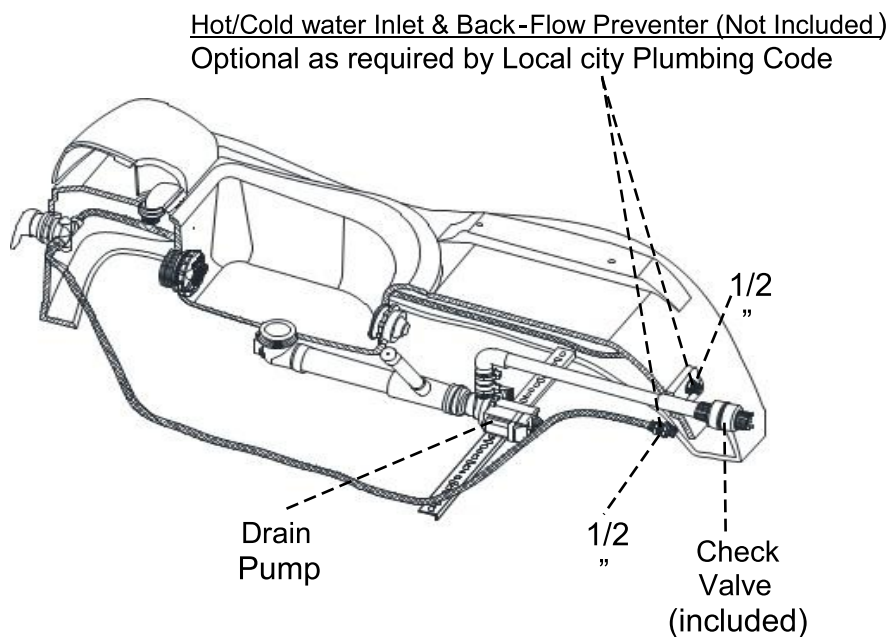

Drain System Recommendation

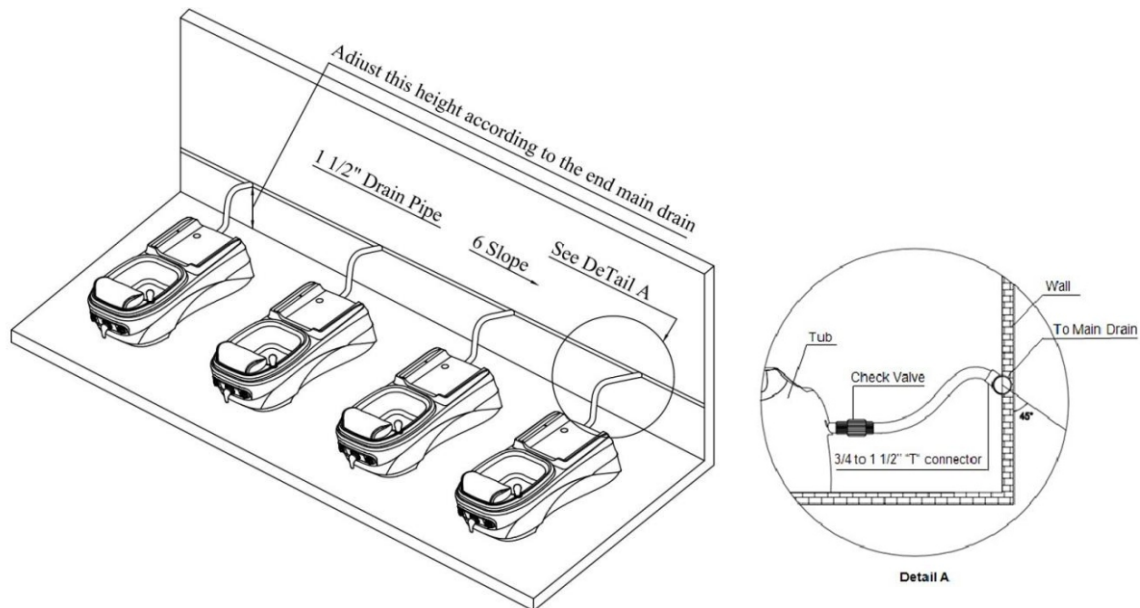

Using 3/4" schedule 40 PVC (Power Drain) and appropriate traps. Connect drain to meet local plumbing codes. Rubber connection to the drain should be removable for easy service and should not be permanent to prevent damages.

Plumbing - Flow Pattern- Gravity Drain:

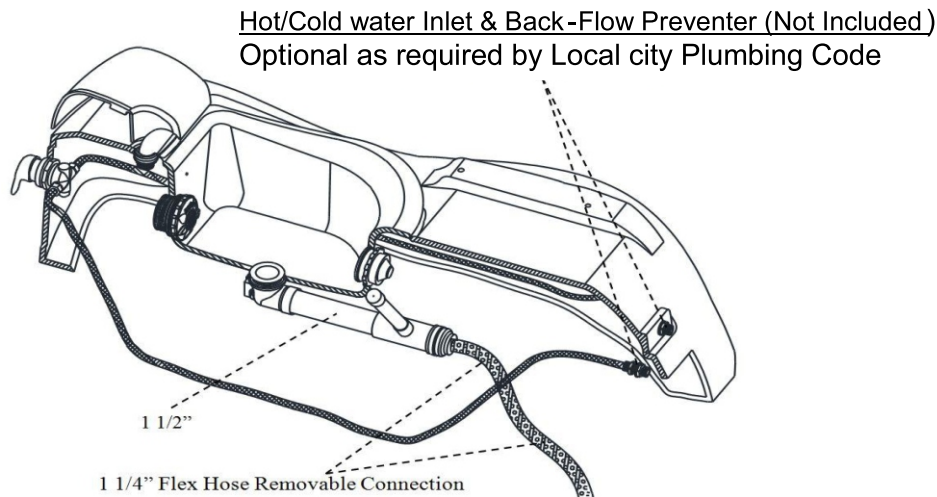

Using 1 1/4" flex tube (Gravity Drain) and appropriate traps, connect drain to meet local plumbing codes. Rubber connection to the drain should be removable for easy service and should not be permanent to prevent damages

HOT AND COLD WATER SUPPLY LINES

Carefully connect 1/2" ID supply hoses (not provided) to fresh water sources. Shut-off valves (not provided) should be utilized. Valves should be placed outside the tub for easy access.

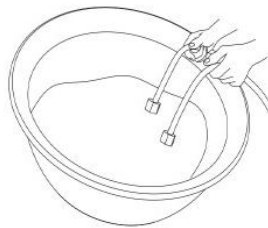

Before water line connections, please follow below:

- 1. New construction:** Make sure to remove any and all debris and/or dust from current hot cold water pipes before hooking up to spa. Suggested direction to remove debris: turn on water and drain into a bucket or container. See illustration above:
- 2. Replacement Spa:** Always use new hot/cold water hoses when connecting a new spa chair to prevent debris, such as old rubber particles, from clogging the system

ELECTRICAL AND PEDICURE SPA COMPONENT SPECIFICATIONS

All electrical connections MUST be made by a qualified, licensed electrician in accordance with Local & National Electrical and Building Codes. A 110V-50/60 Hz, 15 Amp, GFCI protected grounded circuit MUST be used to supply power to the Pedicure Spa. A dedicated circuit must be used with a GFCI. All wiring must conform to National & Local Electrical Codes.

WARNING: IT IS EXTREMELY IMPORTANT THAT THE FOOT SPA OPERATES WITH GFCI PROTECTION

VERY IMPORTANT Both back of chair and seat are adjustable. When both are at maximum positions one must allow 18" (44cm) from back wall to foot spa. This minimum distance assures unobstructed recline. Failure to follow this required dimension might damage your spa components and plumbing connections, which will void your warranty.

PEDICURE SPA SPECIFICATIONS:

Construction: Marble composite, high gloss, acetone-proof gel coat.
 Two (2) electro-mechanical knobs control the drain and whirlpool.
 Electro-mechanically operated reclining, massaging, and sliding seat with hand held control.
 One (1) pipe-less whirlpool jet. (Pipe-free technology)
 Power drain (optional) or Gravity drain (no drain pump)
 Extendable water spray positioned well above water line, air gap is accommodated with back-flow prevention required by plumbing code
 Armrest swing up / down.

SPECIFICATIONS LIST ALL		
Spa Dimensions & Weights PSD100, PSD200, PSD300, PSD400.	Spa = 30" (W) x 55" (L) All Models fully reclined: 74" (L). With Manicure Tray Installed: 46" (W) Empty Weight: ~ 200 lbs. Shipping Weight: ~ 260 lbs.	
Adjustable Stool	Pedicure Stool: Manicure Stool:	12" – 13". 16.25" – 20"
Spa Water Capacity	~ 4 US Gallon	
Jet Motor	120 VAC. At 85W 60Hz	
Massage Motors, Seat Sliding & Reclining	24VDC, 2.5A x 5	
Discharge Pump	Motor – 120V at 85W 60 Hz Maximum vertical lift: 3ft . Flow rate 400 GPH @ floor level	
Power source	115 VAC, 60HZ, 15A. Power needed per spa chair = 6 Amp	
Electrical Switches	One (1) electro-mechanical knob for the Whirlpool. Rated at 5A contact. One (1) electro-mechanical knob for the Drain. Rated at 5A contact.	
Safety	Pedicure Spa is UL Listed.	

OPERATION AND CARE INSTRUCTIONS

Filling Water :

Close the Drain Stopper by turning the Drain Knob counterclockwise. Utilizing the single lever hot/cold mixer faucet located on the front of the Pedicure Spa, fill the tub to the water level above the whirlpool jet at least 1 inch. You must completely submerge the jet. If during the operation of the whirlpool, the water level decreases, simply add more water.

Whirlpool Starting :

Turn the Jet Knob located on the right side of the front panel to clockwise to turn on.
Turn counterclockwise to shut off.

Warning: Do NOT turn "ON" the JET PUMP KNOB unless adequate water is in the tub.
THE WARRANTY IS VOID IF THE PUMP HAS BEEN RUNNING DRY

Draining :

Turn the Drain Knob clockwise to open the Drain Stopper.
Power Drain will turn on automatically if drain pump exist.
Dual Action Electro-mechanical Switch located on the left side of the front panel) When activating the switch, it will raise the drain-stopper and power up the drain pump (if exist) at the same time.

Warning: Do NOT turn "ON" the JET PUMP KNOB unless adequate water is in the tub.
THE WARRANTY IS VOID IF THE PUMP HAS BEEN RUNNING DRY

NOTE: Whirlpool action can cause even small amounts of soap or body oil to foam excessively. For this reason, refrain from using these products during the whirlpool cycle.

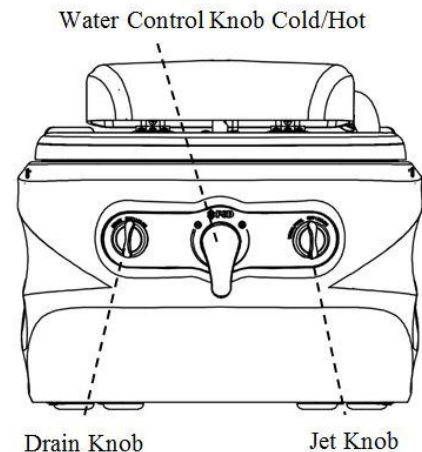

MAGNETIC JET COVER REMOVAL & INSTALLATION:

1. Turn Counterclockwise to remove. Turn Clockwise to install.

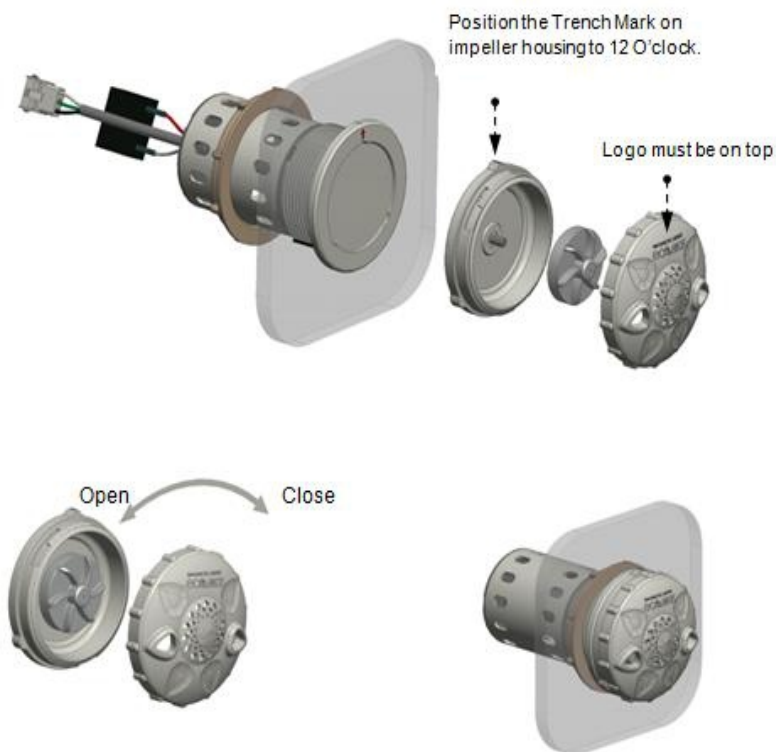

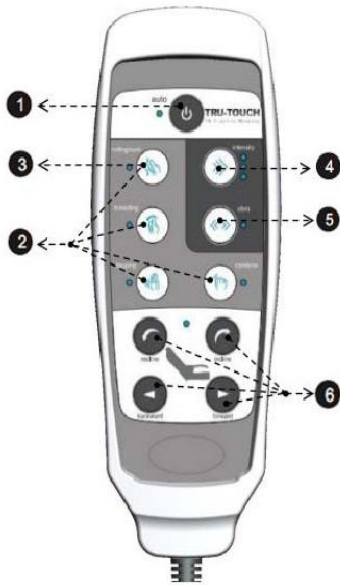
MESSAGE SYSTEM & REMOTE CONTROLLER:

1. Press Auto Button to start Auto mode. Press again to turn off massage. Auto and Manual mode will run for duration of 15min.
2. Press any button (Rolling/Spot, Kneading, Tapping, Combine) to enter Manual mode.
3. Press Rolling/Spot to stop rolling up/down and stop at desired spot.
4. Press Intensity button to select tapping intensity.
5. Vibro Button/LED is an option. Pressing this button will resume with Tapping action.
6. Press any chair button (Recline, Incline, Backward, Forward) to move the chair to desired positions.

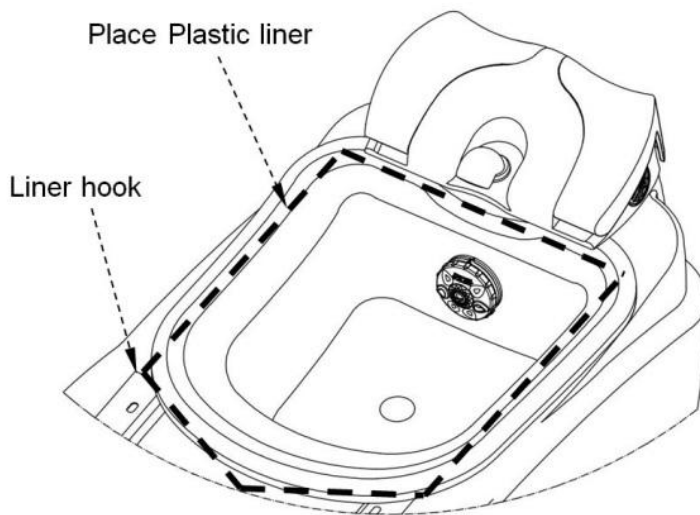
AUTOFILL SYSTEM USING PLASTIC LINER



EUROPEAN INSPECTION AND CERTIFICATION COMPANY S.A.

CERTIFICATE OF CONFORMITY

FULLNESS EXAMINATION OF TECHNICAL FILE

Certificate No. : EMC.0025
Issue Date : 23/05/2016
Applicant : LAC LONG CO., LTD.
(Name & Address) : Lot Q4, 8th Street, Long Hau Industrial Park,
Long Hau Ward, Can Giuoc District, Long An Province, Vietnam
Manufacturer : Same as applicant
(Name & Address)
Test Report Nos. : E16032004
Product Description : SPA CHAIR
Model(s) : Luminous Spa, Infinity Spa, Elite Spa, Mystique Spa, Envision Spa,
Liberte Spa, Ultima Spa, European touch Spa 100, European touch
Spa 200, European touch Spa 300
Directive(s) : Electromagnetic Compatibility Directive 2004/108/EC
Standard(s) : EN 55014-1:2006/A2:2011, EN 55014-2:1997/A2:2008

This is to attest that, upon the relevant request of the applicant, EUROCERT as Third Party Authority has reviewed the Technical Construction File of the described product which found to fulfill the basic health and safety prerequisites of above mentioned Directive(s).

Note:

- The manufacturer should issue a EC Declaration of Conformity according to the basic requirements of the applicable and relevant EC directives.
- The holder of the certificate shall use it in connection with the EC declaration of conformity.
- The CE marking can be affixed on the above mentioned product with the manufacturer's responsibility, if all relevant and applicable EC directives are complied with.
- All modifications to the Technical File should be first submitted to the Third Party Inspection Authority to ensure further validity of this attestation.
- This certificate is valid only for the product and configuration described above.



Third Party Authority Stamp

On Behalf of EUROCERT

George N. Sifonios
Director of Development

89, CHLOIS STR. & LIKOVRISEOS, 144 52 METAMORFOSI, ATHENS, GREECE
Tel.: ++30 210 62.52.495, 30 210 62.53.927 - Fax: ++30 210 62.03.018
Internet site: www.eurocert.gr - e-mail: eurocert@otenet.gr

