

User Manual ANS-P20

Table of Contents

Safety Precautions	3-5
Chair Components	6
Chair Installation.....	7-13
Condition A. Chair with vertical (up and down) mechanism	
Condition B. Chair with metal frame	
Grounding Instructions	14
Chair specification	14
Controller Diagram	15-18
Troubleshooting	19
Chair Care and Storage.....	20
Register Warranty Form.....	22

1 Safety Precautions

Important Safety Instructions

When using the massage chair, basic precautions should always be followed, including the following: Read all instructions before using this massage chair.

DANGER-To reduce the risk of electric shock:

- Always unplug this massage chair from the electrical outlet immediately after using and before cleaning.
- Never use pins or other metallic fasteners with this appliance.
- Carefully examine the covering before each use. Call for service if the covering shows any sign of deterioration, such as blistering, peeling or cracking.
- Keep dry- Do not operate in a wet or moist condition.

WARNING- To reduce the risk of burns, fire, electric shock or injury to persons:

- Read all instructions before using.
- A massage chair should never be left unattended when plugged in. Unplug from the outlet when it is not in use and before putting on or taking off parts.
- Close supervision is necessary when this massage chair is used by or near children or disabled persons. Keep children away from reclining backrest and extended leg rest.
- Use this massager chair only for its intent use as described in this manual.
- Never operate this massage if it has a damaged cord or plug, if it is not working properly, if it has been dropped or damaged, or dropped into water. Contact Customer Department.
- Keep the cord away from heated surfaces.
- Never operate the massage chair with the air openings blocked. Keep the air openings free of lint, hair, and the like.
- Never drop or insert any object into any opening.
- Do not use outdoors.
- Do not operate where aerosol (spray) products are being used or where oxygen is being administered.
- To disconnect, turn all controls to the off position, then remove the plug from the outlet.
- Do not stand on or in the massage chair. Use only while seated.
- The product is not intended for use by children or persons with reduced physical, sensory or mental capabilities, or lack of experience and knowledge, unless they have been given supervision or instruction concerning use of the product by a person responsible for their safety.
- Children should be supervised to ensure that they do not play with the product.
- Temperatures sufficiently high to cause burns may occur regardless of the control setting. Do not use on an infant or invalid or on a sleeping or unconscious person. Check the skin in contact with the heated area of the appliance frequently to reduce the risk of blistering.
- Burns may result from improper use
- Do not crush-avoid sharp folds.
- Keep children away from extended foot support (or other similar parts).
- DO NOT WET-DO NOT USE PINS.
- NEVER REMOVE COVER.
- Connect this appliance to a properly grounded outlet only.
See Grounding instructions. **Save These Instructions**

1. Usage Environment

- Do not use the massage chair in an excessively humid or dusty environment as this may result in malfunction or electric shock.
- Do not use the massage chair in a room with a temperature of 104°F or higher.
- Do not expose the massage chair to heaters, stoves or direct sunlight.
- Place and use the massage chair on an even, non-slip floor.
- The massage chair is designed for commercial purposes.

2. Safety Precautions

- To ensure safe and correct use of the massage chair, do not operate it without reading this operation manual carefully.
- Do not use the massage chair when the upholstery or seat is removed. This may cause injury or malfunction.
- Do not use the massage in combination with other therapeutic equipment or electric blanket, etc, as this may result in ineffectiveness or injury.
- Do not use the massage chair an hour before or after eating as this may have adverse effects on the user.
- Do not allow children or pets to play around the massage chair, e.g. behind the backrest, under the seat or leg rest of the massage chair. This may result in injury.
- Do not use the massage chair when your body is wet.
- Do not operate the massage chair with wet hands.
- It is not recommended to use the massage for more than 30 minutes.
- Do not perform continuous massage on the same spot of your body for more than 5 minutes at a time as this may result in excessive stimulation and may have adverse effects.
- Do not insert your hand or foot along the paths of the massage rollers during use as this may cause injury.
- Stop operation immediately if you experience any discomfort.
- This product is not intended for self-treatment of conditions that should be managed by a qualified health care provider.
- People on medication or with medical conditions, please consult your doctor before use. Please do not use the product if you are not feeling well.

Caution

- This massage chair is to be used indoors only.
- If you use the massage chair in a cold room, do not increase the room temperature abruptly. It is recommended that you increase the temperature gradually to a normal level.
- If the massage chair is stored in a cold place and is being brought into a warm environment, it is advisable to wait one hour before use. This is because its performance may not be at optimum level, as there may be water droplets on the mechanical parts due to condensation. Using the massage chair under such conditions may result in malfunction.

3. People with Medical Conditions Consult your doctor before use if you:

- are under medical rest as ordered by a doctor.
- have spinal disorders, an abnormal spinal condition or have suffered a spinal injury.
- have back problems.
- have diabetes, osteoporosis or sensory impairment.
- have joint dysfunction such as rheumatism, hammertoe or gout.
- have a pacemaker or other electronic medical devices.
- may be pregnant.

- have phlebitis or thrombosis.
- have an increased risk for blood clots.
- had recent surgery.
- have surgical pins, screws, or anything mechanical in the legs, ankles or feet.

Caution

- This massage chair is not intended for use by children or persons with reduced physical, sensory or mental capabilities, or lack of experience and knowledge, unless they have been given supervision or instruction or instruction concerning use of the massage chair by a person responsible for their safety.
- Children should be supervised to ensure that they do not play with the massage chair.
- Avoid using the massage chair under the influence of alcohol.
- Do not apply massage rollers directly on the head, elbow or knee joints, torso or abdomen.
- If your legs or feet slip off the leg rest during massage, do not force them back in as this may result in injury.
- Remove the power plug from the electrical outlet immediately should liquid be accidentally spilled onto the massage chair. Do not use wet hands to connect or disconnect the power plug from the electrical outlet.
- Do not tamper with the power cord or use the massage with a damaged cord as this may result in malfunction and electric shock.

4. Instances When the Massage Chair Should Not Be Used

In the following events, please switch off the main power switch immediately and disconnect the power cord from the electrical outlet:

- If water is accidentally spilled onto the massage chair. This may result in electric shock or malfunction.
- If the fabric of the backrest is torn and the internal components are exposed.
- If pain or discomfort is felt during massage, stop operation immediately and consult your doctor.
- If you detect any malfunction or any other abnormal condition during operation.
- If there is a power failure. Injury may occur when power is restored unexpectedly.
- If there is lightning.

5. Assembly and Repair of the Massage Chair

- Do not disassemble the backrest cover of the massage chair. Touching the internal components may result in malfunction or electrical shock.
- This massage chair must only be professionally serviced or repaired. Do not attempt to disassemble or repair the massage chair yourself.

6. Things to Note About the Power Plug and Cord

- Check that the Alternating Current (AC) voltage corresponds with the specifications indicated for the massage chair.
- Do not connect or disconnect the power plug from the electrical outlet with wet hands. This may result in malfunction or electric shock..
- When disconnecting the power plug, pull it by holding the plug, not the cord.
- Although operation will be stopped automatically by the Auto-Timer function, always remember to switch off the main power switch after use.
- Do not place the power cord under the massage chair or any other heavy objects.
- Do not wrap the power cord around the massage chair as this may damage the cord and result in a fire or electric shock.
- Do not operate the massage with a damaged cord or extension cord.
- Do not use the massage if the electrical outlet is loose.
- If the power cord is damaged, it should be replaced by a qualified technician

Chair Components

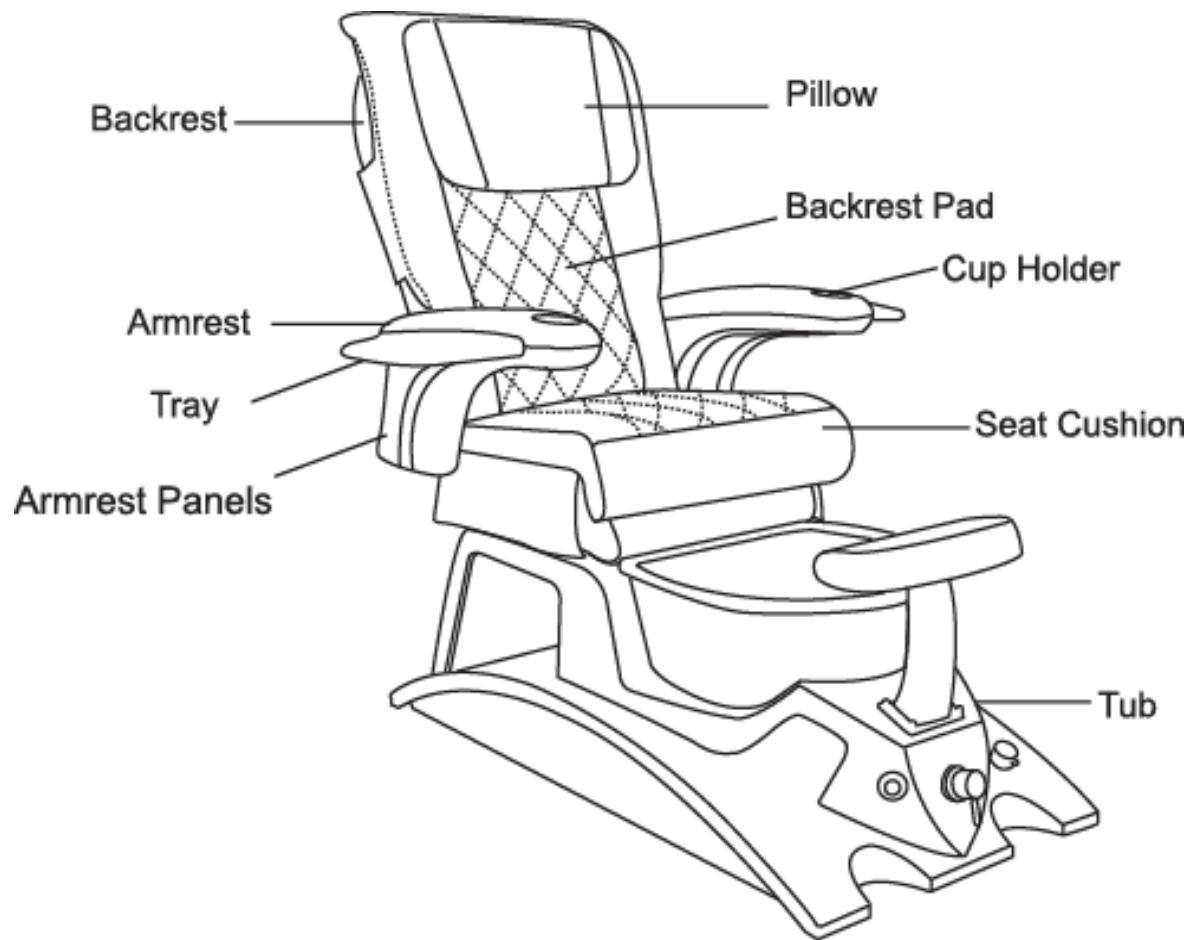

Electric Control Box

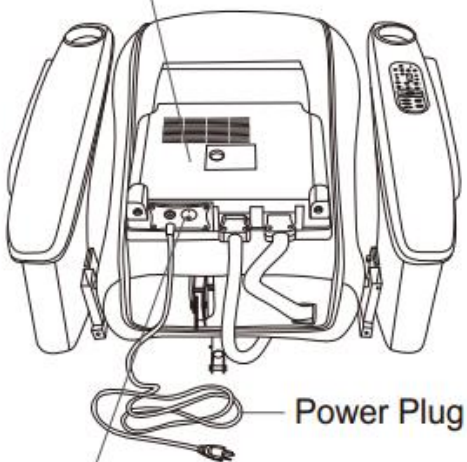

On/Off Power Switch

Raisable mechanism

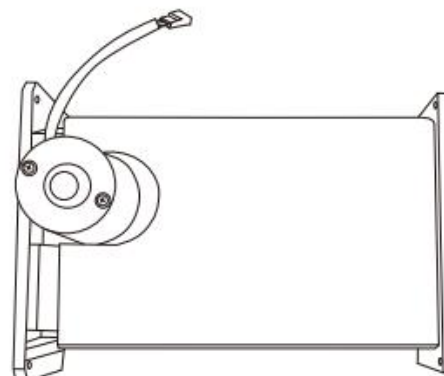

3 Chair Installation

Please leave sufficient spaces around massage chair for safe use. 25" behind the tub for reclining the backrest, and 45" from left to right for tray on the armrest.

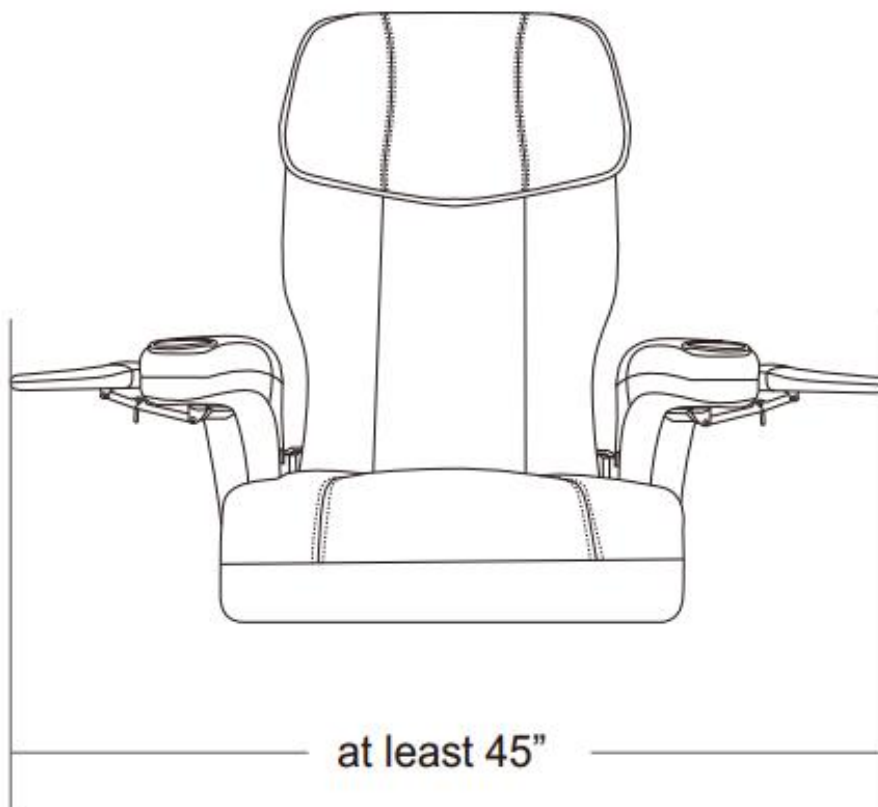
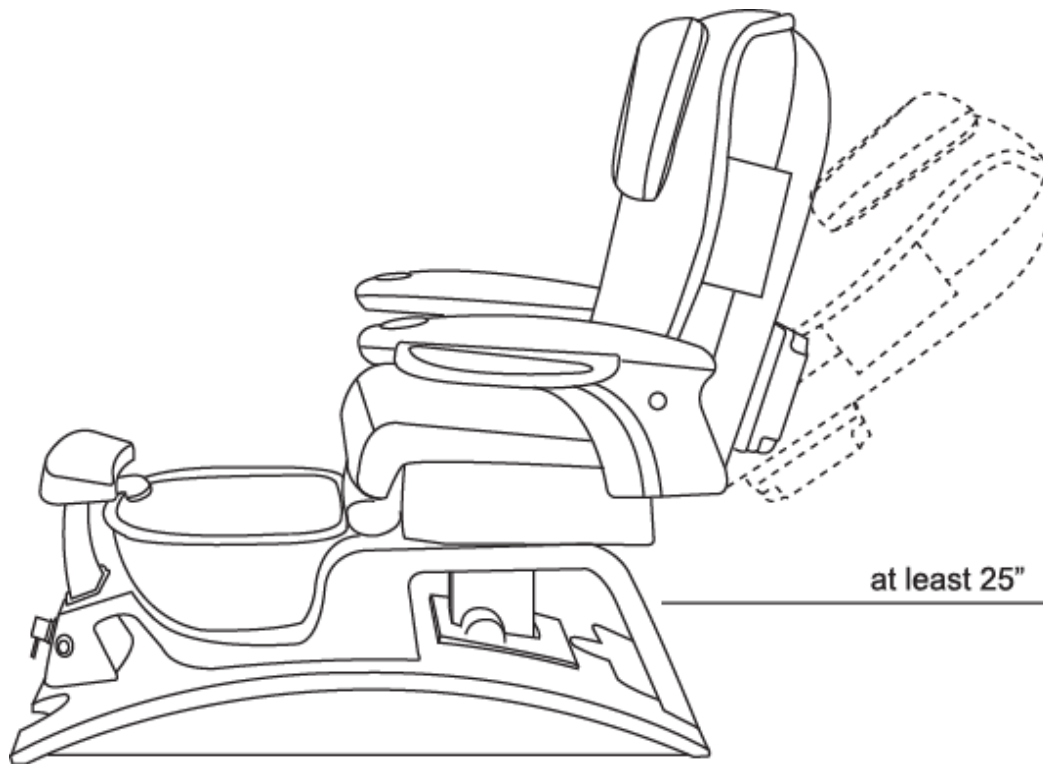

Condition A.

Chair with vertical (up and down) mechanism

Step 1:

Place the vertical mechanism into the tub as PIC6 (motor at the top), then secure the vertical mechanism with 4 bolts as PIC 7

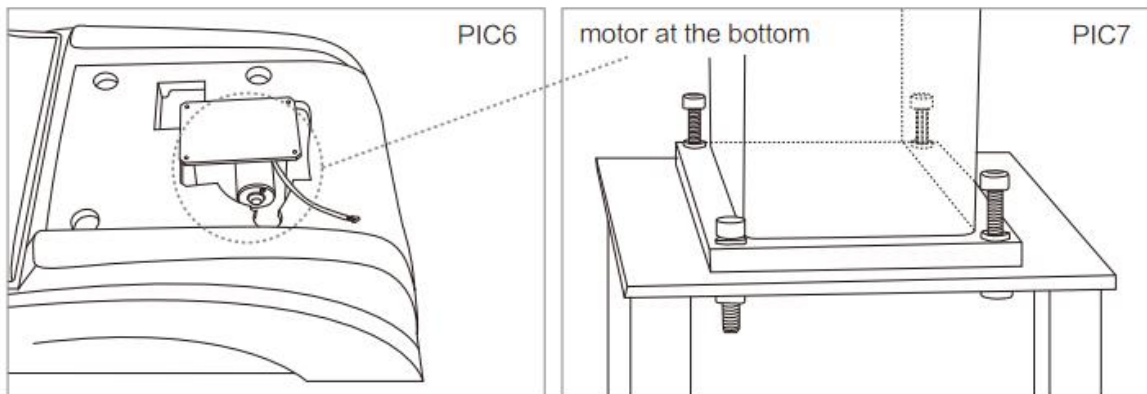

Step 2:

Disconnect the actuator cable and lean backrest 70° as PIC8, remove backrest from chair as PIC9, 10

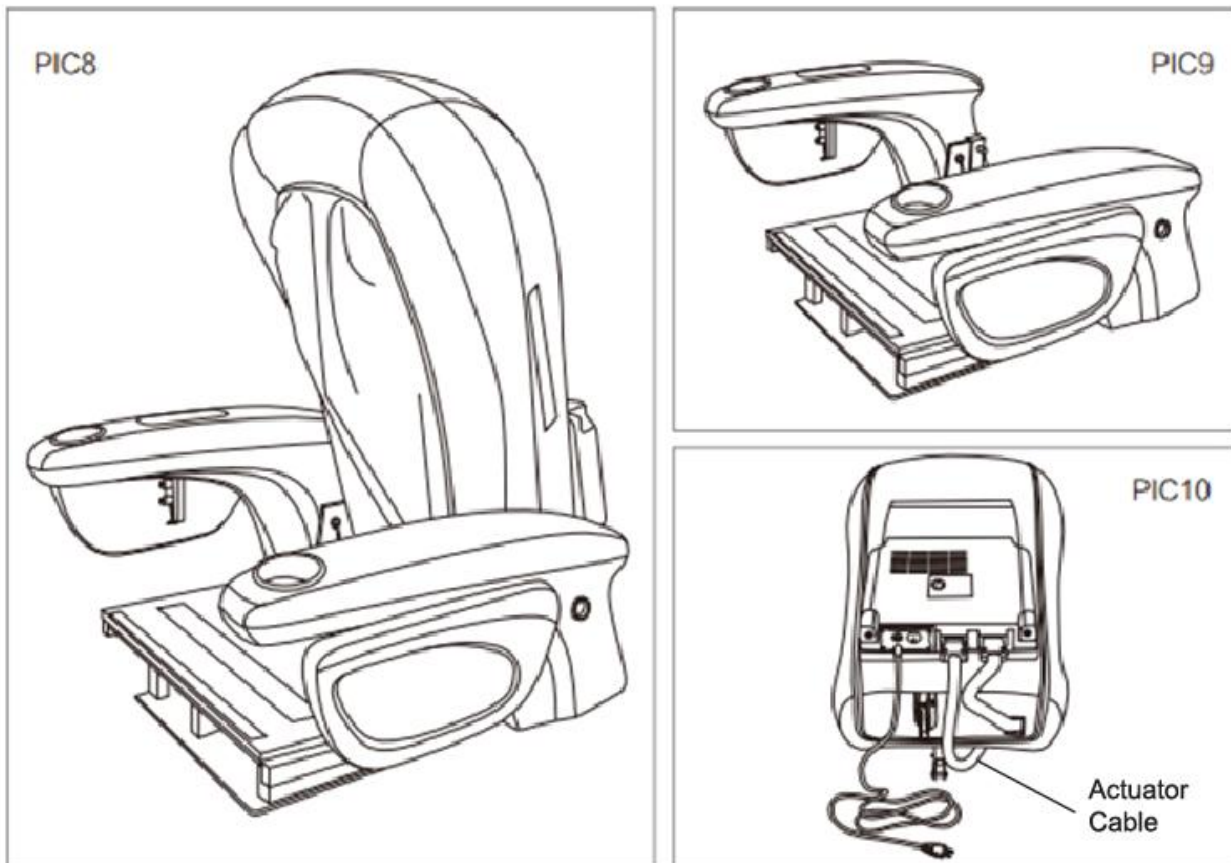

Step 3:

Place the p20+ chair on tub, unfold the seat board as PIC11,12 .

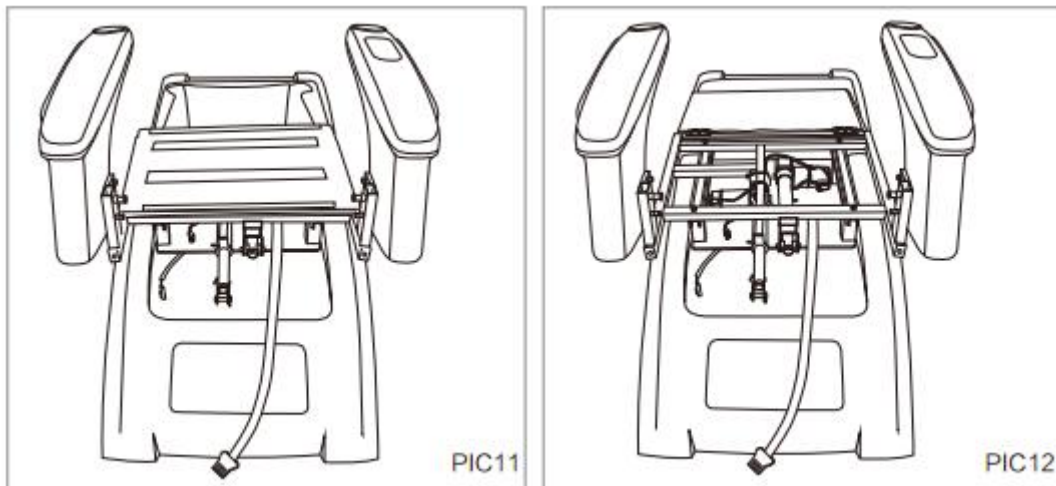

Secure seat frame onto vertical mechanism with 4 short bolts.

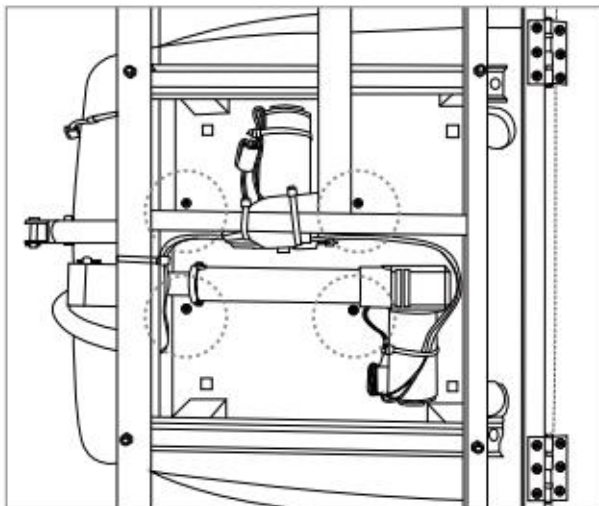

Step 4:

Connect the vertical mechanism together.

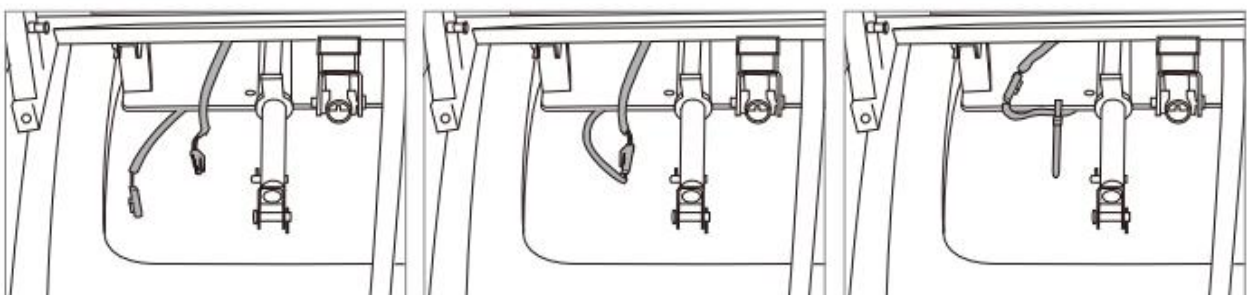

Step 5:

Install backrest back onto chair and connect actuator cable to backrest

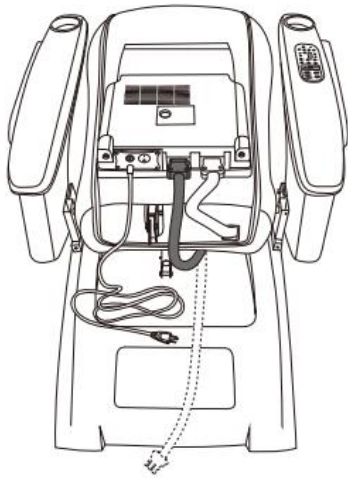

Step 6:

Straighten backrest to upright position and lock the latch on to actuator as PIC19-PIC21

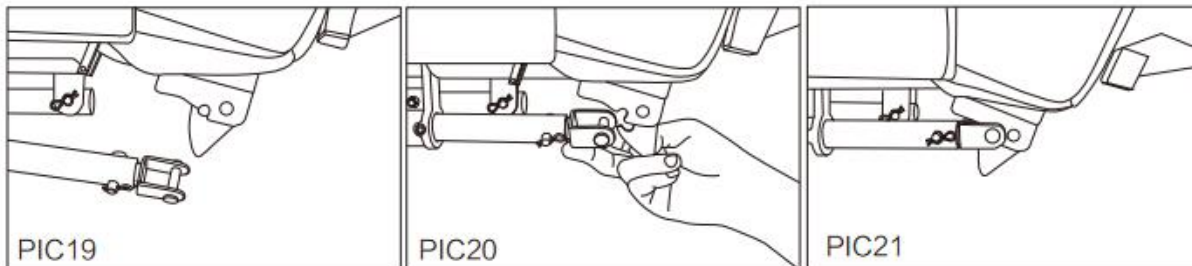

Step 7:

Place backrest pad, pillow and seat cushion on chair as PIC22 ~PIC27 .

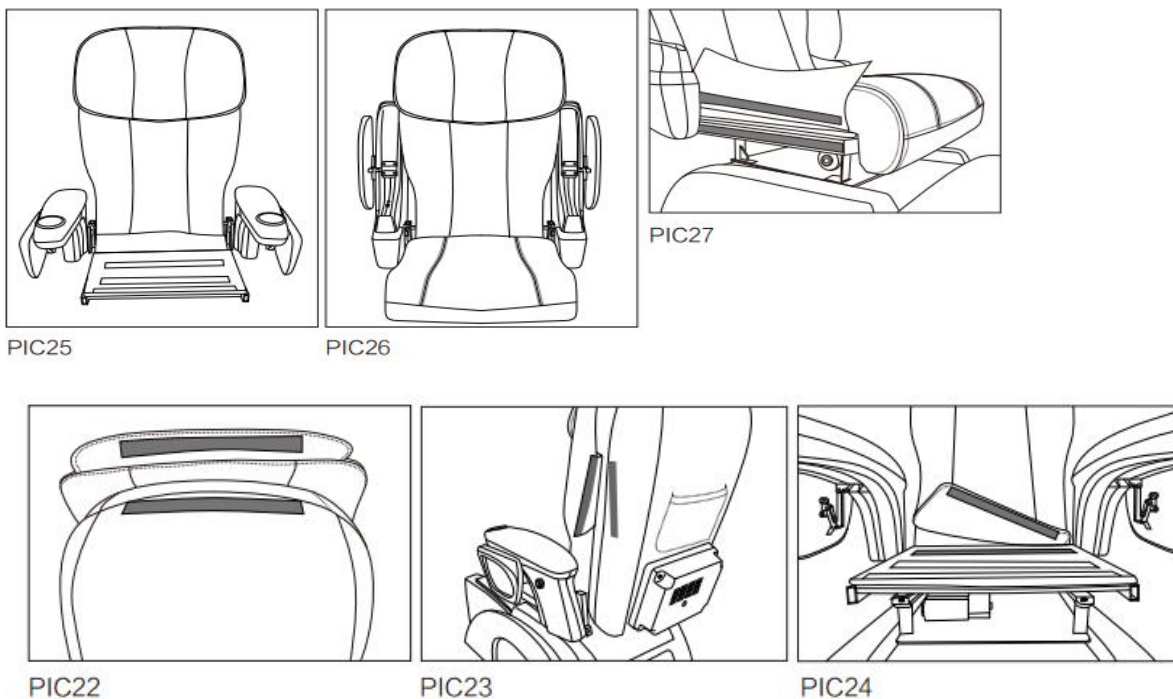

Condition B. Chair with metal frame

Step 1:

Disconnect actuator cable. Lean backrest 70° as PIC28, remove backrest from chair as PIC29, 30 .

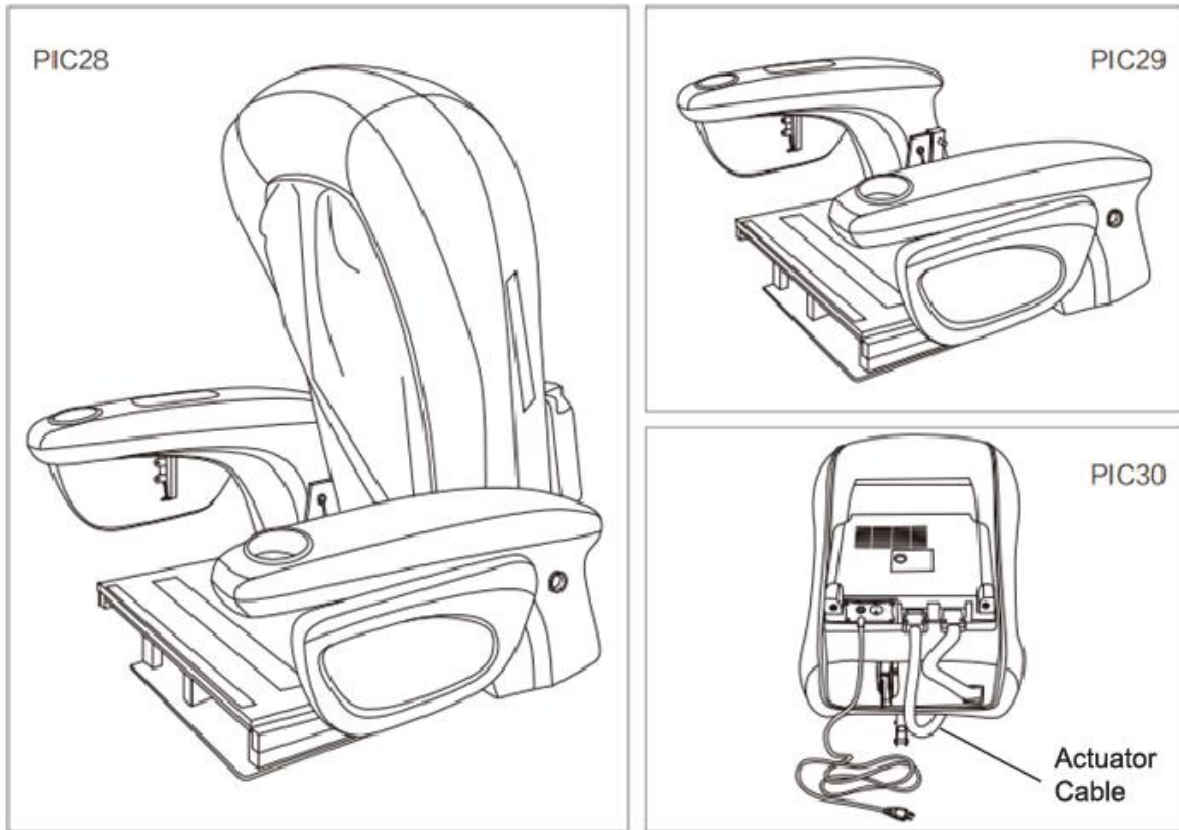

Step 2:

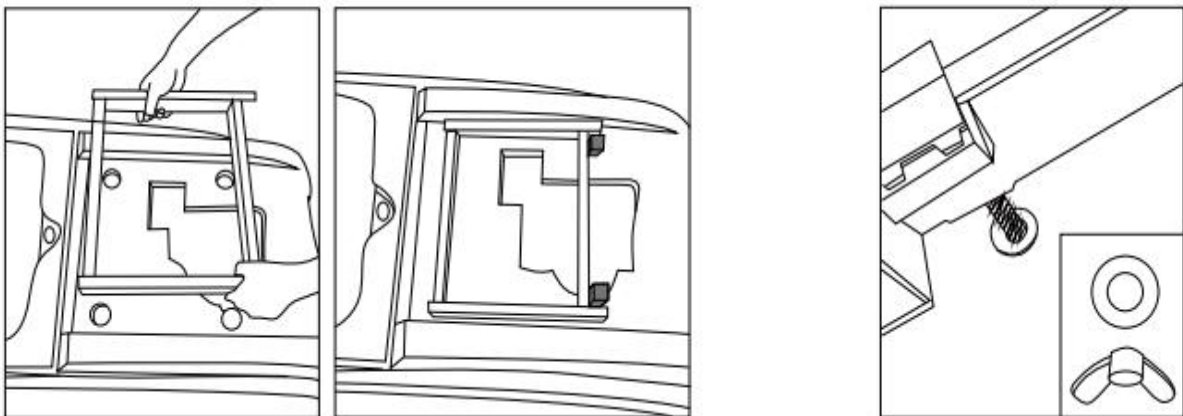

Step 3:

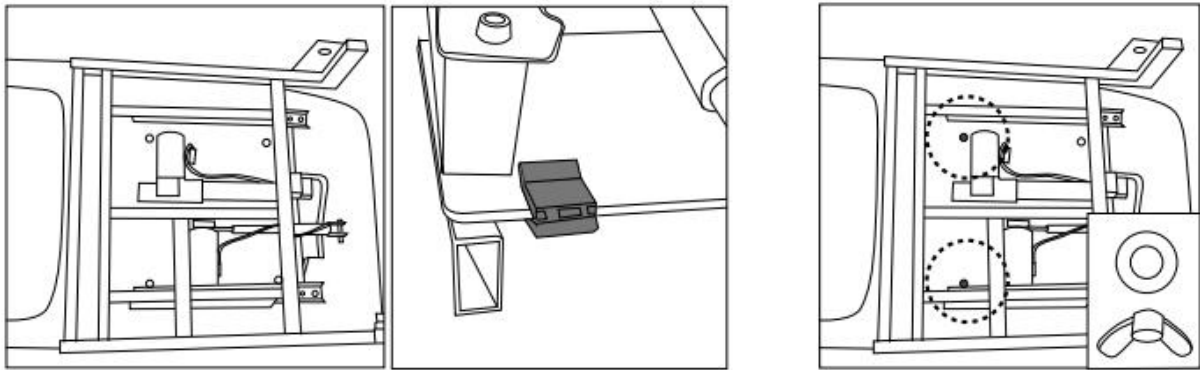

Slide chair onto the hooks located in back of the frame. Align 2 bolts in front of the frame to 2 holes of the chair. Then secure the 2 bolts nuts.

Step 4:

Place backrest back onto chair and connect actuator cable to backrest.

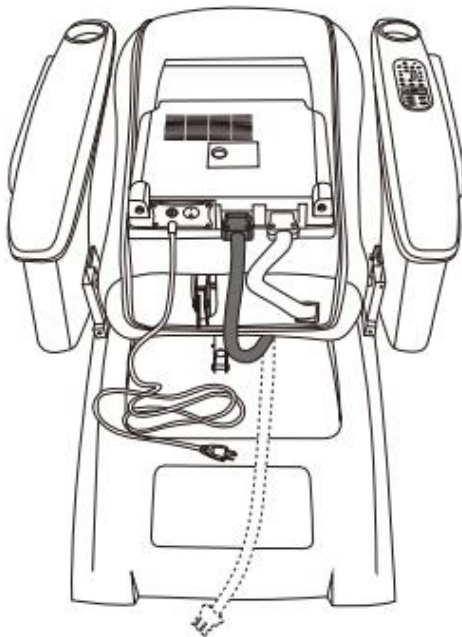

Step 5:

Straighten backrest to upright position and lock the latch on to actuator as PIC38-PIC40.

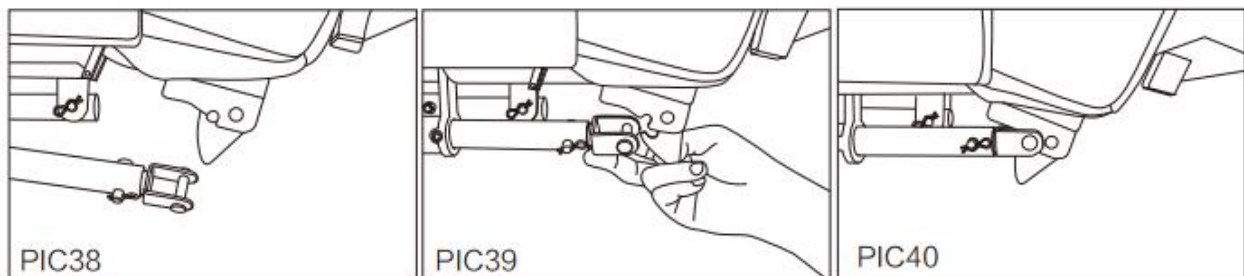

Step 6:

Place the backrest pad, pillow and seat cushion onto the chair as pic41-46.

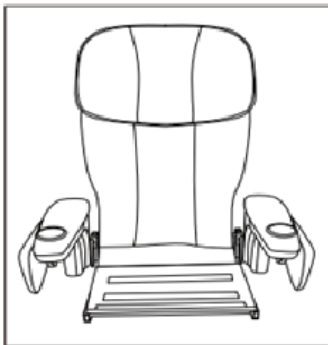

PIC41

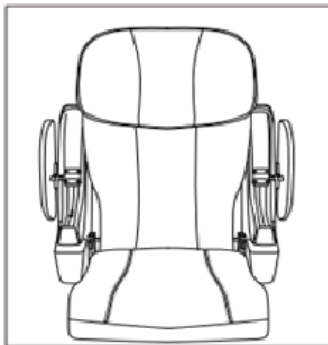

PIC42

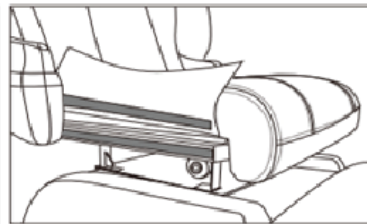

PIC43

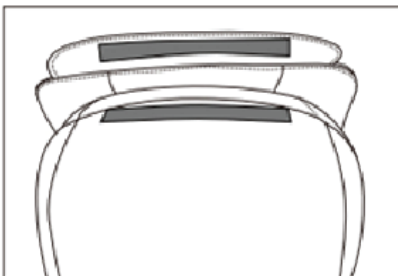

PIC44



PIC45

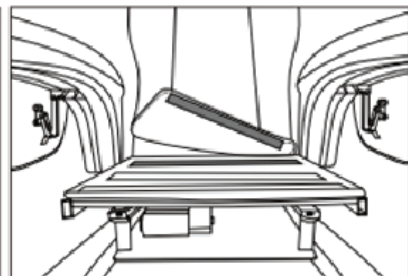

PIC46

Note: Raise the right armrest, USB socket and headset port is located under the armrest.

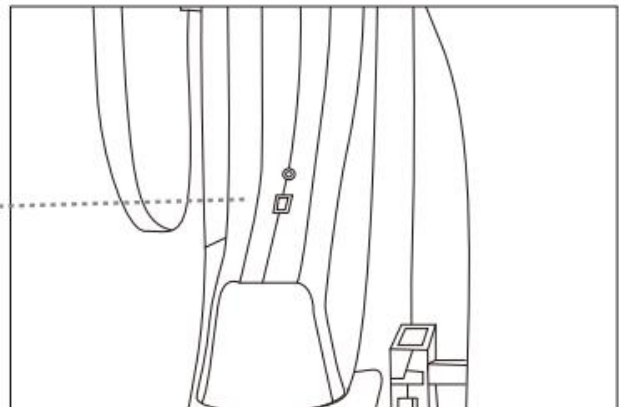
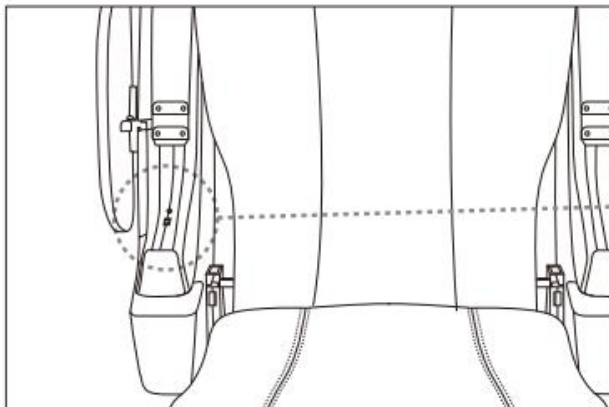

Note: There is a spare socket on rear cover. The max power consumption is 350W.

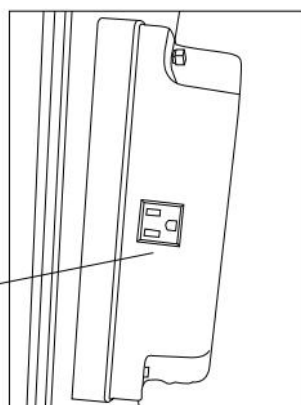
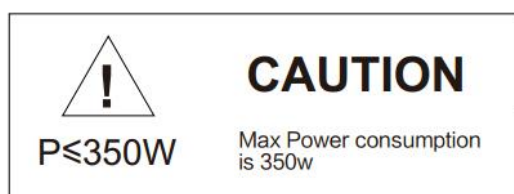

04

Grounding Instructions

This product must be grounded. Because when it have some malfunction, grounding provides a path of least resistance for the electric current to reduce the risk of electric shock. This product is equipped with a cord with an equipment-grounding conductor and a grounding plug. The plug must be plugged into an appropriate outlet that is properly installed and grounded in accordance with all local codes and ordinances. Danger-Improper connection of the plug and outlet can result in a risk of electric shock. Therefore, please check with a qualified electrician or service technician first if you are provided with the product which doesn't fit your outlet. This product is sold widely, and matched different plug for the use in different areas, please must pay attention to distinguish as below picture demonstrated. Make sure that the product is connected to an proper local outlet that have the same configuration as the plug used in the product. And no adapter should be used for this product.

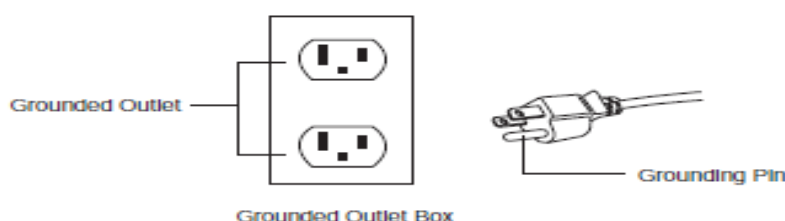

5 Chair Specifications

Description	Specifications
Product Name	Pedicure SPA Chair
Model number of the Product	ANS-P20
Rated voltage	110-120V ~
Rated Frequency	50/60Hz
Power consumption	118W
Timer	5/10/15/20/25/30 minutes
Maximum operating period	30 minutes
Shipping dimensions (L/W/H)	44" x 31" x 20"
Weight	Gross weight:140lbs
	Net weight:120lbs
Length of wire	77"
Storage condition	Storage temperature: 20-60°C
	Storage humidity level: 30-85RH
Usage condition	Environment temperature: 20-60°C
	Contrasting humidity: 30-85RH

Controller Diagram



1. ON/OFF



The Power Control Button

Press POWER button once to activate massage chair functions. Press twice to activate the timer feature. Press the third time to turn off the chair. Massage rollers will return to its original position.

Note:

- Before your press the ON/OFF button to start the chair, please make sure the chair power cord is plug in wall outlet, and the power switch at the bottom of electrical control box is turned on.
- POWER button will flash and all massage functions will stop after the built-in 30min timer has finished. To resume massage, simply press additional massage functions to continue massage.

2. PAUSE



The pause button will stop all massage functions and turn the chair into idle mode. Press the pause button again to resume the original massage function.

Note: While massage is pause, timer is also paused. To resume massage or change massage function, simply press PAUSE button again.

CHAIR RECLINED ANGLE AND POSITION ADJUSTMENT



3/4. BACKREST RECLINE/ RESTORE



To adjust backrest position, press & hold  or , until desired position and release button.

5/6. CHAIR FORWARD/BACKWARD



To adjust seat position, press & hold  or , until desired position and release button

7/8. CHAIR UPWARD / DOWNWARD



To adjust seat height position, press & hold  or , until desired position and release button.

9. RESTORE CHAIR POSITION



Press , and chair will move to its original position.

Note: To achieve desired position, please hold button down. Power must be turned on to restore chair position.

MANUAL MASSAGE PROGRAM

10. KNEADING



3 levels of adjustable strength. Press button once to activate the Kneading function for a full back massage at medium strength. Press again to stop

11. TAPPING



3 levels of strength and width adjustable. Press button once to activate the Tapping function for a full back massage at medium strength and width. Press again to stop

Note: Tapping and Kneading functions can be combined.

12. SWEDISH



3 levels of adjustable strength. Press button once to activate the Swedish function for a full back massage at medium strength. Press again to stop

13. SHIATSU



3 levels of adjustable strength. Press button once to activate the Shiatsu function for a full back massage at medium strength. Press again to stop

14. KNEADING/TAPPING



3 levels strength adjustable. Press button once to activate the Kneading/Tapping function for a full back massage at medium strength. Press again to stop.

15. ROLLING



3 levels width adjustable. Press button once to activate the rolling function for a full back massage at medium width. Press again to stop.

16. SPOT



When operating manual massage function mode, press button to target that massage area. Press again to stop and resume original massage technique selected.

Note: The spot function is not available in auto program mode.

17. PARTIAL



When operating manual massage function mode, press button to start a partial massage at the range about 3" in center of the position stopped. Press again to stop partial massage and resume original manual technique selected. **Note:** The partial function is not available in auto program mode.

18/19. ROLLERS UPWARD / DOWNWARD ADJUSTMENT

When operating manual massage function mode, massage rollers are adjustable using the upward/downward buttons. **Note:** Adjustable roller option is not available in auto program mode.

MUSIC CONTROL

20. MUSIC START/STOP

21/22. SELECT SONG: BACK/NEXT

23/24. VOLUME ADJUSTMENT

AUTO PROGRAM

25. UPPER BACK

Press to start neck and shoulder massage at strong strength level. Press STRENGTH to adjust in sequence of “strong>weak>medium>strong”. Press again to stop.

26. FULL BACK

Press to start full back massage at medium strength level. Press STRENGTH to adjust in sequence of “medium>strong>weak>medium”. Press again to stop.

27. LOWER BACK

Press to start lumbar massage at strong strength level. Press STRENGTH to adjust in sequence of “strong>weak>medium>strong”. Press again to stop.

28. STRENGTH- 3 level adjustable

Available in Manual or Auto Program Mode. Massage strength level can be adjusted by a press of a button.

Note: Strength function is not available in rolling position.

29. WIDTH Available for Tapping, Shiatsu and Rolling Functions

three adjustable levels. Massage width can be adjusted one level at a time noted by indicated light.

Note: Width adjustable function is not available for Kneading, Swedish and Kneading/Tapping

Troubleshooting

This massage chair is controlled by a microcomputer and is susceptible to power surges of +10 to –15%.

The following situations may display in the event of a power surge:

Situation	Solution
The massage chair is connected to the power supply but is not functioning.	<ol style="list-style-type: none">1. Check to see that the plug is well connected and working.2. Make sure that the massage chair switch is turned to the “I” position.
The remote control works, but the massage chair is not functioning.	<p>The massage chair may have overheated due to prolonged use.</p> <p>Turn off the power and allow the chair to cool for 30-50 minutes.</p>
Both the remote control and the massage chair are not functioning.	<ol style="list-style-type: none">1. Make sure the chair is plugged into a working outlet.2. Turn the power OFF and then ON again.

Chair Care and Storage

1. Cleaning the Massage Chair

- Before cleaning, ensure that the main power switch is off and the power plug is disconnected from the electrical outlet.
- Wipe off dust and dirt from the massage with a dry, soft, clean cloth after each use.
- This product can be cleaned thoroughly with a slightly damp cloth.
- Do not iron the upholstery.
- Do not wash the upholstery using a home washing machine as this may result in deterioration of the upholstery's quality.



Caution

- Do not use abrasive cleaning agents like benzene or thinner to clean the massage chair. This may cause the upholstery to fade.

2. Cleaning the Controller

- Use only a clean, dry cloth to clean the controller



Caution

- Do not use a wet cloth to clean the controller. This may result in malfunction.

3. Storing the Massage Chair

- Wipe off dust and dirt from the massage chair with a dry, soft, clean cloth after use.
- Keep the massage chair clean and away from places of high humidity.
- If the massage chair is not to be used for a long period of time, cover the massage chair with a dust cover and unplug its power plug from the electrical outlet.



Caution

- Do not store the massage chair in direct sunlight or in places of high temperature. This may cause the color of the upholstery to fade.
- Do not allow the massage chair to remain in contact with vinyl or wallpaper for extended periods of time as this could lead to discoloration.