

ANODIC

1837
INSTRUCTION MANUAL

EN

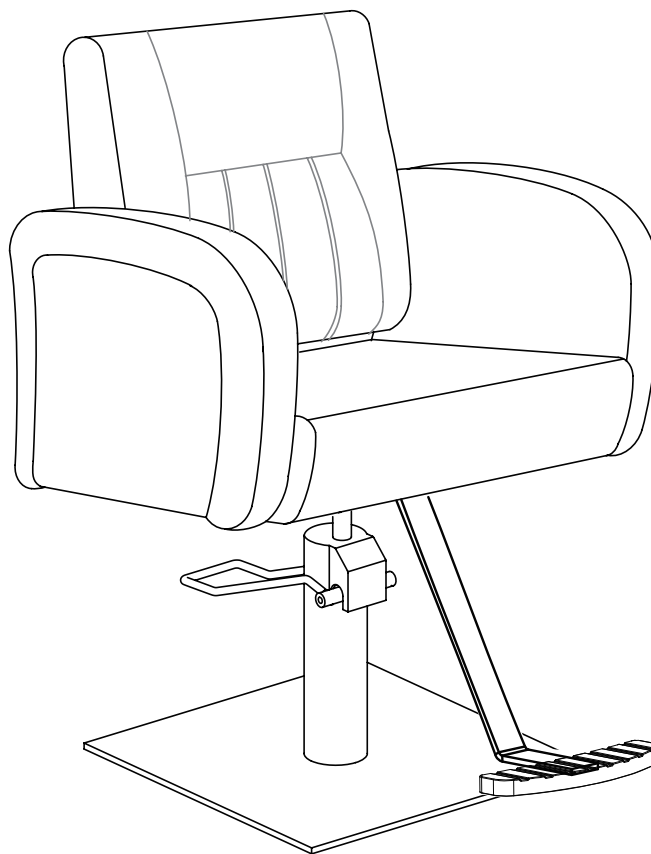

List of Parts & Tools

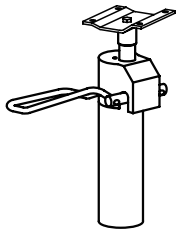

x1

Pump

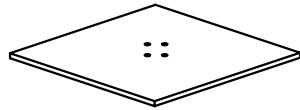

x1

Base

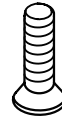

x4

M8x20mm

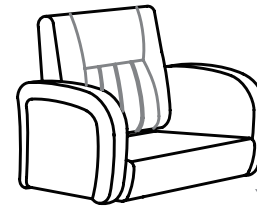

x1

Seat

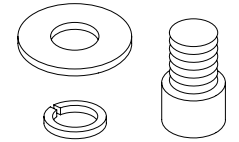

x4

M8 x 16 mm

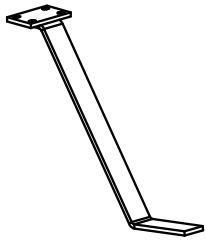

x1

Footrest post

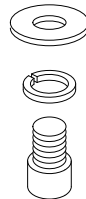

x4

M8x20mm



x1

Foot pedal



x2

M8x12mm



x1

6mm

Step 1

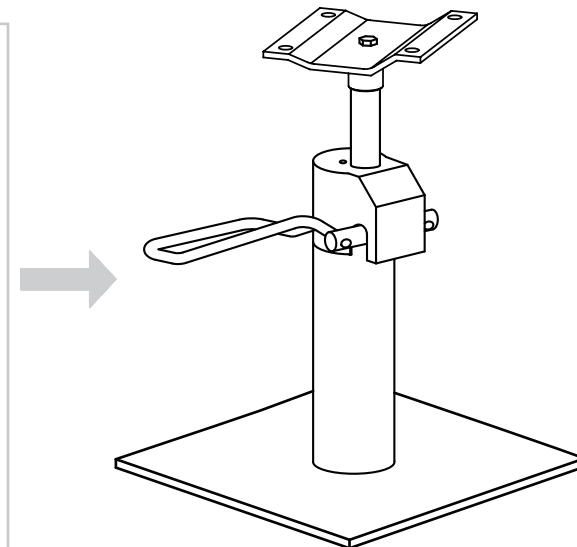
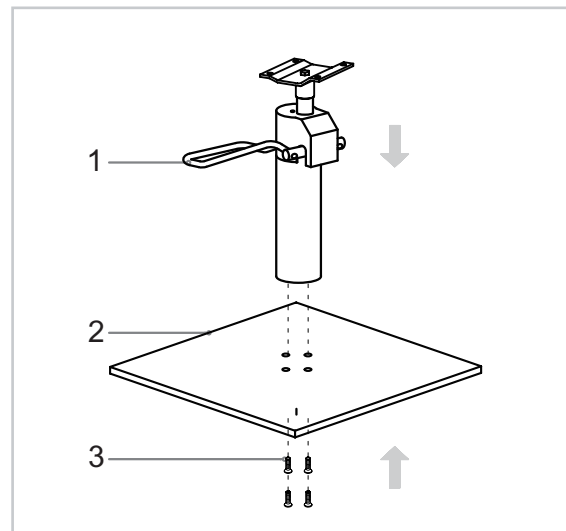
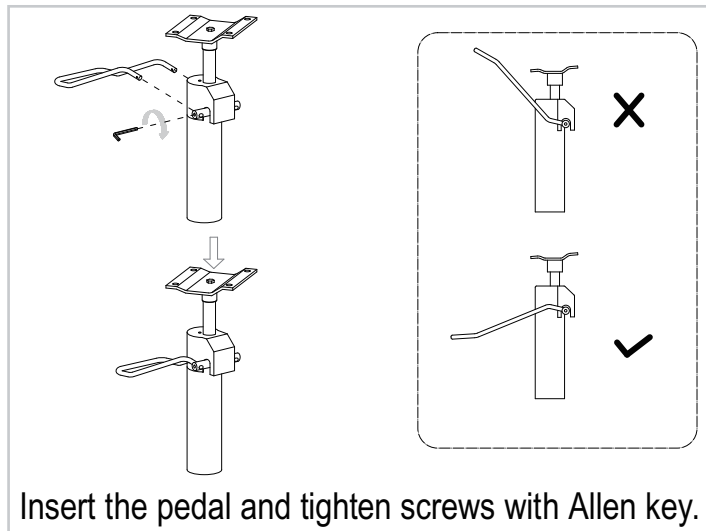
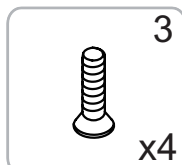
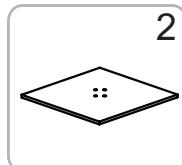
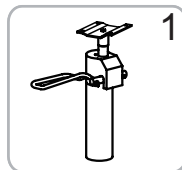

Step 2

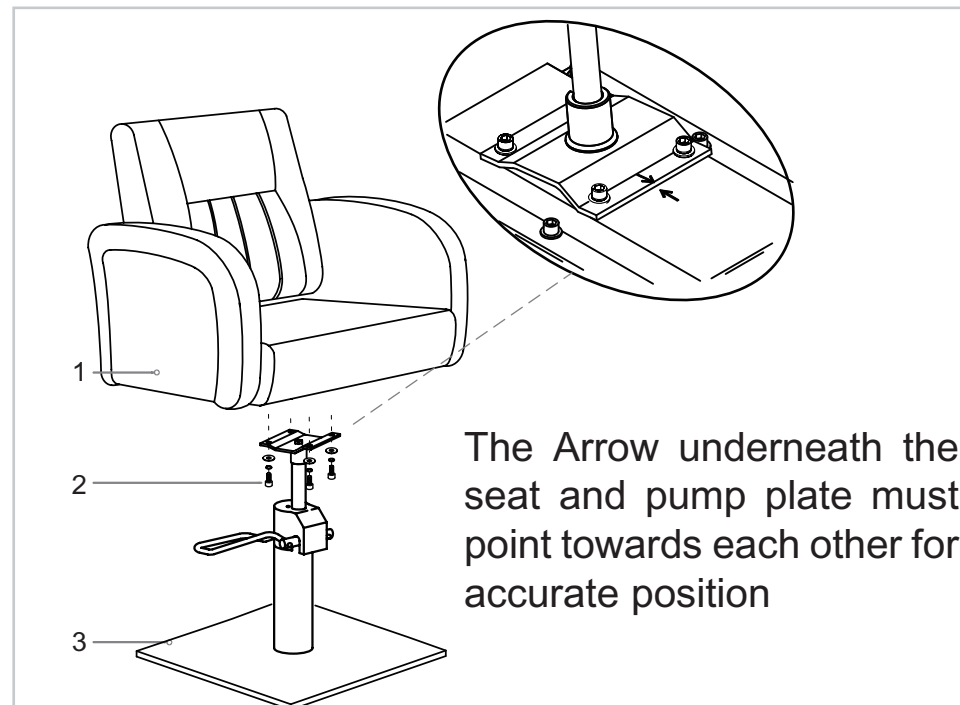
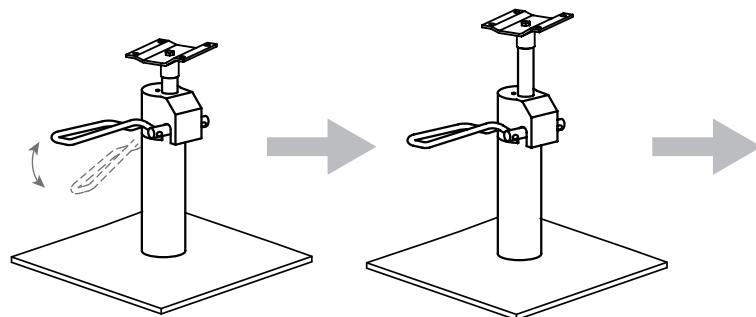
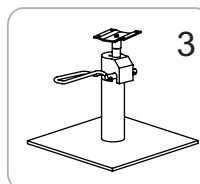
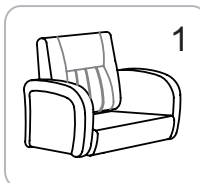

Step 3

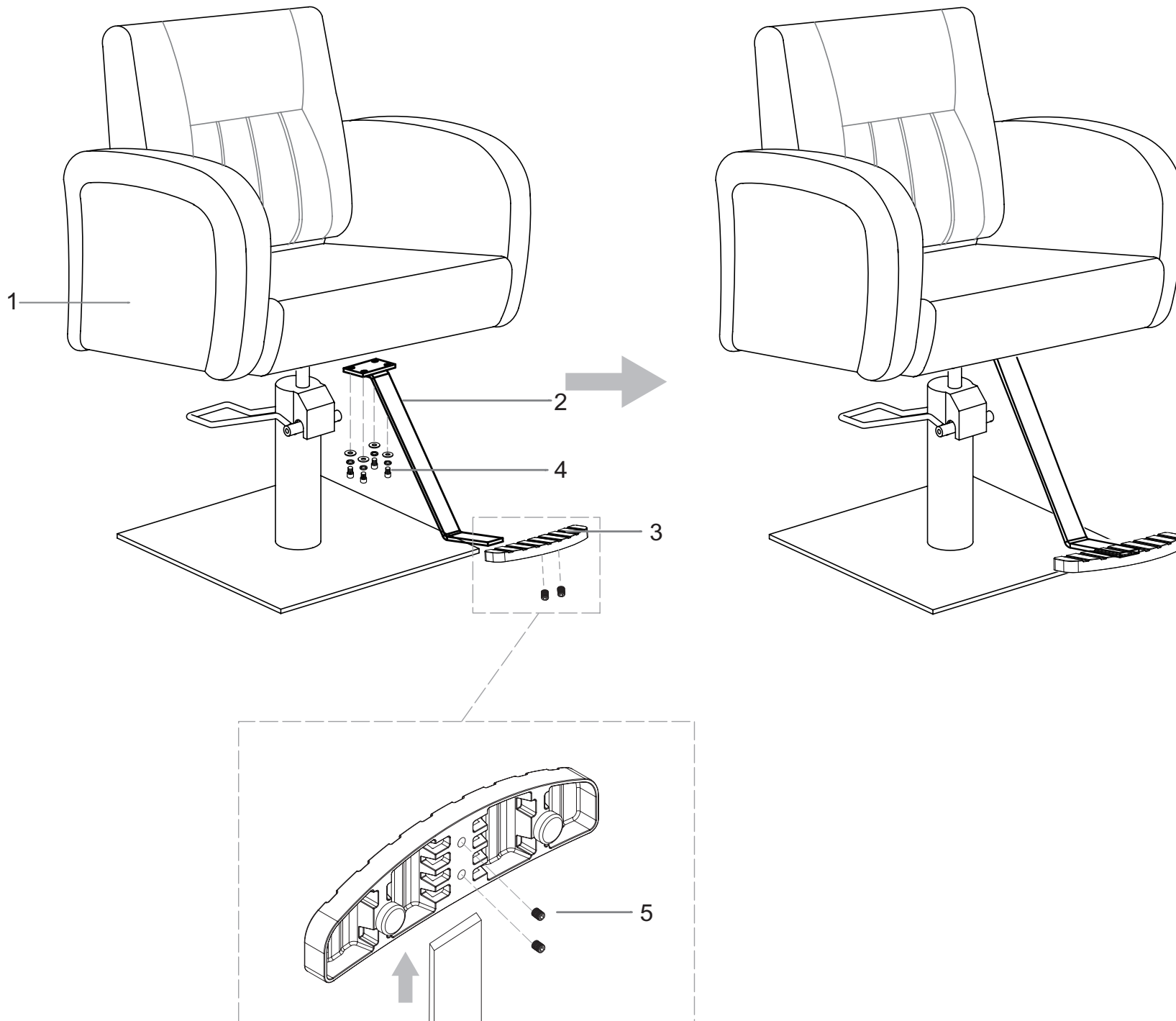
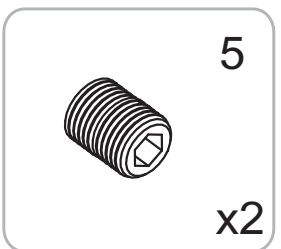
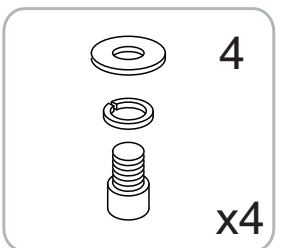
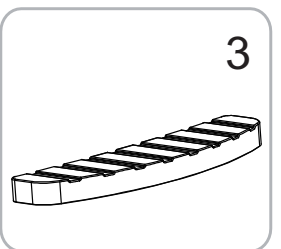
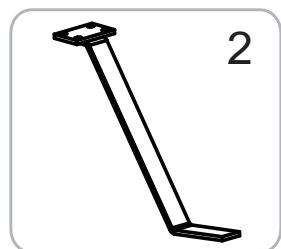
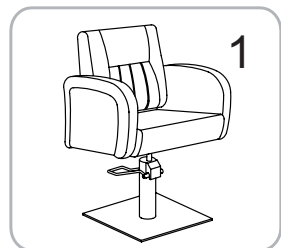

※After an initial period of use, check all fastenings for any loosened screws etc. If found, please tightened appropriately.