

Creativita

1188

INSTRUCTION MANUAL

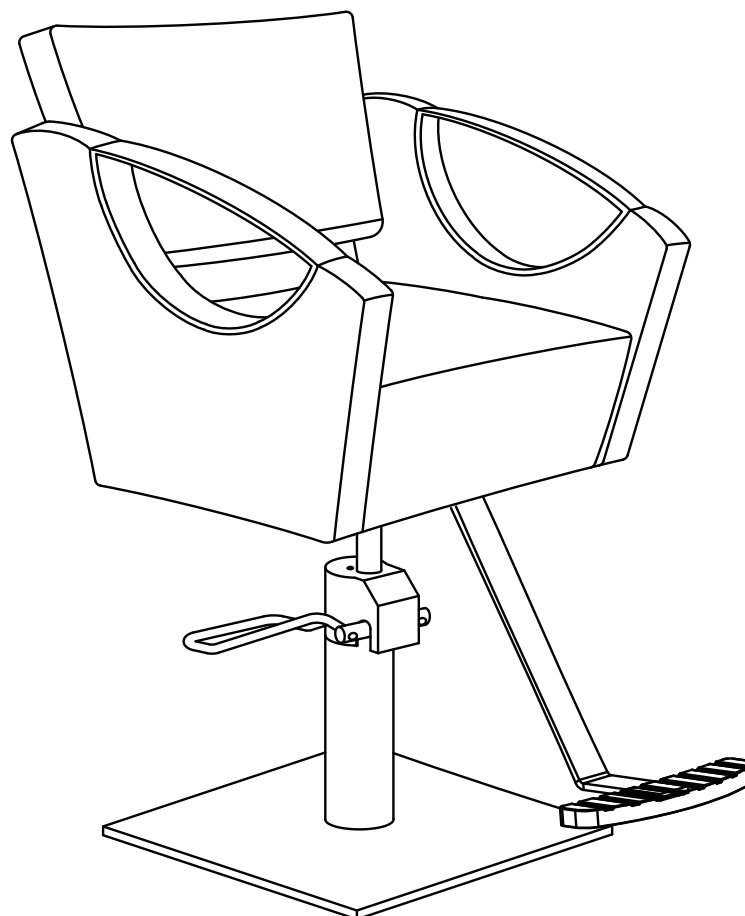

EN

List of Parts & Tools

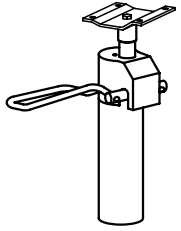

x1

Pump

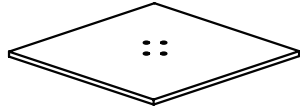

x1

Base

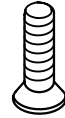

x4

M8x20mm

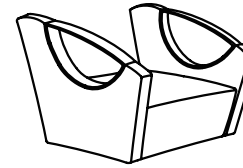

x1

Seat

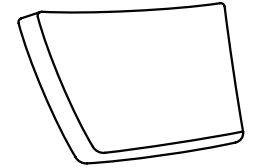

x1

Back

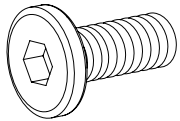

x4

M8x25mm

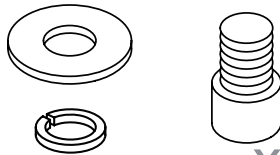

x4

M8x16mm

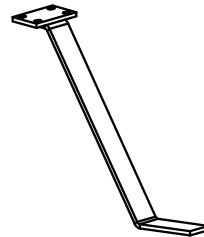

x1

Footrest post

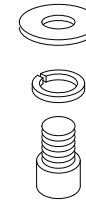

x4

M8x20mm



x1

Foot pedal



x2

M8x12mm

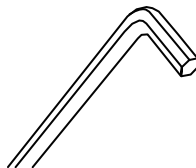

x1

6mm

Step 1

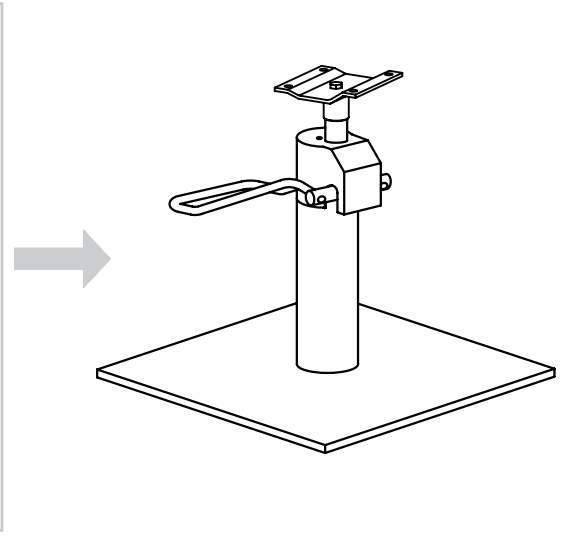
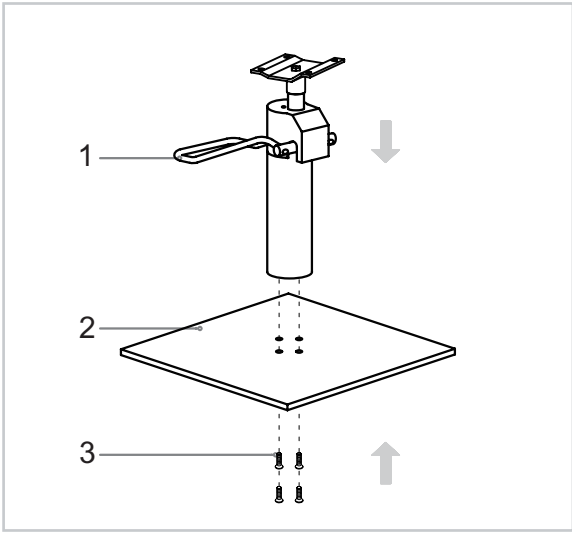
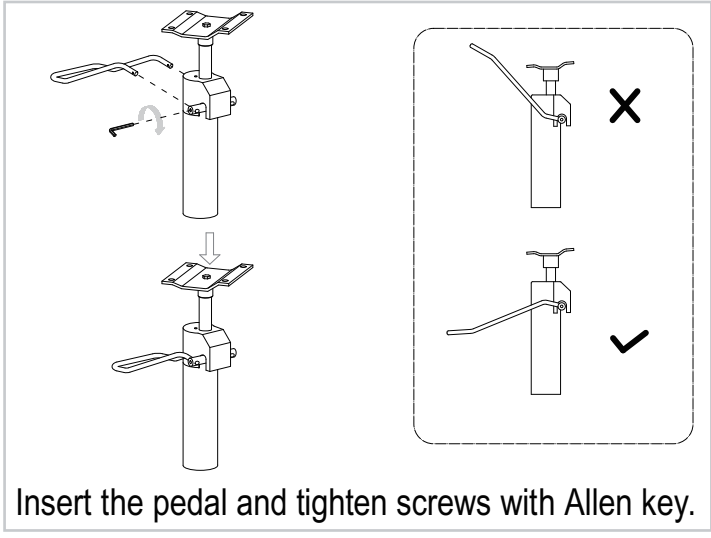
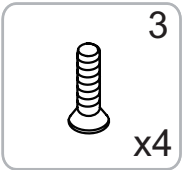
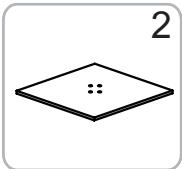
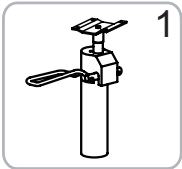

Step 2

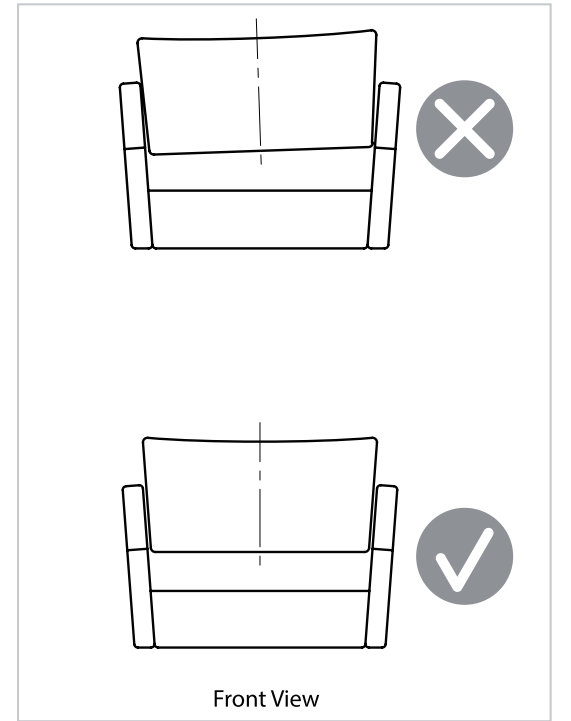
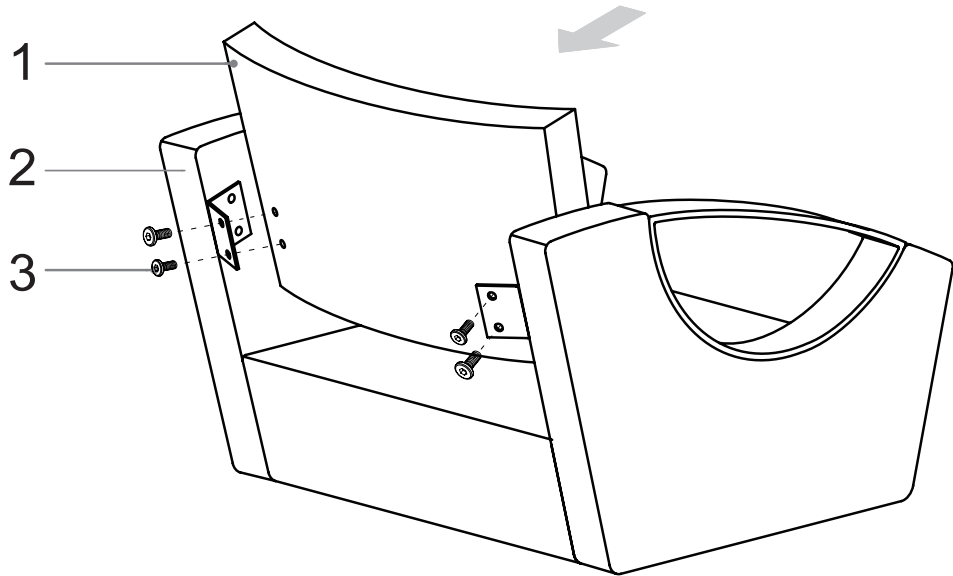
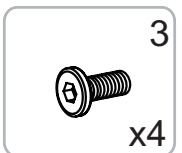
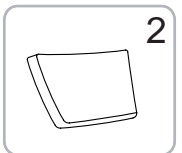
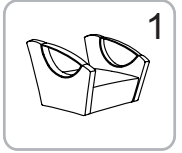

※ Do Not Tighten Screws All The Way Until Entire Assembly Is In Place

Step 3

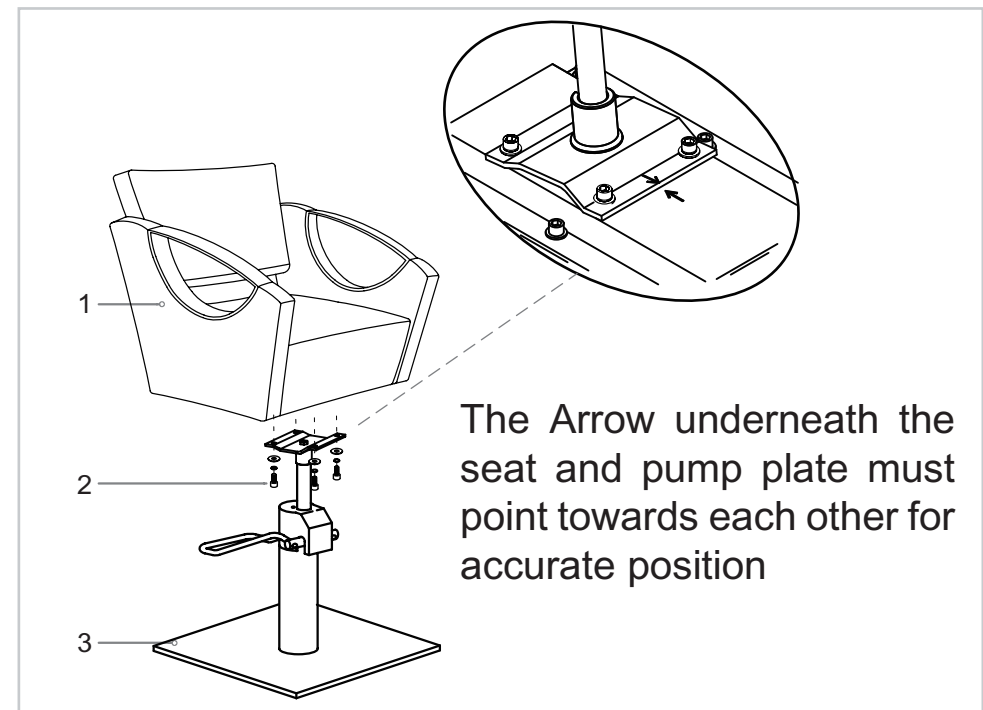
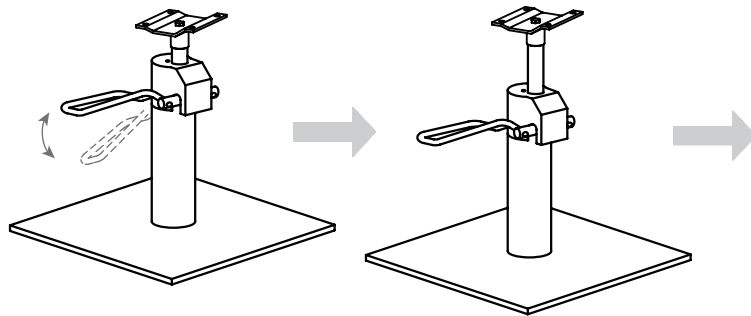
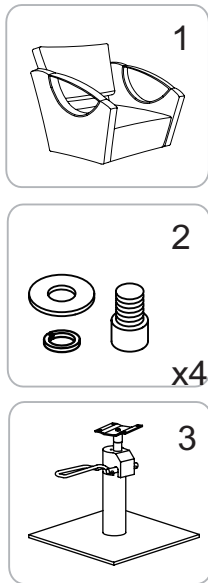

Step 4

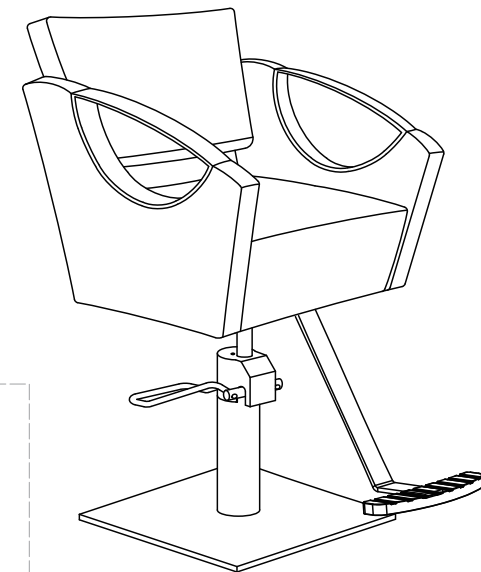
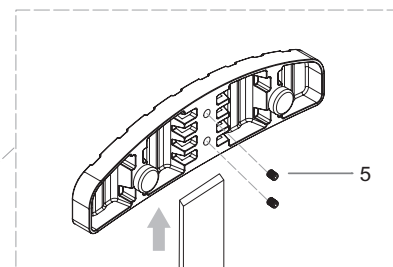
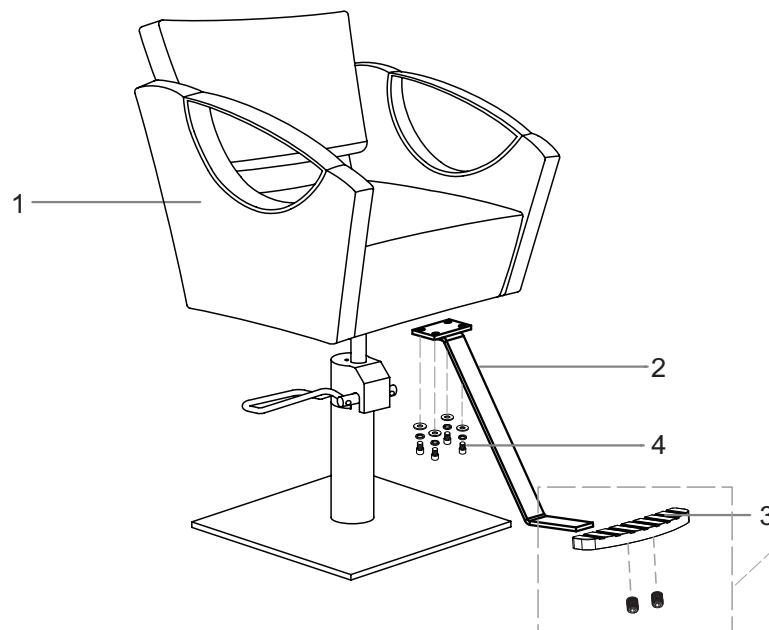

※After an initial period of use, check all fastenings for any loosened screws etc. If found, please tightened appropriately.