

# D'EAMES

1660

INSTRUCTION MANUAL

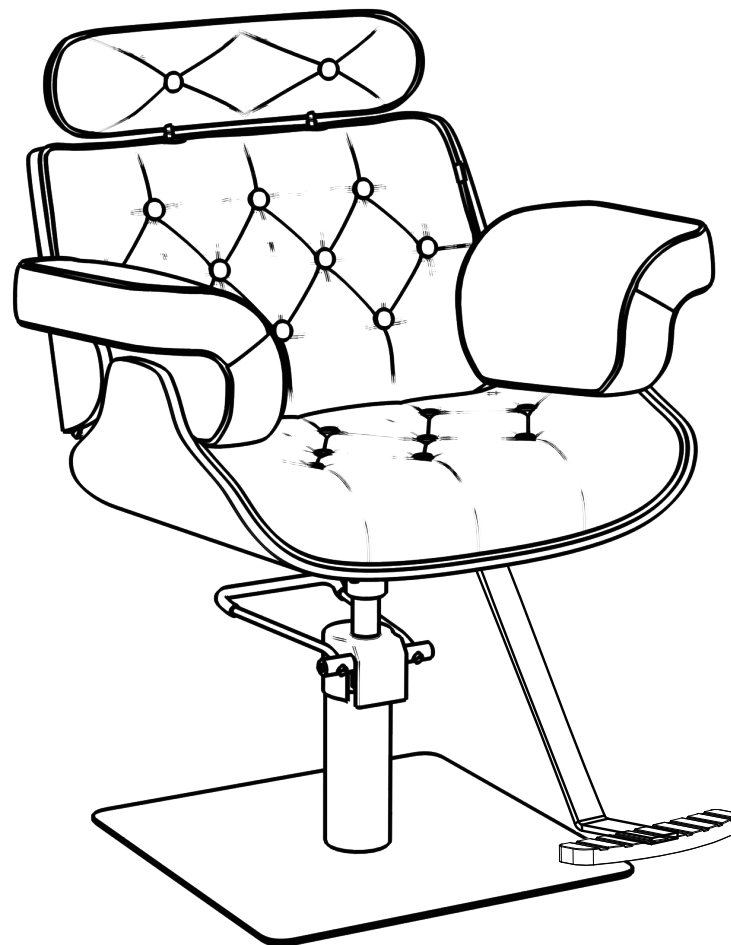

EN

## List of Parts & Tools

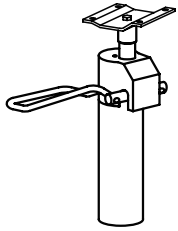

x1

Pump

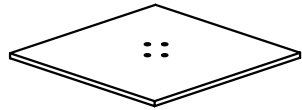

x1

Base

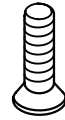

x4

M8x20mm

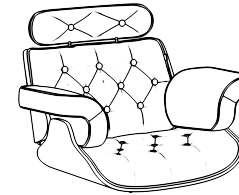

x1

Seat

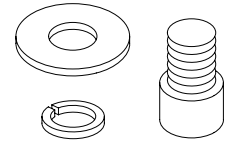

x4

M8 x 16 mm

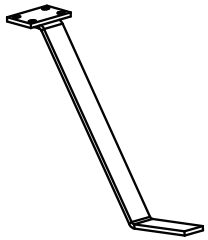

x1

Footrest post

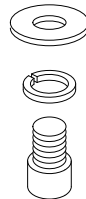

x4

M8x20mm

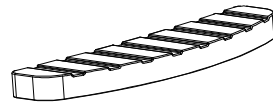

x1

Foot pedal



x2

M8x12mm



x1

6mm

## Step 1

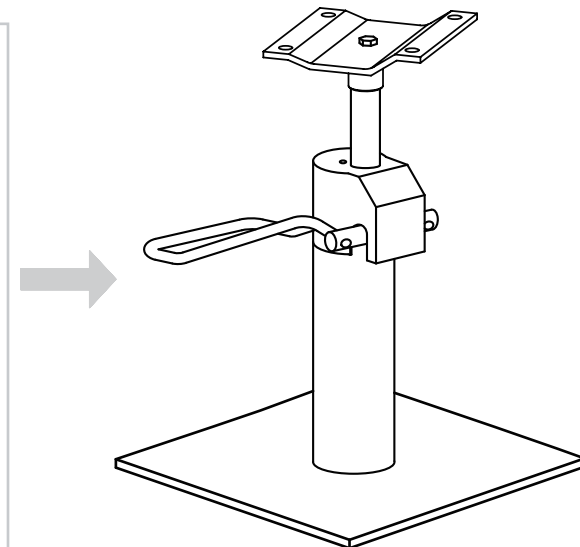
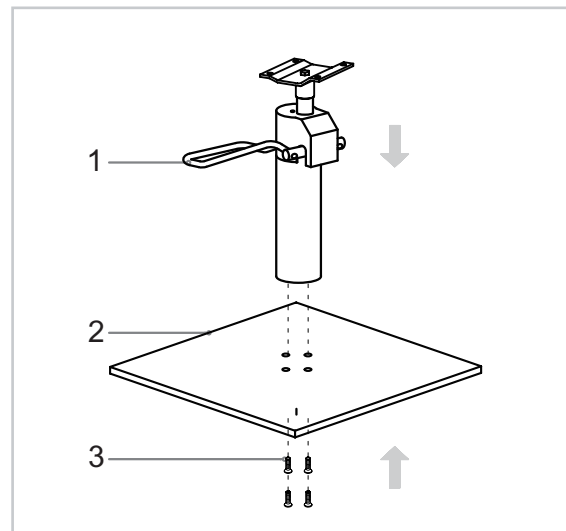
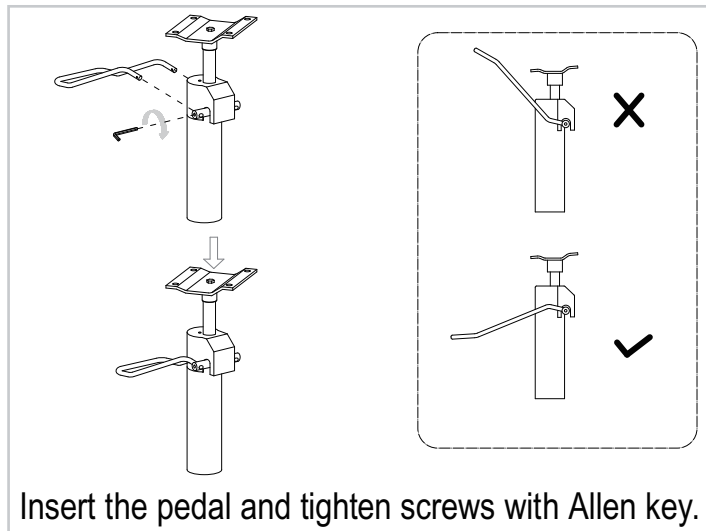
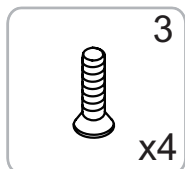
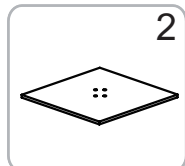
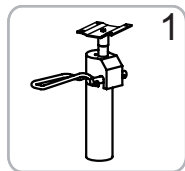

## Step 2

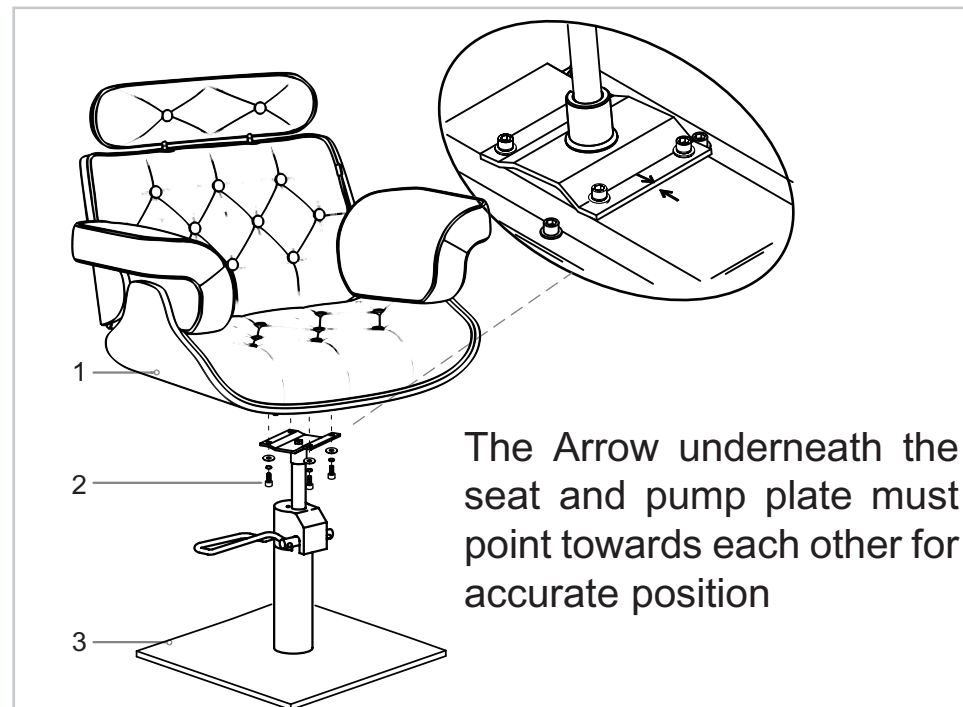
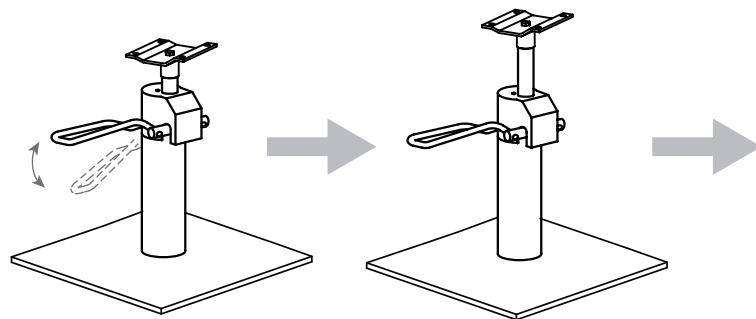
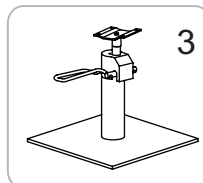
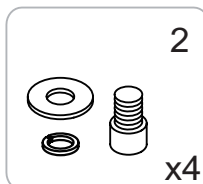
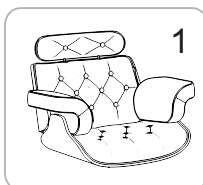

### Step 3



1

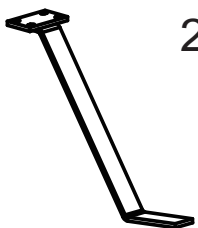

2



3

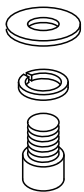

4

x4



5

x2

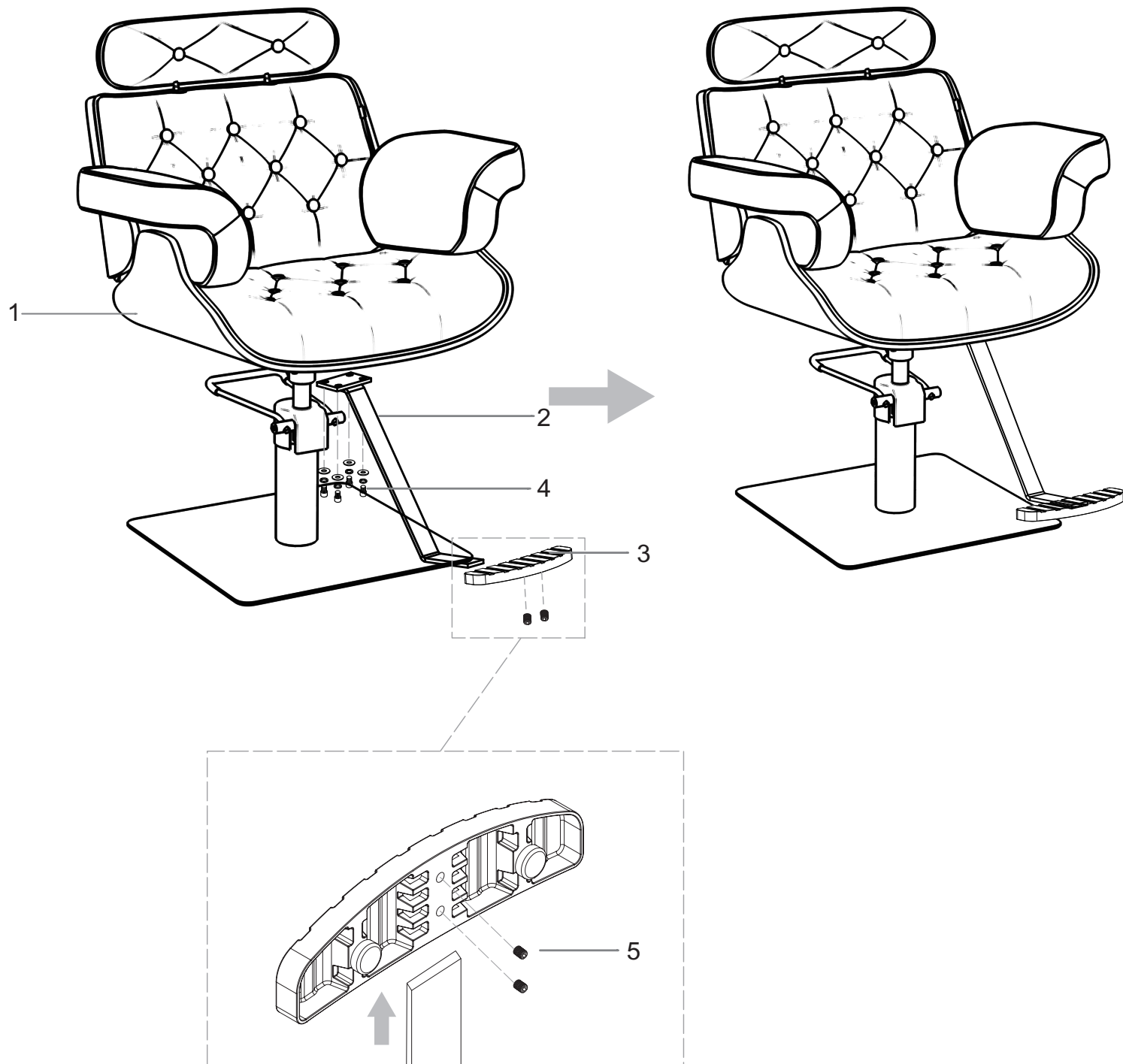

※After an initial period of use, check all fastenings for any loosened screws etc. If found, please tightened appropriately.