

APOLLO

8716

INSTRUCTION MANUAL



	UK	USA
Measurement	1790x845x610-910mm	70 1/2"x33 1/4"x24"-35 7/8"
Maximum load	350kg	771lbs
Net weight	73.5kg	162lbs
Hydraulic height	610-910mm	24"-35 7/8"
Input voltage	220~240 50Hz	AC100~130V 60Hz
Output voltage	DC 24V	DC 24V

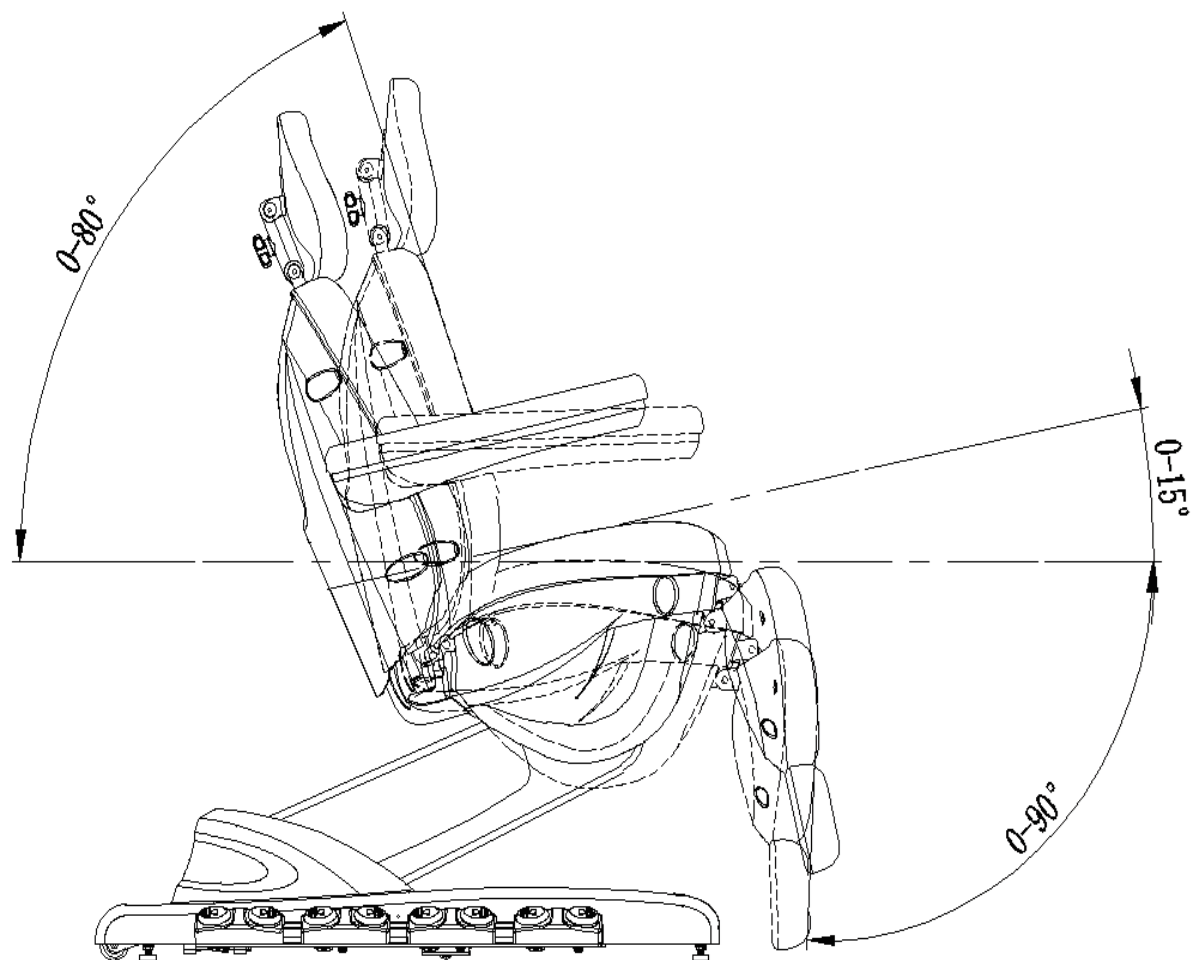

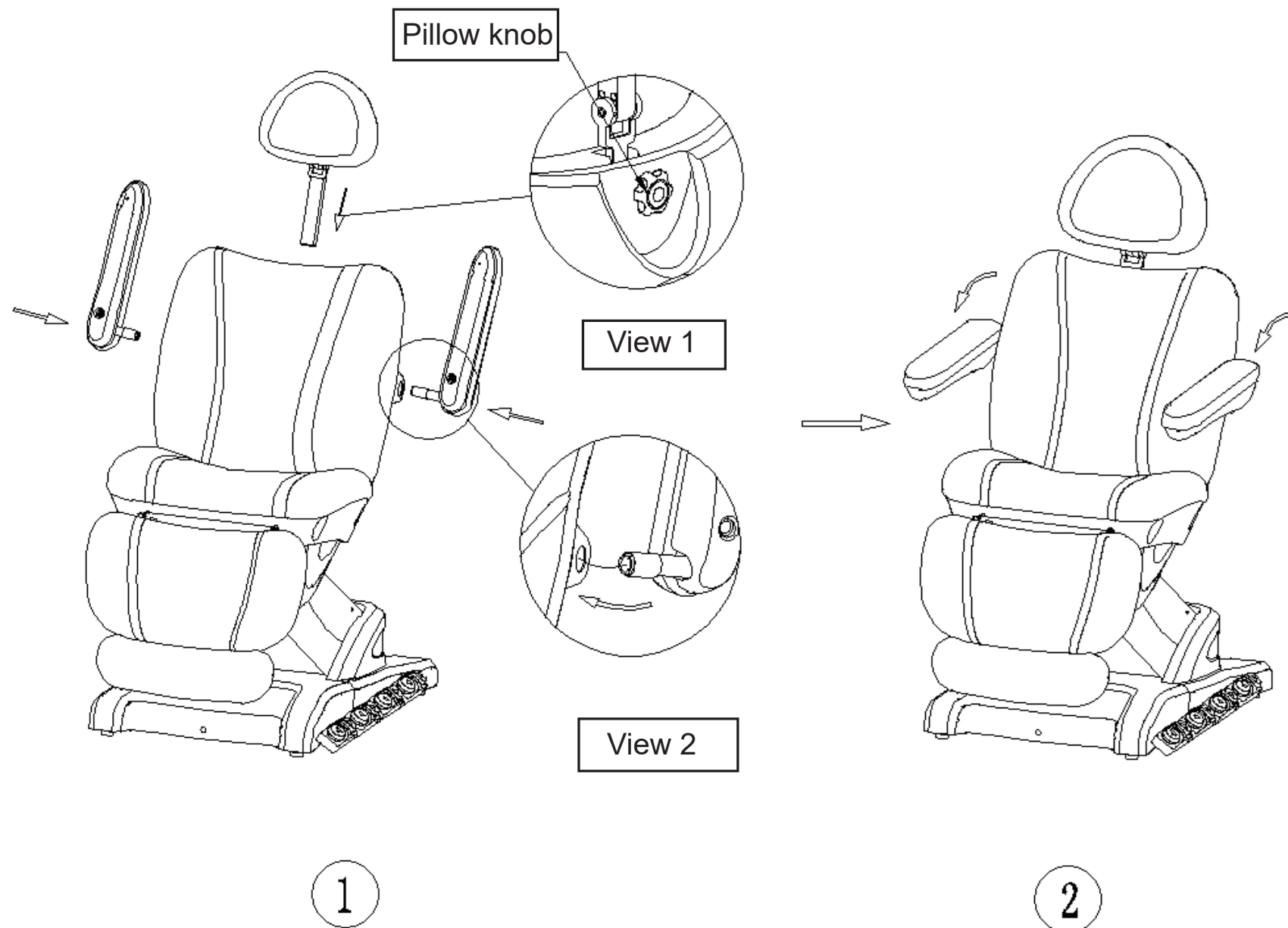

- (1) Install the pillow, connect it to the bed, loosen the knob to adjust the height of the pillow, as shown in picture 1.
- (2) Install the armrests, connect the bar of left and right armrests with the inner pin of the bed, rotate the armrests by 90 degrees counterclockwise, as shown in picture 2.

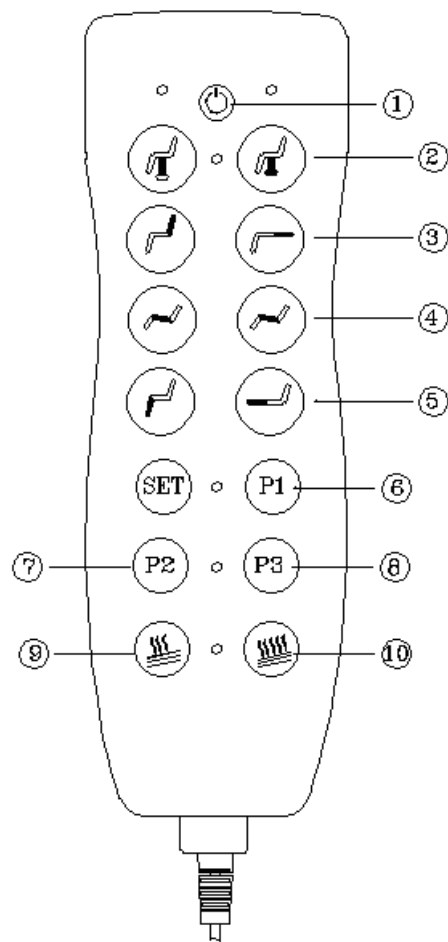

Introduction for control panel

Press button ① to power ON the bed and be able to use all controls. Press ① again to power OFF the bed and the bed will return to its original state.

Press button ② to adjust the whole bed up and down.

Press button ③ to adjust the backrest up and down.

Press button ④ to adjust the incline angle for the seat.

Press button ⑤ to adjust the footrest up and down

Press button ⑥-⑧ for your pre-set preferred height & chair position, you can preset up to 3 different pre-set positions

Press button ⑨ to turn off the heating function.

Press button ⑩ to turn on the heating function.

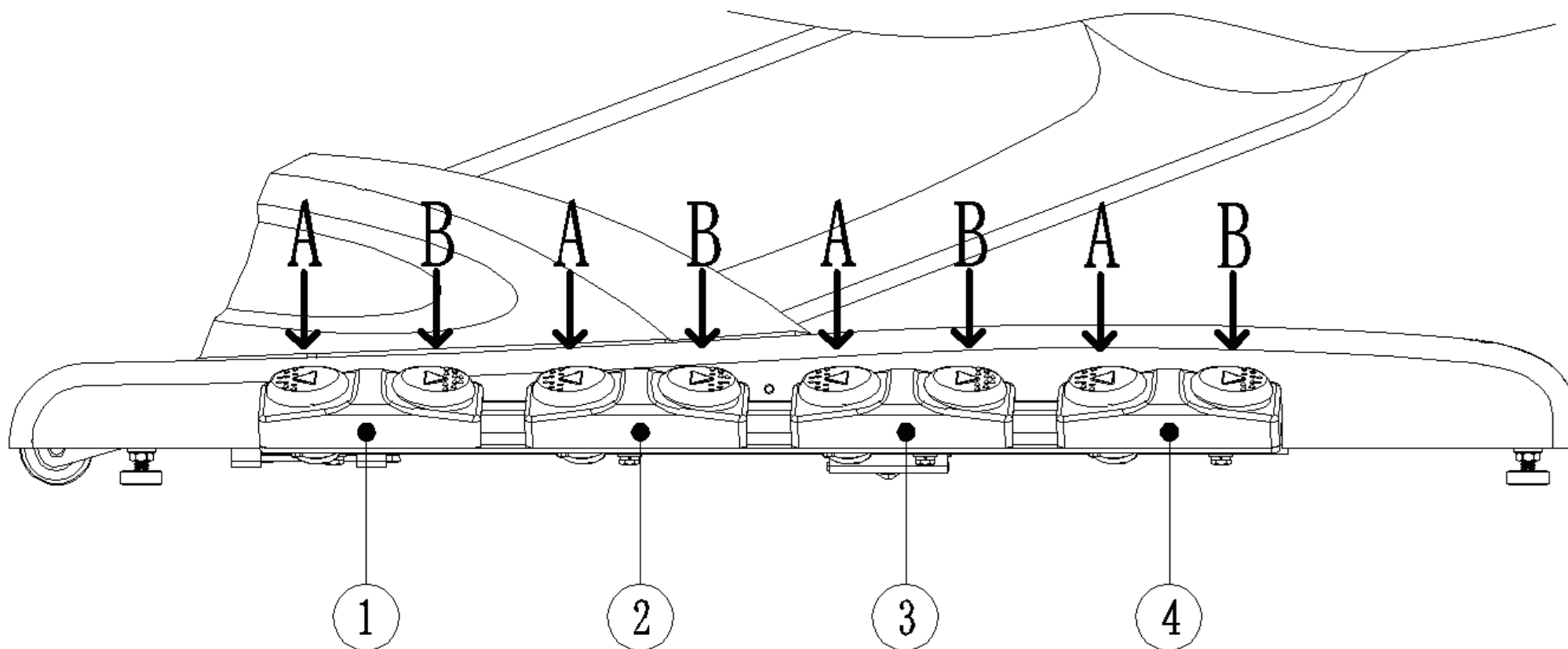

Please make sure the unit is turned ON before operating all adjustments.

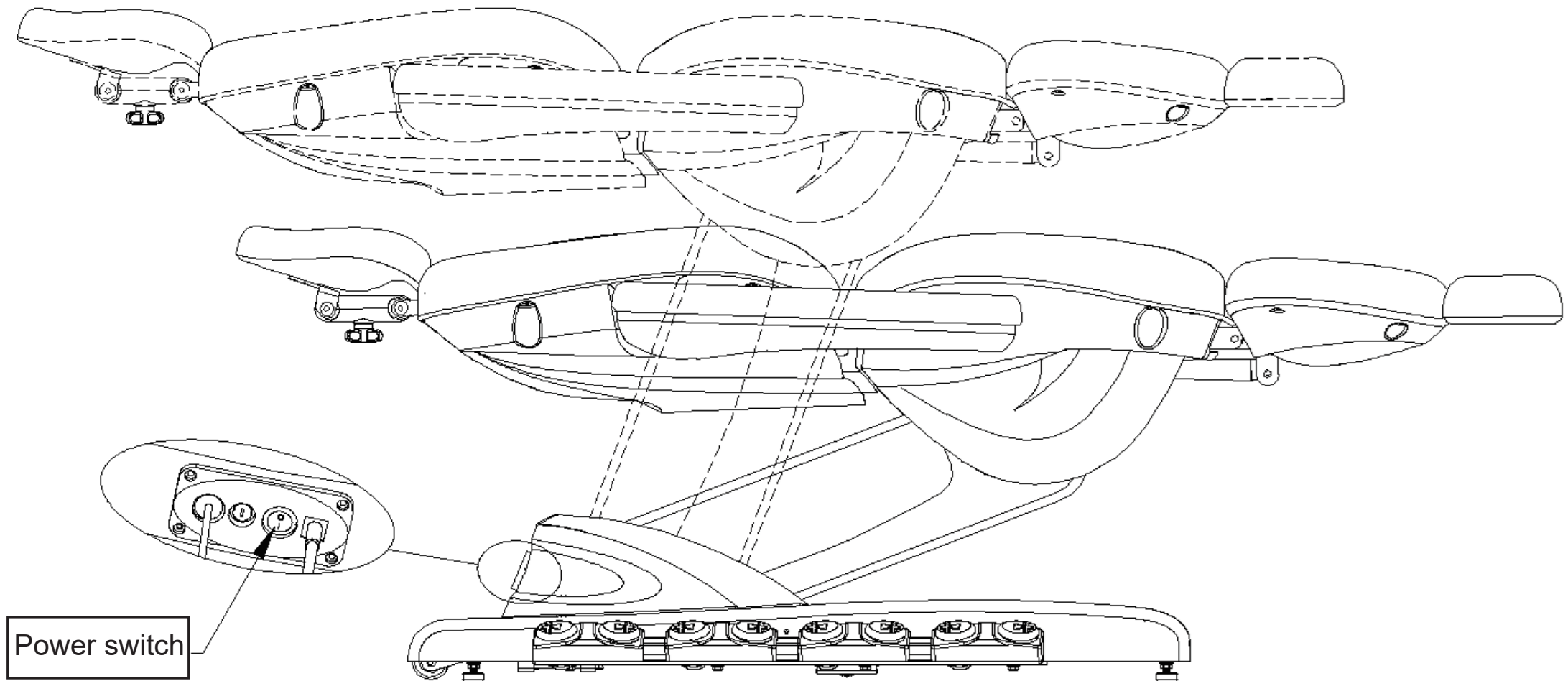

Pedal Control #1 controls the bed's height adjustment, step on A & B to raise or lower the bed.

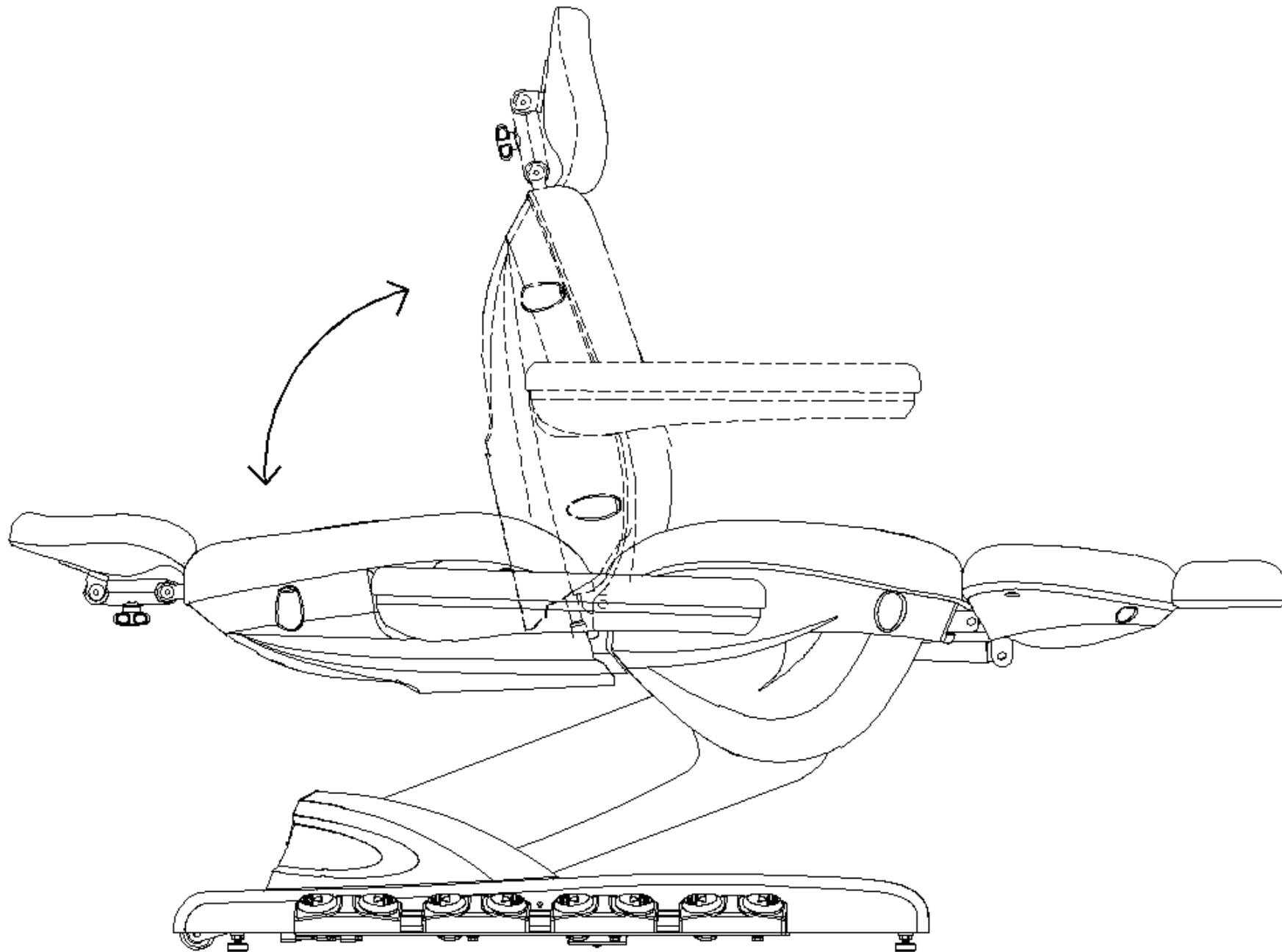

Step on A or B on the pedal control #2 to adjust the angel of the backrest, as shown in below picture

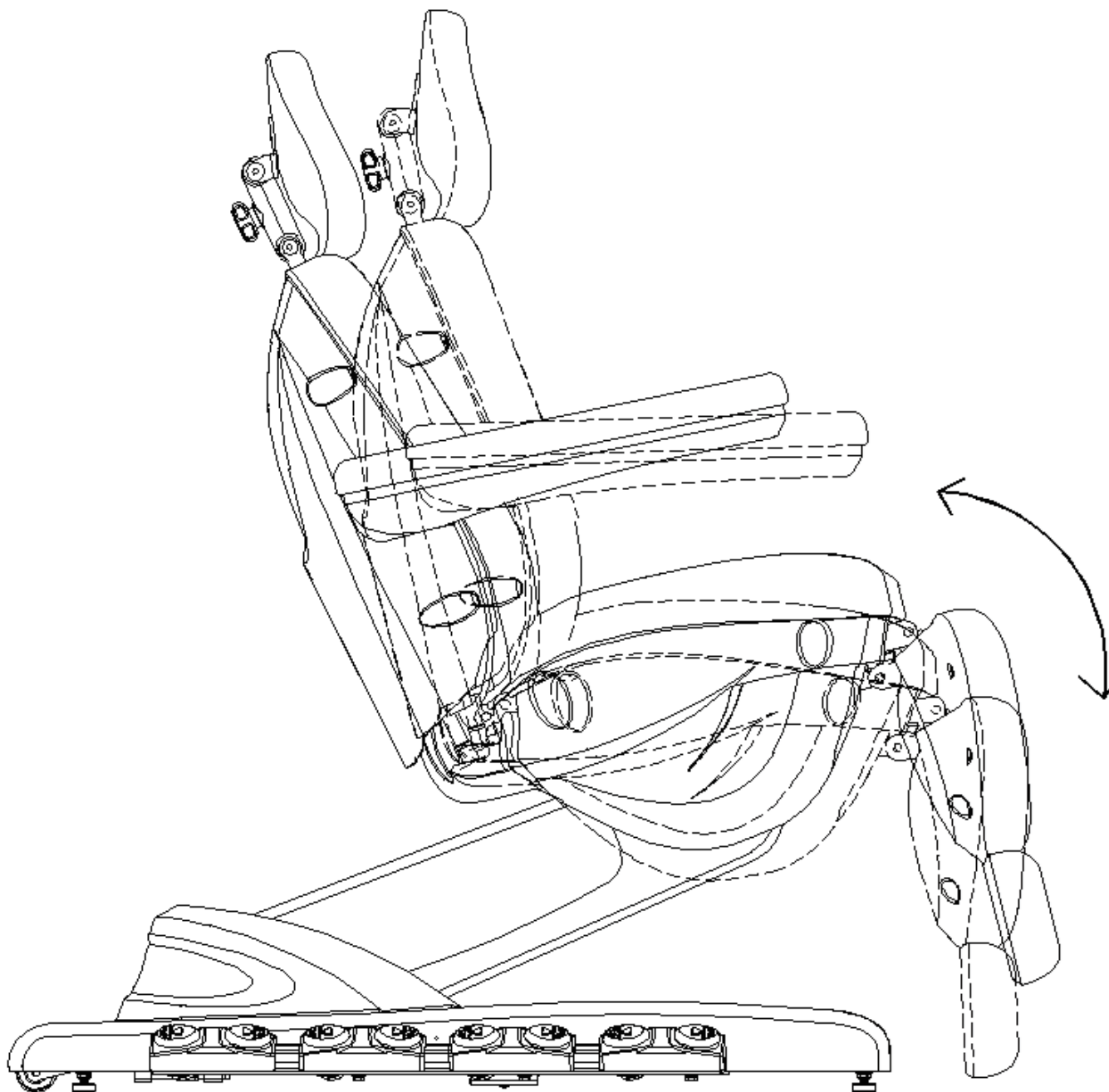

Step on A or B on the pedal control #3 to adjust the incline angel of the seat, as shown in below picture

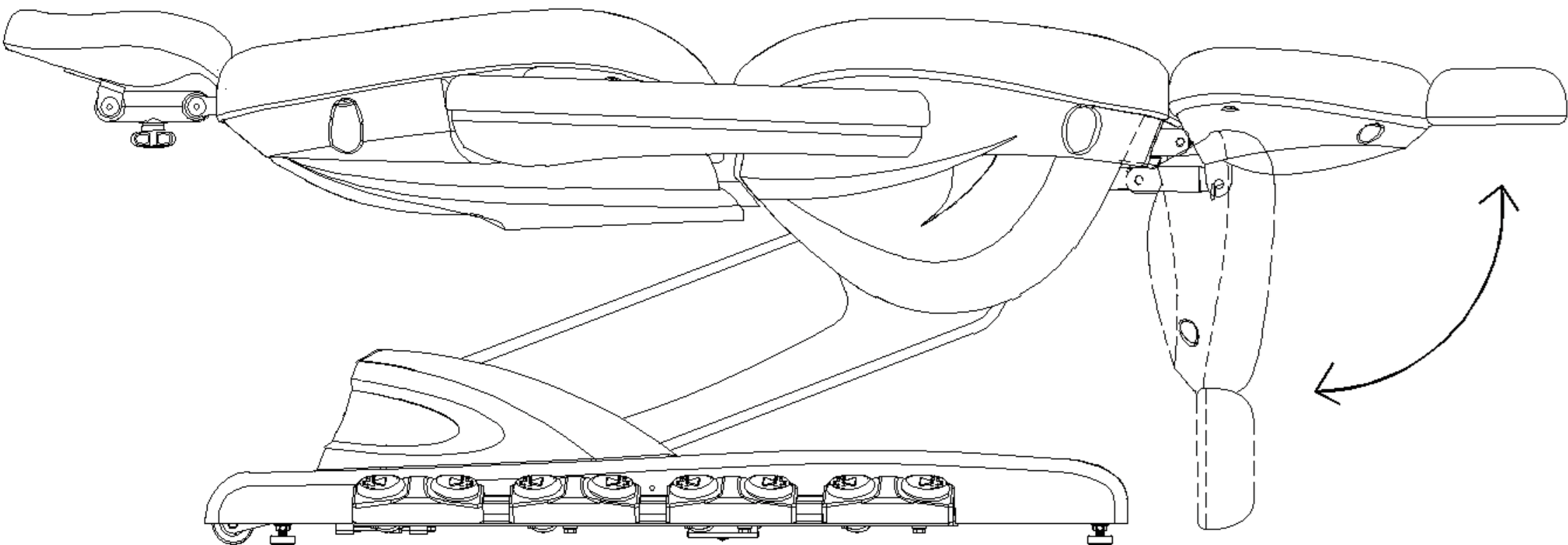

Step on A or B on the pedal control #4 to adjust the incline angel of the footrest, as shown in below picture

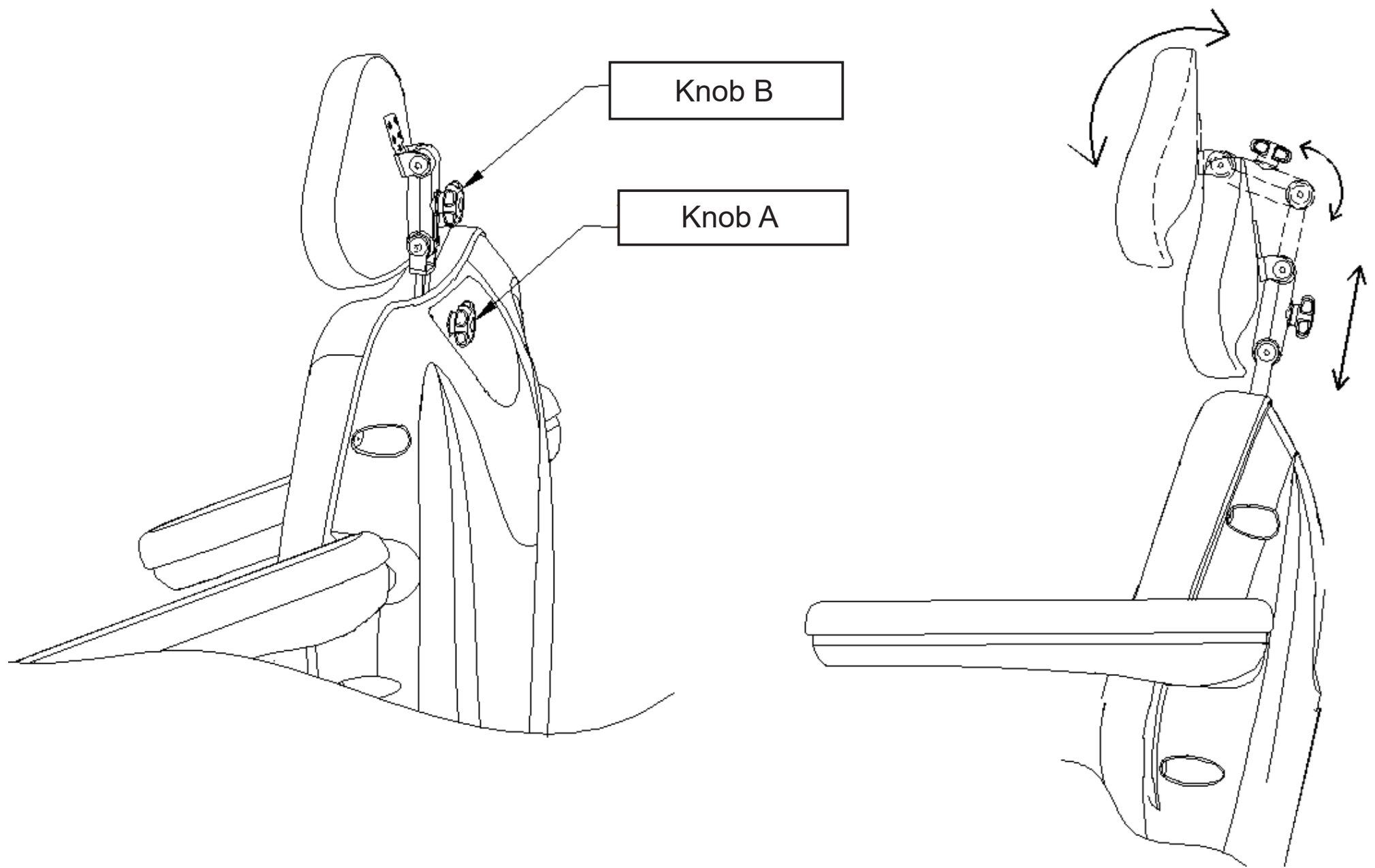

The height of the pillow can be adjusted by loosening knob A. You can rotate or flip over the pillow by loosen the knob B, as shown in below picture.

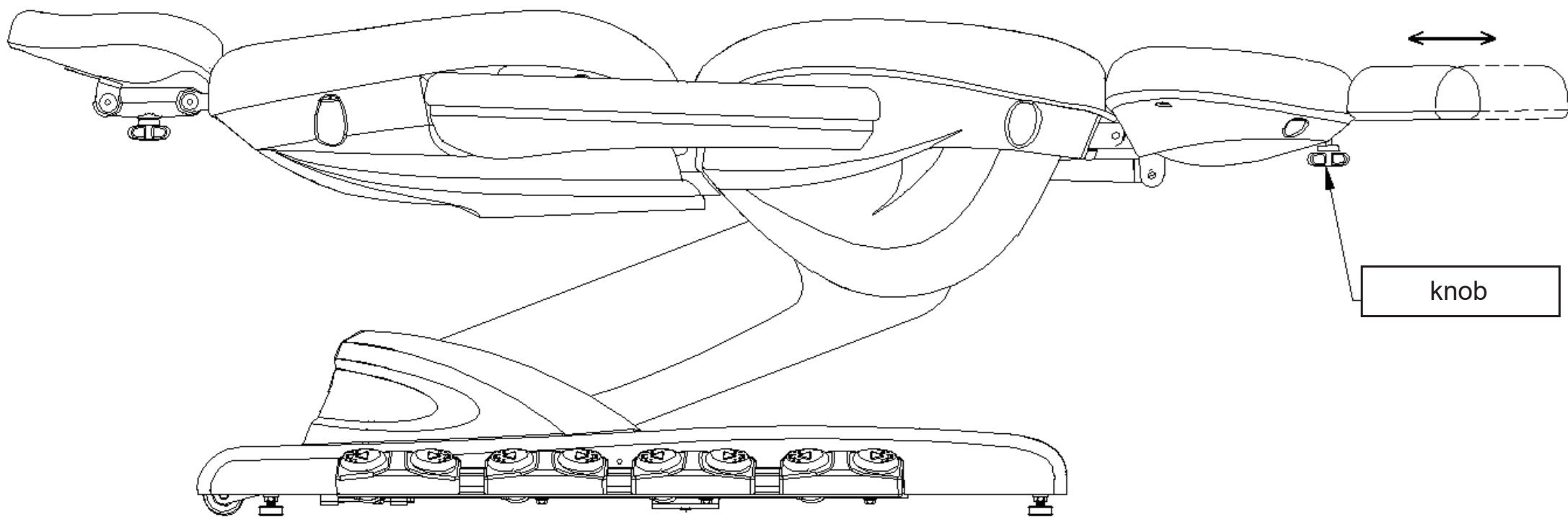

Adjust the extension of the footrest by loosening the knob under the footrest, as below picture shown.

The suggestive instructions

1. Before connection, operation and adjust the bed, please read and the user manual carefully.
2. This electric massage bed uses a three-wire power cable. Meanwhile it should be inserted into the three-prong outlet where there is a ground electrode. And it should be assured that it can be connected to the ground electrode smoothly so that it can prevent people from getting electric shock while functioning normally.
3. Please keep remote, wiring and unit away from water.
4. Keep hands and legs away from gaps when adjusting the bed.
5. It is prohibited to use when plugs, buttons and other components connected to the power cable are damaged.

Attentions

1. Breakages of the power cable and plug should be eliminated before it's normally used. Breakages should be dealt with by someone professionals or service providers.
2. The voltage should accord with the safety voltage before it's officially used. And the wrong voltage may lead to the breakdown of the product.
3. Wet hand is not allowed to touch power cord to avoid shock.
4. The product should not plug in before it's already installed.
5. The power cable should be tuck away safely to avoid tripping
6. Unit should be turned OFF when not in use

Maintenance

1. Daily cleaning

You can wipe out the dust by using soft dry towel.

2. Eliminating the stubborn dirt

As we all know, it is hard to eliminate the stubborn dirt by using normal dry towel. In this case, you can use soft towel with diluted neutral detergent to clean it first. And then you can use a dry towel to scrub.

3. It's prohibited to use benzene, diluent, gasoline or other solvent.

These solvents may damage the leather or it may cause the corrosion of the products' appearance.

4. Storage and operating environment

Don't put the product under the strong sunlight and moisture environment. Otherwise it may cause the damages of the product.