

# Victoria

7062

INSTRUCTION MANUAL

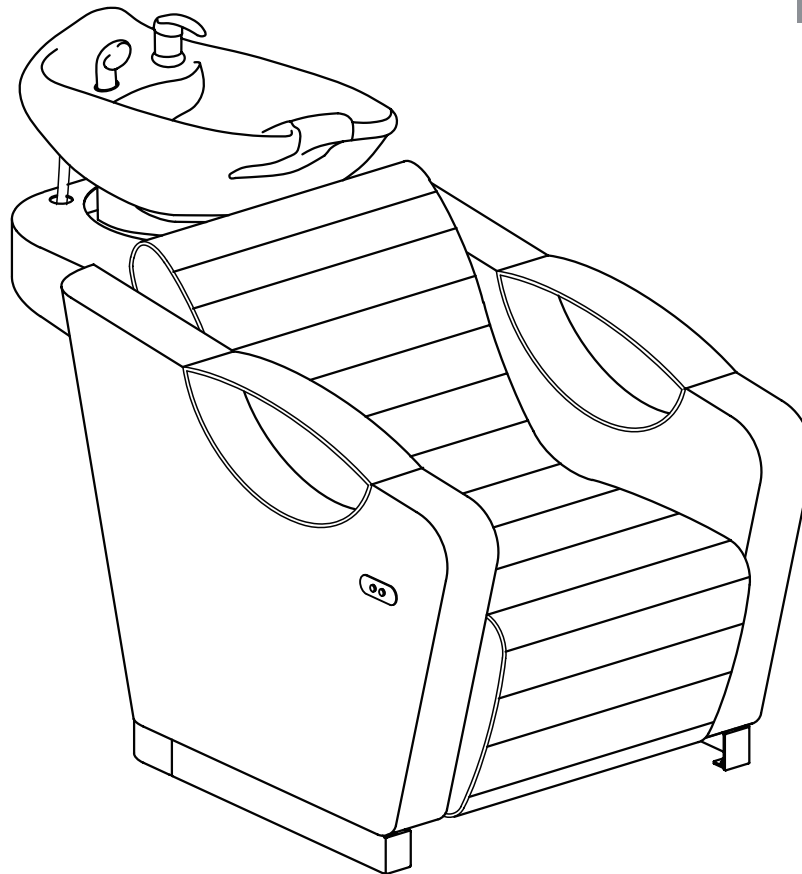

List of Parts & Tools

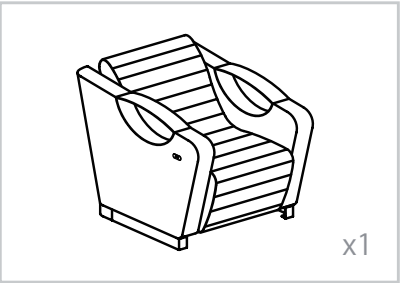

101001

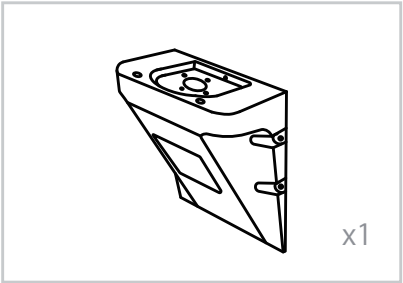

7001

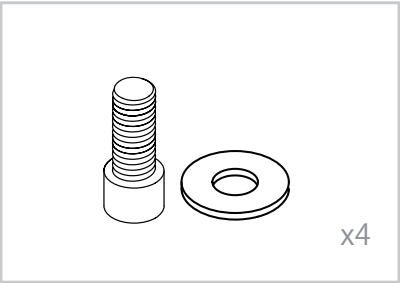

101003

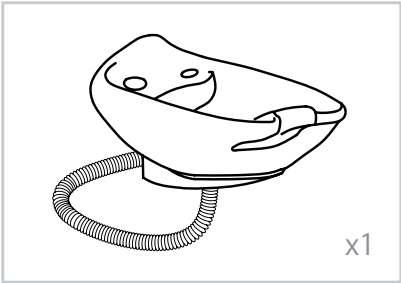

0350/0388

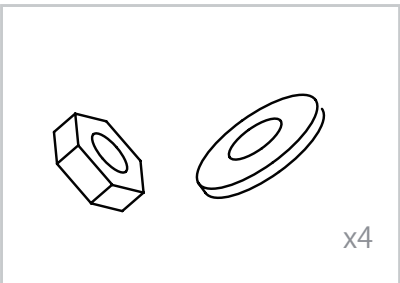

101005

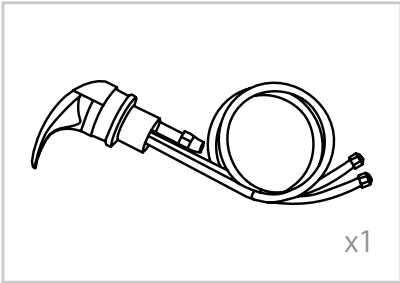

101006

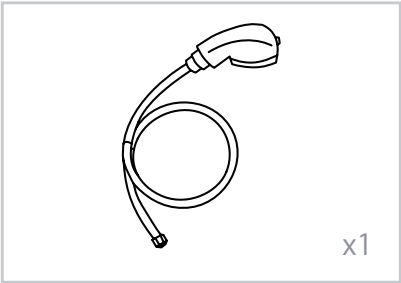

101007

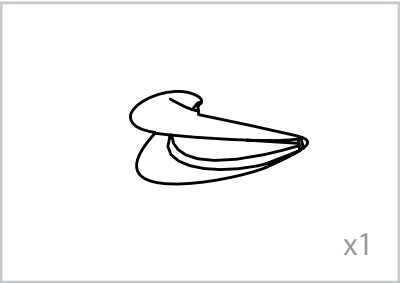

101008

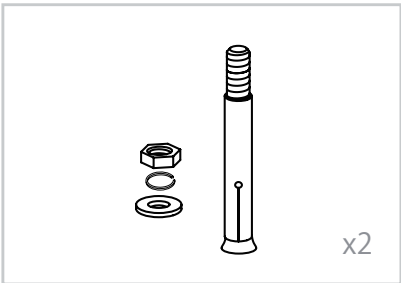

101009

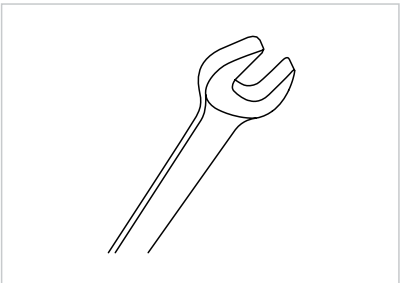

101010

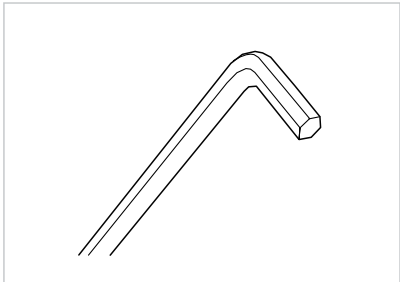

101011

Type	USA size	UK size
Water supply lines Adapter	5/8"	1/2"
Drain Hose Connector	1 1/4"	3.2cm

# Assembly Instruction 1

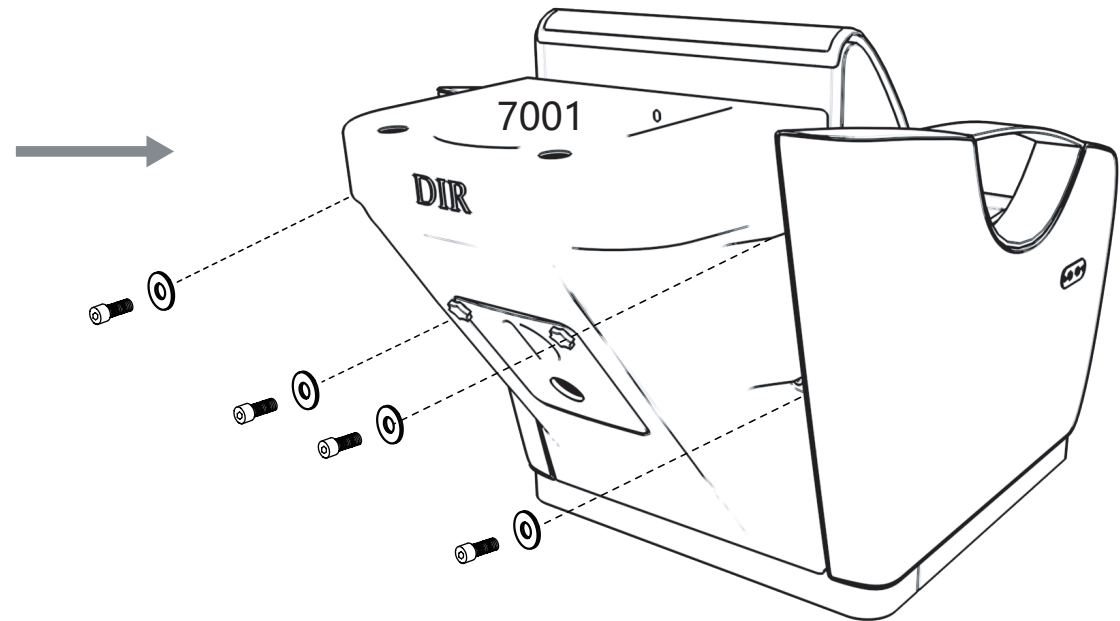
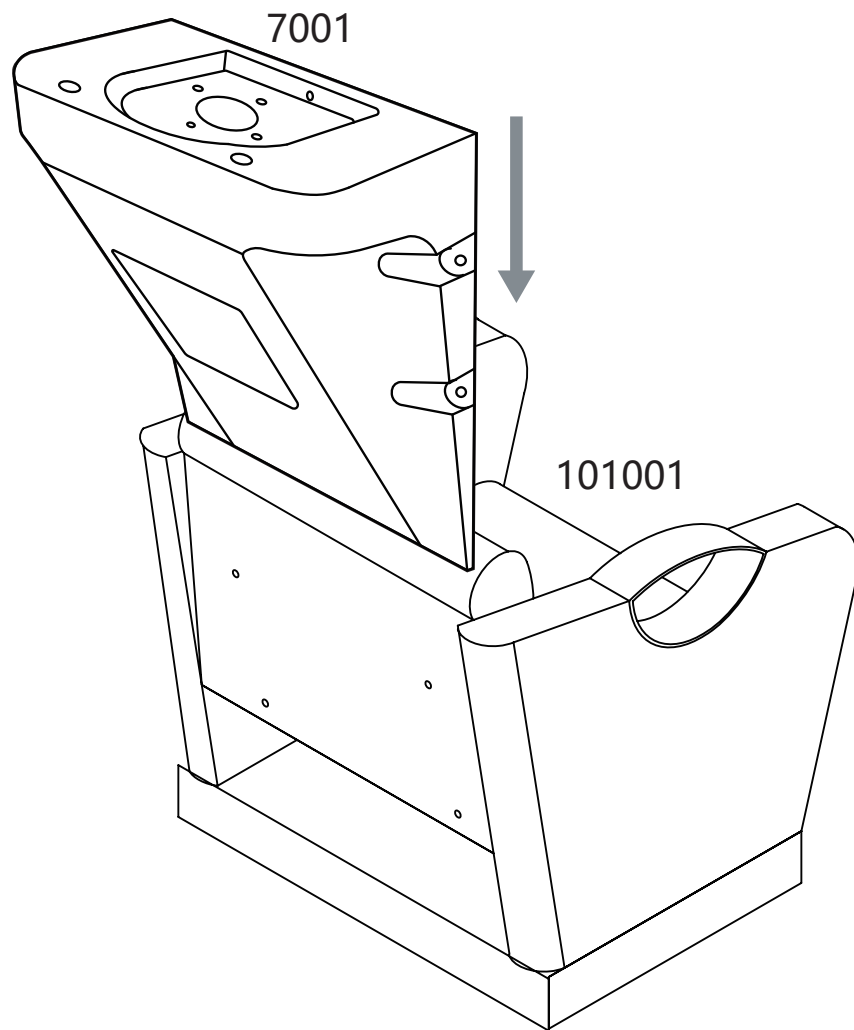

0350

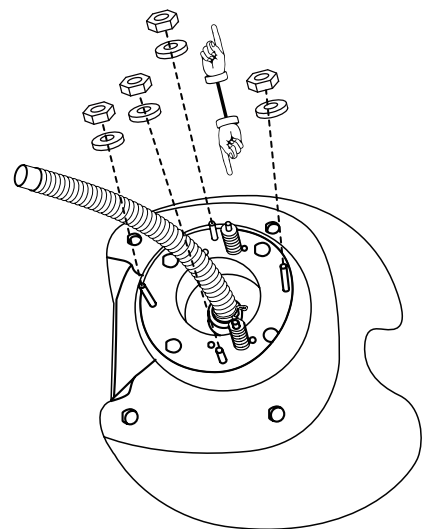

0350

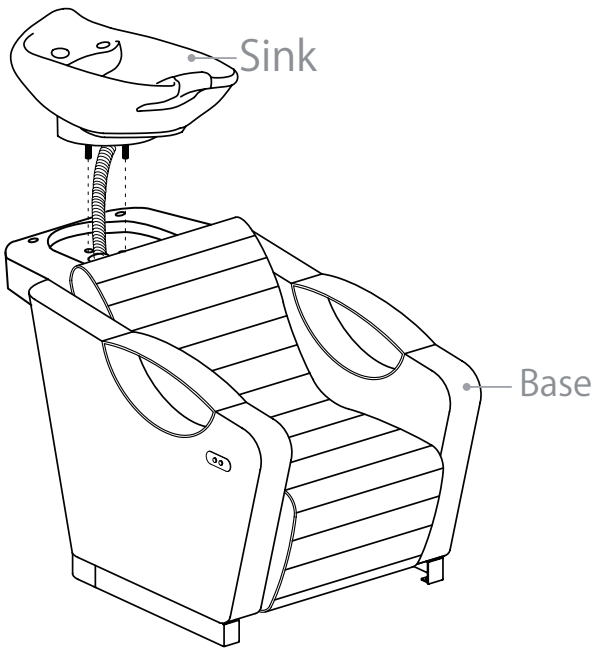

Front

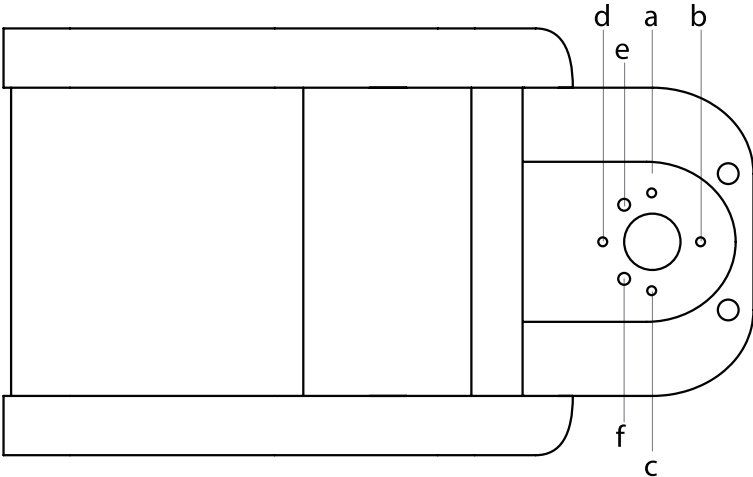

0350

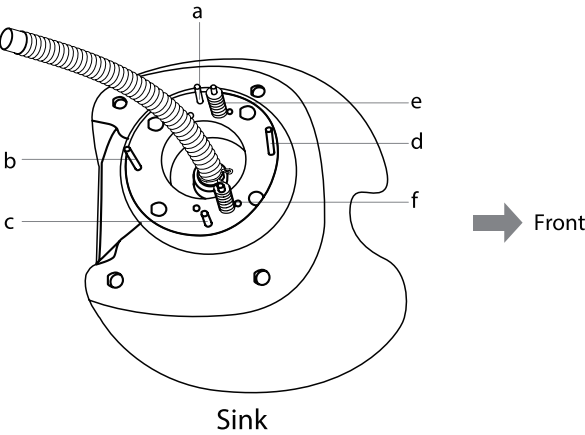

Align the sink to the base as shown in the diagram.

0350

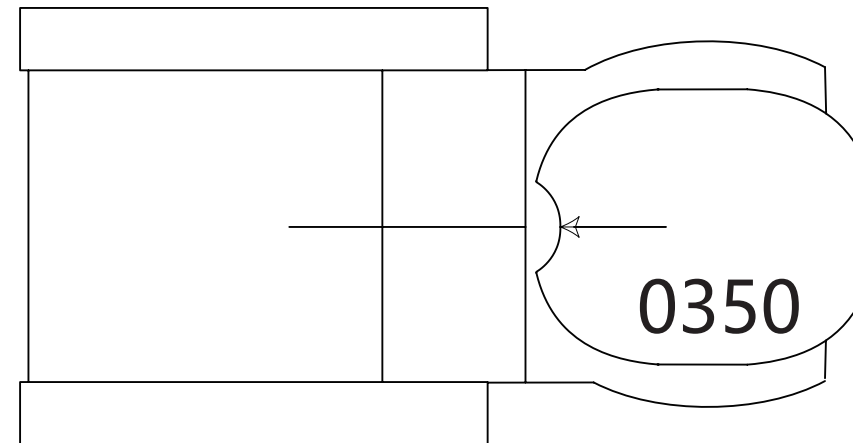
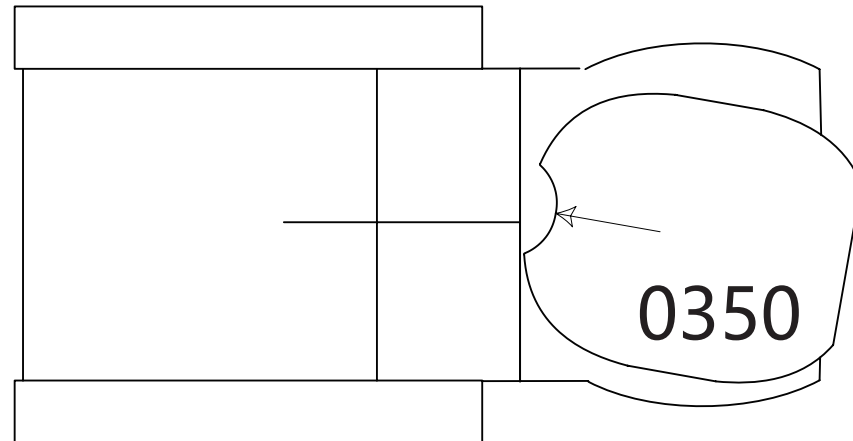
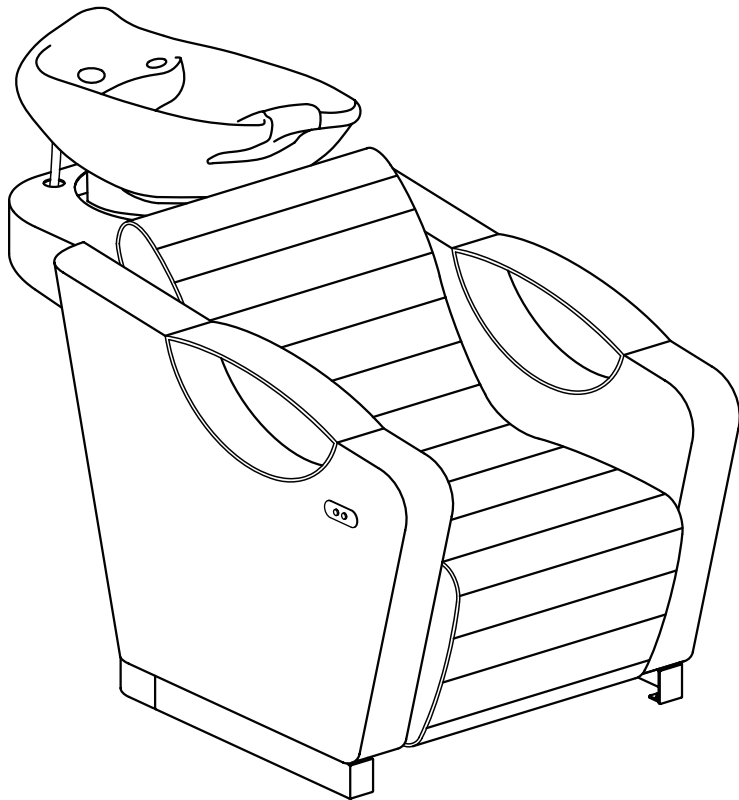

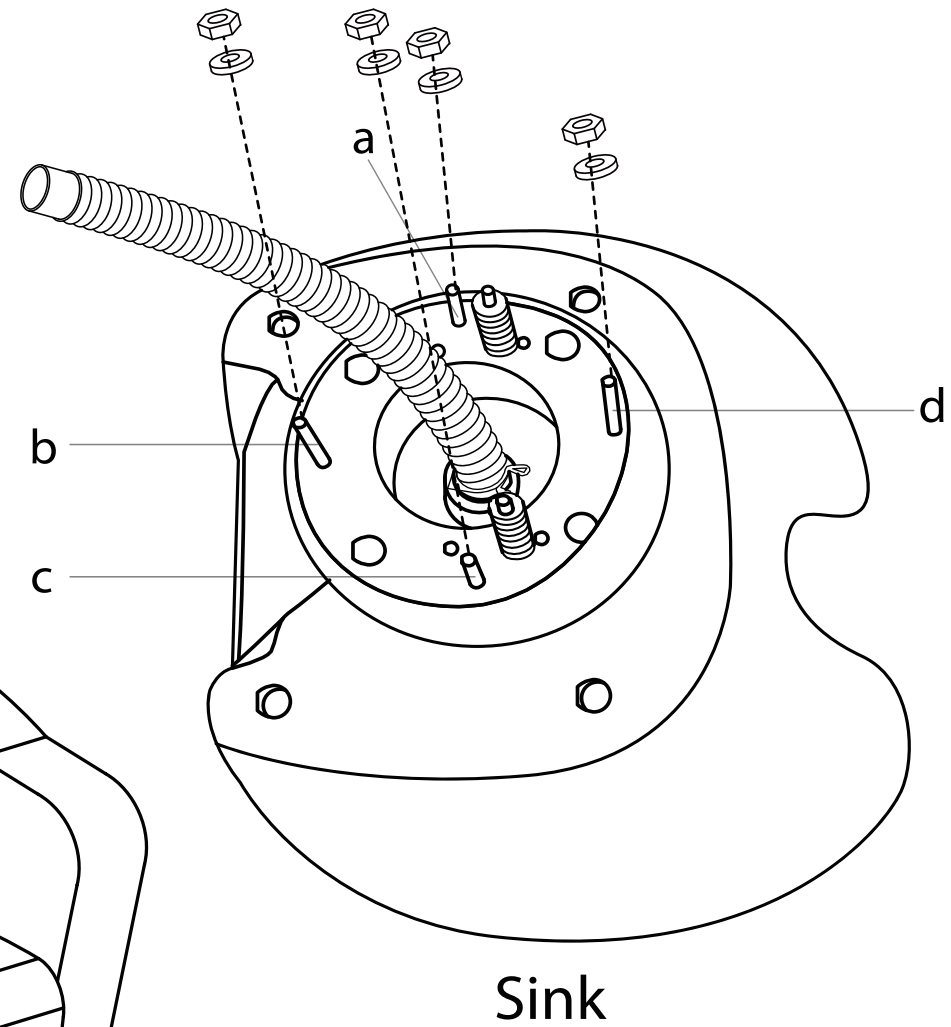
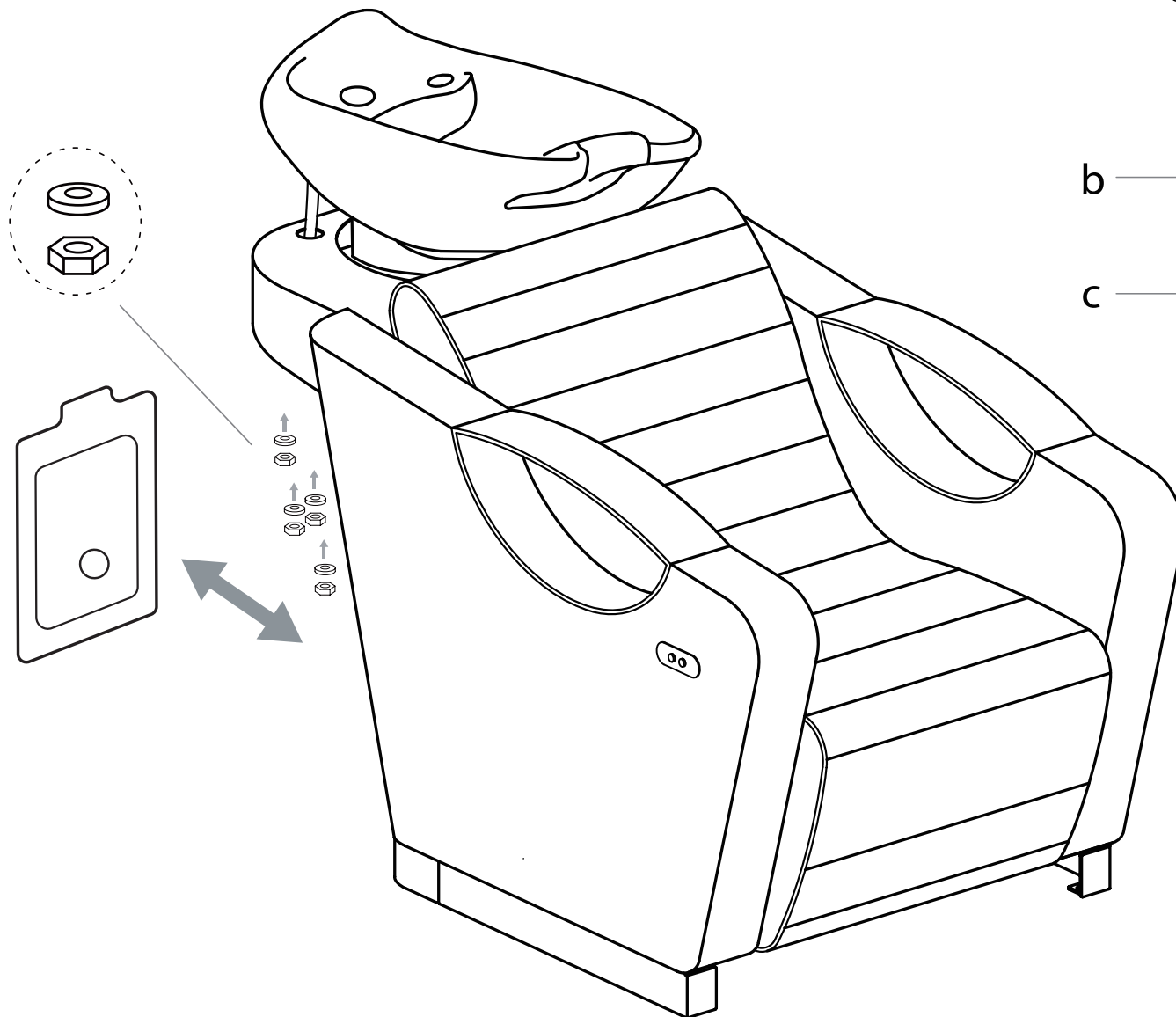

# Faucet Set up

None Vacuum Breaker Sink

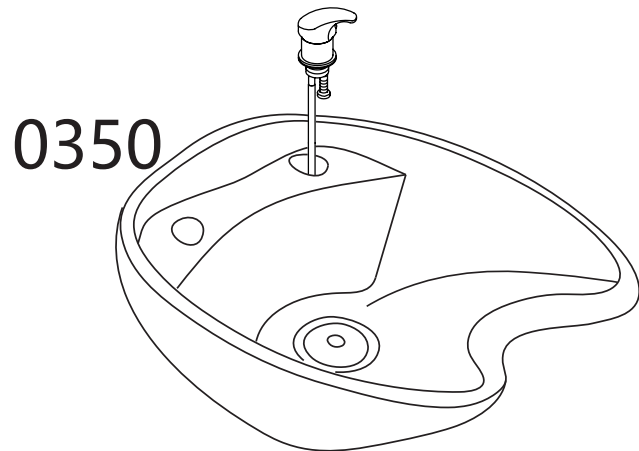

Vacuum Breaker Sink

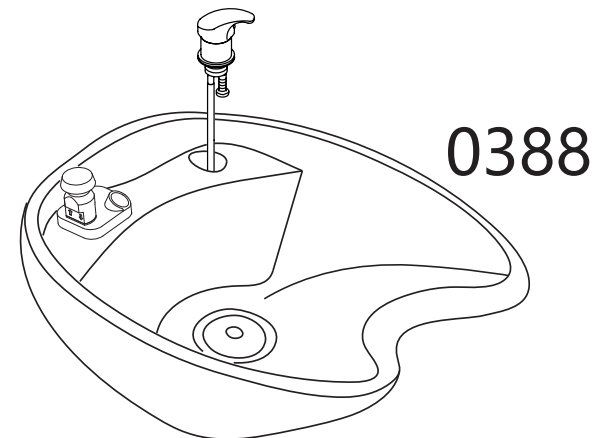

or

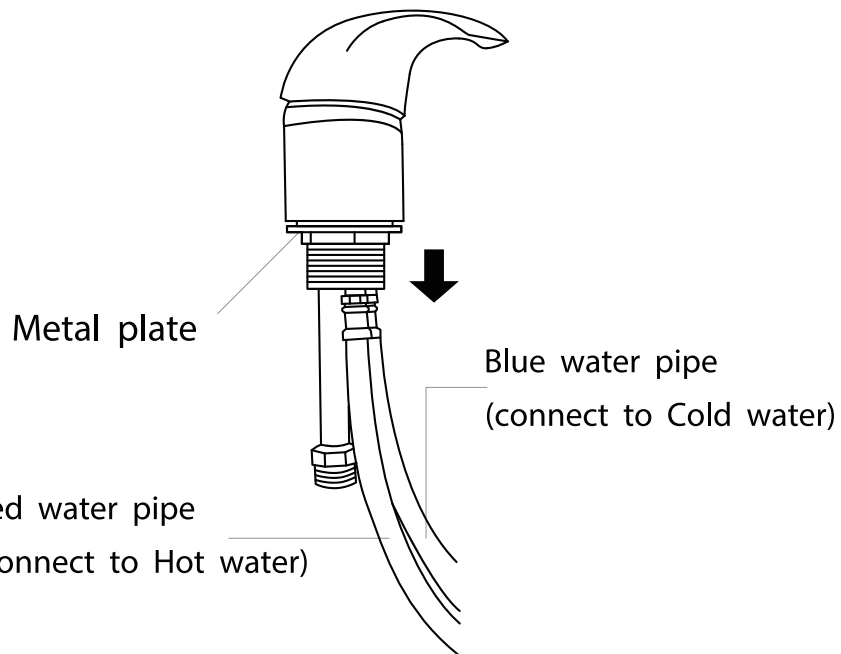

Unscrew the metal plate from the faucet

STEP 1

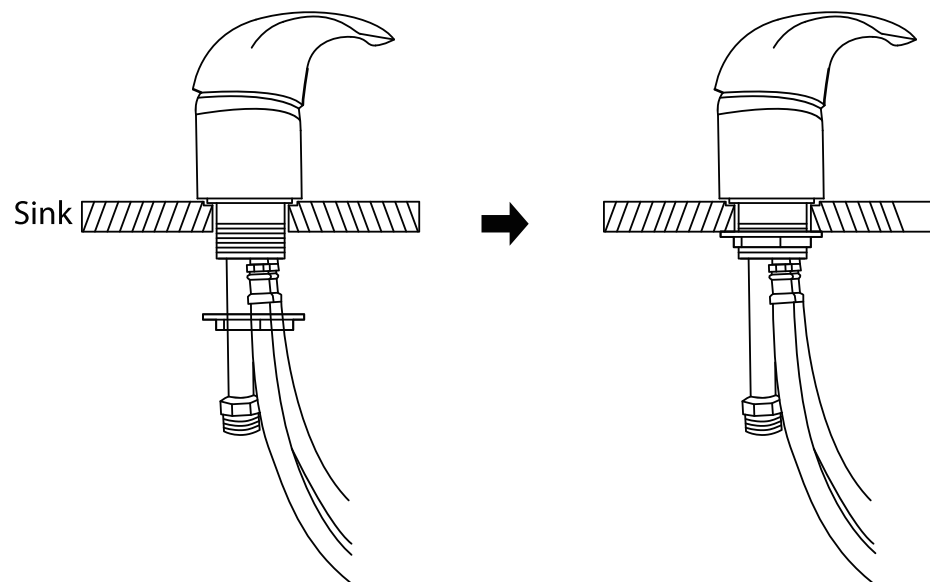

Place the faucet on the sink and fasten using the metal plate

STEP 2

## Sprayer Set Up None Vacuum Breaker Sink

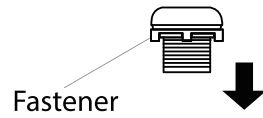
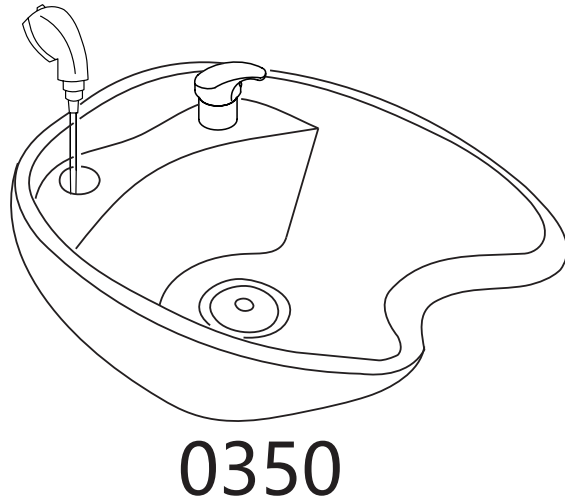

Unscrew the fastener from the sprayerhead holder.

STEP 1

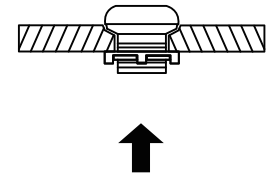
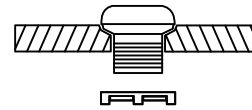

Fasten the sprayerhead holder to the sink with the plastic fastener.

STEP 2

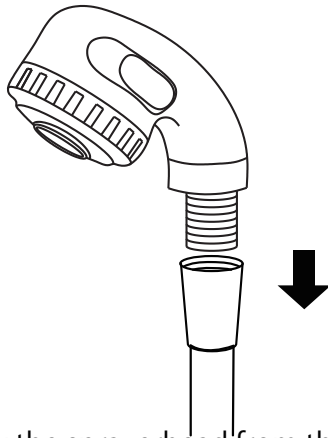

Unscrew the sprayerhead from the sprayer hose.

STEP 3

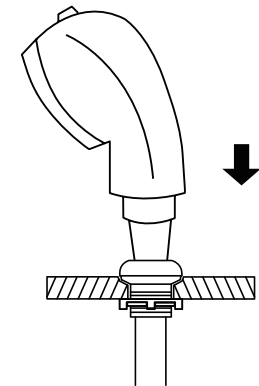
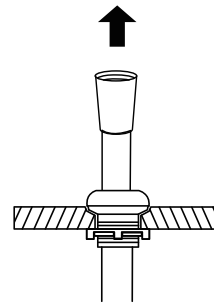

Place the sprayer hose from underneath through the sprayerhead holder and fasten the sprayerhead to the sprayer hose.

STEP 4



## Sprayer Set Up Vacuum Breaker Sink

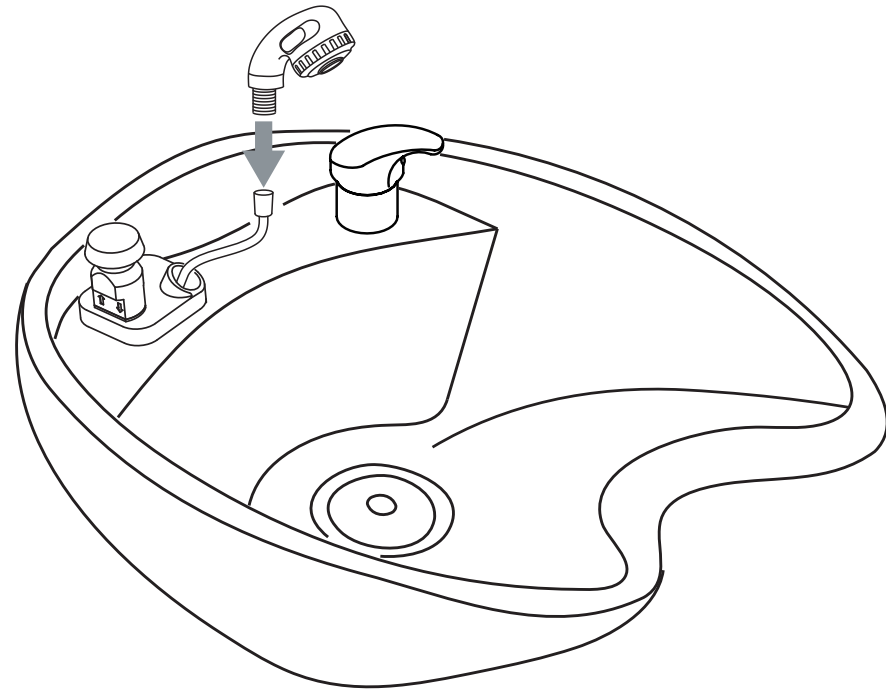

0388

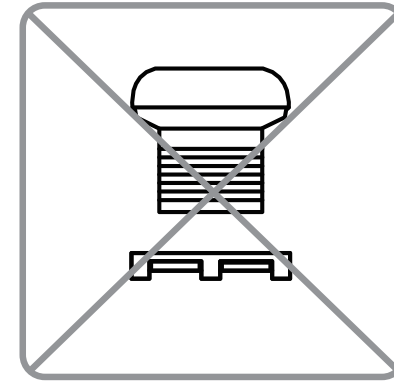

no need

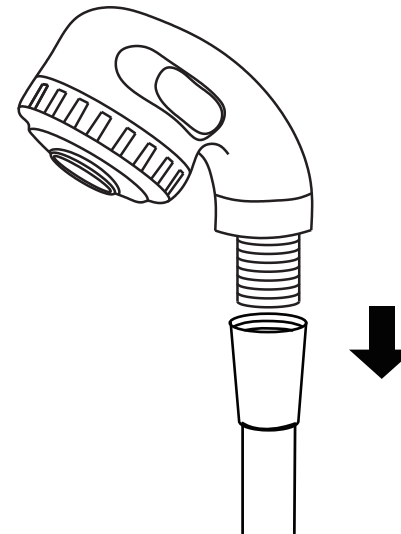

Unscrew the sprayerhead from the sprayer hose.

## None Vacuum Breaker Sink

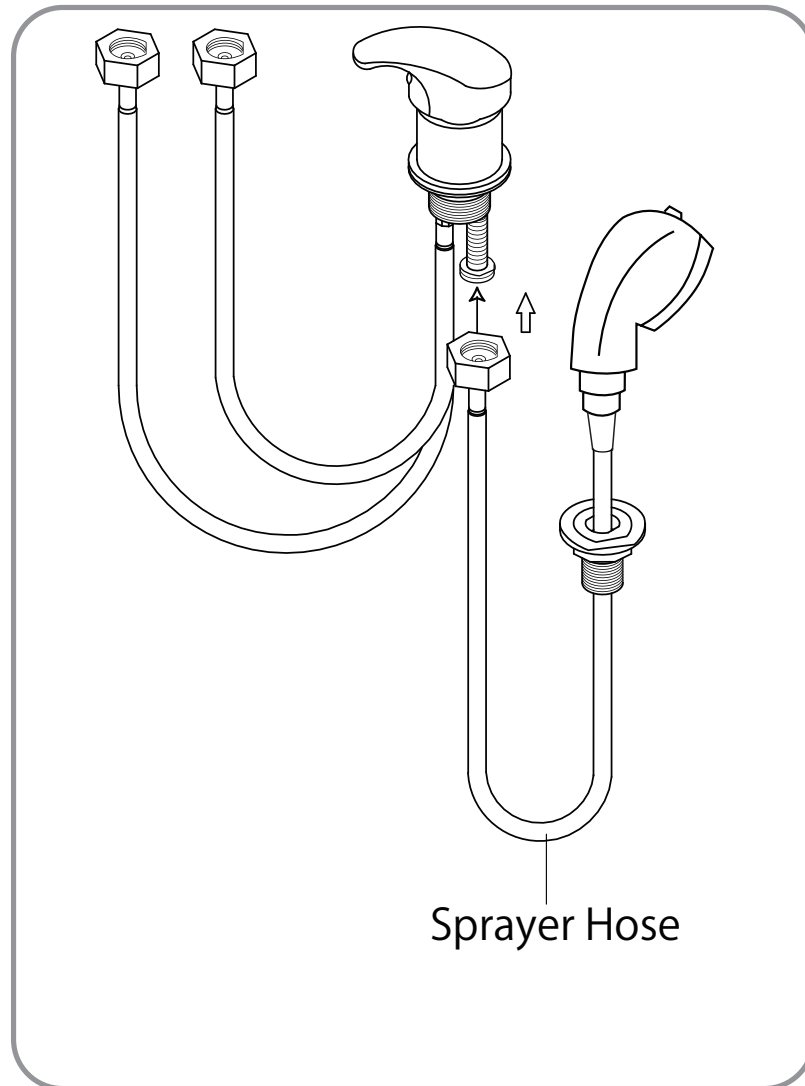

or

## Vacuum Breaker Sink

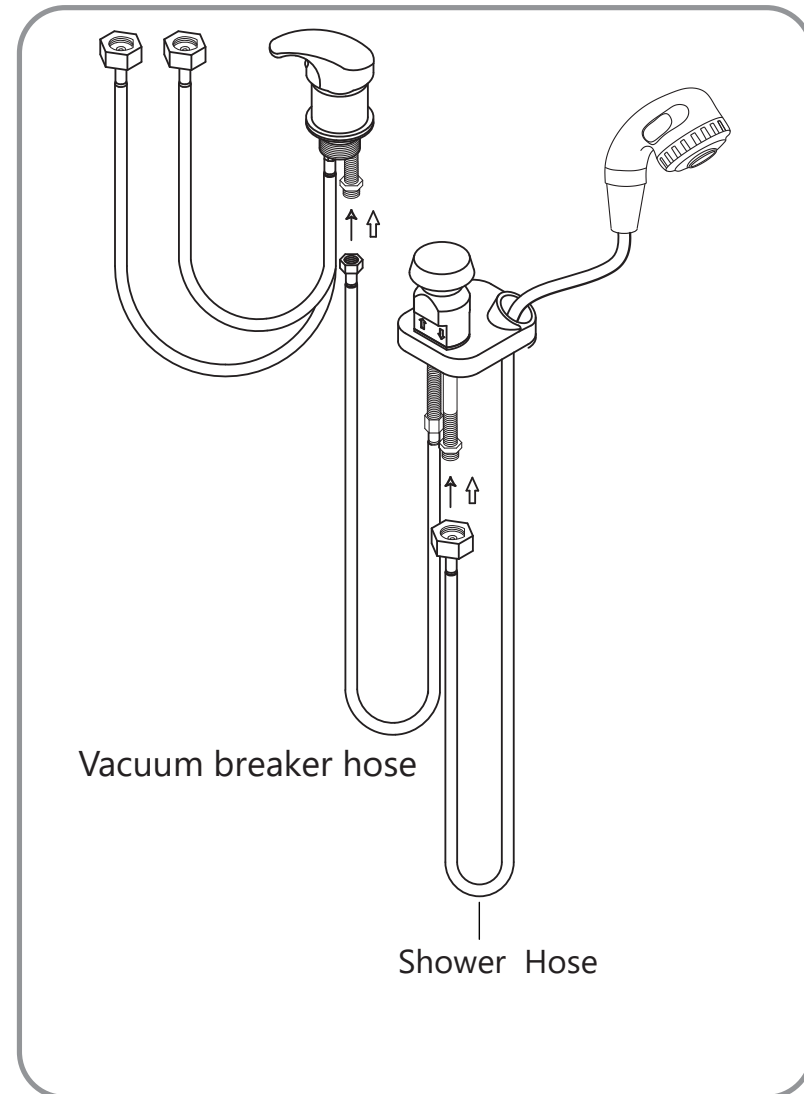

## Plumbing setup:

\*removable back panel to route both water supply lines and make all connections.

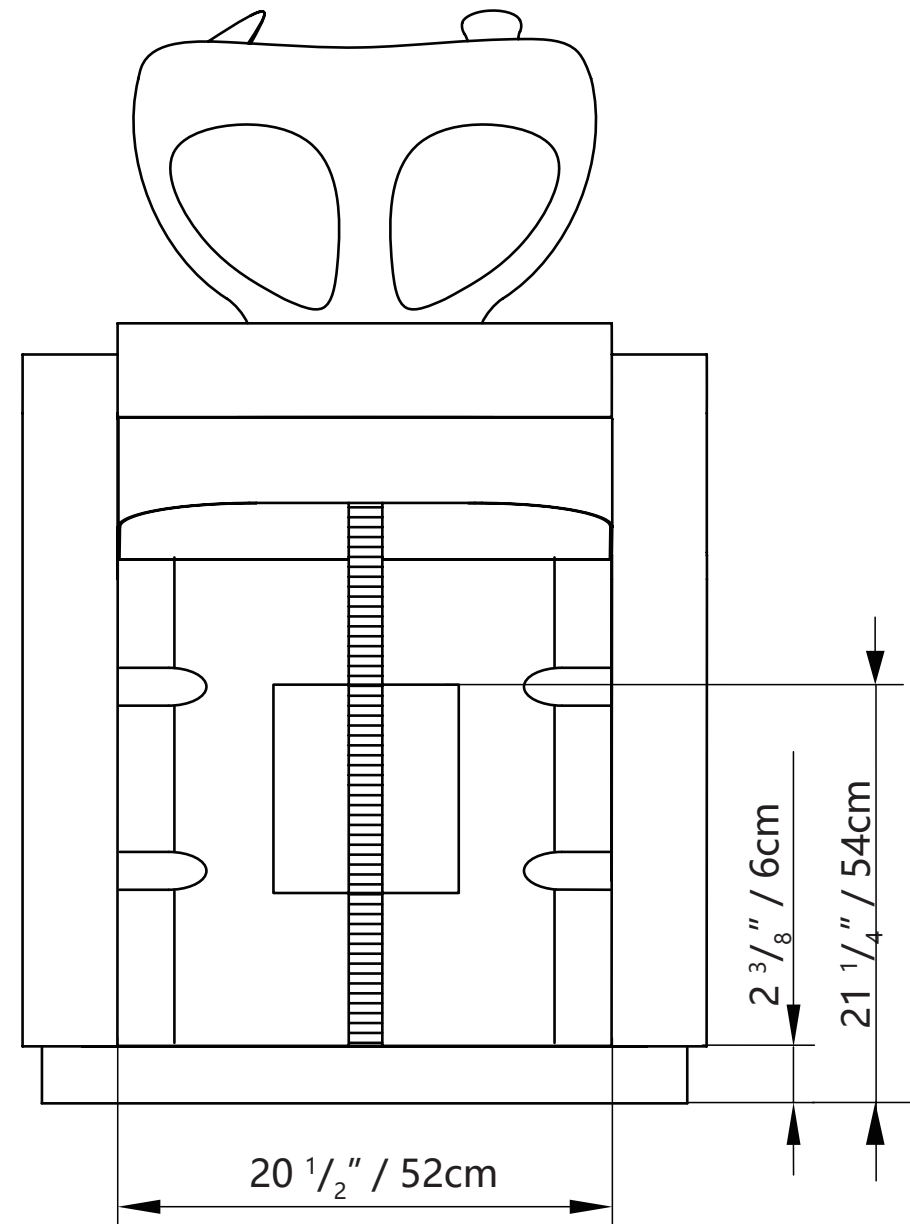
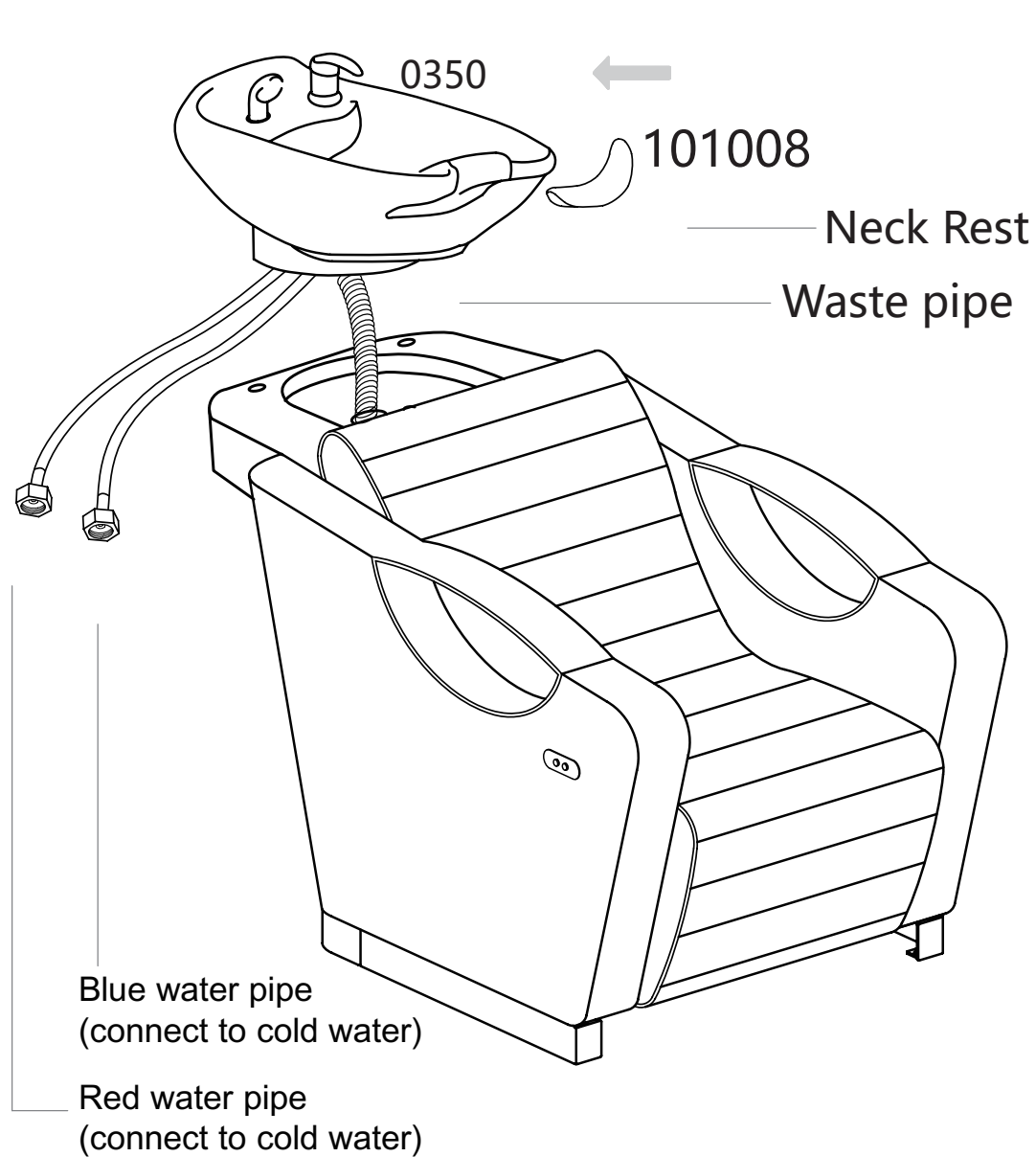

Floor plumbing setup:  
Circle opening on removable back for drain pipe exit

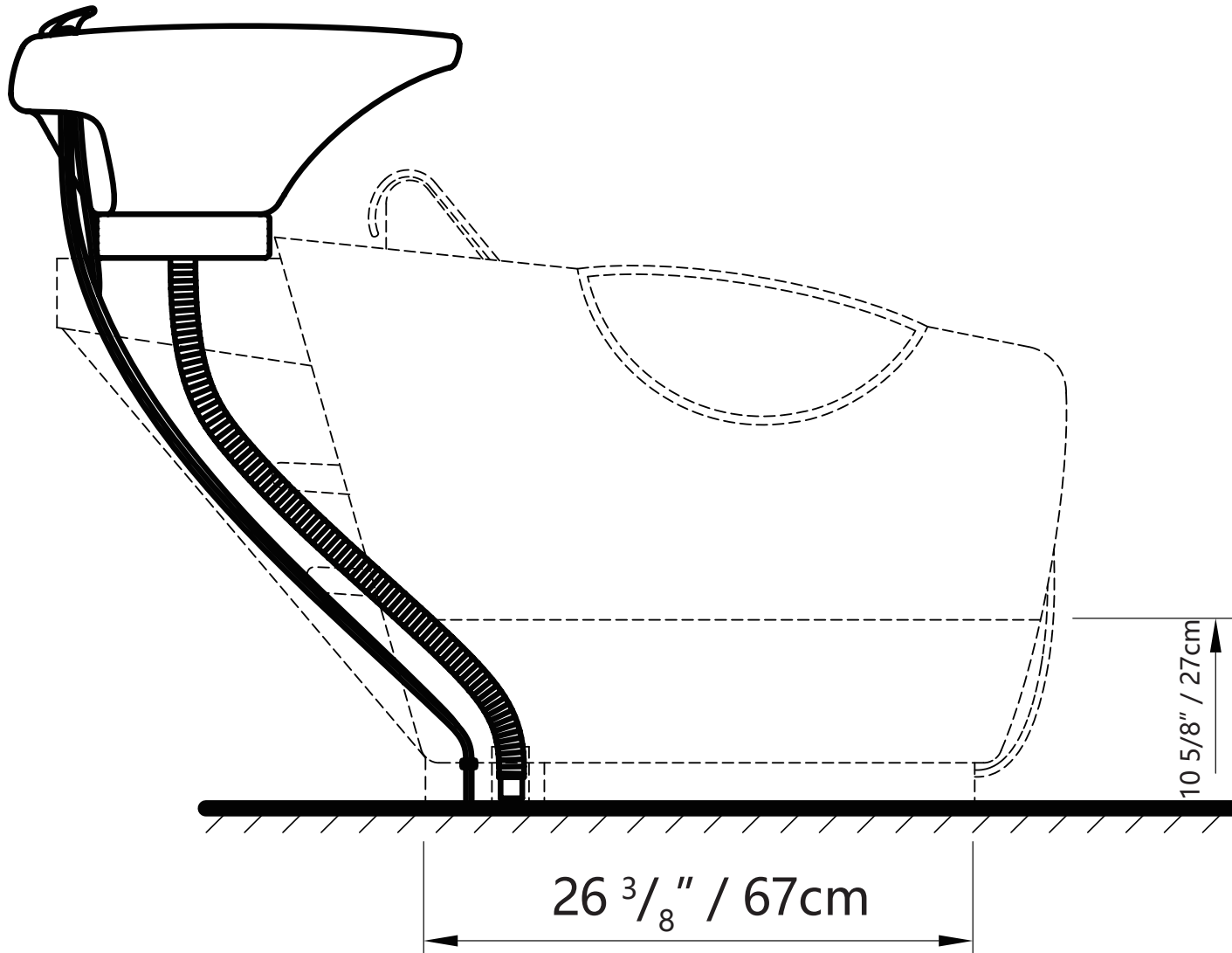

Wall plumbing setup:

All connection pipes are enclosed within the base unit.

Water supply lines are routed into the unit via circle opening on the back of the base.

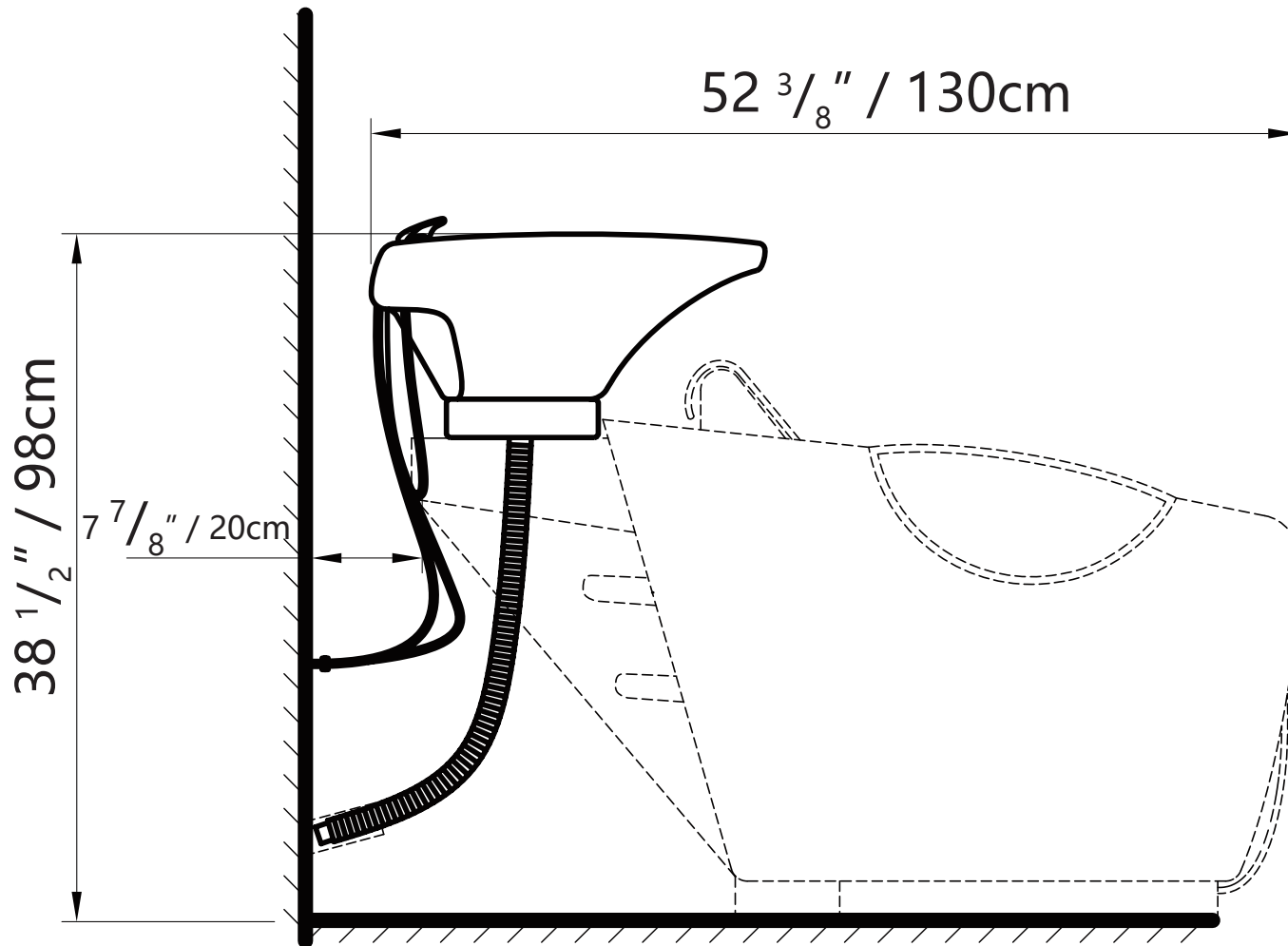

Please leave minimum  $7 \frac{7}{8}'' / 20\text{cm}$  of space measuring from finished wall to the back of the sink to allow sinks tilting position.

Secure the backwash on the floor by the provided floor anchors.

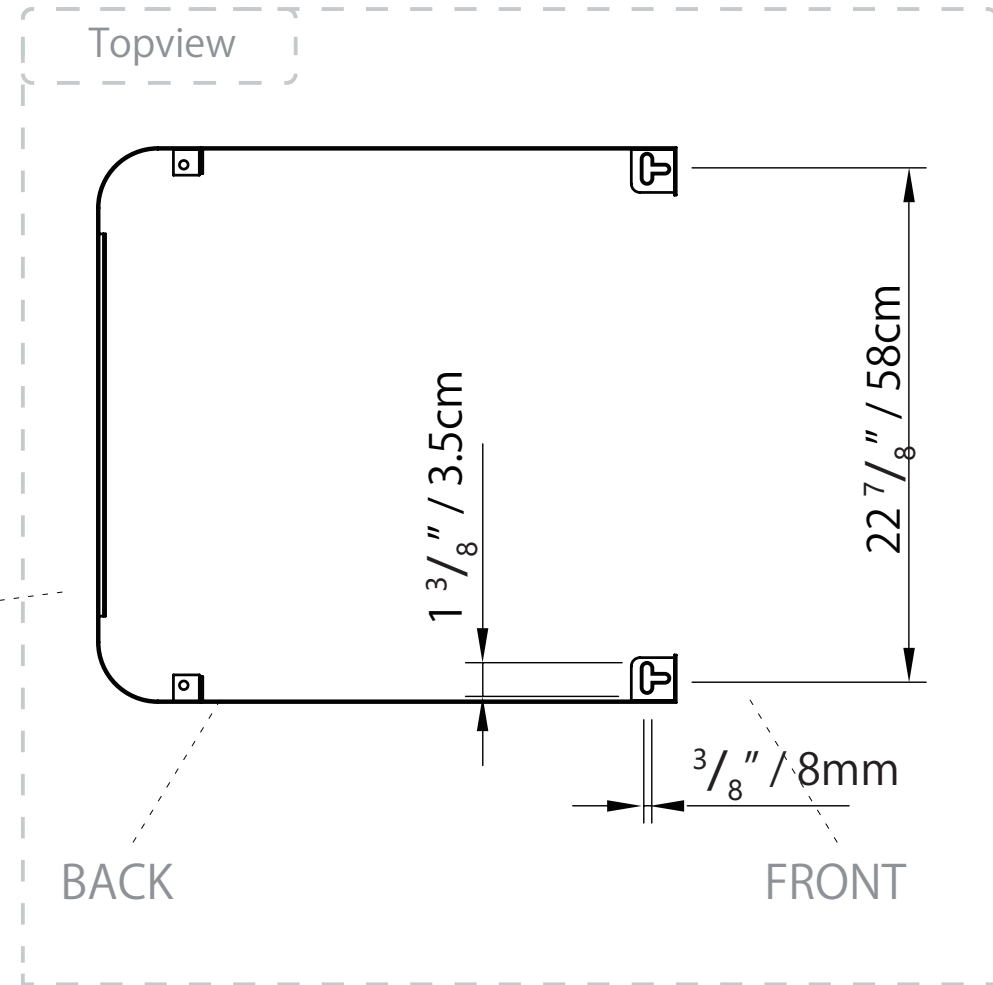
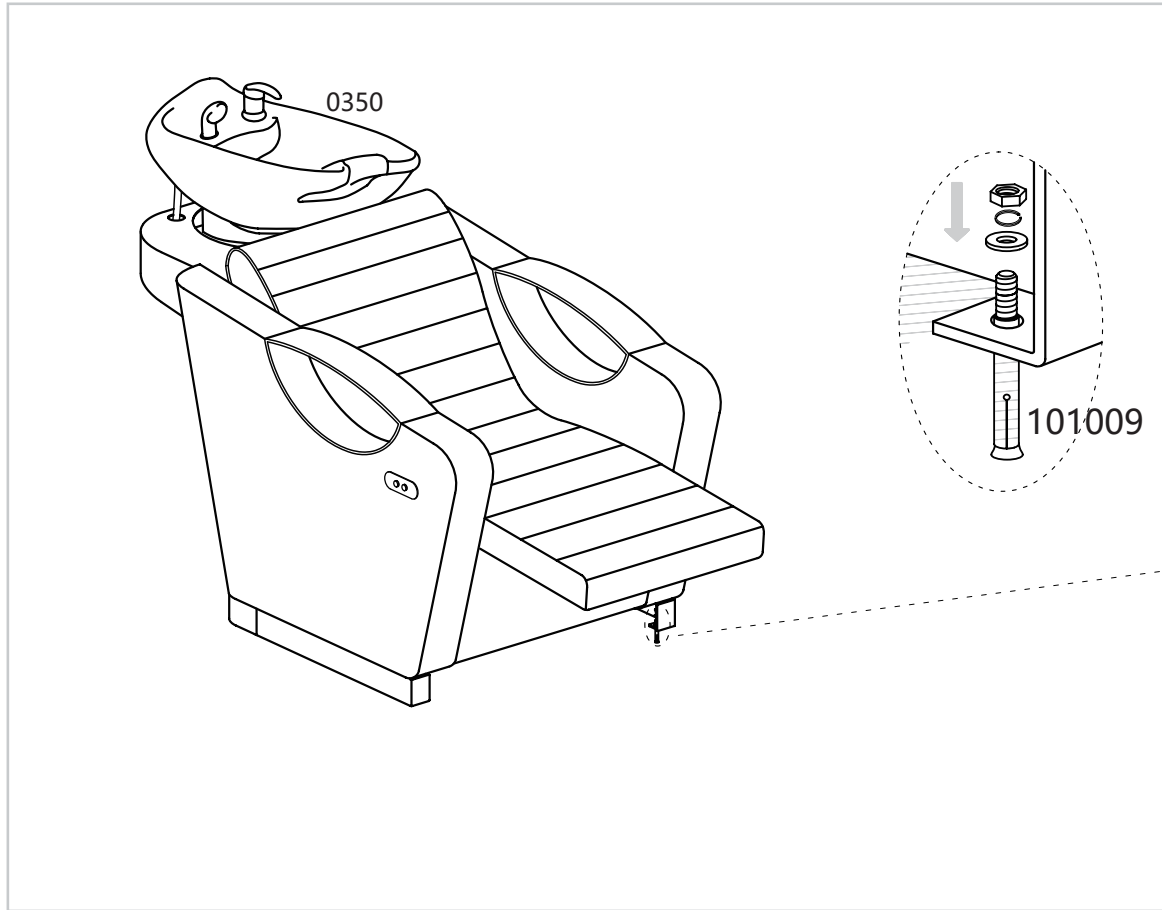

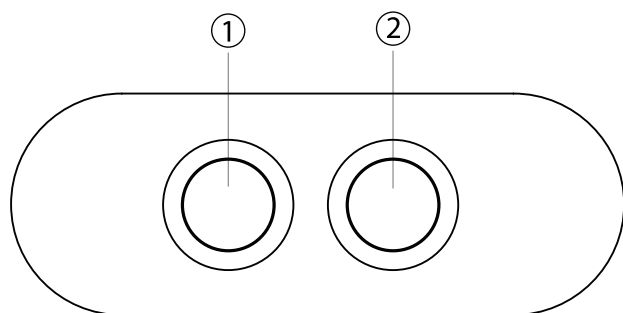

① — Press the button to raise the legrest of the Back Wash.

② — Press the button to lower the legrest of the Back Wash.