



USER MANUAL

EMPRESS LX/RX

EMPRESS

SERVICE & ORDER PARTS

TABLE OF CONTENTS

Safety Instruction	3
User Recommendation	6
Limited Warranty	7
Maintenance and Cleaning	9
Spa Information	
Specification	12
Identification	14
Dimension	16
Drain Instruction	18
Optional Discharge Pump	20
Motors	
Standard Motor	22
Optional Motor	23
Optional Auto-Fill	25
Chair Installation	26
Remote Instructions	27
Remote Holder Assembly	28
Footrest Assembly	29
Back Flow Protection Device	30
Registration	31

EMPRESS : THE SPA THAT EMPOWERS

WELCOME

Here at EMPRESS, We're committed to making OUR VALUES come alive in the work that we do and the products we create. That said, every EMPRESS Pedicure Spa makes a striking first impression - designed to be as functional as they are beautiful. It's important to note that our pedicure spa units must be installed, handled and cared for by licensed professionals, in whichever respective field. Whether it be plumbing, electrical, and/or beauty, the pedicure spa units should in no circumstance ever be handled by an unlicensed professional. We sincerely thank you for your support.

WARNING!!

IMPORTANT USER INSTRUCTION & SAFETY NOTICE. KEEP SAFE!

- The maximum recommended weight of EMPRESS is 250 LBS.
- Keep all ELECTRICAL DEVICES away from the pedicure spa.
- Enter and exit the pedicure spa with caution.
- Do not stand in the pedicure basin
- The water temperature should NOT exceed 105 F (41 C)
- The supply water temperature should never exceed 140 F (60 C)
- Always refer to state or local code to verify maximum supply temperature.

This product in whole is in compliance with applicable UL LISTED standards and requirements for the U.S. and Canada
By Underwriters Laboratories Inc.



Some of the components of this product are also in compliance with applicable safety standards of following:



IMPORTANT USER INSTRUCTION & SAFETY NOTICE.

KEEP SAFE!

ELECTRICAL NOTICE

In order to ensure proper use, a separate **120v 60HZ 15amp(per dedicated outlet)** GFCI protected grounded circuit must be used to supply power to each pedicure spa. Failure to do so renders the Limited Warranty void.

****PEDICURE SPAS** outside the US must be in accordance with the respective country's rules and regulations. For example, if installed in Canada, the pedicure spa must be in accordance with the Canadian Electrical Code Part1.

GROUNDING AND GFCI NOTICE

STOP! PLEASE READ PRIOR TO INSTALLATION AND USE!

When using electrical products, basic precautions should be followed:

1. Risk of electrical shock. Connect the pedicure spa only to a circuit protected by a ground-fault circuit-interrupter.(GFCI)
2. Every EMPRESS Pedicure Spa must be installed by your local, licensed plumber and licensed electrician to install your new spa. Installation **MUST** be in compliance with all local and state building codes.
3. Your pedicure spa cannot operate efficiently or safely unless it is provided with adequate electrical power, sufficient water pressure, proper water temperature, and required drainage capabilities.
4. Contact your local building inspector for information and local code compliance procedure that need to be followed when having your new pedicure spa installed.
5. Subsequent inspections and approvals that may be required are the responsibility of the purchaser.

Shipment Inspection

Examine the components immediately upon arrival to make sure no damages to the pedicure spa base and chair during the shipment. It is very important that you notify the driver directly and notation should be on the face of the freight bill or bill of lading of any damage. Failure to note damage on the bill of lading may prevent any claims you may have against the carrier.

If concealed or damage is found, you **MUST** notify the carrier at once and request an inspection. **DO NOT DISCARD THE SHIPPING CARTON** If receiver sign the carrier clean receipt of goods that have been damaged in transit .Do so at your own risk and expense.

STOP! PLEASE READ PRIOR TO INSTALLATION AND USE!

TO REDUCE THE RISK OF BURNS, ELECTRIC SHOCK, FIRE OR INJURY:

1. Only authorized operators are permitted to use the pedicure spa.
2. If the pedicure spa has a damaged cord or plug, do not use.
3. Keep all electrical cords away from heated surfaces.
4. Do not operate outdoors.
5. You are responsible to ensure that all plumbing connections meet national, state and local code.
6. Shut-off valves are strongly recommended.
7. The water temperature should be adjusted accordingly.

Important Installation Considerations

Electrical Service

110V, 60Hz, 15Amp GFCI protected grounded circuit **MUST** be used to supply power each individual pedicure spa. And the main circuit breaker **MUST** be at 25Amp. For maximum of two units per each electrical outlet.

Water Supply

All plumbing connections must conform to local, state, federal codes.

Water supply to the spa should be provided with adequate water pressure and water temperature.

Water Pressure

To fill the basin correctly up to level, Normal water pressure of 30 to 80 P.S.I is required.

Water temperature

The hot water supply temperature must not exceed 140 . Adjust your hot water accordingly. For hot and cold water supply fittings and drain fittings location, see drain diagram .Carefully connect the water supply line to the appropriate fittings located on the rear of the pedicure spa.

Pressure / Temperature

Maximum Pressure: 150 psi (10 bars)

Minimum Pressure: 10 psi (69kPa)

Working Temperature: 33F to 140F constant; intermittent to 180f
(0.6C to 60C sustained; intermittent to 82.2C)

Recommended Flow: 1.5gpm .

UL LISTED / CE CERTIFIED

Compliance with following Code (s): Uniform Plumbing Code, National Plumbing Code of Canada and international Plumbing Code. Also, Compliance with following Standard (s): ASME A112.18.3M / A112.18.1M, CSA B125, NSF /ANSI 61/372

All EMPRESS USA products has been investigated for compliance with the requirements for water retention for Whirlpool bathtub appliances contained in ASME / ANSI A122.19.7M(1995), CSA C22.2 No. 68-69

ANSI - American National Institute, ASME - American Society of Mechanical Engineers, CSA - Canadian Standard Association IAPMO - International Association of Plumbing and Mechanical Officials, UL - Underwriters Laboratory

***** Back flow Protection Device***

Due to Town and / or State requirement/s are varies in building code, if the Town and / or State requires specific Vacuum Breaker, As the Plumber **MUST** provide Vacuum Breaker according to building code

Drain Facilities

The pedicure spa Drain must meet local plumbing codes. **Check valve for Drain (not Provided) Must be installed by a licensed plumber.** Also Pedicure spa must be securely fasten to the floor.

Installation Summary

A licensed plumber / Electrician **MUST** install the Pedicure Spa conform and comply with local, State and Federal building code. where applicable.

Note: Failure to comply with federal, state, or local codes and ordinances will result in warranty being nullified and void.

Please print this page for your review and reminder.

User Recommendation

PLEASE READ THE MANUAL THOROUGHLY BEFORE USE TO ENSURE CORRECT OPERATION.

THOSE UNDER A DOCTOR CARE OR WHO ARE EXPERIENCING ONE OR MORE OF THE FOLLOWING CONDITION SHOULD CONSULT THEIR DOCTOR BEFORE USE.

- You are receiving medical treatment or are feeling ill.
- Your body shows any cute symptoms.
- You have heart disease.
- You are pregnant or having a menstrual period.
- Your doctor has ordered you to rest.
- You have a back disorder resulting from an accident or disease
- You have high fever.
- You have sensory disorders.
- You have medical electrical device (e.g. pacemaker).
- You have service interruption in the circulation of the legs.
- You have an open wound.
- You are diabetic.

FAILURE TO DO SO MAY RESULT IN ACCIDENTS AND HEALTH PROBLEMS.



EMPRESS PEDICURE SPAS Limited Warranty (1/2)

IMPORTANT

To validate the limited warranty, The Limited Warranty Registration Form **MUST** be filled out completely and return to EMPRESS within 30 days of original purchased date. This Limited Warranty is valid if EMPRESS USA received registration form.

EMPRESS Pedicure Spas has designed and manufactured with the highest standards and expressly warrant the pedicure spa as follows:

To the original owner of the EMPRESS Pedicure Spa may repair or replace, at its option, any pedicure spa found to be defective in material or workmanship upon inspection by a authorized representative of EMPRESS USA Inc. This limited warranty covers the following:

Base - Twenty four (24) month from date of shipment from EMPRESS facility.

Components / Parts - Twenty four (24) month from date of shipment from EMPRESS facility.

Stool - Ninety (90) days from date of shipment from EMPRESS facility.

Shipping Costs - Twenty four (24) month from date of shipment. EMPRESS will cover normal shipping costs associated with replacement parts. Expedited shipping cost will incur an additional charge.

Labor - Twelve (12) month from date of shipping, EMPRESS will cover reasonable labor costs associated with the installation of replacement parts found to be defective in material or workmanship upon inspection by authorized representative of EMPRESS.

No labor cost or replacement parts will be covered under this limited warranty if at the sole discretion of EMPRESS. It is determined a failure was caused by negligence, accident or improper use, improper installation or lack of proper maintenance as in the Owner's Manual.

NO CONSEQUENTIAL, INCIDENTAL, CONTINGENT, INDIRECT, SPECIAL OR OTHER DAMAGES WILL BE ALLOWED.

This warranty is null and void if the pedicure spa is removed from its original installation or is not installed accordance with specifications of pedicure spa or national, state or local codes, regulation and ordinances. Furthermore, this limited warranty is null and void if the pedicure spa is subjected to improper installation or maintenance, negligence, improper cleaning or any other circumstance beyond EMPRESS's control. To validate limited warranty, pedicure spa must be installed by a licensed plumber and/or electrician in accordance with local and / or State code and pedicure spa installation instructions.

Warranty Exclusion

- 1- Unauthorized repairs and/or modification or tampered in any way.
- 2- Damage due to freight, accident, natural disaster and /or abuse or misuse
- 3- Stain, fading or discoloration of seat, back cover, armrests (Upholsteries), Tray or Footrest
- 4- Fading, discoloration or staining of basin or Any portion of surface of pedicure spa caused by water additive or improper Water treatment (such calcium built up) and/or cleaning agents/s
- 5- Damage or malfunction due to improper installation including but not limited to, failure to comply with all national, state and local plumbing, electrical and building codes.
- 6- Damage drain pump due to residue built up in drain pipe and / or due to the lack of maintenance.

EMPRESS PEDICURE SPAS Limited Warranty (2/2)

Parts for which labor / Service is **NOT COVERED** - Following components are simple to replace and DO NOT require a service technician. Therefore, though the part is covered under the guidelines of the warranty agreement.

- 1- Panel
- 2- Jet cover, impeller and / or jet assembly
- 3- Faucet Cartridge, Shower Head
- 4- Footrest
- 5- Air actuate On/Off Button
- 6- Drain Plug
- 7- Remote control

During the Limited Warranty period, EMPRESS will, at its sole discretion, repair or replace any defective component. All component parts removed under this Limited Warranty become property of EMPRESS. And all replacement component/s MUST be return to EMPRESS Within 30 days of replacement. If not, replaced component/s will be charge as its cost/s.

This limited warranty is for the original owner and not transferable. The original owner agrees by using pedicure spa the obligation of EMPRESS shall not extend to indirect or contingent damage or injury. Furthermore, the obligations of EMPRESS are limited to those set forth herein. The limited warranty is the exclusive remedy and is in lieu of all other warranties, express or limited, including but not limited to, any implied warranty of fitness or merchantability for a particular purpose. No distributor or other person has the right or authority to bind EMPRESS to changes to this limited warranty. Consequently, EMPRESS is not responsible for such warranties or representations.

Limitation of liability

TO THE EXTENT ALLOWED BY LOCAL LAW, EXCEPT FOR THE OBLIGATIONS SPECIFICALLY SET FORTH IN THIS WARRANTY STATEMENT, IN NO EVENT WILL EMPRESS OR ITS THIRD PARTY SUPPLIERS BE LIABLE FOR ANY DAMAGED CAUSED BY EMPRESS PEDICURE SPA OR THE FAILURE OF EMPRESS PEDICURE SPA INCLUDING ANY LOST PROFIT OR SAVINGS, BUSINESS INTERRUPTION, LOSS OF USE OR ANY OTHER COMMERCIAL OR ECONOMIC LOSS OF ANY KIND, OR SPECIAL, INCREMENTAL, OR CONSEQUENTIAL DAMAGES. THIS LIMITATION OF LIABILITY APPLIES WHETHER DAMAGES ARE SOUGHT, OR A CLAIM MADE, UNDER THIS LIMITED WARRANTY OR AS A TORT CLAIM, A CONTRACT CLAIM OR ANY OTHER CLAIM.

USER MAINTENANCE INSTRUCTIONS CLEANING AND DISINFECTING YOUR PEDICURE SPA

Note: Please be advised that it is responsibility of purchaser/user to adhere strictly to the following procedure. Any non-compliance will be considered negligence of the purchaser/user.

The Bureau of barbering and cosmetology requires that salons using whirlpool pedicure spas use the following disinfecting Procedures to ensure proper cleaning and maintenance of the equipment, and to prevent bacterial infection. For your clients safety, always use the regulations as a minimum standard for cleaning and disinfecting.

Chair maintenance: Please see chair manual for Do and Don't

A SPECIAL NOTE PERTAINING TO BLEACH

While bleach seems to be used extensively for cleaning and disinfecting of pedicure chair basins, it is **NOT** recommended nor is it effective. Moreover, excessive use of bleach may greatly reduce the longevity of your pedicure chair internal components (i.e. pumps, jet waste assembly, etc.). Excessive and repeated use of bleach may also void your warranty. As always, you are required to check with your state board for mandatory cleaning and disinfecting requirements and procedures.

At the end of the day:

1. Remove the intake suction screen, All debris trapped behind the screen of each pedicure spa must be removed. And the screen and the inlet shall be washed with soap or detergent and water
2. Before replacing the screen, Totally immersed the screen into an EPA- registered disinfectant with bactericidal, Fungicidal, and virucidal activity.
3. Finally, flush the whirlpool system with low-sudsing detergent and warm OR an EPA - registered cleanser for 10 minutes. Rinse with clean fresh water and drain.

Note:

Cleaning or sanitizing is NOT disinfecting. According to the CDC and EPA, disinfecting occurs only when there is a reduction of pathogenic microbes at 99.999%. Sanitizing is a only reduction of 99.9%. Cleaning of whirlpool pedicure spa requires surfactant and chelating detergents that are low foaming and have ability to remove body oils, organic oil additives, mineral oil, skin cell, nail clippings, etc.. That can accumulate both in the basin and the jets which may become fertile area for micro organism to grow.

Note:

The use of oil based products can build up in the whirlpool system causing clogging in the jet and build up onto the surface of the basin. Adherence to the above cleaning will minimize build up thus the manufacturer recommend not to use mineral oil based product.

Maintenance and Cleaning of PU Synthetic Leather

PU synthetic leather is made from polyurethane resin after coating, drying and curing. Compared with the genuine leather, PU synthetic leather is more resistant to acid, alkali, heat and sunshine. However, because of its own physical and chemical properties, it should not be put at the place where there is dust, high temperature, high humidity, low temperature or strong sunshine and the environment containing acid and alkali agent and solution. Otherwise, it will be easily cracked, quickly aging and hydrolyzed.

Cleaning methods of PU synthetic leather and precautions:

1. Organic agent, grease solution and compounds, especially the strong solvent, e.g. alcohol, turpentine, thinner can not be used for cleaning the PU surface and otherwise the PU surface will be easily corrosive.
2. Fresh water or washing powder can not be used for cleaning the PU surface or there will be cracks.
3. Environment-friendly detergent which is containing no abradant and with a PH value of 5-7 should be used for cleaning the PU surface.
4. For the quite dirty PU surface, use a soft cloth with egg white to wipe the dirt, brush should not be used for cleaning the surface.
5. The more popular detergents in the market are: Meipingwang leather detergent and protective agent; Amway leather detergent, etc.
6. For the best result for maintaining your PU synthetic leather please inquire Empress for **Spa Leather Cleaner**.
7. Fabric inside liner and fabric padding **MUST** be check quarterly for the best result. In case of warn out please contact service department for replacement.(Worn and tear is not covered under warranty)

Maintenance methods of PU synthetic leather and precautions:

1. Good room ventilation should be ensured because too dry or too wet environment will fasten the aging of leather.
2. Leather sofa should avoid direct exposure to sunshine or air-conditioner wind; otherwise the leather surface will become hard. Direct exposure to sunshine will make the leather with color faded.
3. There is more sweat on body during the summer the hole of the leather will absorb the sweat. The organic matter in the sweat and the leather will have a chemical reaction during high temperature and wet environment, and there will be peculiar smell. For this, wettish soft cloth should be used for wiping frequently.
4. While wiping the sofa, the alkali cleaner should not be used because there is acid treatment during leather making and the alkali will decrease the pliability of the leather and there will be crack if the alkali cleaner is used for wiping the sofa.

RESIN BOWL Care and Cleaning

Note:

Please be advised that it is responsibility of purchaser/user to adhere strictly to the following procedure. Any non-compliance will be considered negligence of the purchaser/user.

The Bureau of barbering and cosmetology requires that salons using whirlpool pedicure spas use the following disinfecting procedures to ensure proper cleaning and maintenance of the equipment, and to prevent bacterial infection. For your client's safety, always use the regulations as a minimum, standard for cleaning and disinfecting.

EXCLUSIVE WRITTEN WARRANTY

LIMITED ONE - YEAR WARRANTY

Maintenance (resin bowl)

At the end of the day:

1. Remove the intake suction screen, all debris trapped behind the screen of each pedicure spa must be removed. And the screen and the inlet shall be washed with soap or detergent and water.
2. Before replacing the screen, totally immersed the screen into an EPA-registered disinfectant with bacterial, Fungicidal and virucidal activity.
3. Finally, flush the whirlpool system with low-suding detergent and warm OR and EPA-registered cleanser for 10 minutes. Rinse with clean fresh water and drain.
4. Wipe with clean towel.

Don't

1. Do not use abrasive material to clean.
2. Do not use acetone to clean or as stain remover.
3. Do not use harsh or harmful chemical on the surface.
4. Do not use concentrate Chlorine as disinfectant agent.

Do

1. Remove stain - use small amount of alcohol on clean towel.

Note:

Cleaning or sanitizing is NOT disinfecting. According to the CDC and EPA, disinfecting occurs only when there is a reduction of pathogenic microbes at 99.999%. Sanitizing is a only reduction of 99.9%. Cleaning of whirlpool pedicure spa requires surfactant and chelating detergents that are low foaming and have ability to remove body oils, organic oil additives, mineral oil, skin cell, nail clippings, etc.. That can accumulate both in the basin and the jets which may become fertile area for micro organism to grow.

Note:

The use of oil based products can build up in the whirlpool system causing clogging in the jet and build up onto the surface of the basin. Adherence to the above cleaning will minimize build up thus the manufacturer recommend not to use mineral oil based product.

Empress LX/RX: Specification

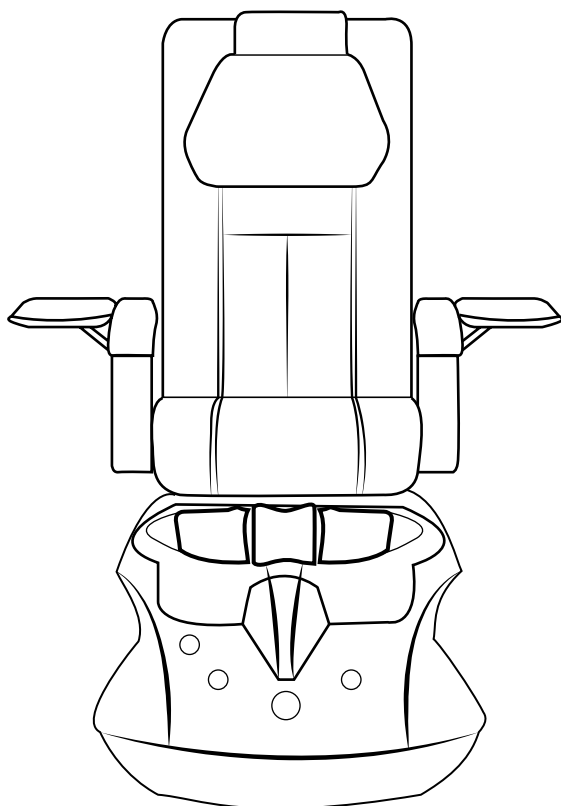

Empress RX

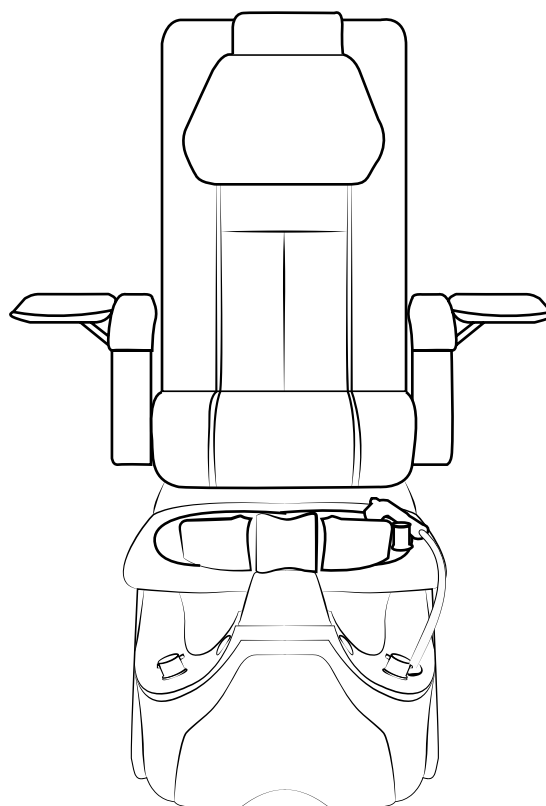

Empress LX

Dimension & Weight (Shipping)	Empress RX	37"W x 66"L x 40"H	275lbs
	Empress LX	37"W x 66"L x 40"H	305lbs
Dimension & Weight (Net)	Empress RX & Massage Chair	28"W x 54"L x 32"H	192lbs
	Empress LX & Massage Chair	28"W x 52"L x 32"H	224lbs
Capacity of Tub		4.5 US Gallon	
Switch		On/Off Air Activated Switch	
Power Source	Dedicated 15Amp Wall Outlet Require Pipe-less Whirlpool Motor Discharge Pump (Optional) Massage System	120Vac, 0.4 Amp, 60Hz	
		120Vac, 60Hz Input: 100-240V 50-60 Hz 1.6A Output: 24V 2.5A	
Plumbing	Hot Water	0.5inches (Fitting Provided)	
	Cold Water	0.5inches (Fitting Provided)	
	Drain	1.5inches (See Plumbing Instruction)	
Warranty		See detail in warranty page.	

Installation Specifications Summary

WARNING: Failure to comply with federal, state or local codes and ordinances will result in warranty being null and void.

As stated, the pedicure spa installation must comply with all **plumbing and electrical codes**. A **licensed plumber and licensed electrician MUST** complete the applicable connections of the pedicure spa.

Location and support: Select a level location. The floor structure beneath the pedicure spa must be capable of supporting the occupied pedicure spa.

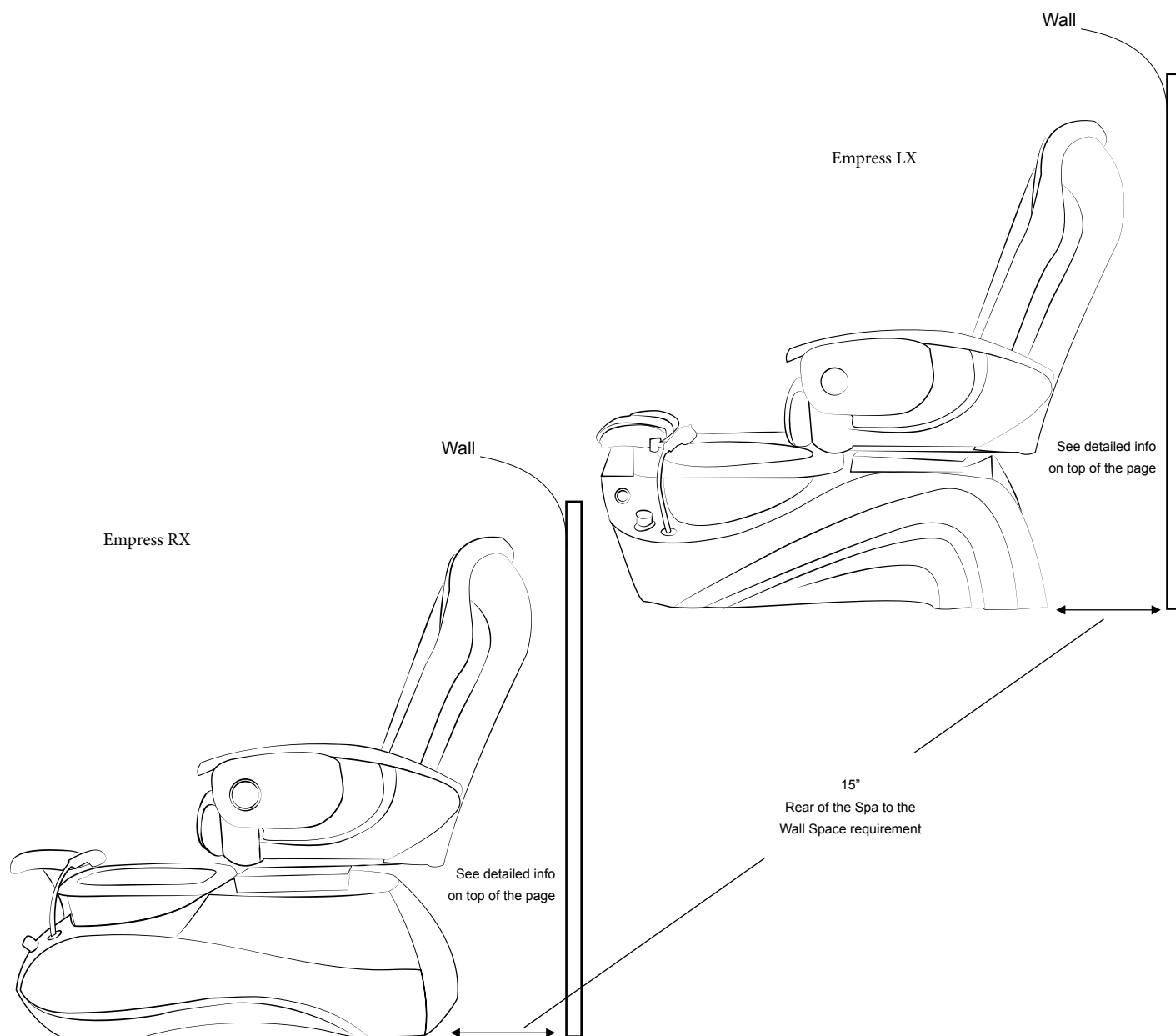

****Due to continuous improvements on all our products, specification, characteristics, packing, color, designs are subject to change without notice.**

Empress RX: Identification

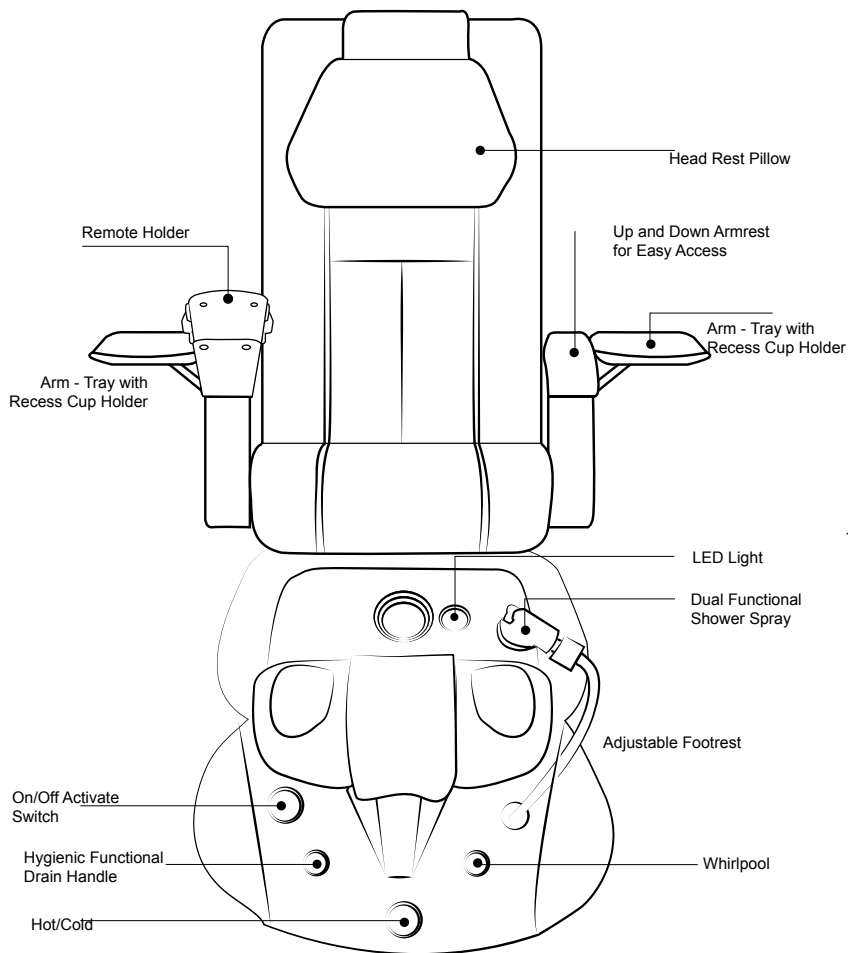

Rear View

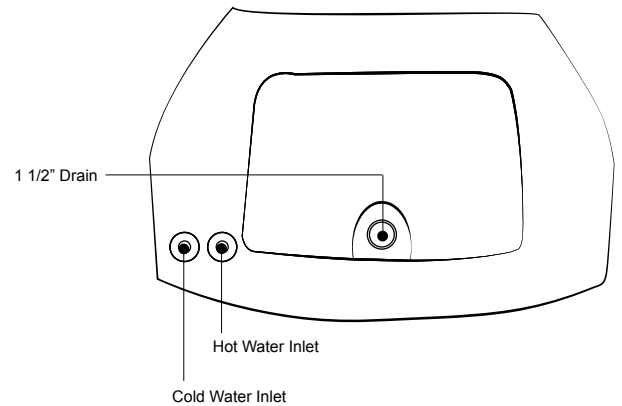

BASIN

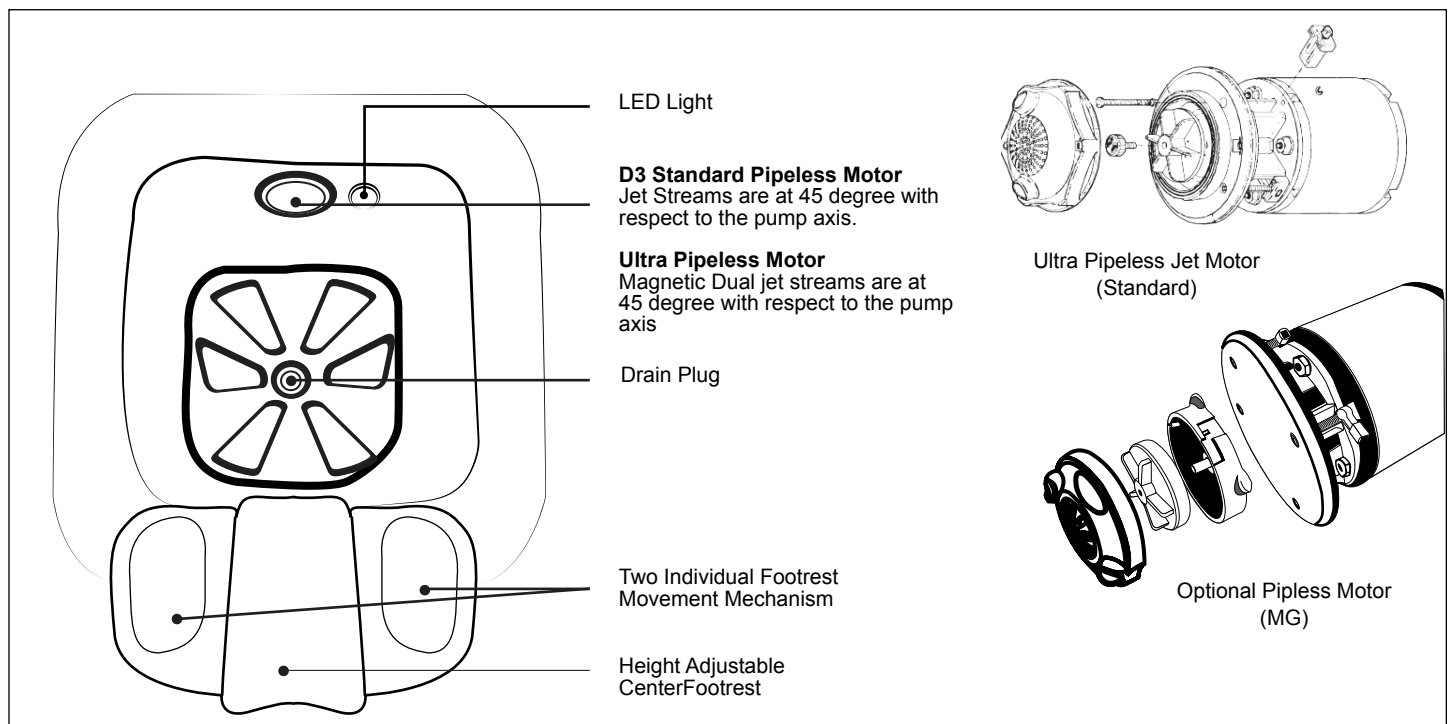

Empress LX: Identification

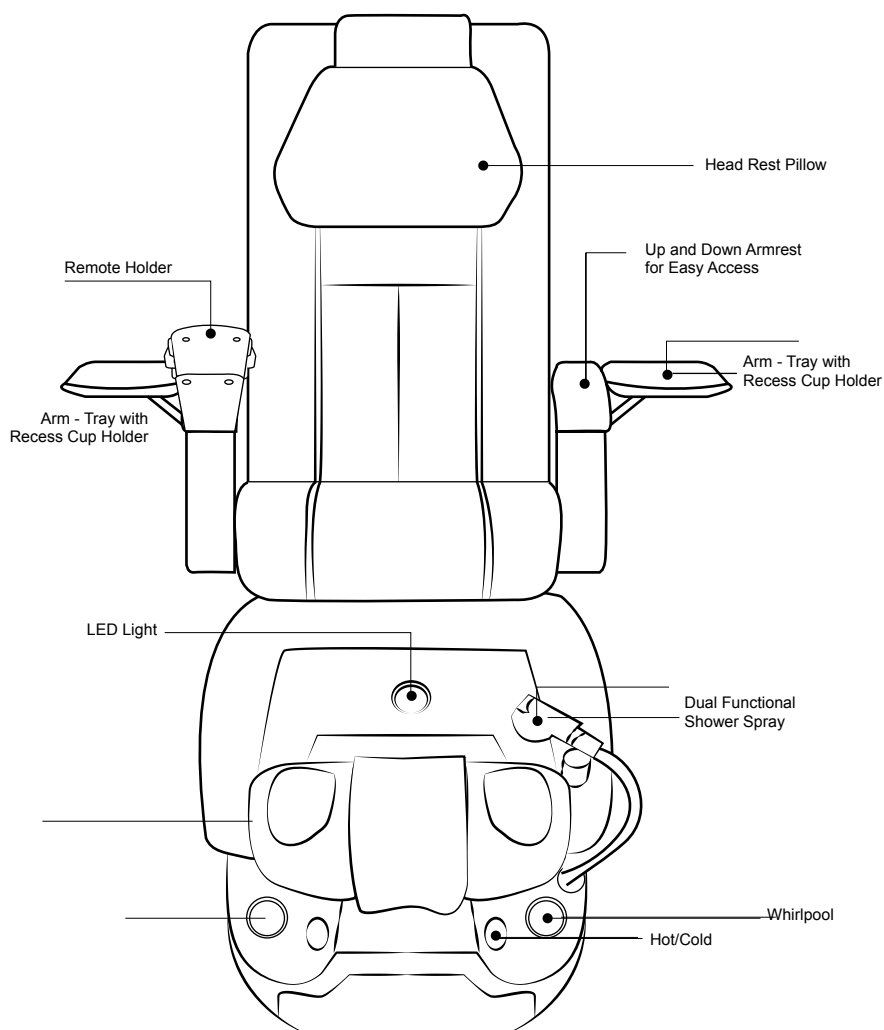

Rear View

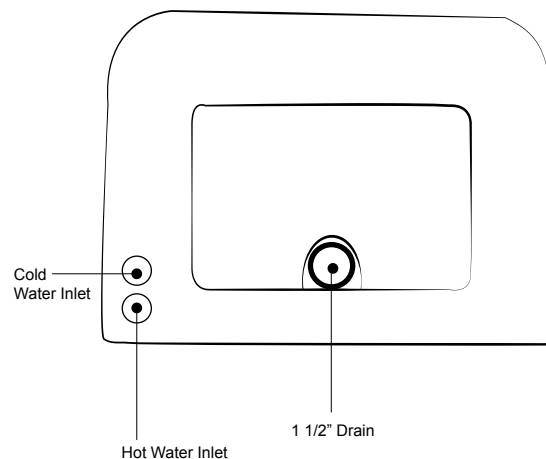

BASIN

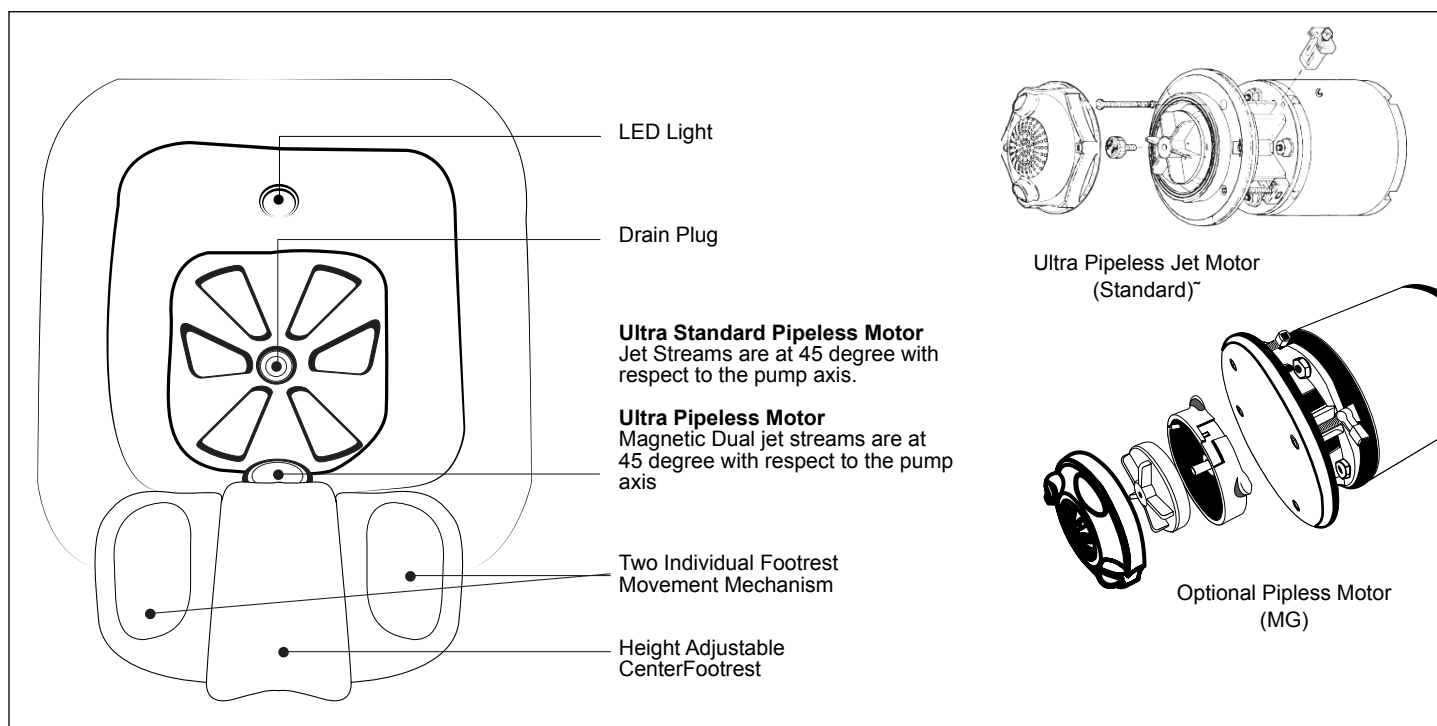

Empress RX: Dimension

Rear View

Wall drain outlet (1 1/2" PVC) Location/
Hot & Cold Inlet (1/2") Location

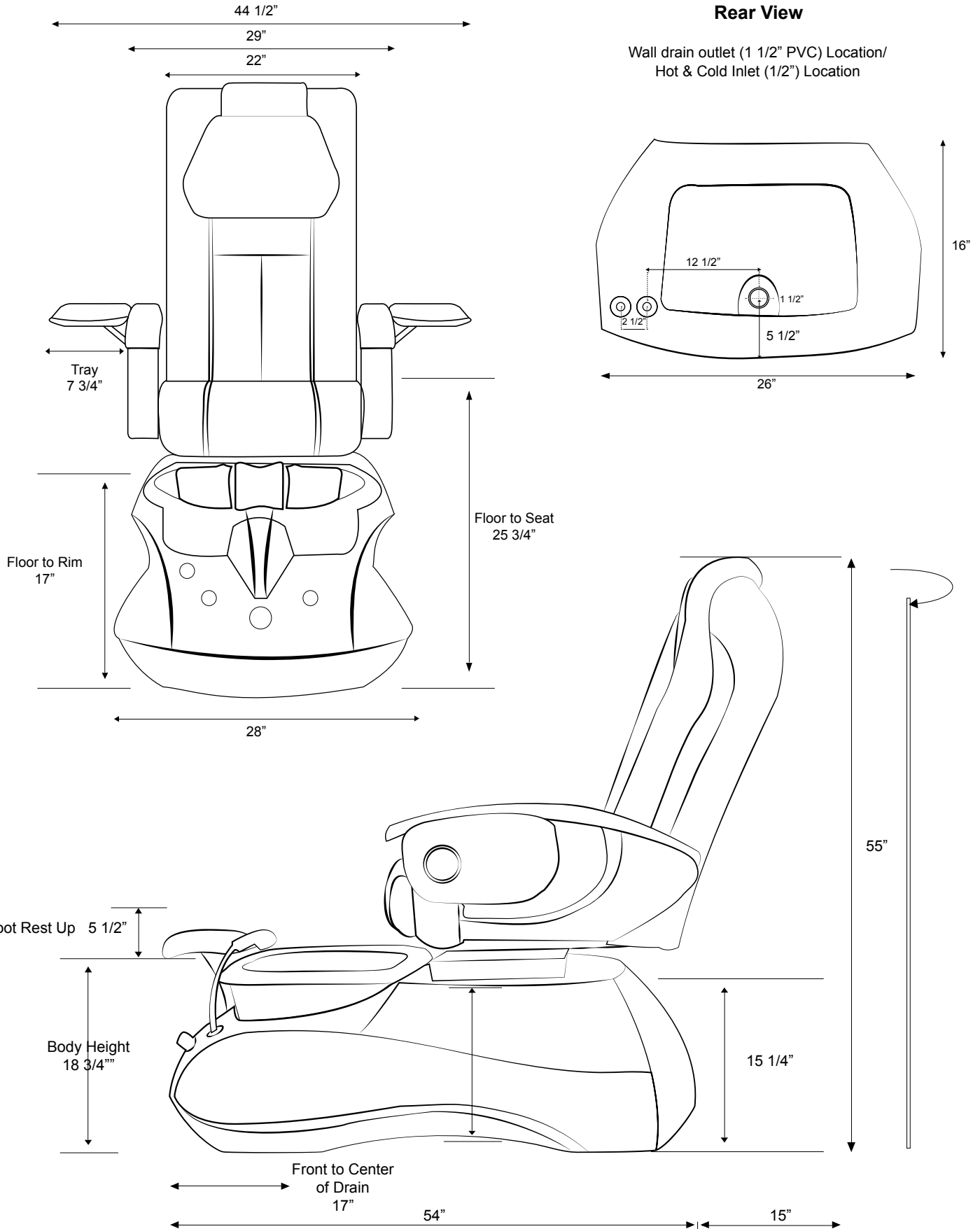

Empress LX: Dimension

Rear View

Wall drain outlet (1 1/2" PVC) Location/
Hot & Cold Inlet (1/2") Location

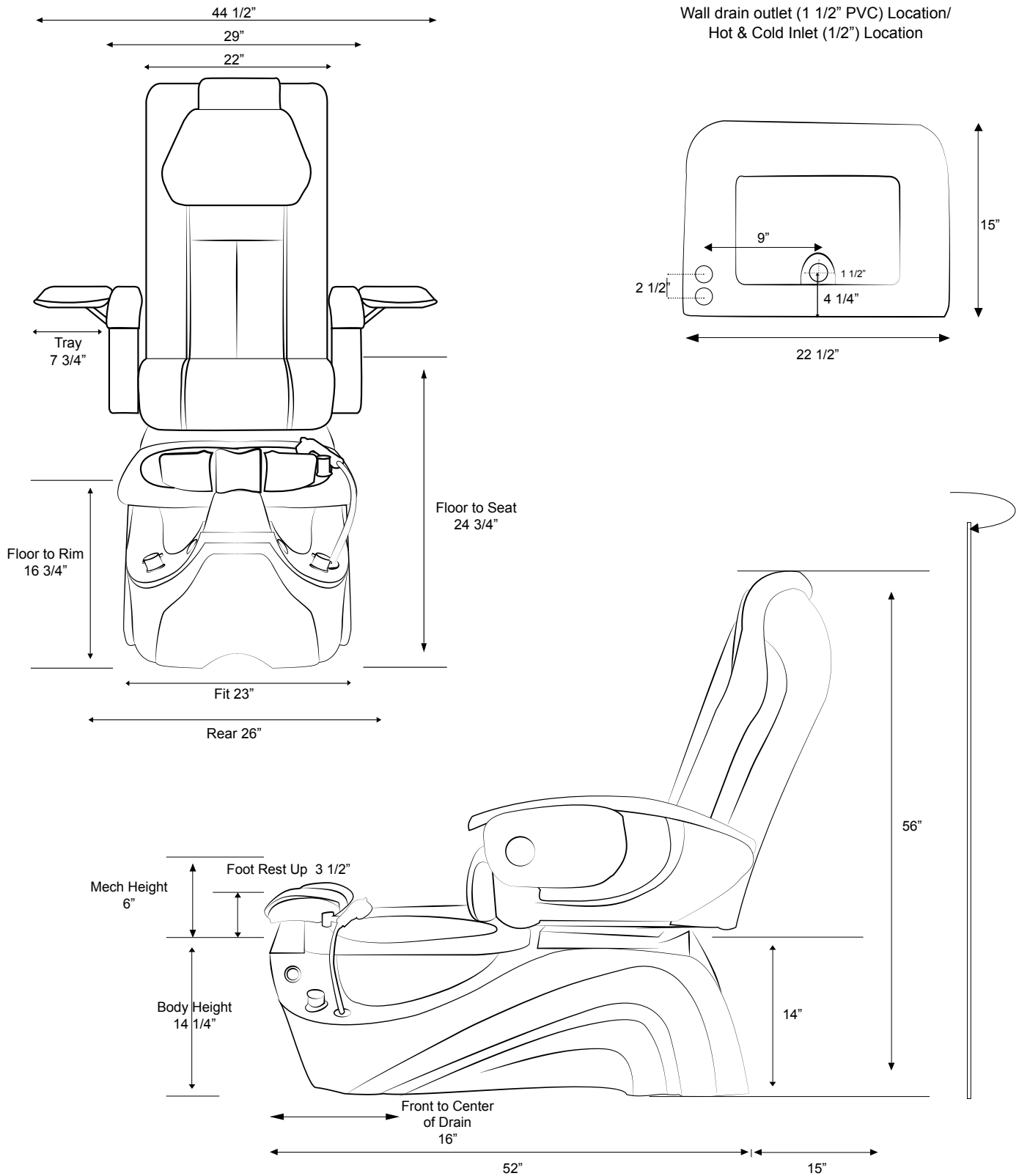

Empress RX: Drain

Wall Drain

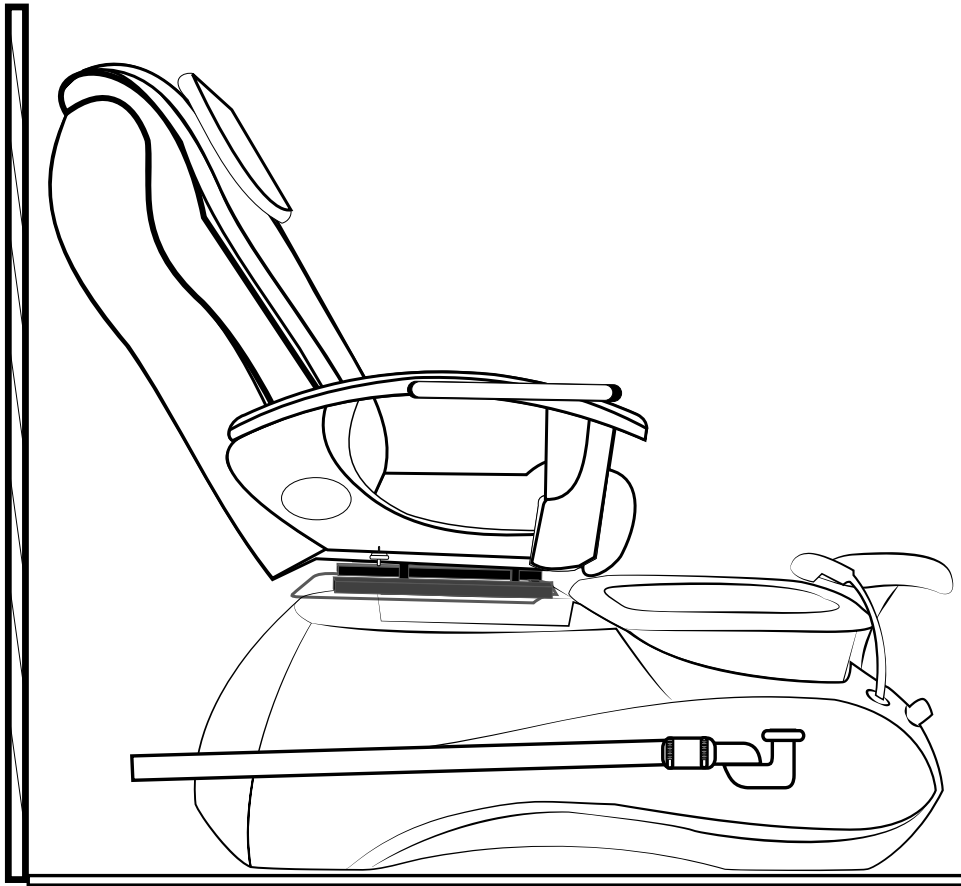

Power Drain
(See detailed power drain pump)

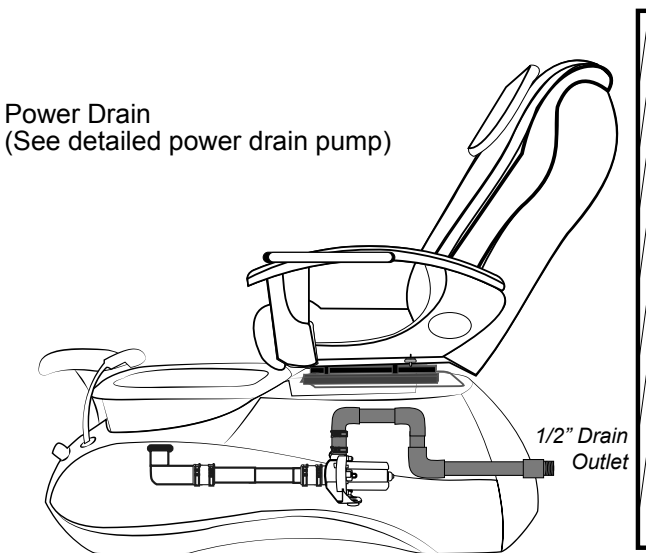

Basement Connection
(NOT recommended
on floor drain)

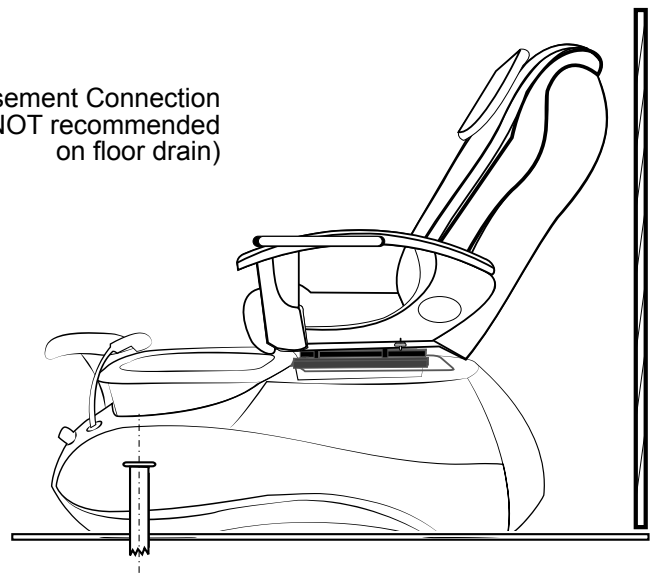

Empress LX: Drain

Wall Drain

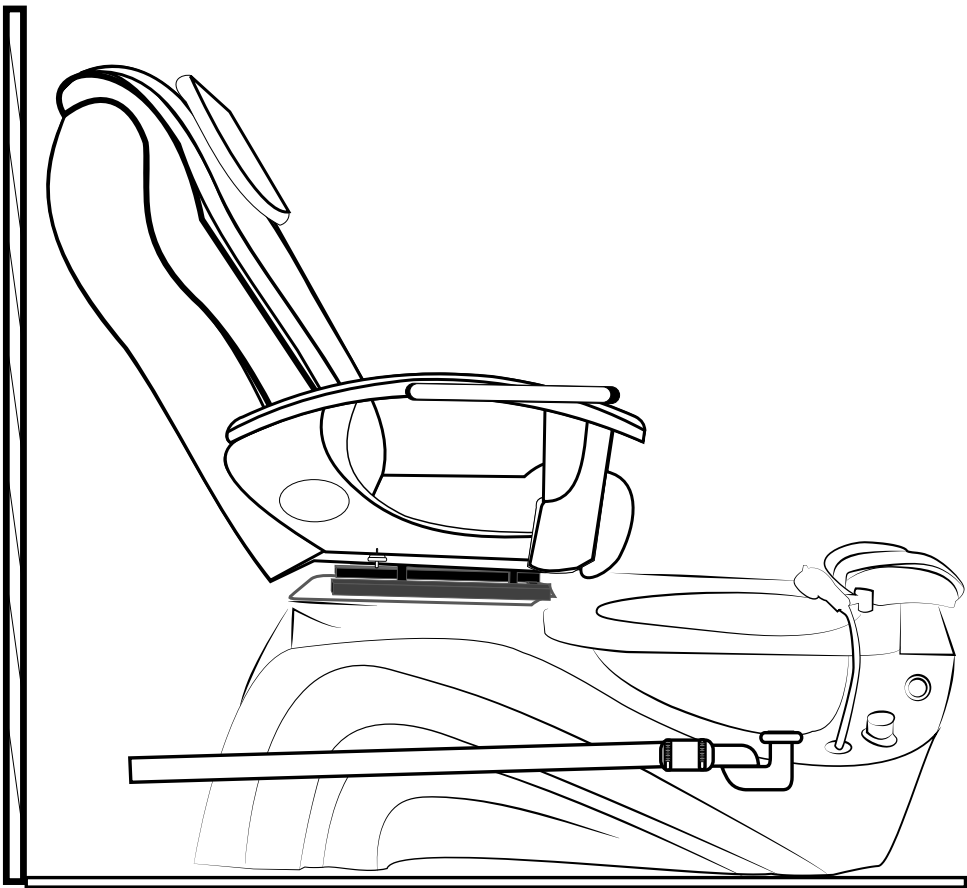

Power Drain
(See detailed power drain pump)

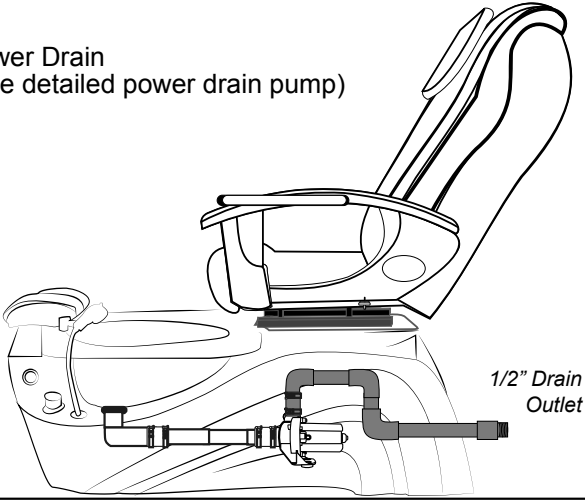

1/2" Drain
Outlet

Basement Connection
(NOT recommended
on floor drain)

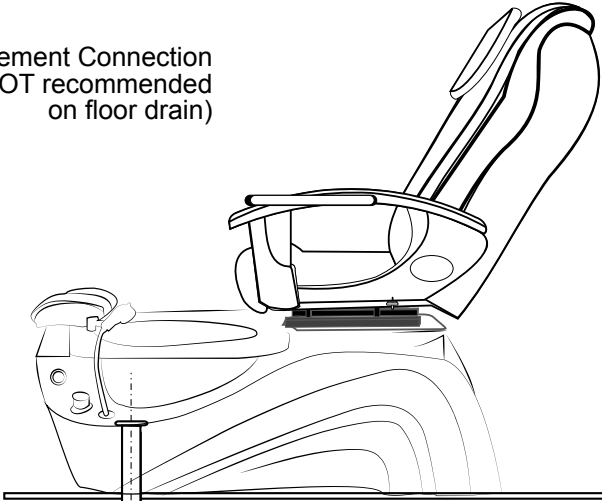

Empress RX: Discharge Pump (Optional)

Up to 4ft @ +/- 39 sec. with 1/2" Connection to main drain

Figure 1

1-3/8" Hole
for On/Off Switch

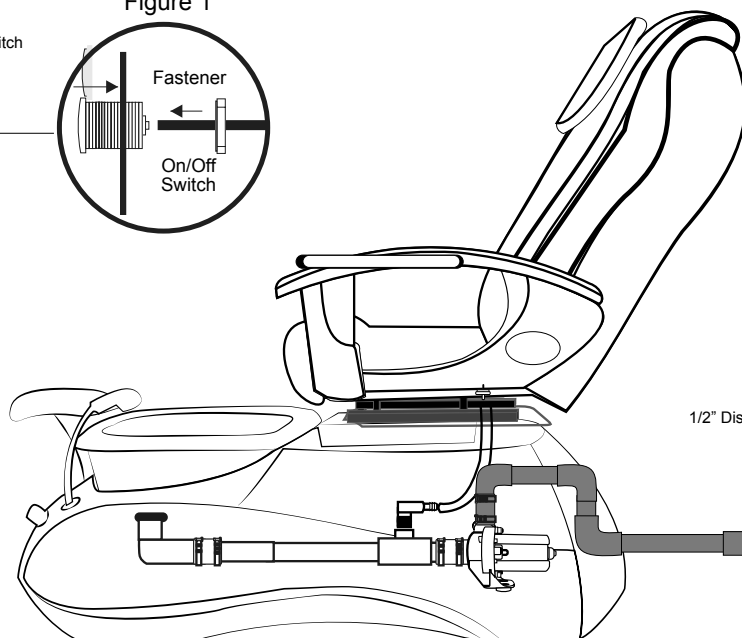
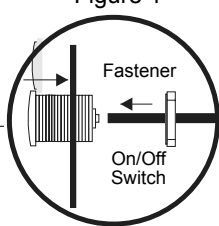

Max. Drainage Height: 4ft.

Drain outlet **MUST** be 1/2" or 3/4" for efficient drainage.

1/2" x 1/2" Brass
Check Valve Required

PLUMBER MUST BE UTILIZED TO INSTALL
CHECK VALVE AND UTILITY VALVE FOR HOT/COLD WATER

Figure 2

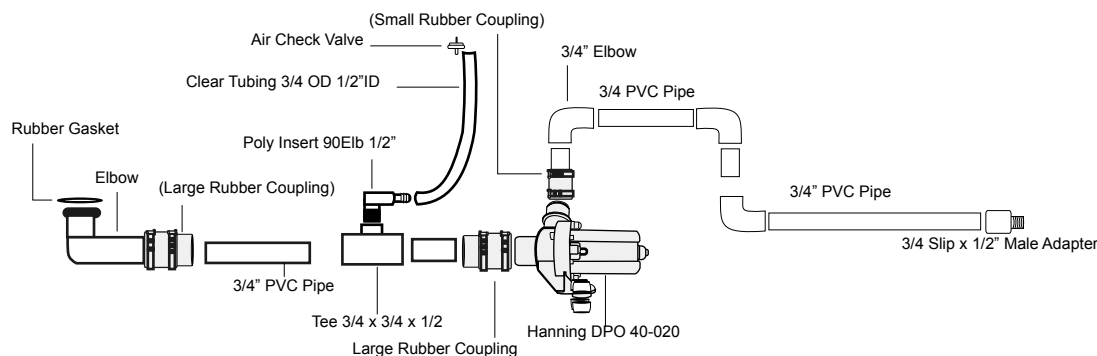

Installation Instruction:

1. Make a hole (size 1-3/8") for the On/Off switch as shown (see fig 1). Pre-drill required.
2. Placed a 1/8" clear hose into the rear of the switch and on/off switch into the hole.
3. The discharge pump kit is made to fit onto the pedicure unit. (See fig 2)
4. Connect E-Z connector onto the drain elbow.
5. Plug discharge pump outlet into the two minute timer outlet
6. Plug two minute timer into the wall outlet.
7. It is very important that tip of the clear tub remain above the water Level with one loop as shown.

Operation Instruction:

Warning ! DO NOT RUN DRY

1. Turn to open drain plug. 3 to 5 second for air to release from the pipe
2. Press On/Off switch to activate timer.
3. At any time, water drain completely from the basin. Press On/Off switch to stop or built in two minute timer.

Electrica 1 Contro 1 Box
(Located left bottom
inside of base)

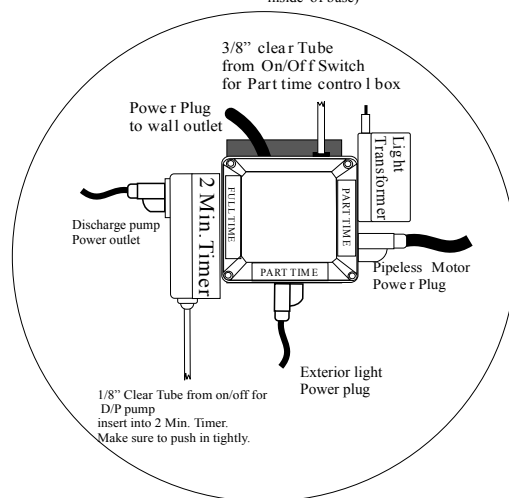

Empress LX: Discharge Pump (Optional)

Up to 4ft @ +/- 39 sec. with 1/2" Connection to main drain

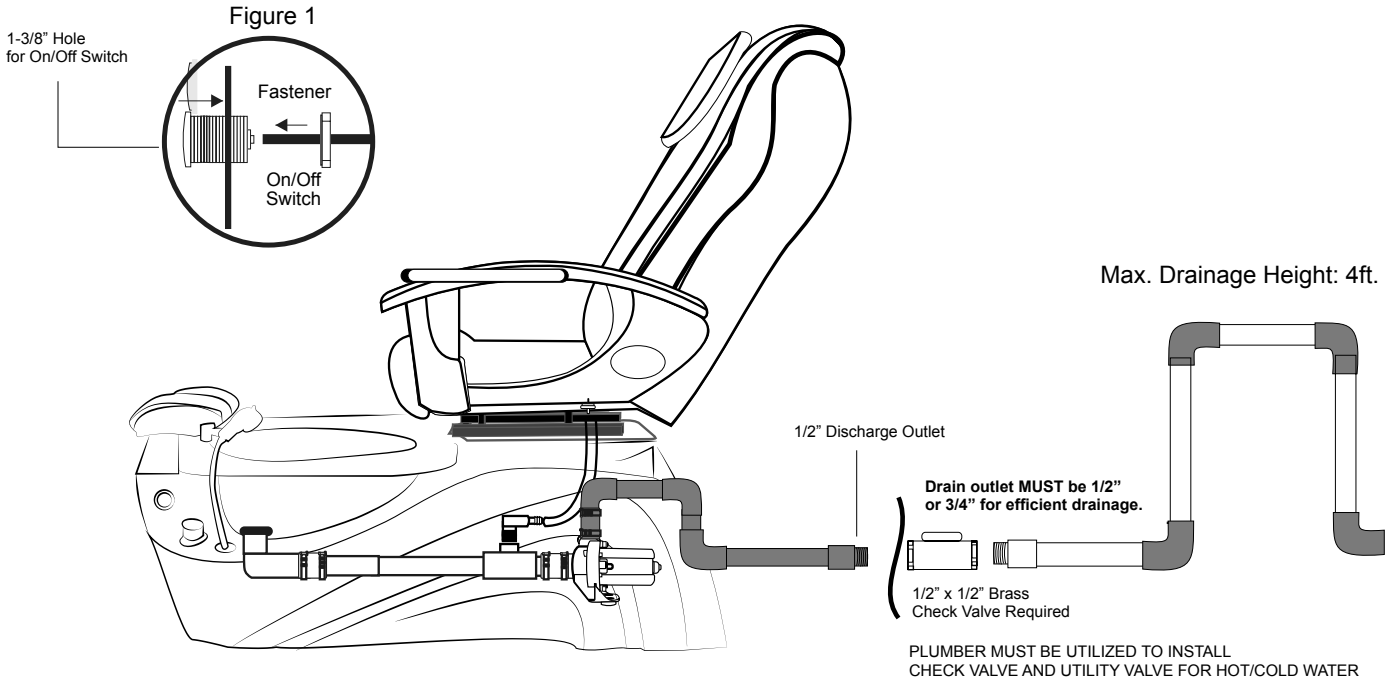
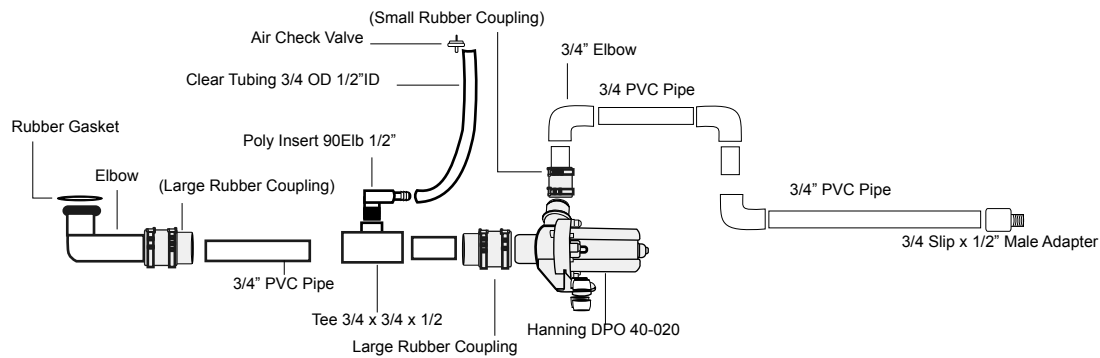

Figure 2



Installation Instruction:

1. Make a hole (size 1-3/8") for the On/Off switch as shown (see fig 1). Pre-drill required.
2. Placed a 1/8" clear hose into the rear of the switch and on/off switch into the hole.
3. The discharge pump kit is made to fit onto the pedicure unit. (See fig 2)
4. Connect E-Z connector onto the drain elbow.
5. Plug discharge pump outlet into the two minute timer outlet
6. Plug two minute timer into the wall outlet.
7. It is very important that tip of the clear tub remain above the water Level with one loop as shown.

Operation Instruction:

Warning ! DO NOT RUN DRY

1. Turn to open drain plug. 3 to 5 second for air to release from the pipe
2. Press On/Off switch to activate timer.
3. At any time, water drain completely from the basin. Press On/Off switch to stop or built in two minute timer.

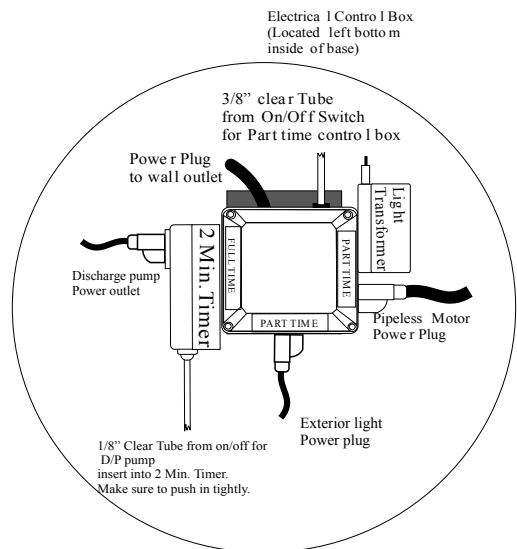

Ultra Jet Whirlpool Motor

Safety Instructions:

When using electrical equipment, basic safety precautions should always be followed to reduce the risk of fire, electrical shock, and injury to persons, including the following:

1. Read and follow all instructions before using the equipment.
2. Keep the cord out of heavy traffic area. To avoid fire hazard NEVER put the cord under the rugs, near heat generating devices.
3. Always turn off the equipment before servicing.
4. Do not drop or insert any object into any openings.
5. Do not operate any equipment with a damage parts.
6. Any other use not recommended by the manufacturer may electrical shock or injury to persons.
7. Never use outdoors
8. Do not attempt to repair or adjust any electrical or mechanical functions on the unit.

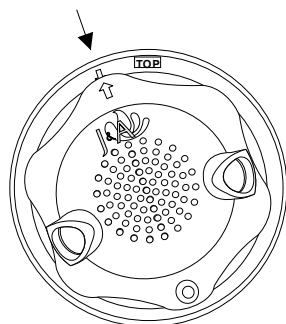

Close Jet Cover

1. Align an arrow line
2. Turn to right (Top indicated)

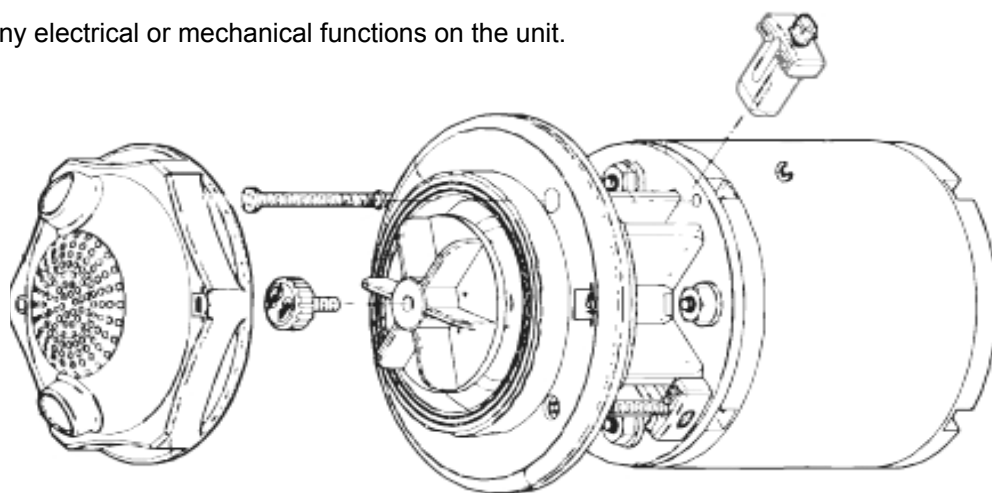
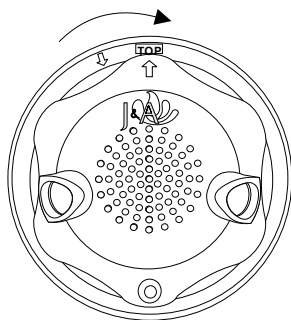

Features:

1. Dual powerful massage jet-streams
2. Jet assembly can be attached from the pump for quick cleaning and sanitizing.
3. Thermally Protected
4. AC motor (long life)
5. Extremely low power consumption .

Cleaning Instruction:

1. Turn the unit off and wait until the motor is fully stops.
2. Remove the front jet cover and notice the locking screw in the center
3. Remove the locking center screw (Indicated an Arrow) and pull out impeller from housing.
4. Use Anti-Bacterial solution (EPA Registered) to clean all part/s.
5. After sanitation, place impeller onto the motor shaft and fasten with center locking screw (Opposite arrow)

Ultra Pipeless Jet Whirlpool Motor Specifications:

Model: CS-0216A-MT

Rating: 120VAC / 60Hz, 0.4A - thermally Protected

Pump: Dual whirlpool Jet Flow

Mounting: Single 3.5" hole Diameter

Auto tighten Mounting screws(4)

Magna-Jet (Optional)

Safety Instructions:

When using electrical equipment, Basic safety precautions must be followed to reduce the risk of fire, electrical shock, and injury to Persons.

1. Read and follow all instructions before using the equipment.
2. Keep electrical cord out of heavy traffic area. To avoid fire hazard NEVER place electrical cord under the rug, near heat Generating devices.
3. Always turn power off the equipment before service.
4. Do not drop or insert any object into any openings.
5. Do not operate any equipment with damaged parts.
6. Any other use not recommended by the manufacturer may cause electrical shock or cause injury to person/s.
7. Never use it outdoors
8. Do not attempt to repair or adjust any electrical or mechanical.

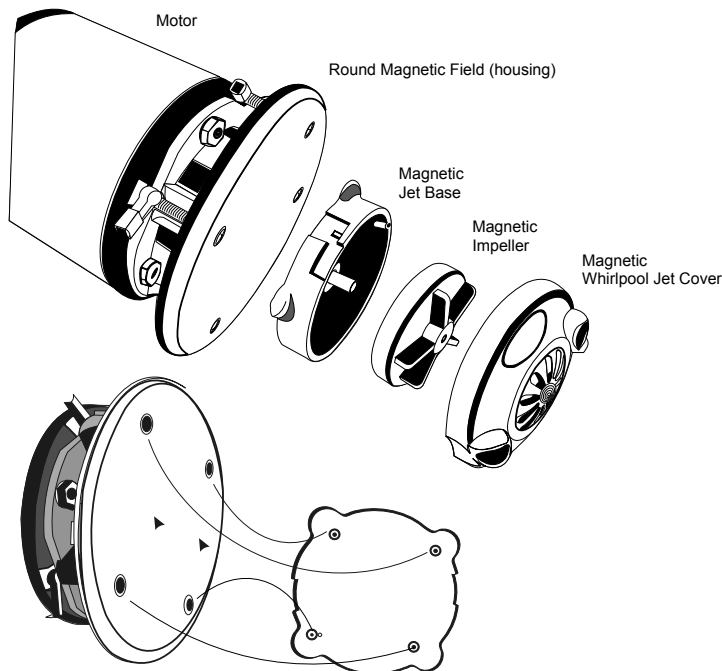

MAGNA JET Features:

1. Hydro dual massage jet stream
2. Magnetic whirlpool jet cover can be remove for quick cleaning and sanitizing.
3. Built-In electronic sensor for pump control.
4. AC Whirlpool motor (long life)
5. Very low power consumption (27W)
6. Manufactured in USA.

Cleaning Instruction:

1. Turn off the unit and wait until the motor is fully stops.
2. Hold hydro whirlpool jet cover firmly and pull to separate from the round magnetic field.
3. Turn hydro whirlpool jet cover to left to open and pull out impeller.
4. Use Anti - Bacterial solution (EPA Registered) to clean all parts.
5. After sanitize all parts, place impeller and close hydro whirlpool jet cover to turn right to lock
6. Hold firmly the whirlpool cover jet and gently place it onto the round magnetic field. Do not release the hydro whirlpool jet cover until jet cover is on the round magnetic housing.

MAGNA-JET Specifications:

Model:MAGNA-JET-120 VAC, 60HZ, 1.0Amp

Pump: Hydro-Massage Dual Air Jet Flow

Mounting: Single 3.5" Hole Diameter Auto Tighten Mounting Screws(4)

How to USE Magnetic Jet!

WARNING: DO NOT RUN DRY, BASIN MUST FILLED WITH WATER TO LEVEL INDICATOR.

CAUTION: MAGNETIC JET COVER ASSEMBLY MUST ALIGN WITH DISCHARGE PORT POSITIONED AT 3/9 O'CLOCK.

When Ready to use, **MAKE** sure jet cover is positioned at 3/9 O'clock for proper whirlpool action in the basin. If jet cover is not align at 3/9 O'clock, water will splash outside of the basin.



Proper way to use Magnetic Jet System:

1. Fill the water to water level indicator.
2. Hold Magnetic Jet firmly to bring closer to the round magnetic field and do not release the Magnetic Jet prematurely or this will cause impacts on the jet cover and the round magnetic field(housing) shortening the life expectancy of the jet cover. When the jet cover nears the round magnetic field, place jet cover onto the four dimple area (see diagram). The jet cover must align with discharge ports positioned at 3/9 O'clock.
3. When finished with client, DO NOT remove Magnetic Jet until motor is fully stopped.
4. When motor is fully stopped, remove Magnetic Jet cover from the motor and remove jet cover and impeller for sanitation.

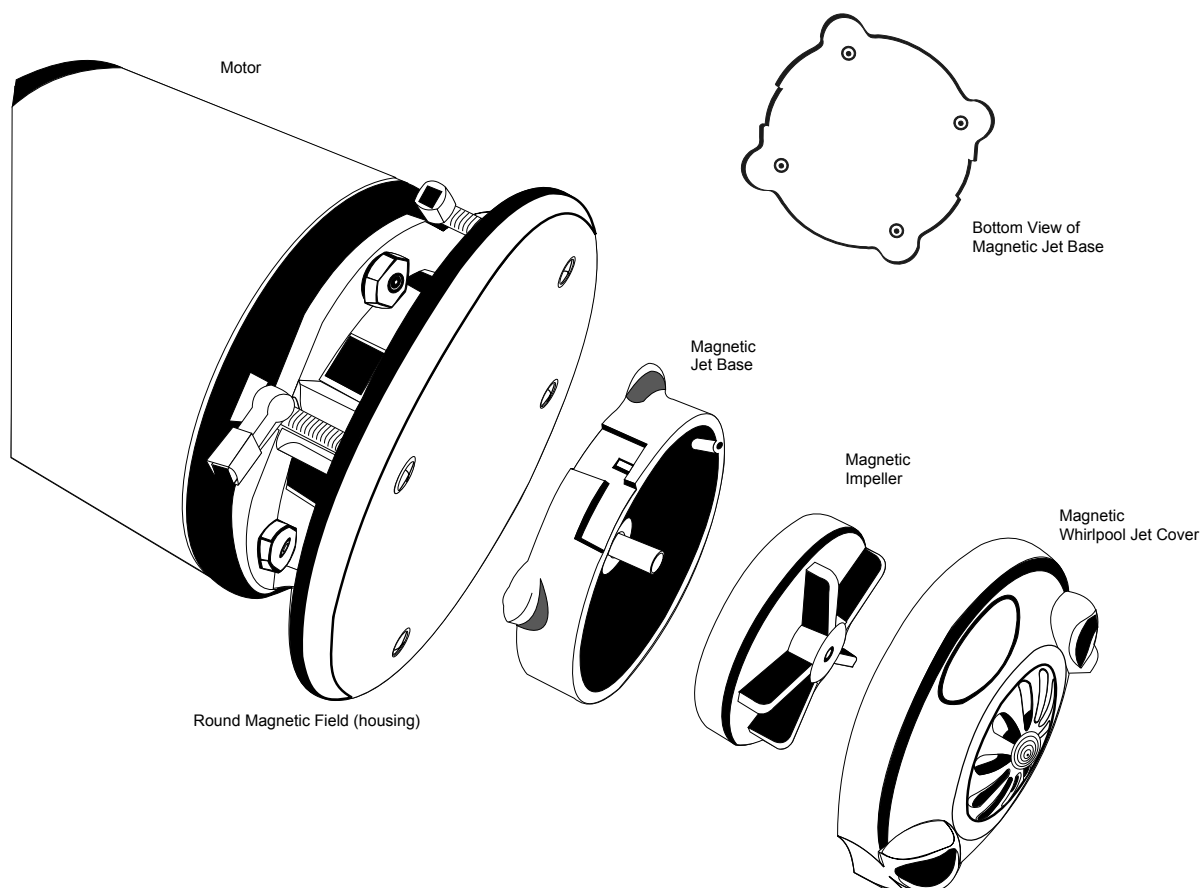

Auto Fill System (Optional)

Feature & Operation

- Automatic spa fills with intelligent and reliable level sensor.
- Time delay setting
- Dual switched outlets/ Control box
- Dual continuous outlets
- Single drain pump controlled outlet with 3 minute timer (If drain pump requested as an option)
- Heavy duty water valve
- Operated in automatic or manual mode
- Built in LED light power supply
- Audible overflow warning in manual fill mode

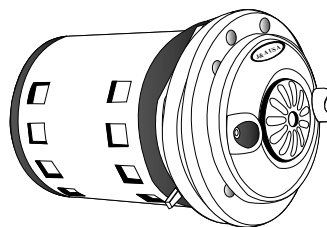

Dura Jet III Built-in Electrodes Water Sensor

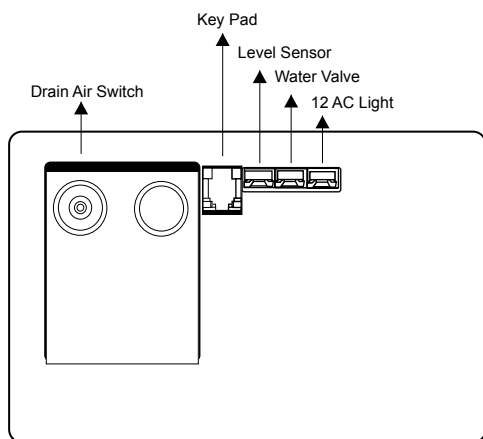
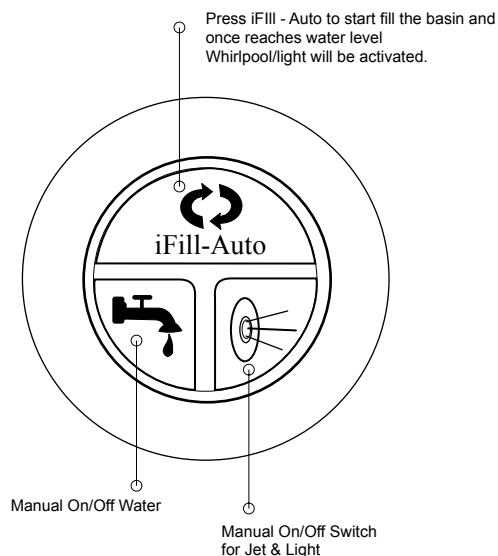
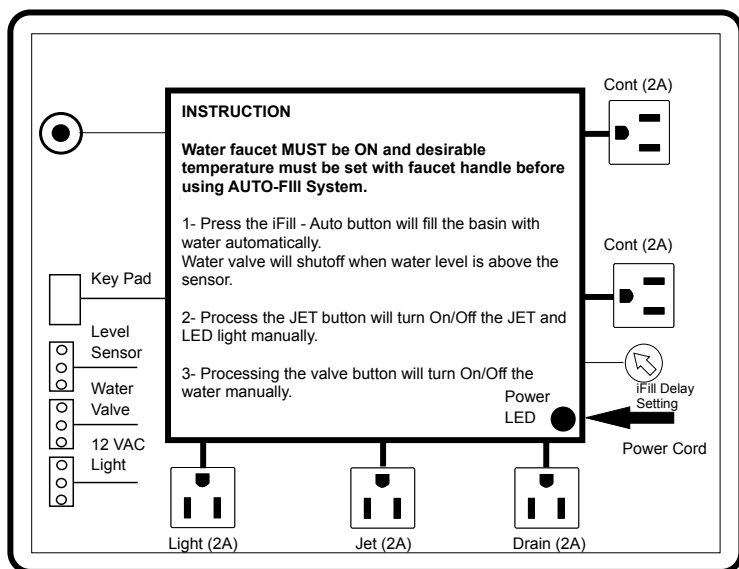

ALL WIRES ARE INDICATED AS IT SHOWN

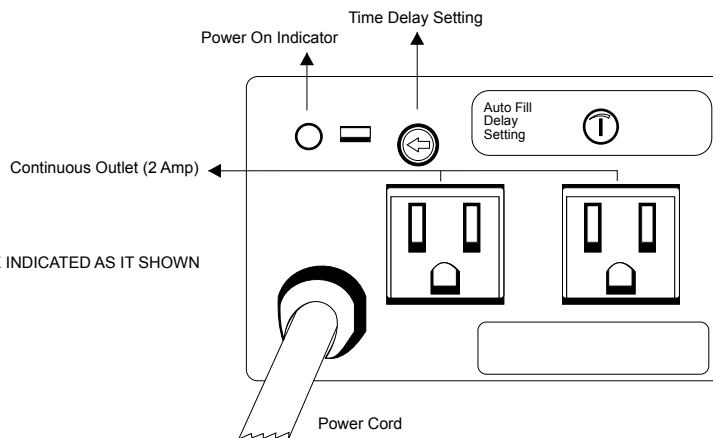

Placing Backrest in Correct Position

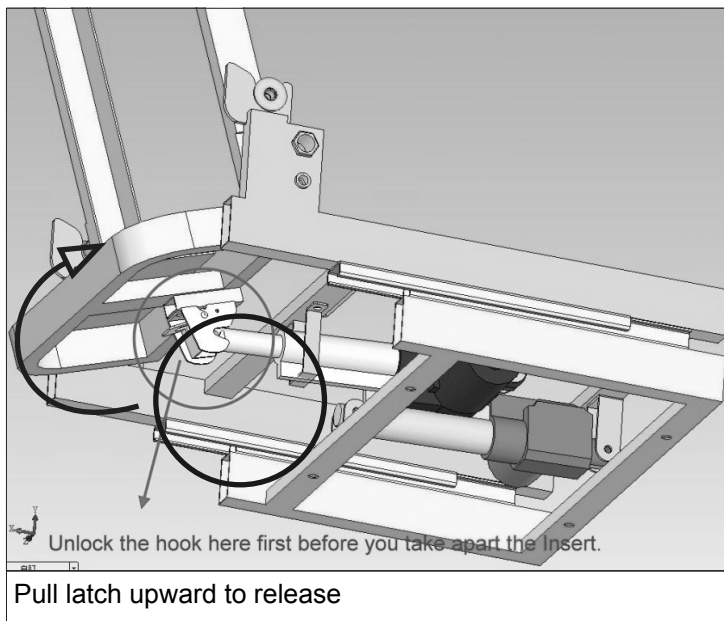

Detachment of Backrest

- Pull latch lever upward to release from recliner piston.
- As arrow indicates, bring backrest to fold onto the seat.
- Disconnect all cables (recliner, slider).

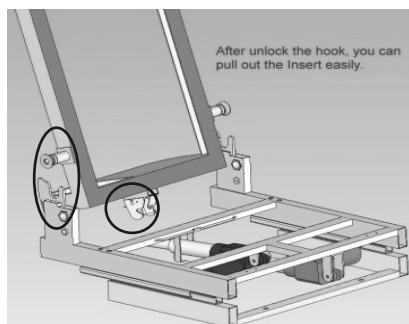

Attachment of Backrest

- On the lower portion of both side of the backrest, there are pivots.
- Align both pivots correctly so they rest perfectly onto the "U" pivot frame.
- Once both pivots sit snugly on the "U" pivot frame, align the release latch with the recliner piston and snap close.

Unlock the hook by pressing latch from recliner piston to pull out insert

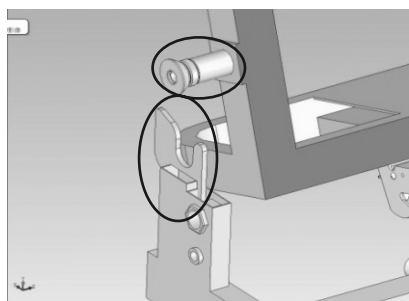

Before operating the chair upon attachment, check following items to ensure proper operation

Figure 1: Shows pivot and "U" pivot frame at correct alignment/ be sure to clear wire

Figure 2: Close-up view of pivot and "U" pivot frame.

Figure 3: Shows correct pivot alignment.

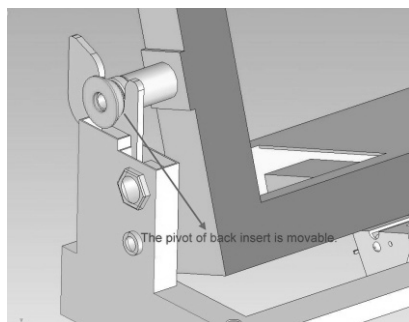

The pivot of back insert is removable

Empress LX/RX: Remote Control Functions

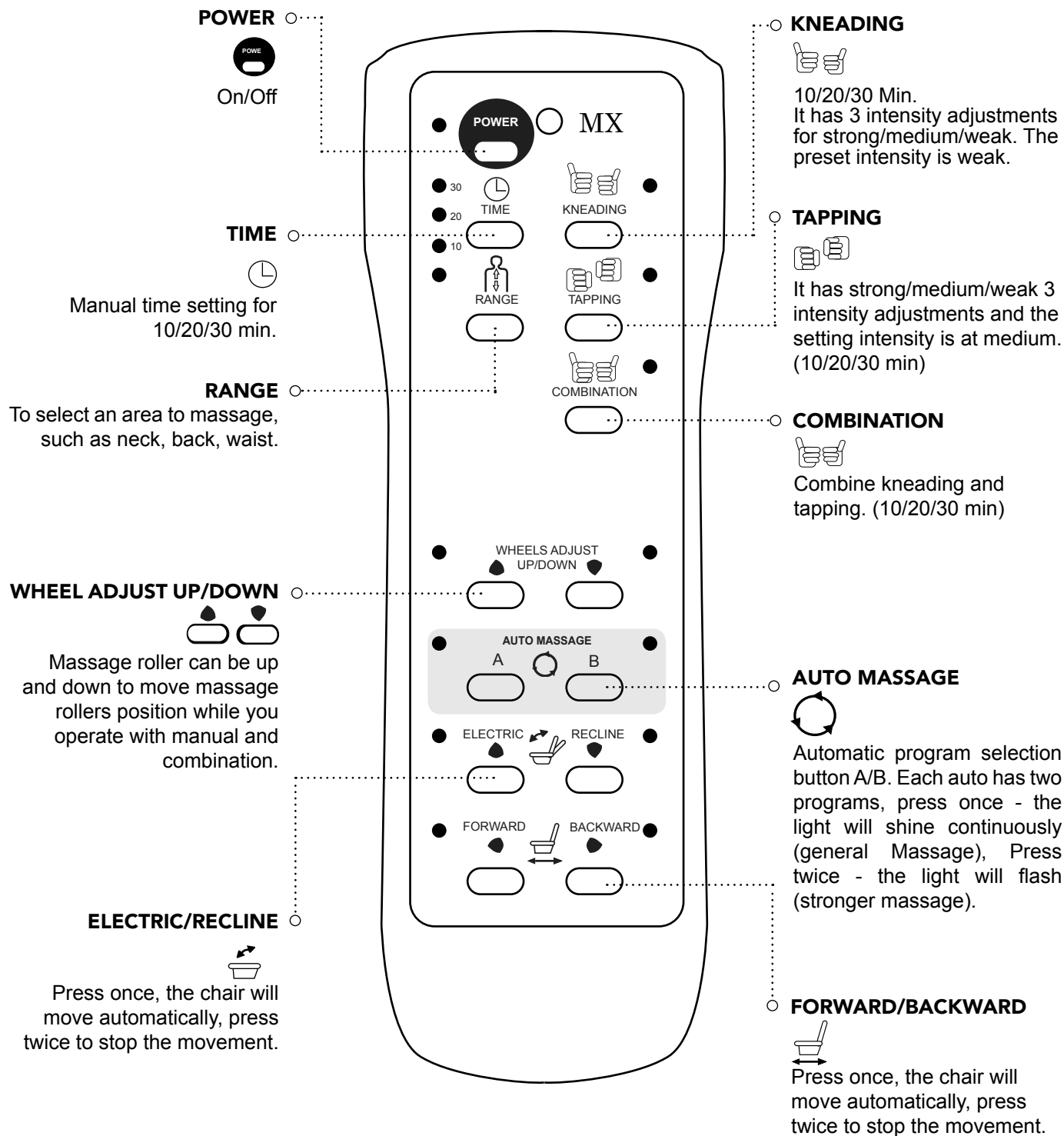

Empress LX/RX: Remote Holder Assembly

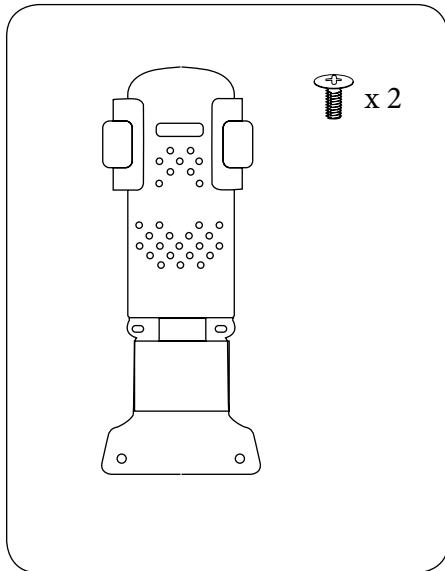

*Content

- a) Remote Holder
- b) 2 phillip x screws

1.

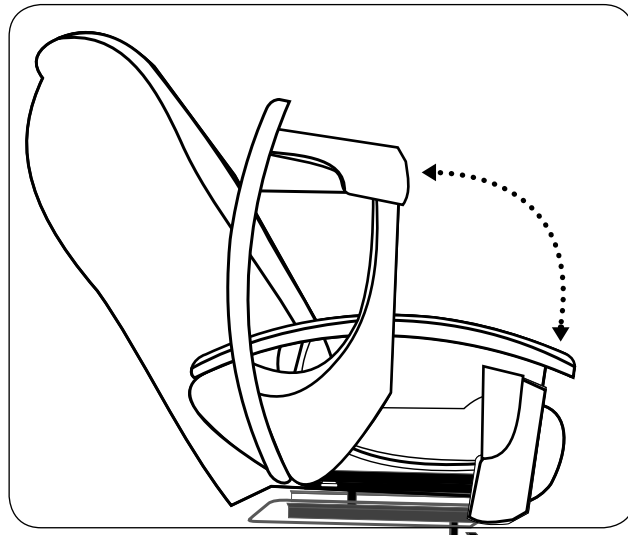

Lift ArmRest (lift from Front)

2.

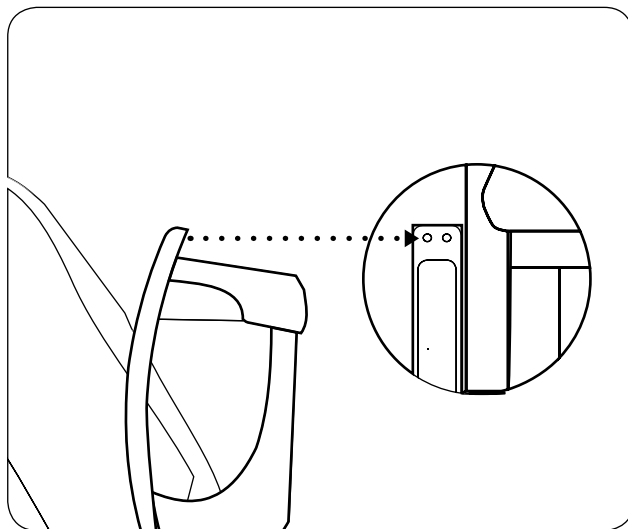

Note of front embedded nut for remote as shown.

3.

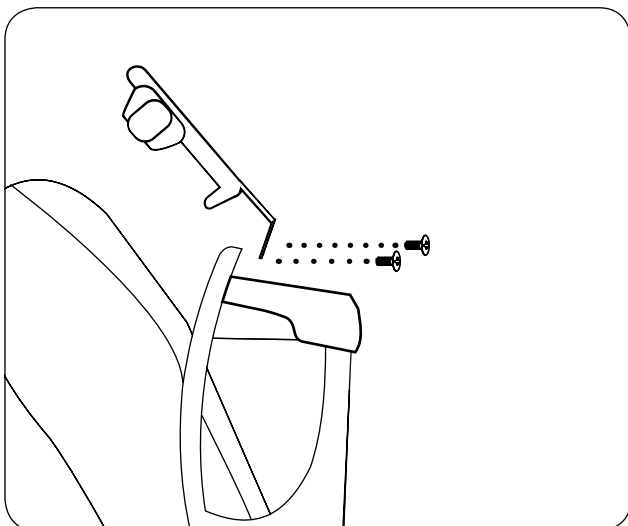

Placed remote holder(as shown) and align with embedded nuts screw in one at a time.

Empress LX/RX: Footrest Assembly

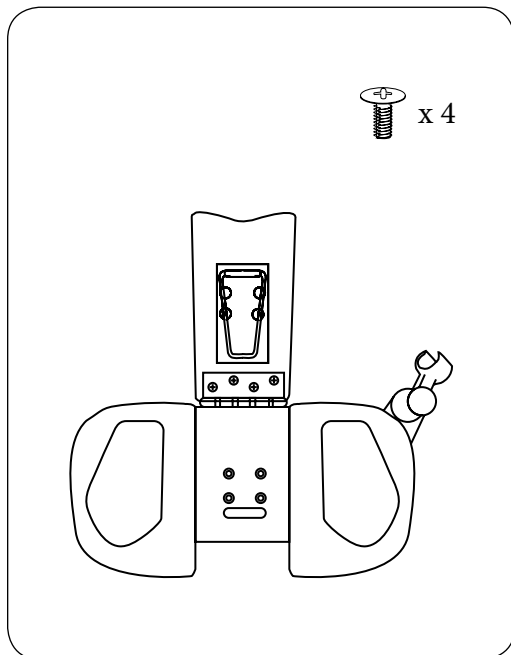

*Content

- a) Pre- Assembled Footrest mechanism & Cushion with shower holder
- b) 2 phillip x screws

1.

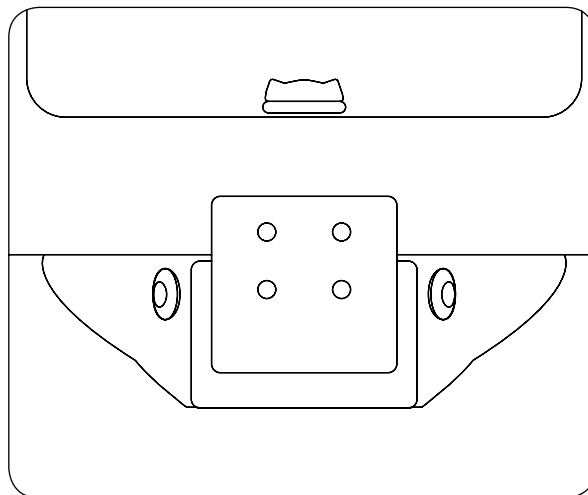

Remove 4 philips screw from FootRest stand.

2.

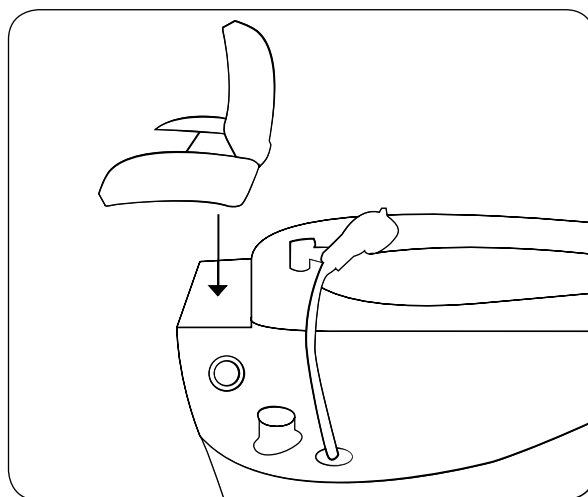

Placed Pre-Assembled on top of Footrest stand: Align 4 holes.

3.

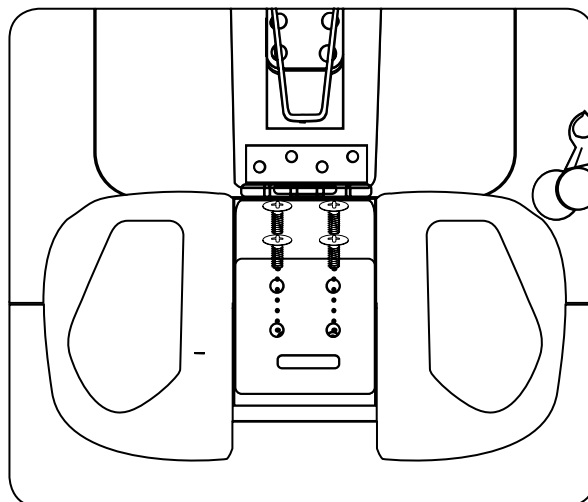

Screw in one at a time(Don't tight) All screws in place

4.

Rotate shower holder(Top should be larger than Bottom)

EMPRESS
**Back Flow Protection Device
(Dual Check Valve)**

May.1.2014

In accordance with applicable Local or State regulations,
Empress, The manufacturer of the pedicure whirlpool spa certifies that all models are
equipped with factory installed Dual Check Valve back flow protection:

****EMPRESS**

The specification of the installed device is as follows:

DEVICE NAME	DUAL CHECK VALVE BACKFLOW PROTECTION
DEVICE MANUFACTURER	NEOPERL INC. Waterbury CT.
DEVICE MODEL	Dual Check Valve 1/2" x 1/2"NPT
DEVICE SPECIFICATION	TESTED AND CERTIFIED TO MEET NSF/ASSI 61 Complies with ANSI/ASME A112.18.3M, A112.18.1M AND CSA B125
DEVICE PRESSURE	MAXIMUM PRESSURE: 150 PSI (10 BAR) SERVICE PRESSURE : 80 PSI
DEVICE TEMPERATURE	MAXIMUM TEMPERATURE : 150F SERVICE TEMPERATURE : 90F

ALL MODELS OF PEDICURE SPA MENTIONED ABOVE ARE EQUIPPED WITH THE SUBJECT DEVICE
AS STANDARD FEATURE. As for your information, indicated State requires Vacuum Breaker.

**** Effective April 01 2005:**

ARIZONA, CALIFORNIA, NEBRASKA, NEVADA, OREGON,
TEXAS AND WASHINGTON

**** Effective June 15 2005:**

ILLINOIS, MINNESOTA, WISCONSIN, MICHIGAN

**** Effective May 01 2007:**

CONNECTICUT

For additional information, Please contact us at 631-243-5300

Very Truly yours,

Technical Support

EMPRESS

335 Crooked Hill Road
Brentwood, NY 11717
Tel: 631.243.3336
Fax: 631.243.3339

empresspedichair.com