

# PETRA

COLLECTION  
OWNER'S MANUAL



pedicure  
spas

## **Table of Contents**

Table of Contents

Introduction & Safety

Important Consideration

Identify Parts & Description

Specification (Petra 900, Petra RMX)

Dimension & Installation

Installation Summary

Maintenance ( GeniJet)

Maintenance (Magna-Jet (OPTIONAL)

Maintenance (Dura Jet III)

Discharge Pump

Chair / Backrest Attachment

Disinfecting Pedicure spa

User Recommendation

UL Certificate

Back Flow Prevention Device

Warranty



## Introduction

Thank you for purchasing the **PETRA** Whirlpool Pedicure Spa. This finest Whirlpool Pedicure Spa has been developed by J&A USA,inc. To operate dependably for many years when used properly. Please take time to read this manual thoroughly before installation and use.

## PLEASE READ AND FOLLOW INSTRUCTIONS CAREFULLY!

### Important Precautions

J&A USA requires that you contact your local, qualified electrician and plumber to install your **PETRA** Whirlpool Pedicure Spa. It cannot operate efficiently or safely unless it is provided with adequate electrical power, sufficient water pressure, proper water temperature and required drain facilities. Information on these important subject contained on this manual. We urge you to read it carefully to make sure these requirements are met.

### Precautions

1. Excessive water temperature is dangerous and should be checked before use. Maximum water temperature should Not exceed 100 degree F (38 degree C.).
2. Always enter and exit the whirlpool Pedicure Spa slowly and carefully.
3. Never bring and/or operate any electrical devices into or near the Whirlpool Pedicure Spa.
4. Do not stand in the Whirlpool tub!
5. This Whirlpool Pedicure Spa has a weight capacity of 250 lbs.

## WARNING

Do not use if you are diabetic, have poor blood circulation, or if any area of your feet or legs are inflamed or have open wounds. Consult a physician before using if you have any kind of fungal infection, swelling, fracture, or persistent pain.

MASSAGE SHOULD BE PLEASANT AND COMFORTABLE.

IF YOU EXPERIENCE PAIN OR DISCOMFORT, DISCONTINUE USE IMMEDIATELY AND CONSULT A PHYSICIAN

This product in whole is in compliance with applicable  
UL LISTED standards and requirements for the U.S and Canada  
By Underwriters Laboratories Inc.



Some of the components of this product are  
Also in compliance with applicable  
Safety standards of following:



# Important Considerations

## Electrical Service

110V, 60Hz, 15Amp GFCI protected grounded circuit **MUST** be used to supply power each individual pedicure spa. And the main circuit breaker **MUST** be at 25Amp. For maximum of two units per each electrical outlet.

## Water Supply

All plumbing connections must conform to local codes.

Water supply to the spa should be provided with adequate water pressure and water temperature.

## Water pressure

To fill the basin correctly up to level, Normal water pressure of 30 to 80 P.S.I is required.

## Water temperature

The hot water supply temperature must not exceed 140°. Adjust your hot water accordingly. For hot and cold water supply fittings and drain fittings location, see below diagram .Carefully connect the water supply line to the appropriate fittings located on the rear of the pedicure spa.

## Pressure / Temperature

Maximum Pressure: 150 psi (10 bars)

Minimum Pressure: 10 psi (69kPa)

Working Temperature: 33F to 140F constant; intermittent to 180f  
(0.6C to 60C sustained; intermittent to 82.2C)

Maximum Recommended Flow: 15gpm (57lpm)

## Backflow Preventive Device

All pedicure spas are pre-installed with Dual Back flow Preventive Device for the following state; AZ, CA, CT, IL, MI, MN, NE, NV, OR, TX, WA, and WI.

## Specification

Tested and certified to meet ANSI/ASSE standard 1024. CSA certified to standard No.B64.6

ANSI - American National Institute, ASME - American Society of Mechanical Engineers, CSA - Canadian Standard Association IAPMO - International Association of Plumbing and Mechanical Officials, UL - Underwriters Laboratory

## **\*\* All other state**

As an option, the dual check flow preventer will be factory installed.

- Inquired with governing authorities for local installation requirement.

## Drain Facilities

The pedicure spa Drain must meet local plumbing codes. **Check valve for Drain (not Provided) Must be installed by a licensed plumber.** Also Pedicure spa must be securely fasten to the floor.

## Installation Summary

The installation must comply with local, state, and federal building, plumbing and electrical codes, where applicable. A licensed plumber should complete the plumbing of the pedicure spa.

Note: Failure to comply with federal, state, or local codes and ordinances will result in warranty being nullified and void.



**PETRA**  
**Identify parts on Petra series**

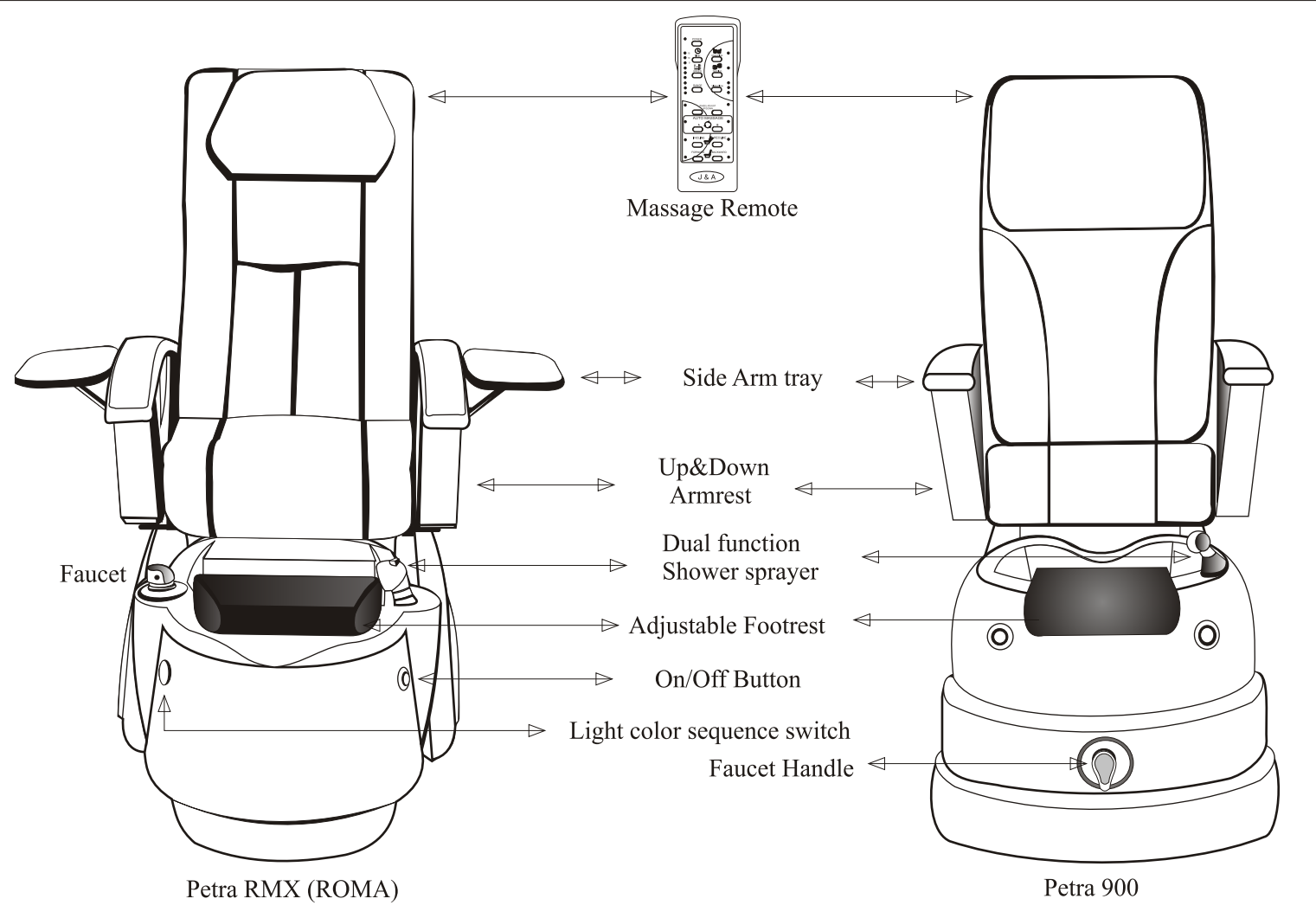

**BASIN**

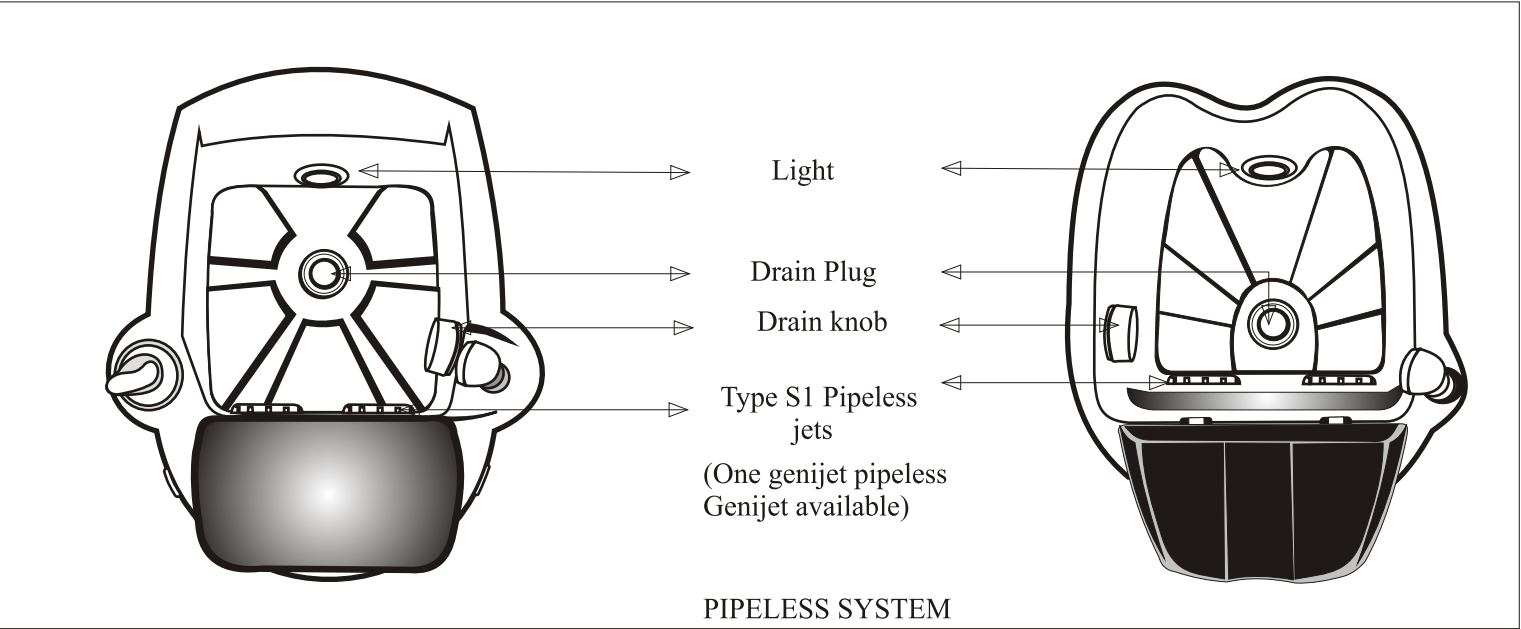

Due to the continuous improvement on all our products: Specification, characteristics, packing, colors, designs are subject to change without notice.

Technical drawing of a toilet showing dimensions and labels. The drawing includes the following dimensions and labels:

- Dimensions:**
  - Overall height: 55
  - Height to top of tank: 24
  - Height to top of bowl:  $17\frac{1}{2}$
  - Overall width: 57
  - Distance from floor to center of bowl: 43
  - Distance from center of bowl to wall: 14
  - Distance from floor to bottom of bowl:  $5\frac{3}{4}$
  - Distance from floor to top of bowl:  $7\frac{3}{4}$
- Labels:**
  - FLOOR
  - WALL
  - 1 ½ PVC EXTENSION DRAINAGE

## Spa Information

**CAUTION: Pedicure spa must be installed by a licensed electrician and a licensed plumber, conforming to all local and national electrical codes.**

Due to the policy of continuous improvements, all specifications are subject to change without notice. All dimensions and weights are approximate

## **Petra RMX (ROMA)**

### **Specification**

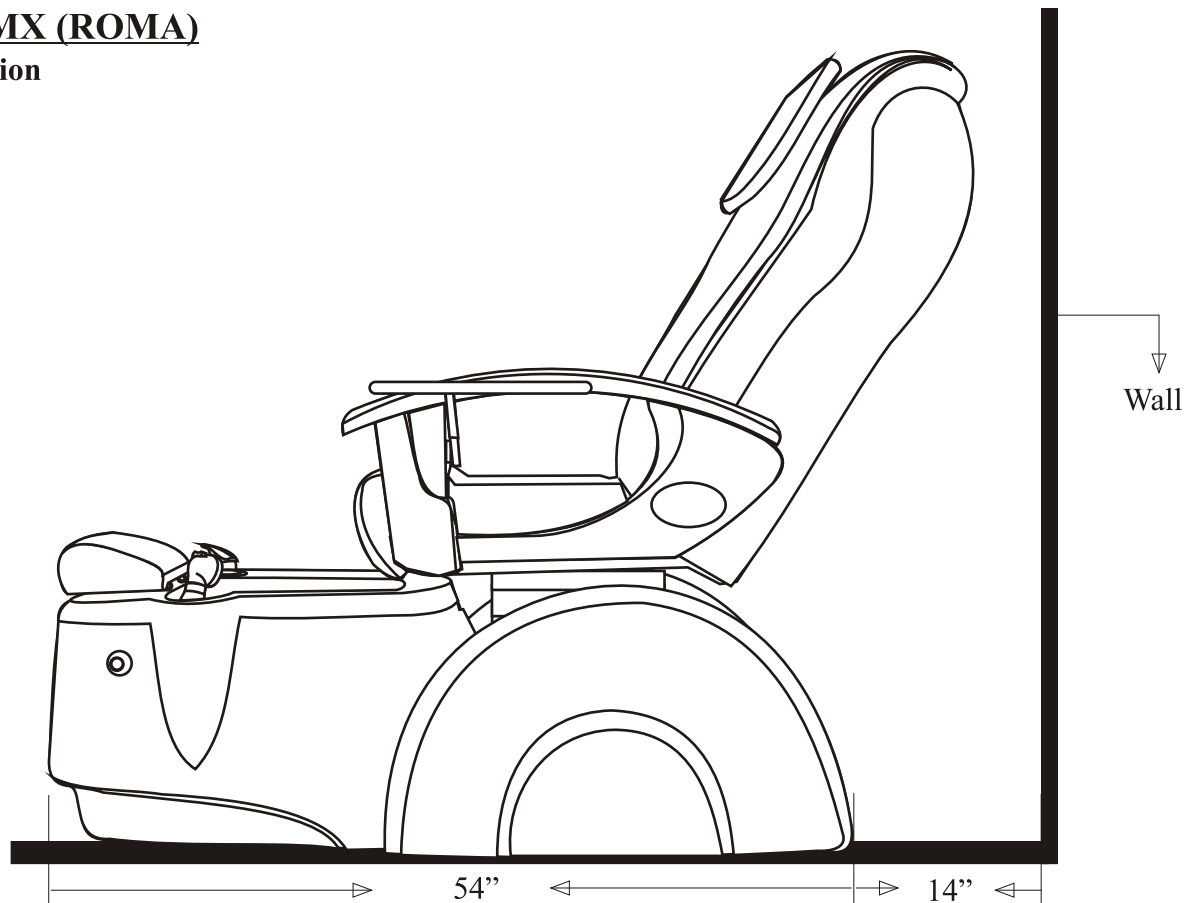

Hot and Cold water supply lines are required with utility shut off valve installed by licensed plumber.

Drain installation : Unit has pre assembled drain pipe (1 1/4" P-Trap with 1 1/2" PVC extension drainage.

**CAUTION: Pedicure Spa MUST be installed by a licensed electrician and a licensed plumber, conforming to all local and national electrical codes.**

### **Spa Information**

Overall Dimensions : 54"L x 29"W x 55"H (54"L x 43.5"W x 55"H when both trays are opened)

Weight

Water Capacity: 4.5 U.S Gallon

Pipeless whirlpool motor 110V 60Hz

Upholstery: Polyurethane

Recline, Back & forward motor: 24v ; 13 inches of space between pedicure spa and wall

Optional discharge Pump: 115V, 3.2A, 60Hz

Optional Check valve: WATT 3/8 7.7C and 3/4, H7, H7C (tested and certified to meet ANSI/ASSE standard 1024

### **Construction**

Lucite Acrylic shells and fiberglass to reinforced

Pipeless Technology : Two strong pipeless motor, 100% fully Drained, easy to clean & sanitize

Electrical switches: Air activate On/Off switch, a single hand held low voltage remote control for massage system

Limited Warranty: One year from date of shipment. Labor is not included

**Due to continuous improvements on all our products, specification, characteristics, packing, color, designs are subject to change without notice.**

Petra - RMX

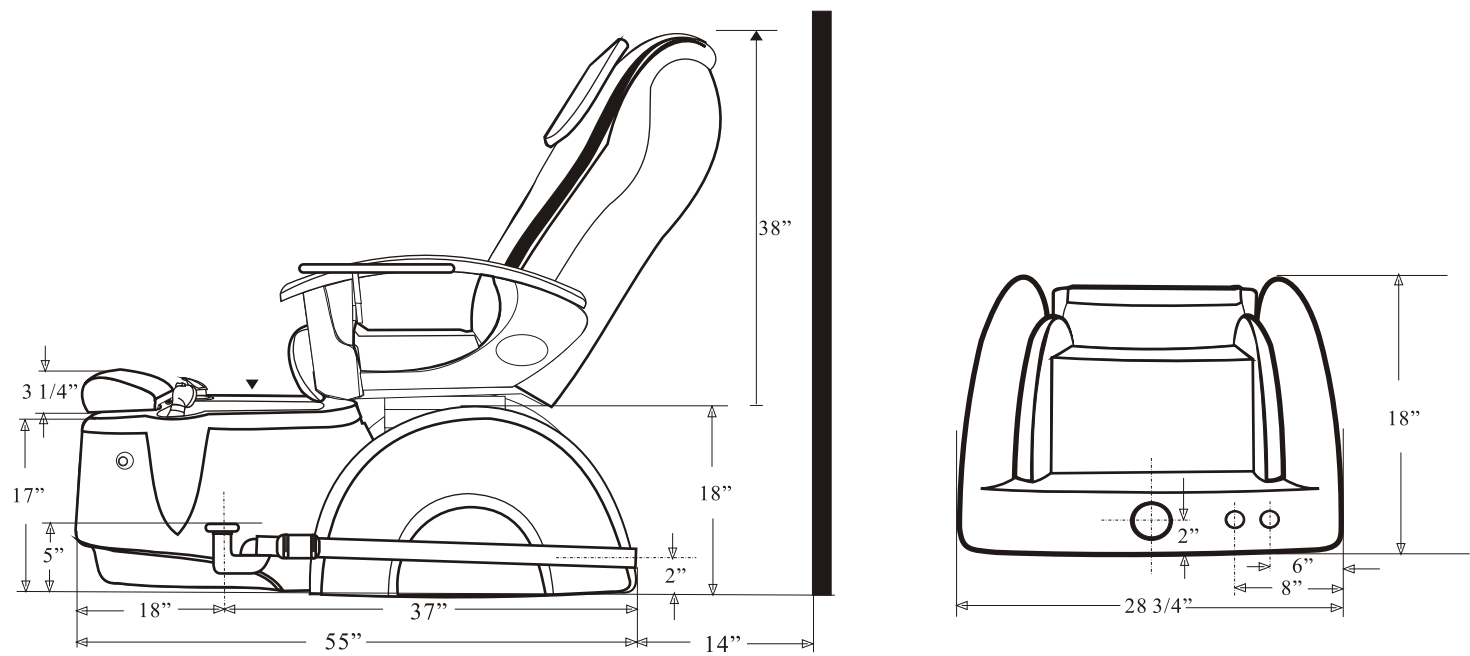

Petra 900

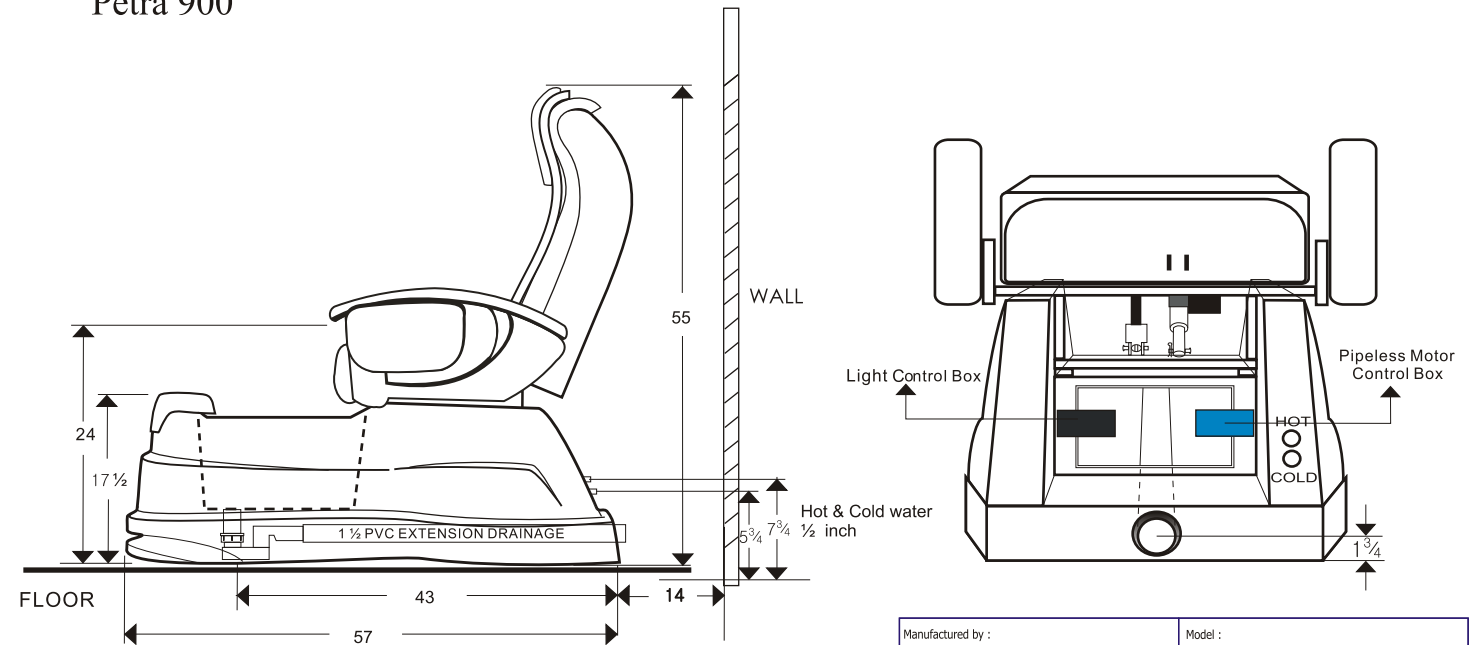

Manufactured by :	Model :
J&A USA Inc.,	Petra 900 / Petra RMX
Dimensions:	Prepared by :
Rear/Side	J&A USA Inc.

## DRAIN

### Back Flow Prevention Device (Dual Check Valve)

#### Specification

Device Name Dual Check Valve Backflow Preventor  
Device MFG WATTS Regulator Company / North Andover, MA  
Device Model WATTS 3/8 7, 7C and 3/4 H7, H7C  
Device Spec. ANSI/ASSE Standard 1024 & 1032, CSA Certified NO.B64.6  
Device Pressure Max, minimum pressure 150 psi. - 10 psi, Recommended Flow 10 gpm  
Device Temp. 33F - 144F Consistent; Intermittent to 180F

Pedicure spa is/are equipped with the subject device as standard feature, sold to following state

Effective April 01 2005: AZ, CA, NE, NV, OR, TX and WA

Effective June 15 2005: IL, MN, WI and MI

Effective May 01 2007: CT

Petra - RMX

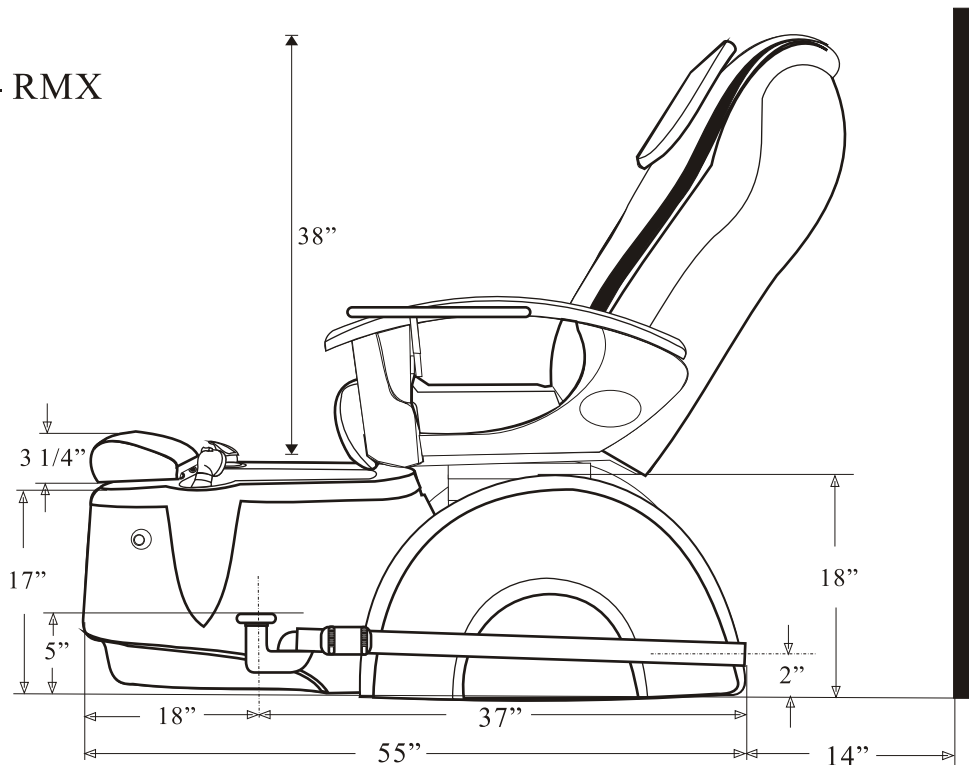

Petra 900

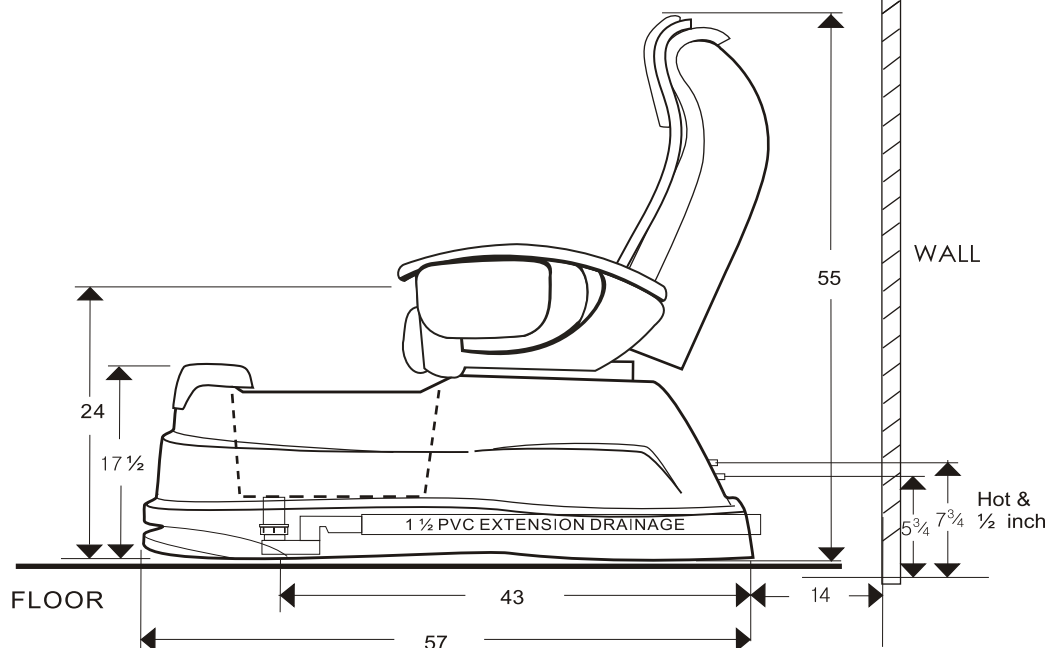

## Installation Specifications Summary

**Warning:** Failure to comply with federal, state or local codes and ordinances will result in warranty being null and void.

As stated, the pedicure spa installation must comply with all plumbing and electrical codes. A licensed plumber and licensed electrician must complete the applicable connections of the pedicure spa.

### Location and support

Select a level location. The floor structure beneath the pedicure spa must be capable of supporting the occupied pedicure spa.

For the seat back to fully recline, the pedicure spa base must be mounted as follow from the wall as shown below:

\*\*\* When chair slide all the way back – would require 15 inches from the wall\*\*\*

\*\*\* When chair slide in the middle – would require 13 inches from the wall\*\*\*

\*\*\* When chair slide all the way to the front – would require 12 inches from the wall\*\*\*

**Above measurement are based on with back cushion is all the way reclined**

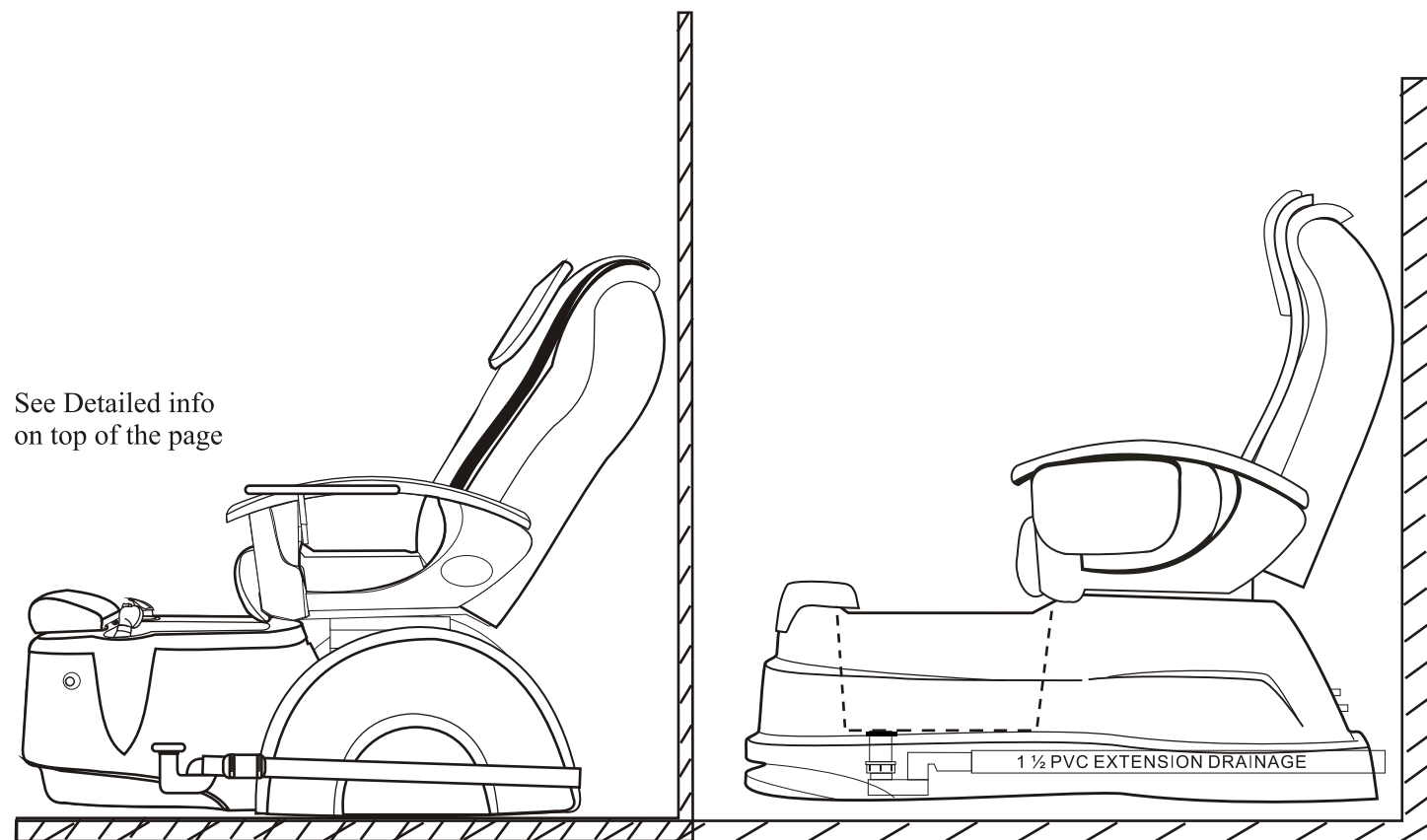

Due to continuous improvements on all our products, specification, characteristics, packing, color, designs are subject to change without notice.

# Genieye Pipe-Less Motor ( Petra “PL” model)

## Dimensions

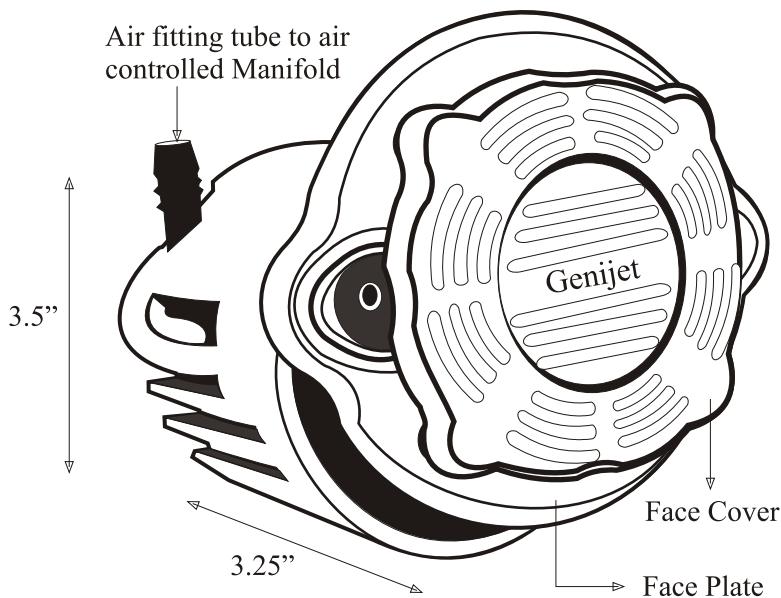

## Genijet™ Cleaning Procedure

- 1- Gently turn the cover counter clockwise to remove it.
- 2- Use anti-bacterial soap or a solution of 3% hydrogen peroxide to wipe inner chamber. DO NOT use chlorine or chlorinated products (such as diluted bleach) as this will damage the plastics and VOID your warranty.
- 3- Clean air supply line by gently sliding a “Q-tip” (dipped in 3% hydrogen peroxide) into air canal.
- 4- Replace the cover by gently turning it clockwise until snug (no need to over tighten).

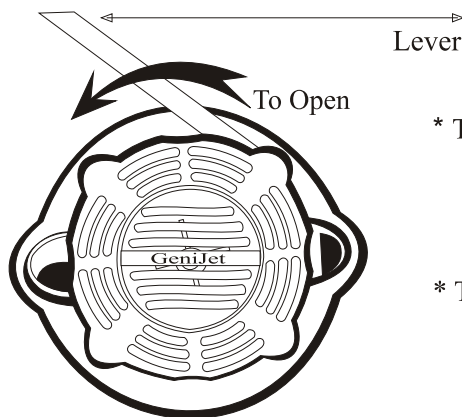

\* To open - Place lever into position as shown  
Gently turn over to counter clockwise to remove cover.

\* To close - Align face cover over to face plate  
and gently turning it clockwise  
until snug.

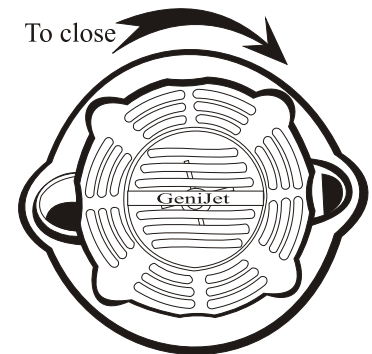

## Specifications:

Model: Genijet™ Motor - 1.2amp @ 120 VAC; 60 Hz; 55W (GFI Receptacle)  
0.1 Hp @ 3600 Hp Magnetically coupled motor

Pump: Dual jet flow with adjustable air low  
White premium grade ABS house with removable jet cover

Mounting: Single 3.5" hole  
Auto tightening mounting screws

All component are certified by ETL, UL, C, E, CSA.

## **MAGNA-JET (OPTIONAL)**

### **Safety Instructions**

**When using electrical equipment, Basic safety precautions must be followed to reduce the risk of fire, electrical shock, and injury to Persons.**

1. Read and follow all instructions before using the equipment.
2. Keep electrical cord out of heavy traffic area. To avoid fire hazard NEVER place electrical cord under the rug, near heat Generating devices.
3. Always turn power off the equipment before service.
4. Do not drop or insert any object into any openings.
5. Do not operate any equipment with damaged parts.
6. Any other use not recommended by the manufacturer may cause electrical shock or cause injury to person/s.
7. Never use it outdoors
8. Do not attempt to repair or adjust any electrical or mechanical.

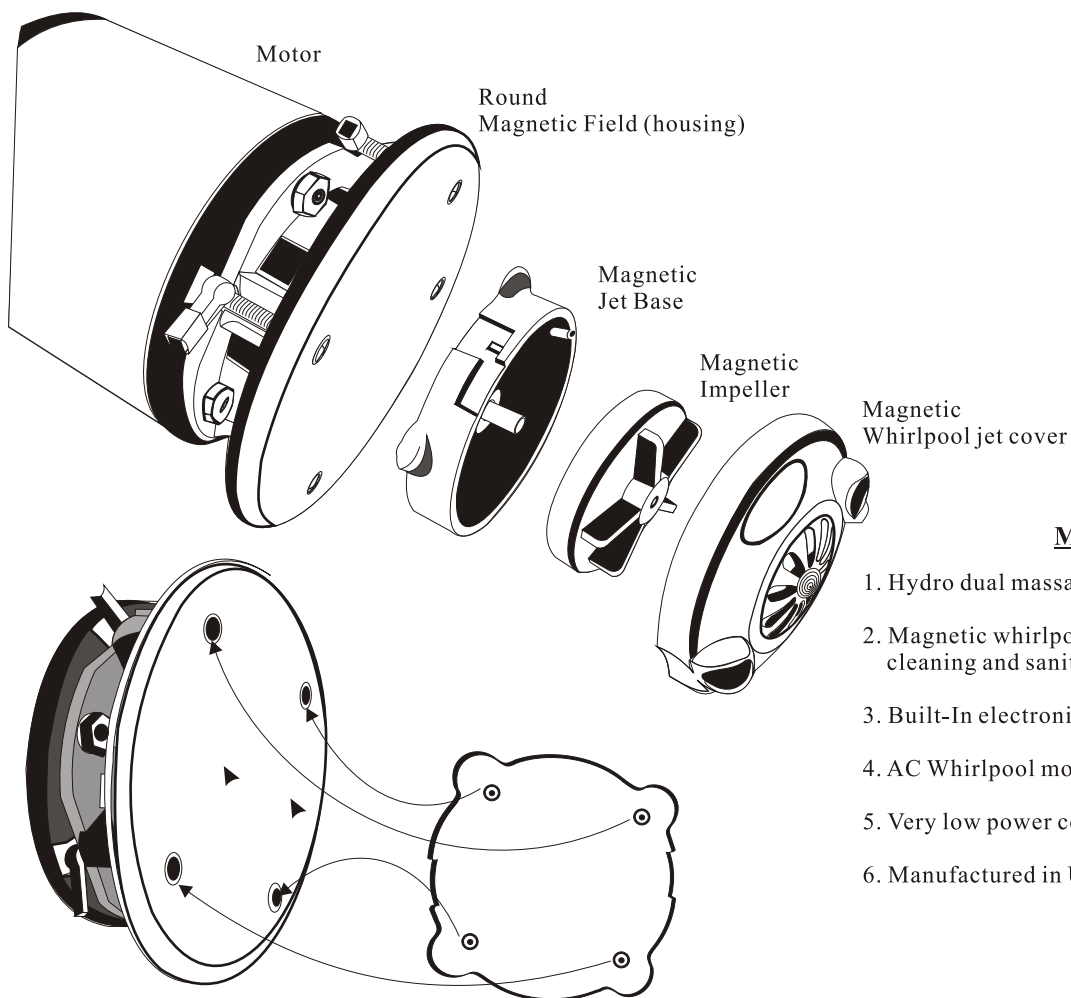

### **MAGNA-JET Features**

1. Hydro dual massage jet stream
2. Magnetic whirlpool jet cover can be remove for quick cleaning and sanitizing.
3. Built-In electronic sensor for pump control.
4. AC Whirlpool motor (long life)
5. Very low power consumption (27W)
6. Manufactured in USA.

### **Cleaning Instruction**

1. Turn off the unit and wait until the motor is fully stops.
2. Hold Hydro whirlpool jet cover firmly and pull to separate from the round magnetic field.
3. Turn hydro whirlpool jet cover to left to open and pull out impeller.
4. Use Anti - Bacterial solution (EPA Registered) to clean all parts.
5. After sanitize all parts, place impeller and close hydro whirlpool jet cover to turn right to lock
6. Hold firmly the whirlpool cover jet and gently place it onto the round magnetic field. Do not release the hydro whirlpool jet cover until Jet cover is on the round magnetic housing.

### **MAGNA-JET Specifications**

Model: MAGNA-JET - 120VAC, 60Hz, 1.0Amp, 27W

Pump: Hydro-Massage Dual jet Flow

Mounting: Single 3.5" hole Diameter  
Auto tighten Mounting screws(4)



## How to USE Magnetic jet !

**WARNING:** DO NOT RUN DRY, BASIN MUST FILLED WITH WATER TO LEVEL INDICATOR.

**CAUTION: MAGNETIC JET COVER ASSEMBLY MUST ALIGN WITH DISCHARGE PORT POSITIONED AT 3/9 O'CLOCK.**

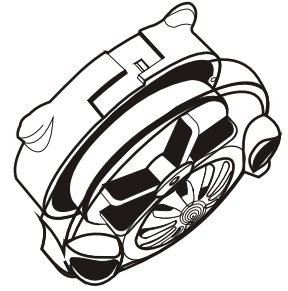

WHEN READY TO USE, **MAKE SURE** JET COVER IS POSITIONED AT **3 /9 OCLOCK** FOR PROPER WHIRLPOOL ACTION IN THE BASIN. IF JET COVER IS **NOT** ALIGN AT 3/9 O'CLOCK, WATER WILL SPLASH OUTSIDE OF THE BASIN.

### **PROPER WAY TO USE MAGNETIC JET SYSTEM**

- 1- FILL THE WATER TO WATER LEVEL INDICATOR.
- 2- HOLD MAGNETIC JET FIRMLY TO BRING CLOSER TO THE ROUND MAGNETIC FIELD AND DO NOT RELEASE THE MAGNETIC JET PREMATURELY OR THIS WILL CAUSE IMPACTS ON THE JET COVER AND THE ROUND MAGNETIC FIELD(HOUSING) SHORTENING THE LIFE EXPECTANCY OF THE JET COVER. WHEN THE JET COVER NEARS THE ROUND MAGNETIC FIELD, PLACE JET COVER ONTO THE FOUR DIMPLE AREA (SEE DIAGRAM). THE JET COVER MUST ALIGN WITH DISCHARGE PORTS POSITIONED AT 3/9 O'CLOCK.
- 3- WHEN FINISHED WITH CLIENT, DO NOT REMOVE MAGNETIC JET UNTIL MOTOR IS FULLY STOPPED.
- 4- WHEN MOTOR IS FULLY STOPPED, REMOVE MAGNETIC JET COVER FROM THE MOTOR AND REMOVE JET COVER AND IMPELLER FOR SANITIZATION.

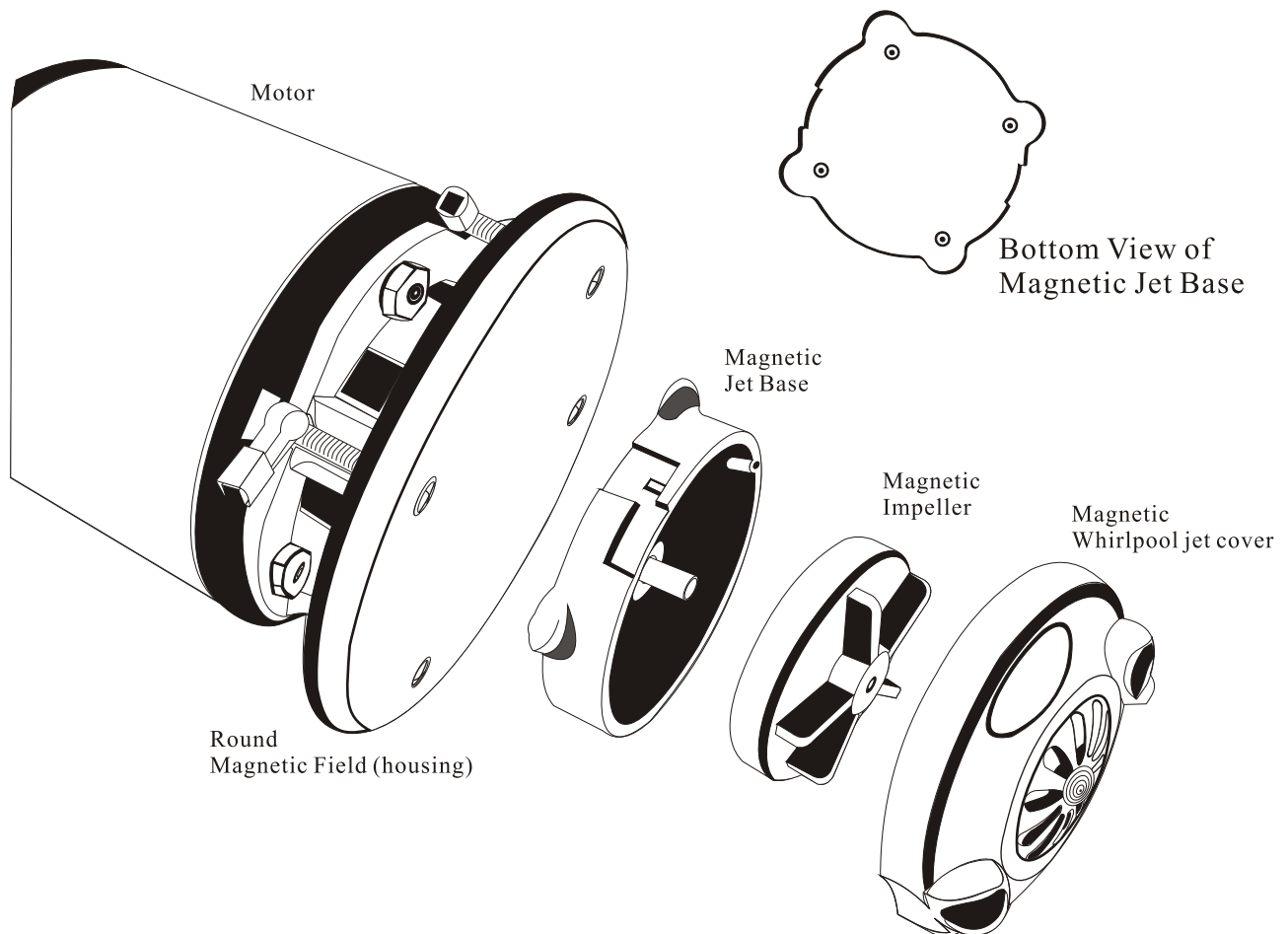

## **Dura-Jet III**

### **Safety Instructions**

**When using electrical equipment, basic safety precautions should always be followed to reduce the risk of fire, electrical shock, and injury to persons, including the following:**

1. Read and follow all instructions before using the equipment.
2. Keep the cord out of heavy traffic area. To avoid fire hazard NEVER put the cord under the rugs, near heat generating devices.
3. Always turn off the equipment before servicing.
4. Do not drop or insert any object into any openings.
5. Do not operate any equipment with a damage parts.
6. Any other use not recommended by the manufacturer may electrical shock or injury to persons.
7. Never use outdoors
8. Do not attempt to repair or adjust any electrical or mechanical functions on the unit.

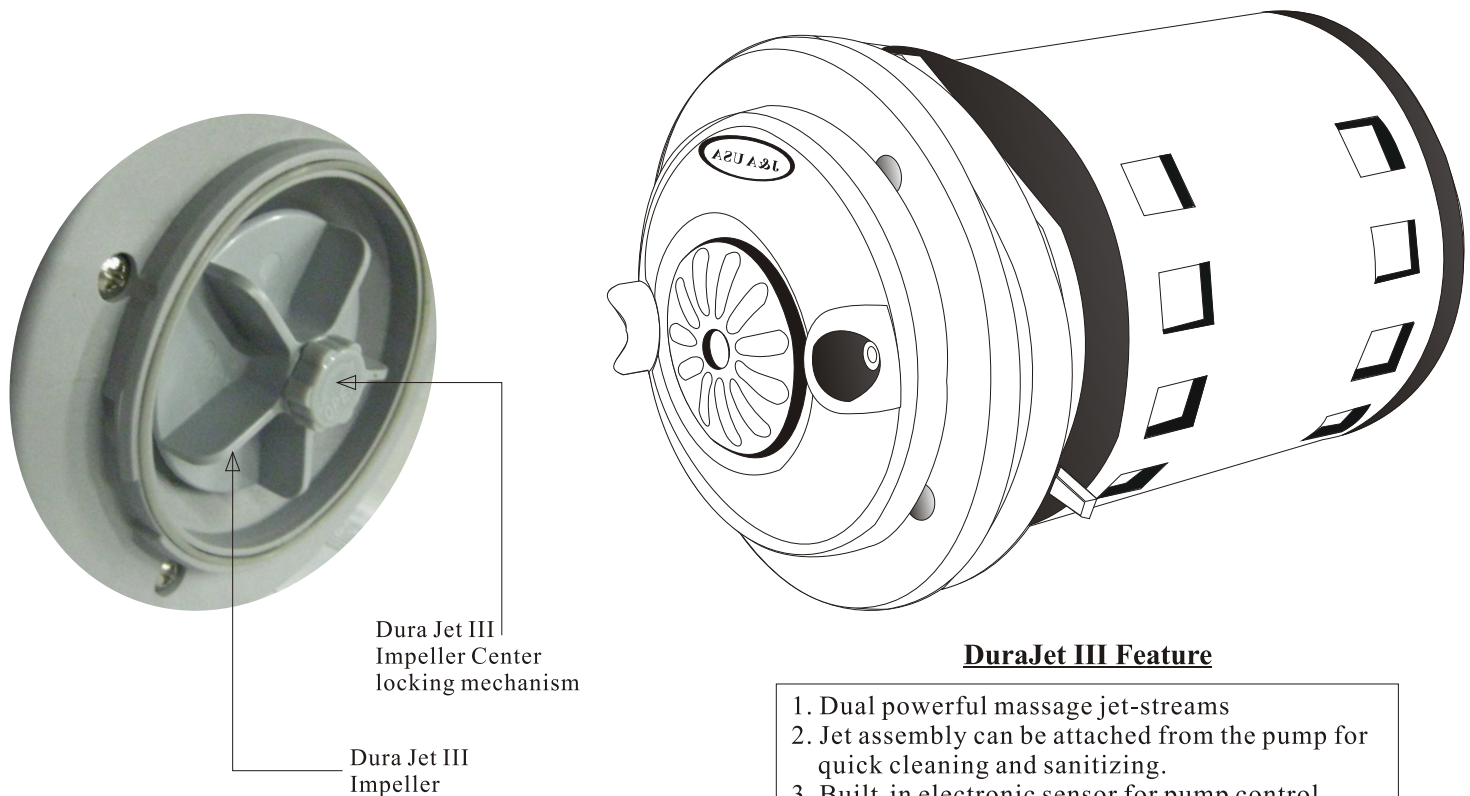

### **DuraJet III Feature**

1. Dual powerful massage jet-streams
2. Jet assembly can be attached from the pump for quick cleaning and sanitizing.
3. Built-in electronic sensor for pump control.
4. AC motor (long life)
5. Extremely low power consumption .
6. Manufactured in USA.

### **Cleaning Instruction**

1. Turn the unit off and wait until the motor is fully stops.
2. Remove the front jet cover and notice the locking screw in the center
3. Remove the locking center screw (turn clockwise) and pull out impeller from housing.
4. Use Anti-Bacterial solution (EPA Registered) to clean all part/s.
5. After sanitization, place impeller onto the motor shaft and fasten with center locking screw ( Turn counter Clock wise).

### **DURA-JET III Specifications**

Model: DURA\_JETIII -120Vac, 0.4 Amp. 60Hz,

Pump: Dual Air Jet Flow

Mounting: Single 3.5" hole Diameter  
Auto tighten Mounting screws(4)

## Discharge Pump

### Petra 900 & Petra RMX (ROMA)

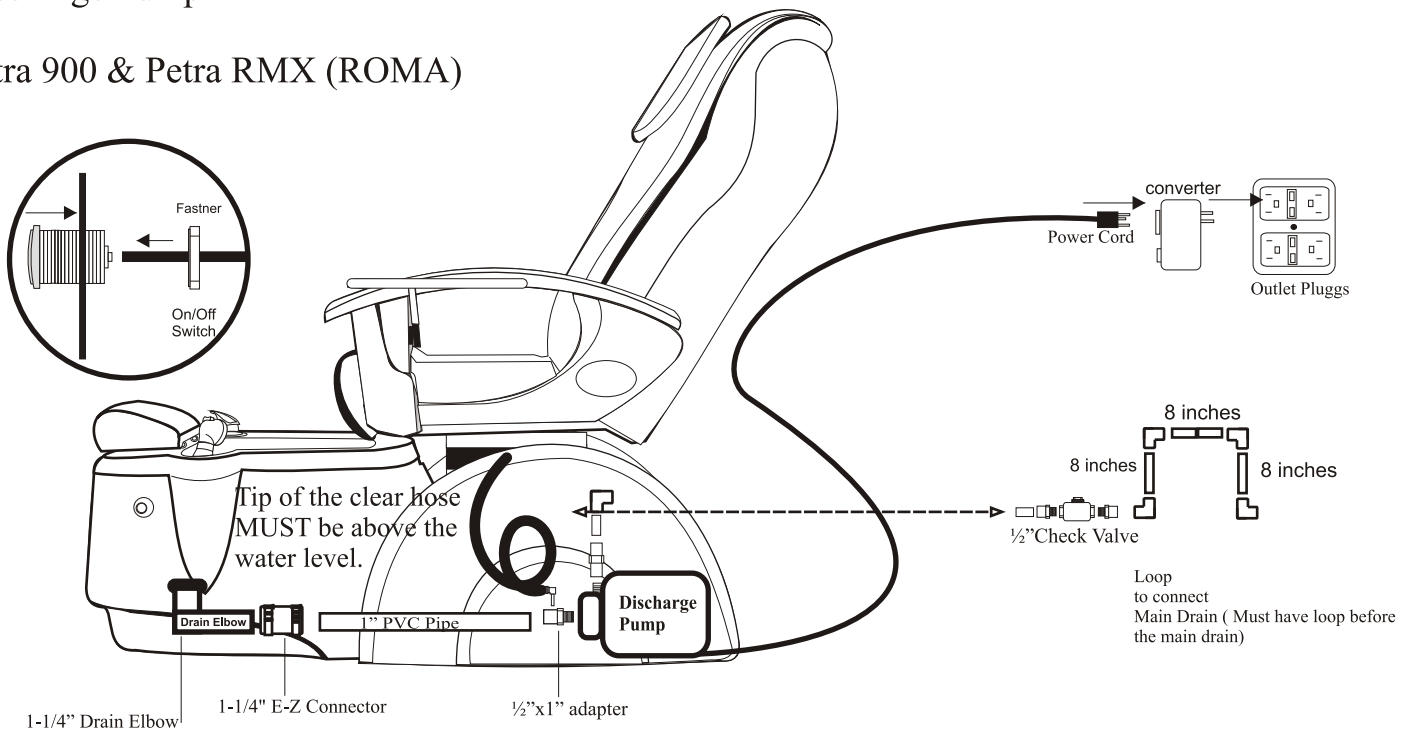

### Installation Instruction

1. Make a hole ( size 1-3/8") for the On/Off switch as shown (see fig 1). Pre-drill required.
2. Placed a 1/8" clear hose into the rear of the switch and on/off switch into the hole.
3. The discharge pump kit is made to fit onto the pedicure unit. (see fig 2)
4. Connect E-Z connector onto the drain elbow.
5. Plug discharge pump outlet into the two minute timer outlet
6. Plug two minute timer into the wall outlet.
7. It is very important that tip of the clear tub remain above the water Level with one loop as shown.

1-3/8" Hole  
for On/Off Switch

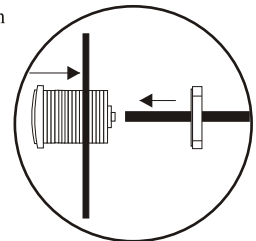

Figure 1

**\*\* Please cut to fit 1" Flex hose to your size\*\***

### Operation Instruction

**Please! DO NOT run dry**

1. Turn to open drain plug.
2. Press On/Off switch to activate timer.
3. At any time, water drain completely from the basin. Press On/Off switch to stop or built in two minute timer.

Tip of the clear hose  
MUST be above the  
water level.

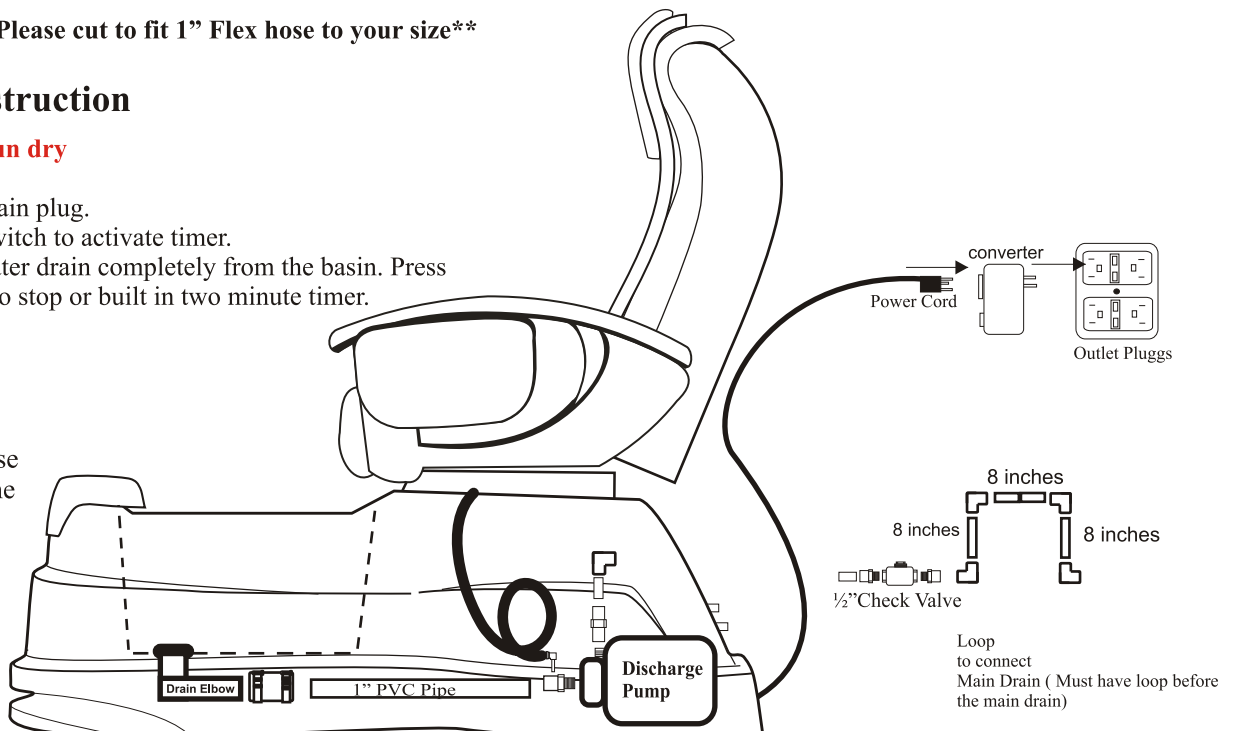

# Maasage System Maintenance

## Backview

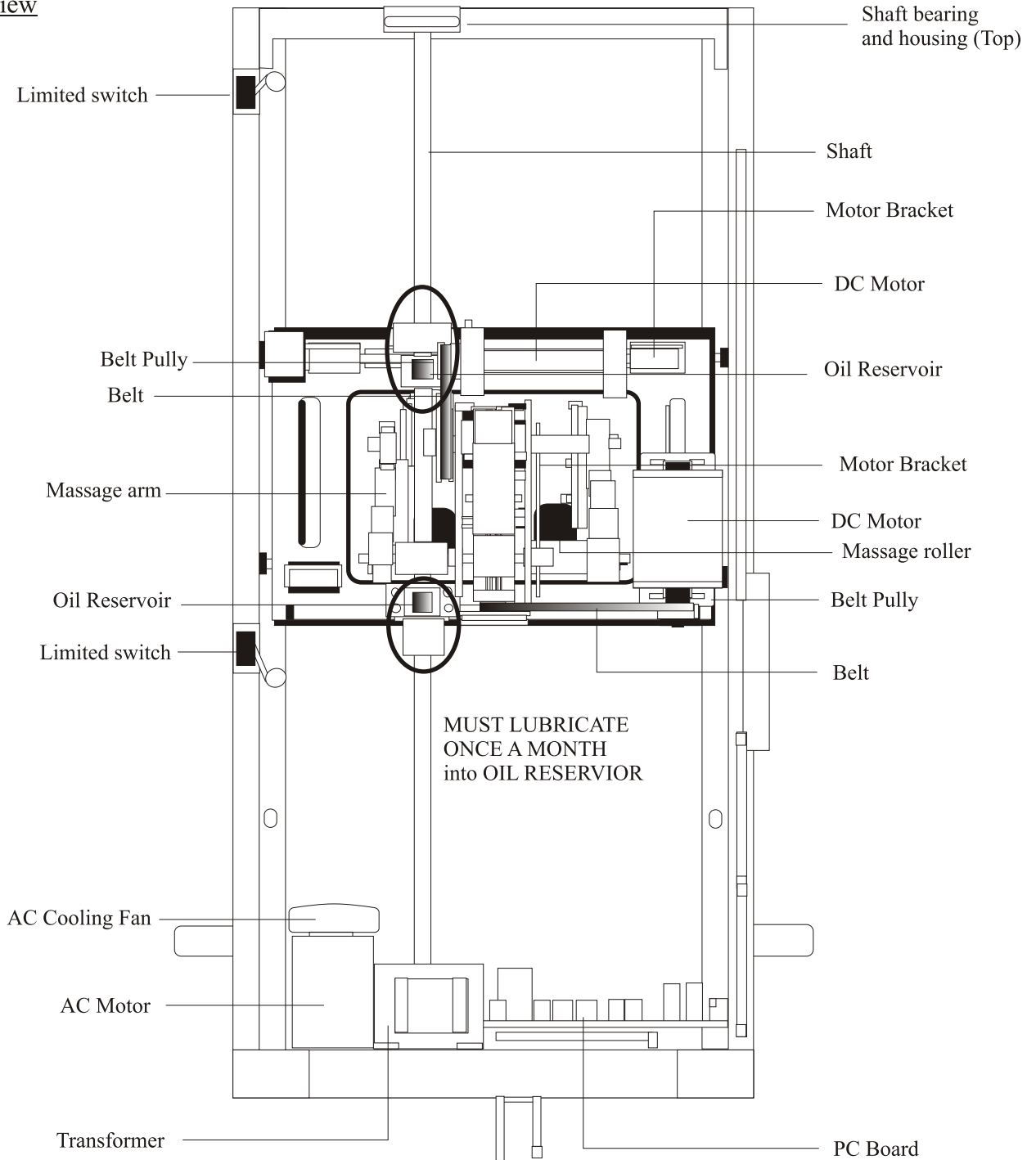

### **Caution**

Do not apply lubricant on DC motor belt

## Bottom View

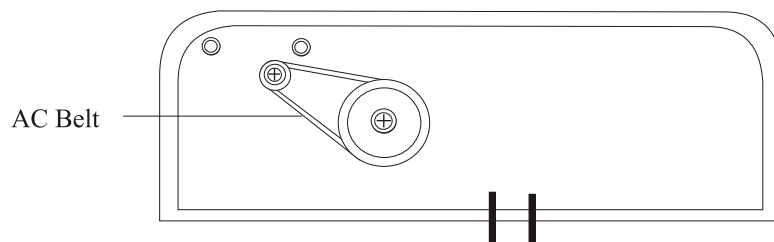

**\* It is strongly recommended by manufacturer, That You MUST lubricate circled area at least once a month!**

## How to remove backrest!!!

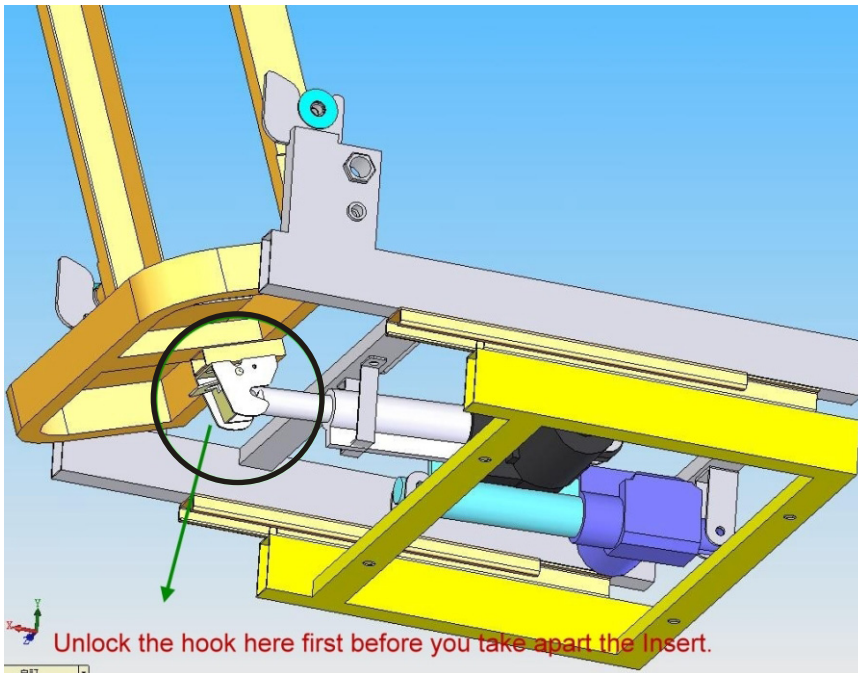

Unlock the hook here first before you take apart the insert.

1. Pressing latch to separate from Piston.
2. Remove backrest by lift up
3. Follow below figures

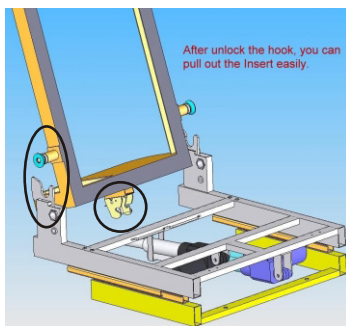

Unlock the hook by pressing latch from recliner piston to pull out insert

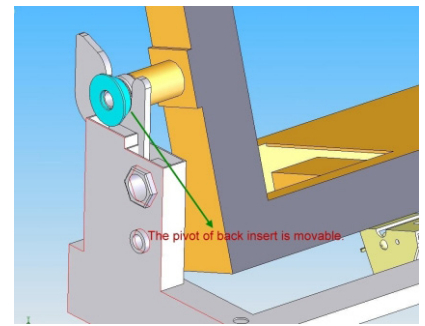
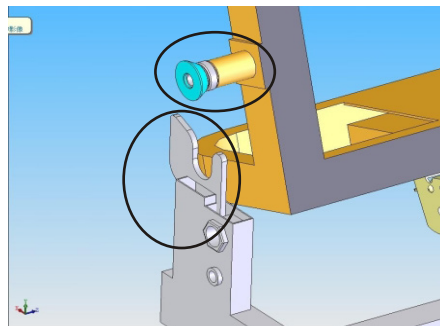

The Pivot of back insert is removable

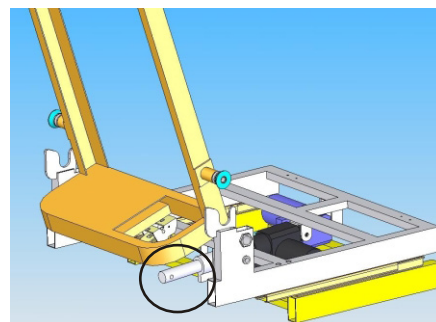

Recliner piston to latch

## **DISINFECTING YOUR PEDICURE SPA**

**Note:** Please be advised that it is responsibility of purchaser/user to adhere strictly to the following procedure.  
Any non-compliance will be considered negligence of the purchaser/user.

The Bureau of barbering and cosmetology requires that salons using whirlpool pedicure spas use the following disinfecting Procedures to ensure proper cleaning and maintenance of the equipment, and to prevent bacterial infection.

### **After each customer:**

1. Drain all water and remove all debris from the pedicure spa.
2. Clean the surfaces and walls of the basin with soap or detergent and rinse with clean, clear water.
3. Disinfect with an EPA - registered disinfectant with bactericidal, fungicidal, and virucidal activity.
4. Wipe dry with clean towel.

### **At the end of the day:**

1. Remove the intake suction screen, All debris trapped behind the screen of each pedicure spa must be removed. And the screen and the inlet shall be washed with soap or detergent and water
2. Before replacing the screen, Totally immersed the screen into an EPA- registered disinfectant with bactericidal, Fungicidal, and virucidal activity.
3. Finally, flush the whirlpool system with low-suding detergent and warm OR an EPA - registered cleanser for 10 minutes. Rinse with clean flash water and drain.

### **Every other week**

1. After following the outlined required cleaning procedures for the end of each day, fill the basin with warm water And 1 teaspoon of 5.25% powdered bleach for each one gallon of water.
2. Circulate the solution through the whirlpool system for 5 to 10 minutes.
3. The solution rests for over night (at least 6-10 hours)
4. The following morning ( before the first customer) drain and flush the system with water.

## USER RECOMMENDATION

PLEASE READ THE MANUAL THOROUGHLY BEFORE USE TO ENSURE CORRECT OPERATION.  
THOSE UNDER A DOCTORS CARE OR WHO ARE EXPERIENCING ONE OR MORE OF THE FOLLOWING DONDITIONS SHOULD CONSULT THEIR DOCTOR BEFORE USE.

- You are receiving medical treatment or are feeling ill.
- Your body shows any cute symptoms.
- You have heart disease.
- You are pregnant or having a menstrual period.
- Your doctor has ordered you to rest.
- You have a back disorder resulting from an accident or disease.
- You have a high fever.
- You have sensory disorders.
- You have medical electrical device (e.g. pacemaker).
- You have service interruption in the circulation of the legs.
- You are diabetic.

FAILURE TO DO SO MAY RESULT IN ACCIDENTS AND HEALTH PROBLEMS.

